

ResMed UltraSoft cushion is designed to uniquely adapt to patient features to deliver uncompromised comfort and seal.

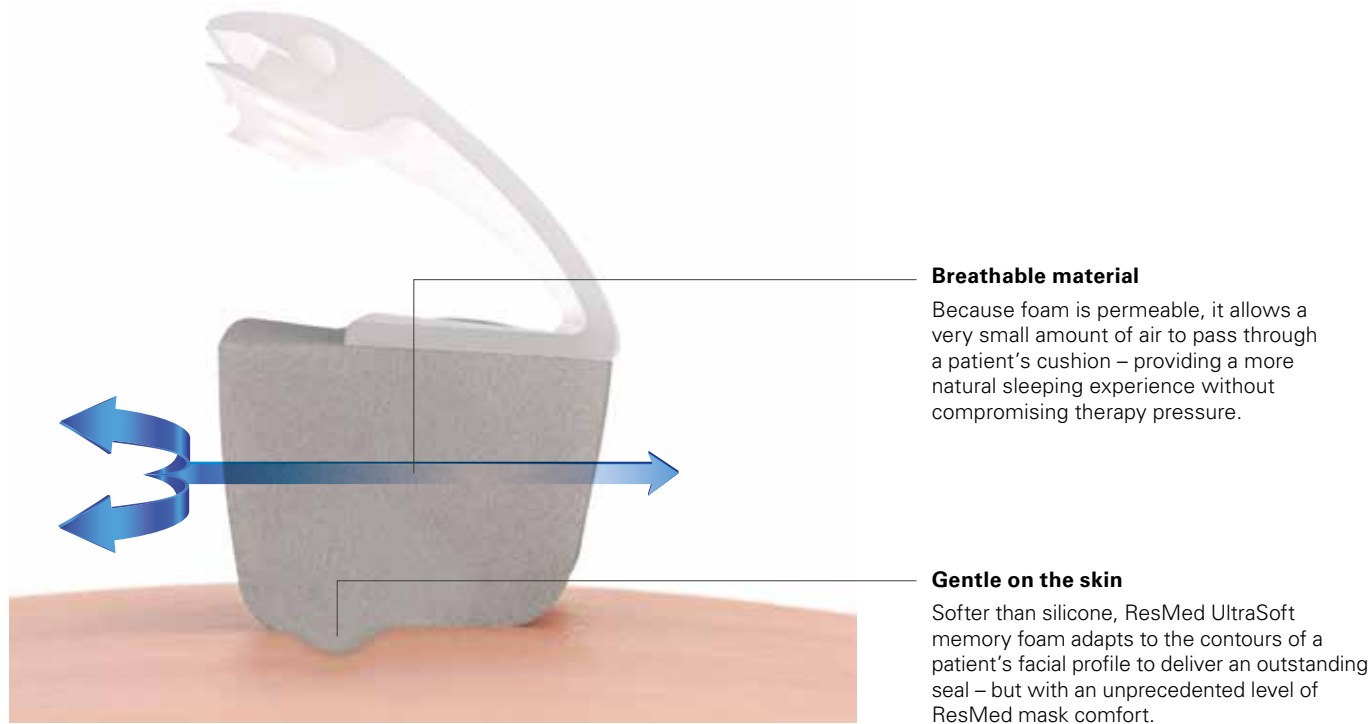

The innovation of ResMed UltraSoft cushion



Regular replacements mean better hygiene and simpler cleaning process

To maintain freshness and mask performance, we recommend replacing AirTouch F20 cushions regularly, so that all patients can maintain better cushion hygiene and feel fresh every day.

AirTouch F20's foam cushion allows for a simpler, smoother cleaning process. Patients who wish to clean their cushions only need to wipe them down with a CPAP wipe or equivalent.



Fitting guide for AirTouch F20

1

- Start by ensuring the magnets on the lower straps are unclipped.
- If they are clipped, detach them by twisting and pulling them away from the frame.

2

- Pull the headgear over your head making sure the logo is facing outwards.

3

- Position the lower straps so they both sit below your ears.
- Bring each of the magnets up to meet their corresponding clips on the frame.

4

- Adjust the fastening tabs on the upper straps until the mask feels even and stable.
- Reattach the fastening tabs.

5

- Repeat Step 4 with the lower straps.
- Reattach the fastening tabs.

6

- Connect your device's air tube to the elbow, then click the elbow into the front of the mask.
- Start your device.

Refer to the user guide for further instructions.



Additional options

- A patient can position the lower part of the headgear over or under their hair to suit any hairstyle preference.

1. ResMed AirTouch F20 internal international fitting study of 34 existing CPAP patients, conducted between 11/04/2016 – 15/04/2016; ID A3774922.
2. ResMed AirTouch F20 internal international fitting study of 43 existing CPAP patients, conducted between 25/07/2016 – 05/08/2016; ID A3846174.
3. ResMed internal testing comparing ResMed UltraSoft memory foam and silicone; ID A3622977.

ResMed Pty Ltd
1 Elizabeth Macarthur Drive
Bella Vista NSW 2153 Australia

Distributed by
ResMed (UK) Ltd 96 Jubilee Avenue
Milton Park Abingdon Oxfordshire OX14 4RW UK

AirFit, AirTouch, InfinitySeal and ResMed UltraSoft are trademarks of ResMed. Specifications may change without notice.
© 2017 ResMed. 1019986/2 2017-09

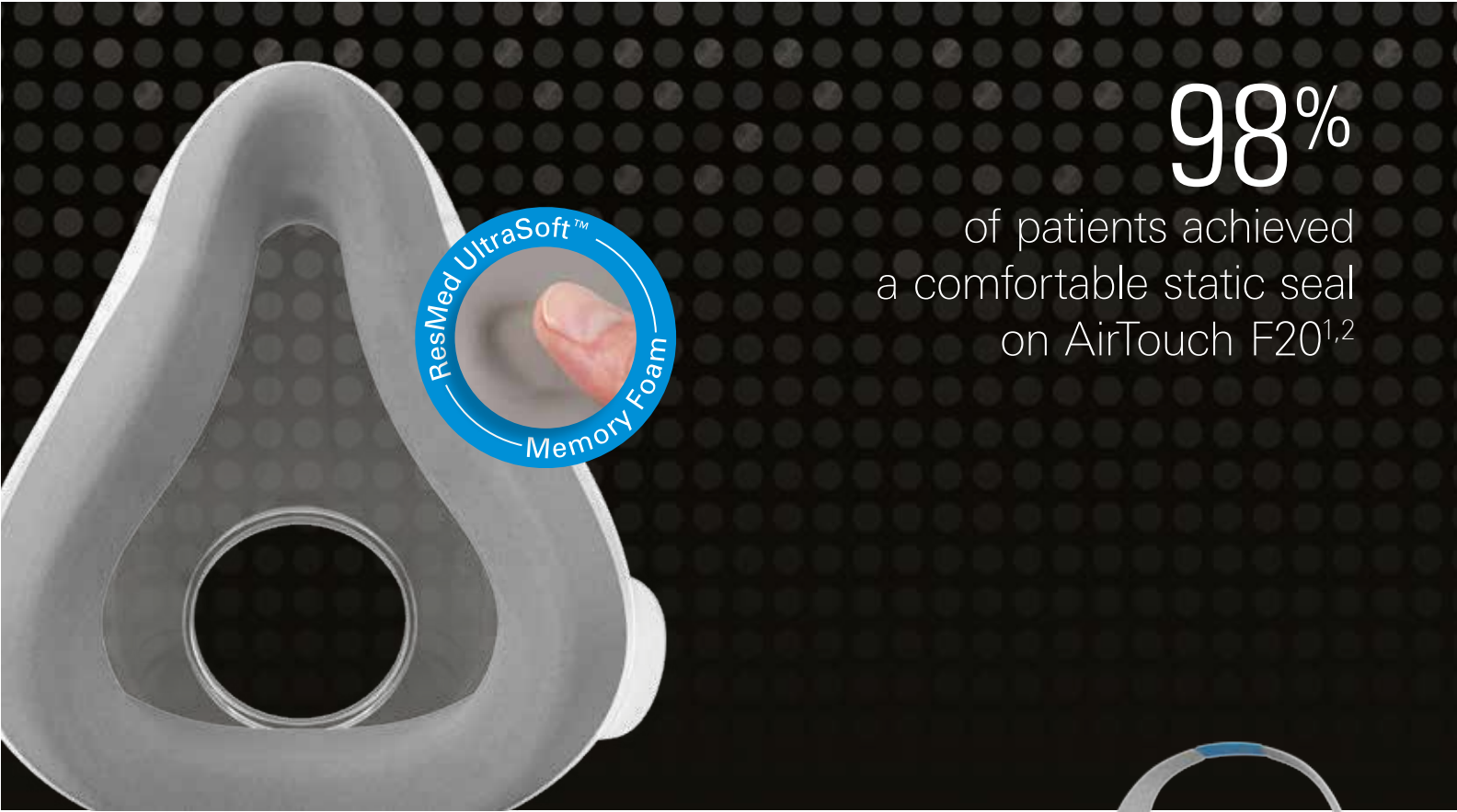

Our softest mask ever

With the AirTouch F20 mask, ResMed introduces the first ever replaceable memory foam cushion to the market. Offering patients a completely new experience thanks to its superior comfort, the new AirTouch cushion is also fully compatible with the AirFit™ F20 mask.

Superior comfort

With a softer,³ breathable material, the AirTouch F20 mask not only feels lighter against the skin, but may be less likely to cause red skin marks.

A gradual but uncompromising seal

The light and supple foam cushion gradually adapts to a patient's face to seal securely and prevent leaks during therapy.

Modular with AirFit F20

AirTouch F20 is made with interchangeable components that will allow you to easily mix and match components with AirFit F20 mask.



In evaluating mask comfort, patients consistently awarded AirTouch F20 higher scores than the market-leading full face mask. They gave it an average score of 8.5/10.²



Sizing tips

AirTouch F20 has three interchangeable cushion sizes - small, medium and large. The modular design of the AirTouch F20 means each size of cushion easily clicks into the same mask frame, so you can swap between them with ease for more flexibility.

We recommend that you refer to the mask fitting template (also applicable for AirFit F20) to gauge which size is the most suitable for each of your patients.

You can download it on [ResMed.com/AirTouchF20](https://www.resmed.com/AirTouchF20).

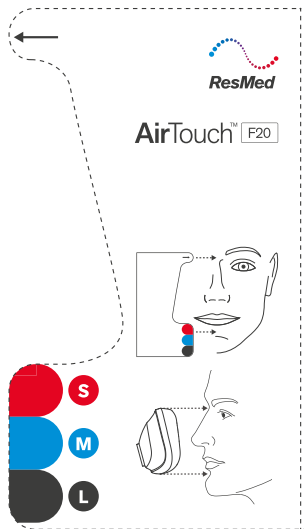

Minimal and modular parts

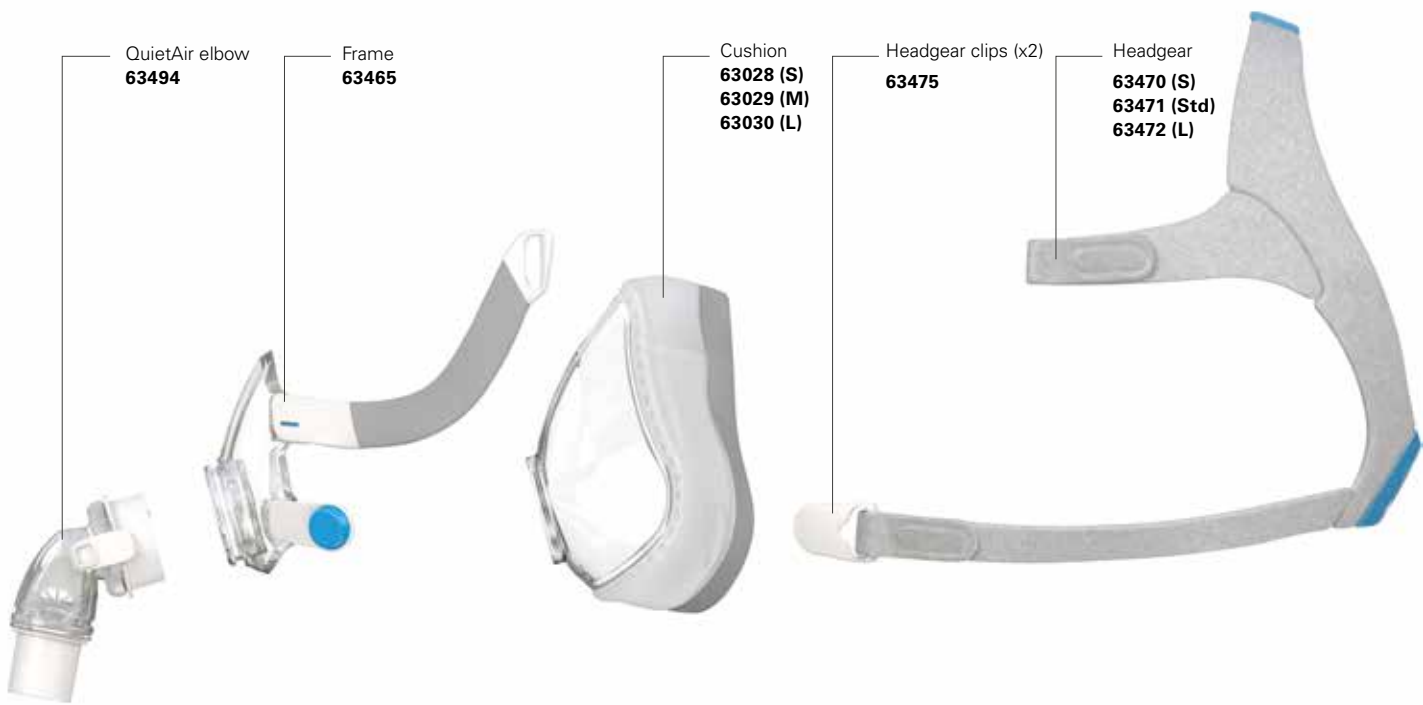

Two cushion types, one frame

Both AirFit F20 and AirTouch F20 cushions are optimised to perform, giving you options to find a solution that maximises comfort and therapy compliance.



Visual freedom
Let patients see and do more in bed with an under-the-eye frame that combines all-round stability and less facial contact.

Soft and gentle
Specifically designed for extra softness and stability, the plush headgear helps ensure patients settle into therapy quickly and comfortably.

Fast fitting time
Less than one minute is needed to fit AirFit F20.¹ Taking the mask on and off is convenient and intuitive, with magnetic clips that guide the headgear to the frame in seconds.

Comfortable seal and fit
Set patients up for comfortable and compliant therapy with a softer cushion that's been designed to reduce facial markings, tolerate mask movement and provide enduring comfort.

Soft and flexible frame
Helping support a wider range of patients, the soft, flexible frame adapts to different face shapes while its integrated padding adds comfort.

Flexible connection and movement
The elbow's quick release feature enables easier connection or disconnection at night, while its 360° rotation capability allows for greater freedom of movement.



QuietAir™ elbow for peace and quiet
The QuietAir diffuser vent minimises noise and gently disperses exhaled air. As a result, the whisper-quiet ResMed AirTouch™ F20 generates just 21 dBA of noise.

Being part of the Air20™ series means you can easily mix and match mask components to fit your business and your patients' needs. Your patients will always get uncompromised comfort and seal, regardless of the solution you configure for them.

AirTouch F20 cushions are also compatible with AirFit F20 for Her masks, so female patients can enjoy the comfort of UltraSoft foam alongside the outstanding fit of a female-specific mask.

Product codes

Europe 1			
AirTouch F20 system: Small	63034	AirTouch F20 cushion: Small	63028
AirTouch F20 system: Medium	63035	AirTouch F20 cushion: Medium	63029
AirTouch F20 system: Large	63036	AirTouch F20 cushion: Large	63030

Europe 1: English, German, French, Dutch, Italian, Norwegian, Swedish, Finnish, Spanish.