

G3 Wireless Mouse

Warm Reminder: The product images shown are for illustrative purposes only; the actual product shall prevail.

PRODUCT OVERVIEW

PART 1

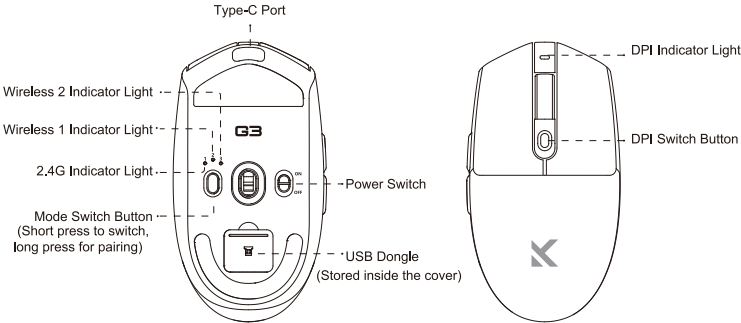

CONNECTION MODE

PART 2

1 Charging/Wired Connection

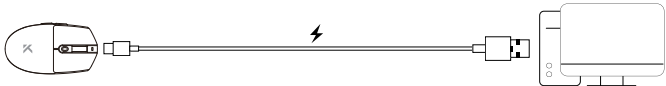

- Connect the cable to Type-C port of the mouse, and connect the cable to the USB port of the computer. The mouse is ready to use.
- In 2.4G/wireless mode, plugging in the USB cable automatically switches the mouse to wired mode and simultaneously charges the mouse.

2 2.4G Connection

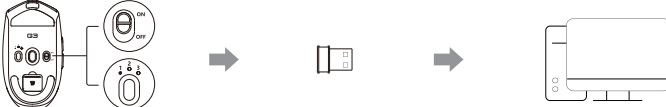

- Switch the toggle to [ON], short press to switch the [2.4G]. Take out the USB dongle at the bottom of the mouse and insert it into the USB port of the computer. The mouse is now ready for use.
- Manual pairing dongle (The dongle is default paired): Press the [Mode Switch] until the indicator light flashes to enter the pairing status. Insert the USB dongle into the USB port of the computer. The mouse is close to the USB dongle (within 20cm), and the [Indicator light] will be off after a successful connection.

3 Wireless Connection
(Wireless 1 and Wireless 2 connection methods are the same)



Toggle the switch to [ON], then short press to switch to [Wireless 1]. Press and hold until the indicator light flashes quickly to enter pairing mode. Search for the device named [G3 Mouse], and the indicator light turns off after the connection is successful.

Indicator Status

PART 3

01.DPI Adjustment

Single press the [DPI Switch Button] to cycle through six DPI levels, adjustable via the driver.

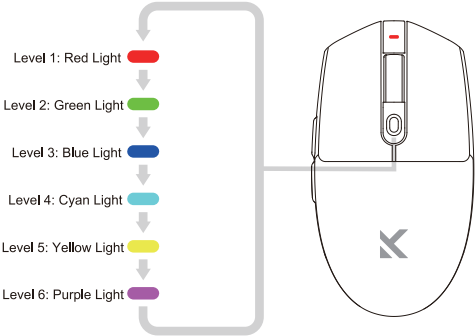

Indicator Status

PART 4

02.Battery Status Indicator

When the [Indicator Light] flashes red, please charge the mouse promptly.



- The red indicator light is flashing: Please charge immediately.
- The red indicator light is on: Charging in progress.
- The green indicator light is on: Charging completed.

Note: This device has been tested and complies with the limits for Class B digital devices under Part 15 of the FCC Rules. These limits are designed to provide reasonable protection against harmful interference in residential installations. This device generates, uses, and can radiate radio frequency energy, and if not installed and used in accordance with the instructions, may cause harmful interference to radio communications. However, there is no guarantee that interference will not occur in a particular installation. If this device does cause harmful interference to radio or television reception (which can be determined by turning the device off and on), we encourage the user to try one or more of the following measures to correct the interference:

- Reorient or relocate the receiving antenna.
- Increase the separation between the equipment and the receiver.
- Connect the equipment to an outlet on a circuit different from that to which the receiver is connected.
- Consult the dealer or an experienced radio/TV technician for help.

Changes or modifications not expressly approved by the responsible party could void the user's authority to operate the equipment. This device complies with Part 15 of the FCC Rules. Operation is subject to the following two conditions:
(1) This device may not cause harmful interference.
(2) This device must accept any interference received, including interference that may cause undesired operation.

CHARGING INSTRUCTIONS

1. It is recommended to charge the keyboard only via a computer USB port.
2. Avoid using substandard or non-compliant power adapters to charge the keyboard.
3. Avoid using over-voltage or over-current power adapters for charging.
4. Keep the keyboard away from high-temperature devices while charging.
5. Please turn off the power switch if the device will not be used for an extended period.

These charging instructions also apply to other rechargeable devices (keyboard/mouse/headphones/speakers, etc.).

WARRANTY CARD

Thank you for purchasing our product. Please contact us If there are any quality issues within the warranty period. Please provide this warranty card so we can provide comprehensive after-sales service.

Product Items: _____ Customer Name: _____

Serial No. : _____ Contact Address: _____

Purchase Date: _____ TEL / E-mail: _____

Purchase Channel: _____ Postcode: _____