

Cautions

(PLEASE READ ALL INSTRUCTIONS BEFORE ASSEMBLING AND USING THE DIFFUSER. )

Avoid casualties and property loss, please always follow the instructions as below.



**WARNING**  
When using electrical appliances, basic precautions should always be followed to reduce the risk of fire, electric shock, property damage and injury to person, including the following:

INSTALLING

- Use appliance only as described in this manual. Any other use not recommended by the manufacturer may cause fire, electric shock, property damage, or injury to person.
- To avoid fire or shock hazards, plug the appliance directly into a safe electrical outlet. DO NOT plug in the cord with wet hands.
- Keep the cord out of heavy traffic areas.
- DO NOT operate any appliance with a damaged cord or plug, after the appliance malfunctions, or if it has been dropped or damaged in any manner.
- DO NOT use the diffuser in a high temperature or wet environment.
- DO NOT allow the mist outlets to face the wall directly. Install the diffuser in a ventilated and adequate space.
- NEVER place the diffuser in an area where it is accessible to children.
- DO NOT operate the diffuser without first turning off the unit. Failure to heed this warning may cause personal injury. NEVER tilt, move, or attempt to empty the unit while operating.
- DO NOT block the air outlet while the unit is running.
- Always place the diffuser on a firm, flat, level surface. NEVER place it on a rug or carpet, or on a finished floor that may be damaged by exposure to water or moisture.
- DO NOT use inflammable, explosive, corrosive, and other hazardous solvents with the diffuser. DO NOT spill water or corrosive liquid on the diffuser surface.
- Suggested average daily usage time should not exceed 14 hours.
- Shut down the unit in an extreme weather environment.



**ATTENTION**  
This diffuser should only be used with fragrance oil without adding water. For a better performance of the perfume in the environment, we recommend using AROMAPLAN's scents only.

Specification

Model: **DAP 1001 (white) / DAP 1002 (black)**  
Voltage: **12V**  
Power: **7.5W**  
Capacity: **10.14 fl oz / 300ml**  
Weight: **0.9KG**  
Coverage: **up to 1500SF**  
Size: **(L) 6.7 in X (W) 3.17 in X (H) 8.11 in**

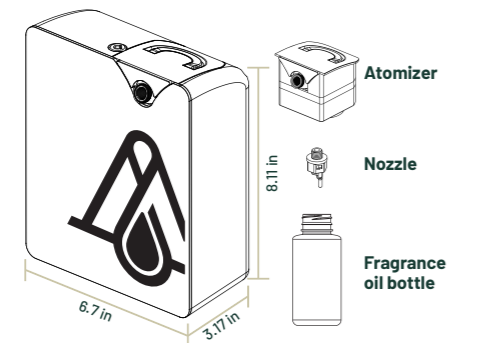

AromaPlan®

Owner's Manual

White Diffuser DAP-1001 & Black Diffuser DAP-1002



AromaPlan's scent diffusers are powerful and easy to use. Our innovative technology converts the liquid perfume into dry vaporous microparticles, creating a practically invisible mist that drifts evenly throughout any space.

When using scented candles, most of the scent is immediately around the candle. Our diffusers are different from candles in that the space is evenly scented, regardless of where you are.

AromaPlan's diffusers give you ultimate control. You can program its working period and intervals, as well as when it will automatically turn on and off to perfectly scent your environment according to your daily needs, without ever wasting your favorite fragrance.



Covers up to 1500 SQ FT



NO FLAME



ECO-FRIENDLY



No water is required with our scents.



NO RESIDUE



PET-FRIENDLY

Features:

- Easy floor or wall installation.
- Space evenly scented.
- No Residue.
- Safe for Kids & Pets
- Diffusion without heating or water.

- Automatic scheduling on/off according to your daily needs.
- Ultracold mist.
- Microparticles permit immediate and even diffusion for lasting results.



Register now your diffuser through the **QR CODE** to get a 1-year warranty.

PLEASE READ ALL INSTRUCTIONS BEFORE ASSEMBLING AND USING THE DIFFUSER.



Accessories and spare parts

NAME	QUANTITY	NAME	QUANTITY
Aroma diffuser	1PC	Manual	1PC
Adapter	1PC	Fragrance card	1PC
Cap	1PC	Nozzle gasket	1PC
Key	2PC	Thank you Card	1PC
Pneumatic fittings	1PC		

After sales service support

1. **Free Technical Solutions** and **Installation Process Guidance.**

2. **Free online FAQ consultation** and **scent-marketing suggestions.**

Warranty

1. The equipment has a 1-year warranty from its date of purchase (please keep your proof of purchase).

2. This warranty does not cover damage resulting from human error, faulty operation, unauthorized attempts to repair, or from any use not in accordance with the instruction manual.



AromaPlan United States  
Distributed by Fullysense LLC

**www.aromaplan.com**

FOLLOW US ON OUR SOCIAL NETWORKS:

  **@aromaplglobal**

CUSTOMER SERVICE:  
E-mail: **support@aromaplan.com**  
Phone: **+1 321 710-9232**  
WhatsApp: **+1 407 312-3317**



POWERFUL, SAFE AND EASY TO USE



AromaPlan®

Owner's Manual

WHITE DIFFUSER - DAP 1001 & BLACK DIFFUSER - DAP 1002

+ APP FOR IOS AND ANDROID (VIA BLUETOOTH)

TO START CONFIGURING THE DIFFUSER, DOWNLOAD THE APP VIA QR CODE



**ATTENTION!**  
This diffuser is only configured through the app via Bluetooth.



In case of doubt, contact our **CUSTOMER SERVICE!**

## How to use the equipment

### Follow these steps to use your scent diffuser



## APP Operations and settings

### 1. Install the APP

TO START CONFIGURING THE DIFFUSER,  
DOWNLOAD THE APP VIA QR CODE



**ATTENTION!**  
This diffuser is only configured  
through the app via Bluetooth.

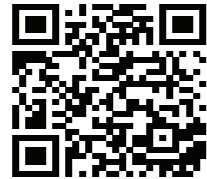

If you have other questions, please contact our **CUSTOMER SERVICE!**

### 2. Open the APP

Swipe the initial slides and click on the button **[EXPERIENCE IMMEDIATELY]**

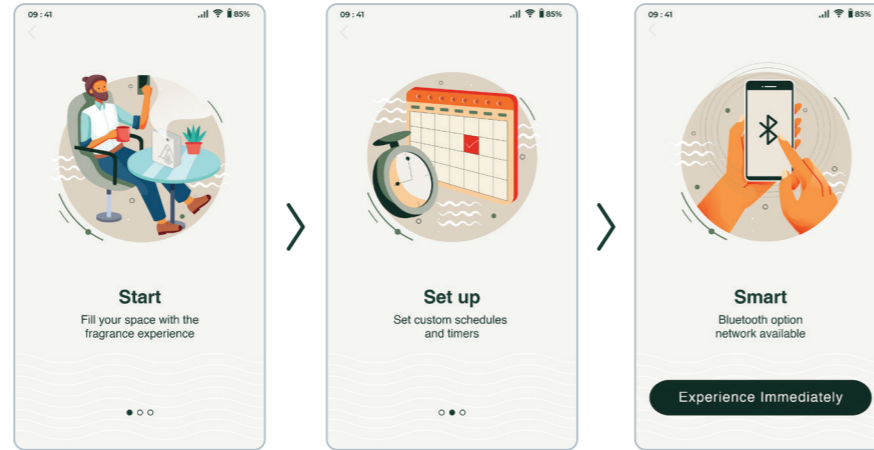

#### ATTENTION!

This diffuser is fully APP controlled via **Bluetooth**.  
If you have other questions, please contact our **CUSTOMER SERVICE!**

### 3. Bluetooth

Go to Settings on your smartphone and make sure the Bluetooth is **ON**.  
Click **[BLUETOOTH]**, the APP automatically searches for nearby diffusers,  
and click on the diffuser name to connect. The default password is: **"1234"**

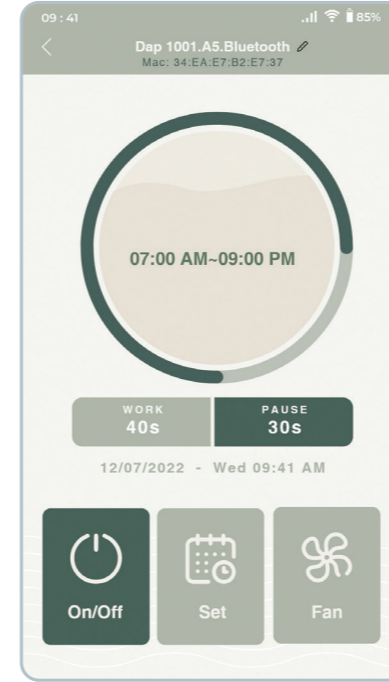
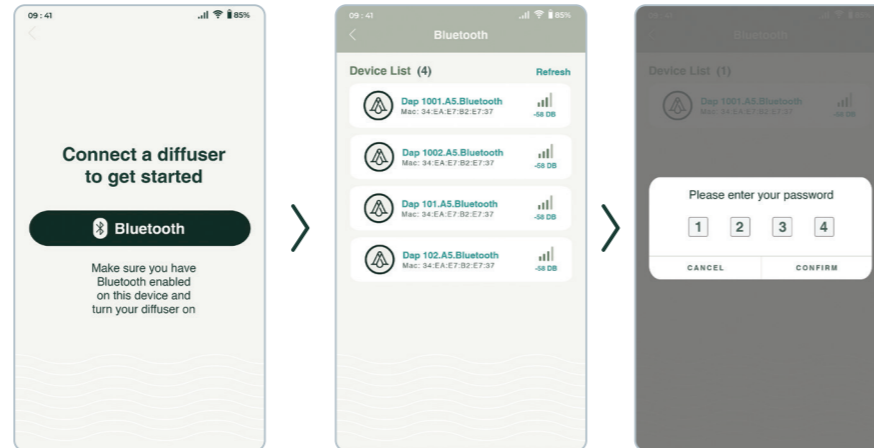

### 4. The control interface is shown below:

Through the app, control the diffuser's functions ON and OFF, TIMES and DAYS.

Follow the operation of your equipment through the animate countdown timer of working time.

Below, we have the **WORK** time and the essence diffusion **PAUSE** time.



Click **[ON/OFF]** to turn On or Off the diffuser



Click **[Set]** to set the Working Period and Working Frequency



Click **[Fan]** to turn on or turn off the fan

### 5. Working Period Panel

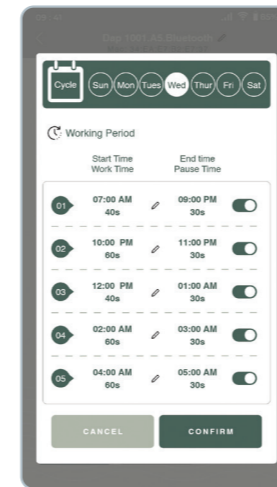

Clicking **[Set]** opens the **Working Period Panel**.  
click on the icon to edit your diffuser diffusion scent **PERIOD** and **WORKING FREQUENCY**.

**You can change** the working hours and pauses for each day of the week, or you **can select the desired days of the week** to change them accordingly.



Once you select all the days, the icons will be highlighted, so you will change everything at once. The selected day of the week will become highlighted when you click on it.

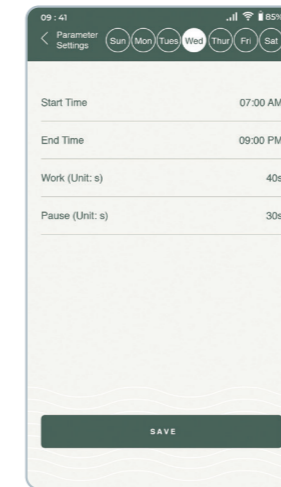

### 6. Reset your AromaPlan Diffuser to factory settings:

- 1 - Please make sure that your AromaPlan Diffuser is connected to power.
- 2 - On the left side of the diffuser, press and hold the button below the light until you hear 5 continuous BEEPS. Then release the button.
- 3 - Wait about a minute for the diffuser to finish restarting.
- 4 - When you hear a long BEEP, the diffuser will reset to its original factory settings.



## Frequently asked questions

### 1- How to clean the diffuser?

Let the diffuser run for 10 minutes with liquid alcohol to clean the filter and diffuser nozzle at each fragrance change.

### 2- How long does the fragrance oil last before I need to refill the diffuser?

On average, this diffuser consumes 1ml per hour.

### 3- How do I connect my diffuser to the air conditioner?

To connect your diffuser to the air conditioner, please contact our customer service for instructions.

FCC Warning:

This equipment has been tested and found to comply with the limits for a Class B digital device, pursuant to part 15 of the FCC Rules. These limits are designed to provide reasonable protection against harmful interference in a residential installation. This equipment generates, uses and can radiate radio frequency energy and, if not installed and used in accordance with the instructions, may cause harmful interference to radio communications. However, there is no guarantee that interference will not occur in a particular installation. If this equipment does cause harmful interference to radio or television reception, which can be determined by turning the equipment off and on, the user is encouraged to try to correct the interference by one or more of the following measures:

- Reorient or relocate the receiving antenna.
- Increase the separation between the equipment and receiver.
- Connect the equipment into an outlet on a circuit different from that to which the receiver is connected.
- Consult the dealer or an experienced radio/TV technician for help.

Caution: Any changes or modifications to this device not explicitly approved by manufacturer could void your authority to operate this equipment.

This device complies with part 15 of the FCC Rules. Operation is subject to the following two conditions:

(1) This device may not cause harmful interference, and (2) this device must accept any interference received, including interference that may cause undesired operation.

This equipment complies with FCC radiation exposure limits set forth for an uncontrolled environment. This equipment should be installed and operated with minimum distance 20cm between the radiator and your body.