



MAKE A DIFFERENCE

Front Bumper

BXG.8542

(INSTALLATION INSTRUCTION)

ATTENTION • Please verify all parts are present and read instructions carefully before starting installation.
Please feel free to contact your distributor if you have any kind of question about your purchase.

CONTENTS

Left

Right

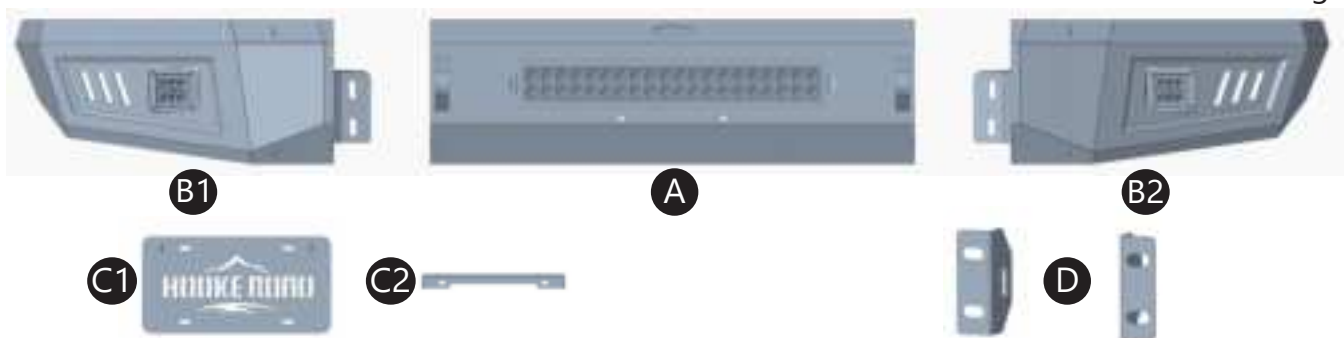

A: Main Body

B1&B2: Wings

C1&C2: License Plate Bracket

D: Mounting Brackets

Qty	Part Name	Size(mm)	Picture	Qty	Part Name	Size(mm)	Picture
2	Hex Bolt	M12*110		22	Flat Washer	M12*30*1.5	
4	Hex Bolt	M12*35		4	Flat Washer	M6*12*1	
10	Hex Bolt	M12*30		2	Nylon Round Spacer	M6*12*1.3	
2	Hex Bolt Plate	M12*35		12	Hex Nut	M12	
4	Button Bolt	M6*16		4	Nylon Lock Nut	M6	
16	Split Lock Washer	D12		2	EVA		

TOOLS REQUIRED

◆ Drive Ratchet Handle

◆ 10mm, 19mm Wrench

◆ 4mm Hex Bit Socket

To view online instruction, please
scan the QR code.



3 INSTALLATION INSTRUCTION

Step 1

Stick the EVA to the bumper and install the left wing to the main body using (3) M12x30mm hex bolts, (3) D12 lock washers, (3) M12x30x1.5mm flat washers, (3) M12 hex nuts. Repeat this step for the opposite of the bumper. Tighten the hardware.

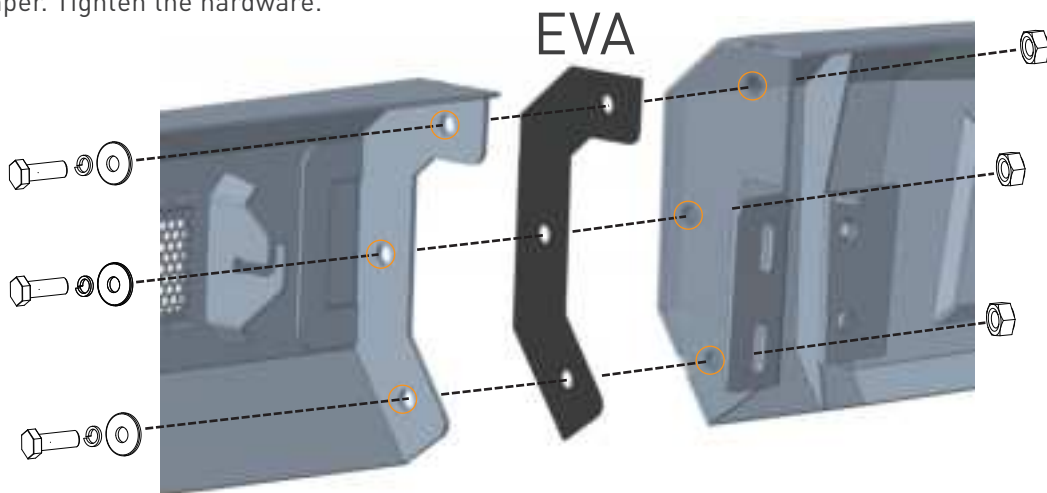

Step 2

Assemble the license plate brackets using the (2) M6x16mm button bolts, (2) M6x12x1mm flat washers, (2) M6x12x1.3mm nylon round spacer, (2) M6 nylon lock nuts.

Install the assembled license plate bracket to the bumper using the (2) M6x16mm button bolts, (2) M6x12x1mm flat washers, (2) M6 nylon lock nuts. Tighten the hardware.

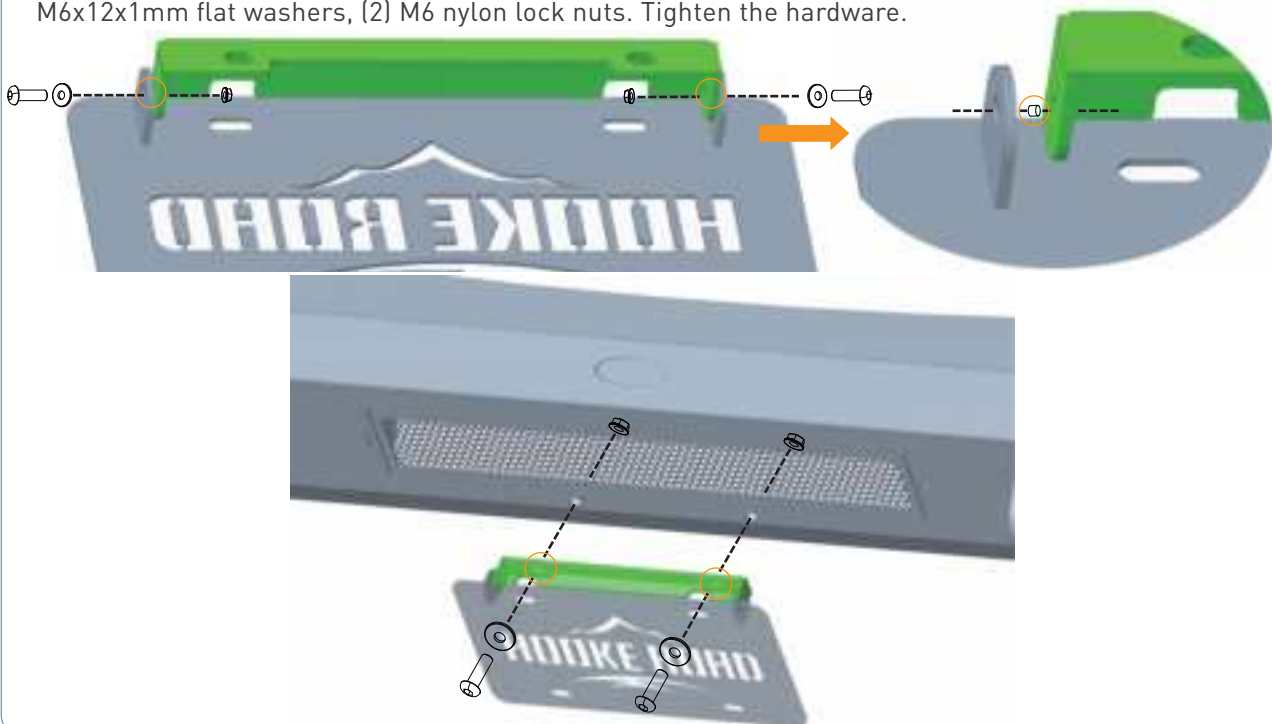

Step 3

Install the mounting bracket to the bumper using the (2) M12x30mm hex bolts, (2) D12 lock washers, (2) M12*30*1.5 flat washers. Repeat this step for the opposite of the bumper. Tighten all bolts.

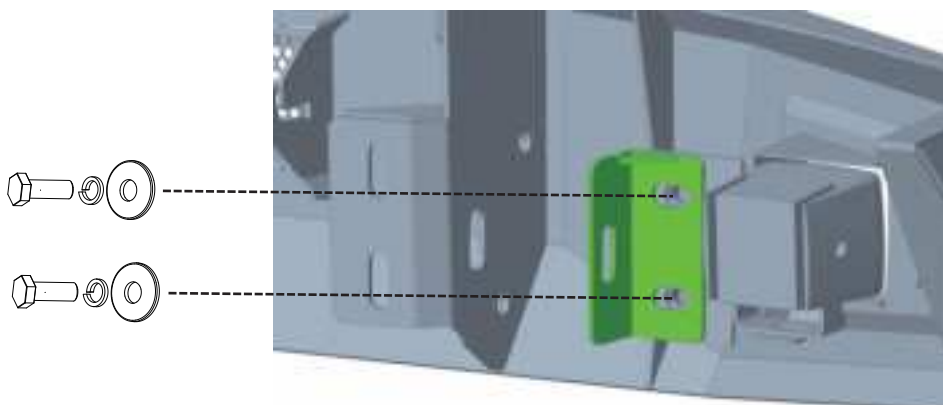

F-150 INSTALLATION INSTRUCTION

Step 4

Place the vehicle in park, remove the factory bumper from the frame.

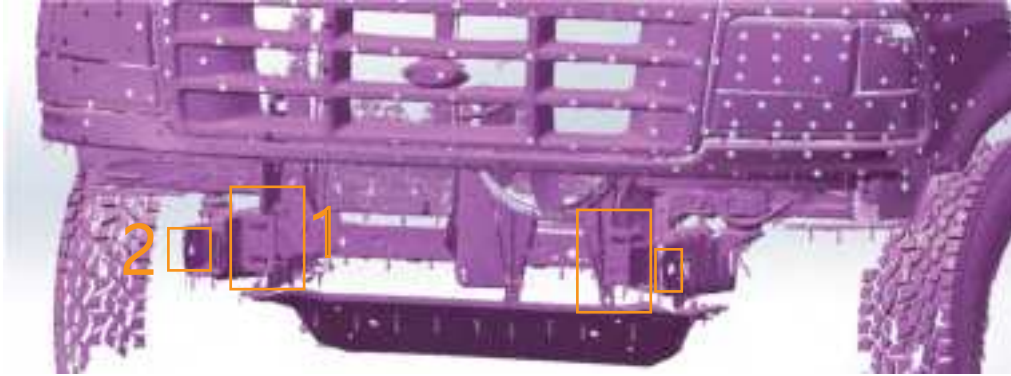

Step 5

Place the hex bolt plate to the vehicle. Repeat this step for the opposite of the vehicle.

2

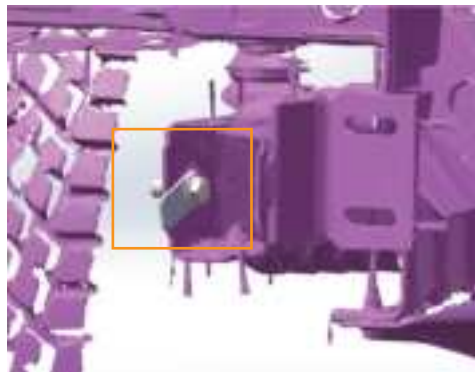

Step 6

Install the bumper to the vehicle using the (2) M12x35mm hex bolts, (2) D12 lock washers, (4) M12*30*1.5 flat washers, (2) M12 hex nuts. Repeat this step for the opposite of the vehicle. **Do not fully hardware to allow adjustability.**

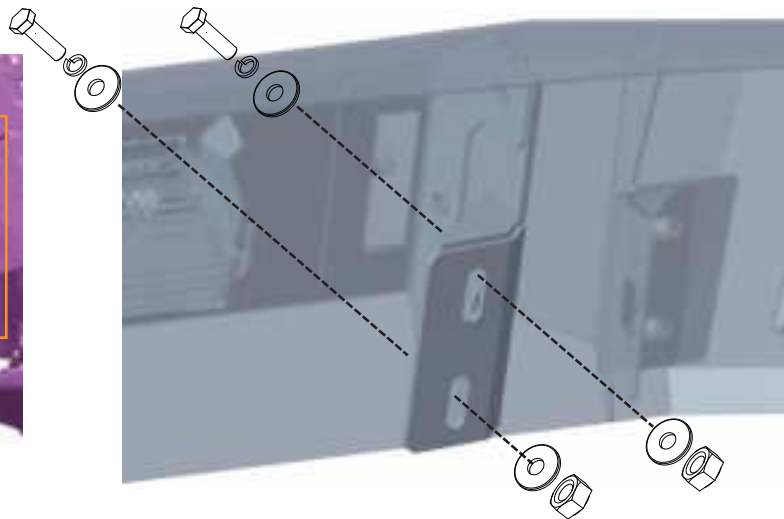

Step 7

Install the hex bolt plate to the bumper using the (1) M12*30*1.5 flat washers, (1) M12 hex nuts. Repeat this step for the opposite of the vehicle. Adjust the bumper to the desired location. **At last, tighten up all bolts and nuts.**

2

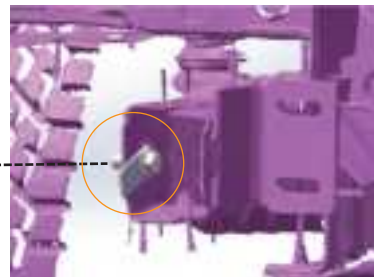
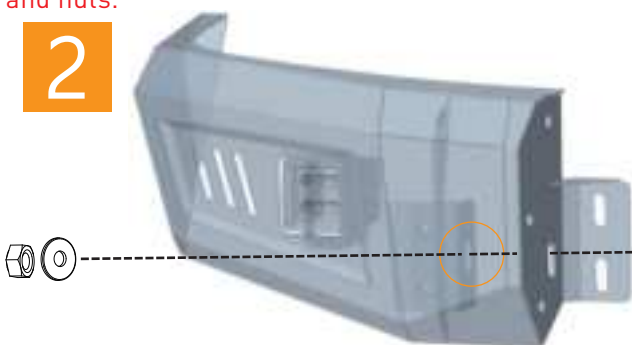

F-250 INSTALLATION INSTRUCTION

Step 8

Place the vehicle in park, remove the factory bumper from the frame.

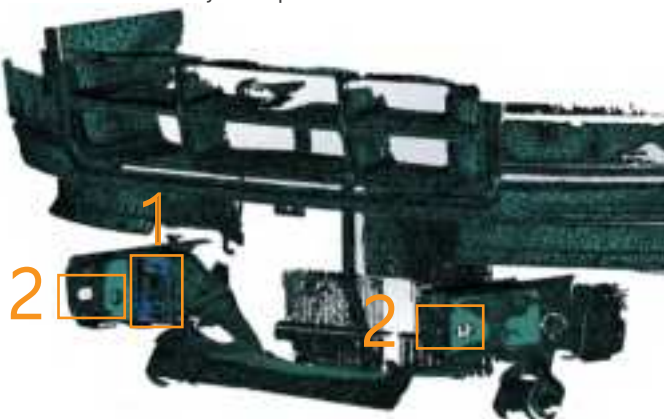

Step 9

Install the bumper to the vehicle using the (1) M12x110mm hex bolts, (2) M12x35mm hex bolts, (3) D12 lock washers, (6) M12*30*1.5 flat washers, (3) M12 hex nuts. Repeat this step for the opposite of the vehicle. **Do not fully hardware to allow adjustability.**

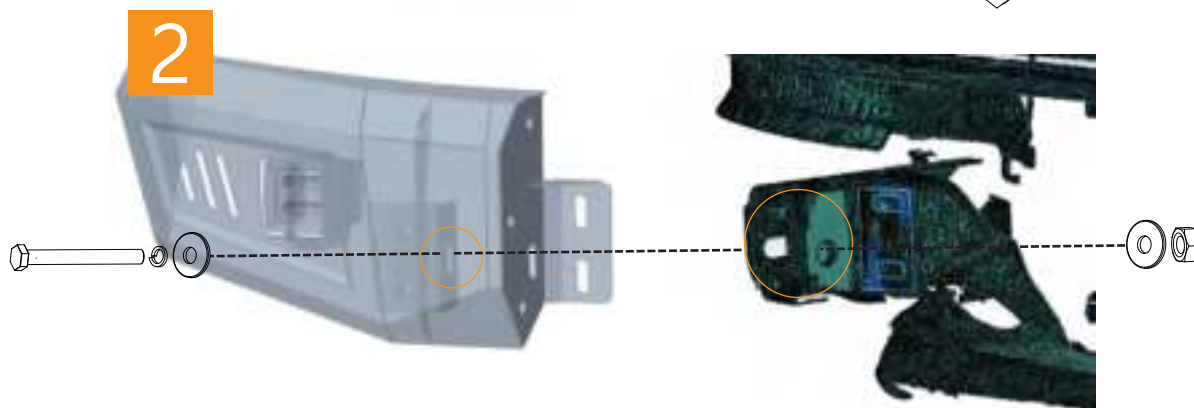
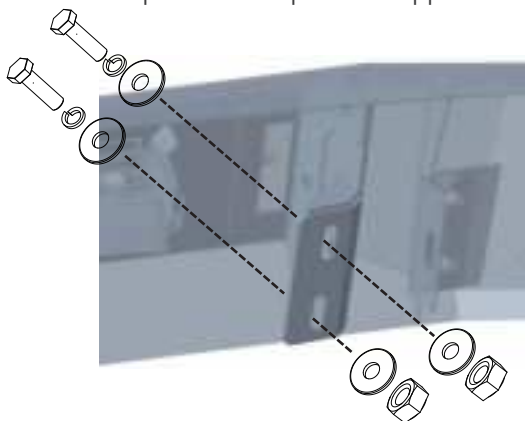

Step 10

The installation is complete. We hope you enjoy a wonderful off-road life with this quality Hooke Road product!

