Exlene Gamecube Controller Switch User Manual

Upgraded Version V1.0 (2021-11-18)



1. Bluetooth Pairing Mode:

Short press the HOME button connect. In shutdown status, long press the HOME button for 3 seconds to enter the Bluetooth pairing mode, the light flashes; If pairing unsuccessful, it go to sleep mode in 2 minutes.

Automatic identification of Switch host, the light is always on after successful connection (with 4 channel lights)

Bluetooth mode can be connected to Switch or PC, the operation is same. Stream is available to use, body feeling is available to use.

Android mode: “A”button + Home button, enter Bluetooth pairing mode, 2 lights flashing, after successful connection, the light is always on;

IOS mode: “Y” buton + Home buton, enter Bluetooth pairing mode, 3 lights flashing, after successful connection, the light is always on; (Note need to use XOBX protocol)

Note: After all Bluetooth modes are successfully connected (including back-to-connect), the controller has a short vibrate, indicating successful connection

2. Receiver Mode

Press and hold the HOME button for 3 seconds to enter the receiver pairing (light blinking). Automatically recognizes Android, Switch Pro, and PC when connected, the 1 light will be on and the controller has a short vibrate at the same time;

The receiver LED flashes when connected and is always on when the controller is connected.

Enter the receiver Xinput mode, the light flashes, after successful connection, 4 lights are always on, and the controller has a short vibrate at the same time;

You can simultaneously long press the '+' key '-' key for 3 seconds to switch between X-INPUT and D-INPUT mode, (X/Dinput conversion when the 4 lights flash 2 lights), switch successfully after the controller has a short vibration;

3. Back-connect Mode

If the SWITCH host is in sleep (not in flight mode), a short press on the HOME button will wake up the host, and automatically connect to its paired host (slow flashing LED), after 1 minute of unsuccessful reconnection, it will automatically sleep. (Other keys do not wake up the controller.)

4. Automatic hibernation

When Switch host screen off, the controller will automatically hibernate.

If no button is pressed within 5 minutes, it will automatically sleep (including the sensor does not move). (Time can be adjusted according to demand)

Long press the HOME button for 5 seconds to shut down, disconnect from the host, the controller will hibernate. (Time can be adjusted according to demand)

5. Charging indication

Controller is off: the corresponding power light flashes when charging, the

indicator light is off when fully charged;

Controller is on: the current channel indicator flashes when charging, the current indicator is always on when fully charged.

Battery low voltage alarm: current channel flashing fast.

6. Low voltage alarm

If the lithium battery voltage is lower than $3.55V \pm 0.1V$, the red light flashes fast to indicate low voltage; (voltage can be adjusted according to demand)

If the lithium battery voltage is lower than $3.45V \pm 0.1V$, it will automatically sleep; (voltage can be adjusted according to demand)

7. USB Wired Mode

Automatic recognition of Switch, PC, Android platform.

PC platform automatically identified as X-INPUT mode by default, you can simultaneously long press the '+' key '-' key for 3 seconds to switch between X-INPUT and D-INPUT mode, connected to the handle vibration;

Automatic recognition of Switch and Android platforms, the controller has a short vibration.

8. Controller hardware reset

Hardware reset button is at the back of the controller.

9. Turbo and AUTO TURBO

Any mode:

Press (for the first time) A/B/X/Y/L1/L2/L3/R1/R2/R3 (any button of those) + Turbo button to set the Turbo function, the controller has a short vibration;

Again (for the second time) press the A/B/X/Y/L1/L2/L3/R1/R2/R3 (Any button of those) + TURBO button to achieve AUTO TURBO function, the controller has a short vibration; (For example, A button has been choosed to set AUTO TURBO function, you need to press the A button again to open AUTO TURBO, and then press the A key to close AUTO TURBO);

Press (for the third time) the A/B/X/Y/L1/L2/L3/R1/R2/R3 (Any button of those) + the Turbo button to clear the Turbo function of the single button you choosed.

Turbo speed is 12 times/sec;

Press and hold the Turbo button for more than 3S and then press the minus key to clear the Turbo function for all buttons, and the LED will resume the current mode indicator;

Adjustment: (Press and hold turbo, use the right stick (up and down) to control adjustment, three gears are 20 times / second, 12 times / second, 5 times / second;

Default speed is 12 times / second. It records user's last adjustment.

10. Vibration Adjustment

Combination operation: firstly press and hold the TURBO key, then press the plus key (+) for increase, minus key (-)for decrease (20% 40% 70% 100% 0%)

Default value is 70%. It records user's last adjustment.

Corresponding intensity will vibrate differently when adjust the vibration.

Basic Setting:

1, How to connect with Switch/Switch Lite console?



Just simply go into the “Controller” menu on your Nintendo Switch/Switch Lite.



Go to the "Change Grip/Order" sub-menu.



Hold down the Home button on the controller till the below blue light flash.



Press L + R button



Press A button when you are ready.



Connected!

2, How to wake up the switch?





hold down the Home button to
wake the Nintendo Switch from sleep mode,
the controller immediately registers as controller number one.

3, How to set Turbo and Auto Turbo function?



Hold "Turbo" down and press any button(A/B/X/Y/L/R/ZL/ZR) to make that button
become a "Turbo" version of the button in question that repeatedly presses over and
over again when you hold it down.



Enter Turbo function.



Do it again to make the button an “always on” Turbo button



Enter Auto Turbo.



Do it a third time to return the button's function to normal.

4, How to adjust vibration?



Press "Turbo" and "-" to decrease;

Press T and + button to increase



Press "Turbo" and "+" to increase.

5, How to pair it with your mobile device?

Turn on your phone's bluetooth



Turn on your mobile's Bluetooth.



you must either hold A (for Android) or Y (for iOS) while you briefly hold down the Home button while your mobile device is in pairing mode.



Choose "Xbox wireless controller" to connect.



successfully connected.

6, How to swap the A/B/X/Y buttons?

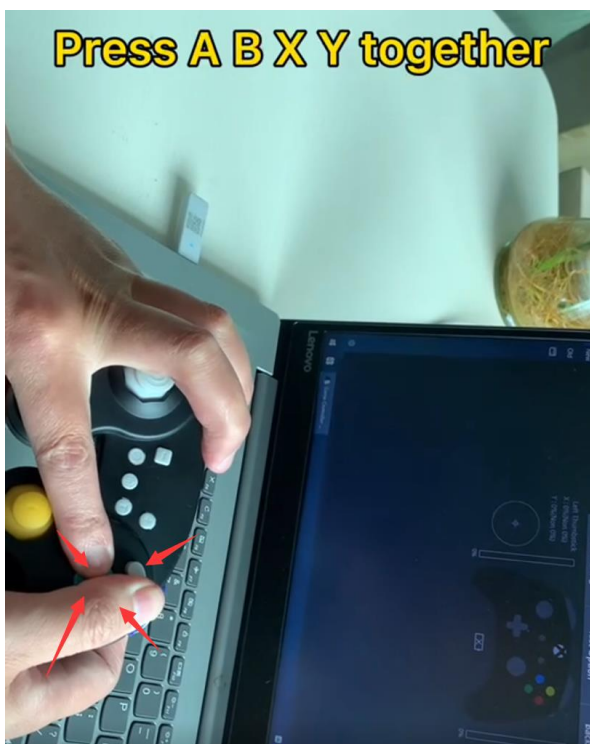

Please hold down A, X, B, Y together to swap the buttons' bindings with the placement typical of Xbox controllers.

7, (optional) How to pair it with your Windows 7, 8, 9, 10, or Windows XP PC? (if you want to use Bluetooth adapter, you can buy it in our website)

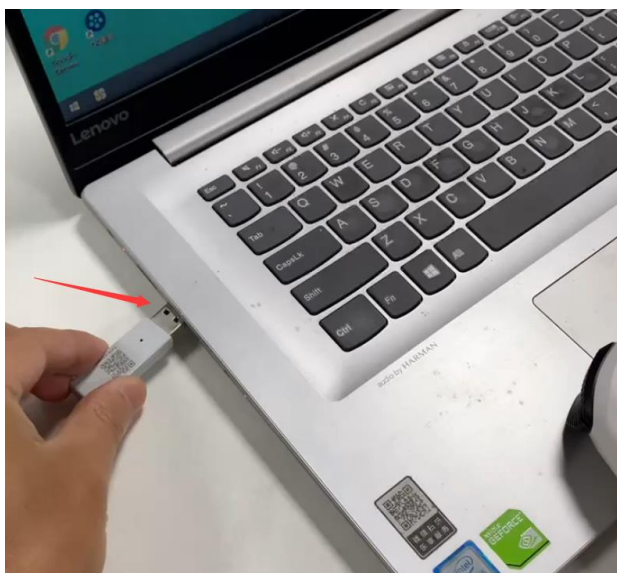

the bluetooth dongle is plugged into the PC.

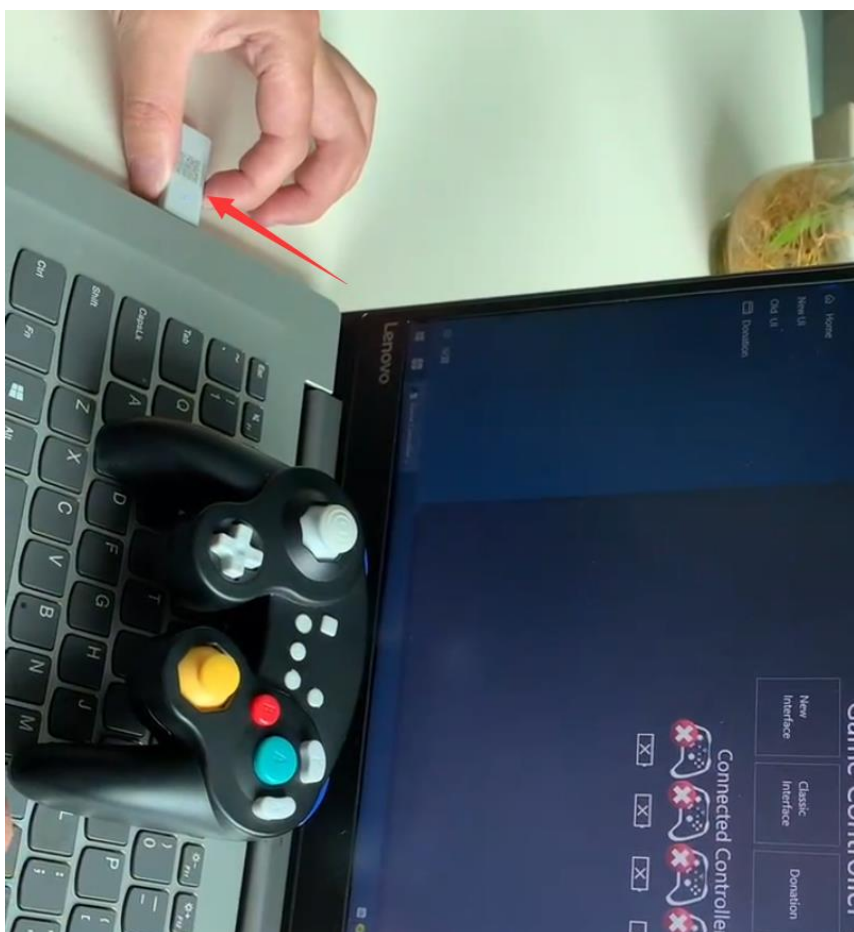

Press the pairing button on the dongle before holding down the Home button on your controller



The pairing button on the dongle is on (blue) , the indicator on the controller is on (blue), successfully connected with PC.

For videos watching, please check with our youtube channel “Wilson Wang”, or go to Exlene official website:

<https://exlene.com/blogs/news/exlene-wireless-gamecube-controller-for-switch-pc-official-gbatemp-review>

Contact email: service@exlene.com; support@exlene.com

FCC Caution.

(1) § 15.19 Labelling requirements.

This device complies with part 15 of the FCC Rules. Operation is subject to the following two conditions:

(1) This device may not cause harmful interference, and (2) this device must accept any interference received, including interference that may cause undesired operation.

§ 15.21 Changes or modification warning

Any Changes or modifications not expressly approved by the party responsible for compliance could void the user's authority to operate the equipment.

§ 15.105 Information to the user.

Note: This equipment has been tested and found to comply with the limits for a Class B digital device, pursuant to part 15 of the FCC Rules. These limits are designed to provide reasonable protection against harmful interference in a residential installation. This equipment generates uses and can radiate radio frequency energy and, if not installed and used in accordance with the instructions, may cause harmful interference to radio communications. However, there is no guarantee that interference will not occur in a particular installation. If this equipment does cause harmful interference to radio or television reception, which can be determined by turning the equipment off and on, the user is encouraged to try to correct the interference by one or more of the following measures:

- Reorient or relocate the receiving antenna.
- Increase the separation between the equipment and receiver.
- Connect the equipment into an outlet on a circuit different from that to which the receiver is connected.
- Consult the dealer or an experienced radio/TV technician for help.

RF warning for Portable device:

The device has been evaluated to meet general RF exposure requirement. The device can be used in portable exposure condition without restriction.

According to § 15.247(e)(i) and § 1.1307(b)(1), systems operating under the provisions of this section shall be operated in a manner that ensures that the public is not exposed to radio frequency energy level in excess of the Commission's guidelines.

According to KDB 447498 (2)(a)(i)