

Item #: 178UBB48GHCS Project: _____

Qty: _____ Date: _____ Approval: _____

Avantco UBB-48G-HC-S 48" Stainless Steel Counter Height Narrow Glass Door Back Bar Refrigerator with LED Lighting

Item #178UBB48GHCS



Technical Data

| | |
|--------------------------|----------------|
| Width | 48 3/4 Inches |
| Depth | 24 7/16 Inches |
| Height | 36 1/4 Inches |
| Power Cord Length | 106 Inches |
| Interior Width | 36 1/4 Inches |
| Left Door Opening Width | 16 7/16 Inches |
| Packaging Width | 51 1/4 Inches |
| Right Door Opening Width | 16 7/16 Inches |
| Shelf Width | 17 5/8 Inches |
| Interior Depth | 18 1/2 Inches |

Features

- 1 1/2" thick stainless steel countertop with stainless steel interior and exterior
- LED interior lighting
- Four adjustable epoxy-coated steel shelves can be removed to fit two 1/2 kegs
- Preprogrammed digital temperature controls featuring auto-defrost function for easy setup and mainte
- 115V; 3/7 hp; R290 refrigerant

Certifications



ETL, US



5-15P



ETL Sanitation

Technical Data

| | |
|-----------------------------|---|
| Nominal Depth | Narrow |
| Packaging Depth | 27 1/2 Inches |
| Shelf Depth | 18 1/8 Inches |
| Interior Height | 30 1/2 Inches |
| Packaging Height | 41 3/4 Inches |
| Amps | 3.5 Amps |
| Hertz | 60 Hz |
| Phase | 1 Phase |
| Voltage | 115 Volts |
| Wattage | 325 Watts |
| Access Type | Doors |
| BTU (LBP) | 974 BTU |
| Capacity | (2) 1/2 Kegs 13 cu. ft. |
| Capacity (per Shelf) | 88 lb. |
| Casters | Without Casters |
| Compressor Location | Side Mounted |
| Countertop Type | Stainless Steel |
| Door Style | Swing |
| Door Type | Glass |
| Exterior Finish | Stainless Steel |
| Features | Automatic Electric Defrost Digital Temperature Controller Food Rated LED Lighting Removable Magnetic Door Gaskets |
| Horsepower | 3/7 hp |
| Insulation Material | Polyurethane Foam |
| Material | Stainless Steel |
| Maximum Ambient Temperature | 90 Degrees F |
| Net Weight | 231 lb. |
| Number of 12 oz. Bottles | 196 Bottles |
| Number of 12 oz. Cans | 144 Cans |
| Number of Doors | 2 Doors |
| Number of Kegs | 2 Kegs |
| Number of Shelves | 4 Shelves |
| Plug Type | NEMA 5-15P |
| Refrigerant Capacity | 2.5 oz. |
| Refrigerant Type | R-290 |
| Shelf Material | Epoxy-Coated Steel |
| Starting Amps | 10.5 Amps |
| Starting Wattage | 975 Watts |
| Temperature Range | 33 - 40 Degrees F |
| Top Capacity | 353 lb. |
| Top Type | Counter Height |

Plan View

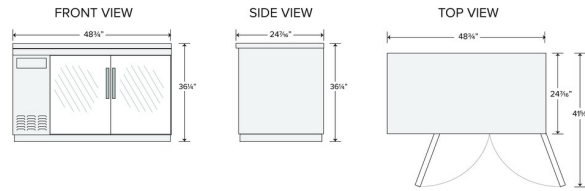

Notes & Details

Optimize the space behind your bar by adding refrigerated storage with this Avantco UBB-48-GT-S 48" back bar refrigerator! Providing 13 cu. ft. of interior storage space, the unit houses 4 epoxy-coated steel shelves that accommodate up to 88 lb. each. The epoxy-coated steel shelves are perfect for storing and organizing drinks for your bar service, from bottles of ale to bottles of cider.

The interior, made of strong 304 type stainless steel, is accessible through 2 solid doors. For overall durability, the unit's exterior is made with sleek stainless steel. This unit also comes with a 2 year Parts and Labor Warranty, providing lasting quality assurance and peace of mind. This back bar refrigerator ensures optimal performance by operating with a 3/7 hp refrigeration system that circulates R290 hydrocarbon refrigerant to maintain temperatures from 33-40 degrees Fahrenheit. R290 refrigerant has an ozone depletion potential (ODP) of 0 and a global warming potential (GWP) of 3, making it an energy-efficient choice for your business. The foamed-in-place polyurethane insulation provides the refrigerator with additional structural integrity and ensures that all beverages held in the unit remain at cool temperatures and are ready for immediate service to customers! The unit requires a 115V electrical connection for operation and even comes with adjustable feet for simple, convenient leveling.

⚠ WARNING: This product can expose you to chemicals including lead, which are known to the State of California to cause cancer and birth defects or other reproductive harm. For more information, go to www.p65warnings.ca.gov.