

PuRuiKai

PRK-M8

Window Cleaning Robot

User Manual



The product is based on the actual item inside the packaging.

Thank you for purchasing this product, please read the manual carefully before using it.

Content

1. Important safety matters and warnings	02
2. Product Description & Parameters	04
3. The remote control	05
4. Use Step	06
5. Cleaning Function	08
6. Troubleshooting	11

Important safety matters and warnings

1. Attention! Must read before use

1. Do not allow children to operate this product. Users with physical, sensory, or psychological illnesses, as well as those who lack understanding of the product's functions and operations, must use it under the supervision of fully capable users after being familiar with the usage process and safety risks. Children should not use this product as a toy.
2. This product is only used to clean glass with frames. If the silicone rubber edge of the window glass frame is damaged, please pay special attention to prevent the machine from leaking air and falling off during the cleaning process. Users must observe the usage scenario to ensure the safe and reliable use of the product.

2. Safety matters

- Please use the original adapter! (Using a non-original adapter may cause product failure or damage the product.)
- Make sure the adapter has enough space for ventilation and heat dissipation during use. Do not wrap the power adapter with other objects.
- Do not use the adapter in a humid environment. Please do not touch the power adapter with wet hands during use.
- Please charge the window cleaner at the voltage that the power adapter can withstand.
- Do not use a damaged power adapter, charging cable or power plug. Before cleaning and maintaining the machine, the power plug must be unplugged and do not disconnect the power by unscrewing the extension cord to prevent electric shock.
- Do not disassemble the power adapter; if the power adapter is faulty, replace the entire power adapter. For assistance and repair, contact your local customer service or distributor.
- This product battery if not handled properly, there is a risk of combustion or chemical discretion injury to the body. Please do not disassemble the battery, so as not to cause a short circuit. Please do not use in fire and high temperature environment above 60°C.
- Please hand over the used battery to the local professional waste battery product recycling center for recycling, the disposal and recycling of used batteries must comply with national laws and regulations.
- Do not immerse this product in liquids (such as beer, water, drinks, etc.) or leave it in a humid environment for a long time.
- Do not expose this product to sunlight and keep this product away from heat sources (such as radiators, heaters, microwave ovens, gas stoves, etc.).
- Do not place this product in a strong magnetic scene.
- Please store this product out of reach of children.
- Please use this product in 0°C~40°C (32°F~104°F) ambient temperature.
- Do not clean damaged glass and objects with uneven surface, this product will not produce enough vacuum suction adsorption on uneven surface or damaged glass machine.
- The built-in battery of this product can only be replaced by the manufacturer or designated dealer / after sales center to avoid danger.
- Before removing the battery or handling the battery, the power must be disconnected.
- Please operate this product in strict accordance with the instructions, if any property damage and personal injury caused by improper use, the manufacturer is not responsible for any.

Attention

- Before use, please make sure that the safety rope is not broken and one end is firmly connected to the machine. The other end should be securely attached to other objects in the room to prevent the Window Cleaning robot falling.
- If the window glass glue is falling off in the middle section or chipped at the corners due to aging, please be careful to use the machine and make sure it is working during the working period. and make sure that there is a user supervising.

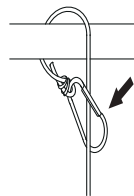

3. Risk of electric shock

- Make sure the power is completely disconnected and the machine is off before cleaning the body or maintaining the body.
- Do not drag the power plug through the extension cord, power off should be properly unplugged.
- Do not continue to use the product if the machine is damaged/the power supply is damaged.
- Machine is damaged, please contact your local after-sales center or dealer for repair.
- Do not use water to clean the machine body and power adapter.
- Do not use this product in dangerous areas such as open fire, bathroom with water flowing from the open nozzle, by the swimming pool, etc.
- Do not damage or twist the power cord. Do not put heavy objects on the power cord or adapter to avoid damage.

4. Warnings

1. Before operation, make sure to attach the safety rope and tie it securely to a stable indoor unit.
2. Before turning on the machine, check the safety rope for damage and secure knotting. Make sure there is no damage and that the knot is secure before using the product.
3. When cleaning the glass of a window or door without a blocking table, please set up a safety warning area downstairs.
4. Fully charge the built-in backup battery before use (green light on).
5. Do not use in rainy or wet weather.
6. Turn on the machine first and then place it on the window glass.
7. Make sure the machine is safely attached to the window surface before releasing your hands.
8. Before turning off the machine, please hold the machine to avoid dropping it.
9. Do not use this product to clean frameless windows or glass.
10. Make sure the cleaning cloth is properly attached to the bottom of the machine to prevent air leakage when the window cleaner is adsorbed.
11. Do not spray the machine or the bottom of the machine. spray water only on the cleaning cloth.
12. Do not allow children to use the machine.
13. Please remove any items on glass surface before use.
14. Please let hair, loose clothes, fingers or other parts of body keep distance with the working parts of machine.
15. Do not use the machine in area of flammable and explosive solids or gases.

2. product details & parameters

- 1. Window Cleaning Robot It has a vacuum motor, which can make the machine adsorb on the glass surface and walk freely on the vertical glass surface. Power failure protection (backup battery) can supply power to the equipment to prevent the equipment from falling due to power failure.
- 2. Window Cleaning Robot has two well-designed cleaning wheels with suction cup, has walking and cleaning functions. The cleaning wheel can absorb and walk on the vertical glass surface. The cleaning cloth on the cleaning wheel can be easily removed and replaced. The cleaning cloth is made of microfiber cloth. the cleaning result is very good.
- 3. The Window Cleaning robot has artificial intelligence, can plan the path, detect the frame, and automatically clean the entire window. Manual remote control mode, you can freely control the robot.
- 4. The Window Cleaning robot is upgraded with more advanced artificial intelligence technology, with a more fashionable appearance and a lighter and thinner body. It has better cleaning performance in more different home environments

1. Product specification

Model	PRK-M8
Input voltage	100-240V / 200-240V AC:50 / 60Hz 1.5A
Rated power	72W / 90W
Battery capacity	650mAh
Suction power	2500-3000Pa
Power failure protection time	10min
Way to control	Remote control
Noise	68dB
Border detection	automatic
Fall arrest control	Power failure protection (backup battery) safety rope
Cleaning mode	Intelligent path planning modes
water tank capacity	60ml
Water spraying method	Manual / Auto
Net weight	1250g
External dimensions	265 x 130 x 79mm

2. Host and accessories

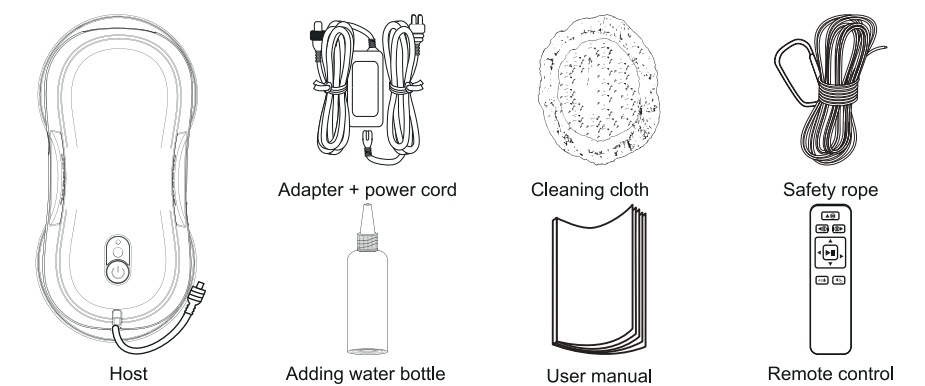

3. Product component name

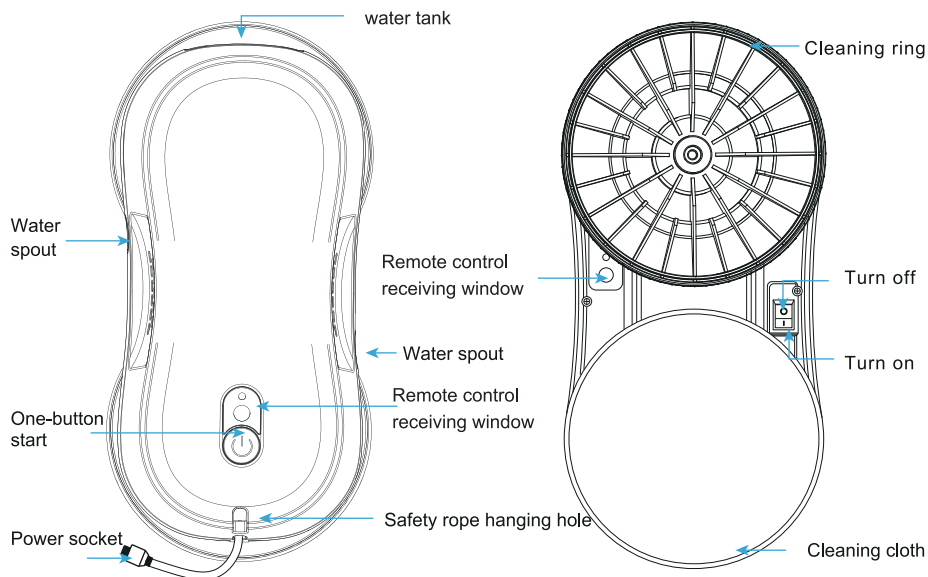

LED light

● Blue light : Robot is normal

● Red light :Robot abnormality

3. The remote control

- Do not charge the remote control battery, do not disassemble the battery, do not put the battery in fire, there is a possibility of detonation.
- Please use No. , AAA/RL batteries of the same specification as required, please do not use different types of batteries, there is a danger of burning the circuit, when the battery is installed and removed, push the remote control cover down, open the battery cover, and install .When using the battery, align the negative pole with one end of the spring first, press it down, the reverse installation of the battery is invalid, and then cover the battery cover.
- New and old batteries or different models, different types of batteries cannot be mixed.

Climb to the top and then automatic clean	Manual upward movement	
Auto clean from right to left	Manual downward movement	
Auto clean from left to right	Manually move to the left	
Automatic water spray	Manually move to the right	
Manual water spray	Pause	

4. Use Steps

1. Install the cleaning cloth

- According to the diagram: Please ensure that the cleaning cloth is correctly placed on the cleaning ring to prevent air leakage. (Figure 1, Figure 2, Figure 3)

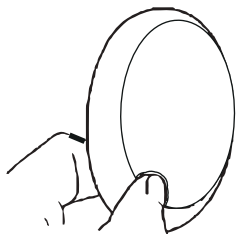

Figure1



Figure2



Figure3

2. Add water

- Please do not add any other cleaning agents to the water tank.
- Turn the machine over, open the silicone cover, and add clean and impurities free water. (Figure1, Figure2, Figure3)
- Do not fill the water tank with water (80% is sufficient) to maintain stable air pressure.

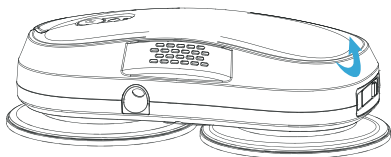

Figure1



Figure2

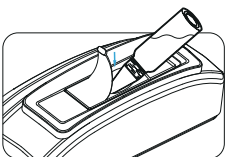
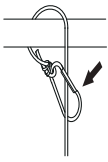
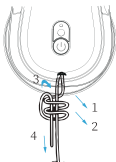
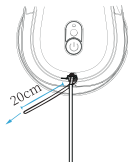

Figure3

3. Attach a safety rope

- Please check whether the safety rope is damaged and whether the knot is loose before using.
- Be sure to fasten the safety rope before using, and tie the safety rope to the fixed objects in the house to avoid danger.



4. Power connect

- Insert the DC connector into the power interface of the machine, and tighten the nut. (Figure1).
- Connect the AC plug to the adapter. (Figure2).
- Connect the power supply. (Figure3)

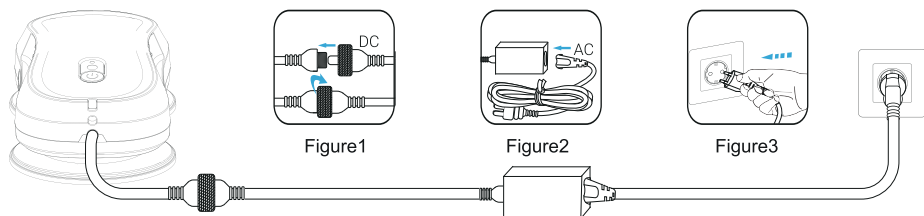

5. Robot charging

Information About Mechanical switch

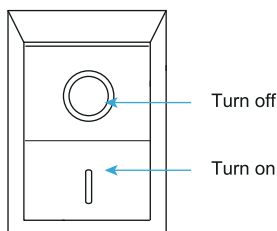

- Mechanical switch is a device that realizes circuit switching through manual operation, and it is the power control switch of our robot.
- Mechanical switches better protect internal battery life. When you turn off the switch, the internal battery doesn't work, and the robot is easier to operate, safer, and lasts longer.

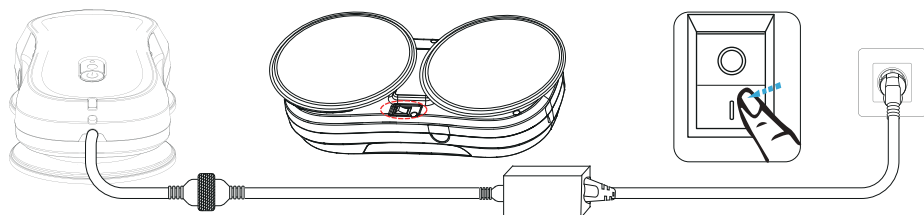

- Built-in battery for standby power supply in case of power failure. Please make sure the battery is fully charged before use
- First turn on the power switch on the robot, connect the powercord, and the red light is on, indicating that it is in the charging state.
- When the red light is off, means the battery is fully charged.



6. Start the robot

- Turn on the power switch.  (Figure1)
- Press and hold the start button for 2 seconds, and confirm that the fan rotates.  (Figure2)
- Put the machine on the glass and keep a certain distance from the window frame. (Figure3)
- Make sure that the robot can be attached to the glass, and then let go. (Figure4)

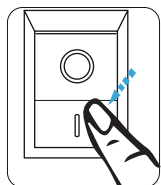

Figure1



Figure2

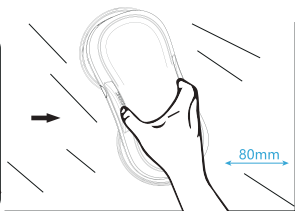

Figure3



Figure4

5. Cleaning function

1. Intelligent path planning modes

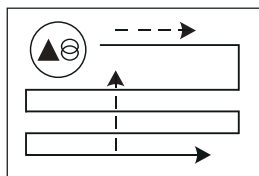

Climb to the top and then automatic clean

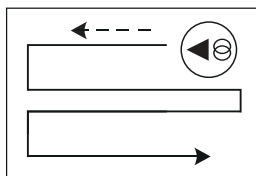

Auto clean from right to left

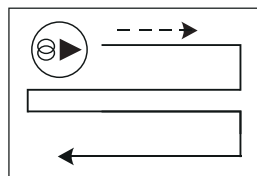

Auto clean from left to right

2. Dry wipe

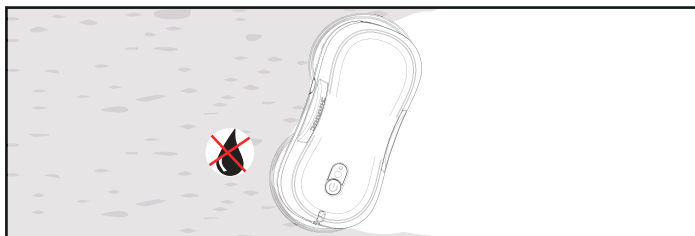

- The first time you wipe, without spraying water(Turn off the water spray function), first remove the sand on the surface of the glass.
- If you spray some water (detergent) on the cleaning cloth or glass first, the water (detergent) will mix with the sand and turn into yellow mud, and the wiping effect will be poor.
- When the machine is used in sunny or low-humidity weather, dry wipe is the best



3. Spray function

Window cleaning robot set two water holes, when the robot to the left cleaning, the left side spray water, when the robot to the right cleaning, the right side spray water.

Automatic water spray

- When the robot starts cleaning, the automatic water spraying mode is turned on by default, with intermittent automatic water spraying.
- Press the  button on the remote control, and the robot will make a beep, indicating that the automatic water spray mode is turned off.
- Press the  button on the remote control, the robot will make two beeps, and the automatic water spray mode has been turned on

Manual water spray

- When the window robot is cleaning, press the  button on the remote control and spray water once.

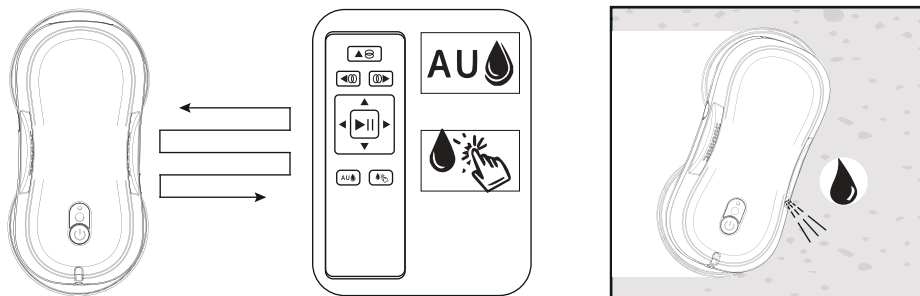

4. Power failure protection (UPS)

- In the event power failure, the robot will start the built-in backup battery power, which can last for 10 minutes (when the battery is fully charged).
- In the event power failure, the machine will stay in place and will not move forward, The blue lights will flash and will emit a warning sound. Take down to the robot as soon as possible to avoid falling from the glass due to the power failure.
- Use the safety rope to gently pull the device back, when pulling the safety rope, keep it as close to the glass as possible to avoid falling.

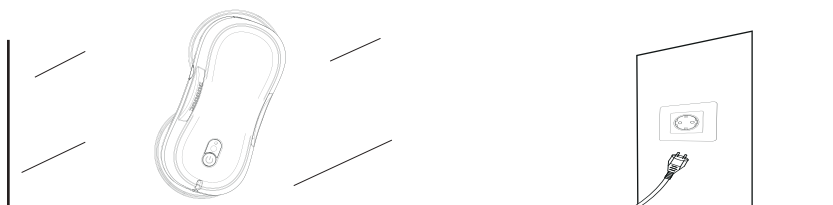

5. Cleaning completed

- When the robot is in pause Hold the window robot with one hand and press the button for 2 seconds with the other hand to the motor stops rotating. (Figure1,Figure2)
- Remove the window cleaning robot.turn off on the power switch (Extend the life of backup battery). Unhook the safety cord and safety clasp and unplug the power supply. (Figure3,Figure4,Figure5)
- Pour out the remaining water and place the machine and its related accessories in a dry and ventilated environment for next use.(Figure6)

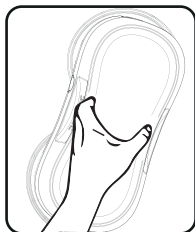

Figure1



Figure2

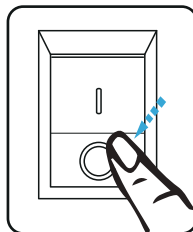

Figure3

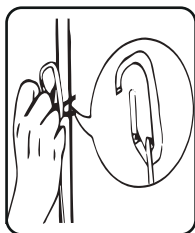

Figure4

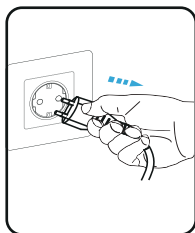

Figure5

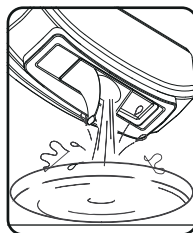

Figure6

6. Troubleshooting

- **When the cleaning cloth is used for the first time (especially in the dirty environment of the outer window glass), the robot may run slowly or even fail:**

- A. When unpacking the robot, clean with a clean cleaning cloth.
- B. Spray a little water or glass water evenly on the cleaning cloth or the surface of the glass to be wiped.
- C. After the cleaning cloth is dampened and wrung out, put it into the cleaning ring of the machine for use.

- **The robot will test itself at the beginning of operation. If it can not run smoothly and there is a warning sound, it means that the friction is too large or too small:**

- A. Whether the cleaning cloth is too dirty.
- B. The efficient of friction of glass stickers and fog stickers is relatively low, so they are not suitable for use.
- C. When the glass is very clean, it will be too slippery.
- D. When the humidity is too low (air conditioning room), the glass will be too slippery after wiping for many times.



- **When pressing the up automatic cleaning button  , the machine can't detect the upper edge of the window due to the sliding of the upper edge of the window:**

Please press the  button to switch to  or  auto clean mode.



- **The robot cannot wipe the upper left side of the glass:**

You can use the remote control manual window cleaning mode to wipe the part that has not been wiped (sometimes the glass or cleaning cloth is slippery, the width of the wiped glass is larger, and the top line slides a little, resulting in the upper left position can not be wiped).

- **The machine can't clean the windows completely, but finish the cleaning work ahead of time:**

You can press  or  auto window mode to continue the unfinished part.

- **Possible reasons for slipping and not climbing when climbing:**

- A. The friction is too small. The friction coefficient of stickers, thermal insulation stickers or fog stickers is relatively low.
- B. The cleaning cloth is too wet. When the glass is very clean, it will be too slippery.
- C. When the humidity is too low (air conditioning room), the glass will be too slippery after wiping for many times.
- D. When starting the machine (press  or  or ), please place the machine at a distance from the window frame to avoid wrong judgment.

- **After cleaning, round wheel marks remain on the glass surface:**

The cleaning cloth is too dirty. Please replace it with a clean cloth and wipe it again.

- **The robot doesn't run smoothly. Possible reasons:**

- A. The cleaning cloth is too dirty. Please replace it.
- B. There are different areas on the glass surface (glass area, sticker area, thermal insulation sticker area or fog sticker area). Please use it in a single area.
- C. If the screw of the cleaning wheel is loose, please lock it (do not lock it too tightly, otherwise it may affect the glass glue thickness at the bottom of the window frame or the performance of the beveled window frame).

- **How to deal with the warning sound and red light flashing when the robot stops operation due to power failure:**
 - A. Gently pull the safety rope back to the robot; when pulling the safety rope, it should be close to the parallel glass as far as possible to avoid falling.
 - B. Turn off the robot power switch.
 - C. Check the wire for poor contact or broken wire.

- **The robot stops when encountering unknown obstacles, the red light flashes and there is no warning sound. How to deal with it:**
 - A. Let the robot back to safe position via remote control.or gently pull the safety rope back to the robot, when pulling the safety rope, it should be close to the parallel glass as far as possible to avoid falling.
 - B. Remove the obstacles on the window.
 - C. Check if there is the reason caused air leak.

- **There are arc marks on the polished glass when the light is shining at night:**

For the first time, please turn off the water spraying function and use a clean cloth to remove the sand. For the second wipe, clean and replace the clean cloth, turn on the water spraying function, or keep the upper cleaning wheel clean and dry, and spray a little detergent or alcohol on the lower cleaning wheel (1 or 2 spray), which can not be completely wet, and can eliminate the arc trace. All wet cleaning cloth will affect the operation of the.

- **The robot has cleaned all the windows, but it can't stop automatically:**

Please press the  button to stop the operation.

- **The robot will not spray water:**
 - A. Please confirm whether the water spray function switch is on.
 - B. Clean the ultrasonic nozzle with a clean soft cloth.
 - C. Please check the water tank whether there is water and whether the added cleaning solution is clean and pure.