

HOTO Golf Laser Rangefinder

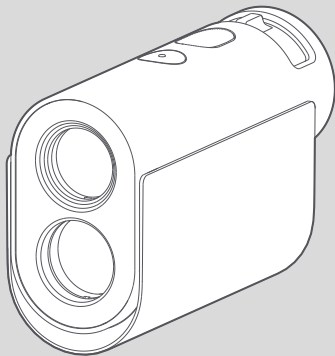

**Make It
Happen**



Visit our website for more Cool Tools
(www.hototools.com)

Thank you for using
HOTO Golf Laser Rangefinder.
Read this manual carefully before use,
and retain it for future reference.

01 Product Introduction

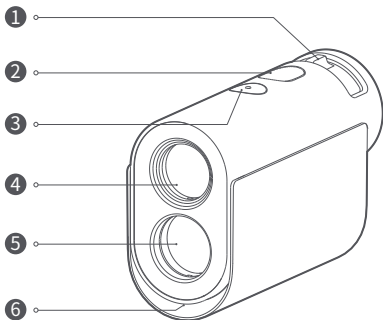

- ① Focusing knob
- ② Power/Measure button
- ③ Mode switch/Set button
- ④ Laser emission object glass
- ⑤ Laser receiving object glass
- ⑥ Golf mode indicator

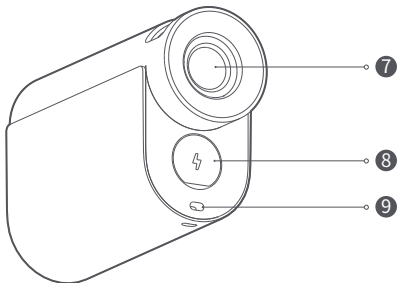

- 7 Observation eyepiece
/Viewfinder
- 8 Charging port
- 9 Lanyard hole

02 Interface Introduction

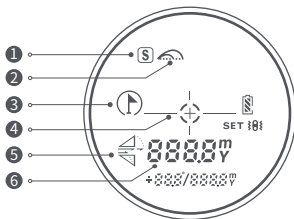

- 1 Straight-line distance mode
- 2 Golf compensation mode
- 3 Flagpole lock-in mode
 - 1) indicates flagpole unlocked
 - 2) indicates flagpole locked
- 4 Cross sight
 - 1) + flashes when the finder is finding and measuring the target
 - 2) + stops flashing when the finder has found and measured the target
- 5 Uphill or downhill in golf compensation mode
 - 1) indicates uphill
 - 2) indicates downhill
- 6 **888.8**
 - 1) Straight-line distance mode: It shows the actual distance
 - 2) Flagpole mode: It shows the flagpole distance
 - 3) Gold compensation flagpole mode: It shows the compensation distance
 - 4) Golf compensation measurement mode: It shows the compensation distance

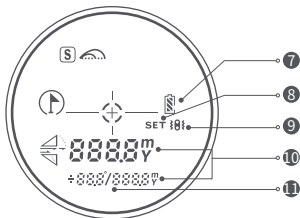

7  Battery level

8 SET Setting mode

9  Vibrate mode

10  Unit of measurement [m: meter/Y: yard]

11  ÷000°/0000m

- 1) Straight-line distance mode: It shows the actual distance
- 2) Flagpole mode: It shows the height and the angle
- 3) Gold compensation flagpole mode: Display height and actual distance
- 4) Golf compensation measurement mode: Display height and actual distance

03 Instructions for Use

Power on/off and measure

- 1 Short press the Power/measure button to power the product on
- 2 The eyepiece will show the entire interface after the product is powered on
- 3 The interface will then automatically change to the "to measure" state

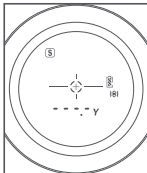
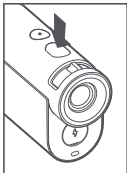

- 4 Press again the Power/measure button to measure
- 5 The eyepiece interface will show the measurement result. Long press the Measure button to measure the real-time distance
- 6 If the meter is let rest for 10 seconds or longer, it will power off automatically

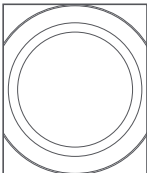
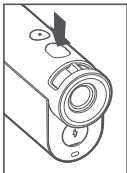

Focus by turning the knob

- 1 Focus by turning the knob
- 2 Turn the knob according to what is shown in the viewfinder to find the appropriate definition

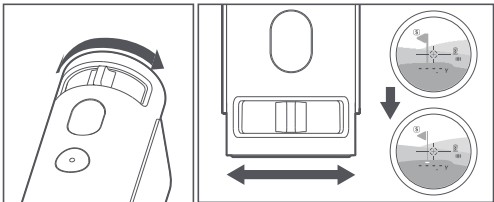

Select the mode

Short press the Mode switch/set button to switch between four modes

- 1 Straight-line distance mode: Measure the straight-line distance between the user and the target of measurement
- 2 Flagpole mode: Lock and measure the distance to the nearest target

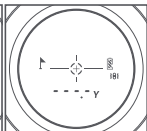
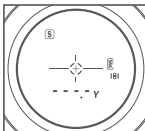
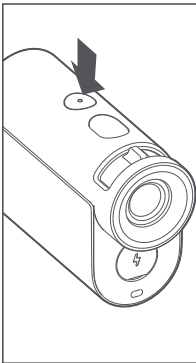

- 3 Gold compensation flagpole mode: Lock and measure the golf trajectory compensation distance

- 4 Gold compensation measurement mode: Measure the golf trajectory compensation distance



Set functions

- 1 Long press the Mode/set button for 2 seconds to enter the setting mode
Short press the Mode/set button to switch between the two settings
- 2 Short press the Power/measure button in the setting mode to change the unit or turn on/off the vibrate mode

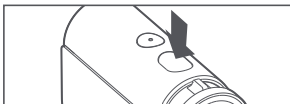
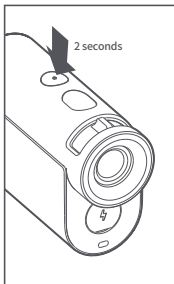

- 3 Set the unit: Switch between m and Y

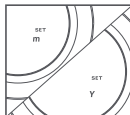

- 3 Set the vibrate mode: Turn on or off the vibrate mode



Note:

1. When the vibrate mode is turned on, the meter vibrates once when measuring the distance, and vibrates twice when locking the flagpole.
2. When the vibrate mode is turned off, the meter will not vibrate when measuring the distance, and will still vibrate twice when locking the flagpole.

Measure the straight-line distance

Measure the distance, height and angle of the target

1. Single measurement: Short press the Power/measure button to measure once the distance
2. Continuous measurement: Long press the Power/measure button to scan the distance and show instantly the distance of the scanned target

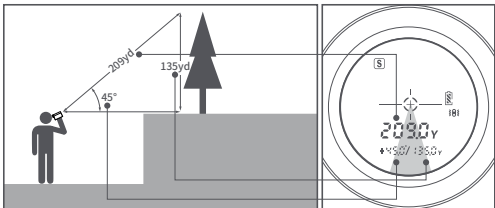

Flagpole lock-in mode

When measuring overlapped targets, long press the Measure button to show the distance to the nearest target

E.g., if you cannot tell for sure if the flag or the trees behind it is the target of distance measurement, the lock function can lock the nearest target, i.e., the flag, for distance measurement

- 1 Long press the Power/measure button to power the product on and measure
- 2 Aim at the flagpole
- 3 The product will vibrate twice after completing the measurement

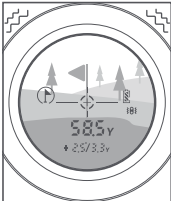
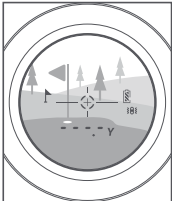
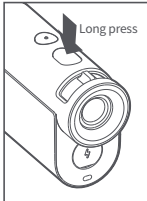

Golf compensation flagpole mode

Long press the Power/measure button to show the golf flagpole compensation distance and the actual distance and height.

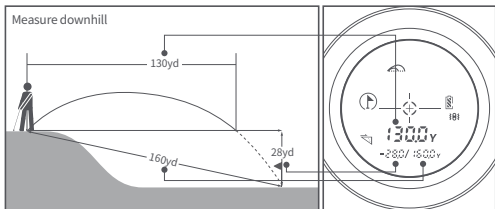
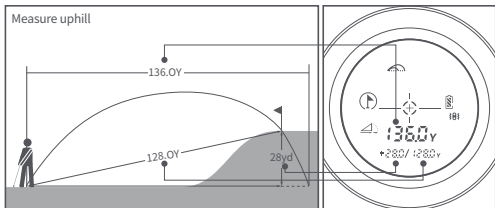

Golf compensation measurement mode

Long press the Power/measure button to show the golf measurement compensation distance and the actual distance and height

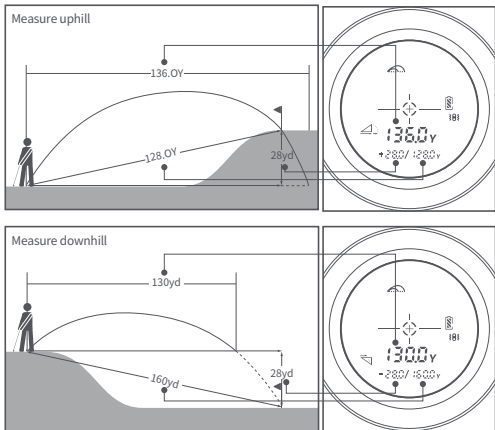

Note: When the product is in golf flagpole/measurement mode, the lamp under the laser receiving object glass will be on

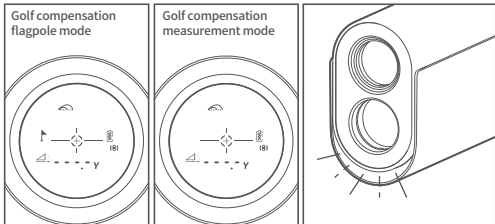

Safety warning

The golf distance meter emits an invisible infrared pulse laser that does no harm to eyes, which is then reflected back from the selected target into the optical receiver. By measuring the time it takes each pulse laser to travel between the distance meter to the target, the system uses an advanced precision charging circuit to calculate the distance being measured in real time. The product's maximum range of measurement depends on the target's reflectivity, color, surface finish, size and actual shape.

The following factors ensure the optimal range and precision of measurement:

- Clear weather
- Targets with shiny appearance
- Zero impurities in the air
- Targets with highly reflective surfaces

The following factors ensure the optimal range and precision of measurement:

- Black targets
- Snowy, rainy or foggy weather
- Targets with obviously diffuse surfaces
- Small or micro targets
- Targets to be measured through glass
- Moving targets
- Strong light interference/sharp sunlight

04 Safety Regulations

Warning!

Before using the product for the first time, please carefully read the safety regulations and instructions for use.

- Before using the product, please carefully read the safety regulations and instructions for use. Your failure to follow the instructions for use provided in this manual may cause the product to be damaged, the measurement precision to be affected, or personal injury to the user or others.
- Do not disassemble or repair the product by yourself in any way. Illegal modification or change of the performance of the laser emitter of the product is strictly prohibited. Please properly keep the product. Keep the product out of the reach of children, and also prevent it from being used by relevant persons.
- Do not expose your own or other people's eyes or other body parts to the laser emitter of the product. Do not expose the highly reflective surface of any object to the laser emitter.
- The electromagnetic radiation of the product may interfere with other equipment or devices. Do not use the product near aircraft or medical equipment. Do not use the product in inflammable or explosive environments.
- Used batteries removed from the product cannot be discarded together with household garbage. So as the product if it is obsolete. Please discard used batteries and the obsolete product according to relevant national or local laws and regulations.

In case of product quality problems or any questions about the use of the product, please contact local distributors or Shanghai Qiwai Culture Technology Co., Ltd. in time. We will respond immediately.

Thank you for buying HOTO Golf Laser Rangefinder!



Li-ion



Laser radiation
Do not look straight at the light beams

Class 1 laser product
Maximum laser radiation output
<1 mW

Wave length: 905 nm
IEC 60825-1:2014;EN 60825-1:2014
Invisible laser radiation



All products bearing this symbol are waste electrical and electronic equipment (WEEE as in directive 2012/19/EU) which should not be mixed with unsorted household waste. Instead, you should protect human health and the environment by handing over your waste equipment to a designated collection point for the recycling of waste electrical and electronic equipment, appointed by the government or local authorities. Correct disposal and recycling will help prevent potential negative consequences to the environment and human health. Please contact the installer or local authorities for more information about the location as well as terms and conditions of such collection points.

 We Shanghai HOTO Technology Co., Ltd., hereby, declares that this equipment is in compliance with the applicable Directives and European Norms, and amendments.

Federal Communications Commission Supplier' s Declaration of Conformity

Product: HOTO Golf Laser Rangefinder

Model Number(s): KE1000

Brand/Trade: HOTO

We declare that the above mentioned device has been tested and found in compliance with CFR 47 Part 15 Regulation.

This device complies with part 15 of the FCC Rules. Operation is subject to the following two conditions: (1) This device may not cause harmful interference, and (2) This device must accept any interference received, including interference that may cause undesired operation.

Note: This equipment has been tested and found to comply with the limits for a Class B digital device, pursuant to part 15 of the FCC Rules. These limits are designed to provide reasonable protection against harmful interference in a residential installation. This equipment generates, uses and can radiate radio frequency energy and, if not installed and used in accordance with the instructions, may cause harmful interference to radio communications. However, there is no guarantee that interference will not occur in a particular installation. If this equipment does cause harmful interference to radio or television reception, which can be determined by turning the equipment off and on, the user is encouraged to try to correct the interference by one or more of the following measures:

- Reorient or relocate the receiving antenna.
- Increase the separation between the equipment and receiver.
- Connect the equipment into an outlet on a circuit different from that to which the receiver is connected.
- Consult the dealer or an experienced radio/TV technician for help.

Representative of Responsible Party for SDoC

Company: HOTO (US) TECHNOLOGY CO LTD

Address: 919 North Market Street, Suite 950, Wilmington DE 19801

Country: U.S.A.

Customer Service(US): +1 855-577-2659

Mon-Fri 9:00am-5:00pm(CST)

05 Faults and Troubleshoot

Maintenance

- Do not keep the product in a high-temperature and high-humidity environment for a long time. If you do not use the product for a long time, please keep it in an environment with room temperature and normal humidity, and charge the product once every six months.
- Please keep the product surface clean. Wipe surface dust with a wet and soft cloth. Do not clean the product with corrosive cleaner. Wipe the laser window and the focusing lens in the way you wipe the surfaces of optical devices.

During use, the main display place may pop up the following messages

Message	Cause	Solution
Low battery level 	The battery voltage is low	Charge the product
Measurement failure	<ol style="list-style-type: none">1. The measurement is beyond the specified range2. It's a snowy, rainy or foggy day3. The target has an obviously diffuse surface4. The target is small or micro5. There is strong light interference/sharp sunlight	Use the product following the instructions for use
Blurred lens	There is dirt or stain on the lens	Gently wipe the lens with a lens wiper only

06 Product Parameters

Model: KE1000

Item Dimensions: 100.5×68×40.5 mm

Net Weight: Approx. 190g

Unit: Y (yard), m (meter)

Measuring Range: 5.5 to 1200yd / 5 to 1000m, $\pm(1.0 \text{ m} + D \times 0.3\%)^*$

Response Time of Measurement: $<0.5\text{s}$
($<131\text{yd}/120\text{m}$ 64 ms; $\geq 131\text{yd}/120\text{m}$ 460 ms)

Telescope Magnification: $6 \times \pm 5\%$

Field of View: $7^\circ \pm 5\%$

Objective Aperture: 19 mm

Exit Pupil Aperture: 16 mm

Range of Diopter Regulation:
 ± 6 diopter

Laser Class: Class 1

Laser Wave Length: 905 nm

Operating Temperature: 0°C to 45°C

Height Measurement: Available

Hill Measurement: Available

Charging Parameters: 5V \approx 0.5A
Type-C interface

Battery Type: 3.7 V \approx 730 mAh Li-ion

Working Hours: 5,000 measurements
(fully charged)

*Note:

The maximum range of measurement is based on light-color buildings. The weather and the size, appearance and shape of the target may affect the maximum range of measurement. The weather, the reflection condition of the target and strong light interference may affect the precision. Please refer to the details.

Manufacturer: Shanghai HOTO Technology Co., Ltd.

Address: Building 45, No.50 Moganshan Road, Shanghai, China

DECLARATION OF CONFORMITY



EU Declaration of Conformity We

Shanghai HOTO Technology Co., Ltd.

Declare that the product:
HOTO Golf Laser Rangefinder / KE1000

Complies with the essential health and safety requirements of the following directives:

2014/30/EU Electromagnetic Compatibility directive

References to the following harmonized standard were made:

EN 61010-1:2010+A1:2019

EN 60825-1: 2014 + A11: 2021

EN IEC 61326-1: 2021

EN IEC 61000-3-2: 2019 + A1: 2021

EN 61000-3-3: 2013 + A2: 2021

2011/65/EU+ (EU) 2015/863 Restrictions of the Use of Certain Hazardous
Substances in Electrical and Electronic Equipment

Authorised signatory and technical file holder:

Shanghai HOTO Technology Co., Ltd.

Building 45, No.50 Moganshan Road Shanghai, China.

Designed by **HOTO**