

Indoor Monitor Station User Manual v1.0



AIIS07

Overview

This product is an indoor monitor station. Functions such as calling, intercom, monitoring and unlocking are available, details are as below:

- Supports video intercom, unlocking
- Supports real-time monitoring from outdoor station
- Supports multiple indoor monitors in one house
- Supports intercom in one apartment and intercom between different apartments
- Supports TF card extension, photo capturing and video recording
- Supports secondary doorbell
- Supports KNX home automation extension

Dimensions & Interface

Unit: mm

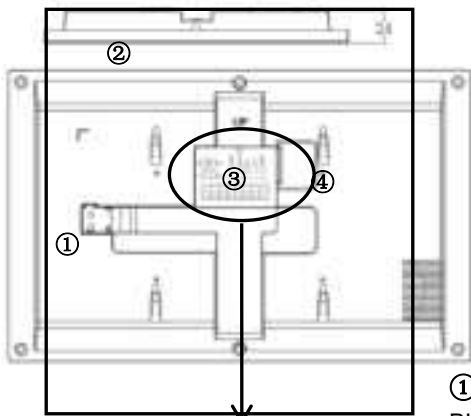
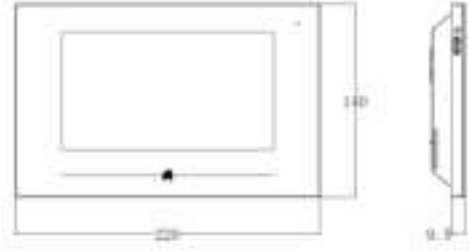

- ① BUS1-A BUS1-B: Bus Interface 1;
BUS2-A BUS2-B: Bus Interface 2;
EXT-DC24V GND: Extended Power Supply 24V.
GND Doorbell: Interface for secondary doorbell button.
- ② 1.Master-slave indoor monitor setting (M stands for Master, S stands for Slave).
2.Video terminal resistance matching.
- ③ Interface for secondary doorbell.
- ④ Interface for 485 extension.

- Note:
- ①Video terminal matching needs to be set on the last indoor monitor by setting the switch No.2 to ON;
 - ②Bus Interface 1 and Bus Interface 2 are for connecting indoor monitors in series.
 - ③Monitor of indoor monitor will turn on and ring, while slave indoor monitor will not turn on but only ring.

Key Button Function

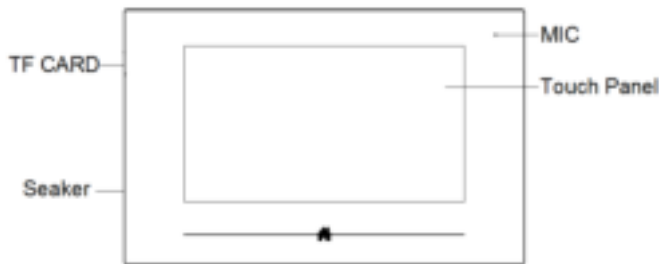

Parameter

Working Voltage: DC 24~30V	Static Current: 30V 15 mA
Working Current: 30V 200 mA	Display: 7inch TFT LCD
Resolution: 800×480	TF card capacity: 2~32G (Class 4 is suggested)
Dimensions (L /W /D) 220×140×24 mm	

Basic Functions and Setting

Menu



1. Video Monitoring

Click to enter monitor interface. Image effect, photo capturing and video recording can be set.

2. Intercom

Click to enter intercom interface. User can call and talk in one apartment or different apartments.

3. Message

Click to enter message interface, user can check captured photos, recorded videos and device information.

4. Setting

Click to enter setting interface, user can configure ringtone/language/ time and operate configuration setting.

Call in



Calling In

Steps: Doorbell rings⇒Talk⇒Unlock the door ⇒End of incoming call:

1. Visitor calls the indoor monitor from outdoor station, the indoor monitor starts ringing;
2. Resident presses button then talk with visitor.
3. During the conversation, resident presses button to unlock the door for visitor.
4. 5 seconds after unlocking the door, the call ends automatically and system returns to standby mode.
5. Resident presses button to end the call.



Setting

Setting:

1. When visitor is calling, click to adjust brightness, color, and contrast manually.

Photo Capture

1. During the call from visitor, click to capture manually.
 2. Captured photos will be saved in message.
- Note: Maximum of 50 images can be stored if there is no external TF card.

Video Recording:

1. During the call from visitor, click to record a video manually (must insert a TF card);
 2. Video will be saved in the message.
- Note: With an extended TF card, up to 40 videos can be stored and up to 1000 images can be stored.

Monitoring



Monitoring

Unlock the door when monitoring

Steps: Choose the device to monitor⇒Monitoring⇒Unlock ⇒End

1. Click the icon in the GUI, choose the device to monitor. The default monitoring device is the outdoor station 1, if the outdoor station 1 does not exist, there will be no monitoring.
2. Resident can choose different outdoor station by and . If the chosen monitor does not exist, it will exit monitoring and return to standby mode.

3. During monitoring, resident can press to unlock for visitor, monitoring will end in 5 seconds after the door is unlocked.
4. Click to end monitoring.

Talk with visitor

Steps: Monitor⇒Talk⇒End

1. During monitoring, resident can press to talk with visitor.

Active Call

Click and enter intercom interface.



Calling Interface

Intercom between different apartments

Steps: Call⇒Ring⇒Talk⇒End

1. Call Input the room number and click **Call** to call;
2. Indoor monitor echoes back.
3. The resident will click **Talk** to answers the call and click **End** to reject the call.
4. Resident can click **End** to end the call after communication.

Intercom in one apartment

Steps: Call⇒Talk⇒End

1. Click **Intercom** to call the indoor monitor in one same apartment.
2. Indoor monitor echoes back.
3. The called indoor monitor in the same apartment echoes back.
4. Resident can press **Talk** to answer the call, click **End** to reject the call, after answering the call, user can click **End** to end the call.

Check Messages



Message Checking

1. Click **Photo** to check messages, captured photos, recorded videos and device information.

Check Photos



Photo Checking

1. Click **Photo** to check photos.
2. While checking photos, click **Next** to choose the next one, click **Previous** to choose the last one, click **Delete** to delete the current one, click **Delete All** to empty the photo record.

Video checking



Video Checking

1. Click **Video** to check recorded videos.
2. While checking videos, click **Next** to choose the next one, click **Previous** to choose the last one, click **Delete** to delete the current one, click **Delete All** to empty the video record.

Device Information



Device Information Checking

1. Click **Version** to check device information including software version and device address.

Unit 3 System Setting

Language Setting



Language Setting Interface

1. Click **English** ⇒ **Chinese**, enter language setting interface.
2. Language must be set in initial start-up.

Configuration Setting



Inputting Password

1. Click **Configuration** ⇒ **Input Password**, input password to enter configuration setting.

Note:
Password is 123456.

ADD Setting



Configuration Setting

1. Click **Address** to enter address setting.



Add Setting

- Note**
1. Add setting from 001 to 200.
 2. If there are multiple indoor monitors in one apartment, the address of all indoor monitors should be the same.

Password Setting



Password Setting

1. Click **Password Setting** to enter password setting.
2. Input new password and input again to confirm.

Factory Reset



Factory Reset

1. Click **Default** to enter factory reset interface.

Unit 4 Installation Height

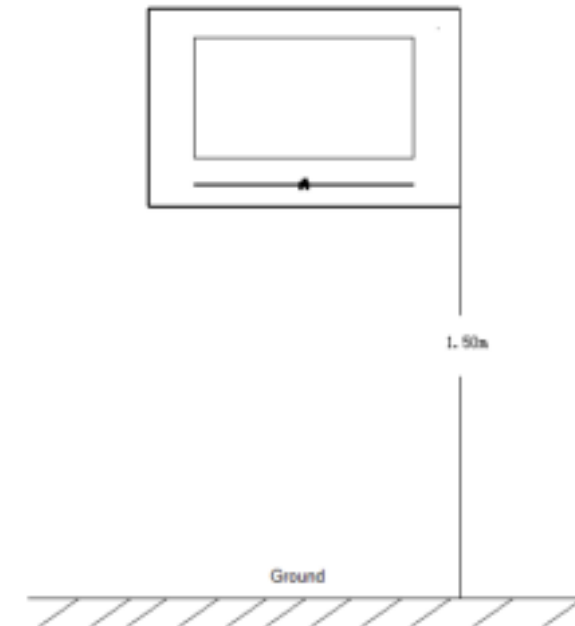

Suggested height for installation: 1.5m

Unit 5 Installation Instruction

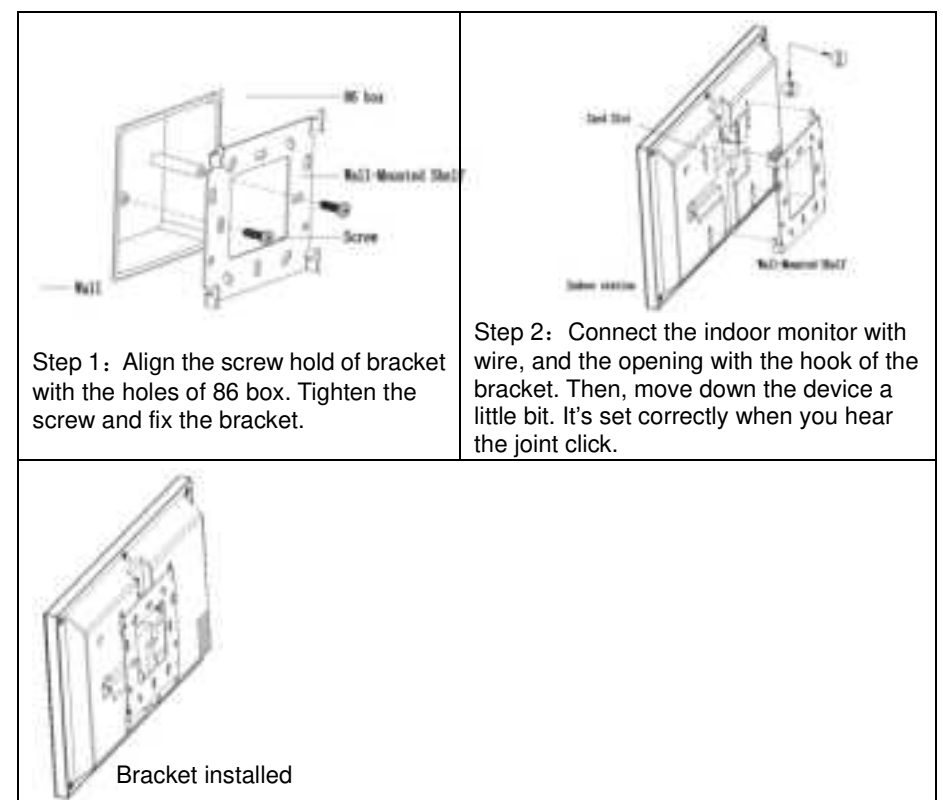

Attention

1. Please keep devices away from strong magnetic fields, high temperature and wet environments.



2. Please handle with care, a drop or any hard impact will damage the device.



3. Please do not use a wet cloth or chemicals to wipes devices.



4. Please do not disassemble the device.