



BG-C9-2

BATTERY GRIP

Designed for the
Canon 5D Mark III, 5DS, and 5DS R
DSLR Cameras



Thank you for choosing Vello

The Vello BG-C9-2 battery grip offers extended shooting time and comfort when shooting in a vertical (portrait) orientation. The grip is compatible with the Canon 5D Mark III, 5DS, and 5DS R DSLR Cameras, and it accepts up to two Canon LP-E6/E6N(H) rechargeable batteries. It offers an alternate shutter release button, main dial, and access to AF-ON, as well as autofocus and autoexposure selection buttons, so you won't have to twist your arm to shoot in portrait mode. The control-lock switch disables all the grip's controls to prevent unwanted triggering.

*Please read through this entire manual
before using the BG-C9-2 battery grip.*



Precautions

- 1.** The BG-C9-2 should be used only with the compatible devices specified in this manual.
- 2.** Use only with the batteries and battery holders recommended in this manual.
- 3.** If you notice smoke, noise, or an unusual smell from the battery pack, discontinue use immediately. Remove the batteries, and take the device to a Vello authorized reseller.
- 4.** The battery level may not display properly if batteries are installed before mounting the grip.
- 5.** Remove the batteries from the grip when not in use.
- 6.** Do not attempt to disassemble.
- 7.** Avoid exposing this product to water or extreme humidity, and keep it in a cool, dry place.
- 8.** Keep out of reach of children.
- 9.** All images are for illustrative purposes only.

Overview

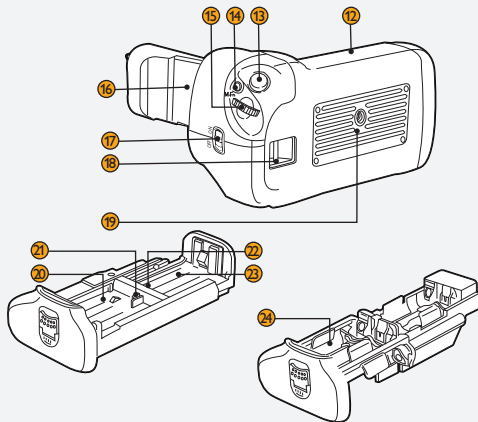
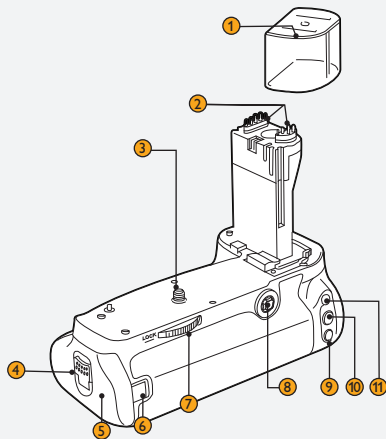

- | | | |
|----------------------------|------------------------------|-------------------------|
| ① Contact cap | ⑨ AF point selection | ⑰ Control lock switch |
| ② Power contacts | ⑩ AE lock button | ⑱ Hand-strap mount |
| ③ Mounting screw | ⑪ AF-ON start button | ⑲ Tripod socket |
| ④ Battery compartment lock | ⑫ Nonslip grip | ⑳ Battery slot 1 |
| ⑤ Battery compartment | ⑬ Shutter release button | ㉑ Slot 1 contacts |
| ⑥ DC coupler cord hole | ⑭ Multi-function button | ㉒ Slot 2 contacts |
| ⑦ Thumbwheel | ⑮ Main dial | ㉓ Battery slot 2 |
| ⑧ Multi-controller | ⑯ Camera battery door holder | ㉔ 6-bay AA battery tray |

Attaching the Grip

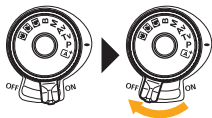

1. Ensure that the camera is turned off.

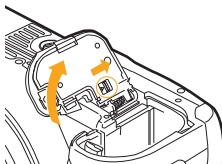

2. Remove the camera's battery chamber door by sliding the latch as shown.

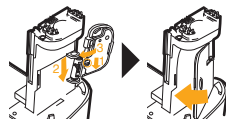

3. Slide the chamber door into the BG-C9-2's camera battery door holder for safekeeping.

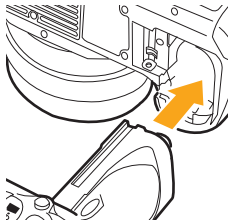

- 4.** Remove the camera's battery, and insert the grip's power contacts into the camera's battery chamber.

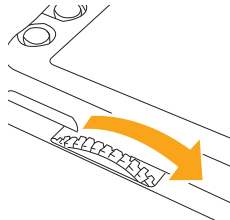

- 5.** Rotate the thumbwheel in the direction of the arrow until the grip is secured to the camera.

Inserting Batteries

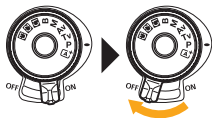

1. Turn off the camera's power, and make sure the grip's control lock switch is in the Off position.

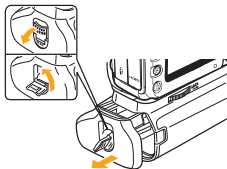

2. Twist the battery tray's lock, and remove the battery tray from the grip.

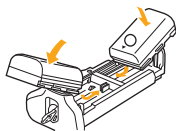

3. **Canon LP-E6/E6N(H) Batteries:** Insert the first battery into slot 1 as shown and push down to lock the battery in place. Repeat for slot 2.

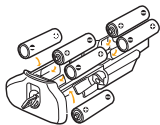

AA Batteries: Place six identical AA batteries into the AA battery tray as indicated.

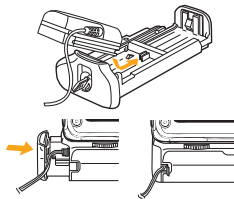

AC Power: The Canon ACK-E6 AC Power Adapter Kit (sold separately) can be connected to supply power from an AC outlet. Push the DC coupler cable into the grip's DC coupler cord hole, ensuring the battery tray isn't pinching the cord.

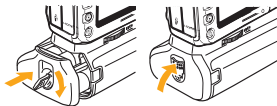

4. Insert and lock the battery tray inside the battery grip.

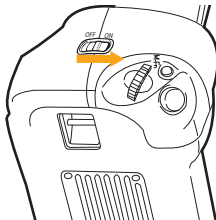

5. Turn on the camera power, and switch the grip's control lock to the On position.

Note: When removing the grip, turn off the camera's power, switch the grip's control lock to Off, and then remove the batteries.

Specifications

Power Source	Up to two Canon LP-E6/E6N(H) type rechargeable Li-ion batteries Six AA/LR6 Alkaline, NiMH, Lithium, or Nickel-Manganese batteries Canon AC Adapter Kit ACK-E6 (sold separately)
Operating Temperature	32°F to 104°F (0°C to 40°C)
Dimensions (H × W × D)	4.5 × 6 × 3.4 in. (11.5 × 15.3 × 8.5 cm)
Weight	10.6 oz. (300.5 g) without batteries

Specifications and design are subject to change without notice.

When the AA battery tray is installed, the battery indicator will work only with NiMH batteries.

Duracell® brand alkaline batteries are not recommended.

ONE-YEAR LIMITED WARRANTY

This VELLO product is warranted to the original purchaser to be free from defects in materials and workmanship under normal consumer use for a period of one (1) year from the original purchase date or thirty (30) days after replacement, whichever occurs later. The warranty provider's responsibility with respect to this limited warranty shall be limited solely to repair or replacement, at the provider's discretion, of any product that fails during normal use of this product in its intended manner and in its intended environment. Inoperability of the product or part(s) shall be determined by the warranty provider. If the product has been discontinued, the warranty provider reserves the right to replace it with a model of equivalent quality and function.

This warranty does not cover damage or defect caused by misuse, neglect, accident, alteration, abuse, improper installation or maintenance. EXCEPT AS PROVIDED HEREIN, THE WARRANTY PROVIDER MAKES NEITHER ANY EXPRESS WARRANTIES NOR ANY IMPLIED WARRANTIES, INCLUDING BUT NOT LIMITED TO ANY IMPLIED WARRANTY OF MERCHANTABILITY OR FITNESS FOR A PARTICULAR PURPOSE. This warranty provides you with specific legal rights, and you may also have additional rights that vary from state to state.

To obtain warranty coverage, contact the Vello Customer Service Department to obtain a return merchandise authorization ("RMA") number, and return the defective product to Vello along with the RMA number and proof of purchase. Shipment of the defective product is at the purchaser's own risk and expense.

For more information or to arrange service, visit www.vellogear.com or call Customer Service at 212-594-2353.

Product warranty provided by the Gradus Group.

www.gradusgroup.com

VELLO is a registered trademark of the Gradus Group. © 2021 Gradus Group LLC. All Rights Reserved.



www.vellogear.com

All other trademarks are the property of their respective owners.

GG1