



CYCLONIC SUCTION



TELESCOPIC TUBE



WASHABLE FILTER



ALL FLOORS



LIGHT WEIGHT



CORDED



CYCLONE LYTE

600W CORDED VACUUM

User Manual



DAEWOO®

**3 YEAR
WARRANTY**

*Terms and conditions apply.

*Please refer to the warranty section for terms of your extended guarantee

IMPORTANT SAFEGUARDS

When using electrical appliances, basic safety precautions should always be followed. These instructions should be saved for future reference:

- Read and familiarise yourself with all operating instructions before using this Vacuum Cleaner.
- Before plugging your unit into the mains, visually check that the unit is intact and has not suffered any transit damage.
- Check that the voltage indicated on the data plate corresponds with that of the local network before connecting the appliance to the mains power supply.
- This appliance can be used by persons with reduced physical, sensory or mental capabilities or lack of experience and knowledge if they have been given supervision or instruction concerning use of the appliance in a safe way and understand the hazards involved.
- Children shall not play with the appliance.
- Keep the appliance and its cord out of reach of children less than 8 years when it is energised or cooling down.
- Do not immerse the appliance or its cord in water or any other liquids.
- Do not leave the appliance unattended during use.
- Do not leave the appliance unattended whilst connected to the mains supply.
- Do not use this appliance outdoors.
- It is imperative to unplug the power cord after the appliance has been used, before it is cleaned and whilst being repaired.
- Repairs to electrical appliances should only be performed by a qualified electrician. Improper repairs may place user at serious risk.
- Do not operate this appliance with a damaged plug or cord, after a malfunction or after being dropped or damaged in any way.
- Regular, periodic checks should be carried out on the mains cable to ensure no damage is evident. Should there be any signs of damage the appliance should not be used.
- If the power cable is damaged, it should only be replaced by the manufacturer or a suitable qualified after-sales-service in order to avoid a hazard
- Do not allow the mains cable to hang over sharp edges or come in contact with hot surfaces.
- Allow the unit to cool before storage.
- Before cleaning, disconnect the appliance from the mains supply and

allow to cool.

- This appliance is intended for household use only and should not be used for industrial purposes.
- Do not use any accessories or attachments with this appliance other than those supplied or recommended by supplier.
- Do not use this appliance for anything other than its intended use.
- Do not push objects into any openings as damage to the appliance and/or electric shock may occur.
- Unplug after each use. Grasp the plug, not the cord.
- Do not pull or carry the Vacuum Cleaner by the electrical cord, use the handle provided.
- Ensure fingers and other objects are never placed in any part of the vacuum cleaner. Clothing or hair may become trapped if the vacuum is used improperly.
- Keep hair, loose clothing, jewellery, fingers and all parts of the body away from openings and moving parts.
- Keep all air vents clear and free of dust, lint, hair and anything else that may reduce airflow.
- Avoid directing the appliance towards naked flames as the air discharged may extinguish gas fires or pilot lights and may disturb ashes in open fires.
- Do not Vacuum water or any other liquids with this vacuum.
- Do not Vacuum hot ashes or lit cigarettes, etc.

Description of Parts



1. Air/Dust Inlet
2. Filters
3. Dust Release Catch
4. Dust Compartment
5. Handle
6. On/Off Trigger Switch
7. Filter Compartment Release Catch
8. Filter Compartment

Description of Parts – Accessories

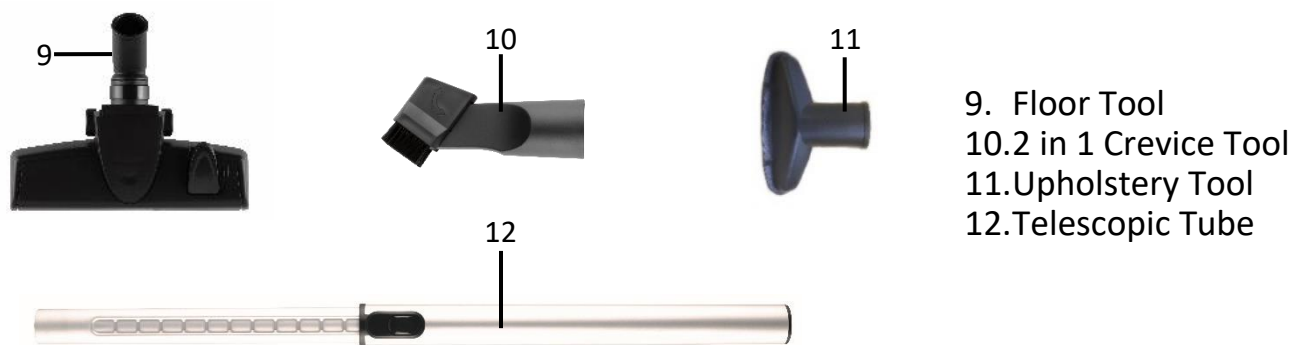

Attaching the Accessories

CAUTION Ensure that the vacuum cleaner is not connected to the mains supply before using the attachments.

The Floor Attachment

1. Push the **Telescopic Tube** (12) onto the **Air/Dust Inlet** (1) as shown below:



2. Push the **Floor Tool** (9) onto the other end of the **Telescopic Tube** (12)



NB Adjust the lever on the **Floor Tool** (9) according to the type of floor being cleaned. Push the lever down for use on hard floors (i.e. non carpeted), pull the lever up for vacuum cleaning carpets:



Left: Adjust the lever on the Floor Tool for carpeted or hard floors:

Up for carpets
Down for hard floors

- Set the required height of the cleaner by pressing the button on the **Telescopic Tube (12)** and adjusting the tube to the required height:

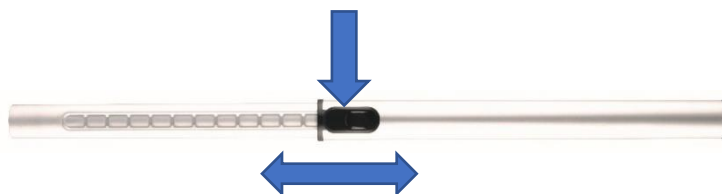

The Crevice Tool

- Attach the **2 in 1 Crevice Tool (10)** onto the **Telescopic Tube (12)** to clean carpet edges and hard to get at areas:



- If the Telescopic Tube (12) is not required, attach the crevice tool directly to the cleaner, this useful whilst cleaning soft furnishings, stairs, etc.:



NB Rotate the brush on the end of the 2 in 1 Crevice tool  to brush dust out of hard to get at areas.

The Upholstery Tool

- Attach the Upholstery Tool (11) to the cleaner to clean soft furnishings such as sofas armchairs etc. Attach the Upholstery Tool (11) to Telescopic Tube (12) to give better reach to clean curtains, etc.:

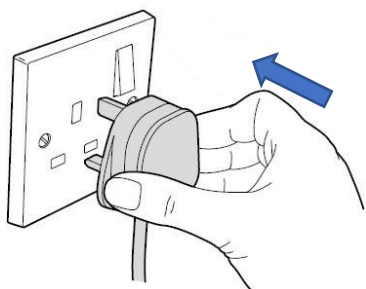

Using Your Corded Stick Vacuum Cleaner

1

1. Once you have assembled your vacuum cleaner as desired above, Insert the mains plug into the nearest socket.

2. To operate the vacuum cleaner, grip the vacuum by the Handle (5) and press the On/Off Trigger Switch (6) at the top of the handle – arrowed right.

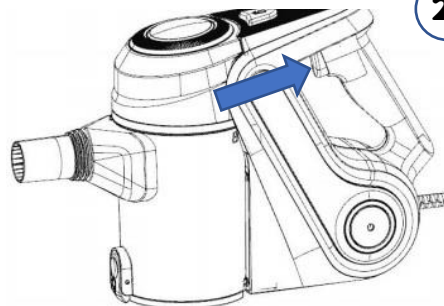
2

Emptying and Cleaning Your Corded Stick Vacuum Cleaner

WARNING Always disconnect the cleaner from the mains power supply before cleaning.

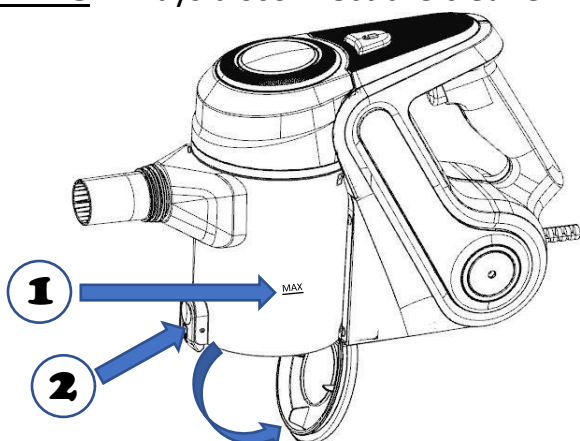

1. Once the dust level reaches the 'MAX' mark on the **Dust compartment** (4) it will need emptying and the filters cleaned.
2. To empty the cleaner, hold the **Dust Compartment** (4) over a dust bin and press the **Dust Release Catch** (3) and the base of the dust compartment will swing open and allow the collected dust to fall out into the dust bin.

WARNING do not continue to use your vacuum cleaner once the 'MAX' mark has been reached as permanent damage may occur to the appliance.

3. Hold the **Filter Compartment** (8) and press the **Filter Compartment Release Catch** (7) and remove the Filter Compartment.
4. Twist the top off the **Filter Compartment** (8) anticlockwise and remove.
5. Pull out the filter assemblies.
6. Wash the Micro, Sponge and cyclonic filters in warm running water until the water runs clear. Allow the filters to dry thoroughly for 24 hours before reuse.

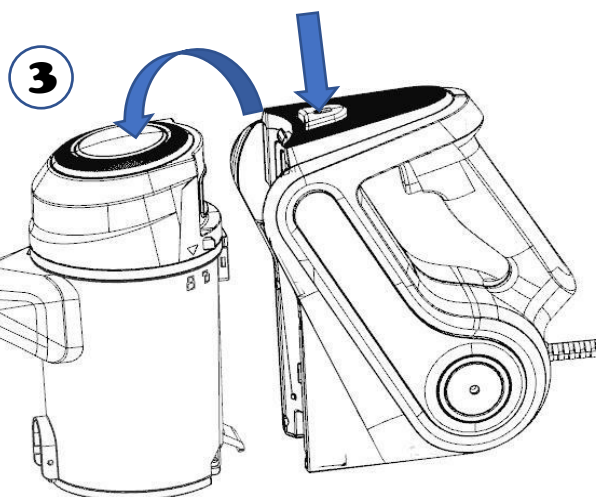

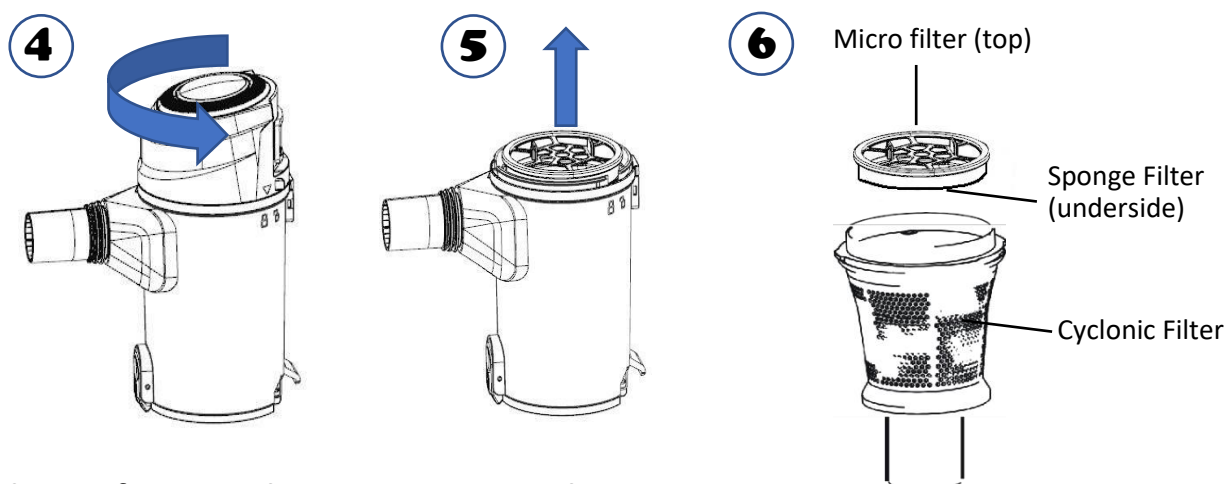



Care and Use of your Cyclone Lyte Vacuum Cleaner

- Always disconnect the cleaner from the mains power supply before cleaning.
- Clean outside of the cleaner with a clean damp cloth. Never clean with harsh or abrasive cleaners.
- Do not submerge the cleaner in water or any other liquids.
- Empty the **Dust Compartment** (4) as soon as the 'MAX' mark has been reached.*
- Wash the Micro, Sponge and Cyclonic Filters (6) regularly – see table below.
- Allow the filters to thoroughly dry out for 24 hours before reassembly and use.

***WARNING** do not continue to use your vacuum cleaner once the 'MAX' mark has been reached as permanent damage may occur to the appliance.

Recommended filter cleaning intervals

Filter Type	Recommended cleaning period
Round Micro Filter 	<ul style="list-style-type: none"> • Shake out debris when you empty the dust container • Rinse under warm water once a month • Allow to dry thoroughly for 24 hours before reuse.
Round Sponge Filter 	<ul style="list-style-type: none"> • Occasionally remove any dust/debris as necessary. • The filter should also be rinsed under warm water once a month. • Allow to dry thoroughly for 24 hours before reuse.
Cyclonic Filter 	<ul style="list-style-type: none"> • Shake out debris once a month • Rinse under warm water once a month. • Allow to dry thoroughly for 24 hours before reuse.

WARNING Ensure the filters are cleaned periodically according to the table above, failure to clean the filters regularly will severely impair the performance and permanent damage may occur to the appliance and may invalidate your warranty.

Electrical Connections

This appliance is fitted with a fused three-pin plug to BS 1363. If the plug has to be removed, it should be cut off and carefully disposed of immediately. To avoid a possible shock hazard, do not insert the discarded plug into a mains socket.

Fitting a new plug

The mains lead must be connected as shown below. The wires are coloured with the following code - Brown wire = Live (L), Blue wire = Neutral (N).

NB no connection must be made to the Earth (E) terminal.

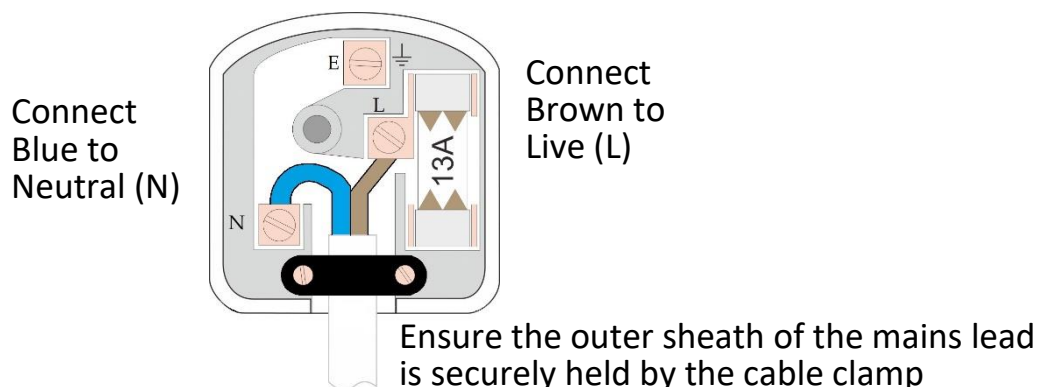

- The Blue wire must be connected to the terminal marked N or coloured Black.
- The Brown wire must be connected to the terminal marked L or coloured Red.
- Check that there are no cut or stray strands of wire inside the plug.
- Use a 13 Amp BS 1362 fuse, only use BSI or ASTA approved fuses.
- If you are in any way unsure which plug or fuse to use, always refer to a qualified electrician.
- After replacing or changing a fuse on a moulded plug, the cover must be refitted to the plug; the appliance must not be used without a fuse cover.

Technical Specification

Model Number	FLR00039
Supply Voltage	AC 220-240V ~ 50/60Hz
Rated Power	600W
Protection Class	II
Unpacked Weight (approx.)	1.8 Kgs
Dimensions (approx.)	315mm (l) x 115mm (w) x 215mm (h)
Vacuum (max)	17kpa
Noise Level (approx.)	75dB
Dust Compartment Capacity	0.6L

Customer Support

Should you require any product information, replacement parts or accessories, please contact our customer care team at help@daewooelectricals.com or call 0161 831 7879.

- *Replacement parts and accessories are guaranteed for 1 year from the date of purchase.*
- *It is important to note that your warranty becomes invalid should non Daewoo parts or accessories be used with this appliance*

Troubleshooting Guide

Problem	Possible Cause	Solution
Unit fails to turn on.	The unit may not be properly plugged in. The fuse may have tripped.	Ensure the plug is fully inserted into the socket and the socket is switched on. Check the fuse on the mains board, if it has tripped, reset it.
Low suction or poor pick-up.	Cylinder is full. Filters are clogged. Blockage in the hose.	Empty the cylinder. Check and clean the filters. Check the Telescopic Tube and clear if necessary.
The vacuum is making a "hissing" sound.	The airflow is restricted	Empty the cylinder. Check and clean the filters. Check the Telescopic Tube and clear any blockages if necessary.

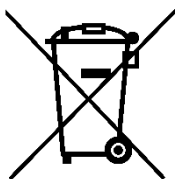

Waste electrical products should not be disposed of with household waste. Please recycle where facilities exist. Check with your Local Authority or retailer for recycling advice.





WARRANTY

Thank you for purchasing your Daewoo Vacuum.

As part of our commitment to quality we are offering you an extra 2 years warranty in addition to your 1 year guarantee.

Your Daewoo vacuum product is guaranteed for 1 year from the date of original purchase, with proof of purchase or receipt. If any defects should arise due to faulty workmanship or material, your faulty vacuum should be returned to the place of purchase, replacement or refund is at the discretion of the retailer.

The guarantee is subject to the following provisions:

- The product must be correctly installed and operated in accordance with the requirements contained in the instruction manual.
- The product must be used solely for domestic purposes.
- It does not cover general wear and tear, damage, misuse or any consumable parts.
- The Guarantee is rendered invalid if the product has been resold or has been damaged through inexpert repair.
- The guarantee is only valid within the UK and Eire.

Your standard 1 year guarantee will only be extended to the maximum available for your individual product upon registration. (Note: products must be registered individually and covers the main body and housing) If you do not register your product within 28 days of the original purchase date, your product will only be guaranteed for 1 year.

To validate your extended 2 year warranty* please register your purchase online within 28 days of the original purchase date by registering at www.daewoowarrantyregistration.com/warranty-registration

**Your extended warranty is only valid with proof of purchase receipt and subject to the conditions outlined above.*

**ESG Ltd
Manchester M3 1JS**

www.esgltd.com

**Daewoo® is a registered trademark.
Produced and imported under licence by ESG Ltd**