

# ATLI T300

## Instruction Manual



This instruction manual covers the camera installation and setup procedures of the ATLI T330.

Please refer to USER INSTRUCTION MANUAL – ATLI CAM APP DASHBOARD CONTROL for more information on how to connect and control the camera.

# Content Index

- Welcoming Notes ..... 3
- Safety Precautions and Warnings ..... 3
  - Installation..... 3
  - Electrical Safety ..... 4
  - Transportation Security ..... 4
  - Repair ..... 4
  - Environment..... 5
  - Operation and Maintenance ..... 5
- Product Introduction ..... 6
  - Overview ..... 6
  - Package Content ..... 6
  - Name of Camera Parts..... 7
- Installation ..... 8
  - Wi-Fi Antenna ..... 8
  - Camera ..... 9
  - Power..... 10
- Quick Setup..... 10
  - Installing ATLI Cam App ..... 10
  - Registering the Camera to the ATLI Cam App ..... 10
- Camera Status ..... 11
- Troubleshooting..... 12
- Hard restart ..... 13
- Reset to factory settings ..... 13
- Specifications ..... 14
- Warranty ..... 16

# Welcoming Notes

---

Thank you for purchasing ATLI T330.

- Please read this manual for proper usage before using the camera.
- Please read and understand the Safety Precautions and Warnings in this manual before using the camera.
- Please keep this manual for future references.

## Safety Precautions and Warnings

---

Please read the following safety precautions and warnings carefully below before using the camera.

They are important to avoid personal injury and damage.

### Installation

- Handle the camera with care and avoid dropping it which could cause internal hardware damage.
- Keep the camera clean, especially the front protective glass.
- Do not connect the camera to a third-party power adaptor.
- Do not place any objects on top of the camera.

## Electrical Safety

- **Battery Usage:** Only use the 18650 li-ion battery for this camera. Do not attempt to use any other type of battery. Always handle the battery with care and avoid exposing it to extreme temperatures or physical damage.
- **Charging:** Use the provided USB cable and connect it to a reliable power source when charging the camera. Ensure that the power source is compatible and meets the required specifications. Avoid overcharging the camera and disconnect it from the power source once it is fully charged.
- **Electrical Hazards:** To prevent electrical hazards, avoid using the camera in wet or damp environments unless it has a suitable IP65 weatherproof rating. Keep the camera away from water sources and do not expose it to rain or excessive moisture.

## Transportation Security

- Avoid heavy stress, violent vibrations, and excess moisture during transportation, storage, and installation of the camera.

## Repair

- Disassemble the camera will automatically void the warranty.
- We are not liable for any problems or damage caused by unauthorized modifications or user-attempted repair.
- Contact us via email [service@atiview.com](mailto:service@atiview.com) for any technical issues.

## Environment

- Do not install the camera in environment with extreme temperatures ( $> 0^{\circ}\text{C}/32^{\circ}\text{F}$  and  $< 50^{\circ}\text{C}/122^{\circ}\text{F}$ ).
- Avoid aiming the camera lens directly to the sun to avoid pictures from overexposure and may possibly damage the camera image sensor in the long run.
- Installing the camera under a roof or shelter could help to improve the camera's life and bring extra benefits to the quality of the recorded video/photo footage.

## Operation and Maintenance

- The camera is designed and manufactured for weatherproof (IP65 standard compliance).
- This product is NOT waterproof and shall not be used under water.
- To avoid scratches on the front protective glass, use only an air blower or a microfiber cloth for cleaning.

# Product Introduction

## Overview

The ATLI T330 is a high-quality timelapse camera designed specifically for outdoor shooting. With its advanced features and durable build, this camera is perfect for capturing stunning timelapse footage in various weather conditions.

- 1080P FullHD Resolution
- IP65 Weatherproof
- Up to 35 Days Battery Life
- Live Preview on App
- Remotely Control the Camera and Download Video

## Package Content

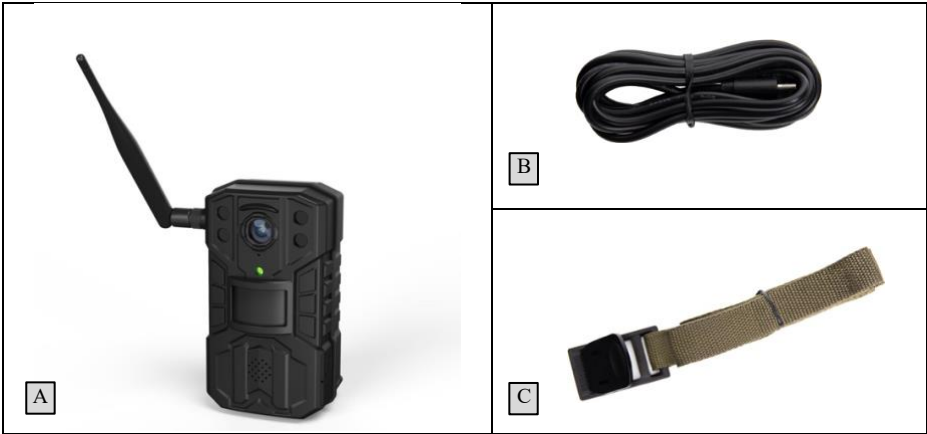

A	ATLI T330 (16GB storage card pre-installed)	B	2-meter USB-C charging cable	C	2-meter Mounting Strap
---	---	---	------------------------------	---	------------------------

# Name of Camera Parts



1	Wi-Fi Antenna	6	Camera QR Code
2	Status LED	7	Strap Retainer
3	Lens	8	Battery Compartment
4	USB-C Charging Point	9	Battery Compartment Lock
5	Power Button	10	Storage Card Slot

# Installation

---

## Wi-Fi Antenna

To ensure maximum wi-fi performance when using the camera, it is recommended to turn keep the wi-fi antenna upright. This positioning allows for optimal antenna reception and signal strength.



Keep the wi-fi antenna upright  
for maximum performance.

## Battery

To ensure the safe and proper functioning of your ATLI T300 Timelapse Camera, it is crucial to follow the correct battery installation process.

- Locate the battery compartment on the camera.
- Open the battery compartment by unlocking the latch.
- Insert the battery (make sure it is fully charged) into the compartment according to the indicated polarity markings (+/-).

Ensure that you align the battery correctly to prevent any short circuits or damage.

- Close the battery compartment securely to ensure proper contact and protection against moisture or dust.
- Double-check that you have inserted the battery correctly before proceeding.
- Turn on your ATLI T300 Timelapse Camera and check if it powers up successfully. If not, please recheck the battery installation.

**Warning: Please ensure correct battery installation to avoid safety issues. Incorrect installation may lead to safety hazards and damage to the camera.**

## Camera

Using the 4-1/2" thread hole at the bottom to set the camera on mount



# Quick Setup

---

## Installing ATLI Cam App

Scan the QR code on the right to install ATLI Cam App.

The ATLI Cam App can also be installed via the Apple App Store or an Android App Store.



## Registering the Camera to the ATLI Cam App

- a. Open ATLI Cam App to display the Discover home screen. Time lapse videos and tutorial videos are available in this page.
- b. Turn the camera upside down to view the camera QR code as shown on the left.
- c. Click on the [Camera] icon at the bottom and then click on [Add Camera] to register your camera.
- d. Scan the QR code to connect.
- e. Switch back to ATLI Cam App to connect the camera to view the camera dashboard.

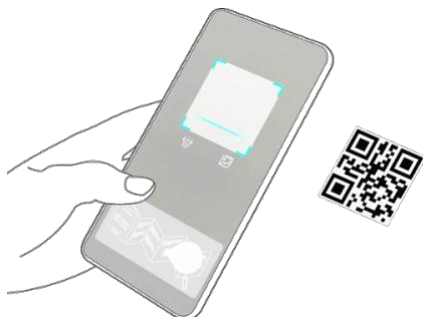

# Camera Status

---

The camera status is displayed by the LED Indicator as shown in the table below.

LED	Light	Description
Status	Steady Green	Powering up
	Fast blinking 3 times consecutively	After the powering sequence is completed (~15 sec), the camera performs this once to indication the camera is ready.
	Blinking every 1 second	Wi-Fi connected (AP or Station mode)
	Blinking every 0.5 second	No Wi-Fi connection
Power Source Indicating LED	Red	External power connected
	Off	No external power connected

# Troubleshooting

---

Symptom	Solution
Camera Offline	<p>Check the camera Status LED.</p> <p>If it is blinking every 1 second, it means that the camera has no Wi-Fi connection. Try to connect to the camera Wi-Fi directly.</p> <p>If it is blinking every 0.5 second, check to see if your phone or other network device is in the same Wi-Fi network.</p> <p>If the LED is off, please check the power connection to make sure that the Power LED is ON.</p> <p>If the camera is in battery operated mode, the battery may be depleted. Please connect power to charge the battery.</p>
Unable to connect Wi-Fi	<p>If the camera is not configured to connect the local Wi-Fi, please first configure your cellphone to connect to the camera Wi-Fi and then try to connect to the camera. Please note that the camera SSID is the camera serial number. If you cannot find the camera SSID, please check if the camera is on and the Status LED is blinking at 0.5 second. If you still cannot connect, please reboot the camera and possibly your cellphone before retrying.</p> <p>If the camera is already configured to join the local Wi-Fi, please check if the Status LED is blinking every second. If it is not, please check your local Wi-Fi to see if it is working properly. If it is, please make sure that your cellphone is connected to the same Wi-Fi network. If you still have trouble connecting the camera, please configure your cellphone to connect the camera Wi-Fi directly and then proceed to connect to the camera. Once connect, you can then debug the problem with the local Wi-Fi connection.</p>

# Hard restart

---

Hard restart the camera if the screen is frozen or cannot be powered on normally.

Long press the power button 4-5 seconds to restart.

# Reset to factory settings

---

To remove all settings from the camera, reset your camera to factory settings.

Open ATLI Cam app, System Settings > Reset to factory defaults.

# Specifications

---

General	
Lens	4 ASPH Lens
Aperture	F2.8
Video Resolution	1080*1920
Photo Resolution	1520*2688
Pixel Size	2μm*2μm
Focus Mode	Fixed
Focal Range	3 meters-Infinity
Field of View	72°
App Control	iOS/Android
Remote Access Control	Windows/MacOS
Connectivity	2.4GHz Wi-Fi 802.11 b/g/n
Video/Photo	
Video Format	MP4
Photo Format	JPEG
Playback Frame Rate	25FPS
Schedule	Daily/Weekly/Custom
Interval	0.5s ± 24hrs
Battery & Charging	
Battery	18650 Li-ion Battery*3
External Power Supply	DC In 5V = 2A (USB-C Connector)
Storage	
Capacity	128GB microSD Card (Max.)
Storage Card Class	Class 10
Design	
Water Resistance	IP65
Operating Temperature	> 0°C/32°F and < 50°C/122°F
Dimensions	
Weight	195g (333g with batteries)



ATLI T330

# Warranty

---

## Terms & Conditions

- a. Under normal operation, the product will receive 1-year limited warranty provided by ATLI World Ltd.
- b. Customers who fail to provide the original purchase invoice or register the product online will be disqualified from this warranty.
- c. ATLI will, at its discretion, repair or replace the product or any defective parts.

This limited warranty does not cover any of the followings:

- a. Defects and damages due to loss, theft, fire, water, or a natural disaster.
- b. Failure of damage caused by improper use, carelessness (knocks, dents, crushing, broken glass, etc.), or accidents.
- c. Failure or damage caused by unauthorized repair or modification.
- d. Esthetical changes, defects, and damages due to normal aging (for example: scratches on the case and/or glass)
- e. The shipping cost to and from the designated repair center.

For warranty service, customers must contact us via email to report the problem and obtain authorization first.

Email: [service@atliview.com](mailto:service@atliview.com)

Website: <https://www.atlitimelapse.com>

# FCC WARNING

This device complies with part 15 of the FCC Rules. Operation is subject to the following two conditions: (1) this device may not cause harmful interference, and (2) this device must accept any interference received, including interference that may cause undesired operation.

**WARNING:** Any changes or modifications not expressly approved by the party responsible for compliance could void the user's authority to operate the equipment.

**NOTE:** This equipment has been tested and found to comply with the limits for a Class B digital device, pursuant to Part 15 of the FCC Rules.

These limits are designed to provide reasonable protection against harmful interference in a residential installation.

This equipment generates, uses, and can radiate radio frequency energy and, if not installed and used in accordance with the instructions, may cause harmful interference to radio communications.

However, there is no guarantee that interference will not occur in a particular installation. If this equipment does cause harmful interference to radio or television reception, which can be determined by turning the equipment off and on, the user is encouraged to try to correct the interference by one or more of the following measures:

- Reorient or relocate the receiving antenna.
- Increase the separation between the equipment and receiver.
- Connect the equipment into an outlet on a circuit different from that to which the receiver is connected.
- Consult the dealer or an experienced radio/TV technician for help.

To maintain compliance with FCC's RF Exposure guidelines, this equipment should be installed and operated with minimum 20cm distance between the radiator and your body: Use only the supplied antenna.