

12 Levels Stepless Pressure Adjustment

E1

Oral Irrigator
Instruction Manual

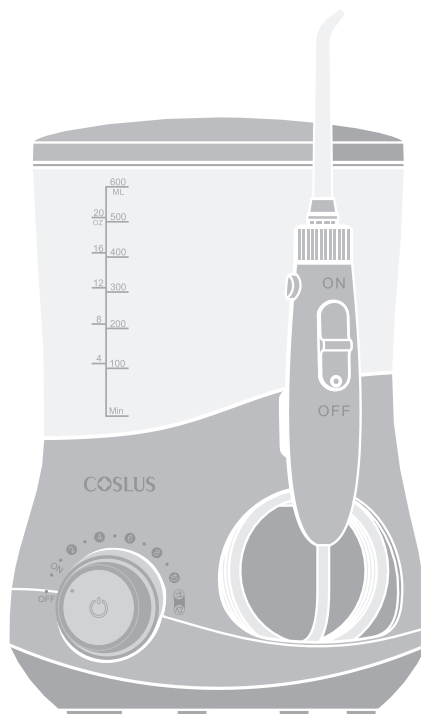

IMPORTANT SAFEGUARDS

Please read the safety instructions before using this product. The safety instructions provided here help you to use this product correctly, and also to prevent you from injuring yourself or others. When using electrical products, especially when children are present, the basic safety precautions should always be followed.

READ ALL INSTRUCTIONS BEFORE USING

DANGERS

- Toddlers, infants, children below 8 years old should not be allowed to use this device.
- Please keep it out of reach of children.
- Do not use if the power cord or plug was damaged.
- Always unplug the device after using.
- Do not touch plug with wet hand.
- Do not place the device in water or other liquids.
- Do not place the device where it may fall or be pulled into a tub or sink.
- Do not touch the product which has fallen into water, unplug it immediately.

⚠ WARNINGS

- The device can be used by children aged from 8 years and above and persons with reduced physical, sensory or mental capabilities or lack of experience and knowledge under supervision.
- Children should not play with the appliance.
- The appliance is only to be used with the power supply unit provided with the appliance.
- Keep the device away from heated surface.
- Do not use other tips except recommend parts.
- Please do not use the device if you lost the nozzle.
- Keep nozzle away from children. The nozzle is small enough to be swallowed and can be become lodged in the throat.
- Do not direct water under the tongue, into the ear, nose or other delicate areas.
- Do not use for any other purpose except oral cleaning.
- Do not fill the tank with warm water over than 40 °C.
- Certain types of mouthwash may damage the device by causing the water tank to crack. Therefore, do not use mouthwash in the water tank.
- People who experience tooth or gum pain may not be able to use this device and should consult their dentist.
- Do not press the nozzle too close against your teeth or gums, doing so may injure your gums.
- Please fill the tank with pure water.

SAVE THESE INSTRUCTIONS

PARTS IDENTIFICATION

Oral Irrigator

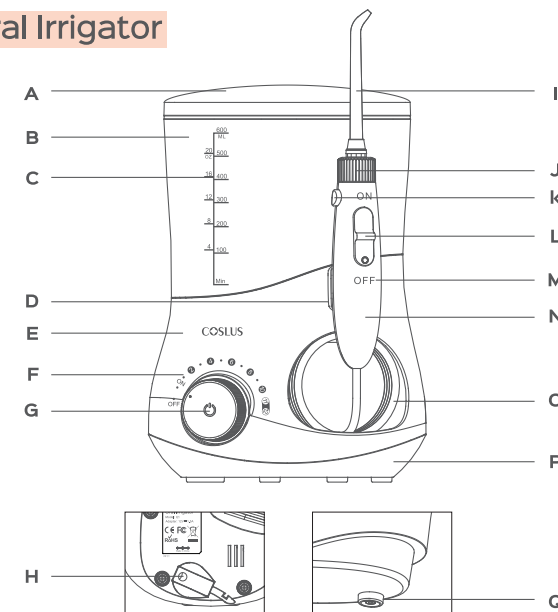

A: Nozzle Case
B: Water Tank
C: Volume Mark
D: Handle Holder
E: Unit Base
F: Pressure Mark
G: Main Button
H: DC Jack Plug

I: Nozzle
J: Nozzle Knob
K: Release Button
L: Pause Switch
M: On/off Mark
N: Handle
O: Pipe
P: Unit Bottom
Q: Tank Valve

Accessories



Standard
Nozzle x 2pcs

Replace every 6 months



Orthodontic
tip x 1pc

Replace every 3 months



Periodontal
pocket tip x 1pc



Toothbrush
Nozzle x 1pc

HOW TO USE

Getting started

Place the device on a flat surface without any sharp objects and make sure the cord is dry and has no damage. The device is powered by a special adaptor with DC jack connector.

(Input: 100-240V~,50/60Hz; Rated Voltage: 12V= 12W).

1. Insert the plug into the DC jack on the bottom of base and plug the adaptor cord into an electrical outlet.(Fig.1)
2. Take the Nozzle Case off.
3. Take the Water Tank off to fill with proper liquid, no warmer than 40 °C, do not pour in salt, tooth-paste, or chemicals, then replace the tank onto the top of main unit and press down firmly. (Fig.2-1&Fig2-2)

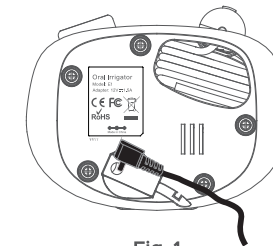

Fig. 1

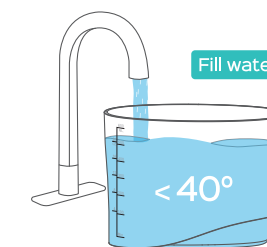

Fig. 2-1

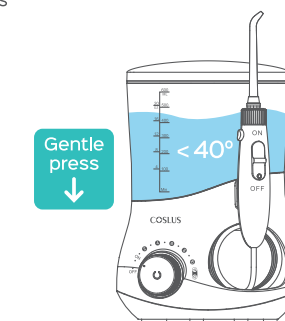

Fig. 2-2

Inserting & Removing Nozzle

Inserting Nozzle

Insert tip into the center of the handle, audibly indicating when the nozzle attached to the handle in place. And also try to pull the tip out gently to confirm the tip is locked firmly.(Fig.3)

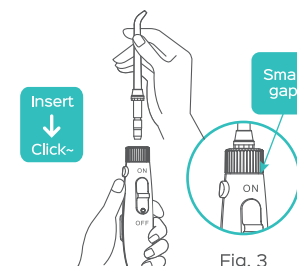

Fig. 3

Removing Nozzle

Press the Release Button on the top end of the handle, then pull the nozzle out lightly by hand. (Fig.4)

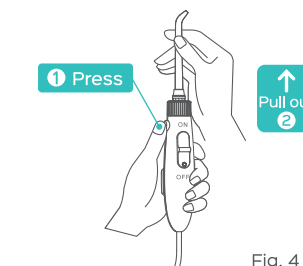

Fig. 4

How to use the oral irrigator

Note:
Do not power on the device before placing the nozzle in your mouth. First use, we suggest you choose the lower pressure, gradually increase the water pressure over time to the setting you need.

- 1. Hold the handle and point the nozzle to sink, then rotate the button clockwise to power on the device.(Fig.5)
- 2. Rotate the main button to adjust water pressure to test water flow, after setting, push the pause switch to “ OFF ” position to pause the water flow. (Fig.6)
- 3. Adjust the direction of nozzle by rotating the nozzle knob.
- 4. Bend over to the sink and place the tip in your mouth, and then push the Pause Switch to “ ON ” position to enjoy irrigating. (Slightly close your mouth to avoid the water splashing.) (Fig.7)
- 5. Position the water jet flow at 90° to the teeth and gums. (Fig.8)
- 6. Move the water jet slowly along the teeth. The unit will continue to work till 2-minute cycle is complete or you turn it off.

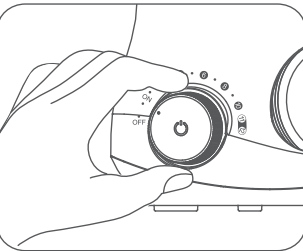

Fig. 5

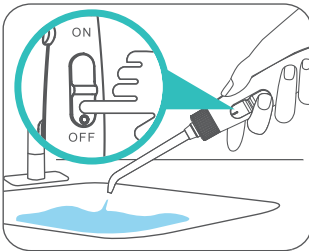

Fig. 6

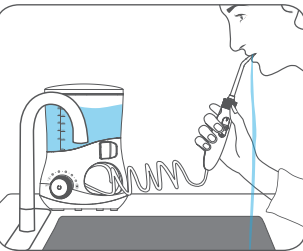

Fig. 7

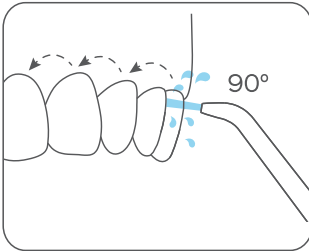

Fig. 8

How to choose a level

Warm tip:
Slight bleeding is normal for first-time use. Continue for a week to see noticeable improvement. If bleeding continues, consult a dentist for possible gum disease.

- Level 1-2:** Use under medical advice for swollen and painful gums, periodontitis, and other special dental conditions.
- Level 3-4:** For children over 8 years old and those with sensitive gums.
- Level 5-6:** For mild use by elderly, pregnant women, etc.
- Level 7-8:** For occasional gum bleeding or routine cleaning of healthy gums.
- Level 9-10:** For deep cleaning in orthodontic and implant patients.
- Level 11-12:** For users with healthy gums and rich experience.

How to end use

- You can end irrigating through the below methods:**
- 1: Automatically shuts off after 2 minute cycle;
 - 2: Turn it off by rotating the button counterclockwise;
 - 3: Unplug the adaptor directly when in any emergency;

After use

- 1. Take off the water tank and dispose of water in it.
- 2. Push the Pause Switch to “ ON ” position, and power on to drain the water inside the device, then push the Pause Switch to “ OFF ” position again .
- 3. Turn off the device and wipe it with a soft dry cloth.(Fig.9)
- 4. Press down the Release Button, and remove the nozzle, then place it into the nozzle case. (Fig.10)
- 5. Unplug the adaptor.

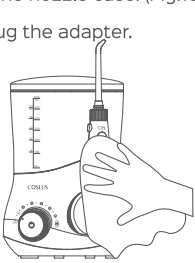

Fig. 9

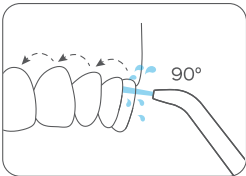

Fig. 10

TIP INSTRUCTION

Standard nozzle:

- Deeply cleans hidden areas between teeth, under the gums and cavities
- Cleans soft plaque, food residues and bacteria on tooth surfaces
- Removes dental plaque
- Massages gums and strengthens teeth
- Recommended to replace every 6 months



Orthodontic tip:

- For daily cleaning of braces and dentures
- Deeply cleans hidden areas between teeth, under the gums and cavities
- Cleans food residue and bacteria around braces
- Removes dental plaque
- Massages gums and strengthens teeth
- Recommended to replace every 3 months

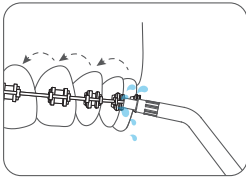

Periodontal pocket tip:

- To deliver water or antibacterial solution to deep periodontal pockets
- During using, the machine must be adjusted to the minimum pressure
- Aims at 45° to the gum line, puts the nozzle into the periodontal pocket, then turns it on
- Recommended to replace every 3 months

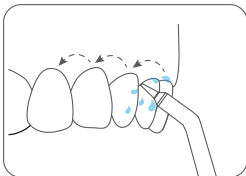

Toothbrush tip:

- More effective for orthodontics and denture users
- Can be used with toothpaste to clean dirt while brushing
- Deeply cleans hidden areas between teeth, under the gums and cavities
- Effectively removes dental plaque
- Recommended to replace every 6 months

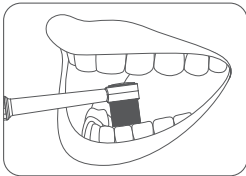

MAINTENANCE

Use only water or neutral cleaning agent to clean the device. Never use caustic or abrasive agents (e.g., vinegar or lime scale removers), since they may damage the device. Do not wash using hot water of over 40 °C. Keep the device away from high temperature area and avoid direct sunlight.

Main unit

- 1. Remove the water tank and drain the remains water inside the device.
- 2. Clean by using a soft cloth with liquid soap and dry with a soft dry cloth.
- 3. Do not submerge the main unit in water to clean.

Handle

- 1. Wash with water and dry up with a soft cloth.
- 2. Do not bend, pull or twist the water hose.

Water tank

- 1. Wash with water and wipe with a soft dry cloth.
- 2. Make sure the water tank is inverted and firmly fixed to store.

Nozzle

- 1. Wash with water and wipe with a soft dry cloth.
- 2. Place the nozzle in the storage compartment.
- 3. Replace once every 6 months for standard nozzle and tongue scraper, and once every 3 months for other tips.

Charging adaptor

Wipe the metal part of the power plug with a dry cloth once every 6 months.

TROUBLESHOOTING

Problem	Possible Cause	Solution
Unit does not work	Motor not running	Make sure the adapter is firmly connected to the outlet and the unit.
		Make sure the outlet and unit power is on
Water pressure is very low	Dirt stuck in the nozzle	Clean or replace with a new nozzle
	The nozzle is deformed	Replace with a new nozzle
	Dirt stuck in the tank valve	Clean the valve and fill the tank with pure water
Water does not come out	The tank is empty	Fill the tank up
	Water pressure under the lowest setting	Slide the switch to adjust pressure
	Tank valve not open	Press down the tank, or reassemble the tank valve
Tank leaks	The valve was lost	Replace with a new tank valve
	The valve isn't install in place	Take off the valve and reinstall again
Tear in Pocket tip head	Tip head is worn	Replace with a new nozzle

DISPOSAL

Do not disassemble the device at any time other than when disposing of it. Doing so earlier will destroy the product.
The appliance must be disconnected from the power supply when disassembling the device.

CONTACT

✉ support@coslus.com 🌐 www.coslus.com
☎ +1(855) 594-3950 (9am-5pm Mon. - Fri. (EST))

Made in China



Coslus Group