

VEVOR[®]

TOUGH TOOLS, HALF PRICE

Technical Support and E-Warranty Certificate www.vevor.com/support

HEAT PRESS MACHINE

We continue to be committed to provide you tools with competitive price.

"Save Half", "Half Price" or any other similar expressions used by us only represents an estimate of savings you might benefit from buying certain tools with us compared to the major top brands and does not necessarily mean to cover all categories of tools offered by us. You are kindly reminded to verify carefully when you are placing an order with us if you are actually saving half in comparison with the top major brands.

VEVOR[®]

TOUGH TOOLS, HALF PRICE

HEAT PRESS MACHINE

MODEL:WBFHPM3804/SJY-H15152M

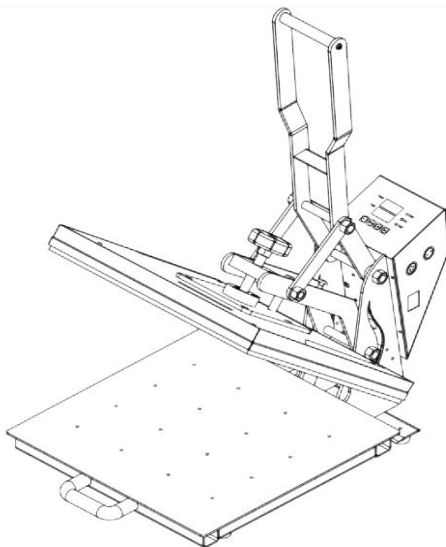

NEED HELP? CONTACT US!

Have product questions? Need technical support? Please feel free to contact us:

Technical Support and E-Warranty Certificate
www.vevor.com/support

This is the original instruction, please read all manual instructions carefully before operating. VEVOR reserves a clear interpretation of our user manual. The appearance of the product shall be subject to the product you received. Please forgive us that we won't inform you again if there are any technology or software updates on our product.

Symbol	Symbol Description
	Warning: To reduce the risk of injury, the user must read the instructions manual carefully.
	This symbol, placed before a safety comment, indicates a kind of precaution, warning, or danger. Ignoring this warning may lead to an accident. To reduce the risk of injury, fire, or electrocution, please always follow the recommendation shown below.
	CORRECT DISPOSAL: This product is subject to the provision of European Directive 2012/ 19/EC. The symbol showing a wheeled bin crossed through indicates that the product requires separate refuse collection in the European Union. This applies to the product and all accessories marked with this symbol. Products marked as such may not be discarded with normal domestic waste, but must be taken to a collection point for recycling electrical and electronic devices.

WARNING

1. Warnings must be followed carefully to avoid body injury, improper use may result in electric shock, fire, personal injury and other damage:

- 1) Keep unplugged when moving the machine.
- 2) Keep unplugged when installing accessories.
- 3) Place on a flat and stable platform and operate under ventilated conditions.
- 4) Wear special protective equipment when operating the machine
- 5) Do not use this machine in a hazardous location.
- 6) Do not use when the machine is not working properly.
- 7) Do not disassemble and repair this machine.
- 8) Do not use an unsuitable AC Outlet.
- 9) Do not touch the heating plate when the machine is heating.

10) Do not use in a humid environment or contact with water. Do not infiltrate liquid in the machine to prevent fire or electric shock caused by short circuit.

11) Do not use the power supply that does not meet the rated voltage. The power supply that does not meet the specified voltage may cause fire or electric shock.

12) Ensure that the machine is grounded so as not to cause harm to body.

13) Do not touch the rotating rod or bearing part with your fingers during use in case of injuries.

14) If the machine is not in use for a long time, please unplug the power cord from the socket.

15) Do not use the machine during thunderstorms or lightning to avoid damage to the machine.

16) Place the machine smoothly on the flame-retardant table and keep away from flammable and explosive items.

17) Please stop using it if the machine smokes, emits a peculiar smell, or becomes noisy and in other abnormal conditions.

18) This appliance can be used by children aged from 8 years and above and persons with reduced physical, sensory or mental capabilities or lack of experience and knowledge

if they have been given supervision or instruction concerning use of the appliance in a safe way and understand the hazards involved. Children shall not play with the appliance. Cleaning and user maintenance shall not be made by children without supervision

19) Type X attachment: If the supply cord is damaged, it must be replaced by a special cord or assembly available from the manufacturer or its service agent.

20) In order to avoid a hazard due to inadvertent resetting of the thermal cutout, this appliance must not be supplied through an external switching device, such as a timer, or connected to a circuit that is regularly switched on and off by the utility.

INTRODUCTION

A heat press machine is using temperature and pressure with a certain amount of time to

transfer designs onto items. The transfer is permanently embedded into the product. Thank you for choosing Heat Press Machine. Please read this user manual carefully and keep it for future reference. If you need any assistance, please email us with your Amazon order number and details.

FCC INFORMATION

CAUTION: Changes or modifications not expressly approved by the party responsible for compliance could void the user's authority to operate the equipment!

This device complies with Part 15 of the FCC Rules. Operation is subject to the following two conditions:

- 1) This product may cause harmful interference.
- 2) This product must accept any interference received, including interference that may cause undesired operation.

WARNING: Changes or modifications to this product not expressly approved by the party responsible for compliance could void the user's authority to operate the product.

Note: This product has been tested and found to comply with the limits for a Class B digital device pursuant to Part 15 of the FCC Rules. These limits are designed to provide reasonable protection against harmful interference in a residential installation.

This product generates, uses and can radiate radio frequency energy, and if not installed and used in accordance with the instructions, may cause harmful interference to radio communications. However, there is no guarantee that interference will not occur in a particular installation. If this product does cause harmful interference to radio or television reception, which can be determined by turning the product off and on, the user is encouraged to try to correct the interference by one or more of the following measures.

- Reorient or relocate the receiving antenna.
- Increase the distance between the product and receiver.
- Connect the product to an outlet on a circuit different from that to which the receiver is connected.
- Consult the dealer or an experienced radio/TV technician for assistance.

SPECIFICATION

Model	WBFHPM3804/SJY-H15152M	
Heat Plate Size	15x15 inch (38×38 cm)	
Temperature Range	32-480°F /0-250℃	
Timer Range	0-999 Seconds	
Voltage	120V~ 60Hz	220-240V~ 50Hz
Power	1400W	1350W

PRODUCT STRUCTURE

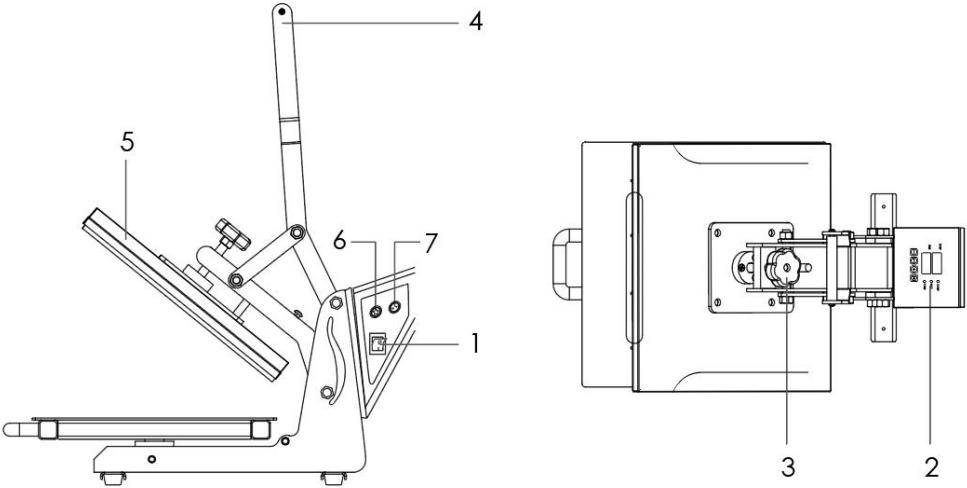

1. Power Switch	5. Heat Platen
2. Digital Controller	6. Heat Plate Interface
3. Pressure Knob	7. Timer Interface
4. Handle	

SPECIFIC SETTINGS

Place the mat on the press bed.

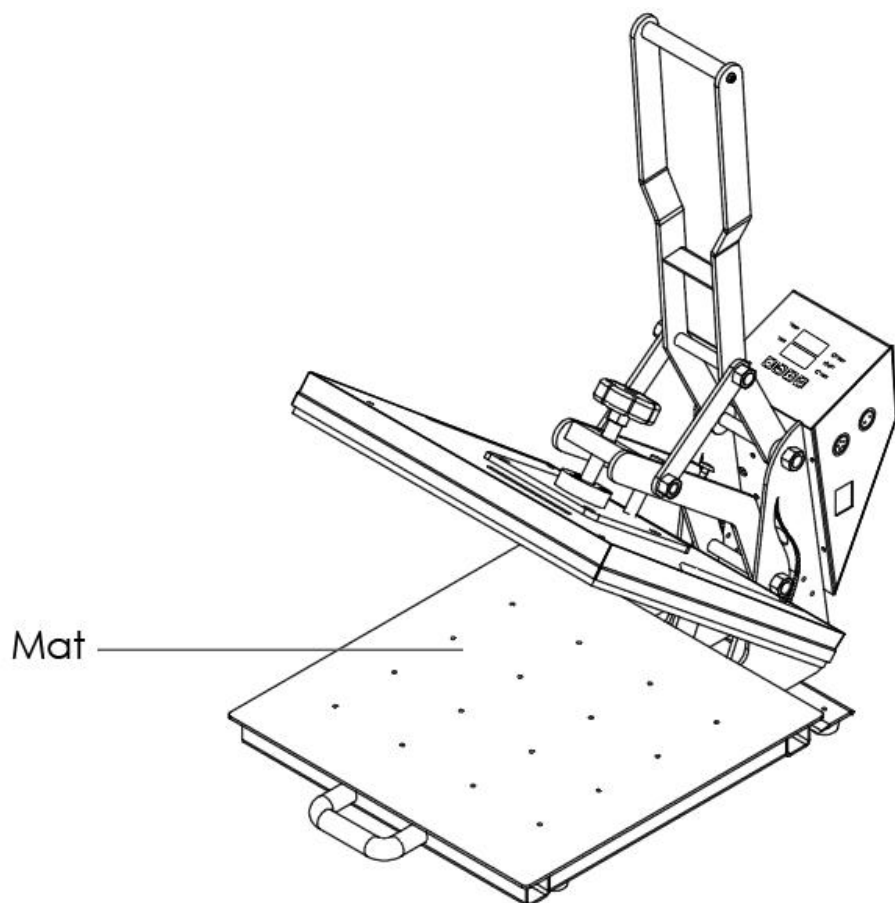

INSTALL THE CONTROLLER

1 Install four screws



2 Plug in the cable



3 FINISH

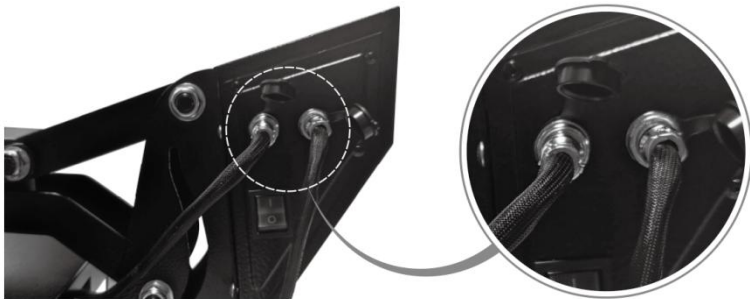

SETTINGS

If you're going to use the machine, please keep the handle lifted up and mat on the press bed first and follow the steps below:

Step 1: Adjust pressure

Turn the pressure adjustment knob to get the desired pressure.

Pressure increase: clockwise rotation

Pressure decrease: counterclockwise rotation

It's better if you try a few times at first use.



Step 2: Set temperature

1. Press the **MODE** button once, and then the digital controller will display **SH**.

2. Press the arrow button + or - to adjust to your desired temperature.

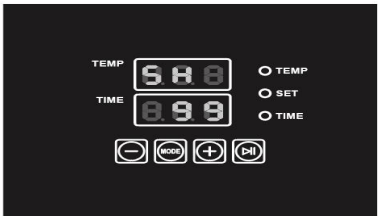

Step 3: Set time (after temperature setting)

1. Press the **MODE** button once again. The digital controller will display **ST**.

2. Press the arrow button + or - to adjust to your desired time (in seconds).

3. Press the **MODE** button once again to set °C or °F

4. Press the **MODE** button last to confirm your setting and the machine will start to heat. (Next time, for the same transfer materials, you don't need to set again, because the machine will memorize your setting.)

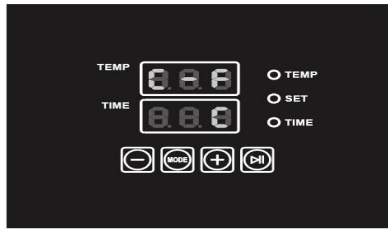
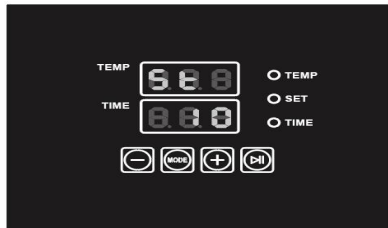

Step 4: Start to transfer

1. Put your items on the high temperature foam mat before the machine reaches the desired temperature. (for T-shirts, please check tips)
2. Position your pre-printed picture where you want it, pictures facing down.
3. Push down the handle and wait for the machine to beep.
4. Lift up the handle (heat platen) and take out transfer items. Transfer done.

TIPS

1. If it's for a T-shirt, please flat it by preheating it for 3-5 seconds to remove wrinkles and moisture, ironing clothes likewise.
2. It's better if you put a white cloth upon the transfer paper to avoid unnecessary marks when setting too high temperature.

TRANSFER PARAMETER (For reference)

		
T-shirt (Non-cotton)	T-shirt (PU flex film)	Aluminum plate
392°F (200°C) 60s	338°F (170°C) 25s	338°F (170°C) 100s
		
Pillow	Mouse pad	Cloth bag
392°F (200°C) 60s	365°F (185°C) 50s	356°F (180°C) 60s

HOW TO USE HEAT PRESS MACHINE

1. Different items require different temperatures and time settings because the material and/or thickness is different.
2. This machine is not suitable for children to use or for food processing.
3. Please turn off the machine and keep it unplugged when not in use.
4. The heat platen will automatically cool down to the room temperature if the heat press stays non-use for more than 30 minutes.
5. For better maintenance of heat press, the maximum setting temperature is 410°F

(210°C).

6. If you want to make a T-shirt double-sided transferred, you'd better insert a sheet of cardboard in between the shirt, adjust the height to less pressure, and then press.

7. It is normal that the heat platen may sway a bit back and forth. Only in this way, can the heat platen be together with the press bed and make the transfer even.

TROUBLESHOOTING

1. Machine doesn't work.

1) Check whether the plug connects well or is broken.

2) Check the fuse whether it has been burnt out.

3) Check the power switch or digital controller whether it is broken.

2. Indicator light is on but the screen is black, showing nothing.

Check cable 5 of railway transformer to see whether it is loosely connected. The transformer may have a fault if the cable is well connected.

3. Screen works well but the temperature is not heating up.

1) Check if the indicator light of solid-state relay is on.

a. If not, please check whether the relay or digital controller is broken. If they are broken, you'd better change them.

b. If yes, it's the heat platen that has a fault.

2) The heat platen still cannot heat up.

a. Please make sure the solid-state relay is fine. And first check the power cable of the heat platen, whether it is connected well.

b. Then check whether the heat platen has a fault. If so, you'd better change a new heat platen.

4. The temperature is out of control:

e.g. Temperature set as 356°F (180°C), but the actual temperature is above 392°F (200°C).

1) It means the solid-state relay is broken, out of control. You'd better change a new one.

2) Or the digital controller has a fault and it keeps conveying electric to relay. In this case, you'd better change a new controller.

5. Transfer pictures are of pale or faded color.

1) The pressure or temperature is not high enough / pressing time is too short. 2) Please adjust the pressure or temperature / increase transfer time.

6. Transfer pictures' color is too dark, deep or blurred.

1) The pressure or temperature is too high / pressing time is too long. 2) Please adjust the pressure or temperature or reduce transfer time.

7. The transfer color is different / partial transfer effect is not good enough. 1) Pressing time is too short / transfer paper is not good enough.

2) Please increase transfer time / use high quality transfer paper.

8. The transfer paper sticks to the transfer items after transfer.

1) The temperature is too high / printing ink is not good enough.

2) Please adjust the temperature / use high quality printing ink.

Manufacturer:Shanghaimuxinmuyeyouxiangongsi
Address: Shuangchenglu 803nong11hao1602A-1609shi, baoshanqu, shanghai 200000 CN.
Imported to AUS: SIHAO PTY LTD. 1 ROKEVA STREETEASTWOOD NSW 2122 Australia
Imported to USA: Sanven Technology Ltd. Suite 250, 9166 Anaheim Place, Rancho Cucamonga, CA 91730

EC	REP
----	-----

E-CrossStu GmbH
Mainzer Landstr.69, 60329 Frankfurt am Main.

UK	REP
----	-----

YH CONSULTING LIMITED.
C/O YH Consulting Limited Office 147, Centurion House,
London Road, Staines-upon-Thames, Surrey, TW18 4AX



Technical Support and E-Warranty Certificate
www.vevor.com/support