

# SANGEAN

## VOCAL 170

FM Stereo RDS / AM Portable  
Radio For The Vision Impaired

**PR-D17**

**GB** Operating instruction ..... 01 - 07



3A81dA110001A



## Important safety instructions

1. Read and understand all safety and operating instructions before the radio is operated.
2. **Retain instructions:** The safety and operating instructions should be retained for future reference.
3. Heed warnings. All warnings on the appliance and operating instructions should be followed.
4. Follow all operations and use instructions.
5. **Water and moisture:** The appliance should not be used near water. Do not use near a bathtub, washbowl, laundry tub, kitchen sink, wet basement, swimming pool, etc.
6. Unplug the radio from the AC power outlet before cleaning. Use only a damp cloth for cleaning the exterior of the radio.
7. Do not place the radio on an unstable cart, stand, bracket or table. The radio may fall, causing serious personal injury and damage to the radio.
8. **Ventilation:** This radio should be situated so that its location or position does not interfere with its proper ventilation. For example, the radio should not be used on a bed, sofa, rug or other soft surfaces that may block the ventilation openings. It should not be placed in a built-in situation like a cabinet that may reduce air flow through the ventilation openings.
9. **Power sources:** The radio should be operated only from the type of power source indicated on the marking label. If you are not sure of the type of power supply to your home, consult your radio dealer or power company.
10. **Power cords:** The power cord should be positioned so it is not walked on, pinched, or items placed on top of it. Pay particular attention to cords at plugs, convenience receptacles, and the point where they exit from the unit. Unplug the power cord by gripping the power plug, not the cord. Operate the radio using only the current type of power source indicated. If you are not sure of the type of power supply to your home, consult your dealer or local power company.
11. Do not overload wall outlets or extension cords. This can result in a risk of fire or electrical shock. Never insert objects of any kind into the radio through opening. The objects may touch dangerous voltage points or short out parts. This could cause a fire or electrical shock.
12. If the radio is left attended and unused for long periods of time, unplug it from the wall outlet. This will prevent damage caused by lightning or power line surges.
13. If the radio is left unattended and unused for a long period of time, remove the batteries. The batteries may leak and damage furniture of your radio.
14. Do not attempt to service the receiver yourself. Removing the cover may expose you to dangerous voltage, and will void the warranty. Refer all servicing to authorized service personnel.
15. Object and Liquid Entry-Never push objects of any kind into the radio through any openings as they may touch dangerous voltage points or short-out parts that could result in a fire or electric shock. Never spill liquid of any kind on the product.
16. The appliance should be serviced by qualified service personnel when:
  - A. The power supply cord or the plug has been damaged.
  - B. Objects have fallen or liquid had been spilled into the radio.
  - C. The radio has been exposed to rain or water.
  - D. The radio does not appear to operate normally or exhibits a change in performance.
  - E. The radio has been dropped, or the enclosure damaged.
17. A warning that batteries (battery pack or batteries installed) shall not be exposed to excessive heat such as direct sunlight, fire or the similar.

GB

F

E

NL

D

### ⚠ IMPORTANT

When your radio has any interference in AM band by its adaptor, please move your radio away from its AC power adaptor over 30cm.

Please note not all AC adapters are alike.

The AC adapter that is included with this radio is designed to be used exclusively with this device. Do not use an AC adapter that differs from the specifications on the AC adapter that is included.

Do not use an AC adapter that does not meet the correct specifications.

### ⚠ CAUTION

These servicing instructions are for use by qualified service personnel only. To reduce the risk of the electric shock, do not perform any servicing other than that contained in the operating instructions unless you are qualified to so.

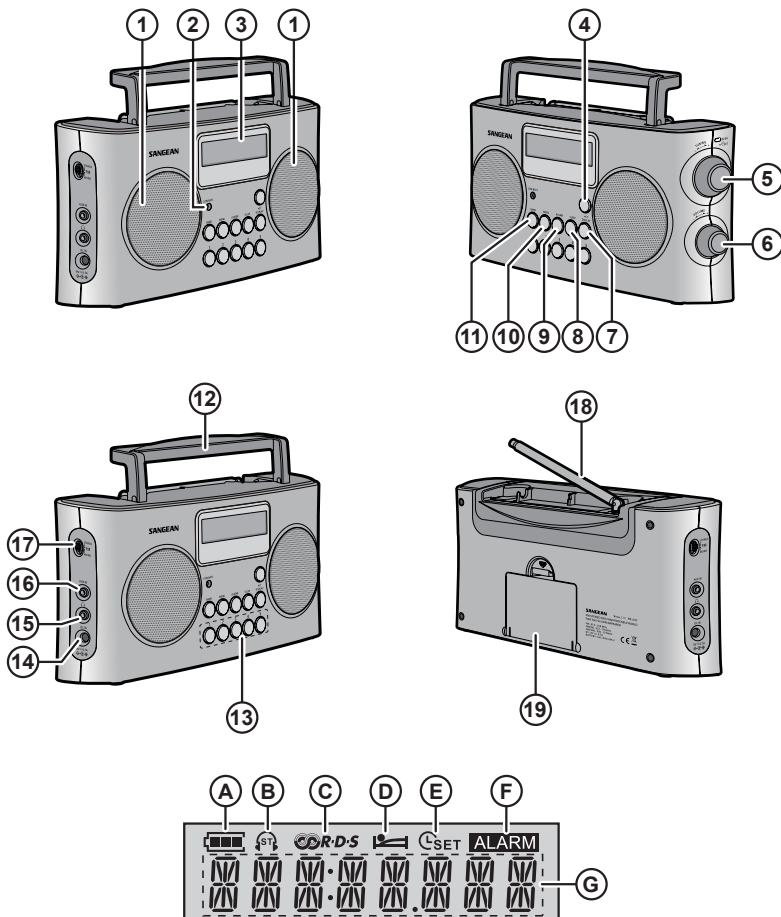

## Controls

①	Speaker
②	Low battery indicator
③	LCD display
④	Power button
⑤	Tuning / Time setting knob / Seek button
⑥	Volume knob
⑦	CT (Clock Time) / Display button
⑧	Sleep button
⑨	Alarm button
⑩	Menu button

⑪	Band button
⑫	Handle
⑬	Preset buttons
⑭	DC IN socket
⑮	Headphone socket
⑯	AUX IN socket
⑰	FM Stereo / Mono switch
⑱	Telescopic antenna
⑲	Battery compartment

## LCD Display

Ⓐ	Battery power
Ⓑ	Stereo display
Ⓒ	RDS display
Ⓓ	Sleep display

Ⓔ	Time set
Ⓕ	Alarm display
Ⓖ	Frequency / Time display

**This radio features helpful voice prompts of all controls that announce functions in multiple languages for vision impaired users.**

**It has high contrast large yellow controls and preset buttons with raised symbols to aid in identification along with large rotary tuning and volume control knobs.**

## Battery operation

1. Open the battery cover on the rear of the unit by pushing the latch downward.
2. Insert 6 x UM-2 (C size) batteries into the battery compartment. Make sure all batteries are inserted with correct polarity as shown in the battery compartment. Close the battery cover.
3. Reduced power, distortion and a stuttering sound or the low battery LED indicator is red are all signs that the batteries need replacing. If the radio is not to be used for an extended period of time, it is recommended that the batteries be removed from the radio.

### ⚠ IMPORTANT

Batteries should not be exposed to excessive heat such as direct sunlight, fire or the like. After use, disposable batteries should be taken to a suitable recycling center. On no account should batteries be disposed of by incineration. Do not leave batteries within reach of young children. They can be a choking hazard.

GB

F

E

NL

D

## Using the AC power adaptor

The AC power adaptor included with this unit is 9 volts DC at 0.7A center pin positive.

Insert the adaptor plug into the DC socket on the left side of the radio. Plug the adaptor into a standard AC outlet.

Whenever the adaptor is used, the batteries are automatically disconnected. The AC adaptor should be disconnected from the main supply when not in use for long periods of time.

### IMPORTANT

The AC adaptor is used as the means of connecting the radio to the power supply. The AC Adapter used for the radio must remain accessible during normal use in order to disconnect the radio from the power supply completely.

## Setting clock time

Upon initial use of the radio after the batteries have been installed or the AC adaptor is plugged in, the voice language option "English" will flash on the display. Rotate the Tuning knob to select the required voice language and press the Tuning knob to confirm the setting. The display will show --:--:--. The clock can be set with the radios power on or off.

1. Press and hold the Time setting knob for more than 2 seconds, the display will flash the time setting symbol  and also the hour digits.
2. Rotate the Time setting knob to set the required hours.
3. Press the Time setting knob, the minute digits will flash.
4. Rotate the Time setting knob to set the required minute.
5. Press the Time setting knob to complete time setting.

## Menu setting

(Voice language → Voice volume → Time format → AM tuning step → Software / Voice version)

1. Press the Menu button, the voice language option "English" (e.g.) will flash on the display. Rotate the Tuning knob to select the required voice language. Press the Tuning knob to confirm the setting and enter the volume of the voice setting.
2. Rotate the Tuning knob to set the volume of the voice. Press the Tuning knob to confirm the setting and enter the time format setting.
3. Rotate the Tuning knob to select "12 HOUR" or "24 HOUR".
4. Press the Tuning knob to confirm the time format setting and enter the AM tuning step setting.
5. Rotate the Tuning knob to select "10kHz" or "9kHz". (10k for America and 9k for most other countries)
6. Press the Tuning knob to confirm the AM tuning step setting, then the software version will show on the display. Rotate the Tuning knob to view software version or voice version.
7. Pressing the Tuning knob will exit the software version or voice version display.

## Tuning the radio – FM / AM

1. Press the Power button to turn on the radio.
2. Select the required frequency band by pressing the Band button. For the FM band fully extend and rotate telescopic antenna to get best reception. For the AM band, rotate the radio to get the best signal. (Please note this radio has a built-in AM antenna.)
3. Rotate the Tuning knob to the desired frequency, shown in the display.

4. Or press the Seek button to seek for the next available station. To seek up in frequency, rotate the Tuning knob in a clockwise direction, then press the Seek button. Your radio will seek in an upwards direction (low frequency to high frequency) and stop automatically when it finds a station of sufficient strength.  
To seek down in frequency, rotate the Tuning knob in a counter clockwise direction, then press the Seek button. Your radio will seek in a downwards direction and stop automatically when it finds a station of sufficient strength.
5. Rotate the Volume knob to get required sound level.
6. To turn off the radio, press the Power button.

## Storing station presets – FM / AM

There are 5 presets each for FM and AM radio. They are used the same way for each operating mode.

1. With your radio switched on, press the Band button to select the desired frequency band.
2. Tune to the desired radio station as previously described.
3. Press and hold the desired preset button for more than 2 seconds. The preset number will appear in the display (such as: <sup>M</sup> 1). The station will be stored under the chosen preset button.
4. Repeat this procedure for the remaining presets.
5. Stations stored in preset memories can be overwritten by following the above procedures.

## Recalling stations presets – FM / AM

1. With your radio switched on, press the Band button to select the desired frequency band.
2. Momentarily press the desired Preset button, the preset number and station frequency will appear in the display.

## RDS function

This function only applies when an FM station provides the RDS service.

When an FM station provides RDS service,  shows on the display and the display will show the station name and then show the radio text if radio text is provided.

## RDS CT (Clock Time) Set

Select an FM radio station which provides RDS CT service, press and hold CT (Clock Time) button for more than 2 seconds, the display will flash . The clock time will be aligned automatically once the CT service is available.

When it shows “No CT” this means there is no CT (Clock Time) service.

To view the time and frequency, press the Display button.

### NOTE

Not all stations broadcast the CT (Clock Time) and may not always be accurate. This is the fault of the radio stations signal not your radio.

## AUX IN

1. Turn on the radio, and press the BAND button until “AUX IN” is displayed.
2. Connect a stereo or mono audio source using a standard 3.5mm connector (e.g. iPod, MP3 or CD player) to the Aux in socket on the left side of the radio.
3. Adjust the Volume control on your iPod, MP3 or CD player and your radio.

GB

F

E

NL

D

## Setting radio alarm time

Ensure that the time is set correctly before setting the alarms. The alarm can be set when the radio is on or off.



1. Press the Alarm button, **ALARM** will flash on the display.
2. Rotate the Tuning knob to select "ALARM OFF" or "ALARM ON". If "ALARM OFF" is selected any current setting for that alarm will be cancelled. With "ALARM ON" selected, press the Tuning knob to enter the alarm time setting. The hour digits will flash on the display.
3. Rotate the Tuning knob to select the hour then press the Tuning knob to confirm hour setting, and the minute digits will flash.
4. Rotate the Tuning knob to select the minute then press the Tuning knob to finish setting.
5. The radio will play the last played radio station at the chosen alarm time. Use the volume knob to adjust the volume for the alarm.
6. While the alarm is sounding, press the Power button or Alarm button to stop it.

### ⚠ NOTE

If it is under AUX band, the alarm will sound by buzzer. When the buzzer alarm activates, the alarm will start softly and gradually increase in level (Humane Wake System). It will sound for 1 minute and silence for 1 minute in repetition for 60 minutes unless cancelled.

## Sleep function

The sleep timer will automatically switch off the radio after a preset time has elapsed.

1. Press the Sleep button,  will flash on the display.
2. Rotate the Tuning knob to select the required sleep time (60-45-30-15-120-90 minutes).
3. Press the Tuning knob to confirm the setting.  will stop flashing on the display.
4. To cancel the sleep time before the preset time has elapsed and to turn off the radio, press the Power button to turn the unit off manually.

## FM Stereo / Mono selection

The FM Stereo / Mono mode switch is on left the side of the radio.

When the FM signal is weak, some hiss may be audible. To reduce the hiss, slide the Stereo / Mono switch to Mono mode.

## Headphone socket

A standard 3.5mm headphone socket located on the left side of your radio is provided for use with headphones.

Inserting earbuds or headphones will automatically mute the internal speaker.

Please be aware that the sensitivity of headphones can vary widely. We therefore recommend setting the volume to a low level before connecting headphones to the radio.

### ⚠ IMPORTANT

- Excessive sound pressure from Earbuds or Headphones can cause hearing loss.
- To prevent possible hearing damage, do not listen at high volume levels for long periods of time.



## Factory reset

If your radio fails to operate correctly, or some digits on the display are missing / incomplete or you simply just want to restore the radio to its original factory setting, carry out the following procedure.

By performing a factory reset, all user entered settings will be erased.

Press and hold the Power button and Preset 5 button at the same time, the “DEFAULT” will appear and flash on the display. Continue holding down these two buttons until all the icons appear on the screen. Now the factory reset is completed.

## Specifications

Power Requirements	
AC Power adaptor	DC 9V 0.7A center pin positive
Batteries	6 X UM-2 (C size)
Battery Life	Approx. 70 hours of listening for 4 hours a day at normal volume using alkaline batteries
Frequency Coverage	FM 87.5 -108 MHz
	AM 522-1710 kHz (9kHz / step)
	AM 520-1710 kHz (10kHz / step)
Circuit Feature	
Loudspeaker	2.5 inches 8 ohm
Output Power	800+800 mW
Headphone socket	3.5mm diameter
Antenna System	FM telescopic antenna
	AM built-in ferrite antenna
Operating temperature range	0°C to +35°C

GB

F

E

NL

D

### ※ The barcode label on the product is defined as below:



aH 18 12 00001

Serial number  
Production month  
Production year  
Product code



The company reserves the right to amend the specifications without notice.

If at any time in the future you should need to dispose of this product please note that: Waste electrical products should not be disposed of with household waste. Please recycle where facilities exist. Check with your Local Authority or retailer for recycling advice. (Waste Electrical and Electronic Equipment Directive).