

Instruction Manual

Quadruple Display USB-C Docking Station

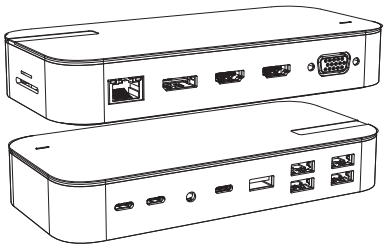

ENGLISH

Product Introduction

This USB-C Docking Station is designed for extra connectivity demands which you can extend the connection of a computer to multiple devices via USB-C interface. In addition, the docking station is equipped with 4 display video outputs. With Quadruple display simultaneously, it allows you to split up the content to multi-stream display devices when the system supports the function. The docking station provides all connections you need include: 2×HDMI, 1×DP and one VGA ports. One of the HDMI resolutions is up to 4K@60Hz [when the Host side is DisplayPort (DP) v1.4 (HBR3)]. Enjoy the speedy transmission and excellent picture quality of 4K video.

Structure Diagram

- Front:
1. PD3.0
 2. USB-C input (Host)
 3. 3.5mm Audio&Mic
 4. USB-C Data
 5. USB-A 3.1
 6. USB-A 3.0
 7. USB-A 2.0

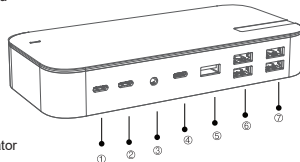

- Back:
1. LED indicator
 2. VGA
 3. HDMI 1
 4. HDMI 2
 5. DP
 6. RJ45
 7. SD&Micro SD Card Reader

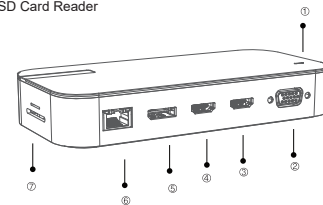

Features

Front:

1. PD3.0:
Up to 100W upstream charging the source devices such as USB-C Laptop/MacBook. Please make sure your device supports power delivery protocol.
2. USB-C input (Host): connect to host
3. 3.5mm Audio & Microphone
4. USB-C 3.1 Gen 2 data: up to 10Gb/s data speed & maximum power output 5V/1.5A
5. USB-A 3.1 : 10Gbps, 5V/1.5A @7.5W
6. USB-A 3.0 : 5Gbps, 5V/0.9A @4.5W
7. USB-A 2.0 : 480Mbps, 5V/0.5A @2.5W

Back:

1. LED indicator
2. VGA: Resolution up to 1080P/60Hz.
3. HDMI 1:
4Kx2K 60Hz / 3840x2160 (work separately while source is DP1.4)
4Kx2K 30Hz / 3840x2160 (work separately while source is DP1.2)
4. HDMI 2: 4Kx2K @30Hz / 3840x2160
5. DP:
4Kx2K 60Hz / 3840x2160 (work separately while source is DP1.4)
4Kx2K 30Hz / 3840x2160 (work separately while source is DP1.2)
6. RJ45 Gigabit Ethernet: 1000Mbps
7. SD&Micro SD Card Reader
Read: 50-104MB/s, Write: 30-80MB/s, (Data transfer rates are subject to the speed of the memory card, itself and your computer's USB ports.)

Connection

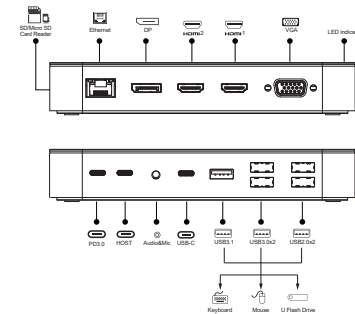

Mobile

Notebook

Tablet PC

Graphics Settings for window 10

1.Clone mode

Right click desktop > Graphics Settings > Display

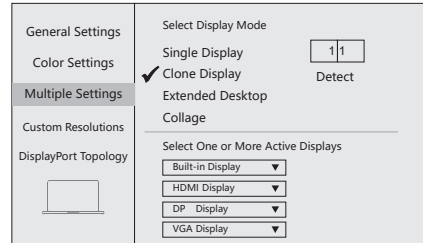

Source device

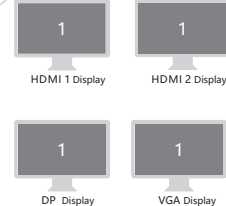

2.Extended Desktop(NOT supported by APPLE)

Right click desktop > Graphics Settings > Display

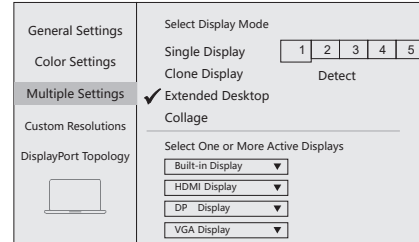

Source device

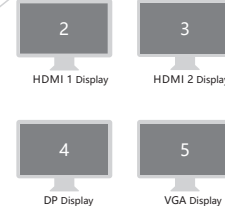

Graphics Settings for Mac

1.Mirror Display

Apple logo>System Preferences > Displays

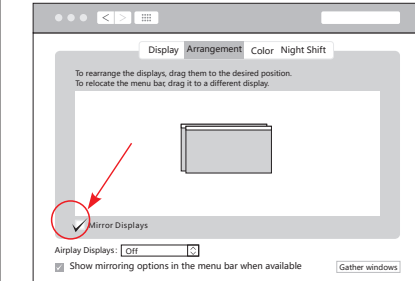

Source device

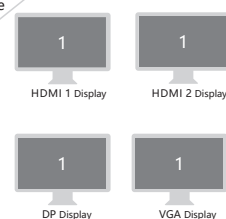

2.Extend Display

Apple logo>System Preferences > Displays

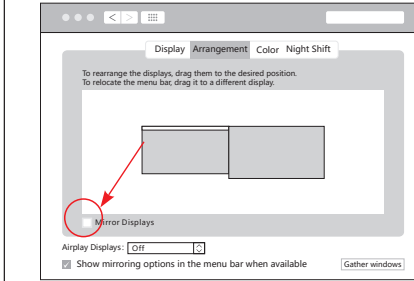

Source device

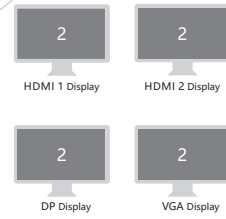

Warm Reminder

1. Please make sure the USB-C port of your Smartphone/Tablet/ Laptop supports the DP feature before purchase, or your PC will not output any contents.
2. 4Kx2K@60Hz video display, please make sure your PC support DisplayPort (DP) v1.4 (HBR3).
3. Please update Mac OS of your MacBook to Catalina (10.15.1) or above for better compatibility.

FAQ

- a. Why is there no video output?
1. Please make sure your host supports DisplayPort Alternate Mode (Alt Mode) video output functionality.
 2. Please use the standard HDMI/DP cable.
 3. Please check if the cables are well connected.
- Why there are not five video output on Windows?
- a. Laptop is a discrete graphics card (while source is DP1.4) Docking station supports FIVE video output.
 - b. Laptop is an integrated graphics card(while source is DP1.2) Docking station supports THREE video output.
 - c. Laptop is an integrated graphics card(while source is DP1.4) Docking station supports FOUR video output.
4. Please make sure select the correct input source for your HDMI and DP monitor.
- b. Why is there no audio output from HDMI port?
1. Please make sure that there is audio output function on the monitor.
 2. Please set the external monitor as default audio output device.
- c. Can I connect my Apple SuperDrive to the dock?
1. No, some devices such as the Apple SuperDrive look for Apple-specific signaling and will not work when connected through any USB hub.
- d. My docking station not charging my laptop?
1. Please check the specifications of your Laptop and identify which port has PD charging functionality if multiple USB-C ports are available.
 2. Verify if your host system supports PD over USB-C.
 3. Please noted some old models of computers have USB-C port, but do not support charging, only can be powered by its original AC/DC power adapter.