

JASTIP

Quick Start Guide

V15

Jastip Support Team:
support@jastip.top

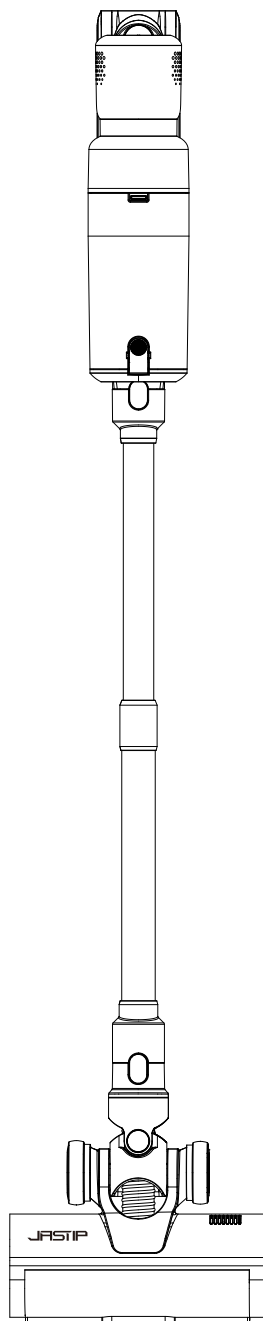

Installing Desired Cleaning Accessory

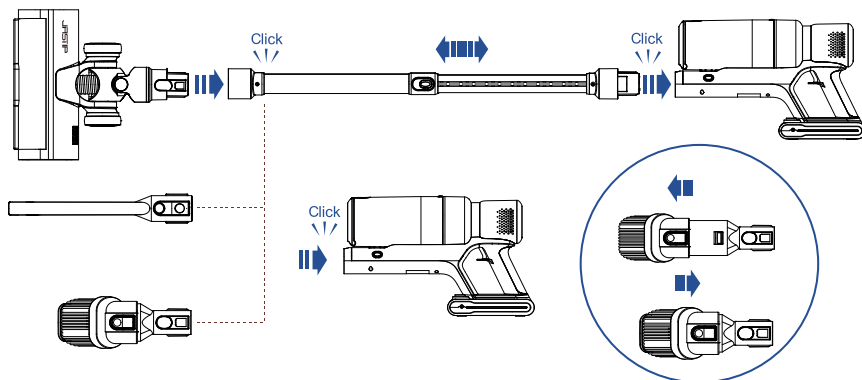

Power mode and speed switch

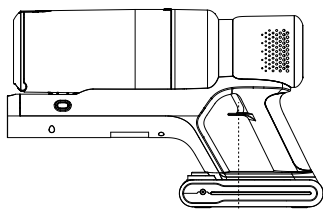

ON/OFF button

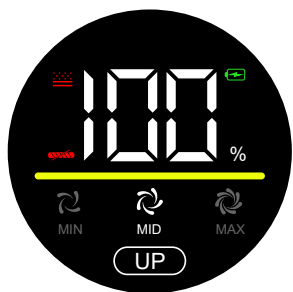
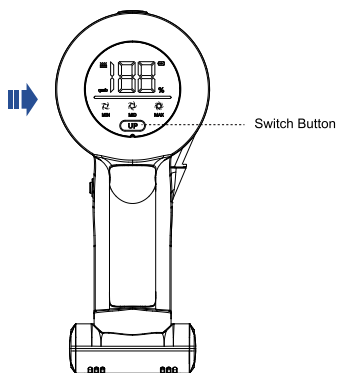

Boot into "MID" Mode

Touch the "UP" Key Set to "MAX" Mode

Touch the "UP" Key Again Switch to "MIN" Mode

Recharging on the storage wall-mount

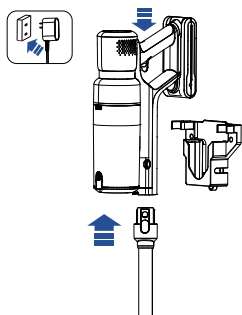

Charging separately

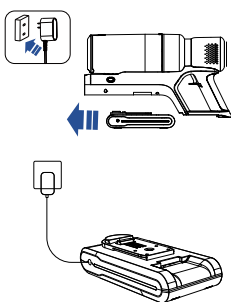

Power display

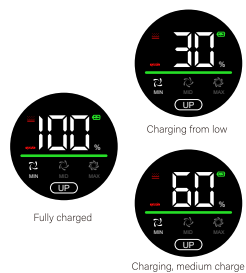

Empty the dust bin

1

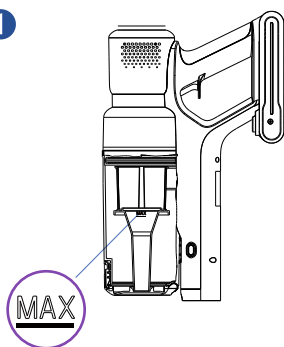

2

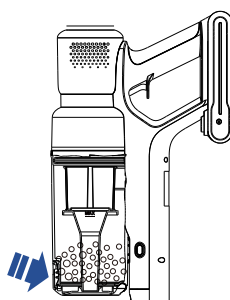

3

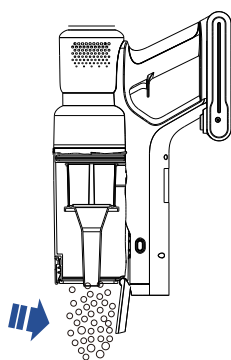

4

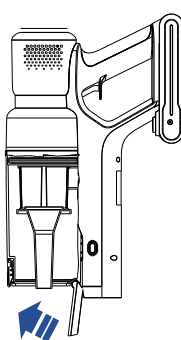

Clean the Electric Floor Brush

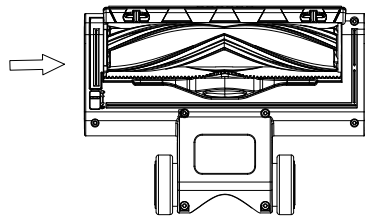
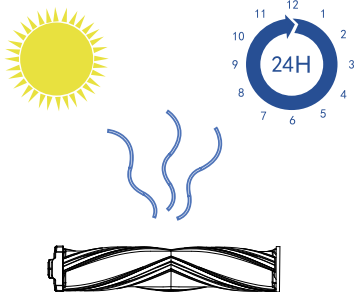
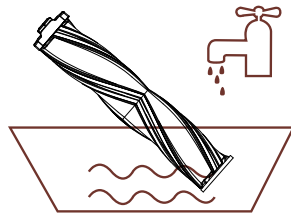
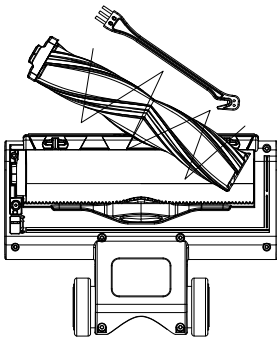
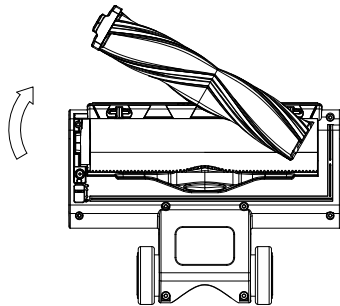
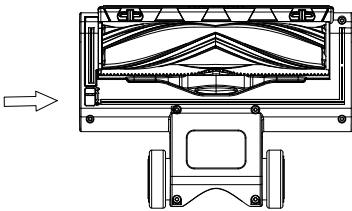

Dust Cup Cleaning



 **IMPORTANT!**

Wash filters with cold water at least every month.
Ensure the filters are completely dry before refitting.

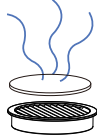
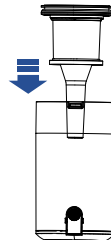
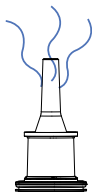
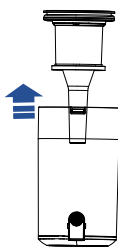

Remove the Dust Cup

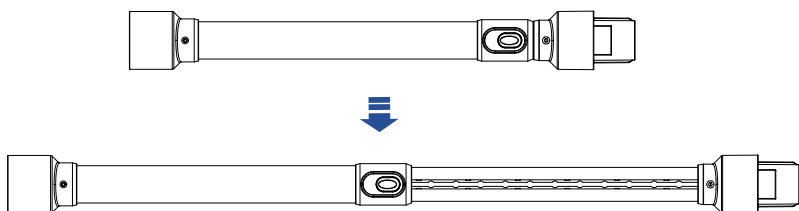
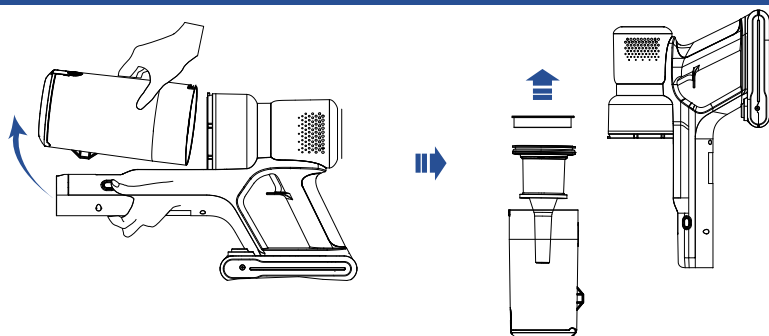

Prohibited operations

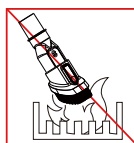

Do not use V15
near open flames.

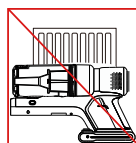

Do not store V15
near heat sources.

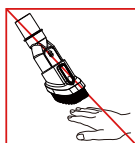

Do not put your hands
near the brush bar
when V15
is running.

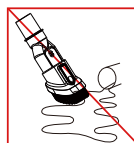

Not applicable for
picking up liquids.

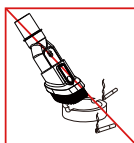

Not applicable for
picking up burning
objects.



Email to **JASTIP** Official Customer Service:
support@jastip.top
We are always here to help you for any questions.

