

**Price and Specification Guide**  
25 January 2023 | Model Year 2023A



# All-new Astra

Including new Plug-in Hybrid and GSe models

GO



# Contents

To find the information you want use the links below to navigate around the guide:

Vauxhall Pure Technology
Choose Your Trim Level
Range Highlights
Models
Prices
Vauxhall PureSense

Vauxhall PureConnect
Vauxhall PureEnergy
Comfort and Convenience
Safety and Security
Styling
Exterior Colours

Wheels and Tyres
Specifications
Dimensions and Capacities
Company Car Information
Further Information



# Vauxhall Pure Technology

We believe technology works best when it works for everyone. When it's not just as smart as can be, but also as easy as can be. We call it Vauxhall Pure Technology. Now everyone can feel the instant excitement of electric. Everyone can keep themselves and their loved ones safe. And everyone can stay connected to the things that matter most, simply and easily. That's Vauxhall Pure Technology. No gimmicks, nothing complicated, just technology that makes driving better, easier and more exciting, for everyone.



## Vauxhall PureSense

Vauxhall PureSense gives you heightened awareness on the road, with smart driver assistance technology that makes every journey safer and more enjoyable. And the best bit? You don't have to do a thing. PureSense is always on, continually working away in the background, scanning the road ahead, keeping you safe and allowing you to just enjoy the drive.



## Vauxhall PureConnect

We live in a connected world. Friends and relatives are only a button away. We play music on demand. Information is instant. At Vauxhall we've brought your connected world inside the car – we call it PureConnect. Easy to use and always on, PureConnect seamlessly connects you to the things that matter through the smooth, flowing Pure Panel display. And, just as intelligently, it connects you to your car's onboard tech, through touchscreen and voice control.



## Vauxhall PureEnergy

At Vauxhall, we're on a mission to open up electric driving to everyone. To deliver instant, exhilarating performance with low emissions. To change the way we move, for the better. And with innovative plug-in Hybrid models available across the range, including the all-new 225PS GSe model, there's an electrified all-new Astra that will fit seamlessly into your life. One that's more exciting than ever, while keeping costs as low as possible. Thanks to PureEnergy from Vauxhall.



# Choose Your Trim Level

## Design

Inject a little excitement into your commute with the Design, including plenty of ‘must have’ features as standard.



## GS

Step up to our sporty GS. It’s kitted out with a whole host of features that make it fun to drive, and great to look at.

Also available as a Plug-in Hybrid model.



## Ultimate

All you could ask for; our Ultimate model has it all.

Also available as a Plug-in Hybrid model.\*



## GSe

The new GSe (Grand Sport electric) radically redefines pure performance. Combining bold design with exhilarating, electrified technology. This is responsible, high-energy excitement.



\*Hatchback model only.





# All-new Astra Plug-in Hybrid Range Highlights

## GS

### Standard features include:

#### PureSense

- LED headlights and tail lights
- LED daytime running lights
- LED front fog lights • High beam assist
- Electronic parking brake
- Front and rear parking distance sensors
- Lane departure warning with lane keep assist
- Traffic sign recognition
- Driver drowsiness alert
- Forward collision alert (all speed)
- Automatic emergency braking with pedestrian detection
- Adaptive cruise control with intelligent speed adaption
- Eight airbags • Hill start assist
- Remote control security alarm system
- ISOFIX child seat fixings on outer rear seats
- In-crash braking
- Intelli-Vision 360° panoramic parking camera

#### PureConnect

- Multimedia Pure Panel Pro Navigation system
  - 10-inch colour touchscreen
  - 10-inch digital instrument cluster
  - AM/FM/DAB digital radio
  - Bluetooth® – Natural voice recognition\*\*
  - Wireless Apple CarPlay/Android Auto™
  - 2 x front USB connections
- Six speakers • Vauxhall Connect

#### Comfort and Convenience

- Dual-zone electronic climate control
- Heated perforated flat-bottomed leather-covered steering wheel

- Steering wheel audio/phone/cruise controls
- Interior ambient lighting
- 60/40 split-folding rear seat backs (Hatchback only)
- 40/20/40 split-folding rear seat backs (Sports Tourer only)
- Fixed floor with luggage restraining nets (pair, Sports Tourer only)
- Rain-sensitive windscreen wipers
- Electrically operated front and rear windows
- Electrically adjustable/heated power folding door mirrors with puddle light
- Soundproofed insulated windscreen
- Driver's ergonomic active seat (AGR approved\*)
- Heated sports-style front seats
- Paddle shift
- Front centre armrest with cup holder
- Centre rear seat armrest and load-through facility
- Frameless automatic anti-dazzle rear-view mirror
- Keyless entry and start
- Intelli-Space (Sports Tourer only. See Versatility page for more information)

#### Styling

- Sports-style front and rear bumpers
- 17-inch black alloy wheels
- Black Griffin logo and vizor frame
- Black lower window moulding
- Dark-tinted rear windows
- Black roof Black headliner
- Alloy-effect sports pedals

## Ultimate

### Features over GS models:

#### PureSense

- IntelliLux adaptive LED® pixel headlights
- Lane change assist with side blind spot alert
- Lane positioning assist
- Rear cross traffic alert

#### PureConnect

- Eight speakers
- Intelli-HUD (Head-Up Display)
- Wireless charger for mobile devices

#### Comfort and Convenience

- Dual-zone electronic climate control with Intelli-Air (air quality sensor)
- Heated soundproofed insulated windscreen
- Heated ergonomic active sports-style front seats (AGR approved\*)
- Alcantara interior seat trim
- Panoramic sunroof

#### Styling

- 18-inch grey diamond-cut alloy wheels

## GSe

### Features over GS models:

#### PureSense

- IntelliLux adaptive LED® pixel headlights
- Lane change assist with side blind spot alert
- Lane positioning assist
- Rear cross traffic alert

#### PureConnect

- Intelli-HUD (Head-Up Display)
- Wireless charger for mobile devices

#### Comfort and Convenience

- Dual-zone electronic climate control with Intelli-Air (air quality sensor)
- Heated soundproofed insulated windscreen
- GSe performance heated front seats (AGR approved\*)
- Alcantara interior seat trim

#### Styling

- Unique GSe front and rear bumpers
- 18-inch gloss black bi-colour diamond-cut alloy wheels
- GSe badge

#### Performance

- Sports chassis incorporating:
  - Frequency Selective Damping with bespoke Koni dampers
  - Revised front and rear springs
  - Recalibrated sports steering
- Suspension lowered by 10mm
- Exclusive ESP settings

\*AGR (The Campaign for Healthier Backs) is an independent centre of excellence for ergonomics, based in Germany. \*\*Available as part connected services. Free for 3 years then subject to a subscription fee thereafter.

# All-new Astra Range Highlights

## Design

Standard features include:

PureSense

- LED headlights and tail lights
- LED daytime running lights
- LED front fog lights
- High beam assist
- Electronic parking brake
- Front and rear parking distance sensors
- Lane departure warning with lane keep assist
- Speed sign recognition
- Driver drowsiness alert
- Forward collision alert (low speed)
- Automatic emergency braking with pedestrian detection
- Cruise control with intelligent speed adaption
- Eight airbags
- Remote control security alarm system
- Hill start assist
- ISOFIX child seat fixings on outer rear seats
- In-crash braking

PureConnect

- Multimedia Pure Panel Navigation system
  - 10-inch colour touchscreen
  - 10-inch digital instrument cluster
  - AM/FM/DAB digital radio
  - Bluetooth®
  - Natural voice recognition\*\*
  - Wireless Apple CarPlay/Android Auto™
  - Front USB connection
- Six speakers
- Vauxhall Connect

Comfort and Convenience

- Electronic climate control
- Flat-bottomed leather-covered steering wheel
- Steering wheel audio/phone/cruise controls
- 60/40 split-folding rear seat backs (Hatchback only)
- 40/20/40 split-folding rear seat backs with remote easy-fold facility (Sports Tourer only)
- Flex load floor with luggage restraining nets (pair, Sports Tourer only)
- Rain-sensitive windscreen wipers
- Electrically operated front and rear windows
- Electrically adjustable/heated door mirrors
- Soundproofed insulated windscreen
- Keyless start
- Intelli-Space (Sports Tourer only. See Versatility page for more information)

Styling

- Body-colour front and rear bumpers
- 16-inch silver alloy wheels
- Chrome-effect Griffin logo and vizer frame
- Black lower window moulding

## GS

Features over Design models:

PureSense

- Traffic sign recognition
- Forward collision alert (all speed)
- Adaptive cruise control with intelligent speed adaption

PureConnect

- Multimedia Pure Panel Pro Navigation system
- Intelli-Vision 360° panoramic parking camera

Comfort and Convenience

- Dual-zone electronic climate control
- Heated perforated flat-bottomed leather-covered steering wheel
- Driver's ergonomic active sports-style seat (AGR approved\*)
- Heated front seats
- Paddle shift (auto models only)
- Front centre armrest with cup holder
- Centre rear seat armrest and load-through facility
- Flex load floor
- Frameless automatic anti-dazzle rear-view mirror
- Keyless entry and start
- Interior ambient lighting

Styling

- Sports-style front and rear bumpers
- 17-inch black alloy wheels
- Black Griffin logo and vizer frame
- Dark-tinted rear windows
- Black roof
- Black headliner
- Alloy-effect sports pedals

## Ultimate

Features over GS models:

PureSense

- IntelliLux adaptive LED® pixel headlights
- Lane change assist with side blind spot alert
- Lane positioning assist
- Rear cross traffic alert

PureConnect

- Eight speakers
- Intelli-HUD (Head-Up Display)
- Wireless charger for mobile devices

Comfort and Convenience

- Dual-zone electronic climate control with Intelli-Air (air quality sensor)
- Heated soundproofed insulated windscreen
- Heated ergonomic active sports-style front seats (AGR approved\*)
- Alcantara interior seat trim
- Panoramic sunroof

\*AGR (The Campaign for Healthier Backs) is an independent centre of excellence for ergonomics, based in Germany. \*\*Available as part connected services. Free for 3 years then subject to a subscription fee thereafter.



# All-new Astra GS Plug-in Hybrid

VX\_AST\_PHEV\_34160



## GS

OTR from £37,285

### PureSense

- LED headlights and tail lights
- LED daytime running lights
- LED front fog lights
- High beam assist
- Electronic parking brake
- Front and rear parking distance sensors
- Lane departure warning with lane keep assist
- Traffic sign recognition
- Driver drowsiness alert
- Forward collision alert (all speed)
- Automatic emergency braking with pedestrian detection
- Adaptive cruise control with intelligent speed adaption
- Eight airbags
- Hill start assist
- ISOFIX child seat fixings on outer rear seats
- In-crash braking
- Intelli-Vision 360° panoramic parking camera

### PureConnect

- Multimedia Pure Panel Pro Navigation system
  - 10-inch colour touchscreen
  - 10-inch digital instrument cluster
  - AM/FM/DAB digital radio
  - Bluetooth®
  - Natural voice recognition
  - Wireless Apple CarPlay/Android Auto™
  - 2 x front USB connections
- Six speakers • Vauxhall Connect

### Comfort and Convenience

- Dual-zone electronic climate control
- Heated perforated flat-bottomed leather-covered steering wheel

- Steering wheel audio/phone/cruise controls
- Interior ambient lighting
- 60/40 split-folding rear seat backs (Hatchback only)
- 40/20/40 split-folding rear seat backs (Sports Tourer only)
- Fixed floor with luggage restraining nets (pair, Sports Tourer only)
- Rain-sensitive windscreen wipers
- Electrically operated front and rear windows
- Electrically adjustable/heated power folding door mirrors with puddle light
- Soundproofed insulated windscreen
- Driver's ergonomic active seat (AGR approved\*)
- Heated sports-style front seats
- Paddle shift
- Front centre armrest with cup holder
- Centre rear seat armrest and load-through facility
- Frameless automatic anti-dazzle rear-view mirror
- Remote control security alarm system
- Keyless entry and start
- Intelli-Space (Sports Tourer only. See Versatility page for more information)

### Styling

- Sports-style front and rear bumpers
- 17-inch black alloy wheels
- Black Griffin logo and vizor frame
- Black lower window moulding
- Dark-tinted rear windows
- Black roof
- Black headliner
- Alloy-effect sports pedals

\*AGR (The Campaign for Healthier Backs) is an independent centre of excellence for ergonomics, based in Germany.



# All-new Astra Ultimate Plug-in Hybrid

VX\_AST\_PHEV\_33853



Ultimate

OTR from £40,400

PureSense

- IntelliLux adaptive LED® pixel headlights and LED tail lights
- LED daytime running lights
- LED front fog lights
- High beam assist
- Electronic parking brake
- Front and rear parking distance sensors
- Lane departure warning with lane keep assist
- Traffic sign recognition
- Driver drowsiness alert
- Forward collision alert (all speed)
- Automatic emergency braking with pedestrian detection
- Adaptive cruise control
- Eight airbags
- Hill start assist
- ISOFIX child seat fixings on outer rear seats
- In-crash braking
- Intelli-Vision 360° panoramic parking camera
- Lane change assist with side blind spot alert
- Lane positioning assist
- Rear cross traffic alert

PureConnect

- Multimedia Pure Panel Pro Navigation system
  - 10-inch colour touchscreen
  - 10-inch digital instrument cluster
  - AM/FM/DAB digital radio
  - Bluetooth®
  - Natural voice recognition
  - Wireless Apple CarPlay/Android Auto™
  - 2 x front USB connections
- Eight speakers • Vauxhall Connect
- Intelli-HUD (Head-Up Display)
- Wireless charger for mobile devices

Comfort and Convenience

- Dual-zone electronic climate control with Intelli-Air (air quality sensor)
- Heated perforated flat-bottomed leather-covered steering wheel
- Steering wheel audio/phone/cruise controls
- Interior ambient lighting
- 60/40 split-folding rear seat backs
- Rain-sensitive windscreen wipers
- Electrically operated front and rear windows
- Electrically adjustable/heated power folding door mirrors with puddle light
- Heated soundproofed insulated windscreen
- Heated ergonomic active sports-style front seats (AGR approved\*)
- Paddle shift
- Front centre armrest with cup holder
- Centre rear seat armrest and load-through facility
- Frameless automatic anti-dazzle rear-view mirror
- Alcantara interior seat trim
- Remote control security alarm system
- Keyless entry and start
- Panoramic sunroof

Styling

- Sports-style front and rear bumpers
- 18-inch grey diamond-cut alloy wheels
- Black Griffin logo and vizor frame
- Black lower window moulding
- Dark-tinted rear windows
- Black roof
- Black headliner
- Alloy-effect sports pedals

\*AGR (The Campaign for Healthier Backs) is an independent centre of excellence for ergonomics, based in Germany.



# All-new Astra GSe Plug-in Hybrid

VX\_AST\_GSe\_34206



## GSe OTR from £40,550

### PureSense

- IntelliLux adaptive LED® pixel headlights and LED tail lights
- LED daytime running lights
- LED front fog lights • High beam assist
- Electronic parking brake
- Front and rear parking distance sensors
- Lane departure warning with lane keep assist
- Traffic sign recognition
- Driver drowsiness alert
- Forward collision alert (all speed)
- Automatic emergency braking with pedestrian detection
- Adaptive cruise control
- Eight airbags • Hill start assist
- ISOFIX child seat fixings on outer rear seats
- In-crash braking
- Intelli-Vision 360° panoramic parking camera
- Lane change assist with side blind spot alert
- Lane positioning assist
- Rear cross traffic alert

### PureConnect

- Multimedia Pure Panel Pro Navigation system
  - 10-inch colour touchscreen
  - 10-inch digital instrument cluster
  - AM/FM/DAB digital radio
  - Bluetooth® – Natural voice recognition
  - Wireless Apple CarPlay/Android Auto™
  - 2 x front USB connections
- Six speakers • Vauxhall Connect
- Intelli-HUD (Head-Up Display)
- Wireless charger for mobile devices

### Comfort and Convenience

- Dual-zone electronic climate control with Intelli-Air (air quality sensor)

- Heated perforated flat-bottomed leather-covered steering wheel
- Steering wheel audio/phone/cruise controls
- Interior ambient lighting
- 60/40 split-folding rear seat backs
- Rain-sensitive windscreen wipers
- Electrically operated front and rear windows
- Electrically adjustable/heated power folding door mirrors with puddle light
- Heated soundproofed insulated windscreen
- GSe performance heated front seats (AGR approved\*)
- Paddle shift
- Front centre armrest with cup holder
- Centre rear seat armrest and load-through facility
- Frameless automatic anti-dazzle rear-view mirror
- Alcantara interior seat trim
- Remote control security alarm system
- Keyless entry and start

### Styling

- Unique GSe front and rear bumpers
- 18-inch gloss black bi-colour diamond-cut alloy wheels
- Black Griffin logo and vizor frame
- Black lower window moulding
- Dark-tinted rear windows
- Black roof • Black roof/headliner
- Alloy-effect sports pedals • GSe badge

### Performance

- Sports chassis incorporating:
  - Frequency Selective Damping with bespoke Koni dampers
  - Revised front and rear springs
  - Recalibrated sports steering
- Suspension lowered by 10mm
- Exclusive ESP setting

\*AGR (The Campaign for Healthier Backs) is an independent centre of excellence for ergonomics, based in Germany.



# All-new Astra Design

VX\_AST\_32915



Design

OTR from £25,290

PureSense

- LED headlights and tail lights
- LED daytime running lights
- LED front fog lights
- High beam assist
- Electronic parking brake
- Front and rear parking distance sensors
- Lane departure warning with lane keep assist
- Speed sign recognition
- Driver drowsiness alert
- Forward collision alert (low speed)
- Automatic emergency braking with pedestrian detection
- Cruise control with intelligent speed adaption
- Eight airbags
- Hill start assist
- ISOFIX child seat fixings on outer rear seats
- In-crash braking

PureConnect

- Multimedia Pure Panel Navigation system
  - 10-inch colour touchscreen
  - 10-inch digital instrument cluster
  - AM/FM/DAB digital radio
  - Bluetooth®
  - Natural voice recognition
  - Wireless Apple CarPlay/Android Auto™
  - Front USB connection
- Six speakers
- Vauxhall Connect

Comfort and Convenience

- Electronic climate control
- Flat-bottomed leather-covered steering wheel
- Steering wheel audio/phone/cruise controls
- 60/40 split-folding rear seat backs (Hatchback only)
- 40/20/40 split-folding rear seat backs with remote easy-fold facility (Sports Tourer only)
- Flex load floor with luggage restraining nets (pair, Sports Tourer only)
- Rain-sensitive windscreen wipers
- Electrically operated front and rear windows
- Electrically adjustable/heated door mirrors
- Soundproofed insulated windscreen
- Remote control security alarm system
- Keyless start
- Intelli-Space (Sports Tourer only. See Versatility page for more information)

Styling

- Body-colour front and rear bumpers
- 16-inch silver alloy wheels
- Chrome-effect Griffin logo and vizor frame
- Black lower window moulding



# All-new Astra GS

VX\_AST\_34159



## GS

OTR from £28,185

### PureSense

- LED headlights and tail lights
- LED daytime running lights
- LED front fog lights
- High beam assist
- Electronic parking brake
- Front and rear parking distance sensors
- Lane departure warning with lane keep assist
- Traffic sign recognition
- Driver drowsiness alert
- Forward collision alert (all speed)
- Automatic emergency braking with pedestrian detection
- Adaptive cruise control with intelligent speed adaption
- Eight airbags
- Hill start assist
- ISOFIX child seat fixings on outer rear seats
- In-crash braking
- Intelli-Vision 360° panoramic parking camera

### PureConnect

- Multimedia Pure Panel Pro Navigation system
  - 10-inch colour touchscreen
  - 10-inch digital instrument cluster
  - AM/FM/DAB digital radio
  - Bluetooth®
  - Natural voice recognition
  - Wireless Apple CarPlay/Android Auto™
  - 2 x front USB connections
- Six speakers
- Vauxhall Connect

### Comfort and Convenience

- Dual-zone electronic climate control
- Heated perforated flat-bottomed leather-covered steering wheel

- Steering wheel audio/phone/cruise controls
- Interior ambient lighting
- 60/40 split-folding rear seat backs (Hatchback only)
- 40/20/40 split-folding rear seat backs with remote easy-fold facility (Sports Tourer only)
- Flex load floor with luggage restraining nets (pair, Sports Tourer only)
- Rain-sensitive windscreen wipers
- Electrically operated front and rear windows
- Electrically adjustable/heated power folding door mirrors with puddle light
- Soundproofed insulated windscreen
- Driver's ergonomic active sports-style seat (AGR approved\*)
- Heated front seats
- Paddle shift (auto models only)
- Front centre armrest with cup holder
- Centre rear seat armrest and load-through facility
- Flex load floor
- Frameless automatic anti-dazzle rear-view mirror
- Remote control security alarm system
- Keyless entry and start
- Intelli-Space (Sports Tourer only. See Versatility page for more information)

### Styling

- Sports-style front and rear bumpers
- 17-inch black alloy wheels
- Black Griffin logo and vizor frame
- Black lower window moulding
- Dark-tinted rear windows
- Black roof
- Black headliner
- Alloy-effect sports pedals

\*AGR (The Campaign for Healthier Backs) is an independent centre of excellence for ergonomics, based in Germany.



# All-new Astra Ultimate

VX\_AST\_32919



## Ultimate OTR from £31,300

### PureSense

- IntelliLux adaptive LED® pixel headlights and LED tail lights
- LED daytime running lights
- LED front fog lights
- High beam assist
- Electronic parking brake
- Front and rear parking distance sensors
- Lane departure warning with lane keep assist
- Traffic sign recognition
- Driver drowsiness alert
- Forward collision alert (all speed)
- Adaptive cruise control
- Automatic emergency braking with pedestrian detection
- Eight airbags
- Hill start assist
- ISOFIX child seat fixings on outer rear seats
- In-crash braking
- Intelli-Vision 360° panoramic parking camera
- Lane change assist with side blind spot alert
- Lane positioning assist
- Rear cross traffic alert

### PureConnect

- Multimedia Pure Panel Pro Navigation system
  - 10-inch colour touchscreen
  - 10-inch digital instrument cluster
  - AM/FM/DAB digital radio
  - Bluetooth®
  - Natural voice recognition
  - Wireless Apple CarPlay/Android Auto™
  - 2 x front USB connections
- Eight speakers • Vauxhall Connect
- Intelli-HUD (Head-Up Display)
- Wireless charger for mobile devices

### Comfort and Convenience

- Dual-zone electronic climate control with Intelli-Air (air quality sensor)
- Heated perforated flat-bottomed leather-covered steering wheel
- Steering wheel audio/phone/cruise controls
- Interior ambient lighting
- 60/40 split-folding rear seat backs
- Rain-sensitive windscreen wipers
- Electrically operated front and rear windows
- Electrically adjustable/heated power folding door mirrors with puddle light
- Heated soundproofed insulated windscreen
- Heated ergonomic active sports-style front seats (AGR approved\*)
- Paddle shift (auto models only)
- Front centre armrest with cup holder
- Centre rear seat armrest and load-through facility
- Flex load floor
- Frameless automatic anti-dazzle rear-view mirror
- Alcantara interior seat trim
- Remote control security alarm system
- Keyless entry and start
- Panoramic sunroof

### Styling

- Sports-style front and rear bumpers
- 18-inch grey diamond-cut alloy wheels
- Black Griffin logo and vizor frame
- Black lower window moulding
- Dark-tinted rear windows
- Black roof
- Black headliner
- Alloy-effect sports pedals

\*AGR (The Campaign for Healthier Backs) is an independent centre of excellence for ergonomics, based in Germany.





# All-new Astra Hatchback Plug-in Hybrid Prices

	LCDV Code	Fuel Type	Price (£)	VAT (£)	Total (£)	On-the-road RRP (£)	Financial Year 2022/23 BiK 20% (£)	WLTP Combined CO <sub>2</sub> (g/km)* - LCDV Code	Insurance Groups
<b>GS</b>									
1.6 (180PS) Turbo/Electric auto	1GO5A5TR8AT0AOCO	Petrol/Electric	30,400.01	6,079.99	36,480.00	<b>37,285.00</b>	49.64	23	26E
<b>Ultimate</b>									
1.6 (180PS) Turbo/Electric auto	1GO5A5VR8AT0AOCO	Petrol/Electric	32,995.84	6,599.16	39,595.00	<b>40,400.00</b>	53.79	24	28E
<b>GSe</b>									
1.6 (225PS) Turbo/Electric auto	1GO5A5ZR7AT0AOCO	Petrol/Electric	33,120.83	6,624.17	39,745.00	<b>40,550.00</b>	53.99	25	31E

# All-new Astra Sports Tourer Plug-in Hybrid Prices

	LCDV Code	Fuel Type	Price (£)	VAT (£)	Total (£)	On-the-road RRP (£)	Financial Year 2022/23 BiK 20% (£)	WLTP Combined CO <sub>2</sub> (g/km)* - LCDV Code	Insurance Groups
<b>GS</b>									
1.6 (180PS) Turbo/Electric auto	1GO5C5TR8AT0AOCO	Petrol/Electric	31,400.01	6,279.99	37,680.00	<b>38,485.00</b>	51.24	23	27E



WLTP Combined CO<sub>2</sub> (g/km) figures are based on a configured vehicle as per LCDV code for UK with no options fitted.

\*Fuel consumption and CO<sub>2</sub> figures are determined according to the WLTP test cycle. CO<sub>2</sub> figures, BiK values and RRP pricing shown above are for a standard vehicle without any additional optional equipment. CO<sub>2</sub> figures are used to calculate Vehicle Excise Duty (VED) for the first registration of the vehicle and BiK. The addition of optional extras could increase the certified CO<sub>2</sub> emission output. This in turn may affect the amount of VED payable upon registration, and, for company car drivers, the PIID value and the amount of Benefit in Kind (BiK) tax payable. Figures shown are for comparison purposes and should only be compared to the fuel consumption and CO<sub>2</sub> values of other cars tested to the same technical standard. The fuel consumption achieved, and CO<sub>2</sub> produced, in real world conditions will depend upon a number of factors including, but not limited to: the accessories fitted (pre and post registration); variations in weather; driving styles and vehicle load. The WLTP (Worldwide Harmonised Light Vehicles Test Procedure) is used to measure fuel consumption and CO<sub>2</sub> figures. Full data relating to WLTP test cycles can be found at: [www.vauxhall.co.uk/wltp](http://www.vauxhall.co.uk/wltp)

**Please note:** On-the-road recommended retail prices (RRP) include number plates and delivery to Retailer of £750.00 (inc. £125.00 VAT), 12 months' Vehicle Excise Duty and new vehicle first registration fee of £55.00. Excludes fuel and insurance. Company Car Benefit in Kind (BiK) rates are monthly based on the standard paint price.



# All-new Astra Hatchback Prices

	LCDV Code	Fuel Type	Price (£)	VAT (£)	Total (£)	On-the-road RRP (£)	Financial Year 2022/23 BiK 20% (£)	WLTP Combined CO <sub>2</sub> (g/km)* - LCDV Code	Insurance Groups
Design									
1.2 (110PS) Turbo	1GO5A5LL5KTOAOCO	Petrol	20,245.84	4,049.16	24,295.00	25,290.00	121.05	123	16E
1.2 (130PS) Turbo	1GO5A5LM6KTOAOCO	Petrol	20,745.84	4,149.16	24,895.00	25,890.00	123.95	123	17E
1.2 (130PS) Turbo auto	1GO5A5LM61TOAOCO	Petrol	21,995.84	4,399.16	26,395.00	27,390.00	135.73	125	18E
1.5 (130PS) Turbo D auto	1GO5A5LP41TOAOCO	Diesel	22,829.17	4,565.83	27,395.00	28,390.00	140.73	127	19E
GS									
1.2 (130PS) Turbo	1GO5A5TM6KTOAOCO	Petrol	22,658.34	4,531.66	27,190.00	28,185.00	139.70	125	19E
1.2 (130PS) Turbo auto	1GO5A5TM61TOAOCO	Petrol	23,908.34	4,781.66	28,690.00	29,685.00	147.20	127	18E
1.5 (130PS) Turbo D auto	1GO5A5TP41TOAOCO	Diesel	24,741.67	4,948.33	29,690.00	30,685.00	152.20	129	20E
Ultimate									
1.2 (130PS) Turbo	1GO5A5VM6KTOAOCO	Petrol	25,254.17	5,050.83	30,305.00	31,300.00	155.28	128	20E
1.2 (130PS) Turbo auto	1GO5A5VM61TOAOCO	Petrol	26,504.17	5,300.83	31,805.00	32,840.00	168.20	131	20E
1.5 (130PS) Turbo D auto	1GO5A5VP41TOAOCO	Diesel	27,337.51	5,467.49	32,805.00	33,840.00	173.37	132	21E

All-new Astra’s petrol and diesel engines meet the Real Driving Emissions Step 2 (RDE2) standards.

WLTP Combined CO<sub>2</sub> (g/km) figures are based on a configured vehicle as per LCDV code for UK with no options fitted.

\*Fuel consumption and CO<sub>2</sub> figures are determined according to the WLTP test cycle. CO<sub>2</sub> figures, BiK values and RRP pricing shown above are for a standard vehicle without any additional optional equipment. CO<sub>2</sub> figures are used to calculate Vehicle Excise Duty (VED) for the first registration of the vehicle and BiK. The addition of optional extras could increase the certified CO<sub>2</sub> emission output. This in turn may affect the amount of VED payable upon registration, and, for company car drivers, the PIID value and the amount of Benefit in Kind (BiK) tax payable. Figures shown are for comparison purposes and should only be compared to the fuel consumption and CO<sub>2</sub> values of other cars tested to the same technical standard. The fuel consumption achieved, and CO<sub>2</sub> produced, in real world conditions will depend upon a number of factors including, but not limited to: the accessories fitted (pre and post registration); variations in weather; driving styles and vehicle load. The WLTP (Worldwide Harmonised Light Vehicles Test Procedure) is used to measure fuel consumption and CO<sub>2</sub> figures. Full data relating to WLTP test cycles can be found at: [www.vauxhall.co.uk/wltp](http://www.vauxhall.co.uk/wltp)

**Please note:** On-the-road recommended retail prices (RRP) include number plates and delivery to Retailer of £750.00 (inc. £125.00 VAT), 12 months’ Vehicle Excise Duty and new vehicle first registration fee of £55.00. Excludes fuel and insurance. Company Car Benefit in Kind (BiK) rates are monthly based on the standard paint price.





# All-new Astra Sports Tourer Prices

	LCDV Code	Fuel Type	Price (£)	VAT (£)	Total (£)	On-the-road RRP (£)	Financial Year 2022/23 BiK 20% (£)	WLTP Combined CO <sub>2</sub> (g/km)* - LCDV Code	Insurance Groups
Design									
1.2 (110PS) Turbo	1GO5C5LL5KT0A0CO	Petrol	21,245.84	4,249.16	25,495.00	<b>26,490.00</b>	131.23	125	16E
1.2 (130PS) Turbo	1GO5C5LM6KT0A0CO	Petrol	21,745.84	4,349.16	26,095.00	<b>27,090.00</b>	134.23	126	18E
1.2 (130PS) Turbo auto	1GO5C5LM61T0A0CO	Petrol	22,995.84	4,599.16	27,595.00	<b>28,590.00</b>	141.73	128	19E
1.5 (130PS) Turbo D auto	1GO5C5LP41T0A0CO	Diesel	23,829.17	4,765.83	28,595.00	<b>29,590.00</b>	146.73	129	19E
GS									
1.2 (130PS) Turbo	1GO5C5TM6KT0A0CO	Petrol	23,658.34	4,731.66	28,390.00	<b>29,385.00</b>	145.70	128	19E
1.2 (130PS) Turbo auto	1GO5C5TM61T0A0CO	Petrol	24,908.34	4,981.66	29,890.00	<b>30,885.00</b>	158.31	130	19E
1.5 (130PS) Turbo D auto	1GO5C5TP41T0A0CO	Diesel	25,741.67	5,148.33	30,890.00	<b>31,925.00</b>	163.47	131	20E

All-new Astra’s petrol and diesel engines meet the Real Driving Emissions Step 2 (RDE2) standards.

WLTP Combined CO<sub>2</sub> (g/km) figures are based on a configured vehicle as per LCDV code for UK with no options fitted.

\*Fuel consumption and CO<sub>2</sub> figures are determined according to the WLTP test cycle. CO<sub>2</sub> figures, BiK values and RRP pricing shown above are for a standard vehicle without any additional optional equipment. CO<sub>2</sub> figures are used to calculate Vehicle Excise Duty (VED) for the first registration of the vehicle and BiK. The addition of optional extras could increase the certified CO<sub>2</sub> emission output. This in turn may affect the amount of VED payable upon registration, and, for company car drivers, the PIID value and the amount of Benefit in Kind (BiK) tax payable. Figures shown are for comparison purposes and should only be compared to the fuel consumption and CO<sub>2</sub> values of other cars tested to the same technical standard. The fuel consumption achieved, and CO<sub>2</sub> produced, in real world conditions will depend upon a number of factors including, but not limited to: the accessories fitted (pre and post registration); variations in weather; driving styles and vehicle load. The WLTP (Worldwide Harmonised Light Vehicles Test Procedure) is used to measure fuel consumption and CO<sub>2</sub> figures. Full data relating to WLTP test cycles can be found at: [www.vauxhall.co.uk/wltp](http://www.vauxhall.co.uk/wltp)

**Please note:** On-the-road recommended retail prices (RRP) include number plates and delivery to Retailer of £750.00 (inc. £125.00 VAT), 12 months’ Vehicle Excise Duty and new vehicle first registration fee of £55.00. Excludes fuel and insurance. Company Car Benefit in Kind (BiK) rates are monthly based on the standard paint price.



# PureSense

Model specific features are outlined in the separate tabular information



## 1. Automatic emergency braking with pedestrian detection

Front camera system monitors the traffic situation in front of the vehicle using the front camera to detect mobile and fixed cars as well as adult pedestrians. The system first warns you through a series of visual and audible alerts and should you not react quickly enough, will automatically brake the vehicle to avoid or mitigate the impact of front-end collisions.\*

\*Cycles, motorcycles, animals and other objects are not detected.

## Front camera and radar system – Standard on Ultimate models only

Adds radar-based technology, enabling you to avoid or mitigate the impact of front-end collisions by detecting fixed and mobile objects, such as cycles and pedestrians. The system will even bring the vehicle to a complete standstill when driving under 30mph in traffic.

## 2. Lane departure warning with lane keep assist

If the driver has not actively steered or signalled, the lane departure warning system warns when the car moves outside of lane markings at speeds above 37mph.

## 3. Driver drowsiness alert

The system monitors driving time and driving behaviour to help prevent accidents caused by tiredness.

## 4. Adaptive cruise control

Adaptive cruise control uses the radar system to adjust the vehicle's speed to maintain a safe distance from the vehicle ahead, up to the speed limit set.

## 5. Cruise control with intelligent speed adaption

With steering wheel mounted controls. Enables you to maintain a constant speed, making it ideal for economical motorway driving.





Model specific features are outlined in the separate tabular information



1. Speed sign recognition

Detects and then displays speed limits, reducing uncertainty and the risk of speeding.

Extended traffic sign recognition (not illustrated)

This system is an evolution of standard speed sign recognition. As well as speed signs, it recognises most other traffic signs by using the front camera and displays them on the driver information cluster within the Pure Panel.

Intelli-Drive 1.0 (Includes following three features):

2. Lane change assist with side blind spot alert

This system is radar-based and uses ultrasonic rear bumper sensors to detect a vehicle in your blind spot.

3. Lane positioning assist

This works as a semi-automatic system that helps you integrate into a motorway lane, follow a particular lane, or follow a vehicle ahead. Engaged at the touch of a button.

4. Rear cross traffic alert

Rear cross traffic alert is radar-based and uses rear bumper sensors to detect moving objects to the rear sides of the vehicle when reversing. The system is able to detect cars, trucks, motorcycles, bicycles and pedestrians.

5. Intelli-Vision

Intelli-Vision is a video assistance function for all low-speed manoeuvres. It uses four cameras (front/rear/lateral in door mirrors) and is activated automatically when the car is put into reverse.

6. Keyless entry and start

Simply get in and start the engine without having to find the keys.



Model specific features are outlined in the separate tabular information



1. IntelliLux adaptive LED® pixel headlights

With 84 segments per headlight, the latest IntelliLux adaptive LED® pixel system offers improved visibility that helps make night time driving significantly safer.

2. Anti-glare beam

Anti-glare beam is an advanced full beam that controls independent units of the IntelliLux adaptive LED® pixel headlights.

3. Eco LED headlights with high beam assist

ECO LED headlights with high beam assist are standard on all Astras. The system will detect both ambient light and vehicle specific light for oncoming and leading traffic. Depending on the lighting level, the system automatically switches between high and low beam.

4. Energy saving mode

Energy saving mode switches the cornering lights on and off in conjunction with the Start/Stop System.

5. Tourist mode

Tourist mode decreases the beam intensity and is designed for driving in countries where traffic drives on the other side the road.

6. Adverse weather

The low beam distribution is optimized, to reduce the potential glare to oncoming traffic in wet road conditions.

7. Manoeuvring mode

Manoeuvring mode provides extra light around the vehicle and is designed for parking and reversing.

Adaptive Motorway mode

Motorway mode recognizes whether the vehicle is on a motorway and responds by adapting the headlights for optimum night-time motorway driving (not illustrated).





Model Specific Features

	Plug-in Hybrid models					
	GS	Ultimate	GSe	Design	GS	Ultimate
Driver Assistance						
Automatic emergency braking with pedestrian detection	●	●	●	●	●	●
Cruise control with intelligent speed adaptation	●	●	●	●	●	●
Driver drowsiness alert	●	●	●	●	●	●
Lane departure warning with lane keep assist	●	●	●	●	●	●
Electronic parking brake	●	●	●	●	●	●
Front and rear parking distance sensors	●	●	●	●	●	●
Speed sign recognition	●	●	●	●	●	●
Extended traffic sign recognition	●	●	●		●	●
Intelli-Vision 360° panoramic parking camera	●	●	●		●	●
Adaptive cruise control	●	●	●		●	●
Intelli-HUD (Head-Up Display)		●	●			●
Intelli-Drive 1.0 – Lane change assist with side blind spot alert/ Lane positioning assist/Rear cross traffic alert		●	●			●
Exterior Lighting						
LED headlights, front fog and tail lights	●	●	●	●	●	●
High beam assist	●	●	●	●	●	●
LED daytime running lights	●	●	●	●	●	●
Automatic lighting control	●	●	●	●	●	●
IntelliLux adaptive LED® pixel headlights		●	●			●



PureConnect

Model specific features are outlined in the following pages

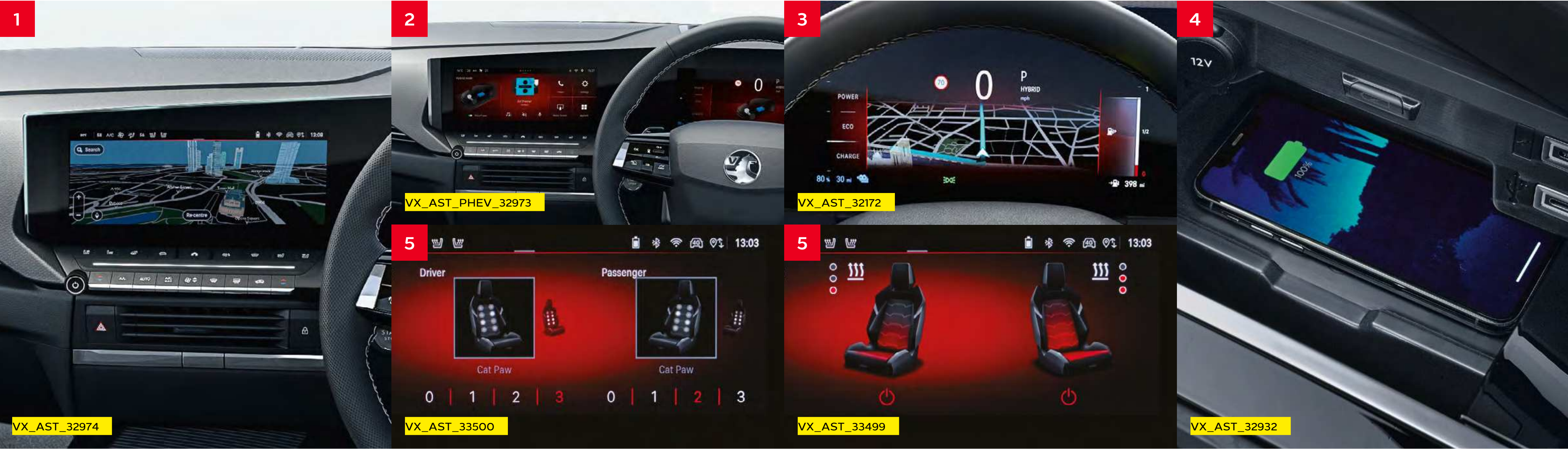

**1. Natural voice recognition\***  
Works with ‘wake-up’ command ‘Hey Vauxhall’ to control the following functions:

- Satellite navigation commands
- Phone connectivity functions
- Choice of music playback
- Operation of electronic climate control

**Personalisation**  
The new Pure Panel features a smartphone-like user interface with virtual shortcuts, driver recognition via smartphone and advanced profile management.

**2. Central display**  
The app wall on the 10-inch infotainment touchscreen provides direct access to the main domains such as electronic climate control, navigation, radio, phone, seat and mirror configuration.

**2. Wireless smartphone interface**  
Wireless smartphone projection that allows operations via voice command, touchscreen and buttons to control apps and music playback with Apple CarPlay and Android Auto™ compatibility.

**3. Instrument cluster**  
The driver can customise the content shown on the fully digital 10-inch driver information cluster by selecting via the left stalk. In addition pop-ups such as receiving calls and alerts can be displayed.

**4. Inductive wireless smartphone charger – Standard on Ultimate models only**  
Smartphones can be charged inductively on the charging pad in the front of the centre console.

**5. AGR front seats\*\***  
The AGR label confirms that the new Astra’s ergonomically certified AGR seats meet even the highest levels of comfort. And included with the Leather option on Ultimate models 3-stage seat heating, massage function and seat ventilation. The option also features a driver’s seat adjustment with memory function.

\*Natural voice recognition services are included free for 3 years and thereafter are subject to an additional subscription fee. \*\*AGR (The Campaign for Healthier Backs) is an independent centre of excellence for ergonomics, based in Germany.



**Standard Pure Panel Features** – The following features are standard across the entire all-new Astra range.

**Pure Panel Digital Display**

Pure Panel technology makes driving more intuitive, with a flowing design that presents the information you need. With a 10-inch infotainment colour touchscreen and 10-inch digital instrument cluster right in front of you, you can stay focused on the road ahead.

**Pure Panel Pro Digital Display**

- Features a Multimedia system with 10-inch infotainment colour touchscreen and full digital 10-inch driver information cluster with edge-to-edge glass finish. Standard on GS and Ultimate

**EV information display**

- Powerflow display – Informs drivers on the current state of charge and what is being used as the power source, petrol or electric
- Charge display – displays an image of the charge port with the corresponding LED charge indication lights
- e-Save – enables the driver to determine how much battery energy needs to be conserved to ensure that the vehicle reaches its destination when in a zero emission zone  
There are three options:
  - 6 mile range reserve
  - 12 mile range reserve
  - Maximum reserve
- Statistics – The Statistics display the average consumption data over a period of time using colour coded graphs
- **Green:** Energy recovered by braking phases and partial recharging by the petrol engine (kWh/mile)
- **Blue:** Energy consumed by the vehicle directly by the battery (kWh/mile)
- **Orange:** Fuel consumption (mpg)

**Digital instrumentation**

- Digital speedometer and rev counter
- Satellite Navigation display
- Digital fuel gauge with low fuel level warning light
- Digital water temperature gauge with warning light
- Shift-up/down indication light – Indicates when to change gear for optimum fuel economy

**Driver information display**

**(centrally located in digital instrument cluster)**

- Total mileage
- Service-due indicator
- Oil life
- Tyre pressure monitoring system

**Multi-function trip computer**

**(displayed on digital instrument cluster)**

- Trip mileage
- Vehicle range based on remaining fuel
- Average speed
- Average fuel economy
- Instantaneous fuel economy
- Driving time

**Digital central facia display**

- Audio information
- Digital clock with automatic RDS time adjustment
- Outside air temperature with ice warning function

**Intelli-HUD (Head-Up Display) – Ultimate and GSe models only**

The innovative Intelli-HUD head-up display projects the essential driving information onto the windscreen, in the driver's field of vision. Thanks to its resolution and its wide projection size, it gives a more realistic view of the information. The Intelli-HUD can display different pages linked to the instrument panel in order to share the displayed information on both screens. The pages can be selected via the left stalk. Pop-ups such as media, alerts, receiving calls and phone book can be displayed independently.



Pure Panel Pro digital display.

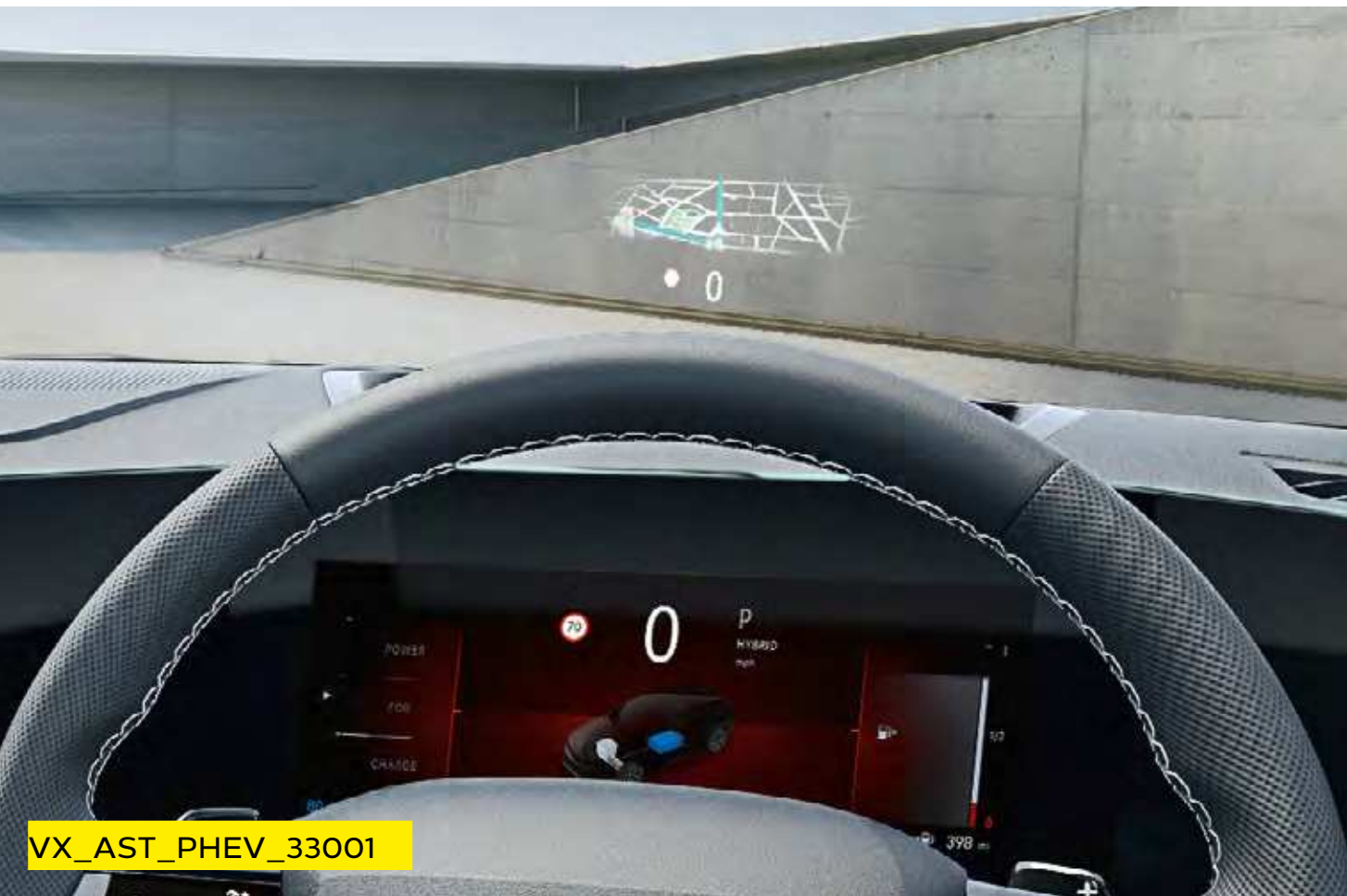

Intelli-HUD (Head-Up Display).



Standard Infotainment Features – The following features are standard across the entire all-new Astra range.

Onboard features

- Satellite navigation system with natural voice recognition
- 2D/3D street level mapping
- European coverage
- Points-of-interest search
- Map updates via USB
- DAB Digital radio
- RDS with Traffic Programme
- AM/FM stereo radio with 36 station presets
- Six speakers
- Customizable screen adaption with enhanced profile management and driver recognition
- Heating, Ventilation and Air Conditioning (HVAC) user interface
- Over-the-air updates (e.g. for software)
- WiFi updates (e.g. content download)

Media connections

- USB connection with iPod control
- Bluetooth® A2DP audio streaming (Advanced Audio Distribution Profile)

Mobile phone portal

- Bluetooth® connectivity
- Vehicle microphone
- Handsfree calls via steering wheel controls
- Phone book access – Contacts/last calls/missed calls etc are mirrored on the display and are easily navigated using the touchscreen (features dependent on mobile phone)
- SMS read out and reply

Additional features

- Steering wheel mounted audio controls
- Shark fin aerial

Drive Smart

- Live navigation provided by TomTom® services (subscription free for three years and subject to fee thereafter)
- Real time traffic news
- Parking prices and availability
- Weather information
- Natural voice recognition
- Fuel prices
- Charging station search
- Quick search for addresses and points of interest
- Road safety alerts

For further details and terms and conditions see separate Vauxhall Connect page.



Digital infotainment display.



Satellite Navigation display.

Please note that compatibility and certain functions may be different depending on the type of device and operating system you're using with the Multimedia systems. Apple CarPlay is a trademark of Apple Inc. Apple and iPhone are trademarks of Apple Inc., registered in the U.S. and other countries. Android is a trademark of Google Inc, also registered in the U.S. and other countries. Services may require a subscription/fee and are subject to mobile network coverage and availability. Live navigation and natural voice recognition services are included for 3 years and thereafter are subject to an additional subscription fee.



# Vauxhall Connect

**Standard Features** – Vauxhall Connect\* is the new way to stay connected while on the road. Smart technology systems and related services keep our drivers safe and provide an exciting, efficient yet safe trip. Activating Vauxhall Connected Services is easy, just visit Vauxhall Connect Store or download MyVauxhall app.

## Peace of mind

- Emergency call (SOS e-call)
- Breakdown call (b-call)
- Vehicle status and information\*\*
- Maintenance alerts, fuel level, average fuel consumption and mileage



### Vauxhall SOS

In the event of a breakdown or accident, you can count on Vauxhall Connect as your car has its own SIM card installed. If something happens that means there may have been an accident – say, the airbags are inflated or the pre-tensioners on the seatbelts are activated – an automatic message will go off to the emergency services, with details of your location. Vauxhall Connect SOS can be activated manually too – just press the button and you’ll be put straight through to the emergency services on the system’s integrated phone. So, if you have an accident, or see one, it only takes a few seconds to call for help.

Got a problem with your car but don’t need the emergency services? Just press the Vauxhall Connect Assistance button and you’ll be connected to our control centre over the system’s integrated phone.

## Convenience

- E-remote control (Plug-in Hybrid only)\*\*
- Remote check of battery level, programming and charge management
- Pre-conditioning of vehicle temperature



### E-remote

Check and manage your electric/hybrid vehicle range remotely and in real time using your smartphone. With MyVauxhall you can check the charge and range of your vehicle at any time, and if you’re plugged into a charging point, you’re even able to control charging when you’re far away. To offer peace of mind, you can be alerted when the battery is full or the charging is interrupted.

The remote pre-conditioning feature allows you to warm or cool the vehicle to an optimal temperature before starting your journey. With your comfort in mind, this feature allows you to maximise range if your vehicle is on charge, by taking energy from the source, rather than the battery.

This service is supplied free of charge by Vauxhall for the life of the vehicle.

## Drive Smart

- Live navigation† (subscription included for three years) with on-line traffic, fuel prices and parking information, Points Of Interest (POI) search and weather
- Trip and drive management\*\*
- Timestamping of trips, trip details, last vehicle position, guide-to-car and more



### Live Navigation Plus†

Vauxhall’s fully integrated navigation system helps you stay informed, providing real-time information from the leading European GPS provider, TomTom®. It can be operated using natural voice recognition, meaning your eyes need never leave the road.

Vauxhall Live Navigation Plus is included free of charge for three years and can then be renewed at a cost.

- TomTom® services
- Real time traffic news
- Parking prices and availability
- Weather forecast on your journey
- Natural voice control
- Fuel prices at petrol stations
- Search for charging stations
- Quick search for addresses and points of interest
- Road safety alerts

\*Subject to subscription – after you have taken delivery of your vehicle, please subscribe on: [connect.vauxhall.co.uk](https://connect.vauxhall.co.uk) \*\*via MyVauxhall App. †Additional terms and conditions apply to connected services, including customer acceptance of location sharing prior to activation.



# PureEnergy

Model specific features are outlined in the following pages

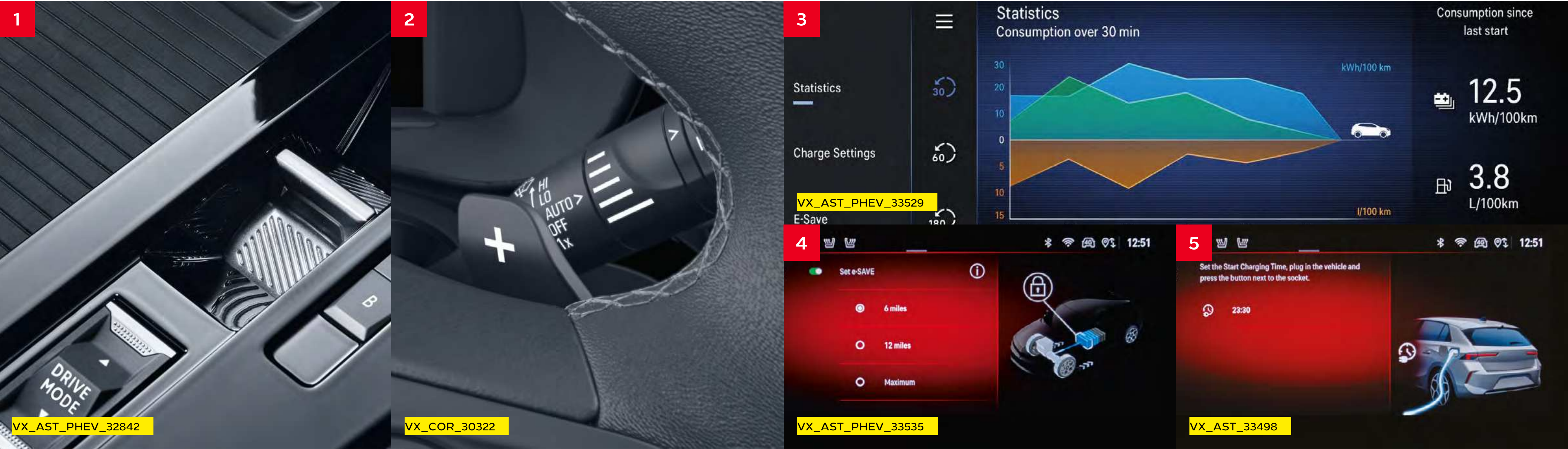

## 1. Electrified transmission

The e-EAT8 electrified 8-speed automatic transmission system is standard on the Astra Plug-in Hybrid and offers smooth transition between gears. It features:

- A multi-disc wet clutch, replacing the torque convertor
- Permanent electric motor that transforms electric energy into mechanical drive energy
- Electric motor installed into the gearbox and petrol engine
- Electric motor adds an additional electric power of 81.2kW (110PS) and makes a torque of 320Nm for 10 seconds

## 2. Paddle shift

All-new Astra automatic customers can also experience a more involving driving experience by using the paddle shift levers integrated into the steering wheel; a feature normally found on larger executive sports models.

## 3/4. Hybrid information displays

All Plug-in-hybrid-specific data is displayed in the infotainment system and can be accessed using the special 'EV' button on the infotainment system. The EV app includes the following submenus:

- Flow
- Statistics
- E-save

## 5. Electric vehicle services

Electric vehicle services, such as thermal preconditioning and battery charging functions, are available not just with the MyVauxhall app, but also through the infotainment system in certain cases.



# PureEnergy – GSe

Model specific features are outlined in the following pages



1. All-new Astra GSe

GSe stands for Grand Sport Electric. Athletic good looks build on Vauxhall’s bold and pure design while a driver-focused, bespoke chassis set-up complements the dynamic performance of an electrified 225PS powertrain.



3. Unique GSe chassis set-up

The Astra GSe features a bespoke chassis set up. The ride height has been lowered by 10mm with unique springs and Koni Frequency Selective Damping (FSD) dampers that adapt almost instantly to changes in road conditions and vehicle behaviour. This delivers a more agile and precise handling experience without sacrificing ride quality.

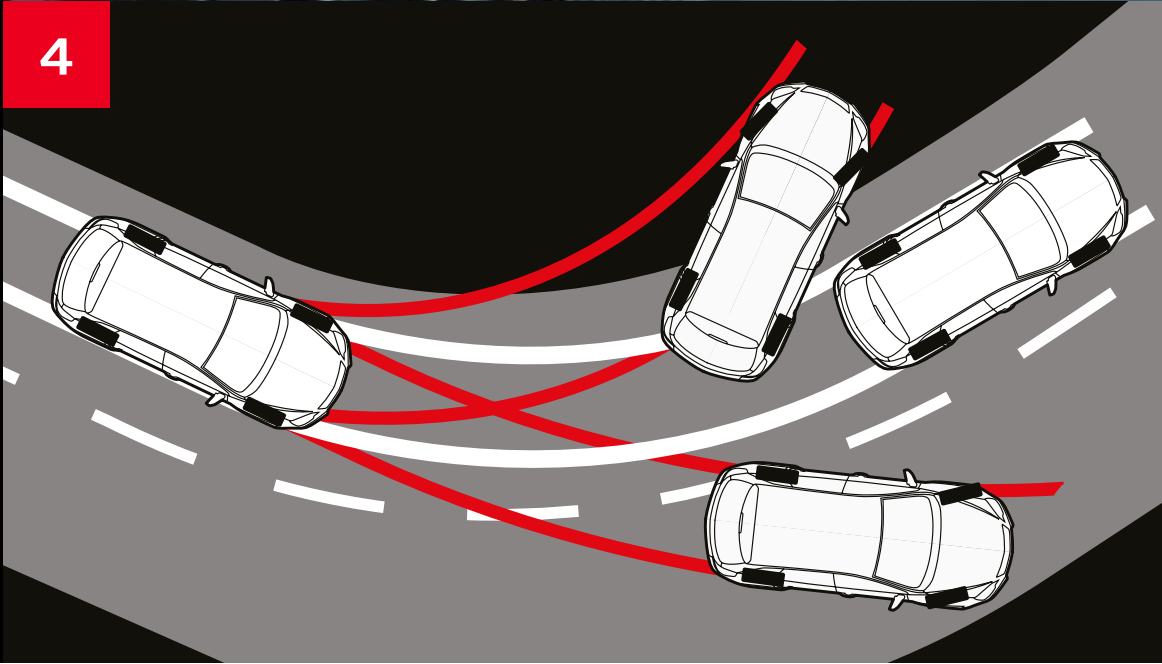

4. Unique ESP settings

Adjustments have also been made to the electronic stability program which monitors the traction control. This enables the system to respond more effectively to cope with the increase in engine power and greater dynamic driving behaviour made possible by the chassis improvements.





Plug-in Hybrid Specifications\*

Electrified Transmission

The 8-speed electrified transmission system is standard and offers both smooth transition between gears. The 8-speed electrified gearbox includes the following content:

- Multi-disc wet clutch replaces removed torque converter
- Permanent electric motor that transforms electric energy into mechanical drive energy
- Electric motor installed into the gearbox and petrol engine
- Comes with intuitive and stylish automatic gearbox with electric shifter with shift paddles

The current driving position is indicated to the driver with a LED between:

- **R:** used for reverse driving
- **N:** used for neutral, allowing the vehicle to be moved with ignition off
- **D:** used for automatic drive, the gearbox change gears without any action from the driver
- **B button:** to switch to regenerative braking

Drive Mode Selector

The Drive Mode selector is positioned next to the automatic gearbox with electric shifter and enables drivers to select one of the following:

- Normal is the default Hybrid mode and offers the best of both worlds between controlled fuel consumption and on-road performance
- Sport mode, draws on the combined power of the engine and motor for a more dynamic drive
- Electric mode activates the electric motor only, for zero CO<sub>2</sub> emissions and complete silence

- **Engine sound enhancement:** In the Sport mode, the engine sound is amplified via the radio speakers depending on input factors such as vehicle speed, engine speed, acceleration, gear and pedal position.

Weights

- Kerbweight: 1678kg Hatchback/ 1703kg GSe Hatchback/1717kg Sports Tourer
- Gross vehicle weight: 2150kg Hatchback/ 2170kg Sports Tourer
- Maximum towing weight:  
Braked trailer 1450kg Hatchback/ 1400kg Sports Tourer (without brakes 750kg)

Charging

- All-new Astra Plug-in Hybrid range comes with a Mode 2 cable and a 3.7kW on-board charger as standard. Includes cable bag at no extra cost
- A 7kW on-board charger can be purchased as an option for £500 inc VAT

This option halves the vehicle charging time when charging with a 7kW wallbox.

Please note: A Mode 2 cable (standard UK socket\*\*) would charge the vehicle in less than 8 hours.

All-new Astra Plug-in Hybrid range charging time examples are listed showing times dependant on the various powers of charge point which the vehicle is plugged into.

Charging		
Supply	Socket	Charge Time (0-100%)
AC current - Domestic 3 pin socket (2.3kW)	Type 2	5h 30m
AC current - Home wallbox or public charger (3.6kW)	Type 2	3h 30m
AC current - Home wallbox or public charger (7kW) <sup>†</sup>	Type 2	1h 55m



Preliminary data determined according to WLTP test procedure methodology. EU type approval and Certificate of Conformity are not yet available. Preliminary values may differ from official final type approval data. Charging rate depends on power source and charging cable used.  
\*Provisional data. \*\*Only use a domestic electrical socket that has been checked by a qualified electrician and is protected by a circuit breaker adapted to the amperage of the electrical circuit. <sup>†</sup>Requires optional 7kW on board charger.





Plug-in Hybrid Specifications

Petrol Engine	1.6 (180PS)	1.6 (225PS)
Maximum power	150PS (110kW) @ 6000rpm	180PS (133kW) @ 6000rpm
Combined power	180PS (133kW) @ 6000rpm	225PS (165kW) @ 6000rpm
Maximum torque	250Nm (184lb.ft.) @ 1750rpm	250Nm (184lb.ft.) @ 1750rpm
Combined torque	360Nm (265lb.ft.) @ 6000rpm	360Nm (265lb.ft.) @ 6000rpm
Combined CO <sub>2</sub> emissions (WLTP)#	23–24g/km	25g/km
Combined fuel economy (WLTP)#	256 mpg (1.1 l/100km)	256 mpg (1.1 l/100km)
Combined maximum speed	140mph	146mph
0–62mph	7.7 secs	7.5 secs
Configuration	4 cylinders, 4 valves per cylinder, double overhead camshafts	
Fuel/induction system	Turbocharger. Variable Valve Timing. Common rail direct injection	
Emission compliance	Euro 6.4	
Service interval	20,000 miles or 1 year (whichever occurs sooner)	

Convenience

- E-remote control
- Remote check of battery level, programming and charge management
- Pre-conditioning of vehicle temperature

For further details and terms and conditions see separate Vauxhall Connect page.

Please note, EV range assumes that vehicle has been pre-conditioned prior to journey. This function can be accessed via MyVauxhall App or Infotainment system.

Electric Motor	1.6 (180PS)	1.6 (225PS)
Maximum power	110hp (81kW) @ 2500rpm	110hp (81kW) @ 2500rpm

Battery	1.6 (180PS)	1.6 (225PS)
Battery capacity	12.4kWh	12.4kWh
AC on-board charger speed (standard)	3.7kW	3.7kW
Equivalent All Electric Range – EAER (WLTP high)#	up to 42 miles	up to 40 miles
Energy consumption (WLTP combined)	16kWh/100km	16kWh/100km
Battery warranty	8 years/100,000 miles/70% capacity	



These figures were obtained using a combination of battery power and fuel. The all-new Astra Plug-in Hybrid requires mains electricity for charging.

#WLTP Figures shown are for comparison purposes and should only be compared to the fuel consumption, CO<sub>2</sub> values and electric range of other cars tested to the same technical standard. The fuel consumption and electric range achieved, and CO<sub>2</sub> produced, in real world conditions will depend upon a number of factors including, but not limited to: the accessories fitted (pre and post registration); charging frequency; battery condition; variations in weather; driving styles and vehicle load. For more information contact your local Vauxhall Retailer.



# Comfort and Convenience

Model specific features are outlined in the separate tabular information



## 1. Cool and in control

Electronic climate control is standard on all-new Astra's with dual-zone and Intelli-Air features available. Filters help to keep allergy-causing pollens and bad smells out. A multizone sun sensor adjusts to sunlight intensity and keeps the entire cabin at a steady temperature, whatever the weather outside. It's safer, too: controlled particle air recirculation prevents windows from fogging up for improved visibility.

## 2. Intelli-Air with air quality sensor

Intelli-Air provides an automatic cabin air exchange when detecting a poor quality atmosphere. The system combines a high-efficiency filter with an air quality sensor that constantly monitors the air quality. The system also provides accurate cabin information through the central Pure Panel display.

## 3. Storage solutions

There's space for everything inside all-new Astra, with storage in all the right places, featuring 60/40 split folding rear seat backs on Hatchback and 40/20/40 on Sports Tourer models. Both with a foldable armrest and cup holders.

## 4. Heated front seats and steering wheel

Driver and front passenger seats heat in three stages for a more efficient alternative to climate control – and a driving experience to look forward to.

## 5. Heated rear seats

Heated outer rear seat cushions are also available as part of the leather option on Ultimate models. These operate through separate dials and in three stages.

## 6. Heated windscreen

Kiss goodbye to early morning ice scraping with a handy heated windscreen. Pair it with heated front seats and steering wheel, and it's smiles all round.





Model Specific Features

Model Specific Features	Plug-in Hybrid models					
	GS	Ultimate	GSe	Design	GS	Ultimate
Interior Convenience						
Reach and rake adjustable steering	●	●	●	●	●	●
Steering wheel audio/phone/cruise controls	●	●	●	●	●	●
60/40 split-folding rear seat backs	hatchback only	●	●	hatchback only	hatchback only	●
Twin electrically adjustable/heated door mirrors	●	●	●	●	●	●
Electrically operated front and rear windows with safety autoreverse and one-touch up/down facility	●	●	●	●	●	●
Paddle shift	●	●	●		auto only	auto only
Front centre armrest with cup holder	●	●	●		●	●
Centre rear seat armrest and load-through facility	●	●	●		●	●
Frameless automatic anti-dazzle rear-view mirror	●	●	●		●	●
Flex load floor					●	●
Wireless charger for mobile devices		●	●			●
Keyless start				●		
Keyless entry and start	●	●	●		●	●
Heating and Ventilation						
Electronic climate control				●		
Dual-zone electronic climate control	●				●	
Dual-zone electronic climate control with Intelli-Air (air quality sensor)		●	●			●
Heated steering wheel and front seats	●	●	●		●	●
Heated windscreen		●	●			●



Model Specific Features/Option

	Plug-in Hybrid models					
	GS	Ultimate	GSe	Design	GS	Ultimate
Interior Lighting						
Illuminated vanity mirrors and rear reading lights	●	●	●	●	●	●
Ambient lighting – customisable with eight different colours	●	●	●		●	●
Interior Styling						
Black headliner	●	●	●		●	●
Alloy-effect sports pedals	●	●	●		●	●
Exterior Convenience						
Manually folding door mirrors				●		
Power folding door mirrors with puddle light	●	●	●		●	●
Electrically operated slide/tilt glass sunroof with blind		●				●
Tow bar	£605*	£605*	£605*	£605*	£605*	£605*

\*Optional at extra cost including VAT.



Ambient lighting.



Alloy-effect sports pedals.



Electrically operated slide/tilt glass sunroof with blind.



# Versatility – Sports Tourer

**Standard Features** – The following features are available across the all-new Astra Sports Tourer range. Specific features by model are outlined in the separate tabular information.

**Intelli-Space**

- 40/20/40 split-folding rear seat backs
- Intelli-Space load floor adjustable in two heights for flat load area. Adds additional 40 litres of load volume in lower position
- Easy accessible storage boxes in the boot floor accommodate tyre inflation kit and first-aid kit

- Side storage with nets
  - Luggage compartment retractable cover
- Additional features (petrol/diesel)**
- Spare-wheel storage area
  - Rear seat backs with remote easy-fold facility

**Additional feature (Plug-in Hybrid)**

- Special under-carpet storage space for battery, charging cable, tyre inflation kit and first-aid kit

**Model Specific Features**

	Plug-in Hybrid model		
	GS	Design	GS
Interior Load Area			
Fixed floor with luggage restraining nets (pair)	●		
Flex load floor with luggage restraining nets (pair)		●	●
Rear seat load-through facility with armrest and cup holders	●		●



Intelli-Space 40/20/40 split rear seats.



Intelli-Space adjustable load floor.



Easy accessible storage boxes.



Design



Seating:

Redesigned comfort front seats with special density foams for firm lateral support and a genuine low position 'sporty' feel.

- Driver's seat (six-way adjustable):
  - Height – Reach – Backrest
  - Head restraint
- Front passenger's seat (four-way adjustable):
  - Height – Reach – Backrest
  - Head restraint
- 60/40 split-folding rear seat backs
  - Hatchback
- 40/20/40 split-folding rear seat backs
  - Sports Tourer

Steering wheel:

- Three-spoke flat-bottom design
- Leather-covered
- Satin chrome-effect accents

Facia and door trim:

- Black facia with Modene trim inserts
- Instrument panel bar Alexit Grey
- Birdie Grey trim inserts on front doors
- Chrome-effect interior door handles



VX\_AST\_33514

Seat trim:

- Jet Black Modene seat trim inserts
- Jet Black Modene fabric side bolsters and surrounds



GS



Seating:

The sports-style driver's seat has once again received the AGR\* accolade, confirming that the all-new Astra GS meets the highest of comfort standards

- Ergonomic active sports-style driver's seat (eight-way adjustable):
  - Height – Reach – Tilt – Backrest
  - Seat cushion extension – Head restraint
  - Lumbar adjustment (four-way electrical)
- Front passenger's seat (four-way adjustable):
  - Height – Reach – Backrest
  - Head restraint
- 60/40 split-folding rear seat backs
  - Hatchback
- 40/20/40 split-folding rear seat backs
  - Sports Tourer
- Heated front seats

Steering wheel:

- Three-spoke flat-bottom design
- Heated
- Perforated leather-covered with accent stitching
- Satin chrome-effect accents

Facia and door trim:

- Black facia with Isabella trim inserts
- Instrument panel bar Liquid Palladium
- Mistral Black trim inserts on front doors
- Chrome-effect interior door handles



VX\_AST\_33516

Seat trim:

- Jet Black Greta fabric seat trim inserts
- Jet Black Greta side bolsters and surrounds

VX\_AST\_33740

\*AGR (The Campaign for Healthier Backs) is an independent centre of excellence for ergonomics, based in Germany.



Ultimate



Seating:

The sports-style front seats have once again received the AGR\* accolade, confirming that the all-new Astra Ultimate meets the highest of comfort standards.

- Ergonomic active sports-style front seats
- Driver's seat (eighteen-way adjustable)
  - Height (electrical) – Reach (electrical)
  - Tilt (electrical) – Backrest (electrical)
  - Seat cushion extension
  - Lumbar adjustment (four-way electrical)
  - Head restraint
  - Pneumatically adjustable backrest side bolsters
- Front passenger's seat (eight-way adjustable)
  - Height – Reach – Backrest
  - Seat cushion extension – Head restraint
  - Lumbar adjustment (four-way electrical)
- Heated front seats
- 60/40 split-folding rear seat

Steering wheel:

- Three-spoke, heated flat-bottom design
- Perforated leather-covered with accent stitching
- Satin chrome-effect accents

Facia and door trim:

- Black facia with high gloss black inserts
- Instrument panel bar Liquid Palladium
- Alcantara Tramontane inserts on front doors
- Chrome-effect interior door handles



VX\_AST\_33517

Seat trim:

- Alcantara seat trim inserts
- Alcantara side bolsters and surrounds

VX\_AST\_PHEV\_32912

\*AGR (The Campaign for Healthier Backs) is an independent centre of excellence for ergonomics, based in Germany.



GSe



Seating:

The GSe performance front seats have once again received the AGR\* accolade, confirming that the all-new Astra GSe meets the highest of comfort standards.

- Ergonomic active sports-style front seats
- Driver's seat (eighteen-way adjustable) with memory function
  - Height (electrical) – Reach (electrical)
  - Tilt (electrical) – Backrest (electrical)
  - Seat cushion extension
  - Lumbar adjustment (four-way electrical)
  - Head restraint
  - Pneumatically adjustable backrest side bolsters
- Front passenger's seat (eight-way adjustable)
  - Height – Reach – Backrest
  - Seat cushion extension – Head restraint
  - Lumbar adjustment (four-way electrical)
- Heated front seats
- 60/40 split-folding rear seat

Steering wheel:

- Three-spoke, heated flat-bottom design
- Perforated leather-covered with accent stitching
- Satin chrome-effect accents

Facia and door trim:

- Black facia with high gloss black inserts
- Instrument panel bar Liquid Palladium
- Alcantara Tramontane inserts on front doors
- Chrome-effect interior door handles



VX\_AST\_GSe\_34210

Seat trim:

- Alcantara seat trim inserts
- Alcantara side bolsters and surrounds
- GSe badge

VX\_AST\_GSe\_34208

\*AGR (The Campaign for Healthier Backs) is an independent centre of excellence for ergonomics, based in Germany.



Ultimate and GSe – Nappa Leather (extra-cost option)

Optional seating priced at £2,100 including VAT



Seating:

The sports-style front seats have once again received the AGR\* accolade, confirming that the all-new Astra Ultimate meets the highest of comfort standards.

- Ergonomic active sports-style front seats
- Driver's seat (eighteen-way adjustable)
  - Height (electrical) – Reach (electrical)
  - Tilt (electrical) – Backrest (electrical)
  - Seat cushion extension
  - Lumbar adjustment (four-way electrical)
  - Head restraint – Active ventilation
  - Pneumatically adjustable backrest side bolsters
  - Massage and memory seat adjuster functions
- Front passenger's seat (eight-way adjustable)
  - Height – Reach – Backrest
  - Seat cushion extension
  - Head restraint – Active ventilation
  - Lumbar adjustment (four-way electrical)
- Heated front and outer rear seats
- 60/40 split-folding rear seat

Steering wheel:

- Three-spoke, heated flat-bottom design
- Perforated leather-covered with accent stitching
- Satin chrome-effect accents

Facia and door trim:

- Black facia with high gloss black inserts
- Instrument panel bar Liquid Palladium
- Alcantara Tramontane inserts on front doors
- Chrome-effect interior door handles

Additional features:

AGR front seats with 3-stage seat heating, massage function and seat ventilation are standard with the leather option. The option also features a driver's seat adjustment with memory function.



VX\_AST\_33518

Seat trim:

- Nappa Leather seat trim inserts
- Leather-effect side bolsters and surrounds

VX\_AST\_PHEV\_32911

\*AGR (The Campaign for Healthier Backs) is an independent centre of excellence for ergonomics, based in Germany.



# Safety and Security

Model Specific Features	Plug-in Hybrid models					
	GS	Ultimate	GSe	Design	GS	Ultimate
Airbags						
Driver’s and front passenger’s airbag	●	●	●	●	●	●
Front seat side-impact airbags	●	●	●	●	●	●
Full-size curtain airbags	●	●	●	●	●	●
Braking						
In crash braking – the system automatically brakes the vehicle to help it come to a standstill after a severe collision	●	●	●	●	●	●
Hill start assist – holds the vehicle steady for two seconds on slopes with a gradient of over 3% after the brake pedal is released.	●	●	●	●	●	●
Child Safety						
Deactivation switch for front passenger’s front and side-impact bags	●	●	●	●	●	●
ISOFIX child seat mountings – located on outer rear seats incorporating top tether mounting points. (Does not include child seat)	●	●	●	●	●	●
Security						
Remote control ultrasonic security alarm system	●	●	●	●	●	●
Locking wheel bolts for alloy wheels	●	●	●	●	●	●



Hill start assist.

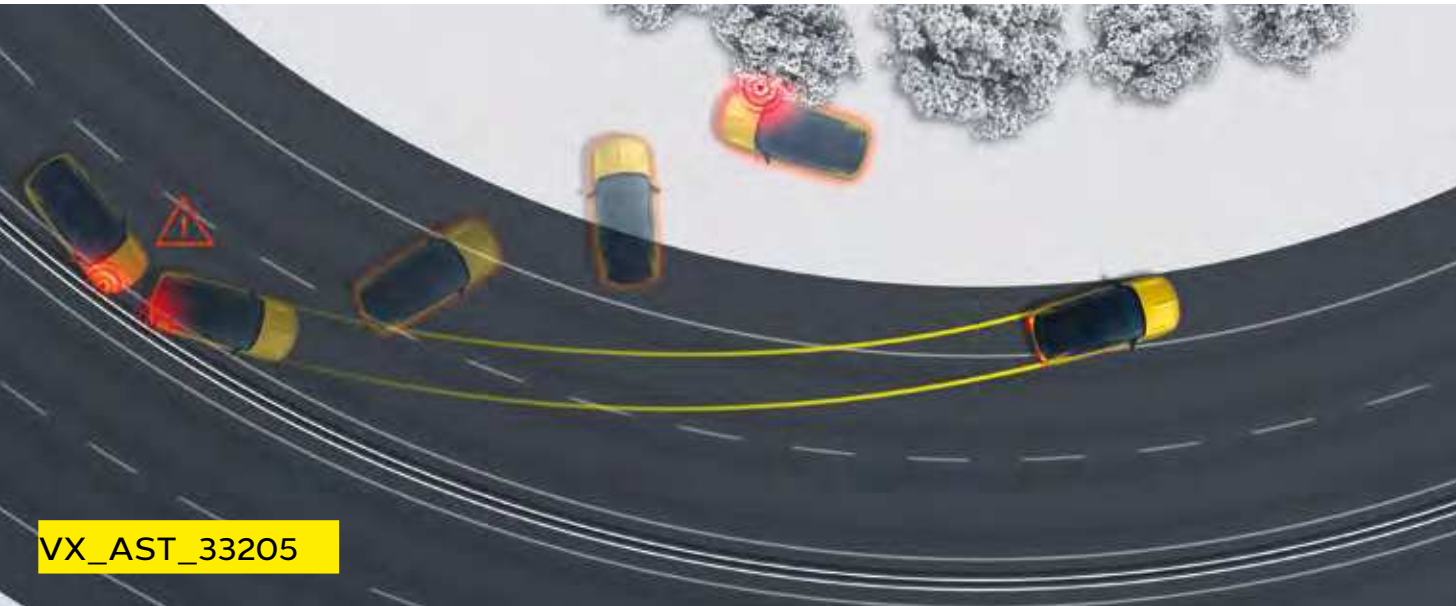

In-crash braking.



ISOFIX child seat mountings.



# Styling – Hatchback

Model Specific Features/Option	Plug-in Hybrid models				
	GS	Ultimate	Design	GS	Ultimate
Exterior Styling					
Body-colour door handles	●	●	●	●	●
Black lower window moulding	●	●	●	●	●
Black-painted door mirrors	●	●	●	●	●
Body-colour bumpers with grained black lower front grille and rear valance panel			●		
Body-colour sports-style bumpers with high gloss black lower front grille, decor blade and rear valance panel	●	●		●	●
Chrome-effect Griffin logo and vizor frame			●		
Black Griffin logo and vizor frame	●	●		●	●
Dark-tinted rear windows	●	●		●	●
Body-colour roof and rear spoiler	No-cost	No-cost	●	No-cost	No-cost
Carbon black roof and rear spoiler*	●	●		●	●

\*Standard with Carbon Black body colour.



Black Griffin logo and vizor frame.



Black roof and dark-tinted rear windows.



Rear styling.



# Styling – Sports Tourer

Model Specific Features/Options	Plug-in Hybrid model		
	GS	Design	GS
Exterior Styling			
Body-colour door handles	●	●	●
Black lower window moulding	●	●	●
Black-painted door mirrors	●	●	●
Body-colour bumpers with grained black lower front grille and rear valance panel		●	
Body-colour sports-style bumpers with high gloss black lower front grille, decor blade and rear valance panel	●		●
Chrome-effect Griffin logo and vizer frame		●	
Black Griffin logo and vizer frame	●		●
Dark-tinted rear windows	●		●
Body-colour roof and rear spoiler	No-cost	●	No-cost
Carbon black roof and rear spoiler**	●		●
High gloss black roof rails	£200*		£200*

\*Optional at extra cost including VAT. \*\*Standard with Carbon Black body colour.



Black Griffin logo and vizer frame.



Black roof and dark-tinted rear windows.



Rear styling.



# GSe Styling

**Standard Features** – The following features are standard across the all-new Astra GSe range.

**Exterior styling**

- Body-colour door handles
- Black lower window moulding
- Dark-tinted rear windows
- Black-painted door mirrors
- Unique GSe body-colour sports-style bumpers with high gloss black lower front grille, decor blade and rear valance panel
- Black Griffin logo and vizor frame
- Carbon black roof and rear spoiler
- Unique GSe 18-inch gloss black bi-colour, diamond-cut alloy wheels
- GSe badge on tailgate

**Interior styling**

- GSe performance heated sports-style front seats (AGR approved\*)

\*AGR (The Campaign for Healthier Backs) is an independent centre of excellence for ergonomics, based in Germany.



GSe badge.



Unique GSe front styling.



Unique GSe 18-inch alloy wheels.



Unique GSe rear styling.



# Exterior Colours

**Arctic White (POWP)\***  
Brilliant paint



VX\_AST\_PHEV\_32844

**Carbon Black (M49V)\*\***  
Two-coat metallic paint £600



VX\_AST\_PHEV\_32850

**Vulcan Grey (M6VL)\*\***  
Two-coat metallic paint £600



VX\_AST\_PHEV\_32848

**Crystal Silver (M0ZR)\*\***  
Two-coat metallic paint £600



VX\_AST\_PHEV\_32849

**Crimson Red (M5PQ)\*\***  
Two-coat premium metallic paint £700



VX\_AST\_PHEV\_32845

**Electric Yellow (M0RV)†**  
Two-coat premium metallic paint £700



VX\_AST\_PHEV\_32847

**Cobalt Blue (M6SM)††**  
Tri-coat premium metallic paint £700







VX\_AST\_PHEV\_32846

The colours reproduced may vary slightly from the actual paint colour. As a result they should be used as a guide only. Your Vauxhall Retailer has a comprehensive display of our paint samples.  
Please note, vehicles illustrated are not model specific and are for illustrative purposes only.  
\*Standard exterior paint. \*\*Optional at extra cost including VAT. †Optional at extra cost including VAT. Not available on GSe Hatchback or Sports Tourer models.  
††Optional at extra cost including VAT. Not available on GSe Hatchback models.



# Wheels and Tyres

		Plug-in Hybrid models					
		GS	Ultimate	GSe	Design	GS	Ultimate
 VX_AST_32864_SKH	<b>16-inch silver alloy wheels</b> <ul style="list-style-type: none"><li>• 205/55 R 16 tyres</li><li>• Emergency tyre inflation kit</li></ul> <b>TYRE LABEL</b>				●		
 VX_AST_32866_QOJ	<b>17-inch black alloy wheels</b> <ul style="list-style-type: none"><li>• 225/45 R 17 tyres</li><li>• Emergency tyre inflation kit</li></ul> <b>TYRE LABEL</b>	●				●	
 VX_AST_32868_PU1	<b>18-inch bi-colour diamond-cut alloy wheels with grey inserts</b> <ul style="list-style-type: none"><li>• 225/40 R 18 tyres</li><li>• Emergency tyre inflation kit</li></ul> <b>TYRE LABEL</b>	£300*	●			£300*	●
 VX_AST_32867_PU2	<b>18-inch bi-colour diamond-cut alloy wheels with red inserts**</b> <ul style="list-style-type: none"><li>• 225/40 R 18 tyres</li><li>• Emergency tyre inflation kit</li></ul> <b>TYRE LABEL</b>	£300*				£300*	
 VX_AST_GSe_34211_PU3	<b>18-inch gloss black bi-colour diamond-cut alloy wheels</b> <ul style="list-style-type: none"><li>• 225/40 R 18 tyres</li><li>• Emergency tyre inflation kit</li></ul> <b>TYRE LABEL</b>			●			
<b>Provision for spare wheel fitment (spare wheel is Retailer-fit)</b>					£20*	£20*	

\*Optional at extra cost including VAT. \*\*Not available with Electric Yellow or Cobalt Blue paints.



# Specifications

## Transmission

### Six-speed manual gearbox

Petrol engines: 1.2 (110/130PS) Turbo models

### 8-speed automatic transmission

Available on the 1.2 (130PS) Turbo/1.5 (130PS) Turbo D, the 8-speed automatic transmission enables increased drive comfort and improved fuel economy. The automatic gear lever has been replaced by an ergonomic e-toggle in harmony with the interior design. The new e-toggle is standard for combustion engine and Plug-in Hybrid.

The current driving position is indicated to the driver with a LED between:

- **R:** used for reverse driving
- **N:** used for neutral, allowing the vehicle to be moved with ignition off
- **D:** used for automatic drive, the gearbox change gears without any action from the driver
- **M button:** Manual shifting mode for combustion engines. The driver changes gears with the shift paddles on steering wheel

The driver can also select between three different driving modes, Sport, Normal and Eco, which offer several enhancements to the driving experience.

## Steering

- Power-assisted steering
- Turning circle (wall-to-wall):
  - 10.51m (34.5ft.) Hatchback
  - 10.71m (35.1ft.) Sports Tourer

## Tank Capacities

- 52 litres (11.4 gallons) – Petrol/Diesel
- 42 litres (9.2 gallons) – Plug-in Hybrid
- 13 litres (2.8 gallons) – AdBlue® tank capacity

## Braking and stability

- Electronic Stability Programme (ESP) – ESP monitors many different inputs to determine when the car starts to lose traction, it can then immediately respond by varying the brake pressure between up to three wheels and adjust the engine output to help correct the loss of traction and improve stability
- Cornering brake control
- Straight line stability control
- Rollover mitigation
- Drag torque control – Maintain stability on slippery roads when lifting off the accelerator or changing gear
- Hill start assist
- Anti-lock Braking System (ABS)
- Emergency brake assist
- Fading brake support
- Electronic brakeforce distribution
- Adaptive brake lights

## Suspension

Front: Independent. Decoupled MacPherson struts with gas-pressure dampers and coil springs.

Anti-roll bar.

Rear: Compound crank with coil springs and gas-pressure dampers.

### GSe models

Ride height lowered by 10mm.

Front: Independent Decoupled MacPherson struts with Koni FSD (Frequency Selective Damping) oil-filled dampers and revised springs. Anti-roll bar.

Rear: Compound crank with coil springs and Koni FSD (Frequency Selective Damping) oil-filled dampers and revised rear springs.

## Start/Stop technology

All-new Astra’s feature Start/Stop technology offering real benefits by improving fuel economy and reducing CO<sub>2</sub> emissions, particularly in town. It does this by automatically stopping the engine when you come to a standstill, and then restarting as you prepare to move off.

Before automatically stopping the engine a number of system checks are carried out to ensure that it is both safe and practical to do so. To ensure safety, the driver must depress the clutch pedal, shift in to neutral, and then release the clutch pedal.

System checks carried out before Auto Stop activates include:

- Start/Stop system is not manually deactivated via the facia button
- Sufficient brake vacuum is available to prevent the car rolling down an incline
- Battery is in good condition and charged
- Outside air temperature and engine temperature are above specified minima
- Electronic climate control (where fitted) is not in maximum heating or maximum cooling mode
- Self-cleaning function of the diesel particulate filter is not active

If all of these conditions are satisfied then the vehicle will Auto Stop.

When you are ready to pull away from standstill, Auto Restart is activated by depressing the clutch pedal.

Whilst at a standstill the vehicle is continually monitored. If necessary, the engine will automatically be restarted. Conditions that would initiate an Auto Restart include:

- Low battery level
- Brake vacuum below specified minimum
- Start/Stop system is manually deactivated
- Stationary for 5.5 minutes





Petrol Engines	1.2 (110PS) Turbo	1.2 (130PS) Turbo
Capacity	1199cc	1199cc
Maximum power	110PS (81kW) @ 5500rpm	130PS (96kW) @ 5500rpm
Maximum torque	205Nm (151lb.ft.) @ 1750rpm	230Nm (169lb.ft.) @ 1750rpm
Configuration	3 cylinders, 4 valves per cylinder, double overhead camshafts	3 cylinders, 4 valves per cylinder, double overhead camshafts
Fuel/induction system	Turbocharger. Variable Valve Timing (VVT). Spark ignited direct injection (SIDI)	Turbocharger. Variable Valve Timing (VVT). Spark ignited direct injection (SIDI)
Emission compliance	Euro 6.4	Euro 6d (6.3)
Service interval	12,500 miles or 1 year (whichever occurs sooner)	12,500 miles or 1 year (whichever occurs sooner)

Diesel Engine	1.5 (130PS) Turbo D auto
Capacity	1498cc
Maximum power	130PS (96kW) @ 3750rpm
Maximum torque	300Nm (221lb.ft.) @ 1750rpm
Configuration	4 cylinders, 4 valves per cylinder, double overhead camshafts
Fuel/induction system	Turbocharger. Common rail fuel injection
Emission compliance	Euro 6d (6.3)
Service interval	20,000 miles or 1 year (whichever occurs sooner)





Performance, Fuel Economy and Emissions**	Performance (manufacturer's figures)		Fuel economy mpg (litres/100km)#		CO <sub>2</sub> emissions g/km#		Vehicle Excise Duty*		BiK rates from – 2022/23 tax year
	Maximum speed (mph)	Acceleration 0–60mph (sec)	Combined Low	Combined High	Combined Low	Combined High	First year rate	Standard rate	
Hatchback									
1.2 (110PS) Turbo	124	10.5	52.3 (5.4)	52.3 (5.4)	123	123	£190	£165	29%
1.2 (130PS) Turbo	130	9.7	49.6 (5.7)	52.3 (5.4)	123	128	£190	£165	29%
1.2 (130PS) Turbo auto	130	9.7	48.7 (5.8)	50.4 (5.6)	125	131	£230	£165	31%
1.5 (130PS) Turbo D auto	130	10.6	56.5 (5.0)	58.9 (4.8)	127	132	£230	£165	30%
Sports Tourer									
1.2 (110PS) Turbo	124	10.8	50.4 (5.6)	50.4 (5.6)	125	125	£190	£165	30%
1.2 (130PS) Turbo	130	10.0	49.6 (5.7)	50.4 (5.6)	126	128	£190	£165	30%
1.2 (130PS) Turbo auto	130	9.9	48.7 (5.8)	49.6 (5.7)	128	130	£190	£165	30%
1.5 (130PS) Turbo D auto	129	11.0	56.5 (5.0)	57.6 (4.9)	129	131	£230	£165	31%

Weights and Towing Data kg**	Gross vehicle weight		Maximum towing weights Trailer with brakes (without brakes)	
	Hatchback	Sports Tourer	Hatchback	Sports Tourer
1.2 (110PS) Turbo	1820	1870	1250 (660)	1200 (680)
1.2 (130PS) Turbo	1840	1880	1250 (660)	1200 (690)
1.2 (130PS) Turbo auto	1880	1900	Factory-fit 1400 / Retailer-fit 1200 (680)	Factory-fit 1400 / Retailer-fit 1200 (710)
1.5 (130PS) Turbo D auto	1940	1980	1550 (710)	1500 (740)

#Figures shown are for comparison purposes and should only be compared to the fuel consumption and CO<sub>2</sub> values of other cars tested to the same technical standard. The fuel consumption achieved, and CO<sub>2</sub> produced, in real world conditions will depend upon a number of factors including, but not limited to: the accessories fitted (pre and post registration); variations in weather; driving styles and vehicle load. The WLTP (Worldwide Harmonised Light Vehicles Test Procedure) is used to measure fuel consumption and CO<sub>2</sub> figures. The CO<sub>2</sub> figures display a range to reflect the highest value for the highest emitting version with all available options added, through to a minimum value to represent the lowest emitting version in standard specification.

**Please note: Gross vehicle weight** is the total permissible weight of the vehicle including passengers and their luggage. The **maximum roof rack loading** should not exceed 75kg. The **maximum towing weights** are based on the ability of the car, with two occupants of 75kg each, to restart on a 12% gradient, which is approximately 1 in 8.3, at sea level. The permitted trailer load applies up to the specified incline and up to an altitude of 1000 metres above sea level. The permissible gross train weight decreases by 10% for every 1000 metres of additional altitude. At altitudes above 1500 metres, the engine output may drop with a corresponding reduction in towing capability. Any extra weight, such as luggage or additional passengers, should be deducted from the maximum towing weight. With a trailer fully loaded, maximum noseweight should not exceed 75kg. Always fit Vauxhall towing attachments and accessories available from your Vauxhall Retailer. They are designed specifically for Vauxhall models and carry a 12-month guarantee.

\*Correct at time of publication. \*\*Provisional data.





Dimensions and Capacities

All measurements in mm (inches) unless stated otherwise.

Loadspace Dimensions	Hatchback	Sports Tourer
Load floor length (rear seats folded)	1589 (62.5)	1850 (72.8)
Load floor length (behind rear seats)	795 (31.3) 770 (30.3)**	1026 (40.3) 1018 (40.0)**
Load area width	1020 (40.2)	1032 (40.6)
Load area height	599 (23.5) 601 (23.6)**	599 (23.5) 601 (23.6)**
Tailgate aperture width (maximum)	1019 (40.1)	tba
Tailgate aperture height	526 (20.7)	482 (18.9)

Luggage Capacities* Litres (cu.ft.)	Hatchback	Sports Tourer
Rear seat up (under luggage compartment cover)	422 (14.9) 352 (12.4)**	597 (21.0) 516 (18.2)**
Rear seat down (measured to roof)	1339 (47.2) 1268 (44.7)**	1634 (57.7) 1553 (54.8)**

\*Measured using the ECIE method. When a spare wheel is specified loadspace capacity is reduced due to a raised luggage compartment floor. \*\*Plug-in Hybrid.

Hatchback



Sports Tourer







# Company Car Driver and Fleet Information

**Benefit in kind company car taxation\***

The car benefit charge will be the car’s list price (including VAT, options and accessories fitted, delivery to Retailer and number plates, but excluding Vehicle Excise Duty and new vehicle first registration fee) multiplied by the percentage charge for the CO<sub>2</sub> emissions band in which the car falls (see table opposite). Multiply this figure by your personal income tax rate (20%\*\* for Basic Rate, 40%\*\* for Higher Rate) to calculate your annual benefit in kind tax liability.

**Generic example:**

**Hybrid vehicle: 24g/km CO<sub>2</sub>, up to 43 miles (electric-only range)**

On-the-road RRP	£32,200.00
Deduct: Vehicle Excise Duty	-£10.00
New vehicle first registration fee	-£55.00
Effective list price	£32,135.00
Add: Optional two-coat metallic paint	£600.00
List price for tax purposes (P11D value)	£32,735.00
Car benefit charge 2022–23 tax year (8%)	£2,619.00
Benefit in kind tax liability	
Basic Rate (20%) tax payer	£523.80
Higher Rate (40%) tax payer	£1,047.60

\*Please note this Price Guide provides taxation information as a guide only. Vauxhall does not provide taxation guidance. Drivers should always take professional advice on their own tax position.  
\*\*Excludes residents of Scotland.

**BiK for Scottish Residents**

Effective 6 April 2018 the Scottish Government have introduced their own BiK taxation structure. This only applies to Company Car Drivers that are Scottish taxpayers. HMRC will determine whether or not an individual is a Scottish taxpayer based on where their main place of residence is.

**The BiK rates for Scotland are:**

- Over £12,570 – £14,732 Starter Rate 19%
- Over £14,732 – £25,688 Basic Rate 20%
- Over £25,688 – £43,662 Intermediate Rate 21%
- Over £43,662 – £150,000 Higher Rate 41%
- Above £150,000 Top Rate 46%

CO <sub>2</sub> emissions (g/km)	Percentage of cars price to be taxed 2022–23 tax year
Up to 50	14%
51 – 54	15%
55 – 59	16%
60 – 64	17%
65 – 69	18%
70 – 74	19%
75 – 79	20%
80 – 84	21%
85 – 89	22%
90 – 94	23%
95 – 99	24%
100 – 104	25%
105 – 109	26%
110 – 114	27%
115 – 119	28%
120 – 124	29%
125 – 129	30%
130 – 134	31%
135 – 139	32%
140 – 144	33%
145 – 149	34%
150 – 154	35%
155 – 159	36%
160 – 164	37%
165 – 169	37%
170+	37%

CO <sub>2</sub> emissions (g/km)	Electric range (miles)	Percentage of cars price to be taxed 2022–23 tax year
0	–	2%
1 – 50	130+	2%
1 – 50	70 – 129	5%
1 – 50	40 – 69	8%
1 – 50	30 – 39	12%
1 – 50	<30	14%

To calculate your own personal liability, search: **Vauxhall BiK**, or click the link below:  
[Vauxhall BiK Tool](#)

**Fleet Toolbox**

Discover the facts in our online Toolbox for both Company Car Drivers and Fleet Decision Makers. The Fleet Toolbox has a host of useful calculators, comparators, interactive listings and information.

Search Vauxhall Fleet Tools or click the link below:  
[Vauxhall Fleet Tool Box](#)

**Contact Vauxhall Fleet**

Please contact one of our dedicated sales teams who will be happy to help with your particular enquiry.

**Company Car Drivers**

Call: 0345 111 2020  
Email: [company-car@vauxhallinfo.co.uk](mailto:company-car@vauxhallinfo.co.uk)

**Telephone lines are open**

– Monday to Friday 8:00am–9:00pm  
– Saturday and Sunday 9:00am–6:00pm

**Fleet Decision Makers**

Depending on the size of your fleet of vehicles, we have a dedicated team to handle your enquiries. The lines are open Monday to Friday excluding Bank Holidays.

**1–24 vehicles**

Call: 0845 076 2254 (8:30am–5:00pm)

**25+ vehicles**

Call: 0330 587 8222 (8:30am–5:00pm)  
Email: [vauxhallfleet@vauxhall.co.uk](mailto:vauxhallfleet@vauxhall.co.uk)

**Special Vehicles (Police, Fire and Ambulance)**

Call: 01582 409999 (8:30am–5:00pm)  
Email: [vauxhallspecialvehicles@vauxhall.co.uk](mailto:vauxhallspecialvehicles@vauxhall.co.uk)



# Further Information

On-the-road prices

To eliminate uncertainty about hidden costs when buying a new car, Vauxhall publishes on-the-road recommended retail prices (RRP) and these are shown in the pricing tables within this price guide. These prices include VAT, number plates and delivery to Retailer of £750.00 (including £125.00 VAT), 12 months’ Government Vehicle Excise Duty (see opposite for details) and the DVLA new vehicle first registration fee of £55.00.\*

**Please note:** The on-the-road recommended retail price (RRP) does not include fuel supplied by the Retailer, motor insurance or any other goods or services supplied by agreement between the Retailer and the customer.

Price protection

Order a new Vauxhall for build in the current model year (as confirmed by your Retailer) for delivery no more than three months in advance and the price you are quoted is the price you pay. This is irrespective of any subsequent price rises between placing your order and delivery of your new car, but you must take delivery as soon as the car is available.

**Please note:** Price protection does not apply to Plug-in Hybrid models. Vauxhall Motors Limited is not liable for price adjustments caused by Government changes in the rate of VAT (currently 20%), Vehicle Excise Duty, DVLA new vehicle first registration fee or by any other applicable legislation or regulations.

In the event of an accident

Vauxhall Accident Management helps keep you mobile following an accident. Benefits include vehicle recovery, Vauxhall-approved repairs and contacting your insurer. For more details, visit [vauxhall.co.uk/AccidentManagement](http://vauxhall.co.uk/AccidentManagement)

Free2Move Lease

Whether you’re a big company or a small business looking for vehicle financing, Free2Move Lease, our business finance specialists, can deliver exactly what you need.

Free2Move Lease is one of the UK’s largest leasing companies and is also a member of the British Vehicle Rental and Leasing Association (BVRLA).

With over 60,000 vehicles in the Free2Move Lease portfolio, Free2Move Lease is able to offer competitive vehicle solutions. In addition, Free2Move Lease also offer innovative connected management of servicing and maintenance.

For further information, please contact your local Vauxhall Retailer or visit [vauxhall.co.uk/offers-finance/business-leasing.html](http://vauxhall.co.uk/offers-finance/business-leasing.html)

Vehicle Excise Duty

The amount of Vehicle Excise Duty (road fund licence) payable on new cars varies depending on the level of carbon dioxide (CO<sub>2</sub>) emissions produced by the vehicle. CO<sub>2</sub> emissions are measured in grams per kilometre (g/km) travelled and divided into 13 charging bands shown in the table opposite.

A ‘first year rate’ of Vehicle Excise Duty is payable on all new cars and in subsequent years the amount payable reverts to the ‘standard rate’. From 1 April 2017 the breakpoints for each of these bands have been revised. Also, for vehicles with a list price over £40,000, including factory-fitted options, an additional £335 is payable for the first five years of standard rate payments.

Vehicle Excise Duty\*

Band	CO <sub>2</sub> emissions in grams per kilometre	First year rate Petrol/Diesel	Standard rate Petrol/Diesel	Standard rate Hybrid
A	0	£0	£0	£0
B	1 – 50	£10	£165	£0
C	51 – 75	£25	£165	£15
D	76 – 90	£120	£165	£110
E	91 – 100	£150	£165	£140
F	101 – 110	£170	£165	£160
G	111 – 130	£190	£165	£180
H	131 – 150	£230	£165	£220
I	151 – 170	£585	£165	£575
J	171 – 190	£945	£165	£935
K	191 – 225	£1,420	£165	£1,410
L	226 – 255	£2,015	£165	£2,005
M	Over 255	£2,365	£165	£2,355

\*Correct at time of issue.



# Further Information

### Customer Care Commitment

For added peace of mind, Vauxhall has an innovative Customer Care Commitment that offers the following:

- Three-year vehicle warranty consisting of a one-year/unlimited mileage manufacturer’s warranty and a second and third year manufacturer’s warranty with a 60,000 miles limitation
- Vauxhall Assistance for 12 months from first registration
- Six years’ body panel anti-perforation warranty

**Please note:** Warranty is only available on vehicles sourced from Vauxhall Motors Limited. Terms and conditions apply – please see your Vauxhall Retailer for details.

### Vauxhall Assistance

Vauxhall Assistance is provided automatically with every new Vauxhall for 12 months from first registration and covers everything from accident assistance, roadside recovery and ‘at home’ service to flat tyres. For even more peace of mind, on fully electric models, the cover is extended\* to 3 years or 100,000 miles, whichever comes first. Even more reason for you to stay calm and let us take care of everything should the need arise. With Vauxhall Assistance help is literally just a free\*\* phone call away, 24 hours a day, 365 days a year!

### Protecting the environment

Vauxhall’s commitment to the environment is demonstrated by our products’ many environmental awards. For even more information on Vauxhall’s efforts to achieve an environmentally sustainable future, and how to dispose of your end-of-life vehicle, see [vauxhall.co.uk/recycling](https://vauxhall.co.uk/recycling)

### Vauxhall Care

This all-inclusive service package is available on Vauxhalls under 10 months old (from date of first registration).

This package offers complete peace of mind for the first 3 years of your Vauxhall’s life with fixed monthly payments for the plan duration.

- **3 years’ Vauxhall servicing** – covers first, second and third annual services. Including a brake-fluid change in the second service
- **2 years’ Vauxhall Roadside Assistance** – first year from us
- **First years’ MOT<sup>†</sup>** – free of charge by your local Vauxhall Retailer

For full terms and conditions and to sign up, visit: [vauxhall.co.uk/vauxhallcare](https://vauxhall.co.uk/vauxhallcare)

### Vauxhall Service Club

Vauxhall Service Club is available for all Vauxhall owners, and it’s free to join. Members benefit from the following:

- 15% off Vauxhall Approved Accessories
- Vauxhall’s aged 2-3 Years = 15% off parts and labour
- Vauxhall’s aged over 3 Years = 25% off parts and labour
- Half price MOT’s (NI excluded)
- Free pre-MOT test inspection (NI only)
- Fixed price AdBlue® Refills
  - Car = £14.99
  - Van = £24.99
- Access to the Vauxhall Accident Management Programme
- Online service booking available 24/7 with servicing appointments available within 3 days – [Book Online](#)
- Collection and delivery/onward mobility options
- Complimentary ‘Wash and Vac’ with all routine services<sup>††</sup>
- Vauxhall trained technicians
- Genuine Vauxhall parts
- Minimum 12 months warranty on parts and labour
- Regular newsletters with exclusive offers, discounts and competitions

Terms and conditions apply. To join visit: [vauxhall.co.uk/serviceclub](https://vauxhall.co.uk/serviceclub)

### Vauxhall Insurance with added reassurance

Comprehensive cover – Summary of benefits

- Competitive premiums
- Repairs by a Vauxhall-trained technician
- Genuine Vauxhall parts, guaranteed for five years when we repair your car within our Approved Repairer Network
- Free courtesy car as standard when using an Approved Repairer<sup>‡</sup>
- 24 hour claims helpline
- Personal Accident benefit
- Cover for audio equipment
- Windscreen cover

Call for a quote on 0330 678 1130<sup>‡‡</sup>

### For more product information

For further information on the Vauxhall range or location of your nearest Vauxhall Retailer please call **0345 600 1500**. Alternatively, details can be found on our website at [vauxhall.co.uk](https://vauxhall.co.uk)

\*Terms and conditions apply. Please click [here](#) for full terms and conditions. \*\*Mobile phone users will be charged at their standard tariff. <sup>†</sup>First years’ MOT is not available for Northern Ireland. <sup>††</sup>Participating Retailers only. <sup>‡</sup>Should your car need repairing following an accident we provide a courtesy car (subject to availability) for the duration of the repair. Only genuine Vauxhall parts are used. Terms and conditions apply. <sup>‡‡</sup>Calls may be recorded. Vauxhall Insurance Services is a trading name of Europa Group Limited which is authorised and regulated by the Financial Conduct Authority. Europa Group Limited’s Financial Services Register number 309794. Registered as a limited company in England and Wales No 03279177. Registered Office: Europa House, Midland Way, Thornbury, Bristol, BS35 2JX.



For more information call **0345 600 1500**

For Fleet enquiries call **0330 587 8222**

Discover the full Vauxhall range at **[vauxhall.co.uk](https://www.vauxhall.co.uk)**

**Join us online**



The invoice price, including delivery to Retailer, factory-fitted options, accessories fitted by the Retailer and number plates, is subject to VAT. Some feature descriptions in this guide may refer to, and some illustrations may show, optional equipment not included in the standard delivery. The information contained in this guide was accurate at the time of publication. We reserve the right to make changes in design and equipment. Please note that Vauxhall Retailers are not the agents of Vauxhall Motors Limited and are not authorised to bind Vauxhall Motors Limited by any specific or implied undertaking or representation. It is advisable to ensure that your motor insurance policy provides adequate cover for additional fitted options and accessories. The colours in this guide are only approximate actual colours. Illustrated optional equipment is available at extra charge. Availability, technical features and equipment provided on our vehicles can vary by model. For precise information on the equipment provided on our vehicles, please contact your local Vauxhall Retailer.



**VAUXHALL**