

# Dual Nozzle Bidet Sprayer

## Assembly Instruction & Owner's Manual

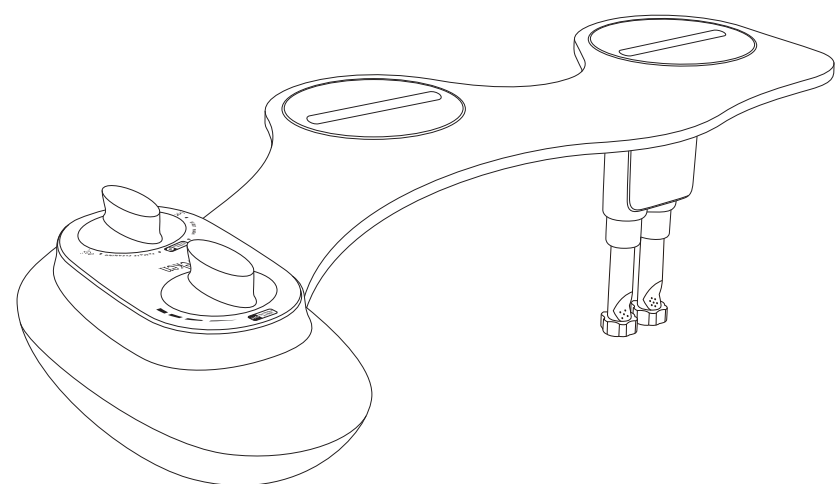

### Products and Accessories List

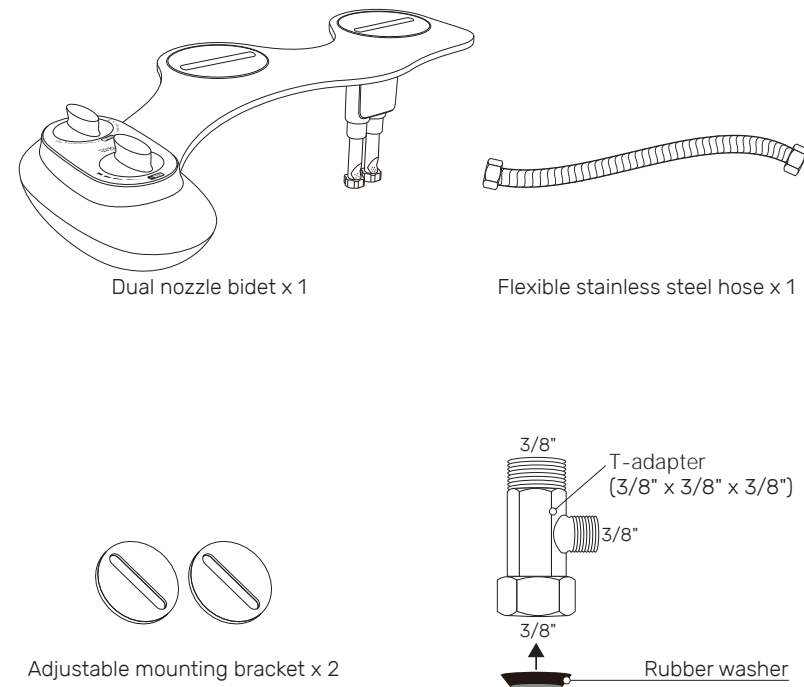

Installation tools needed: **monkey wrench** and **phillips screwdriver** (both tools are not included)



Wrench



Screwdriver

### Installation

1. Remove the existing toilet seat by unscrewing the bolts and nuts which are typically on the plastic bracket.

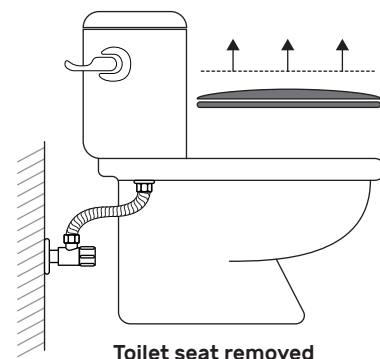

Toilet seat removed

2. Turn off the water supply and drain the toilet water. Try to leave no water in the toilet tank.

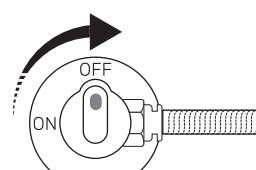

Turn off the water supply.

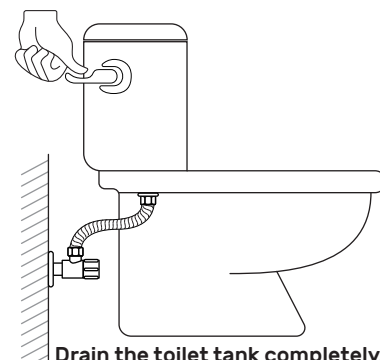

Drain the toilet tank completely.

3. Unscrew the hose connected to the toilet tank from the water supply shut-off valve.

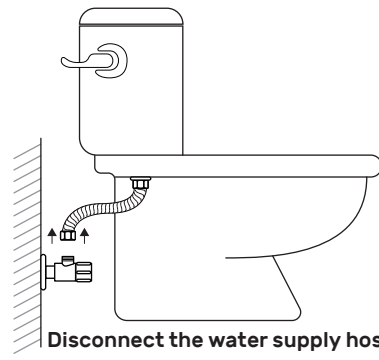

Disconnect the water supply hose.

4. Connect the T-valve to the water supply valve and the water supply hose to the top of the T-valve.

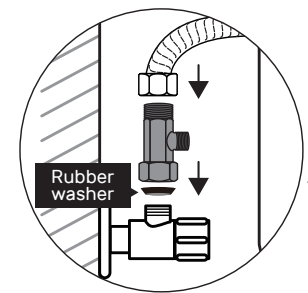

Rubber washer

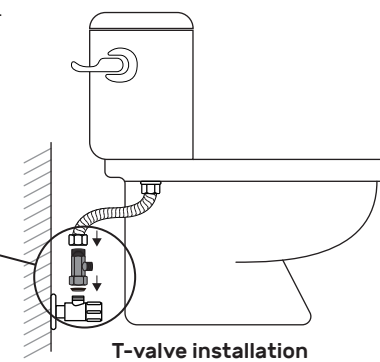

T-valve installation

5. Connect the stainless steel hose (provided) to the open end of the T-valve.

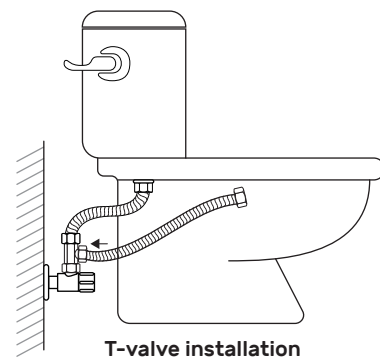

T-valve installation  
Stainless steel hose installation

6. Connect the other end of the hose to the water inlet under the bidet.

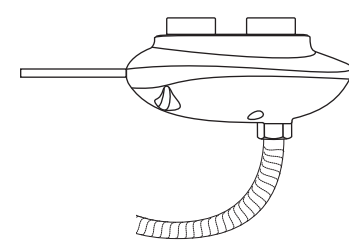

Stainless steel hose installation

7. Place the circular mounting brackets into the bidet attachment.

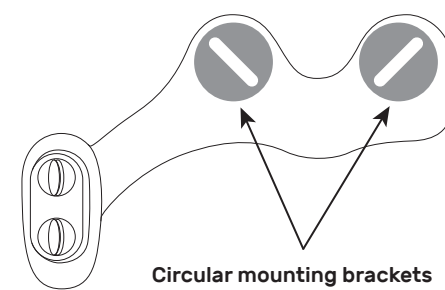

Circular mounting brackets

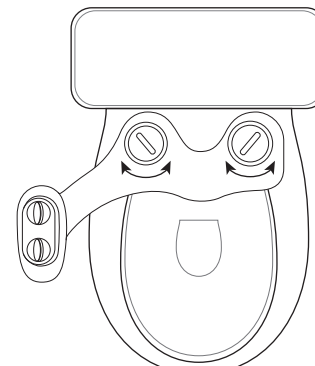

Bidet Alignment

8. Place the bidet on the toilet with the mounting brackets over the mounting bolt holes, rotate the bracket to align the bidet so that the nozzles are positioned at the centerline of the toilet.

9. Place the toilet seat back on the toilet over the bidet and secure the bolts firmly.

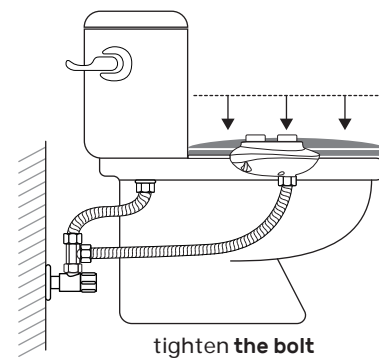

tighten the bolt

10. Slowly turn the water supply back on and check for leakage, as well as the function of bidet.

### Turn on the water supply

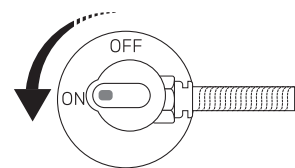

Note: If leakage occurs, check if the rubber washers are firmly secured, and make sure all connections are properly tightened.

Thank you for choosing us!



30 days free return or exchange for any reason



2 YEARS product warranty (For any product quality issues, free return or replacement will be provided)



Lifetime Customer Support

Tell: 1-888-281-8150 (Monday-Friday 9am-5pm CST)  
Email: support@aborderproducts.com (Monday-Friday 9am-5pm CST)

### How to use the bidet

Warning! DO NOT use the bidet until someone is sitting on the toilet. Otherwise, water may spray out of the toilet.

First select the spray mode on the lower panel, and then set the desired water pressure.

- Turn the knob to the center to activate nozzle cleaning mode.
- Turn the knob counter-clockwise to activate Rear Wash mode.
- Turn the knob clockwise to activate Feminine Wash mode.

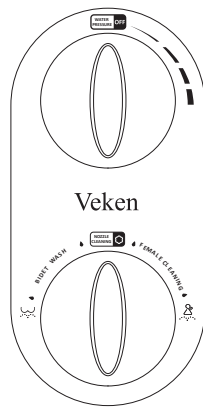

After selecting the spray mode, adjust the pressure control to the desired pressure. **NOTE:** The pressure control knob does not reset automatically after use, turn it off manually.

### Troubleshooting

#### Problem 1

There is leaking from the connection between the T-adapter and the water supply valve.

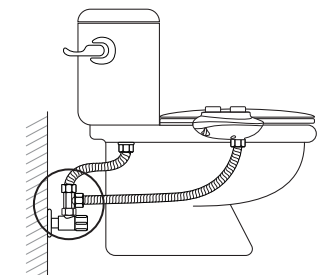

#### Possible Causes

- The T-adapter thread is damaged.
- The black rubber washer is not properly installed on the T-adapter.

#### Possible Solutions

- Connect the T-adapter to the water supply valve, and make sure the T-adapter cannot rotate freely after tightening.
- Make sure that the rubber washer is properly located inside the nut with the narrow side downward.

#### Problem 2

There is leaking from the connection between the hose and the control unit.

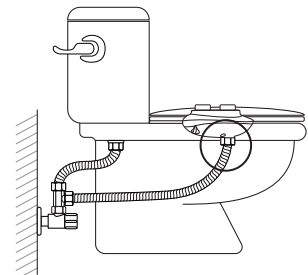

#### Possible Causes

The black rubber gasket is not properly installed on the hose.

#### Possible Solutions

Make sure that the black rubber gasket is properly installed on the hose.

#### Problem 3

There is leaking from the control unit.

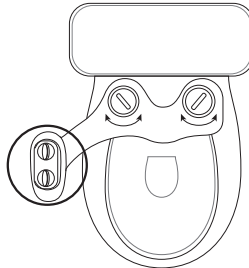

#### Possible Causes

The internal connections may loosen during transportation.

#### Possible Solutions

Contact us to solve the problem.

#### Problem 4

The nozzle cannot extend.

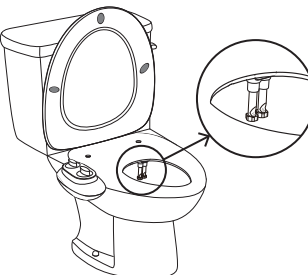

#### Possible Causes

- The nozzle is too close to the toilet.
- The water pressure is too low and cannot support the nozzle to extend.

#### Possible Solutions

- Reinstall the bidet and adjust the position of the bidet to ensure that the nozzle can fully extend to work.
- Make sure the water supply is on.

If you have a problem not mentioned here, or the above troubleshooting can not solve your problem, please email us at [support@aborderproducts.com](mailto:support@aborderproducts.com), and we will provide assistance.

### Warranty Information

#### TWO YEARS NON-TRANSFERRABLE LIMITED WARRANTY

To provide customers with quality shopping and user experience, we guarantee to replace or issue a refund or provide acceptable solutions for any defective products (as customers prefer) from the date of purchase to 2 years.

Proof of purchase must be provided (Amazon order number or receipt) when making a claim to our customer support center.

The warranty is not transferrable. We only provide warranty services to buyers who purchased from our Amazon store and possess the purchase proof, and not to any other purchaser or subsequent owner.

Price matching policy is not applicable. No price difference refund.

Sellers are the responsible party. Amazon allows different sellers to sell the same product, so please confirm the seller by checking the order details before contacting us.

### What Is Covered

- Received defective or used (proof needed) products;
- Received with missing parts;
- Defective item under proper use.

### What Is Not Covered

- Purchased from non-Amazon channel or other physical stores;
- Gift without proof of purchase;
- Tampering/ abnormal use/ accidental damage or commercial use;
- Replacements and parts;
- Installation fee/ labor fee.

### Making A Claim

If you have any problems when using our products, you can choose any of the methods to reach out to us.

Toll free: 1-888-281-8150 (Monday-Friday 9am-5pm CST)  
Email: support@aborderproducts.com (Monday-Friday 9am-5pm CST)

30 days free return or exchange for any reason  
2 YEARS product warranty ((For any product quality issues, free return or replacement will be provided))

Gifted parts, replacements, consumable products are not covered by the 2-year warranty.

Manufacturers' warranties may not apply in all cases, depending on factors such as use of the product, where the product was purchased, or who you purchased the product from. Please review the warranty carefully, and contact the manufacturer if you have any questions.

Manufacturer: Xiamen Soothingware Sanitary Co., Ltd.  
Address: Industrial Plant, Unit 501, No.566-568 Banqiao Road, Jimei District, Xiamen.