



MOWERS



Mower-P



Mower-S

Operating & Maintenance Manual

INDEX

1. SPECIFICATIONS	1
2. SYMBOLS & WARNINGS	2
3. OPERATION	5
3.1. Operating Controls	5
3.2. Assembly Instruction	6
3.3. Engine Starting	6
4. MAINTENANCE & STORAGE	8
4.1. Engine	8
4.2. Blade	8
5. TERMS OF WARRANTY	10

Congratulations on selecting the Dayliff Mower. They are manufactured to the highest standards and if operated correctly will give many years of efficient and trouble free service. Careful reading of this Installation Manual is therefore important, though should there be any queries they should be referred to the equipment supplier.

1. SPECIFICATIONS

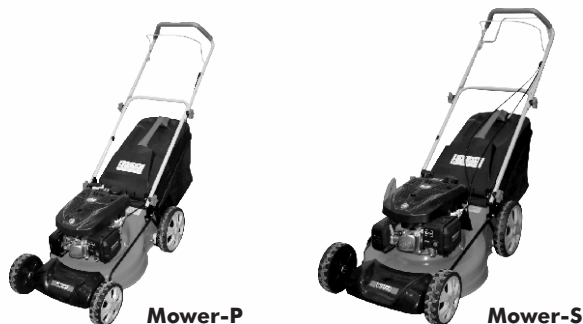

Dayliff MOWERS are high specification rotating blade type mowers suitable for general lawn maintenance in residential and small commercial applications. They are available in either self-propelled or push versions. Hand push MOWER-P models feature a 45cm grass cutting width while for powered MOWER-S models it is 50cm. Other features include:-

- Reliable and economical 4-stroke OHV vertical Euro V compliant petrol engines with recoil start and 0.9 litre fuel tank
- Seven position adjustment that provides for grass cutting heights between 25 to 75mm
- Robust frame fitted with large size 20cm front and 25cm rear wheels for ease of manoeuvring
- Strong collapsible tubular operating handle for compact storage fitted with easy to use self-closing engine control bar
- Options of mulching, rear grass collection or side grass discharge
- Large capacity 70L nylon bag grass collector with plastic cover

Dayliff MOWERS are robust and highly effective quality products carefully designed to make lawn mowing easy and are the ideal solution for all lawn care requirements.

Model	Mower-P	Mower-S
Engine Model	GK150FE	GK170FE
Displacement (cc)	150	175
Max/Rated Power (HP)	4/3.5	4.5/4
Drive	Hand Push	Self Propelled
Cutting Width (")	18	20
Dimensions (LxW) mm	850x575	954x610
Dry Weight (Kg)	34	37

2. SYMBOLS & WARNINGS



User must read the instruction manual before operation of the Dayliff mower.



Ensure the blade and all moving parts are stopped before cleaning, repairing or inspecting the machine.



Before carrying out any operation, stop the engine and disconnect the spark plug cap.



Keep hands and feet away from the cutting blade.



After the mower has stopped, the blade will continue to rotate for a while. Do not move the mower until it has stopped completely.



Use safety equipment such as safety goggles and boots when mowing



Do not mix gasoline and oil with a four-stroke engine. The mower has two separate storage tanks for oil and fuel.



Do not run the engine in an enclosed and/or poorly ventilated area else the engine may emit carbon monoxide which is harmful.



The lawn mower is to be used exclusively for cutting natural grass. Any other use can cause danger to the user and damage to the mower.



The mower is to be operated by a qualified personnel without mental incapacitation.



The user is responsible for the safety of other people in the working area. Children and animals are to be kept at a safe distance away from the mower in use.



Before mowing, remove all foreign objects from the lawn which may be thrown by the machine. Be on the look out for any foreign object which may have been missed.



Before mowing, place the grass catcher in position.



Before mowing, make sure that the blade and the blade fixing screws are securely fastened. When cutting edges requires resharpening, this must be done evenly on both sides, in order to prevent any imbalance. If the blade is damaged it must be replaced.



The lawn mower should be operated only when there is sufficient light.



Do not use the lawn mower when it is raining or when the grass is wet.



Particular precautions must be taken while mowing on slopes . Mow across the slopes and not uphill or downhill.



Turn off the engine if the mower is to be left unattended.



Do not lift the rear of the mower while starting the engine. Also do not place hands and feet underneath the deck or into the rear discharge chute while the engine is running.



Do not interfere with the rated speed of the engine.



For Mower-S disconnect the self propelled system before starting the engine.



Always use the lawn mower with the grass catcher or/and the deflector in position.



Stop the engine before emptying the grass catcher or adjusting the cutting height.



If the mower vibrates in an abnormal way take the mower to an authorized service centre.



Fill up the tank with a funnel, do the operation outside. Do not smoke. Do not use mobile phone.



Fill up with gasoline and oil before starting the engine. Never open the cap of the fuel tank to add gasoline while the engine is running or still hot.



Do not start the engine if there is some gasoline spread around, take the mower away from the area where gasoline has been spilt and avoid any contact from a hot source until spilt gasoline is completely removed



Tighten the fuel tank cap and close tightly the jerry can cap.

3. OPERATION

3.1 Operating Controls

1.	Upper Handle	9.	Deflector	b	Drive Cable
2.	Lower Handle	10.	Mulcher		
3.	Engine Control Bar	11.	Recoil Starter		
4.	Throttle Control	12.	Nut Knobs		
5.	Engine	13.	Height Adjustment Lever		
6.	Cutter	14.	Wheels		
7.	Grass Catcher	15.	Side Cover		
8.	Propeller Bar	16.	Discharge Open		

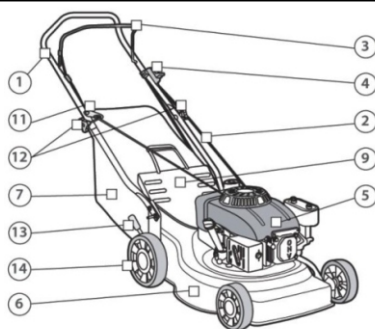

Hand Push Mower

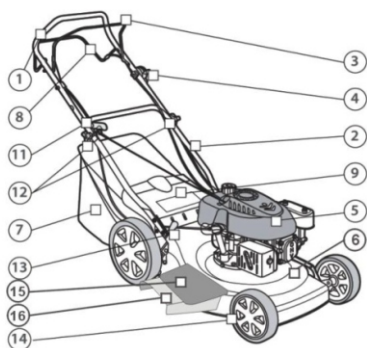

Mower with Side Discharge

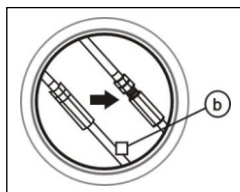
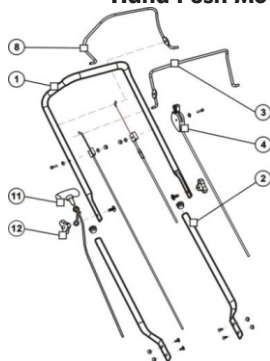
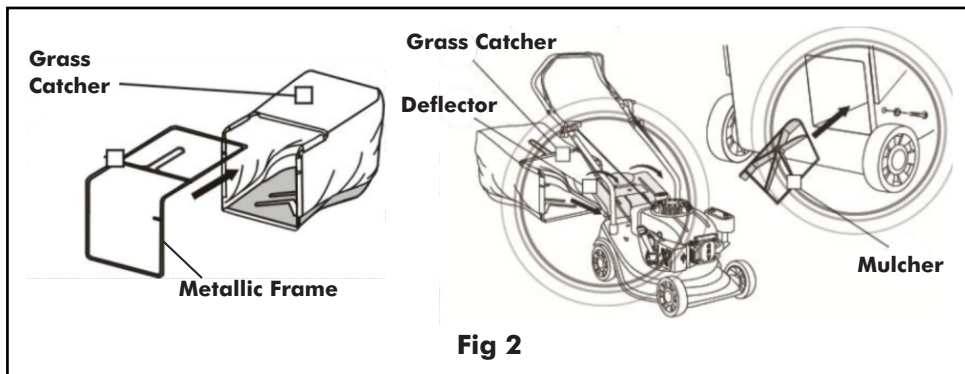

Fig 1

3.2 Assembly Instructions

Grass Catcher

- Put the metallic frame inside the grass catcher and fit in position.
- Pull the deflector and place the grass catcher in its place.



Mulching Option

- Place the mulcher inside the grass evacuation place.

Handle

- Open out the handle and screw the handles parts with the two screws and plastic nuts.
- Join upper and lower handle with the two nut knobs and its screws provided.
- Put the recoil starter on the right of the handle and fix the cable with the plastic collar.
- Introduce the rope of the recoil starter on its support guide rope.

Cutting Height Adjustment

Wheels dependent adjustment:

- Set the desired height, tightening wheel by wheel at the same high position.

Central Height Adjustment

- Set the desired height by pulling and turning the height adjustment lever.

Side Discharge Option

- Pull upwards the side cover, attach the discharge open onto the deck and release the side cover .

3.3 Engine Starting



Engine is delivered without engine oil: add 0.6 litres of oil before starting the engine.

Once the mower has been set up properly, start the engine as follows:

- Put the throttle control on the **START** position.
- Take the engine control bar and maintain it against the superior handle, pull on the recoil starter handle until you can feel resistance and then pull hard
- Put the lever on **RUN** position.
- Blade is in action as soon as the engine starts. While the machine is working, maintain the throttle control in working position. The engine will stop as soon as you release the engine control bar.

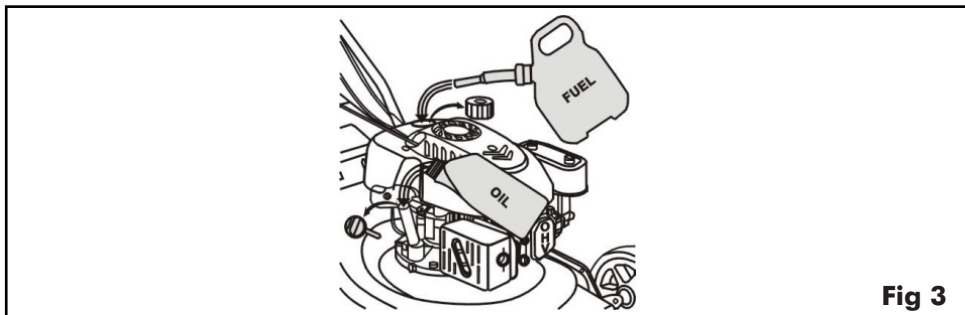

Fig 3

- To engage the self propelled system, pull the propeller bar of the upper handle and maintain it engaged together with the engine control bar .



Regularly check the self propelled system. Polish and grease the gears in the wheels.

- If the drive system does not engage and disengage correctly, check the handle for correct assembly. Make sure that all parts are in good condition and that the fasteners are tight.
- The drive system can slip if the drive cable is too loose.
- If the drive system slips shorten the cable by turning the cable nut and test the drive system.
- If the drive system still slips repeat the adjustment and test until the drive system does not slip.
- Before mowing, make sure the drive system will correctly disengage and that the mower will stop. If the drive system does not disengage, take the lawn mower to an authorized service centre for checking.
- Ensure that all cables are firm enough.

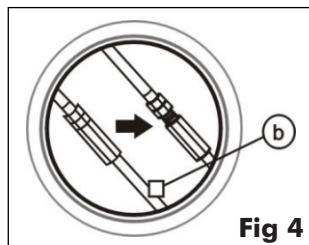

Fig 4

4. MAINTENANCE & STORAGE

4.1 Engine



Stop the engine and unplug the spark plug before any repair or maintenance operation which includes removing and emptying grass catcher, chute, changing blades adjusting cutting heights among others.

- Make sure that all nuts, bolts and screws are kept well tightened to keep the lawn mower in a safe operating condition.
- Never store the lawn mower filled with gasoline in an enclosed area where gasoline fumes could reach a strong heat source or a flame. Allow the engine to cool down before storing it.
- In order to reduce risk of fire, clean the lawn mower particularly the engine, the muffler and the fuel tank. Remove all traces of grass leaves or excess grease.
- Check the condition of the deflector and the grass catcher, frequently replace them if there is any damage.



Do not leave a running mower unattended.

- Wear thick gloves before mounting or sharpening the blade. Be sure that the bandblade is always well balanced.
- Check regularly the oil level and add some oil or replace it if necessary.
- Frequently check the lawn mower and make sure that all grass deposits are removed from beneath the deck.
- Lubricate the wheel axle and the bearing with grease regularly.
- For a clean cut, the blade should always be sharpened and well balanced.
- At regular intervals all bolts and screws should be checked if tight. Worn off or badly tightened nuts and bolts can cause damage to the engine and the frame.



After hitting a foreign object, stop the engine and check if the mower is damaged. Take the mower to an authorized service centre if necessary.

4.2 Blade



Wear gloves, stop the engine and unplug the spark plug before proceeding with below operations

The blade is made of pressed steel for optimum performance, it should be well sharpened about every 25 hours of work.

- A small spindle (2 or 3mm of diameter) should be introduced in the central hole of the blade: which should stay horizontal. If the blade does not stay horizontal, balance it by taking off some metal on the lower side.

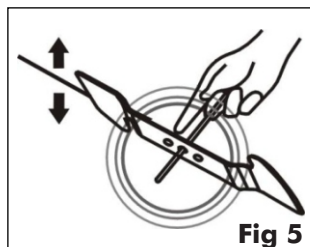

Fig 5



Use only Dayliff original spare parts. Any other spares parts can lead to serious damage to the lawn mower and void the warranty.

- To remove the blade, unscrew it, check the blade support and change all spare parts if they are worn out or damaged.
- To sharpen the blade, place it in a vice and file the cutting edge evenly.
- When reassembling the blade, make sure that the cutting edges face in the direction of the engine's rotation. The blade screw must be tightened to (37Nm) with an appropriate tool.

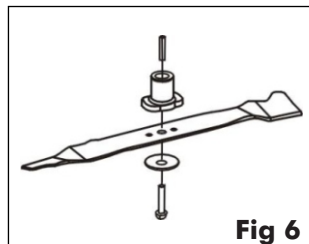

Fig 6

5. TERMS OF WARRANTY

I) General Liability

- In lieu of any warranty, condition or liability implied by law, the liability of Davis & Shirliff (hereafter called the Company) in respect of any defect or failure of equipment supplied **is limited to making good by replacement or repair** (at the Company's discretion) defects which under proper use appear therein and arise solely from faulty design, materials or workmanship within a specified period. This period commences **immediately after the equipment has been delivered to the customer** and at its termination all liability ceases. Also the warranty period will be assessed **on the basis of the date that the Company is informed of the failure.**
- This warranty applies solely to equipment supplied and **no claim for consequential damages**, however arising, will be entertained. Also the warranty specifically excludes defects caused by fair wear and tear, the effects of careless handling, lack of maintenance, faulty installation, incompetence on the part of the equipment user, Acts of God or any other cause beyond the Company's reasonable control. Also, any repair or attempt at repair carried out by any other party **invalidates all warranties.**

ii) Standard Warranty

General Terms

If equipment failure occurs in the normal course of service having been competently installed and when operating within its specified duty limits warranty will be provided as follows:-

- **Up to 1 year - The item will be replaced or repaired at no charge.**

The warranty on equipment supplied or installed by others is conditional upon the defective unit **being promptly returned free to a Davis & Shirliff office** and collected thereafter when repaired. No element of site repair is included in the warranty and any site attendance costs will be payable in full at standard chargeout rates. Also proof of purchase including the purchase invoice must be provided for a warranty claim to be considered.

DAYLIFF is a brand of **Davis & Shirtliff**
for enquiries contact

Davis & Shirtliff, Ltd.

P.O. Box 41762 - 00100, Nairobi, Kenya

Tel: 6968000/ 0711 079 000

or visit

www.dayliff.com

for details of the nearest branch or stockist