



MAKE A DIFFERENCE

Roof Rack

BXG.8906-3S
(INSTALLATION INSTRUCTION)

ATTENTION • Please verify all parts are present and read instructions carefully before starting installation.
Please feel free to contact your distributor if you have any kind of question about your purchase.

CONTENTS

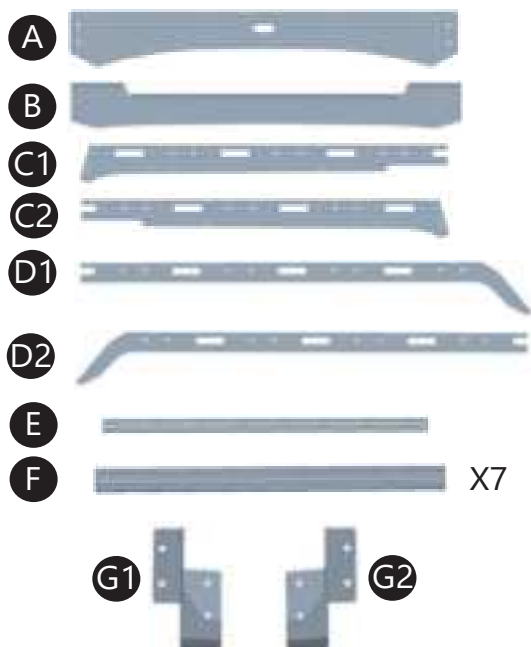

A: Front Fairing
B: Rear Fairing
C1&C2: Rear Side Rails
D1&D2: Front Side Rails
E: Short Crossbar
F: Crossbars
G1&G2: Front Supports
H1&H2&H3&H4: Middle Supports
I1&I2&I3&I4: Rear Supports
J1&J2: Connect Parts

Qty	Part Name	Size(mm)	Picture	Qty	Part Name	Size(mm)	Picture
8	Button Bolts	M8*25		12	Flat Washers	M6*16*1	
8	Button Bolts	M8*20		8	Flat Washers	M6*12*1	
28	Button Bolts	M8*16		12	Flange Hex Lock Nuts	M8	
12	Button Bolts	M6*20		16	Flange Hex Lock Nuts	M6	
8	Button Bolts	M6*10		8	T-nuts	M6	
44	Flat Washers	M8*20*1					

2 TOOLS REQUIRED

◆ Drive Ratchet Handle

◆ 4mm, 5mm Hex Bit Socket

To view online instruction, please scan the QR code.



3 INSTALLATION INSTRUCTION

Step 1

Remove the front factory covers. See the figure below to locate the proper installation position.

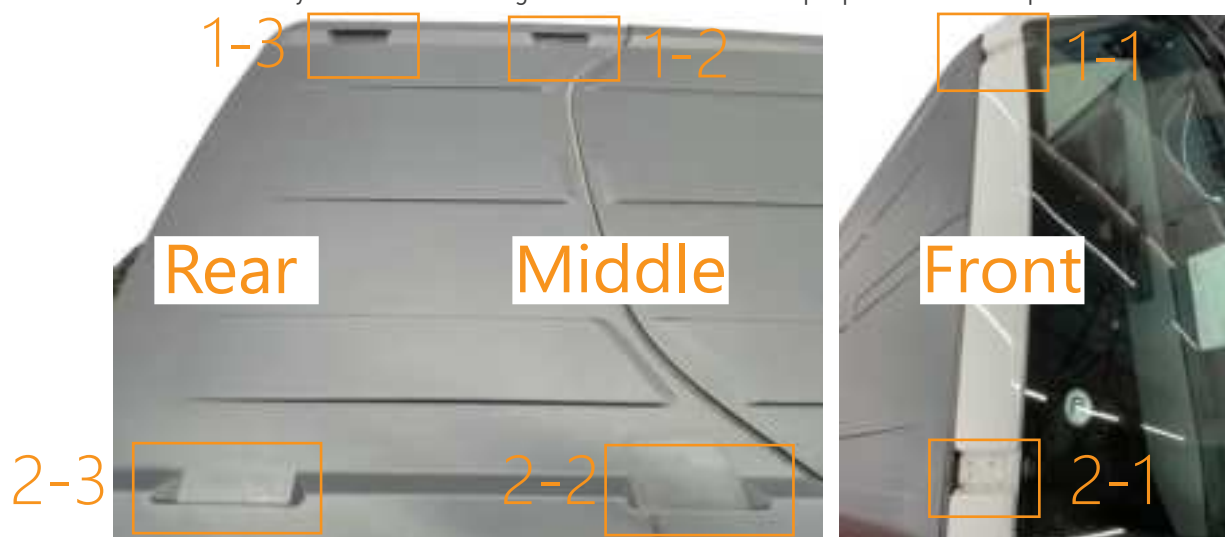

Step 2

(Rear Parts Assembly) Tighten all bolts.

- (3) Crossbars
- (2) Rear Side Rails
- Rear Fairing
- (4) M8x20 Button Bolts
- (12) M8x16 Button Bolts
- (16) M8x20x1 Flat Washers
- (4) M8 Flange Lock Nuts



Step 3

(Middle & Rear Supports Identify & Assembly) Repeat this step for the remaining rear supports. **Don't fully tighten to allow adjustability.**

• (8) M8x25 Button Bolts

• (8) M8x20x1 Flat Washers

• (8) M8 Flange Lock Nuts

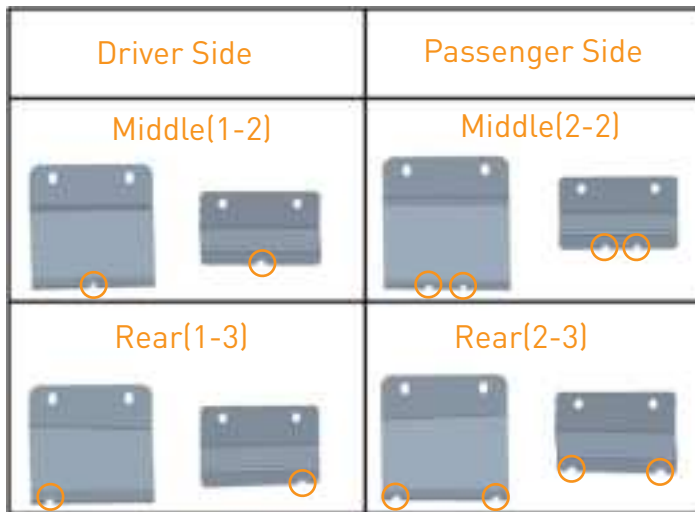

1-2

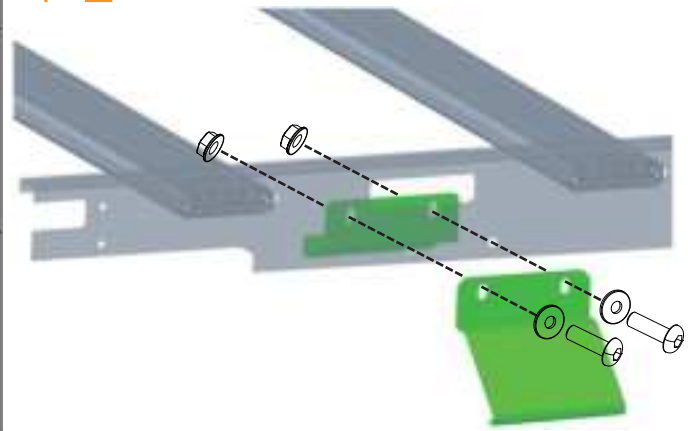

Step 4

Mount the rear roof rack, ensuring the bracket screws remain adjustable.



Step 5

(Front Faring Assembly) Tighten all bolts.

• Short Crossbar

• (8) M6x10 Button Bolts

• (8) M6x12x1 Flat Washers

• (8) M6 T-nuts

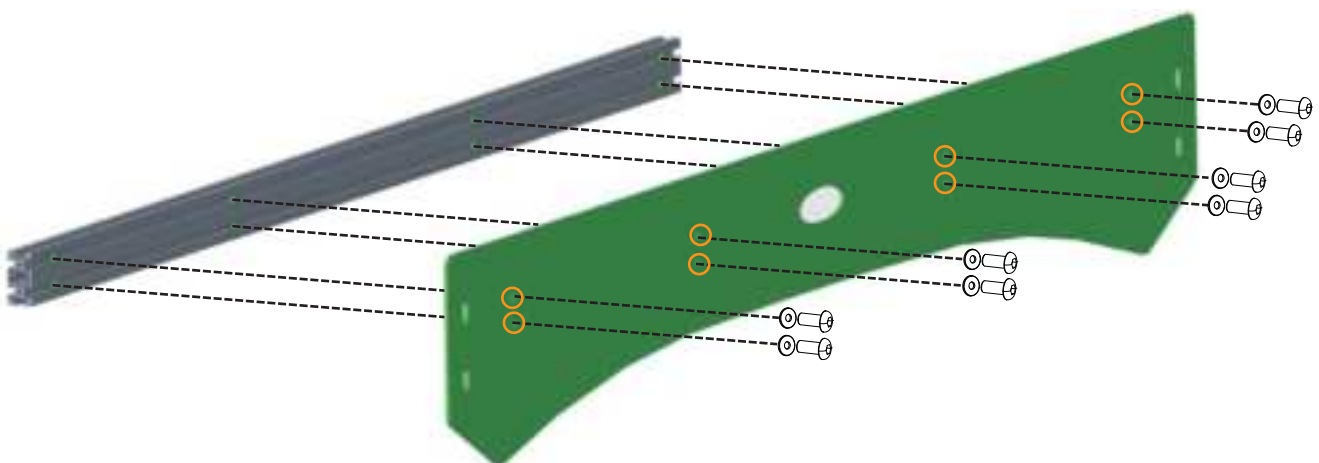

Step 6

(Front Side Rails Assembly) Tighten all bolts.

• (4) Crossbars

• (16) M8x16 Button Bolts

• (16) M8x20x1Flat Washers

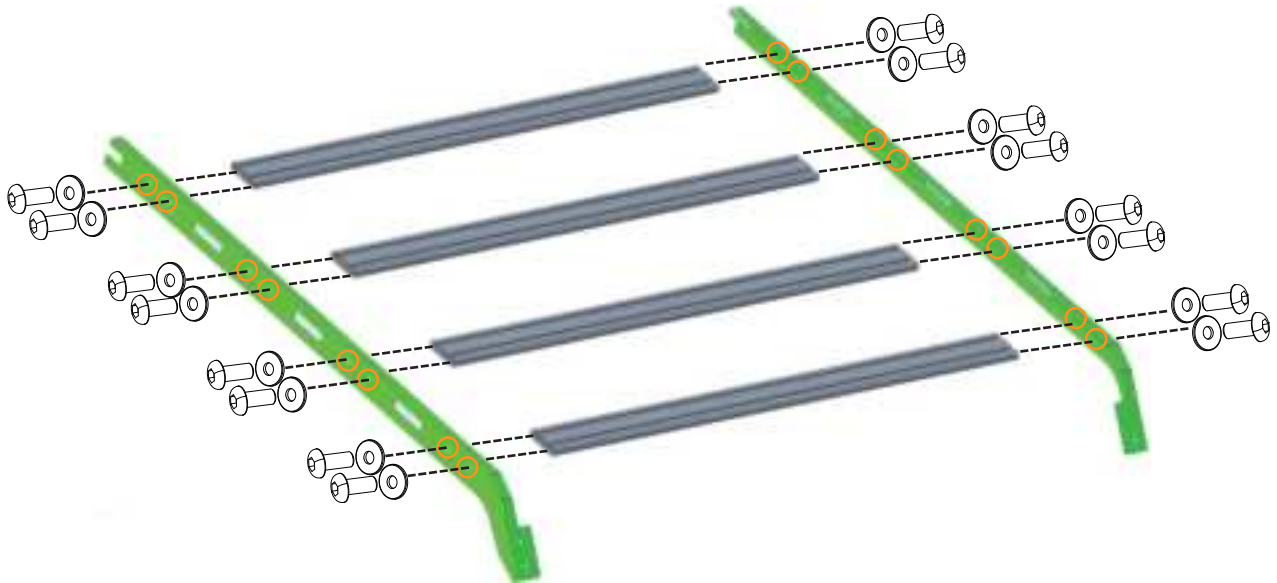
**Step 7**

(Install Front Supports) Repeat this step for the opposite of the vehicle. Tighten all bolts.

• (4) M6 Flange Lock Nuts

Drive Side

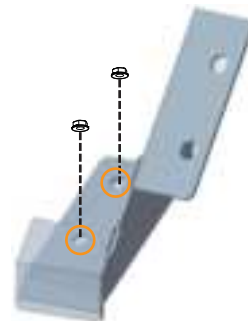
**Step 8**

(Front Parts & Front Supports Assembly) Repeat this step for the opposite of the front support. Do not fully tighten to allow adjustability.

• Front Fairing

• (2) Front Side Rails

• (4) M8x20 Button Bolts

• (4) M8x20x1Flat Washers

Drive Side

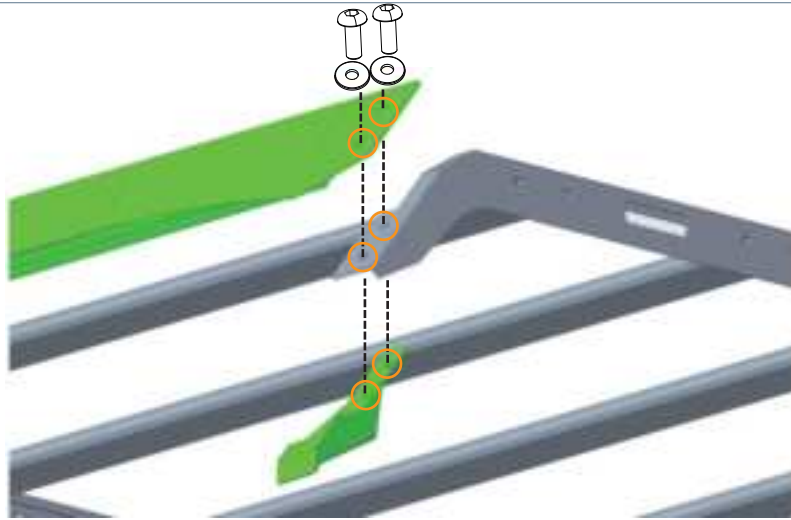

Step 8**Step 9**

(Connect Parts & Side Rails Assembly) Repeat this step for the opposite of the roof rack. Tighten all hardware to secure the roof rack to the vehicle.

- (12) M6x20 Button Bolts
- (12) M6x16x1 Flat Washers
- (12) M6 Flange Lock Nuts

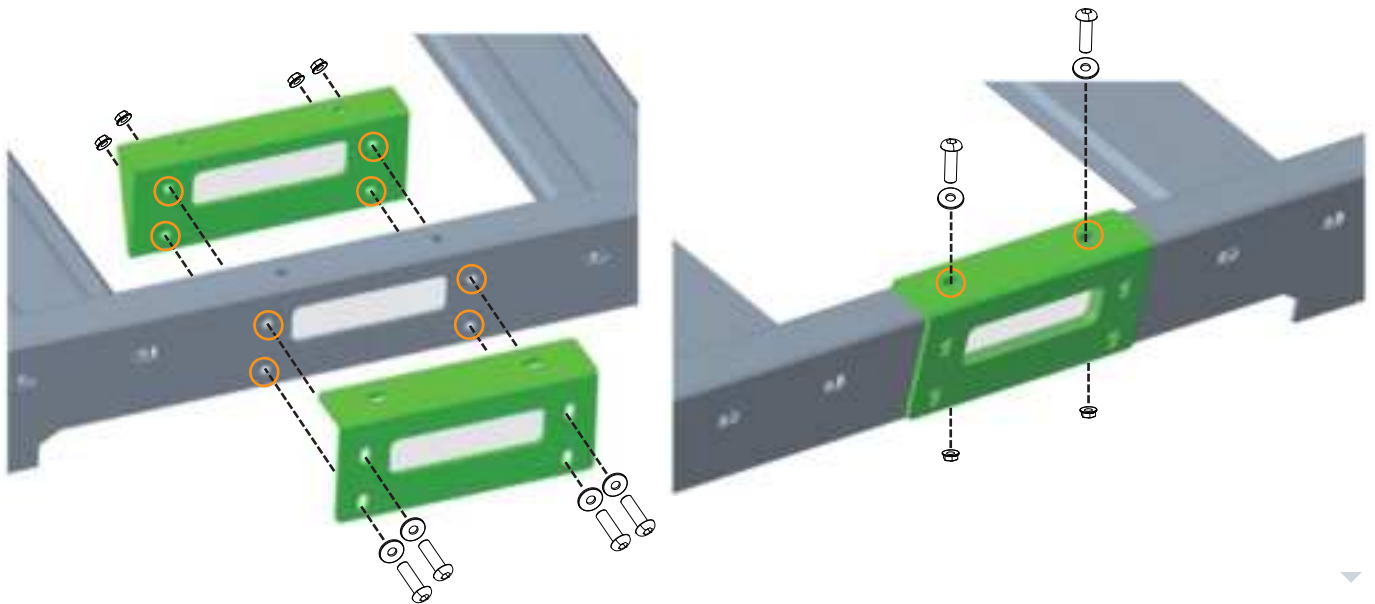
**Step 10**

The installation is complete. We hope you enjoy a wonderful off-road life with this quality Hooke Road product!

