

# HEINNER

## VERTICAL VACUUM CLEANER

Model: HSVC-V29.6IWH / HSVC-V29.6SBK



- Vertical vacuum cleaner
- Power: 350W
- Suction power: 23kPa

[www.heinner.ro](http://www.heinner.ro)

Thank you for choosing this product!

## I. INTRODUCTION

***Before using the appliance, please read carefully this instruction manual and keep it for future reference.***

This instruction manual is designed to provide you with all required instructions related to the installation, use and maintenance of the appliance.

In order to operate the unit correctly and safety, please read this instruction manual carefully before installation and usage.

## II. PACKAGE CONTENT

- Vacuum cleaner
- Crevice
- Bending brush
- Charging adaptor
- User manual
- Warranty card



### III. SAFETY WARNING

1. Read this instruction booklet carefully.
2. This appliance is for domestic use only. Use as described in this instruction booklet.
3. Before using this appliance, check that the mains power voltage corresponds to the voltage shown on the rating plate.
4. Do not use the appliance to vacuum all the latter things:
  - water and other liquids
  - lighted stub, hot ashes and other combustible things
  - sharp matter
  - wood pieces, gesso, cement, calcimine and other tiny granules
5. Keep the vacuum cleaner away from stoves and heat-emitting appliance. Heat can deform and discolor the plastic parts of unit.
6. Always remove the plug from the power socket when the appliance is not in charging.
7. Never use spirits or other solvents to clean the appliance.
8. Never leave the appliance unattended when it is switched on. Keep the appliance out of the reach of children or the infirm.
9. Do not switch the appliance on if it appears to be faulty in any way.
10. This appliance can be used by children aged from 8 years and above the persons with reduced physical, sensory or mental capabilities or lack of experience and knowledge if they have been given supervision or instruction concerning use of the appliance in a safe way and understand the hazards involved. Children shall not play with the appliance. Cleaning and user maintenance shall not be made by children without supervision.
11. Operate the appliance from a power source of the same voltage frequency and rating as indicated on the product identification plate.

#### IV. DESCRIPTION OF THE VACUUM CLEANER

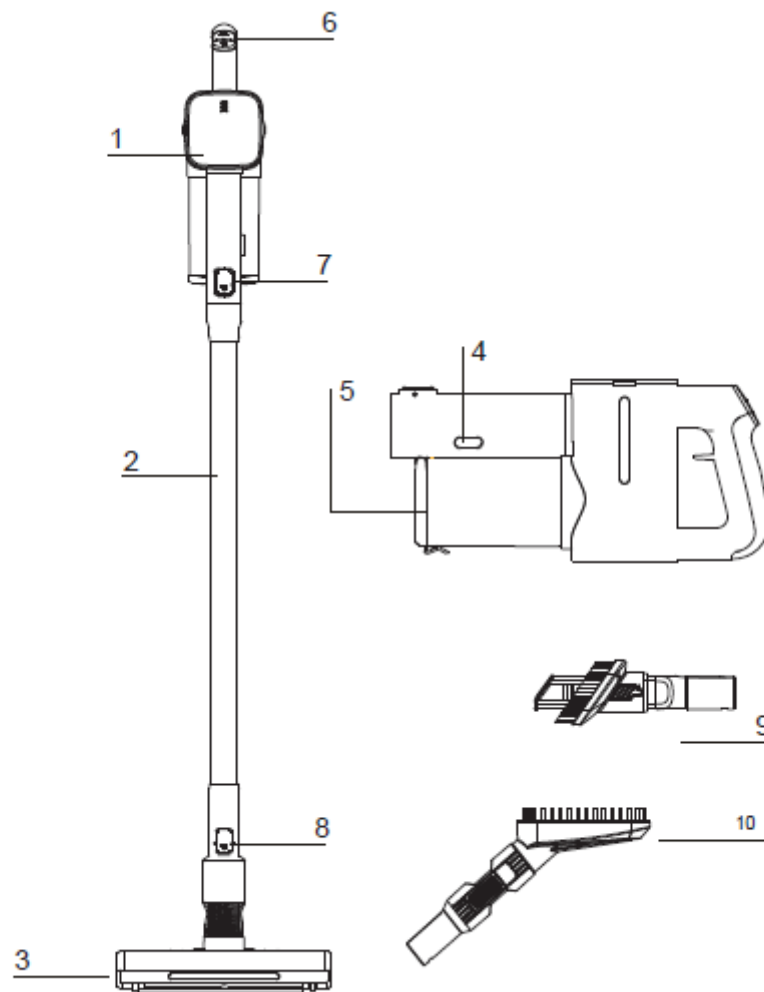

1. Vacuum cleaner main unit
2. Aluminum tube
3. Electrical floor brush
4. Dust bin release knob
5. Removable dust bin
6. ON/OFF button
7. Aluminum tube release knob
8. Scrubbing brush release knob
9. Brush
10. Bending brush
- 11.

## V. ASSEMBLY

### Note:

Before assembly, please ensure that you have received all parts listed in the parts list

Note: Always remove the plug from the power socket before fitting or removing accessory.

### Assembling the cordless vacuum cleaner

#### 1. Assembling the aluminum tube

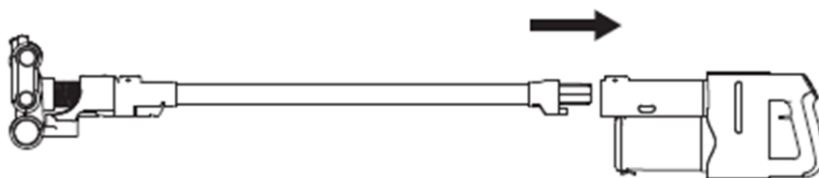

Fit the tube onto the main body's air inlet until it clicks into the position.

If need to remove the tube, hold the main body, press the release knob and remove the tube.

#### 2. Assembling the electrical floor brush

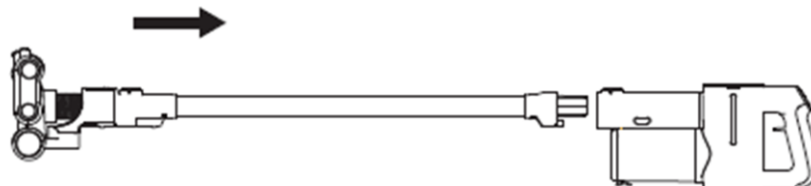

Fit the electrical floor brush on the tube until it click into the position.

If need to remove the electrical floor brush, hold the aluminum tube, press the floor brush release knob and remove the brush from the tube.

#### 3. Assembling the bending brush

Fit the accessory on the main body's air inlet and/or on the tube until it clicks into the position. The bending brush is good for cleaning stairs, in corners and awkward crevices.

## VI. USING THE APPLIANCE

### Charging the vacuum cleaner

Untied the cord, insert the plug into the power supply.

**Important!** The vacuum cleaner is powered by connecting the charging cable to the wall stand, according to the picture. We recommend installing the wall stand for easier storage and efficient powering.

After charging, unplug and tie the cord together.

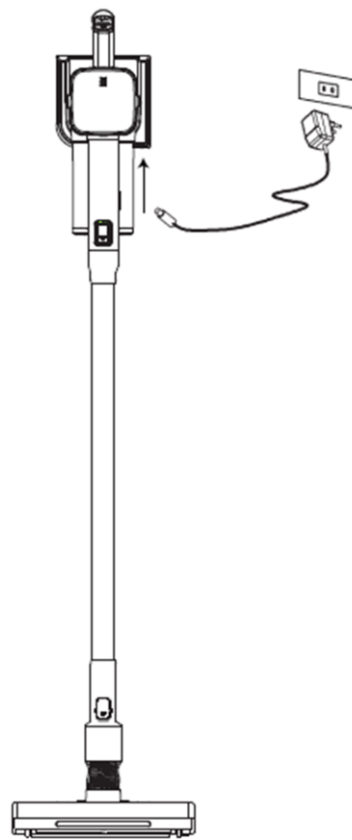

### Using the bending brush

For cleaning stairs, in corners and awkward crevices.

## VII. MAINTENANCE

### Filter replacement and cleaning

1. Turn off the cordless vacuum cleaner.
2. Press the dust bin release knob, remove the dust bin
3. Come up with the filter, empty the dirt inside
4. Cleaning the filter in water, wait for it to dry completely.
5. Put the filter back into the dust bin carefully.
6. Put the dust bin back into the main body.

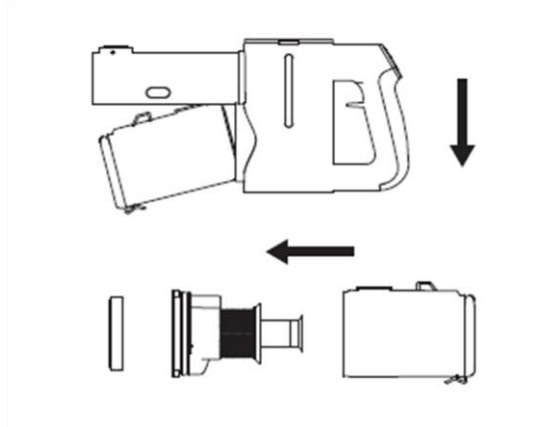

### Rotating brush cleaning

1. Turn the brush bottom screw to unlock position (pictured).
2. Open the brush bottom fixed device.
3. Show brush, clean the rotating brush on the twisting thing.
4. Put the rotating brush back.
5. Turn the brush bottom screw to lock position.

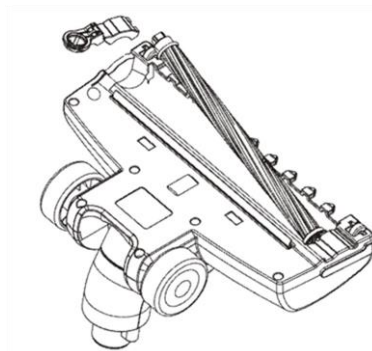

**WARNING:** The plug must be removed from the power socket before any maintenance or replacement.

**NOTE:** to maximize the performance of the vacuum cleaner, you should clean your filters regularly.

**VIII. TROUBLE SHOOTING**

Problem	Possible reason	Active
Motor does not start	<ul style="list-style-type: none"><li>- Power cord not firmly plugged into outlet</li><li>- Outlet damaged</li><li>- Cleaner not switch</li></ul>	<ul style="list-style-type: none"><li>- Plug unit firmly</li><li>- Check the outlet</li><li>- Switch on the appliance</li></ul>
Suction power is weaker	<ul style="list-style-type: none"><li>- Unit clogged</li><li>- Dust filter needs cleaning</li><li>- Dust container not in position</li><li>- Filter blocked</li></ul>	<ul style="list-style-type: none"><li>- Remove the blockage</li><li>- Clean the dust filter</li><li>- Close the dust container</li><li>- Clean the filter</li></ul>
The dust bin container cannot be closed	Dust filter is not in the position	Fix the dust filter and try again

**Warning:**

If the supply cord is damaged, it must be replaced by a qualified person in order to avoid a hazard.

**Environment**

BATTERIES - Discarded batteries are environmentally friendly and disposed of it in accordance with applicable regulations.

- Discharge the battery by running the appliance to stop the engine at idle.
- Remove the battery from the appliance.
- Dispose of the battery to a collection of chemical waste from.



## IX. TECHNICAL DETAILS

Power	350W
Suction power	23 kPa
Battery Li	29.6V
Voltage	100-240V~50/60Hz
Noise level	ECO <70dB, MAX <80dB
Dust bin capacity	0.35 L

**Environment friendly disposal**

You can help protect the environment!

Please remember to respect the local regulations: hand in the non-working electrical equipment's to an appropriate waste disposal center.



**HEINNER** is a registered trademark of **Network One Distribution SRL**. Other brands and product names are trademarks or registered trademarks of their respective holders.

No part of the specifications may be reproduced in any form or by any means or used to make any derivative such as translation, transformation, or adaptation without permission from NETWORK ONE DISTRIBUTION.

Copyright © 2013 Network One Distribution. All rights reserved.

[www.heinner.com](http://www.heinner.com), <http://www.nod.ro>

<http://www.heinner.com>, <http://www.nod.ro>



This product is in conformity with norms and standards of European Community.

Importer: **Network One Distribution**

Marcel Iancu Street, 3-5, Bucharest, Romania

Tel: +40 21 211 18 56, [www.heinner.ro](http://www.heinner.ro), [www.heinner.com](http://www.heinner.com)