

Montpellier

DOMESTIC APPLIANCES LTD

LAUNDRY DISHWASHING COOKING COOLING

Installation & Operating Instructions



Fridge Freezer in White
MDAS144W

Please read these instructions carefully before attempting to install or use this appliance.
We recommend that you keep these instructions in a safe place for future reference.

Thank you for choosing this Montpellier appliance.

Your appliance has been designed to provide you with the best combination of style, reliability and performance, to give you years of trouble-free use.

You may be familiar with a similar product, but please take the time to read these instructions carefully before installing or using your appliance to ensure that you get the most from your purchase and keep the manual for future reference.

The design and specifications are subject to change without prior notice for product development.

Your appliance is covered by a comprehensive two year Parts & Labour Guarantee. In the unlikely event that you experience a problem with your appliance, you can rest assured that you are fully protected against the cost of repairs for the first 24 months. Please note that any claim must be accompanied by the model reference number, serial number and proof of purchase.

To activate your guarantee, you will need your product serial number. This can be found inside your appliance.

NB: Please make sure that you keep a copy of your original sales invoice as this will be needed if any service call is required.

There are three ways to register your Guarantee:

Online: Visit the Support page on our website and complete the online Product Registration form.

www.montpellier-appliances.com

By Post: Simply detach and fill in the form provided, attach a stamp and send it in the post. Don't forget to include your e-mail address so that we can send confirmation through to you.

By Phone: Contact our warranty registration department on **08081 961 388**

Montpellier
montpellier-appliances.com

2

**YEAR
GUARANTEE**
PARTS & LABOUR
ACROSS ALL OUR MODELS

Icon	Type	Meaning
	Warning	Serious injury or death risk
	Risk of electric shock	Dangerous voltage risk
	Fire	Warning, risk of fire / flammable materials
	Caution	Injury or property damage risk
	Important	Operating the system correctly

CONTENTS

Safety Information

General Safety.....	4-5
Starting Off.....	5-6
Installation.....	6-7

General

Reversing the Door.....	8-10
Locating the Appliance.....	10
Appliance Users.....	10
Getting to Know your Appliance.....	11

Operation

Operating the Appliance.....	12
Daily Use.....	12-13
Food Storage.....	13

Advice

Maintenance.....	14
Troubleshooting	14-15
Service.....	15

Here for You – Service Details.....	16
-------------------------------------	----

DEAR CUSTOMER:

Thank you for buying this Fridge/Freezer. To ensure that you get the best results from this appliance, please take time to read through the simple instructions in this booklet. Please ensure that the packing material is disposed of in accordance with the current environmental requirements. When disposing of any freezer equipment please contact your local waste disposal department for advice on safe disposal. This appliance must only be used for its intended purpose.

1) Putting Your Safety First

General Safety Instructions

Read these instructions carefully before using your appliance and keep this manual for future reference. Please keep a copy of this manual with the appliance so other future users can be instructed in the safe operation of the appliance.

Ensure that there is always sufficient ventilation around the appliance and that it is free from any obstructions.

Don't pack food items closely together. Please ensure that air can freely circulate around the appliance between the food stuffs.

Do not use mechanical devices or other means to accelerate the defrosting process, other than those recommended by the manufacturer.

Do not damage the refrigerant circuit.

Do not use mechanical devices such as ice cream makers inside the appliance, unless they have been approved for this use by the manufacturer.

Do not touch the light bulb if it has been illuminated for an extended

period of time. It will become hot and possibly cause burns.

Do not trap, pinch, squash or damage the electrical supply cord when positioning the appliance.

Do not use extension leads, multiple plugs or portable power supplies at the rear of the appliance.

The refrigerant Isobutane (R600a) is contained within the refrigerant circuit. This is a natural gas with a high level of flammability but is environmentally compatible.

During transport and installation, be certain that none of the components of the refrigerant circuit become damaged.

Avoid open flames and sources of ignition.

Do not alter the specification or modify this appliance in any way. It is dangerous and will invalidate your warranty.

Any damage to the electrical supply cord may cause a short circuit, fire or electric shock.

This appliance is only intended for use in domestic environments. It is not designed for commercial or professional use outside of a domestic setting.

Any electrical components (plug, Power cable, compressor etc) must

be replaced by qualified and certified service agent.

The light bulb supplied with this appliance is a "Special use lamp bulb" usable only with this appliance. This "Special use lamp bulb" is not usable as domestic lighting.

Make sure the plug is not squashed or damaged by the back of the appliance. Do not remove the plug by pulling on the mains cable. If the socket is loose, do not insert the plug. The power cord must not be lengthened.

This appliance is heavy. Care should be taken when moving it.

Do not remove or touch items from the freezer compartment if you have wet or damp hands. This could cause skin abrasions or frost/freezer burns.

Do not position the appliance in direct sunlight. This may affect the performance of the appliance.

2) Starting Off

Before First Use

Unpack and inspect the appliance. If there are any signs of damage, immediately report this to your retailer and retain the packaging if the appliance needs to be returned.

Once you are happy that the appliance is not damaged, remove the remaining packaging and securing tape from the appliance and dispose of it correctly, recycling any and all recyclable components.

If this appliance replaces an old appliance with a lock, remove the old door lock to ensure that no-one becomes trapped inside the appliance.

Disconnect the old appliance from the power supply. Then cut the power cable as close to the old appliance as possible and discard the appliance at the local WEEE recycling point. Alternatively, contact your local retailer or local council to ensure safe disposal.

Your old appliance contains insulation gasses and refrigerant that may be harmful to the environment and must be disposed of correctly. Please ensure the refrigerant circuit is not damaged before the appliance is taken away for correct disposal, in line with current legislation.

This appliance contains Isobutane (R600a). This is a natural gas with a high level of environmental compatibility; however, caution is required as Isobutane is flammable. It is essential to ensure that the refrigerant tubes are not damaged during transportation and

installation of the appliance. If the refrigerant circuit is damaged, avoid naked flames or sources of ignition and ventilate the room where the appliance is situated.

3) Installation

Getting Started

In the interest of safety and to ensure correct use, before installing the appliance, please read this manual carefully.

To avoid unnecessary mistakes and accidents, it is important to ensure that all people using the appliance are familiar with its operation and safety features.

Save the instructions and ensure they remain with the appliance if it is moved or sold so that anyone using the appliance will be properly informed of its use and safety.

The warranty is non-transferrable.

The manufacturer accepts no responsibility for the incorrect installation or use.

IMPORTANT – This appliance must be left to stand in an upright position for at least 4 hours before being switched on for the first time after transportation.

IMPORTANT – This appliance is designed for domestic use only. This refrigerating appliance is not designed to be used as a built in or integrated appliance.

Wash the interior of the appliance with lukewarm water containing a small amount of bicarbonate soda to remove any residue from the manufacturing process and the interior of a new appliance.

For the electrical connection carefully follow the instructions given.

There must be adequate air circulation around the appliance to avoid overheating. To achieve this, follow the relevant instructions for installation.

Wherever possible the spacers of the product should be against a wall to avoid the possibility of touching or catching parts that may become hot such as the compressor.

Connect the plug to an adjacent 13amp socket and ensure that the appliance is not trapping the power cable.

Make sure the plug is accessible after the installation of the appliance.

Position the appliance in an internal heated room, away from heat

sources such as radiators and cooking appliances and out of direct sunlight. Failure to do this may affect the performance of the appliance.

Leave a minimum of 2cm gap between appliances to avoid condensation build up.

Please ensure there is adequate air circulation around the sides and rear of the appliance.

Do not store heavy items on the appliance. And ensure there is a minimum of 5cm of clearance if placing the appliance below a shelf or cupboard.

Ensure the appliance is located on a solid floor such as Tiles, Stone, Laminate or Lino. Do not locate on a carpet or soft cushioned flooring.

Ensure the appliance is level. The 2 front feet are adjustable to achieve this.

Ensure the appliance is stable and upright and it's wheels/feet are in firm contact with the floor so the appliance does not wobble or rock when the door is opened.

Install the appliance in a location where the ambient temperature corresponds to the climate class indicated on the rating plate.

EXTENDED TEMPERATE (SN) –

This refrigerating appliance is intended to be used at ambient temperatures ranging from 10°C – 32°C

TEMPERATE (N) - This refrigerating appliance is intended to be used at ambient temperatures ranging from 16°C – 32°C

SUBTROPICAL (ST) – This refrigerating appliance is intended to be used at ambient temperatures ranging from 16°C – 38°C

TROPICAL (T) – This refrigerating appliance is intended to be used at ambient temperatures ranging from 16°C – 43°C

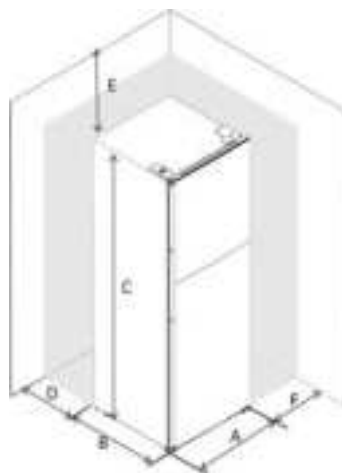

A	480
B	510
C	1440
D	min=50
E	min=50
F	min=50

4) Reversing the Door

The doors on this appliance can be reversed from being hinged on the right-hand side to the left. Please read and understand the following instructions before attempting this. If you do not feel confident performing this procedure, please contact your local retailer for support.

The manufacturer will not be held responsible for damages or loss of property if this procedure is incorrectly performed.

Ensure the product is disconnected from the mains electrical supply before beginning this process.

- 1) Begin with the top hinge. Prize off the hinge cover on the top right front corner of the appliance and remove the retaining screws.



- 2) Lift off the upper door and delicately place it on a soft surface to avoid damage.
- 3) Unscrew the middle hinge and lift off the lower door. Once again, place the lower

door on a soft surface to avoid damage



- 4) Move the hinge hole covers from the left to the right side.

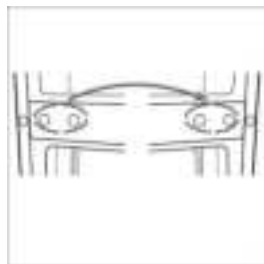

- 5) Tilt the appliance back to access the bottom hinge. Unscrew the adjustable feet and place to one side. Then detach the bottom hinge by undoing the screws.

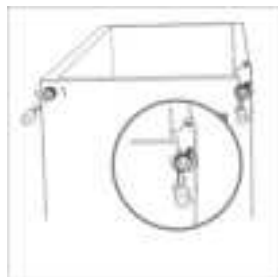

- 6) Unscrew and remove the bottom hinge pin from the mounting plate. Flip the mounting plate over and reattach the hinge pin to the bracket.

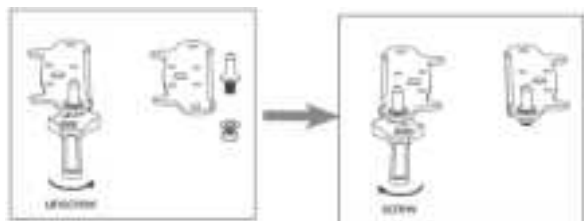

- 7) Reattach the bottom hinge to the left side of the appliance and attach the adjustable feet.

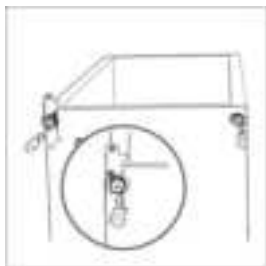

- 8) Place the bottom door on the lower hinge and line up the seal to ensure a tight fit. Reverse the direction on the middle hinge and reattach it to the left side of the appliance. Tighten up the screws.

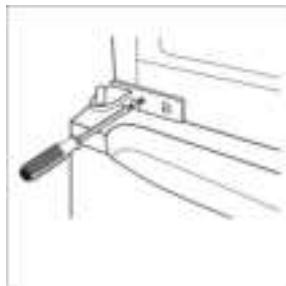

- 9) Place the upper door onto the middle hinge and line up the seal to ensure a tight fit. Unscrew the hinge pin from the upper hinge. Flip the hinge bracket 180° and reattach the hinge pin.

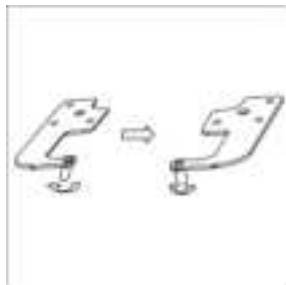

- 10) Remove the hinge hole cover from the top left of the fridge and reinsert it to the holes on the top right.



- 11) Reattach the top hinge to the left side of the fridge and move the hinge hole cover from the top left of

- 12) the fridge door and reinsert it on the top right.



- 13) Replace the top hinge cover over the top hinge. It will click when securely reattached.

5) Locating The Appliance

This appliance should be in a warm internal room. The appliance should not be in a position where the external air temperature surrounding the appliance falls below 10°C. Positioning the appliance in a garage, cellar or shed will result in the freezer under-freezing food or not working at all. This is not a fault with the appliance, but it is operating within its designated operating parameters.

6) Persons Using the Appliance

This appliance can be used by children aged from 8 years and above and persons with reduced physical, sensory or mental capabilities or lack of experience or knowledge if they are under

supervision or have been given instruction concerning the use of the appliance in a safe way and therefore understand the hazards involved.

Children aged from 3 to 8 years are allowed to load and unload this appliance.

Children should be supervised to ensure that they do not play with the appliance.

Cleaning and user maintenance shall not be carried out by children unless they are aged 8 years and above and supervised.

Keep all packaging well away from children to avoid risk of suffocation.

7) Getting To Know Your Appliance

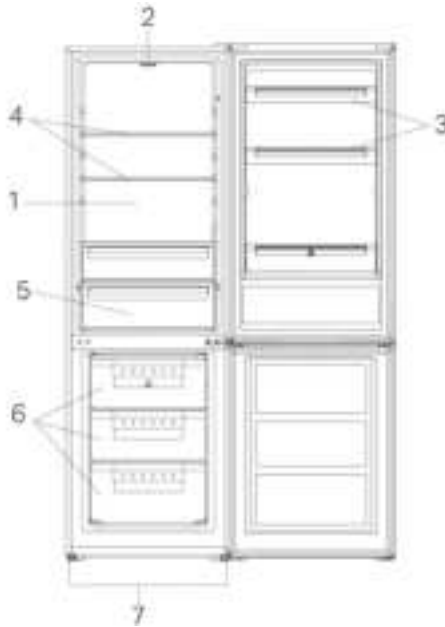

- 1) Fridge Compartment
- 2) Thermostat Control & Interior Light
- 3) Door Balconies
- 4) Interior Glass Shelves
- 5) Salad Crisper Box
- 6) Freezer Compartment
- 7) Adjustable Feet

8) Operating The Appliance

Set the temperature control to the required setting as displayed in the diagrams below by adjusting the dial to the right setting for the time of year.

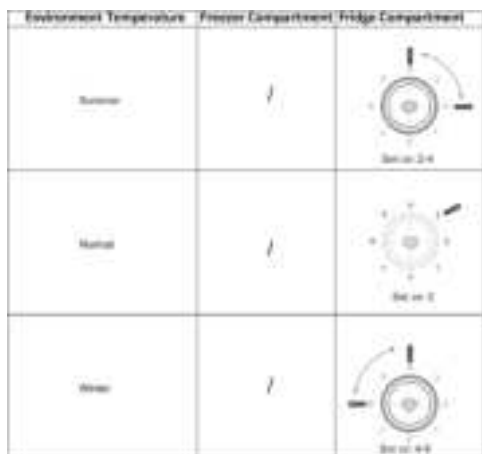

Food Storage

Under recommended settings, the best storage time for food in the fridge compartment is 3 days.

The best storage time for the freezer is no more than 1 month

The best storage times may be reduced under other settings.

Setting the Temperature

Plug in the appliance. There are 8 settings controlled by the thermostat. Setting 1 is the warmest setting. Setting 7 is the coldest setting.

Setting 0 turns off the appliance.

If the appliance is in a very warm environment, it may not operate at the correct temperature.

Leaving the door open for an extended period will cause the internal temperature to rise.

During high ambient temperatures, adjust the thermostat to setting 7. This is the coldest setting. It may cause the thermostat to continuously run to maintain the temperature.

9) Daily Use

Never place food that is above room temperature into the fridge.

Ensure food is not in contact with the rear wall as it may freeze to it.

You must never re-freeze food that has been defrosted.

Always follow manufactures recommendation for Best Before and Use By dates.

Never place fizzy carbonated drinks in the freezer. As liquids freeze, it expands. This will cause pressure on the container and may result in the container exploding causing damage to the freezer.

Ice lollies can cause frost burns if consumed as soon as they are removed from the freezer.

Regularly clean all surfaces that come into contact with food to ensure the highest standards of cleanliness.

Raw meet and fish should be stored in in suitable airtight containers in the fridge. Ensure there is no contact with other food stuffs and that juices cannot drip and contaminate other food stuffs.

A faint gurgling sound may be heard when the refrigerant is pumped around the cooling circuit. This is the appliance operating normally.

You may also hear a pulsating or whirring sound when the compressor is in operation.

The thermostat may click as it cycles on and off.

One-, two- and three-star freezer compartments are not suitable for the freezing of fresh foods.

If left empty for long periods of time, you should switch off the appliance, defrost, clean and dry it. The you need to leave the doors open to prevent the formation of mould.

Do not open the doors during a power cut.

Accessories such as shelves, drawers and balconies should be left in place so the appliance can operate at maximum efficiency.

10) Food Storage Advice

Compartment	Type of food
Balconies	Jams, Juices, Drinks & Condiments
Salad Crisper	Fruits, Herbs, Vegetables
Bottom Shelf	Raw meat, fish and poultry
Middle Shelf	Dairy Products
Top Shelf	Pre cooked foods, ready meals, deli meats
Top Freezer Drawer	Ice Cream, Frozen Fruit, baked goods
Middle Freezer Drawer	Vegetables and chips
Bottom Freezer Drawer	Meat of Fish

11) Maintenance

Before performing any user maintenance or cleaning, disconnect the power supply.

Internal Cleaning

Clean the interior and accessories with lukewarm water and diluted with bicarbonate soda. Rinse off and dry thoroughly. Do not use abrasive powders, detergents and perfumed cleaning products as these can damage component parts and contaminate food.

Regularly check the drainage whole and keep clear of obstructions. If it becomes blocked water will connect in the base of the fridge compartment and salad drawer causing a risk to health and food spoilage.

External Cleaning

Clean the outer cabinet with warm soapy water. Do not use abrasive products such as these may damage the appearance of the unit.

Dust the compressor & compressor units at the rear of the appliance occasionally. You can use a soft brush or vacuum cleaner. Dust can affect the performance of the appliance and affect its energy consumption.

Defrosting

Ice will build up in the freezer compartment over time. When it exceeds 3-5mm, turn off the appliance, and empty the contents. Leave the door open and allow the ice to melt. Clean and dry the freezer before turning the appliance back on.

DO NOT USE SHARP OBJECTS TO AID THE DEFROSTING PROCESS. You may damage the cooling circuit and invalidate your warranty.

While defrosting the appliance, store the food in a cool box if available.

12) Troubleshooting

No Power:

Check the fuse in the plug. This must be a 13amp version.

Check the trip switch and reset if required

Check there is power to the socket

Check there is no power cut.

The Compressor is Continuously Running:

Is the thermostat set to high? 7 is the coldest setting turn it down.

Has the door been opened for a long period? If so, let the appliance return to its normal operating temperature.

Has a large amount of food been added to the appliance recently? If so, allow the internal temperature to return to normal.

Is the door closed? Close the door.

Excessive Frost/Ice Accumulation:

Ensure the freezer door is closed.

Ensure the door seal is clean and making contact around the join between the door and the door frame.

Check the thermostat setting. 7 is the coldest temperature – turn it down.

Noisy:

Refer to the section 9 titled daily use.

Check the installation to ensure it is correct.

13) Service

Electrical work or servicing must be performed by a qualified electrical or competent service engineer.

Only genuine spare parts can be used and service must be

performed by an authorised service centre.

6 Here For You

6.1 After-sales assistance

If you continue to experience problems with your appliance, please call the Montpellier customer service helpline on: **03333 234473 opt 3**

Please have all your product details available, including the model number, serial number, original sales invoice (clearly showing model number, date of purchase and your retailer's details) before registering a fault.

The service call cannot progress without this information.

Your 2 year Manufacturer's guarantee

THIS DOES NOT AFFECT YOUR STATUTORY RIGHTS.

Your new Montpellier appliance carries a free guarantee which protects you against the cost of repairs during the first 24 months from date of purchase provided that:

Any claim is accompanied by evidence of the model reference, model serial number and proof of purchase, such as a Sales Receipt, showing that the appliance was purchased within the 24 months prior to the date of claim.

What is not covered under the Guarantee

- Any appliance not correctly installed and operated in accordance with the manufacturer's instructions
- Any appliance that is used for anything other than domestic purposes.
- Any defect caused by accident, misuse, unauthorised modification or inexperienced repair.
- Cost of Call-out where a fault cannot be found with the appliance. Cost of Call-out for work covering routine maintenance, such as, but not exclusively, cleaning of filters or defrosting.
- Cost of Call-out for work required to correct the alignment of doors following door reversal procedures carried out by you. Use of the appliance by anyone other than the Householder. Use in any commercial environment.
- Consumable items, such as, but not exclusively, fuses in plugs, bulbs and breakable items which require routine replacement. Repair costs incurred that have not been authorised by Montpellier service and/or carried out by a non-approved Montpellier engineer.

- Montpellier Appliances do not accept claims for consequential loss, rusting, corroding, delivery damage or scratches.

YOUR GUARANTEE IS VALID ONLY IN THE UK & THE REPUBLIC OF IRELAND

To register your appliance simply complete the card in your appliance pack and return it with a stamp affixed or alternatively you can register online at:

montpellier-appliances.com/support

...or by phone, call our warranty registration department on **08081 961 388**

SERVICE HELP - LINE

Should your appliance develop a fault, please call the Montpellier customer service helpline on:

03333 234473 opt 3

Please remember to have all your product details available, including the model number, serial number, date of purchase and your retailer's details before registering a fault.

Montpellier Domestic Appliances Ltd.

Unit 1, Tewkesbury Retail Park, Northway Lane,
Tewkesbury, Gloucestershire GL20 8UY

www.montpellier-appliances.com



The symbol on the product or on its packaging indicates that this product may not be treated as household waste. Instead it shall be handed over to the applicable collection point for the recycling of electrical and electronic equipment. By ensuring this product is disposed of correctly, you will help prevent potential negative consequences for the environment and human health, which could otherwise be caused by inappropriate waste handling of this product. For more detailed information about recycling of this product, please contact your local city office, your household waste disposal service or the shop where you purchased the product.