



**These instructions must be read prior to installation and use!**



**HELLA**

ONYX.SWITCH

- Installation instructions
- Operating guidelines

## Preliminary remarks ONYX.SWITCH

With this HELLA product you have opted for a high-quality product with a most up-to-date technology that can nevertheless be easily installed and operated. In these instructions we describe the basic use of the wall-mounted radio transmitter ONYX.SWITCH.

The following symbols will assist you with the installation or use and require a safety-conscious conduct:



**Attention!**  
This symbol indicates instructions that, if disregarded, can put the user in danger.



**Attention!**  
This symbol indicates instructions that, if disregarded, can potentially result in damage to the product.



This symbol indicates instructions for use or helpful information.



This symbol requires you to act.



This symbol indicates parts of the product, for which you will find important information in these installation instructions.

## Table of Contents

Preliminary remarks ONYX.SWITCH .....	3
General notes .....	4
Safety instructions .....	5
Scope of delivery .....	6
Device description .....	6
Technical data .....	7
Installation .....	8
Configuration .....	9
Operation .....	11
Replacing the battery .....	11
Ideal use of the radio signal .....	12
Fault removal .....	13
Disposal .....	14

## General notes

### ☞ Questions

In case of questions concerning the installation or the use of your product, please consult your authorized specialist shop.

### ☞ Warranty

Warranty claims are subject to statutory limitation periods. Service parts are excluded from the warranty; the same applies for changes in colour and changes in characteristics caused by UV radiation.

### ☞ Liability

Should the notes and information given in these instructions be disregarded or if the product is misused or used for the wrong purpose, the manufacturer declines the guarantee for damage to the product. In these cases the liability for consequential damage to any parts or persons is ruled out as well

### ☞ Legal notes

The graphs and texts of these instructions were carefully prepared. We cannot be held liable for any errors and their potential consequences! Subject to technical modifications to the product and to these instructions! These instructions include copyrighted information. All rights reserved! The listed product or brand names are trademarks of the respective owners.

### ☞ EC declaration of conformity

The HELLA Sun and weather protection technology GmbH hereby declares that this product complies with the basic requirements and the other applicable regulations of the EC directives. The complete declaration of conformity can be found in the download area of our website <https://www.hella.info>.

## Safety instructions



The safety instructions as well as the appropriate instructions must be read carefully before installation and use. In case of non-observance of the directions and information given in these instructions and in case of improper installation and operation or unintended use, the manufacturer shall not accept any warranty claims concerning any damage to the product. In these cases the liability for consequential damage to any parts or persons is ruled out as well.



- Follow the described installation steps and pay attention to recommendations and notes.
- Keep these instructions in a safe place.
- Observe the regulations for prevention of accidents of the employer's liability insurance association!
- Before operation check the unit for visible damage. If the unit is damaged, it should not be used; please consult authorized specialist staff immediately.
- Only use unmodified original parts from HELLA.
- In case of unauthorised opening of the device, improper use, incorrect installation or incorrect operation, there is a risk of damage to persons or property.
- Never let children play with the unit.



Never randomly press the pushbuttons of your wall-mounted radio transmitter when the sun protection element is not within your sight.



### Observance of regulations and rules

The building owner is responsible for the observance of statutory rules and country-specific provisions on site.



If the wall-mounted radio transmitter ONYX.SWITCH is mounted nearby a junction box/flush-mounted box, a junction plane must be provided by the customer! ONYX.SWITCH may not get in contact with a 230 V AC voltage circuit!

## Scope of delivery

### The following components are included in the scope of delivery:

- Wall-mounted radio transmitter ONYX.SWITCH without frame
- Mounting plate
- Mounting material
- CR2032 Battery (already inserted)

## Device description

ONYX.SWITCH  
Art.-No. 50680601  
868MHz/ 2.4GHz

ONYX.CLICK is a 5-channel wall-mounted radio transmitter which can be used in combination with all ONYX control devices/sensors. In addition, the wall-mounted radio transmitter can quickly and easily be linked to the ONYX smart home control system with ONYX.CENTER. As ONYX.SWITCH works bi-directionally, feedback signals by the control commands are directly displayed on the wall-mounted radio transmitter. The wall-mounted radio transmitter ONYX.SWITCH is compatible with all standard designs of the 55 mm frame systems.

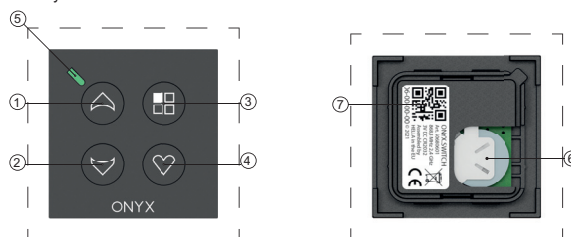

### Legend

- |                                |                       |
|--------------------------------|-----------------------|
| ① UP (tilting)                 | ⑤ Status/channel bar  |
| ② DOWN (tilting)               | ⑥ Battery compartment |
| ③ Group pushbutton             | ⑦ QR code             |
| ④ Pushbutton with heart symbol |                       |

## Technical data

Power supply	3V DC CR2032 lithium battery (230mAh)
Operating time of the battery	3 years
IP rating	IP20
Permitted storage temperature range	-20 °C to +70 °C
Permitted operating temperature range	0 °C to +60 °C
Radio frequency	868,3 MHz/2,4 GHz band
Transmission power	12,6 mW (868,3 MHz) 2,5 mW (2,4 GHz)
Channels	5
Device per channel	5 (there are no restrictions on the number of devices per channel when used in combination with ONYX.CENTER)
Dimensions LxWxH	55 x 55 x 9.5 mm
Weight	20 g

## Installation



1. Fix the mounting plate. The mounting material enclosed may be used for this.
2. Place the frame onto the mounting plate.
3. Press the wall-mounted radio transmitter ONYX.SWITCH in the frame and in the mounting plate.

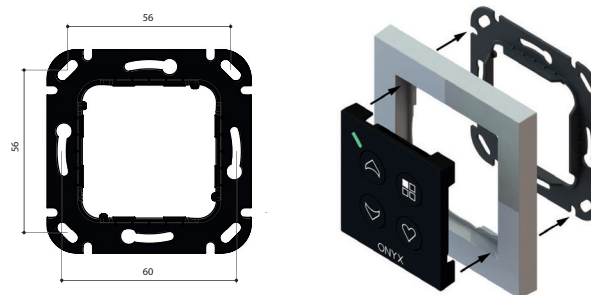

## Configuration



Before configuring ONYX.SWITCH, download HELLA's free "ONYX" app from the App store / Google Play to your smart phone. Bluetooth must be activated at your smart phone to configure the wall-mounted radio transmitter ONYX.SWITCH. Bluetooth is not necessary for the later operation of the wall-mounted radio transmitter.

## Configuration



### Configuration of ONYX.SWITCH without ONYX.CENTER

Open the "ONYX" app. Now press the group button (3) and the heart button (4) together on the wall-mounted radio transmitter for 3 seconds. The wall-mounted radio transmitter appears in the app and can be selected. Then follow the instructions on the screen. "Settings for motor and pushbuttons" can usually be adopted. When using a weather sensor you should activate the respective sensor for each taught-in control unit. As soon as the first control device/the first weather sensor has been taught in, you can add additional control devices with "+". Only after the connection of all control devices/ sensors, go to "←" on the top left. Now tap on one of the 5 groups and assign the devices as you like. The configuration is completed with "Done". You can close the app now.



If, after the configuration of the ONYX.SWITCH, your shading elements move into the wrong direction, connect the wall-mounted radio transmitter with the app "ONYX" as described above. Under "Configure devices" you now can tap on the pencil symbol of the respective device (top right). Under the menu item "Advanced settings" tap now on "Reverse direction of rotation". By tapping on "Done" these settings are adopted.



To actuate your shading unit brightness dependent, tap under "Configure devices" on the pencil symbol of the respective device (top right). Under the menu item "Advanced settings" you find the item "Brightness range". Here two ranges can be adjusted via the two scroll bars. Both ranges can be assigned the action "Extend" or "Retract". These settings can only be made, if a weather sensor ONYX.WEATHER is available.



You can find additional information regarding the adjusting possibilities at the control device in the respective "Instructions for use".

## Configuration



### Configuration of ONYX.SWITCH with ONYX.CENTER

First of all, ONYX.CENTER must be configured completely according to the "Instructions for use" enclosed. As described in the respective instructions for use, all control devices and sensors must also be connected to ONYX.CENTER. Now connect with ONYX.CENTER. The "Configuration mode" in the app must be activated. You find it under "Settings". ONYX.SWITCH can be taught in under "Devices" and "+". Then follow the instructions on the screen. The configuration is completed with "Done".



Wall-mounted radio transmitters ONYX.SWITCH are only visible in the app "ONYX", when the "Configuration mode" is active. If you want to adjust the configuration at the wall-mounted radio transmitter, activate the "Configuration mode". You find it under "Settings". Then tap on the respective ONYX.SWITCH. The groups can be adjusted under "Advanced settings".

## Operation



With the two pushbuttons UP (1) and DOWN (2) you can extend or retract your shading element with a click on the relevant latching pushbutton. Outdoor blinds are tilted with a brief click. If the respective latching pushbutton is pressed for 2 seconds, the outdoor blind raises or lowers. With a brief click on the respective pushbutton the lighting is switched off or on. By pressing the respective pushbutton for 2 seconds, the lighting is dimmable, if it is combined with the matching ONYX control device. Successfully transmitted control commands are displayed by a backlight in the status/channel bar in the corresponding channel colour.



With the group pushbutton (3) you can change over to other channels, which you configured earlier in the app "ONYX" (see chapter Configuration). The fixed assigned channel colour is displayed in the status / channel bar (5).



With the pushbutton with heart symbol (4), one favourite position per channel can be saved, which is then ready for later use. Press this pushbutton for 3 seconds to save the selected position. With a brief click on this pushbutton, the position saved before can be accessed again. Successfully transmitted control commands are displayed by a backlight in the status/channel bar in the corresponding channel colour.

## Replacing the battery



To replace the CR2032 button cell, remove the battery from the battery slot (6) on the back of ONYX.SWITCH.

Use a pointed object (e.g. pencil) to remove the button cell from the battery slot. When replacing the battery, please observe the correct alignment of the battery in the battery slot (6) (when inserting the button cell, the + pole must be aligned towards the top).

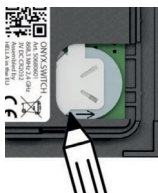

## Ideal use of the radio signal



In case of bad reception, the position of the ONYX.SWITCH must be changed.



Radio systems that send on the same frequency may cause interference with reception. It must be considered that the range of the radio signal is limited by statutory regulations and structural measures.

## Fault removal

Problem	Possible cause	Troubleshooting
Status/channel bar flickers red	CR2032 Battery is empty	Replace the CR2032 battery as described in point "Replacing the battery"
No backlight in the status/channel bar. ONYX.SWITCH is inoperative.	Battery CR2032 is empty or is inserted in the wrong direction	Open the battery slot, check the battery and replace it, if necessary, or turn it around
No backlight in the status/channel bar when pressing the pushbutton "Favourite position" (4)	A favourite position has not been configured yet	Teach-in the favourite position as per point "Operation"
Drive runs in the wrong direction	Directions were interchanged when connecting the motor cable	Perform the reversal of the direction in the "ONYX" app as per point "Configuration"
The backlight in the status/channel bar shows red when giving a control command	Unfavourable position of the ONYX.SWITCH, poor or no radio reception	Reposition ONYX.SWITCH or control device slightly
Backlight in the status/channel is rainbow-coloured	ONYX.SWITCH is not configured yet	Configure ONYX.SWITCH as per point "Configuration"
Status/channel bar flashes in the channel colour, the shading product is extended and retracted by a few centimetres	One or more control devices from the respective group are locked due to a possible wind alarm	Wait until the wind has weakened, afterwards the respective control device is released after 15 minutes

Subject to technical modifications – Date of issue December, 2021

13

## Disposal



Dispose of the device in accordance with the current country-specific regulations for electronic scrap (e.g. suitable collecting points).



According to the current regulations, batteries are to be disposed of at the retailer or the municipal collection points.

Subject to technical modifications – Date of issue December, 2021

14



#### HELLA Interior Venetian Blinds

regulate the lighting in a room very comfortably, immediately gracing it with much more atmosphere.



#### HELLA Insect screens

and you decide who is allowed to come in and who isn't.

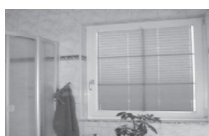

#### HELLA Pleated Blind

folds up very compactly and protects very well against the sun and nosy glances where only little space is available.



#### HELLA Outdoor Blinds

serve for the light regulation, as view protection, anti-glare blind and heat protection.



#### HELLA Front-mounted Roller Shutter

for more safety and protection against rain, wind, heat, the cold, noise, incident light and nosy glances, also available for subsequent installation.



#### HELLA Facade Awning

with toggle catch mechanism for a lovely facade design with perfect heat and glare protection.

For questions, wishes and ideas:  
HELLA Infoline +43/(0)4846/6555-0

#### HELLA Sonnen- und Wetterschutztechnik GmbH

A-9913 Abfaltersbach, No. 125

Phone: +43/(0)4846/6555-0

Fax: +43/(0)4846/6555-134

e-mail: office@hella.info

Internet: <http://www.hella.info>