

# Quick Start Guide

## How to Pair

### First-Time Pairing:

- 1 Open the charging case, the earbuds will automatically power on and enter pairing mode.
- 2 Select "soundcore AeroFit 2" on your device's Bluetooth list to connect.



### Manual Pairing:

Open the charging case, and without taking out the earbuds, press and hold the case's power button for 3 seconds to enter pairing mode.

## Touch Controls

Use the soundcore app to activate, disable, or customize controls for volume adjustment and voice assistant.

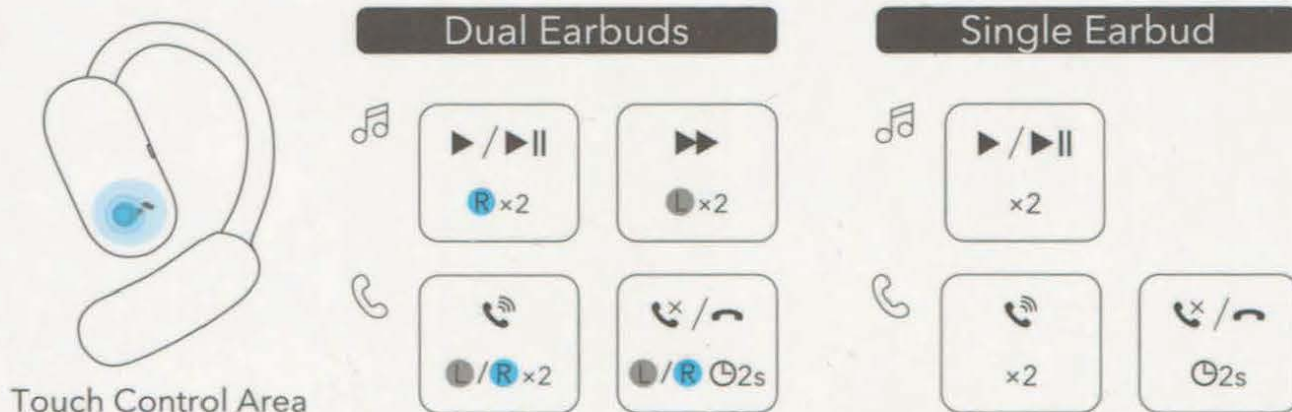

## How to Wear

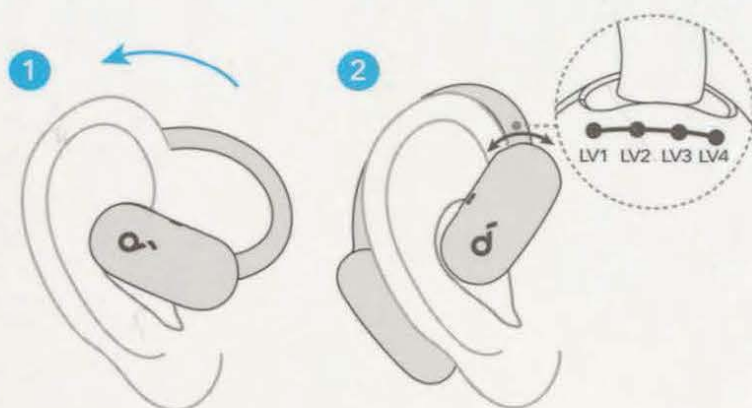

Adjust the ear hooks between four levels to find the most comfortable and secure fit and achieve the best listening experience.

- LV1 and LV2: Best suited for small to medium-sized ears.
- LV2 to LV4: More comfortable for medium to large-sized ears.

### Ear Hook Position Guide



## How to Clean



Charging Contacts

After each use, wipe the earbuds with a soft, dry cloth and clean the charging contacts with a cotton swab to prevent charging and power-off issues caused by sweat accumulation.



Download the soundcore app to adjust EQ settings, experience Gaming Mode, customize touch controls, update firmware, and explore more features.



Scan to View User Guide

## APP



Google Play and the Google Play logo are trademarks of Google Inc.



Apple and the Apple logo are trademarks of Apple Inc.



Download the soundcore app to adjust EQ settings, experience Gaming Mode, customize touch controls, update firmware, and explore more features. If your earbuds cannot connect with the soundcore app, try re-installing the app or updating it to the latest version available in your mobile app store. Download the app via <http://dl-soundcore.soundcore.com/qcdl?flow=soundcore>

## OVERVIEW

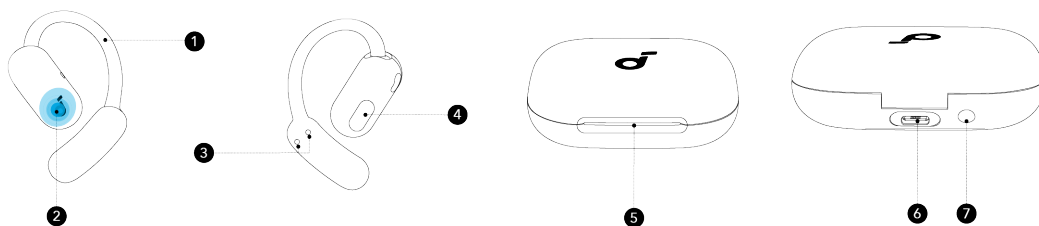

1. Adjustable Ear Hook
2. Touch Area
3. Charging Contactors
4. Sound Outlet
5. LED Light Strip
6. USB-C Charging Port
7. Charging Case Button

## POWERING ON & PAIRING

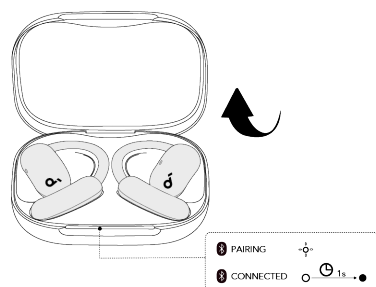

1. Open the charging case. The earbuds will automatically power on and enter Bluetooth pairing mode.



2. Select "**soundcore AeroFit 2**" on your device's Bluetooth list to connect. During pairing, the LED light strip on the charging case will start flashing. Once the pairing is successful, the LED light strip will stay on for 1 second before turning off.



Once connected, the earbuds will automatically reconnect to your device every time you open the charging case, as long as you haven't deleted the pairing history from your device.

## DUAL CONNECTIONS

To connect your earbuds with two Bluetooth devices at the same time, there are two methods:

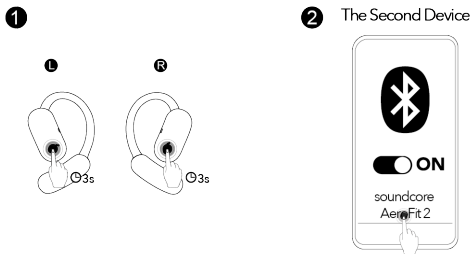

### Method 1: Manually Pair with the Second Device

While wearing the earbuds, press and hold the touch control areas on both earbuds for 3 seconds until you hear a sound prompt for pairing mode. You can then proceed to pair with the second device.

If your earbuds have been connected to two devices, remove at least one before pairing with a new device.

### Method 2: Use the soundcore App

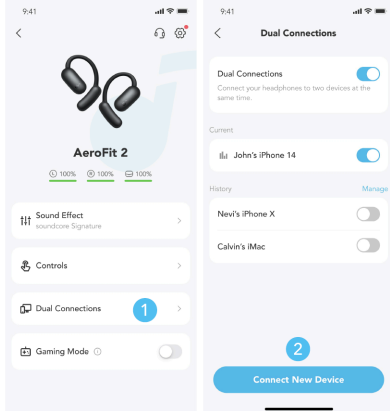

In the soundcore app, tap **Dual Connections** on the main interface, then proceed to **Connect New Device**.

Dual Connections feature is enabled by default.

## MANUAL PAIRING

To manually enter Bluetooth pairing mode:

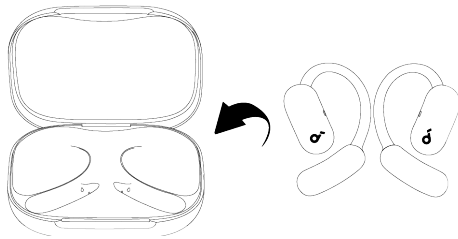

1. Return the earbuds to the charging case.

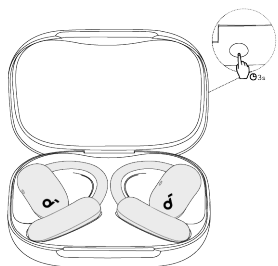

2. Leave the case open, then press and hold the charging case button for 3 seconds.



3. The earbuds will enter pairing mode. Proceed to pair with your device.

## WEARING

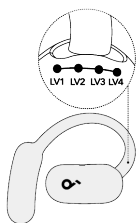

1. Pick up the earbuds and slide the ear hooks all the way to the LV4 position, which offers the largest fit.

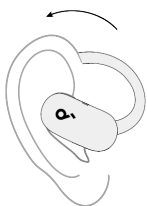

2. Rotate the ear hooks along your outer ear for proper positioning.

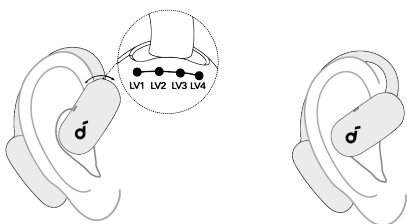

3. After putting on the earbuds, you can slide the ear hooks back and forth between four levels until you find the most comfortable and secure fit.

## Ear Hook Position Guide



Proper Fit



Level Too Small



Level Too Large



Unstable Fit

## How to Clean



Charging Contacts

After each use, wipe the earbuds with a soft, dry cloth and clean the charging contacts with a cotton swab to prevent charging and power-off issues caused by sweat accumulation.

## SOUND EFFECTS

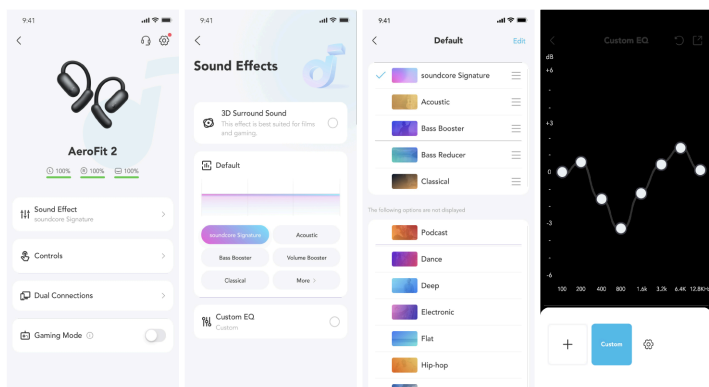



In the soundcore app, the default sound effect is "soundcore Signature", a special preset recommended by the soundcore team. We offer 22 EQ presets for different scenarios, which you can switch based on your preferences. Additionally, you can create your own sound profile by adjusting eight sliders on the "Custom Equalizer" page.

CONTROLS

Using Dual Earbuds

Double tap the right earbud to play / pause audio

Double tap the left earbud to skip songs

Double tap to answer calls

Tap and hold for 2 seconds to reject / end calls

Using Single Earbud

Double tap the earbud to play / pause audio

Double tap to answer calls

Tap and hold for 2 seconds to reject / end calls

		Using Dual Earbuds	Using Single Earbud
	Play / Pause Audio	Double tap (R)	Double tap
	Play the Previous Track	Customize in the soundcore app	/
	Play the Next Track	Double tap (L)	
	Answer a Call	Double tap (L/R)	Double tap
	Reject a Call / End a Call	Tap and hold for 2 seconds (L/R)	Tap and hold for 2 seconds
	Increase Volume	Customize in the soundcore app	Customize in the soundcore app
	Decrease Volume		
	Activate Voice Assistant	Customize in the soundcore app	Customize in the soundcore app

Customize Touch Controls on soundcore App

Note: The UI images are for illustration purposes only. Actual display contents may vary based on the software version.

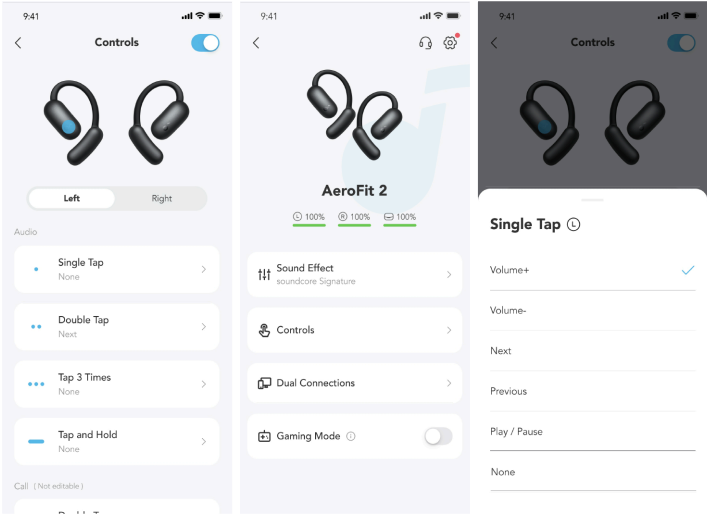

Tap **Controls** on the home page to personalize touch control actions for either the left or right earbud. **You can adjust actions such as increasing/decreasing volume, switching songs, playing/pausing audio, and activating the voice assistant.**

CHARGING

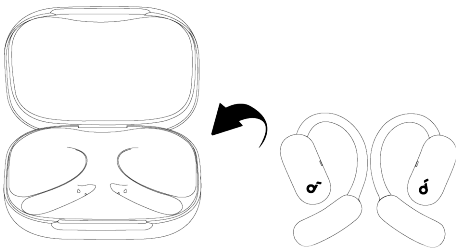

1. Place the earbuds in the charging case and close it.
- Ensure the earbuds and the USB-C charging port are fully dry before charging.

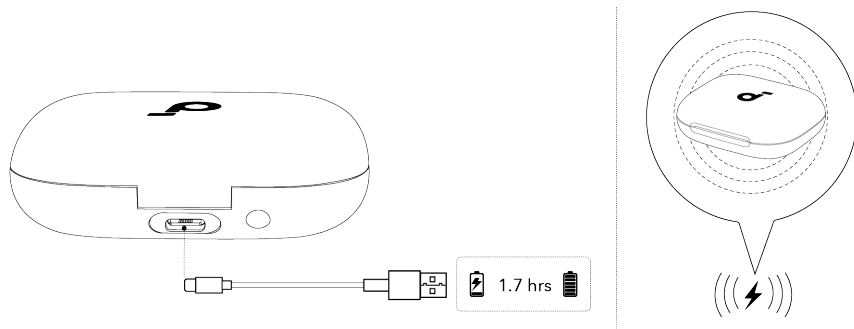

2. Connect the charging case to a power supply using the provided USB-C charging cable. Alternatively, for wireless charging, place the charging box at the center of your wireless charger.

- Recharging the charging case takes 1.7 hours via cable and 2.6 hours via wireless charging.

## POWERING OFF

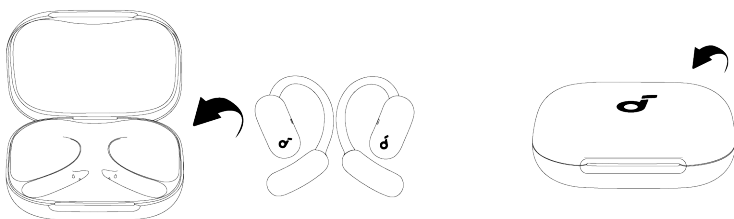

To power off, return both earbuds to the charging case and close the case.

 The earbuds will automatically power off after 30 minutes if they are not connected. The duration can be customized in the soundcore app.

## RESET

Reset the earbuds if they have issues pairing with each other or with other devices.

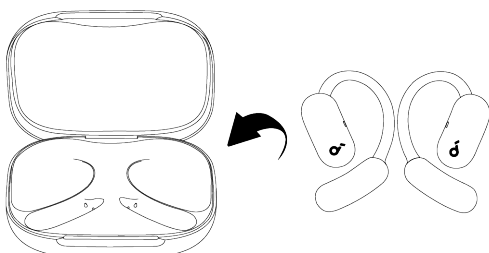

1. Return the earbuds to the charging case and leave the case open.

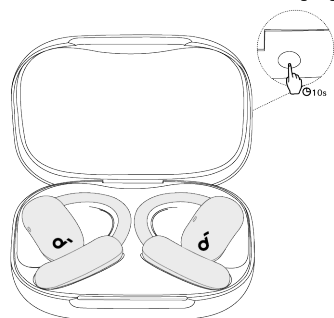

2. Press and hold the charging case button for 10 seconds until the LED light strip flashes white quickly three times, indicating a successful reset.

## LED LIGHT GUIDE

### Checking the Battery Level

When you open the charging case, the LED light strip will indicate the remaining battery level of the case.

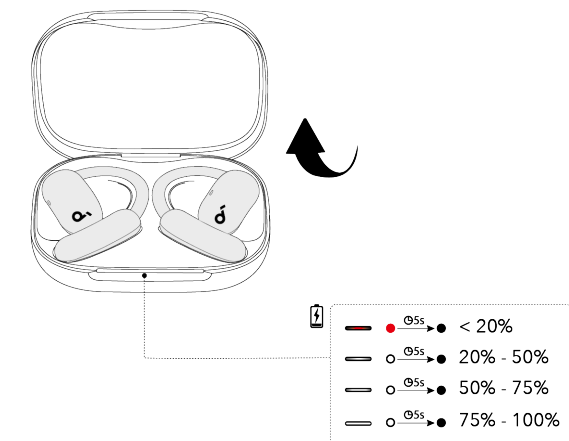

## Checking the Charging Status

When you connect the charging case to a power source, the LED light strip will display the charging status:

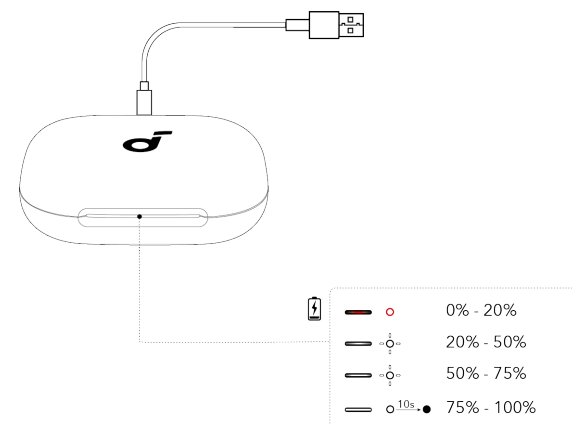

## FIRMWARE UPDATE

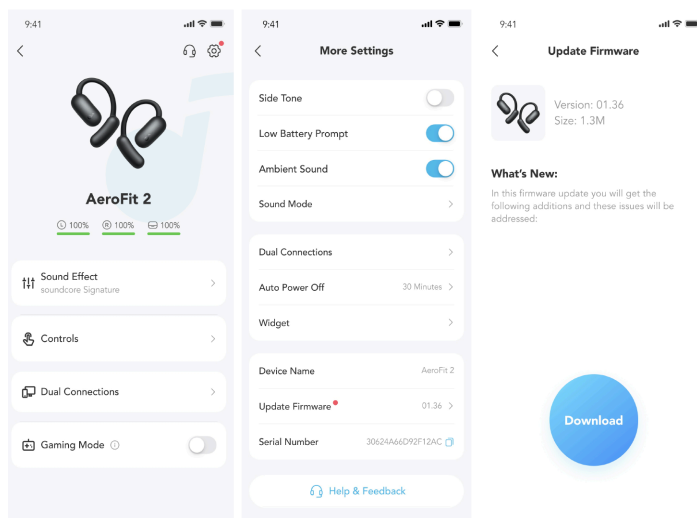

You will be notified once a new firmware version is detected when the earbuds are connected to the app. Ensure the earbuds are in the charging case and the case remains open until the firmware update is complete. Avoid using the earbuds during the update.

## SPECS

Specifications are subject to change without notice.

Input	5V $\pm$ 1.2A
Output	5V $\pm$ 0.42A (0.21A per port)
Battery capacity	750mAh
Charging time	Earbuds: within 1 hour Charging case: Wired charging time: 1.7 hours to fully charge the charging case, 2.2 hours to fully charge the charging case and the earbuds Wireless charging time: 2.6 hours to fully charge the charging case and the earbuds.
Driver unit	20*11.5mm
Frequency response	20~20kHz (20~40kHz when LDAC is enabled)
Impedance	16 $\Omega$
Waterproof rating (earbuds)	IP55
Bluetooth version	5.4



Customer Service



service@soundcore.com  
support.me@soundcore.com (For Middle East and Africa Only)  
support@anker.com (日本)  
+1 (800) 988 7973 (US/Canada)  
+44 (0) 1604 936200 (UK)  
+49 (0) 69 9579 7960 (DE)  
03 4455 7823 (日本)  
+86 400 0550 036 (中国)  
+82 1666-8470 (한국)  
+971 8000320817 (UAE)  
+966 8008500030 (KSA)  
+965 22069086 (Kuwait)  
+20 8000000826 (Egypt)  
+61 3 8331 4800 (Australia)  
+90 (850) 460 14 14 (Türkiye)  
+8 (800) 511-86-23 (Russia)  
000-8000-504-414 (India)



Note: The 'x' of SN Code: xxxxxxxxxxxxxxxx is a variable, see below table.

Variable 'x'	Range of variable	Content
Eighth	8,9,A,B,C...	Denotes the year, 8 means 2018, 9 means 2019, A means 2020, B means 2021, C means 2022, and so on.
Ninth and tenth	01,02,03...	Denotes weeks, 01 means the first week in this year, 02 means the secondary week in this year, and so on.
Eleventh	1-7	Denotes date, 1 means Monday, 2 means Tuesday..., 7 means Sunday and so on.
The last five	00001-99999	Denotes serial No.

Hereby, Anker Innovations Limited declares that this device is in compliance with The Product Security and Telecommunications Infrastructure (Security Requirements for Relevant Connectable Products) Regulations 2023. For the Statement of Compliance, visit the website: <https://uk.soundcore.com/pages/psti-related>.

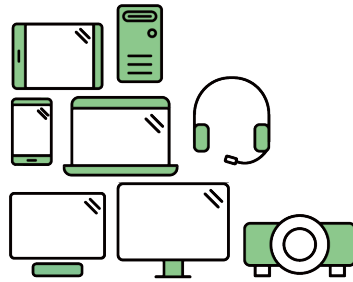

## Say hello to a more sustainable product

IT products are associated with a wide range of sustainability risks throughout their life cycle. Human rights violations are common in the factories. Harmful substances are used both in products and their manufacture. Products can often have a short lifespan because of poor ergonomics, low quality and when they are not able to be repaired or upgraded.

**This product is a better choice.** It meets all the criteria in TCO Certified, the world's most comprehensive sustainability certification for IT products. Thank you for making a responsible product choice, that help drive progress towards a more sustainable future!

Criteria in TCO Certified have a life-cycle perspective and balance environmental and social responsibility. Conformity is verified by independent and approved verifiers that specialize in IT products, social responsibility or other sustainability issues. Verification is done both before and after the certificate is issued, covering the entire validity period. The process also includes ensuring that corrective actions are implemented in all cases of factory non-conformities. And last but not least, to make sure that the certification and independent verification is accurate, both TCO Certified and the verifiers are reviewed regularly.

### Want to know more?

Read information about TCO Certified, full criteria documents, news and updates at **[tcocertified.com](https://tcocertified.com)**. On the website you'll also find our Product Finder, which presents a complete, searchable listing of certified products.

# soundcore

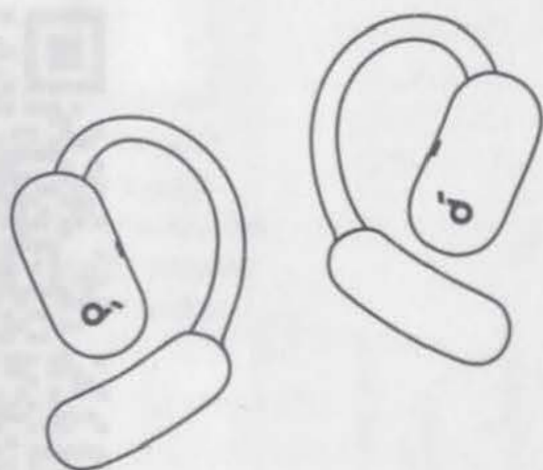
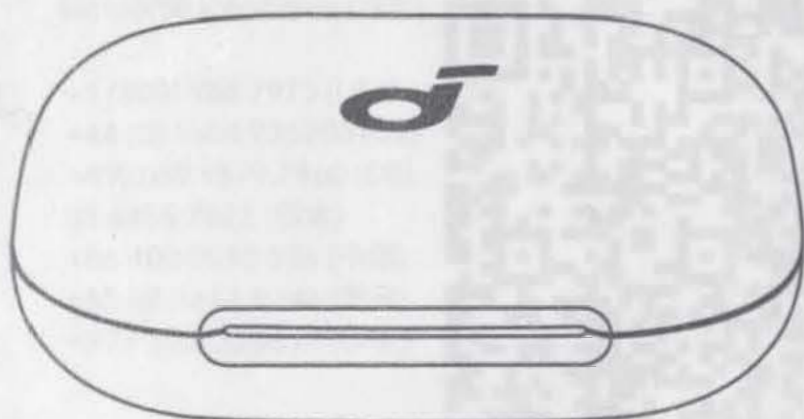

soundcore AeroFit 2

Safety Sheet



soundcore

Scan to View User Guide



soundcore AeroFit 2

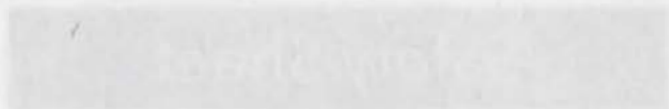

## 18-month limited warranty

18 Monate beschränkte Herstellergarantie | Garantía limitada de 18 meses | Garantie limitée de 18 mois |  
Garanzia limitata 18 mesi | 通常保証18ヶ月 (延長あり) | 18개월 제한 보증 | 18个月质保期 | 18個月有限保固 |  
18 meses de garantía limitada | 18 aylık sınırlı Garanti  
12-month limited warranty for INDIA

ضمان محدود لمدة 18 شهرًا

✉ service@soundcore.com  
support.mea@soundcore.com (For Middle East and Africa Only)  
support@anker.com (日本)

☎ +1 (800) 988 7973 (US/Canada)  
+44 (0) 1604 936200 (UK)  
+49(0)69 9579 7960 (DE)  
03 4455 7823 (日本)  
+86 400 0550 036 (中国)  
+82 02-1661-9246 (한국)  
+971 8000320817 (UAE)  
+966 8008500030 (KSA)  
+965 22069086 (Kuwait)  
+20 8000000826 (Egypt)  
+90 (850) 460 14 14 (Türkiye)  
+8 (800) 511-86-23 (Russia)  
000-8000-504-414 (India)

Input: 5V = 1.2A

Output: 5V = 0.42A (0.21A per port)

Anker Innovations Limited

Unit 56, 8th Floor, Tower 2, Admiralty Centre, 18 Harcourt Road, Hong Kong

The following importer is the responsible party (contact for EU and UK matters)

Anker Technology (UK) Limited

GNR8, 49 Clarendon Road, Watford, Hertfordshire, WD17 1HP, United Kingdom

Anker Innovations Deutschland GmbH

Georg-Muche-Strasse 3, 80807 Munich, Germany

Left Earbud Model: A3874L

FCC ID: 2AOKB-A3874L

CAN ICES-003 (B) / NMB-003 (B)

IC: 23451-A3874L

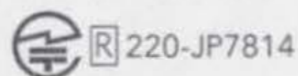

Right Earbud Model: A3874R

FCC ID: 2AOKB-A3874R

IC: 23451-A3874R

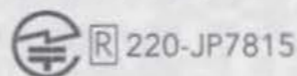

FR

Cet appareil,  
piles et cordons  
se recyclent

À DÉPOSER  
EN MAGASIN



ou

À DÉPOSER  
EN DÉCHÈTERIE



Points de collecte sur  
[www.quefairedemesdechets.fr](http://www.quefairedemesdechets.fr)



**EAC**

**PAP 22**  
Raccolta Carta

The power delivered by the charger must be between min [0.005] Watts required by the radio equipment, and max [5] Watts in order to achieve the maximum charging speed.



## Important Safety Instructions

- Do not disassemble.
- Keep out of the reach of children. The product contains small parts which may be a choking hazard.
- The battery shall not be exposed to excessive heat such as sunshine, fire or the like.
- Do not use the product in environments with too high or too low temperatures, and never expose the product to strong sunshine or very wet environments.
- Ensure there is no liquid, sweat or water on the charging port when charging.
- This product shall be installed and operated with minimum distance 20 cm between the radiator & body while charging wirelessly.
- Refer to your user manual for your earphones' waterproof level and follow the corresponding instructions.
  - For IPX4: Do not expose earphones to dripping or splashing water.
  - For IPX4, IPX5, and IPX6: Do not submerge earphones in water.



### Hearing Safety

- To avoid hearing damage, do not listen for extended periods at high volume.
- Do not turn the volume so high that you're unable to hear your surroundings.
- Do not use earphones while driving.
- You should use caution or temporarily discontinue use in potentially hazardous situations.



The product generates stronger permanent magnetic fields that could cause interference with cardiac pacemakers, implanted defibrillators (ICDs) and other implants. Always maintain a distance of at least 3.94"/10 cm between the product component containing the magnet (earbuds and charging case) and the cardiac pacemaker, implanted defibrillator, or other implant.

### Notice



This product complies with the radio interference requirements of the European Community.

### Declaration of Conformity

Hereby, Anker Innovations Limited declares that this product is in compliance with Directive 2014/53/EU. The full text of the EU declaration of conformity is available at the following internet address:

<https://support.soundcore.com/s/articleRecommend?type=Download&secondType=doc>

Maximum output power: 10.8dBm  
Frequency band: 2.4G band (2.402GHz-2.480GHz)  
WPT Operate Frequency: 110KHz-205KHz  
H-Field Strength: -3.82dBuA/m @10m  
Data Communication: 135.10KHz

Hereby, Anker Innovations Limited declares that this device is in compliance with The Product Security and Telecommunications Infrastructure (Security Requirements for Relevant Connectable Products) Regulations 2023. For the Statement of Compliance, visit the website <https://uk.soundcore.com/pages/psti-related>.



This symbol means the product must not be discarded as household waste, and should be delivered to an appropriate collection facility for recycling. Follow local rules and never dispose of the product and rechargeable batteries with normal household waste. Correct disposal of old products and rechargeable batteries helps prevent negative consequences for the environment and human health.



This symbol indicates "separate collection" for all batteries and accumulators. Danger of explosion if battery is incorrectly replaced. To reduce risk of fire, explosion or leakage of flammable liquid/gas, don't disassemble, crush, puncture, short external contacts, expose to temperature above 60°C (140°F), sunshine or like, expose to extremely low air pressure or dispose of in fire or water. Replace only with specified batteries.

High or low extreme temperatures that a battery can be subjected to during use, storage or transportation:

- During use: maximum 40°C (104°F)
- Storage: -20 - 45°C (-4 - 113°F)
- Transportation: 5 - 35°C (41 - 95°F)

## FCC Statement

This product complies with Part 15 of the FCC Rules. Operation is subject to the following two conditions: (1) This device may not cause harmful interference, and (2) this device must accept any interference received, including interference that may cause undesired operation.

Warning: Changes or modifications not expressly approved by the party responsible for compliance could void the user's authority to operate the equipment.

Note: This equipment has been tested and found to comply with the limits for a Class B digital device, pursuant to Part 15 of the FCC Rules. These limits are designed to provide reasonable protection against harmful interference in a residential installation. This equipment generates, uses, and can



radiate radio frequency energy and, if not installed and used in accordance with the instructions, may cause harmful interference to radio communications. However, there is no guarantee that interference will not occur in a particular installation.

If this equipment does cause harmful interference to radio or television reception, which can be determined by turning the equipment off and on, the user is encouraged to try to correct the interference by one or more of the following measures:

- Reorient or relocate the receiving antenna.
- Increase the separation between the equipment and receiver.
- Connect the equipment into an outlet on a circuit different from that to which the receiver is connected.
- Consult the dealer or an experienced radio/TV technician for help.

The following importer is the responsible party.

Company Name: Fantasia Trading LLC

Address: 5350 Ontario Mills Pkwy, Suite 100, Ontario, CA 91764

Telephone: +1 (800) 988 7973

## **Radiation Exposure Statement**

The highest SAR value reported under this standard during product certification for use next to the head with the minimum separation distance of 0mm. This transmitter must not be collocated or operating in conjunction with any other antenna or transmitter.

## **IC NOTICE TO CANADIAN USERS**

This device contains licence-exempt transmitter(s)/receiver(s) that comply with Innovation, Science and Economic Development Canada's licence-exempt RSS(s). Operation is subject to the following two conditions:

- (1) This device may not cause interference.
- (2) This device must accept any interference, including interference that may cause undesired operation of the device.

L'émetteur/récepteur exempt de licence contenu dans le présent appareil est conforme aux CNR d'Innovation, Sciences et Développement économique Canada applicables aux appareils radio exempts de licence. L'exploitation est autorisée aux deux conditions suivantes:

- (1) L'appareil ne doit pas produire de brouillage;
- (2) L'appareil doit accepter tout brouillage radioélectrique subi, même si le brouillage est susceptible d'en compromettre le fonctionnement.

CAN ICES-003 (B)/NMB-003 (B)

This Class B digital apparatus complies with Canadian ICES-003.

(Cet appareil numérique de la Classe B conforme à la norme NMB-003 du Canada).

## Radiation Exposure Statement Déclaration d'exposition aux radiations

This EUT is compliance with SAR for general population/uncontrolled exposure limits in IC RSS-102 and had been tested in accordance with the measurement methods and procedures specified in IEEE 1528 and IEC 62209. This equipment should be installed and operated with minimum distance 0 mm between the radiator and your head. This device and its antenna(s) must not be co-located or operating in conjunction with any other antenna or transmitter.

Casque de musique:

Cet EUT est conforme au SAR pour la population générale/limites d'exposition non contrôlées dans IC RSS-102 et a été testé conformément aux méthodes et procédures de mesure spécifiées dans IEEE 1528 et CEI 62209. Cet équipement doit être installé et utilisé à une distance minimale de 0 mm entre le radiateur et votre tête. Cet appareil et ses antennes ne doivent pas être situés ou fonctionner en conjonction avec une autre antenne ou un autre émetteur.

---

## Důležité bezpečnostní pokyny

- Výrobek nerozebírejte.
- Uchovávejte mimo dosah dětí. Výrobek obsahuje malé části, které mohou představovat nebezpečí udušení.
- Baterii nevystavujte příliš vysokým teplotám, například přímému slunečnímu záření, ohni a podobně.
- Nepoužívejte v prostředí s příliš vysokou nebo příliš nízkou teplotou a nevystavujte ho silnému slunečnímu záření nebo prostředí s vysokou vlhkostí.
- Při nabíjení zkontrolujte, že na nabíjecím portu není žádná tekutina, pot nebo voda.
- Úroveň odolnosti sluchátek vůči vodě najdete v uživatelské příručce. Postupujte podle příslušných pokynů.
  - Pro úroveň IPX4: Sluchátka nevystavujte kapajícím ani stříkajícím kapalinám.
  - Pro úroveň IPX4, IPX5 a IPX6: Sluchátka neponořujte do vody.



### Ochrana sluchu

- Pokud chcete zabránit poškození sluchu, nepoužívejte sluchátka po delší dobu při vysoké hlasitosti.
- Nezvyšujte hlasitost tak, že neuslyšíte, co se děje ve vašem okolí.
- Nepoužívejte sluchátka při řízení.
- V potenciálně nebezpečných situacích dbejte opatrnosti, nebo sluchátka na chvíli přestaňte používat.

- עבור IPX4: אין לחשוף את האוזניות למים מטפטפים או ניתזים.
- עבור IPX4, IPX5 ו-IPX6: אין להשקיע את האוזניות במים.

## בטיחות השמיעה



- כדי למנוע נזק לשמיעה, אל תאזין זמן ממושך בעוצמת קול גבוהה.
- אל תגביר את עוצמת הקול עד כדי כך שלא תוכל לשמוע את סביבתך.
- אל תשתמש באוזניות במהלך נהיגה.
- במצבים שעלולים להיות מסוכנים, עליך לנקוט זהירות או להפסיק זמנית את השימוש.

המוצר יוצר שדות מגנטיים קבועים חזקים יותר, שעלולים לגרום להפרעה לקוצבי לב, דפיברילטורים מושתלים (ICD) ושתלים אחרים. תמיד יש לשמור על מרחק של 3.94 אינץ' / 10 ס"מ לפחות בין רכיב המוצר המכיל את המגנט (אוזניות ומארז הטעינה) לבין קוצב הלב, הדפיברילטור המושתל או שתל אחר.



The Bluetooth® word mark and logos are registered trademarks owned by the Bluetooth SIG, Inc. and any use of such marks by Anker Innovations Limited is under license. Other trademarks and trade names are those of their respective owners.



For FAQs and more support information, please visit:

For FAQs and more support information, please visit:



Model: A3874 / A3874L / A3874R  
51005005002 V1