

PG-9090 说明书 70g 书写纸双面印刷/单色印刷 尺寸: 105x142mm



## Blue Elf Wireless Controller

User Manual(PG-9090)

### Application Instruction:

- 1.New upgraded gamepad, direct connect &Play , easy to operate, no activation, directly play , no APP needed, (system requirements: support for Android systems above 6.0 , IOS systems 11.0~13.3.1).
- 2.The product is suitable for operating games on Android mobile (tablet) / IOS mobile (tablet) / Android smart TV / P3 console / N-S console / PC through wireless connection, as well as P3 console / N-S console / PC computer over a wired connection.
- 3.Design with telescopic phone stand (Extend maximum size 45-80mm).
- 4.Ergonomic structure, comfortable hand feeling.

- ★ Due to mobile phone system problems, individual mobile phones may not support this device (e.g. the mobile phones of the Media Tek platform can not support it ).
- ★ Due to the official game platform software upgrade or source code changes and other not resist factors caused of some games can not be played or connected with our gamepad. iPega has no responsibility , iPega reserves the right of final interpretation.

### Instruction for key function :

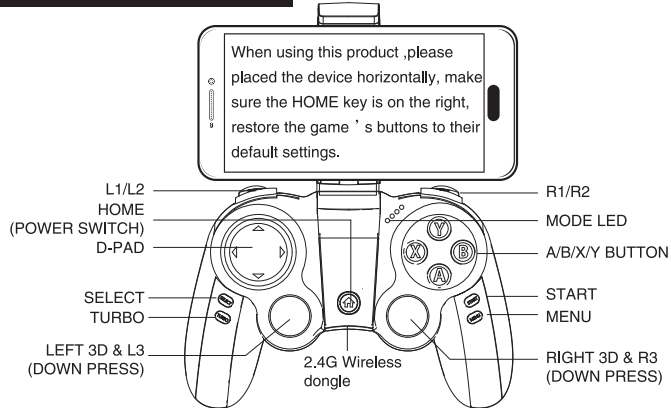

### Direct Play Mode ( Android V3):

Press A+ for 2seconds to enter direct play mode (Android V3) , then search PG-9090 on mobile BT and paired, LED1 will be always on after connected successfully. Once connected , press , LED1 flashes slowly, reconnect automatically.

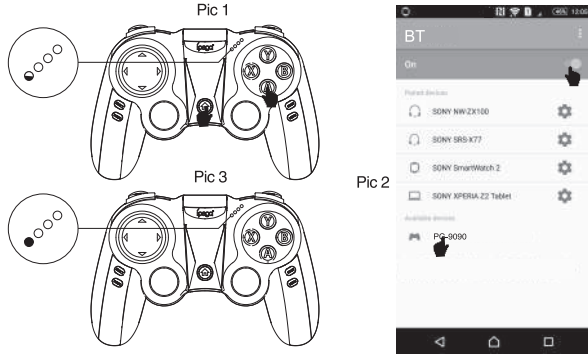

### Direct Play Mode (IOS V3):

Press Y+ for 2 seconds to enter direct play mode (IOS V3), will flash quickly, then search PG-9090 on mobile BT and paired, LED2 will be always on after connected successfully. Once connected , press , LED2 flash slowly, reconnect automatically.



### Mapping for direct play mode:

Check the default operation, if need to modify the buttons by yourself, please download "Shootingplus" App and set up the mapping from "Shootingplus" App. Search "www.ipega.hk" and find the detailed operation on this website.

### Android standard game mode:

Press X+ for 3 seconds to enter the mode and pairing,LED3 flashes,search"PG-9090" on Android mobile/tablet/smart TV and connect, after connected successfully, LED3 is always on. When device is connected, if the device is under sleep mode, Press" " to reconnect automatically. You can directly play simulator games, or you can download the Gamepad enabled games from Google Play Store. Below are the recommend games for reference: Fortnite/ Implosion/ Dead Trigger/ Dead Effect/ CS Portable.

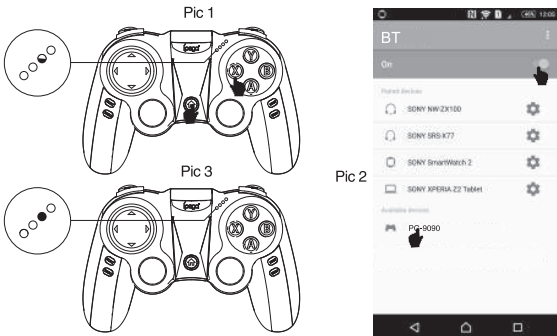

### Wired mode:

It will automatically recognizes different mode under wired mode. Press "R1" button while plug in the USB data cable, LED1&LED3 flash quickly. Support Windows PC, Android device, P3 and N-S. 1. PC connection method: Press "R1" button while plug in the USB data cable to Windows PC ( The default mode is X-input 360 mode), LED3 is always on. Press and hold "select+start" for 3 seconds N-S to D-input mode, LED2 is always on. 2. P3/N-S/ Android connection method: Press and hold "R1" button while plug in the USB data cable to console, LED light will be always on after successfully connected. (The console will distribute LED indicator light automatically).

### Operation Instructions:

BT Connection instruction (press and hold on 3s)	Android BT Mode		IOS BT Mode
	Direct Play Mode (Android V3)	Android General model	Direct Play Mode (IOS V3)
Indicators	A+	X+	Y+
Remark	Gamepad operation and Touch screen operation are not supported at the same time	LED 3	LED 2

BT Connection instruction (press and hold on 3s)	Wired mode(connecting by USB data cable )	
	P3/N-S/ Android Wired mode	PC Wired mode
Indicators	Press the R1 button and connect the gamepad to the P3 console's port via the USB cable.	
Remark	Automatically allocated by console LED lights always on	

### 2.4G mode:

Insert the 2.4G receiver to the USB interface of delice compatible with PC,Android decidue PS3 Canade ,N.S Console.at the same time Press L1+ For 3 seconds to enter 2.4G receiver mode,LED1 and LED2 flashes, both two indicators will be always on after connected successfully, When device is connected, press" " to reconnect if sleep mode.

### TURBO/MENU function:

- a.Action button includes(A/B/X/Y/L1/L2/R1/R2),all these buttons can set up the TURBO function.
- b.Setting Method: Long press any of the action buttons first, then press TURBO to start up. opposite, Long press action button, press TURBO to shut off.
- c.TURBO function will be cleared automatically as soon as the product enter to sleep mode, power off or re-tum on the device,need to re-set up TURBO function.
- d.Different Android device different menu mode,press MENU button on gamepad, the mobile will display a MENU interface for the user to manage, press the button again to exit. Remarks: This function only support parts of Android device.

### Charging/Sleep/Wake up/ Turn off function:

- 1.Charging function:
  - a.Lower power, LED4 flashes quickly indicate to charge.
  - b.Charging, LED4 flashes slowly.
  - c.Fully charged, LED4 is always on.
- 2.Sleep/Wake up/ Turn off function:
  - a.Gamepad will enter to sleep mode if without operation in 5 min.
  - b.Press" " button to reconnect.
  - c.Long press" " for 3 seconds, device will turn off, all LED indicator will be off.

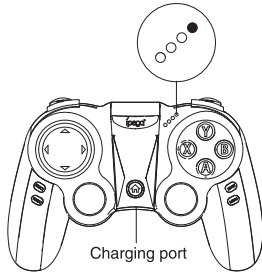

### Electrical Parameter:

- 1.Working voltage: DC3.7V
- 2.Working current: <20mA
- 3.Static current: <15uA
- 4.Continuous gameplay time: >15H
- 5.Charging voltage /current: DC5V/500mA
- 6.Charging time: almost 2hours
- 7.BT 5.0, transmission distance: ≤8M
- 8.Battery capacity: 300mAh
- 9.Standby time: up to 30 days once fully charged

### Notes:

1. Please do not store this product in wet or high-temperature areas.
2. Don't knap, beat, drub, pierce, or try to decompose this product, to avoid unnecessary damage to the product.
3. The product has built-in batteries, and please don't discard them together with the garbages.
4. Don't charge the controller in a place near the fire or other heat source.
5. Non professional personnel should not disassemble the product, otherwise it will not be covered in the after-sales warranty service.

### Accessories List :

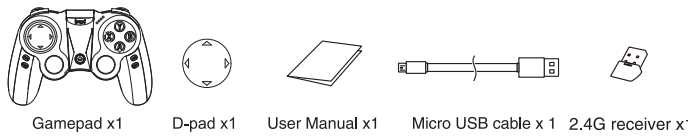

## 蓝精灵无线游戏手柄

产品说明书(PG-9090)中文版

### 产品适用说明:

- 1.产品支持直连直玩，无需多余的游戏平台和复杂的设置与激活操作.(支持安卓6.0以上，IOS11.0~IOS13.3.1系统)。
- 2.产品适用于安卓手机(平板)/苹果手机(平板)/安卓智能电视/P3主机/N-S主机/PC电脑等无线连接使用,同时可支持P3主机/N-S主机/PC电脑有线连接.进行游戏操作时使用。
- 3.一体式拉杆伸缩支架(拉伸度45-80mm)。
- 4.结构符合人体工学,手感舒适。

★因官方游戏平台软件升级或源代码变更等不可抗拒的因素造成部分游戏无法与本产品连接操作，我公司不承担任何责任。对此我公司保留最终解释权。

技术支持QQ群: 837350687  
客服电话: 0755-2791 8998  
在线时间: 周一至周五9:30-17:30



ipega官方微信公众  
(关注微信号 下载游戏文件)

### 功能按键图示:

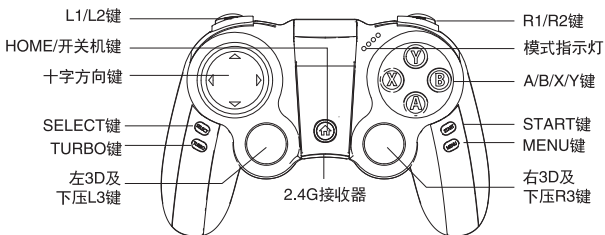

### 产品特性参数:

- 1.工作电压: DC3.7V
- 2.工作电流: <20mA
- 3.静态电流: <15uA
- 4.持续使用时间: >15H
- 5.输入电压/电流: DC5V/500mA
- 6.充电时间: 约2小时
- 7.BT 5.0, 传输距离: ≤8M
- 8.电池容量: 300mAh
- 9.待机时间: 满电放置30天

### 产品使用说明:

#### 安卓 V3 直玩模式:

同时按A+ 键2秒进入V3直玩配对模式(安卓), 手柄LED1灯快闪, 当安卓手机/平板搜索到“PG-9090”设备名时, 选择连接. 连接成功后, 手柄LED1灯常亮. 已成功连接过, 可以直接按 键, LED1灯慢闪, 自动回连。



#### IOS V3 直玩模式:

同时按Y+ 键2秒进入V3直玩配对模式(IOS), 手柄LED2灯快闪, 当苹果手机/平板搜索到“PG-9090”设备名时, 选择连接. 连接成功后, 手柄LED2灯常亮. 已成功连接过, 可以直接按 键, LED2灯慢闪, 自动回连。



### 安卓/IOS直玩按键映射功能:

关注公众号 (“ ShootingPlus ”) , 查看公众号内的默认操作说明, 如需设置映射键位, 请下载安装 “ ShootingPlus V3 ” APP. 在APP内进行按键映射以及调整按键位。

### 安卓标准游戏模式:

同时按X+ 键3秒进入安卓标准游戏配对模式, 手柄LED3灯快闪, 当安卓手机/安卓平板/安卓智能电视搜索到“PG-9090”设备名时, 选择连接. 连接成功后, 手柄LED3灯常亮. 已成功连接过, 可以直接按 键, LED3灯慢闪, 自动回连。

安卓游戏平台: 葡萄游戏厅



### 有线模式:

有线模式下自动识别各个模式, 按下R1键插USB数据线LED1灯和LED3灯快闪; 支持PC电脑、安卓设备、P3主机、N-S主机。

- 1.PC电脑连接方法: 按下R1键插USB数据线PC连接成功后默认为X-input 360模式, 手柄LED3灯长亮. 同时按下 select+start 3秒切换为D-input P3模式, 手柄LED2灯长亮。
- 2.P3/N-S主机和安卓设备连接方法: 按下R1键插USB数据线, 设备连接成功后手柄LED灯长亮, (LED灯主机自动分配)。

### 操作使用模式:

模式配对 (长按3秒)	安卓无线模式		IOS无线模式
	安卓V3直玩模式	安卓标准模式	IOS V3直玩模式
模式 指示 灯	A+	X+	Y+
备 注	LED 1	LED 3	LED 2

模式配对 (长按3秒)	有线模式	
	P3/N-S主机和安卓设备有线模式	PC有线模式
模式 指示 灯	按下R1键再用一条USB数据线将产品与主机相连	
备 注	主机自动分配, LED灯常亮	

### 2.4G模式:

将手柄自带的2.4G接收器插入设备的USB口, 同时可支持PC、安卓设备、P3主机、N-S主机. 同时按L1+ 键3秒进入2.4G接收器模式, 手柄LED1与LED2灯快闪, 连接成功后, 手柄LED1与LED2灯常亮. 已成功连接过, 可以直接按 键, LED1与LED2灯慢闪, 自动回连。

### TURBO/MENU功能:

- a.动作键包括(A/B/X/Y/L1/L2/R1/R2)八个按键, 均可手动设置TURBO功能。
  - b.设置方式: 长按动作键, 再轻按TURBO键开启, 长按动作键, 再轻按TURBO键, TURBO功能关闭。
  - c.产品休眠、关机、重启手柄后, 之前设置Turbo功能自动清除, 若启用Turbo功能, 必须重新设置。
  - d.不同的安卓设备进入菜单模式将不同, 在部分安卓设备桌面按下MENU, 手机进入菜单页面, 方便安卓设备整理桌面, 再次按下将退出菜单模式。
- 注: 此功能仅支持部分安卓设备。

### 手柄充电/休眠/唤醒/关机功能:

- 1.手柄充电功能:
  - a.低电时, LED4指示灯快闪提示。
  - b.充电时, LED4指示灯慢闪提示。
  - c.充满时, LED4指示灯长亮提示。
- 2.手柄休眠/唤醒/关机功能:
  - a.游戏手柄在5分钟内无任何按键操作时自动关机休眠。
  - b.当需要重新使用时需按 键唤醒即可回连。
  - c.在开机状态下, 长按 键3秒, 产品关机, 所有LED指示灯熄灭。



### 注意事项:

1. 请不要把本产品放在潮湿或高温地方存储。
2. 不要敲击、摔打、棒打、刺穿、或试图去分解本产品, 以免对产品造成不必要的损害。
3. 产品内置电池, 请勿和垃圾一起丢弃。
4. 不要在靠近火或其他热源的地方对手柄进行充电。
5. 非专业人员误拆卸本产品, 否则不在售后保修服务内。

### 产品清单:

