

8KG VENTED DRYER

KAJDRYVT80A

SAFETY & WARNINGS

Read this manual thoroughly before first use, the safety precautions enclosed herein reduce the risk of fire, electric shock and injury when correctly adhered to. Retain this user guide for future reference. If applicable, pass these instructions on to the next owner.

- Do not attempt to repair this product yourself. If the product or its power supply experiences any malfunction or damage, cease use immediately and contact Kogan.com for support.
- This appliance is not intended for use by persons (including children) with reduced physical, sensory or mental capabilities or lack of experience and knowledge, unless they have been given supervision or instruction concerning use of the appliance by a person responsible for their safety.
- Ensure children are supervised so that they do not play with the appliance.
- Ensure the lint filter is cleaned after every cycle and whenever prompted by the dryer.
- The lint filter and air intake filter should be washed frequently.
- Lint must not to be allowed to accumulate around the tumble dryer.
- **WARNING:** The appliance must not be supplied through an external switching device, such as a timer or connected to a circuit that is regularly switched on and off by a utility.
- This appliance is not intended for outdoor use.
- Do not place any open flames, such as candles or lit cigarettes, on the appliance.
- Do not locate the appliance or cord near heat sources such as radiators, heaters, air ducts or direct sunlight.
- The dryer must not be installed behind a lockable door, a sliding door or a door with a hinge on the opposite side to that of the tumble dryer, in such a way that the operation of the dryer door is restricted.
- Avoid stopping the dryer before the end of the drying cycle. If this cannot be avoided ensure all items are removed quickly and spread out to allow the heat to dissipate.
- The final part of a tumble dryer cycle occurs without heat (cool down cycle) to ensure that the items are left at a temperature to reduce wrinkling and ensure that the user will not be exposed to remaining heat that could cause injury.
- Do not block any of the ventilation openings or allow them to be blocked by newspapers, tablecloths, curtains, etc. Do not install inside a narrow cabinet.
- For appliances with ventilation openings in the base, ensure that the floor covering does not obstruct the openings.
- That exhaust air must not be discharged into a flue which is also used for exhausting fumes from appliances burning gas or other fuels.

- Do not run the cord under floor coverings. Instead, arrange the cord away from traffic areas where it will not become a trip hazard.
- To disconnect the appliance, turn the appliance off, switch off the power outlet and remove the plug from the power outlet.
- Never carry the appliance by the cord or pull to disconnect it from the outlet. Instead, grasp the plug and pull to disconnect.
- This appliance is only to be serviced by a qualified person. There are no user-serviceable parts inside
- Do not bend, stretch, twist or bind the power cord or place heavy objects on it.
- Do not use an extension cord with this appliance.
- Do not overload the dryer.
- Keep the drum clear of foreign objects and always remove items from pockets before placing them in the dryer.
- The door window may be hot after a long drying cycle. Please ensure children are kept away from the machine.
- If the dryer is not wall mounted, place in a flat, firm, dry and draft place. Use the adjustable front legs to assist in levelling the dryer if need be. Do not place it on any soft material such as foam or plastic
- After turning off the power supply to the dryer, wait at least 2 minutes before turning it back on again.
- Remove all packaging from the dryer, prior to first use.
- Should the appliance need to be moved, it must be transported vertically.
- Delicate items should be placed into a nylon net bag prior to drying. It is not recommended to dry underwire bras in this unit.
- Do not add items into the dryer whilst it is running.

Electrical safety and cord handling

Always follow basic safety precautions and accident prevention measures when using an electrical appliance, including the following:

- **Voltage:** Ensure your outlet voltage and circuit frequency correspond to the voltage indicated on the appliance's rating label and your outlet socket is properly earthed. If this is not the case, do not use the dryer.
- **Separate circuit:** We strongly recommend you connect the appliance to a separate circuit serving only this appliance. This provides the best performance and prevents overloading the house wiring circuits that could cause a fire hazard from overheating.
- **Electrical hazard:** Do not insert any objects into the appliance.
- **No extension cord:** Do not use this appliance with a power adaptor or extension cord.

WARNING: If such a device must be used, the cord or outlet must be positioned so that it is not subject to splashing or liquid ingress.

- **Protect the power cord.** Do not kink or damage the power cord. Position the cord out of the way so no one steps on or places anything on the cord or against it. Do not run the cord under floor coverings. Position the cord away from high traffic areas where it will not become a tripping hazard.
- **Disconnect:** Unplug the clothes dryer from the power supply after use, before cleaning, servicing or moving the appliance. To disconnect, turn the appliance off, switch off the power outlet and remove the plug from the power outlet. Grip the plug when disconnecting; do not pull on the cord. After disconnection, wait at least 2 minutes before turning the appliance back on again.
- **RCD:** Unless your home is already fitted with a residual current device (safety switch), we recommend installing an RCD with a rated residual operating current not exceeding 30mA to provide additional safety protection when using electrical appliances. Consult an electrician for professional advice.

Usage conditions and restrictions

This appliance is intended for indoor household use only. It is not intended for industrial, commercial or trade use. Do not use it outdoors. Do not use it for anything other than its intended purpose (drying domestic quantities of washing) and only use it as described in this manual.

Unsuitable Items:

The items listed below are unsuitable for tumble drying. They can cause fire in the clothes dryer or extensive damage. Do not place the following items into the clothes dryer.

- Items containing foam rubber (also known as latex foam) or similarly textured rubber-like materials - when heated, these materials can spontaneously combust and cause a fire.
- Items that have been spotted or soaked with cooking oil or with highly flammable substances - these substances constitute a fire hazard. Highly flammable substances used in domestic environments include acetone, alcohol, petrol, kerosene, some stain removers, dry-cleaning solvents, turpentine, waxes, wax removers and some hair care products. (This also includes items that have previously been cleaned or spotted with dry-cleaning solvents or other flammable or explosive substances.)
- Washing these items thoroughly beforehand in hot water with an extra amount of detergent will reduce, but not necessarily eliminate the hazard. The 'cool down' cycle of a clothes dryer should be used to reduce the temperature of the items. They should not be removed from the clothes dryer or piled or stacked while hot.
- Undergarments that contain metal reinforcements (such as underwire bras) - these parts can come loose during drying and damage the clothes dryer.
- Plastic articles such as shower caps or waterproof baby bibs.
- Rubber-backed articles, clothes fitted with foam rubber pads, pillows, galoshes and rubber coated tennis shoes.



Oil-affected items can ignite spontaneously, especially when exposed to heat sources such as in a tumble dryer. The items become warm, causing an oxidation reaction in the oil. Oxidation creates heat. If the heat cannot escape, the items can become hot enough to catch fire. Piling, stacking or storing oil-affected items can prevent heat from escaping and so create a fire hazard.

- Do not dry unwashed items in the tumble dryer.
- This dryer is not to be used if industrial chemicals have been used for cleaning.

OVERVIEW

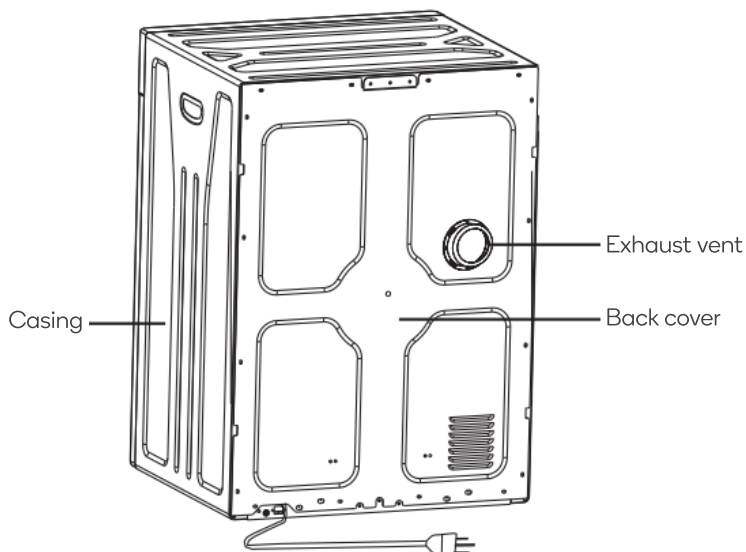
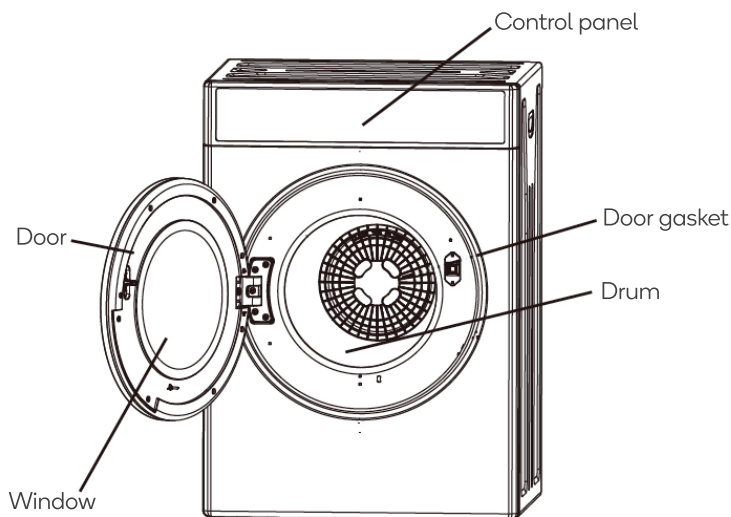

INSTALLATION

The dryer comes with fixed legs that need to be assembled to ensure stability.

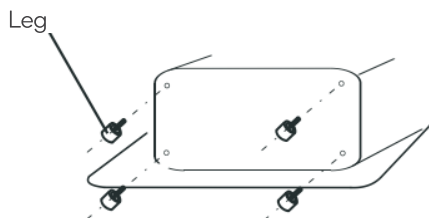

If the dryer is not wall mounted, it must be placed on a firm horizontal surface. Do not place the dryer on carpet as this will block the intake. There should be at least 15cm between the dryer and the walls.

If the dryer is rack mounted. A secure bracket (not included) is required to ensure stability and prevent vibration. At least 15cm between the dryer and walls is required (The bracket is not included).

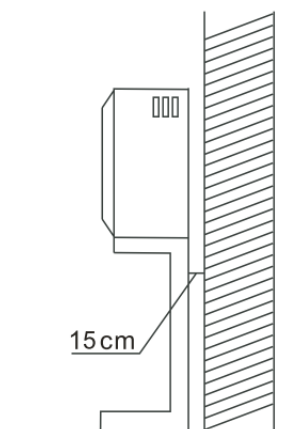
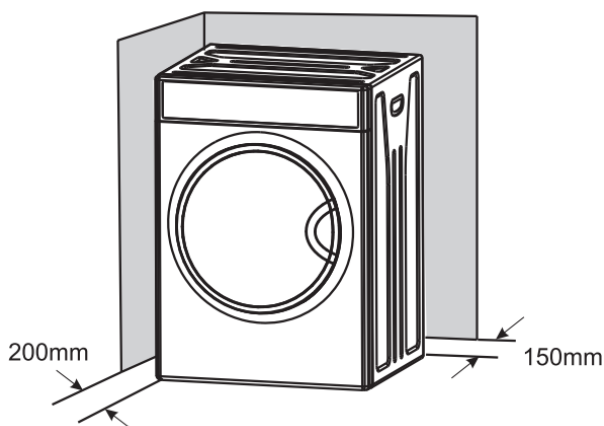

WALL MOUNTING

Wall Mounting Kit



Wall brackets (x2)



Spacers (x2)



Exhaust connector

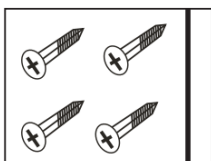

12mm Screws (x4)

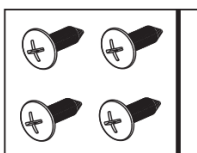

25mm Screws (x4)

Tools Required



Drill & Ø3mm drill bit

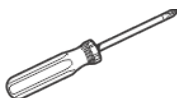

Phillips head screwdriver



12x50mm Timber screws (x4)
(not supplied)

Note: It is highly recommended to seek the assistance of a second person to help lift the dryer on onto the wall bracket.

Mounting the Dryer

- 1. Determine the location for installation and mark the wall. If installing above a top loader washing machine, leave sufficient space to open the lid. A minimum of 50mm is needed between the top of the dryer and the ceiling

WARNING: The dryer must be mounted to the wall studs and not the plaster. Ensure you are not drilling into any electrical wiring. If you are unsure, consult a trade professional.

- 2. Securely attach the wall brackets (included) to the wall 440mm apart, ensuring you are mounting into the wall studs (Figure 1).

Note: If the position of the wall studs is too far apart, a timber slat (not included) can be attached to the studs to provide a suitable mounting surface for the wall brackets.

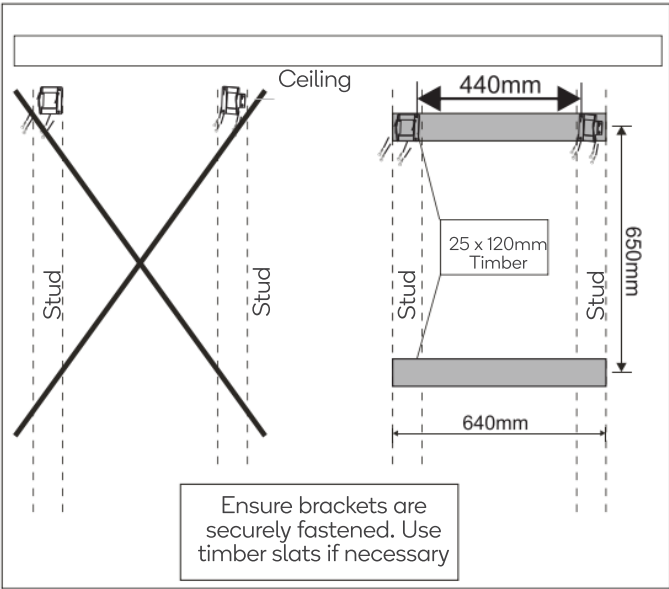
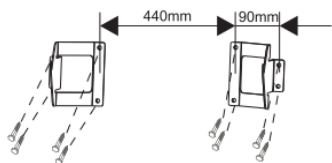

Figure 1

3. Use the x4 25mm screws to attach the x2 wall brackets to the timber slat (Figure 2).

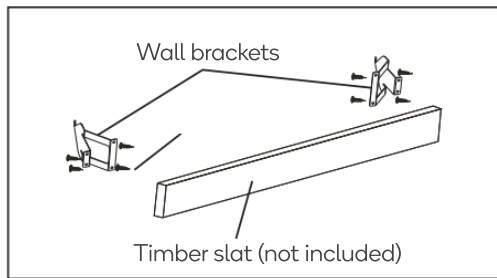

Figure 2

4. Align the wall brackets fasten screws tightly.
5. Attach the exhaust connector to the connector base by rotating it in a clockwise direction (Figure 3).

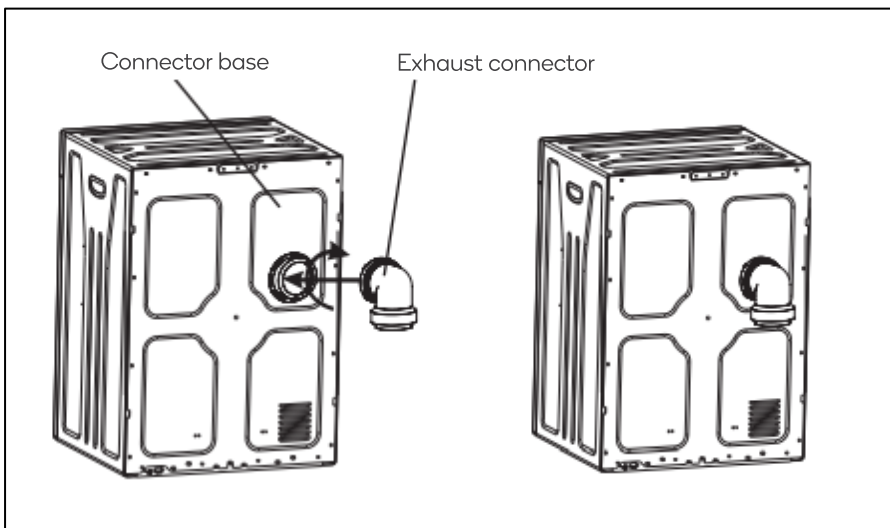

Figure 3

6. **Normal mounting:** Using the x4 12mm screws, attach the x2 spacers to the dryer (Figure 4).
- Inverted mounting:** Remove the x4 existing screws then using x4 12mm screws attach the x2 spacers to the dryer (Figure 5)
7. With assistance, carefully mount the dryer onto the wall brackets.

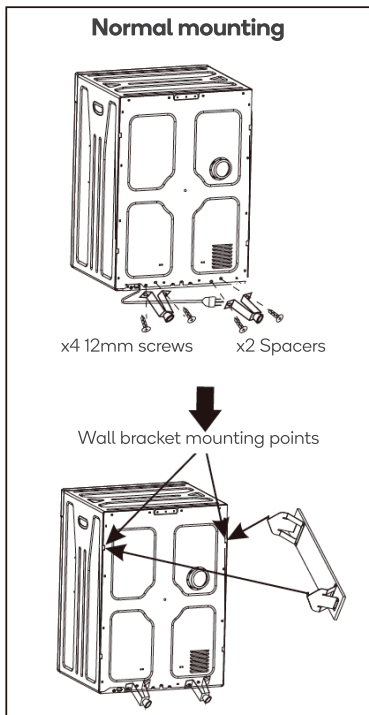

Figure 4

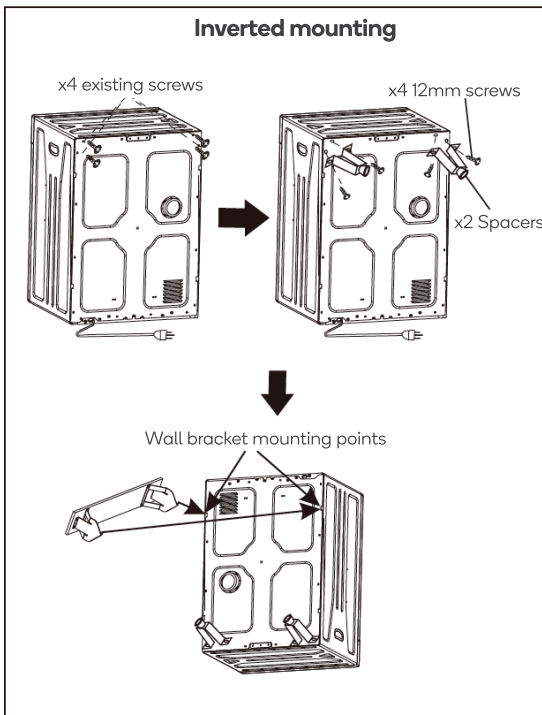
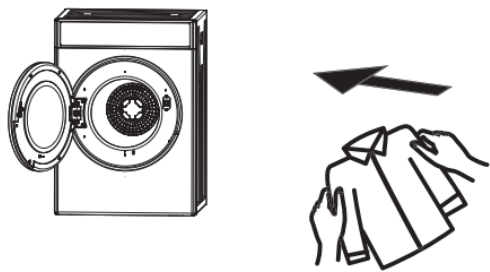

Figure 5

OPERATION

Loading

It is recommended to place items in the dryer one at a time. This ensures they do not become tangled, which results in uneven drying. When closing the dryer door, ensure items are not jammed.



Tips Before Drying

Do not use this appliance to dry garments if they have one of the following warning labels:



Dry flat



Dry in the Shade



Do not tumble
dry



Hang to dry



Drip dry

- Turn items with zippers inside out, fasten buckles and remove all objects such as lighters, coins, etc.
- Dryer heat may permanently set stains. Ensure stains are removed prior to drying.
- Separate dark and light-coloured clothing.
- For best results, dry similar materials together and place small, delicate items into mesh a mesh bag and take care not to overload.

Drying guide:

Drying Capacity	Dry Time
Approx. 1kg	Approx. 30min
Approx. 2kg	Approx. 60min
Approx. 4kg	Approx. 120min

Approx. 6kg

Approx. 200min

Control Panel

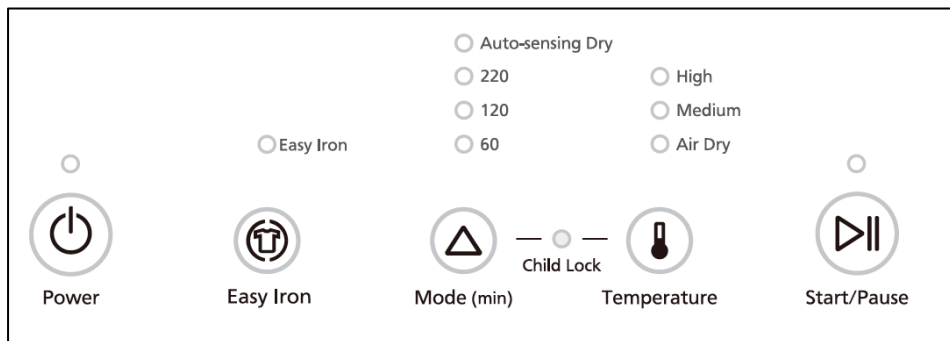

Power Button

Press the power button to turn the dryer on and off.

Easy Iron

Press to enable the Easy Iron program. The light above the button will come on.

When this program is selected, the dryer will add an 8-10-minute air-dry cycle after the set drying program. During this cycle only cool air (no heat) will be generated to help prevent creasing of the items just dried.

Note: To ensure you get the most out of the Easy Iron function, do not overload the dryer. Remove the dried items from the dryer immediately and hang on coat hangers or fold.

Mode

Press the Mode button to cycle through the options:

- **Auto-sensing Dry:** The dryer will stop working when it detects that the laundry has been dried.

Note: The maximum running time of this program is 220 min. Certain materials may not be dry enough by the end of the cycle, if this occurs, try a fixed program instead. Not recommended for loads less than 2kg.

- **220min:** Select this program to run the dryer for 220 minutes.
- **120min:** Select this program to run the dryer for 120 minutes.
- **60min:** Select this program to run the dryer for 60 minutes.

Temperature Button

Press this button to cycle through the temperature options:

- **High:** On this setting, the dryer uses two sets of heating elements running simultaneously, providing the strongest hot airflow.
Note: “Easy Iron” function should be used after the high heat cycle to reduce the temperature of the items. They should not be taken out from the dryer, piled or stacked while hot.
- **Medium:** On this setting, the dryer uses a single heating element, providing medium temperature airflow.
- **Air Dry:** On this setting, the dryer doesn’t use the heating elements. This function uses cool air to for items that require freshening.

Start / Pause

Press this button to start or pause the dryer program.

If the door is opened during operation, close the door and push this button to restart the dryer.

Press the “Pause” button to make adjustments to the program, then push “Start” to restart the dryer.

Child Lock

Press and hold the “Mode” and “Temperature” buttons at the same time for 3 seconds until “Child Lock” light comes on. All other buttons will be locked. Press and hold the “Mode” and “Temperature” buttons at the same time for 3 seconds to disable the child lock.

Operation precaution:

If drying large items such as a blanket, it is recommended that from time to time you open the dryer door, shake the item, place the item back in the dryer and close the door. This will ensure even drying

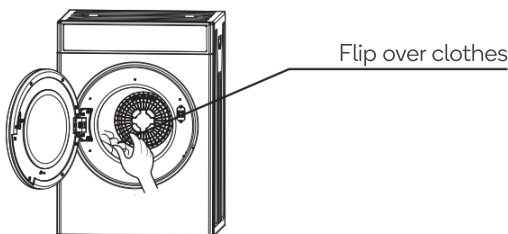

CLEANING & CARE

Disconnect the appliance from the power outlet before you perform any cleaning or maintenance.

Cleaning Interior & Exterior of Dryer

- Do not clean the dryer by directly spraying water onto it.
- Do not clean using benzene, thinner, alcohol or acetone as this may cause discoloration, deformation, damage, electric shock or fire.
- Clean the external surfaces of the dryer using a soft cloth with a solution of soap and water and then dry thoroughly.
- Do not use any type of spray cleaner when cleaning the interior. The drum can be cleaned with a damp cloth.
- Thoroughly dry and remove any residue before next operation

Cleaning the Filter

Note:

Ensure the lint filter is cleaned after every cycle and whenever prompted by the dryer.

Step 1: Removing filter

Remove the filter by pulling in an outward direction.

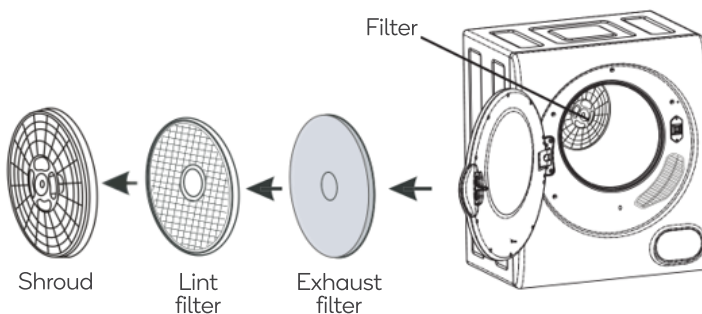

Step 2: Cleaning filter

- Separate the shroud, lint filter and exhaust filter.
- Clean using a soft brush or vacuum cleaner, taking care not to damage any of the components.

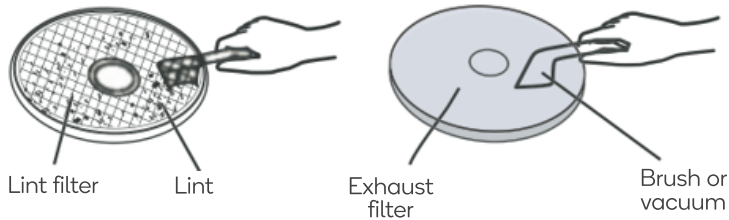

Step 3: Reinstalling

- Reassemble the filter, aligning recesses in the centre with the centre of drum.
- Ensure the filter it is firmly inserted.

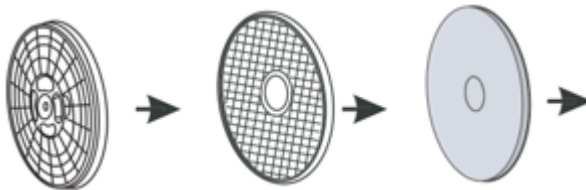

WARNING: Never operate the appliance without the filter installed.

Cleaning the Air Intake Filter

Note:

Ensure the air intake filter is cleaned at least once a month.

- Remove the air intake filter shroud by pulling it in an outward direction
- Carefully separate the filter from the shroud and clean using a soft brush before reassembling.
- Replace the air intake filter shroud back into the dryer.

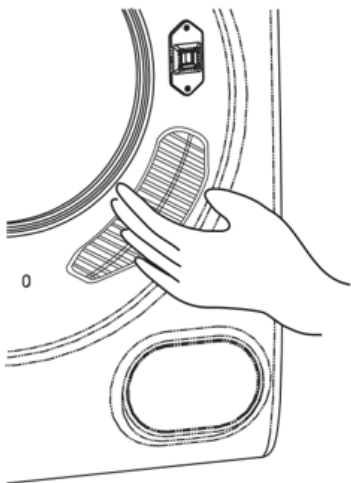

Air intake shroud



Air intake filter

SPECIFICATIONS

Drying capacity	8kg
Voltage	220-240V 50/60HZ
Rated input	1900W
Net weight	29kg
Dimensions	600 x 595 x 850mm

TROUBLESHOOTING

Review the following pages before calling for service.

Problem	Possible Cause	What to do
Drum does not turn	<ul style="list-style-type: none">• Is the door closed?• Is the power cord plugged in?	<ul style="list-style-type: none">• Close the door.• Insert the power cord firmly.
The laundry is not thoroughly dried	<ul style="list-style-type: none">• Are the filters clogged?• Is the dryer overloaded?• Have items been added whilst the dryer is in the middle of a cycle?• Has the laundry become twisted whilst drying?• Has the dryer been placed in a small and poorly ventilated area?• Have you set the dryer to Air Dry?	<ul style="list-style-type: none">• Clean the filter,• Reduce the load in the dryer.• Re-dry items again.• Untwist the items and re-dry.• Place the dryer in a well-vented area.• Try using “Medium” or “High” setting instead.
Dryer does not start	<ul style="list-style-type: none">• Is there a power failure?• Is the power cord inserted firmly?• Is the door closed?	<ul style="list-style-type: none">• Try again when there is power.• Insert the power cord firmly.• Close the door.
Door opening alarm (all LEDs flashing and dryer beeping)	Is the door closed?	Close the door and press the “Start / Pause” button.

NOTES

[illegible]

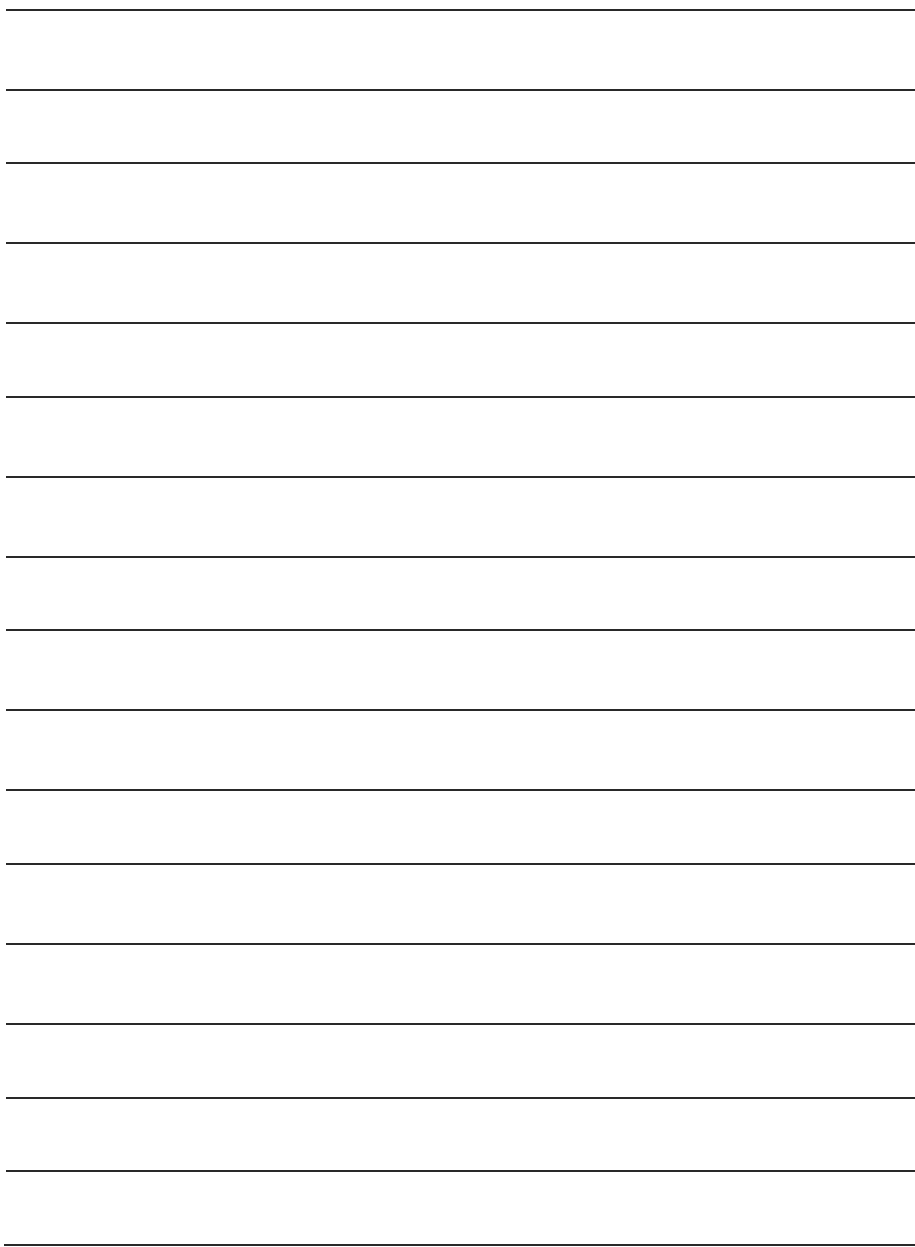

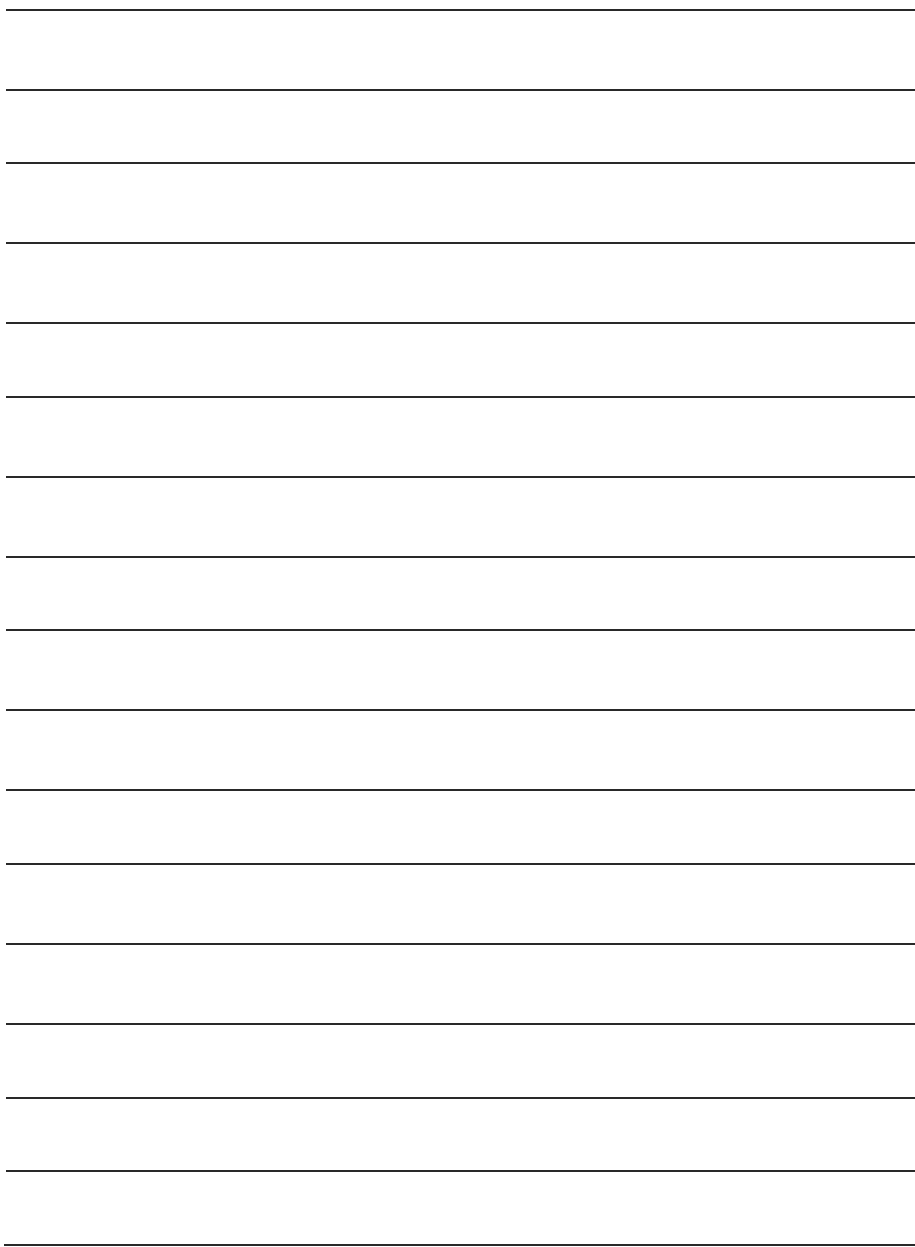

Need more information?

We hope that this user guide has given you the assistance needed for a simple set-up. For the most up-to-date guide for your product, as well as any additional assistance you may require, head online to **help.kogan.com**

kogan.com