

INSTRUCTION MANUAL



MODEL: OFB18M

RECHARGEABLE FAN

AC/DC OPERATED
RECHARGEABLE FAN WITH
SUPER BRIGHT LED LIGHT



Please read these instructions before first use:

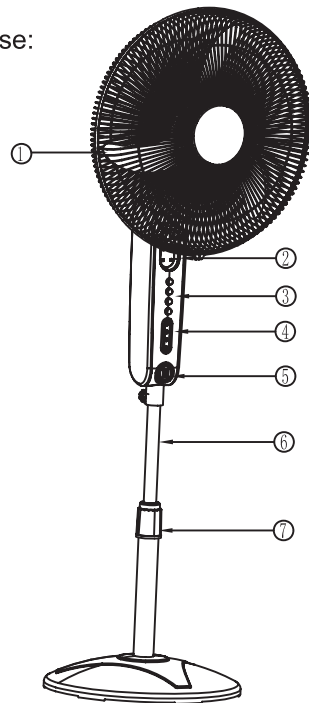

- 1: Fan blade
- 2: LED light
- 3: Button
- 4: Battery level indicator
- 5: Speed level indicator
- 6: Expansion link
- 7: Adapter sleeve
- 8: Oscillating switch
- 9: Battery cover
- 10: AC port
- 11: Rotary knob for expansion link
- 12: USB socket

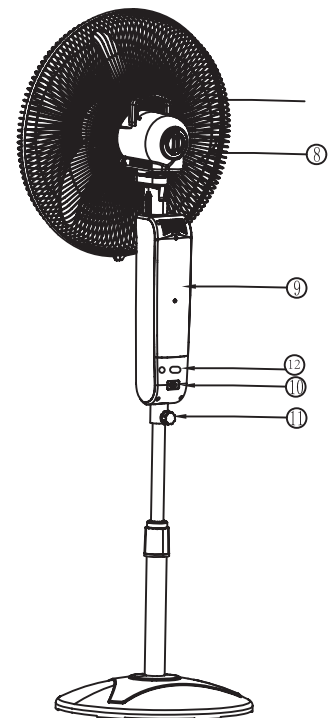

ATTENTION

1. Please read this instruction before first use
2. Please ensure that the voltage indicated on the appliance corresponds with the mains voltage.
3. When the led gets dim, please recharge the product.
4. Charge at least once in every 3 months for 8 hours even when the appliance is not in use.
5. Please keep the fan switch in OFF status when not in use.
6. Suitable operating ambient humidity level is 0 C-40 C
7. Avoid using in water or moist.

HOW TO USE THE FAN

- 1: ON /OFF function: Press ON/OFF to choose to turn on or turn off the fan. Battery level indicator will show the capacity of the battery as picture 2.
- 2: SPEED function: Press SPEED to choose any speed you like . The fan will start from 3-speed (as picture 3).
The fan will be cycled by 4-5-1-2-3 after every pressed.
- 3: TIMER function : Press TIMER to choose the expected timing hours. Press one time means interval time is 1 hours
(Speed level indicator shows Number 1).
Press one more time, Press one more time, means the interval time is 2 hours (Speed level indicator shows Number 2).
By that analogy, the max timing is 8 hours.
- 4: LIGHT function: Press the LIGHT button to choose to turn on or turn off the LED light.
- 5: When plug into the AC power, the fan will charge automatically (battery level indicator will not stop running until it is fully charge).
- 6: The fan has an oscillating knob as picture 4. you can choose the fan oscillating or stationary in any angle.
- 7: Unscrew the Adapter sleeve (part 7) can adjust the height of the expansion link, max available space is 200mm.
can use the rotary knob to fix the right height you like.



Picture 1

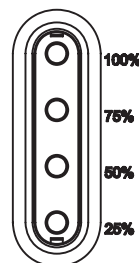

Picture 2



Picture 3



Picture 4

HOW TO ASSEMBLE THE FAN

- 1: Please find the M8 nut and screw, fix the fan head into the body, please refer to picture 7.
- 2: Please find the parts as picture 8 shows, and assemble them one by one as showed.
- 3: Please use the rotary knob to fix the body and base as picture 9.
- 4: After finish these steps, it will be same like picture 10.
- 5: Please refer to picture 11, assemble part ⑦⑥⑤④③② one by one.
- 6: The completed fan will be same as picture 12.

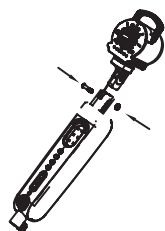

Picture 7

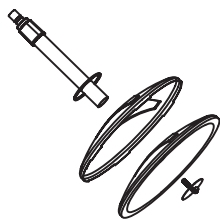

Picture 8

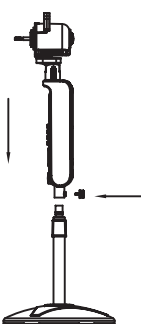

Picture 9

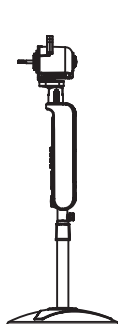

Picture 10

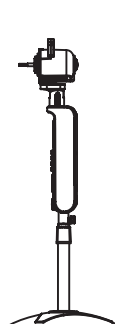
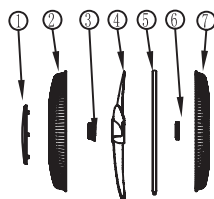

Picture 11

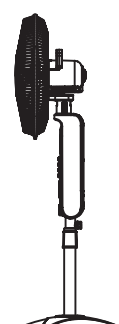

Picture 12

HOW TO CHARGE THE FAN

- 1: Please ensure that the voltage indicated on the appliance corresponds with the mains voltage.
- 2: Plug in the cord to AC socket.
- 3: Red indicator shows that the battery is getting charged.
- 4: It is a normal phenomenon of slight heat while charging the battery.

HOW TO CHANGE THE BATTERY

- 1: Loosen the fixing screw on the battery cover as picture 13.
- 2: Take out the battery.
- 3: Put the new battery inside, and connect "+" to red cord, and "-" to black cord, must follow it.
- 4: Put the cover and tighten the screw.

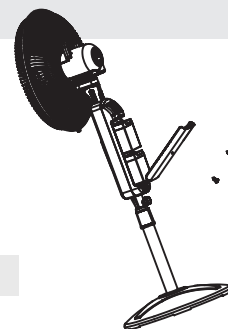

HOW TO USE REMOTE CONTROL

- 1: Put 2pcs AAA battery inside of the remote control before use it.
- 2: Press the control button, and choose difference modes, (Please refer to HOW TO USE)
- 3: Please take the battery out if not in use for long time.

Remote control emitter

Remote control button



Picture 13

Battery cover

SPECIFICATION

Built-in battery: 2x6V 4.5Ah rechargeable lead acid battery

6pcs 0.1W SMD LED light

Power source: 110-220V 50/60Hz

Charge time: 8-12 hours

Working time:

5-speed: 2.5 hours

4-speed: 3.5 hours

3-speed: 7 hours

2-speed: 15 hours

1-speed: 30 hours

LED light: 50 hours

Max power: 40W

Product size: 500x407x1408 mm

WARNING :



1. The product may not be abandoned in the life waste. The battery should be special recycling after abandoning, as it will be harmful to the environment.
2. If the supply cord of the fan is damaged, it shall be exclusively replaced by the manufacturer or his service agent or a similar qualified person in order to avoid a hazard.
3. This appliance is not intended for use by person (including children) with reduced physical, sensory or mental capabilities, or lack of experience and knowledge, unless they have been given supervision or instruction concerning use of the appliance by a person responsible for the safety.
4. Children should be supervised to ensure that they do not play with the appliance.

OFB18M FAN ASSEMBLY

Questions? Call 1-718-567-7754

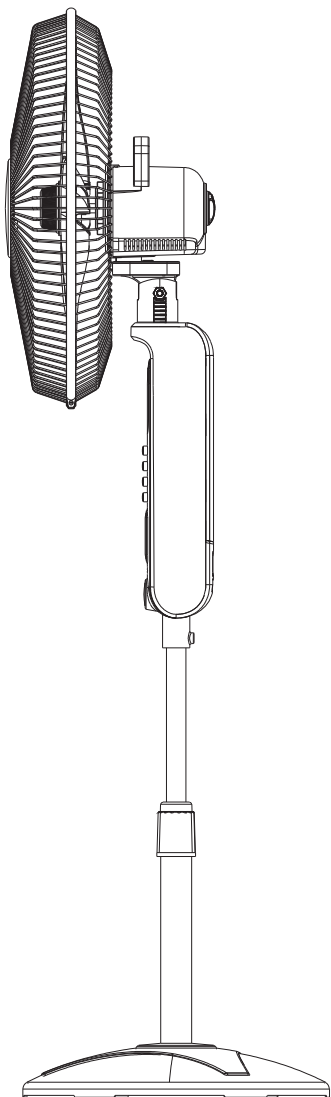

Step1: Find the nut (1) & bolt (2), screw the **Body** and **Head** together.

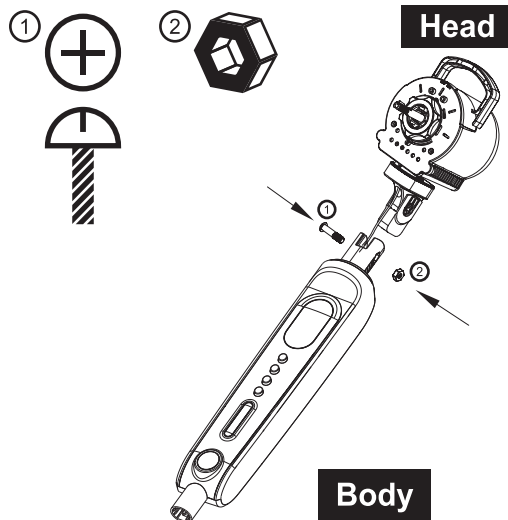

Step2: Locate the base accessories and use the Lever Screw (3) to attach the **Pole** to the **Base**.

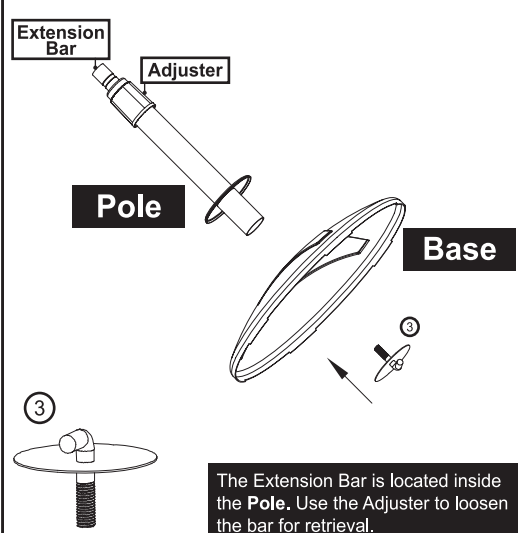

Step3: Attach the Body built in STEP ONE to the Base built in STEP TWO using the Knob Screw (4).

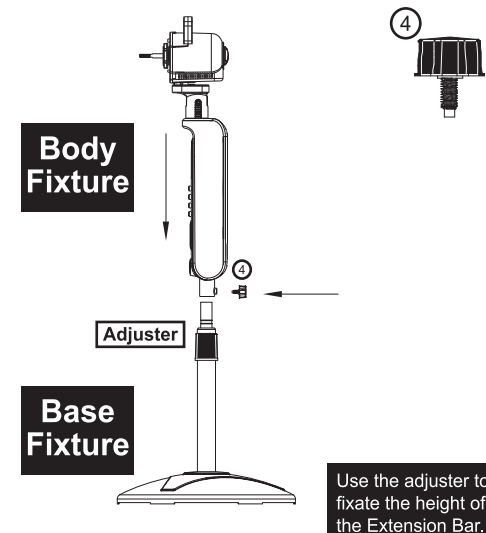

Step4: Assemble the wind cover as shown. Back Cover(5), Washer Ring(6), Fan Blade(7), Fixed Cap(8), Front Cover(9) Emblem Cover(10). Once all have been assembled, use the Clips (11) included on the covers to hold it all in place.

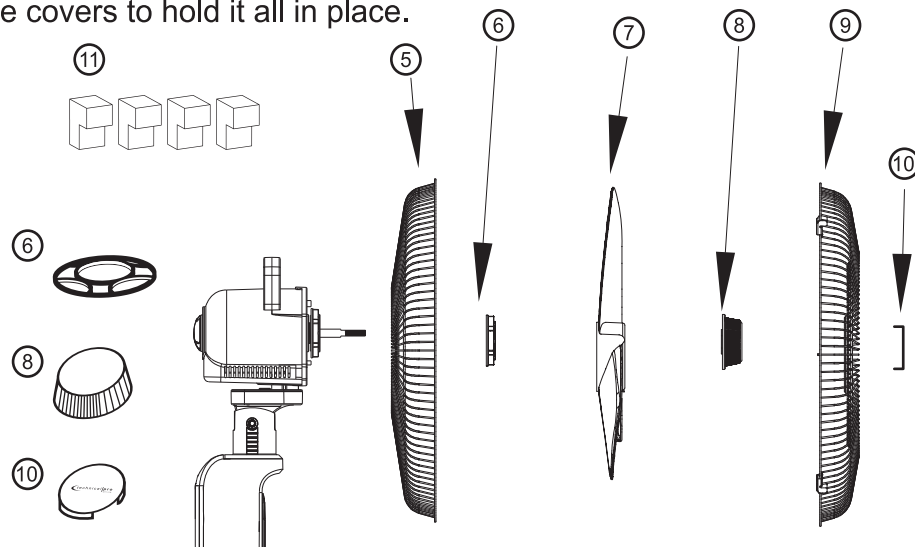

Step5: Unscrew & Open battery cover. Take out battery, from the **Body**, connect red wire to "+" terminal & black wire to "-" terminal, cover back and tighten the screw

