

User Manual

Tuya DIY
Smart WIFI+IR Digital Music Lines Kit

Features

- ✕ DIY intelligent splicing scheme, which can be spliced according to customer needs.
- 🌈 Cool lighting effects, colorful, flowing water, rainbow, Ambilight and other transformation modes.
- 📱 WIFI+BLE+IR protocol with APP+Remoter control.
- ⚡ 12V low-voltage power supply, and uses any single product as the power supply for the overall shape. Classic appearance and compact structure. It can be spliced with different shapes and is easy to install.

Parameters

Model	Colour	Voltage	Power	Control	Parts List
FWW54S-25-4	RGBIC	DC12V	10W	Remote+Control	Adapter 1 x 1 25 pins x 1.27 Controller 1 x 8 Remote Controller x 1
FWW54S-25-8	RGBIC	DC12V	14W	Remote+Control	Adapter 1 x 1 25 pins x 1.27 Controller 1 x 11 Remote Controller x 1
FWW54S-25-12	RGBIC	DC12V	18W	Remote+Control	Adapter 1 x 1 25 pins x 1.27 Controller 1 x 14 Remote Controller x 1

Product Size

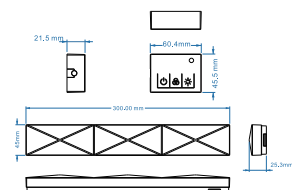

Styling reference

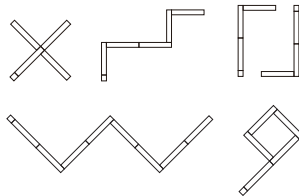

Product function diagram

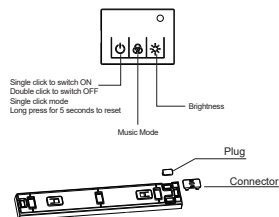

Installation Instructions

- 1: Unpack the package and check whether the appearance is intact, and whether the number of accessories is correct:
Figure ① Remove the protective cover of the controller and the lamp IN-interface, and then install the connector of the controller. The connector is aligned with the OUT of the controller. The bumps are aligned with one end of the single notch of the connector. (Bump to Notch) Figure ② (The yellow slant of the connector clip and the orange slant of the controller are close to each other and then pressed down diagonally).
Note: Press down on the side of the suspension to remove a single connector. When two lamps are connected together, grab one lamp and lift it up to remove it, and then remove the single connector.

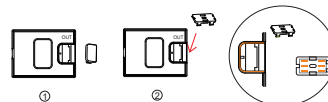

- 2: In the same way, align the IN-port of the lamp to connect, plug in the adapter to light up, and test each one. Figure ③ Take out the double-sided adhesive, tear off one side of the white centrifugal paper, and stick it to the square position on the back of the lamp(controller). Figure ④ And design the shape and place it according to your own preferences. Figure ⑤ Check if there is a problem with the lamp. Pay attention to the running mode of the light, which is related to the position of the controller. It is recommended that the controller be designed in the head position.

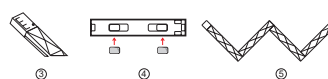

- 3: Take out the first one according to the shape, install connectors on both sides, and deduct the OUT direction to connect position the protective cover, then take out the connector to connect one end of the single notch of the clip is connected to one end of the lamp OUT. (Bump to Notch) (The yellow slope in the diagram of the connector buckle and the orange slope on the controller are close to each other, and then press down diagonally.) Figure ④ Attach the connector at one end of the two notches in the IN direction with same way.

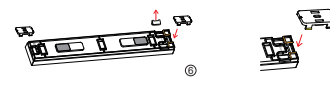

- 4: Determine a position according to the shape, tear off the double-sided adhesive red centrifugal paper on the lamp, align the adhesive surface on the wall to be installed, press hard and install the first piece, and then install the rest according to the shape. Determine whether to use screws for reinforcement according to the user's usage scenario. The reinforcement position is as shown in the figure. At the middle oval hole of the buckle, the whole set needs to be reinforced, and the user decides by himself. Figure ⑦ Note: (one inlet, three outlets) - the OUT port of the lamp must be connected to the IN port of the next lamp.

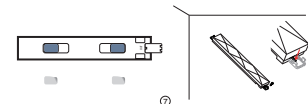

- 5: The second one of the modeling starts, just install the connector on the OUT port, and tear off the red centrifugal paper on the lamp. When installing, the width of the lamp should be aligned with the previous lamp, and the inclined surface of the IN interface of the lamp should be aligned with the inclined surface of the buckle, and then press down firmly. Figure ⑧ Refer to Figure ⑦ to see if screw reinforcement is required, and install the remaining few in the same way. The last part of the shape does not need to buckle the protective cover, and does not need to install the connector.



- 6: Finally, tear off the double-sided tape of the controller, buckle the connector, and install the controller on the connector of the first head. Installation is complete. Figure ⑨ Plug the adapter into the DC socket of the controller and start the experience. Figure ⑩

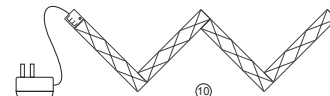

Notes:
Please choose a dry, clean and smooth surface for installation, the following conditions should not be used: Do not use double-sided tape for fixing in humid or low temperature environments (such as bathrooms, toilets, etc.) Do not install this product on the ceiling to prevent it from falling (the double-sided tape is not sticky enough to stick this product firmly on the ceiling) Do not use double-sided tape on brick walls, rough walls, frosted glass, wall coverings with wallpaper, dusty walls, rough plastic surfaces and other uneven walls. Users can decide whether to increase the reinforcement method of screws according to their own usage scenarios, and reinforce several screws in the whole set.

IR Music remote controller manual

Product introduction:
The 19 keys IR remote control could realize various dreamcolor modes include running water and music modes etc.

Parameters:
Power supply: 3V button cell
Control distance: 5-8 meters in open area

Instructions of remote control:
Please remove the PVC insulation sheet from the end of the remote control before using. Please set the APP internet connection as priority when the light is blinking.



Features	Action	Remote control buttons
ON/OFF	Short Press	
Music mode personalized	Short Press	
Speed/variability	Short Press	
Dynamic mode switching	Short Press	
Music mode	Short Press	
Automatic mode	Short Press	
Brightness +/-	Short Press	
Static color switching	Short Press	
W R G B	Short Press	

Download APP

1: Search "Smart Life" from App store or Google play.



2: Scan the QR code from the label or user manual.

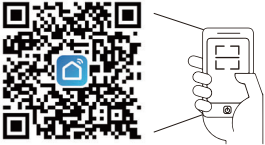

The APP is compatible with Android 5.0 and IOS 10.0 and higher version.

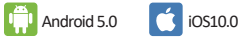

Log in / Register account number

Open the Smart APP, sign up for a new account or log in with an existing account.

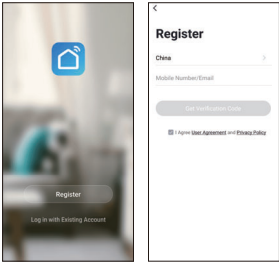

APP connection

- 1. Preparation: Turn on the LED and enter the home of APP while ensure the WIFI signal is good and stable.
- 2. The LED will flashing when turn on the power supply. Add all devices on the APP and enter adding lighting device interface, match LED .

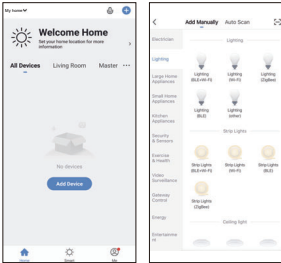

- 3. If the LED is not flashing when turn on the power supply, long press the Reset button for more than 5 seconds. While LED flashing, enter the APP adding lighting device interface,match LED .

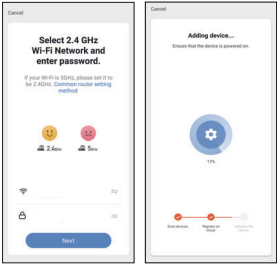

Symphony APP function scheduled scenarios : scenery, life, festivals, mood
Dozens of preset static or dynamic scenes in four scene modes to meet the needs of different situations and occasions

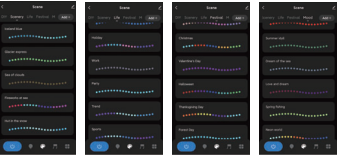

DIY Scene Mode

Customize the scene with a combination of red and color.

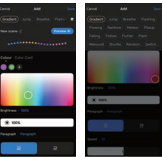

FCC Caution:

This device complies with part 15 of the FCC Rules. Operation is subject to the following two conditions: (1) this device may not cause harmful interference, and (2) this device must accept any interference received, including interference that may cause undesired operation. Any changes or modifications not expressly approved by the party responsible for compliance could void the user's authority to operate the equipment.

NOTE: This equipment has been tested and found to comply with the limits for a Class B digital device, pursuant to Part 15 of the FCC Rules. These limits are designed to provide reasonable protection against harmful interference in a residential installation. This equipment generates, uses and can radiate radio frequency energy and, if not installed and used in accordance with the instructions, may cause harmful interference to radio communications. However, there is no guarantee that interference will not occur in a particular installation.

If this equipment does cause harmful interference to radio or television reception, which can be determined by turning the equipment off and on, the user is encouraged to try to correct the interference by one or more of the following measures:

- Reorient or relocate the receiving antenna.
- Increase the separation between the equipment and receiver.
- Connect the equipment into an outlet on a circuit different from that to which the receiver is connected.
- Consult the dealer or an experienced radio/TV technician for help.

To maintain compliance with FCC's RF Exposure guidelines, This equipment should be installed and operated with minimum distance between 20cm the radiator your body: Use only the supplied antenna.

FCC ID: 2AUPE-FWWSA8-23-18