

# Richmond pendant light

## INSTRUCTIONS

### INCLUDED

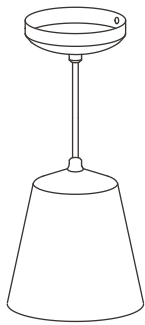

Light body x1

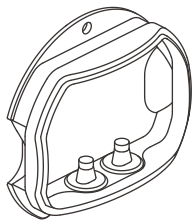

Ceiling mount x1

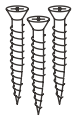

Wall screw x3

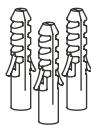

Anchor x3



2-terminal  
WAGO x1

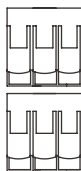

3-terminal  
WAGO x2

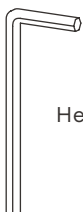

Hex key x1

### TOOLS YOU'LL NEED



Crosshead screwdriver

**Note:** the glass cover protects the bulb in wet environments and is required for the IP rating. If the light is installed in a dry setting, you can remove the glass cover to increase the life expectancy of the bulb.

### Richmond pendant light instructions

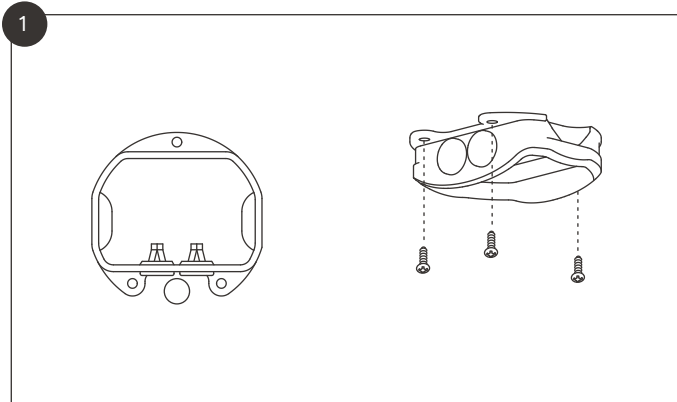

Install the pendant light mount, using wall plugs if needed. See **page 3** for dimensions.

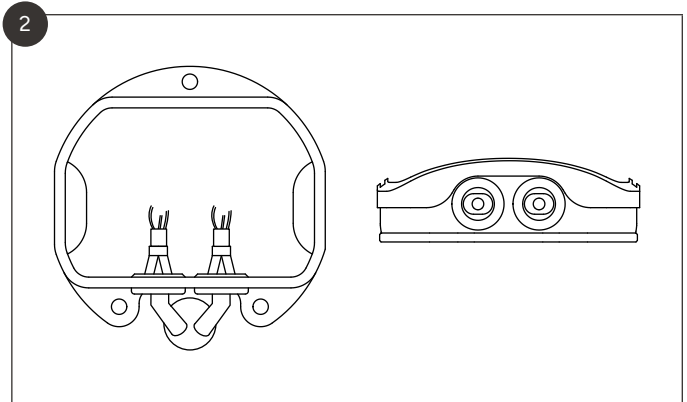

Push the wires through the grommet.

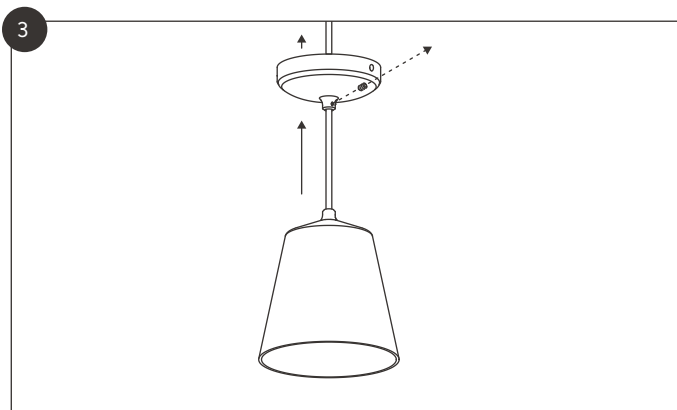

Adjust the cable length using the grub screw.

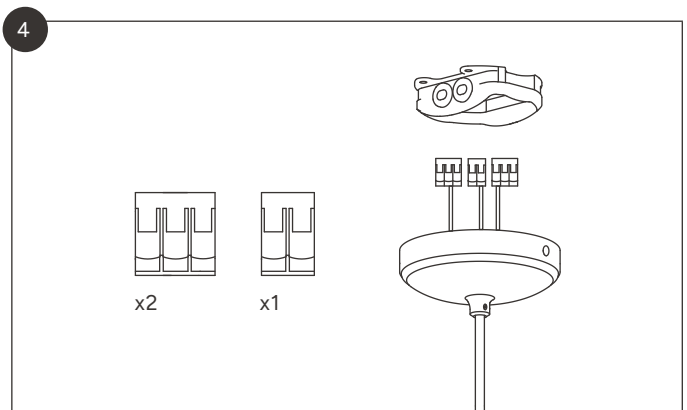

Make the connections in the base using the WAGO connectors provided.

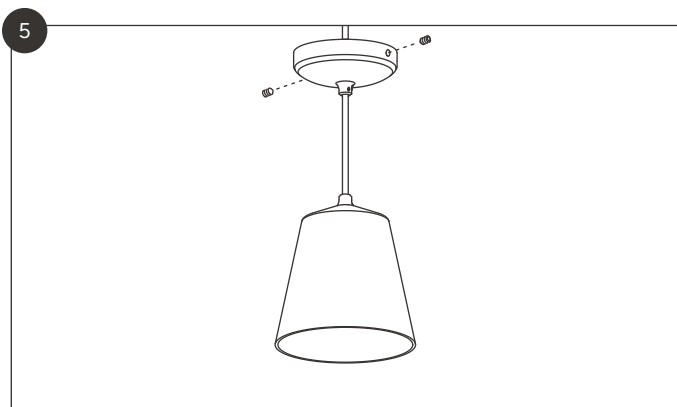

Tighten the grub screws.

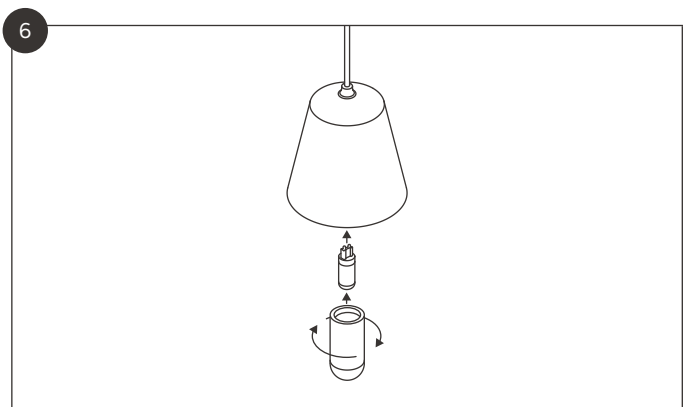

Unscrew the glass cover to fit the bulb.

Richmond pendant light instructions

