

# Dog Bark Control Collar

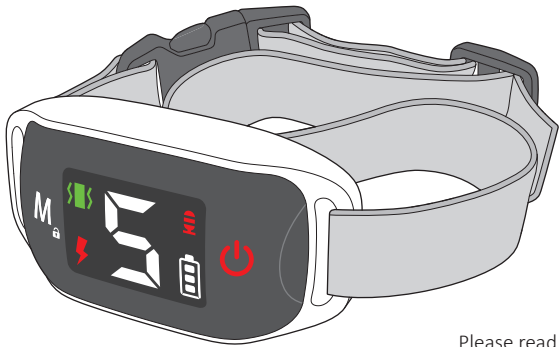

Please read and fully understand this manual before using

## This Packaging Includes

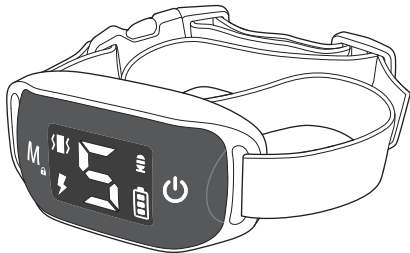

Bark Collar with Strap

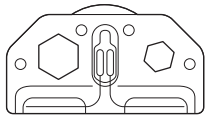

Test Bulb

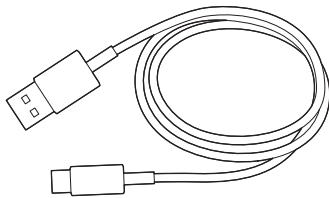

Type-C USB Cable



User Manual

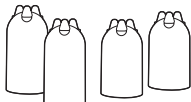

Silicone Probe Covers x 4



Steel Probe x 4

## Product Information

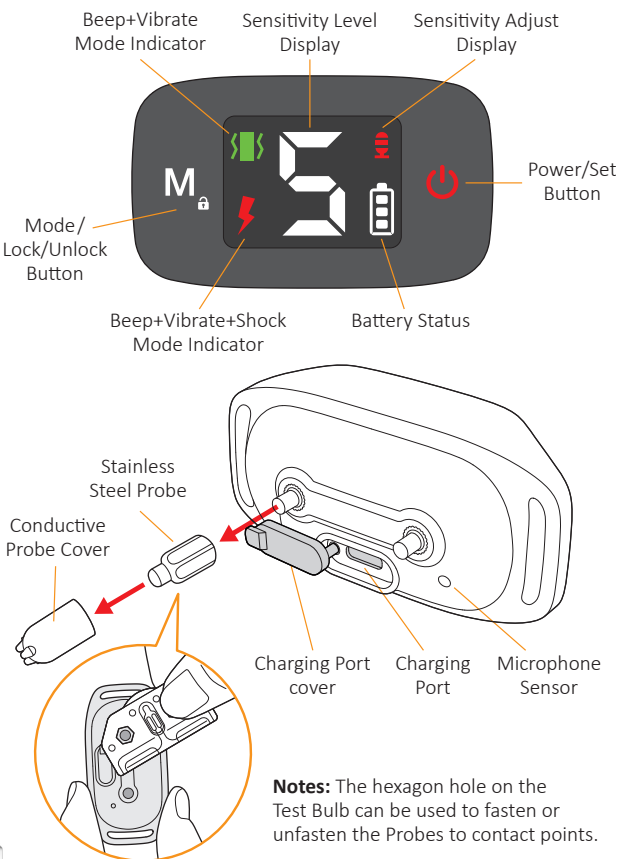

## Important Safety Information

- It is forbidden for children to play with this product.
- It is forbidden to use this product for aggressive dogs.
- This product is NOT intended for using on dogs under 6 months old and less than 8 pounds.
- To better protect your pet's skin, please wear the Conductive Probe Covers before use.
- Avoid leaving the product on dog for more than 12 hours per day. Never connect a leash to the collar.
- Check the shock vibration contact area on the pet's neck every day for rashes and sores. If you find rashes and sores on the wearing part of your pet, please stop using this product until pet's skin heals.
- Wash the dog's neck area, Conductive Probe Covers and Probes weekly with a damp cloth.
- The environment noise, temperament and breed or size of your dogs may affect the bark control effect.

Notes: The Conductive Probe Covers can deliver static shock.

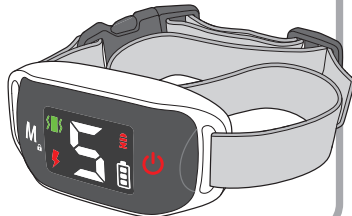





## Setting The Product

### 1) Charge the Bark Control Collar before Using

You can charge the product via PC, Power Bank or Adapter with output voltage of 5V for 2-3 hours.

### 2) Power ON the Bark Control Collar

- Long press and hold the Power button  for 2 seconds until emits a beep sound to Power ON the Device.
- Short press the Mode button "M" to select Vibration mode  or Shock + Vibration mode .
- To Power OFF the Device, press and hold the Power button  for 2 seconds until emits a beep-beep sounds.



### 3) Adjust the Sensitivity

Short press the Power Button  once to adjust the sensitivity level.

When adjusting the sensitivity, the sensitivity adjustment symbol  will be displayed in the upper right corner of the screen.

(Level 1 is the least and Level 5 is the most sensitive)

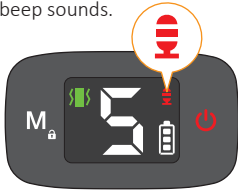

### 4) Lock & Unlock the Bark Control Collar

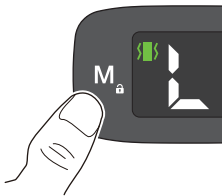

- Long press & Hold the Mode Button "M" for 2 seconds to lock the Bark Control Collar, a "L" will show on the display.
- Long press & Hold the Mode Button "M" for 2 seconds again to unlock the Bark Control Collar, the "L" will disappear on the display

**Note:** Mode settings and Sensitivity levels will remain last setting.



## Test The Product

### 1) Test the Bark Control Collar

1. Long press the Power Button  for 2 seconds to turn ON the device.
2. Short press the Power Button  again to adjust the sensitivity to the highest level (digital shown 5).
3. Short press the Mode Button "M" to select **Shock + Vibration Mode** .
4. After that blow or imitate barking towards the microphone sensor (located at the back of the device) to trigger the **1st Step** of operation.
5. Repeat step 4 to trigger the **2nd Step** of operation.

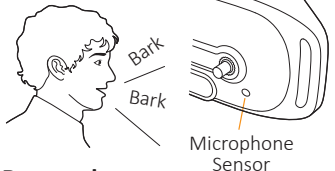

### 2) The Bark Control Collar Responds

When the device triggered the **2nd Step** of operation, it will Beep, Vibrate then deliver Static Shock.

**Notes:** Hold the Test Bulb on the contact points when testing shock function. The indicator will be light on after you simulate dog's bark or blow at the microphone sensor.

If the product responds as described above, you've succeeded at testing the collar properly!

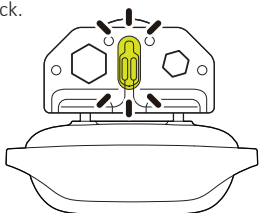

## Put the Product on Your Pet

### Fit the product on your dog

Please ensure to fit the product snugly, yet loose enough to allow one finger to fit between the strap and your pet's neck.

GREAT! Now you have successfully put the Bark Control Collar on your dog and it's ready for training.

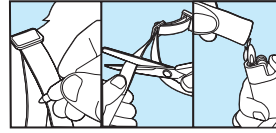
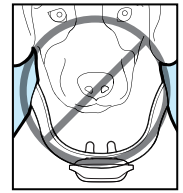
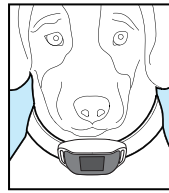
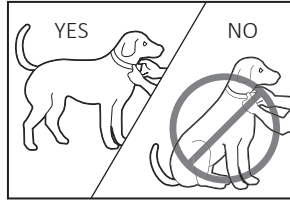
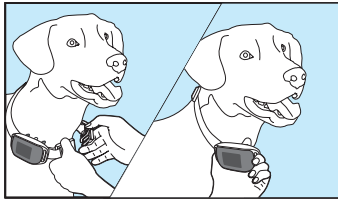

Notes: Mark the desired length, leaving some extra inches (if your dog is still young and will grow more or for thicker winter coat), and cut off the excess. Seal the edge of the cut strap by holding it above the fire for a few seconds.

## How It Works



### Beep + Vibration Mode

The Bark Control Collar will beep then vibrate every time it's triggered.



### Beep + Vibration + Shock Mode

6 Smart operation steps as described on the below. Constant barking within 30 seconds after the previous operation step will trigger the next operation step.

Will go back to Step 1 if the device is not activated within 30 seconds.



## Mode Setting

The following instruction will guide through the process of switching modes.

- Power ON the device by press and hold the Power button for 2 seconds.
- Mode indicator or will display after device is powered ON.
- Short press the Mode Button "M" to select the Mode.

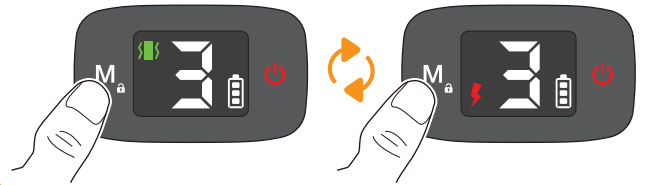

## Indicator & Display

### Mode Indicator



On Beep + Vibration Mode



On Beep + Vibration + Shock Mode



### Battery Status



Solid



Blinks

- **3 bars solid:** Full battery or on charged & fully charged.
- **2 bars solid:** 2/3 battery left.
- **1 bar solid:** 1/3 battery left.
- **Bars blink from bottom to top:** On charged but not fully charged.
- **1 bar blink simultaneously:** Battery is low, stop using it and charge it immediately.

### Display



#### Sensitivity Adjustment

When adjusting the sensitivity, the sensitivity adjustment symbol will be displayed in the upper right corner of the screen.



#### Sensitivity Level 1 - 5

Level 5 is the most sensitive, level 1 is the least.



#### Lock

Long press & Hold the Mode Button "M" for 2 seconds to Lock or Unlock the Bark Control Collar.



#### Protection Mode

On Protection Mode. Protection mode lasts 2 minutes, during which it cannot be triggered in order to prevent over shock to your pet. Protection Mode will be cancelled after 2 minutes automatically or after you press the Power Button.

## Frequently Asked Questions & Answers

### Q: Why the product doesn't work when the dog barks?

**A:** Please first ensure to fit the product snugly, yet loose enough to allow one finger to fit between the strap and your pet's neck. Some dogs has weak barking, in this case you will need to level up the sensitivity level. Thick coat on the neck area may also have small chance to decrease the sensing from the barking, trim the coat near the area where you place the product.

### Q: Why the product is triggered sometimes automatically in a noisy environment though the dog isn't barking?

**A:** Though we have optimized the barking detection to the best, some environment noises may have similar frequency to your dog's barks, which may have small chance to activate the product. Please lower the sensitivity level.

### Q: Can I use the product when there are other dogs playing around?

**A:** Dogs will bark when playing and get excited, for the comfort and safety of your pet, we don't suggest using this product in such environment.

### Q: Can this product stop my dog's howl?

**A:** No, this Bark Control Collar is designed to detect the barking and training for stopping barking. It cannot detect or stop the howling.

### Q: How do I know if I can use this product for my pet?

**A:** The product is designed for healthy dogs over 6 months old, weighing no less than 8 pounds. Most importantly, this product cannot be used on unhealthy or aggressive dogs, and if you are unsure whether this product is appropriate for your pet, please consult your veterinarian or a certified trainer.

### Q: Can I charge this product with any type of charger?

**A:** No, you are suggested to charge this product with charger of 5V output voltage, because charger with output voltage of 9V or 12V may cause damage to the product. The product will stop charging automatically if input voltage becomes too high and deliver warning tone.

### Q: Will my dog stop barking completely?

**A:** The Bark Control Collar effectively and humanely stops all barking when it is worn. It should only be worn during periods of unwanted barking.

### Q: Is the Bark Control Collar safe and humane?

**A:** Yes. The Bark Control Collar is designed to get your dog's attention, not to punish him. However, the initial static shock correction may startle your dog.