

Kaadas

Access to your Future !

User Manual

www.kaadasgroup.com

Shenzhen Kaadas Intelligent Technology Co.,Ltd,
reserve all rights for the final interpretation to this user manual

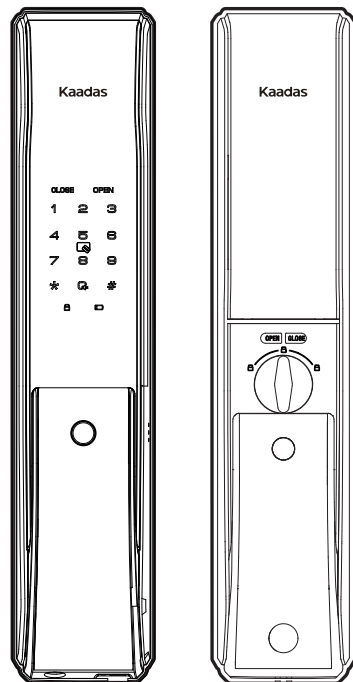

Friendly Reminders:

Dear customers, thank you for using our smart lock. Please check the package content and read the installation instruction carefully before you install this lock, and then install the product according to the instruction. Our company will not assume any responsibility for direct or indirect product problems, other hazards and losses if you don't follow the instruction to install. Thanks.

Contents

1. Important information

- Safety instruction
- Warning
- Disposal of used battery and lock

2. Install your smart lock

- Package content
- Explosive view
- Before installation
- Change the direction of Latchbolt
- Installation steps

3. Overview

- Front panel
- Back panel

4. Set your smart lock

- Before you set up
- Enter Master mode
- Add general user
- Add temporary user
- Modify the master PIN code
- Delete user

5. Use your smart lock

- Unlock from outdoor
- Unlock by mechanical key
- Unlock/lock from indoor
- Emergency Knob
- Defence Mode (Enable/Disenable)
- Volume Adjustment

6. Other functions

- Restore to default setting
- System reboot
- Emergency power supply
- Replace battery

1. Important information

• Safety instruction

Read and understand all instructions before using this smart lock.

Damages caused by failure to follow instructions is not covered by the warranty.

It is recommended to use the enclosures/accessories specified by the company.

Use only alkaline batteries configured with this product.

Do not forcibly disassemble this product in order to avoid alarm sound or damage to the product.

Do not scratch the fingerprint reader with sharp objects, otherwise it may cause permanent Long-term damage.

Do not expose the product to corrosive substances, so as not to damage the outer protective layer.

Do not hang objects on the handle, so as not to affect the normal use of the door lock.

Cleaning the product, please wipe it with a soft cloth.

Do not disassemble the battery while the device is operating.

Please choose a professional engineer to install the door lock and follow the company's standard installation instruction, and do not install it by yourself .

After the door lock is installed, please modify the default master PIN code immediately and keep the mechanical key in a safe place.

Don't disclosure PIN code to the unknown person.

When low battery alarm is triggered, please replace all the batteries in time.

• Warning

Do not place battery closing to fire in case of explosion .

Do not use emergency power sources that do not comply with safety regulations to power this product.

Do not short-circuit the two poles of the battery lead with metal objects to avoid explosion.

Making sure replacement or maintenance are done by professional person authorized by Kaadas .

Your warranty may invalidate if you used accessories produced by other manufacturer or not recommended by Kaadas.

• Disposal of used battery and lock

Please understand the local electronic product classification and collection system.

Please follow the local regulations and do not discard used batteries into ordinary household garbage.

Properly disposing of used products helps to avoid potential negative impacts on the environment and human health.

The battery can not be disposed of with ordinary household garbage.

2. Installation

- Package contents

This package list is for reference only, All package contents are subject to the actual packing contents.



Front Panel
(with rubber gasket)



Back Panel
(with rubber gasket)

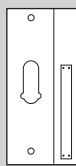

Installation Template



Mortise



Strike Plate
Assembly



Mechanical Key

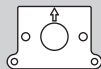

Mounting plate

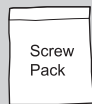

Screw Pack

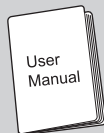

User Manual

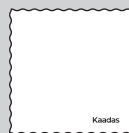

Scouring pad



User Card

• Explosive view

Understanding the installation of a three-dimensional assembly drawing is beneficial to understand lock structure.

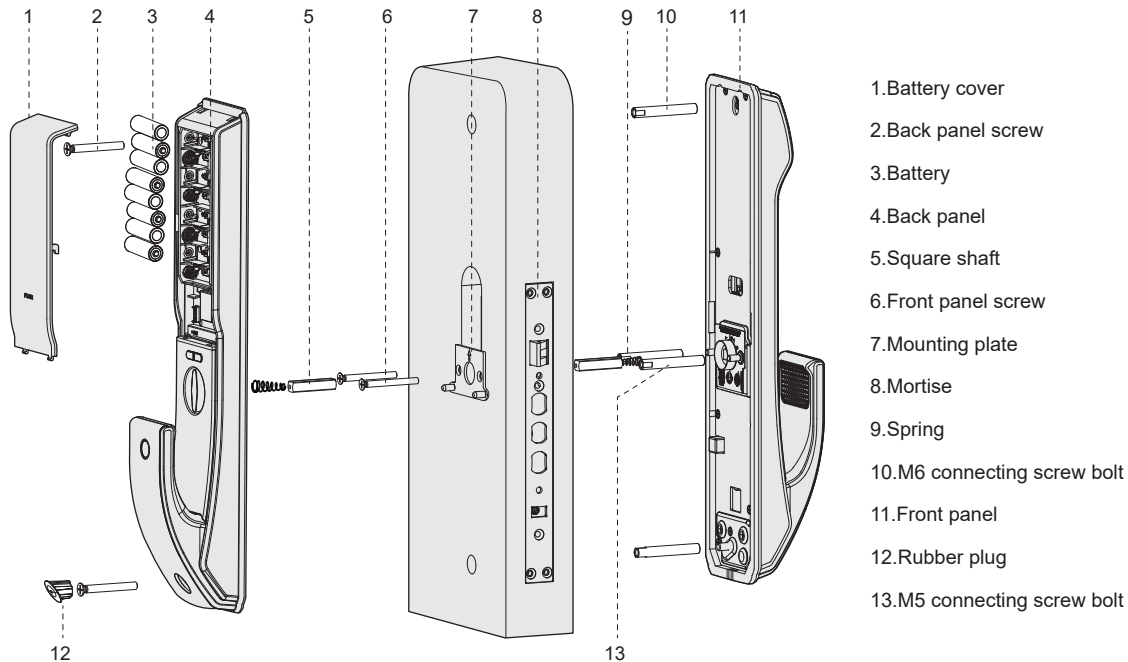

- Before installation

Check door open direction before installation

Right-out open

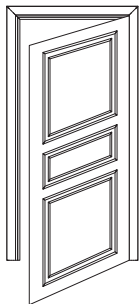

Right-in open

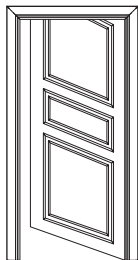

Left-out open

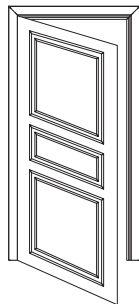

Left-in open

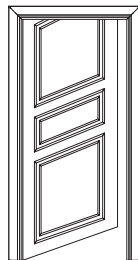

- Change the direction of Latchbolt

1. Loosen the screw counterclockwise with an Allen wrench, then take out face plate.

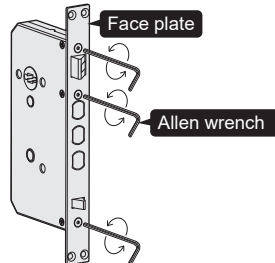

2. Take out latchbolt and rotate 180°, then take back latchbolt.

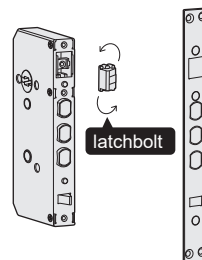

3. Install back faceplate and tighten screws, then work done.

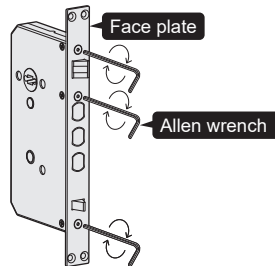

- Installation steps

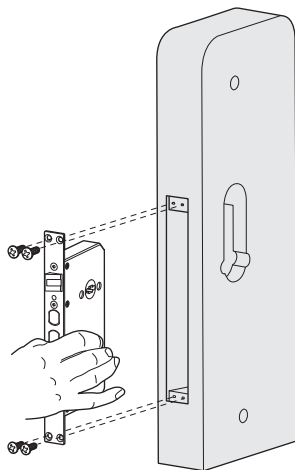

1. Drill bores following the installation template and then put the mortise into the door and tighten the four mounting screws.

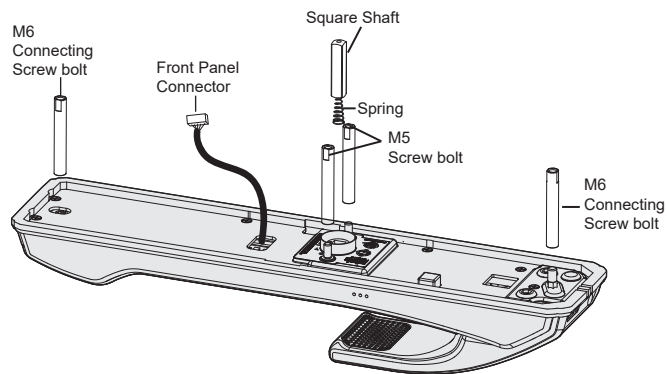

Note: According to the thickness of the door, choose the appropriate length of the square shaft and solenoid.

Install the connecting screw bolt on the front panel, and put the pressure spring and square shaft in the hole.

- Install your smart lock

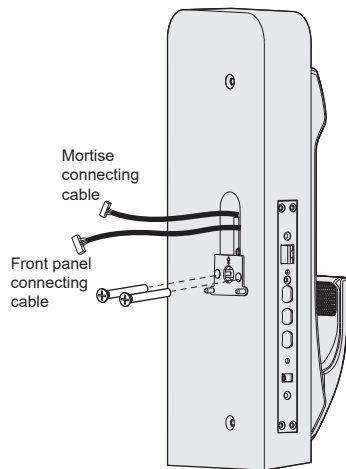

Pass the connectors through the bore on the door, and then insert the square shaft into the mortise follower of the front panel. Finally, mounting the front panel by mounting plate.

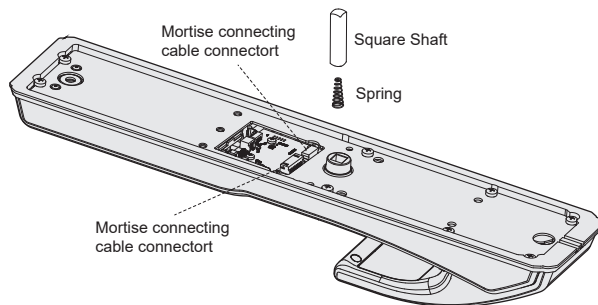

Note: According to the thickness of the door, choose the appropriate length of the square shaft and compression spring.

Install compression spring and square shaft on the back panel, front panel connection cable and mortise connection cable. Insert the corresponding connector on the back panel.

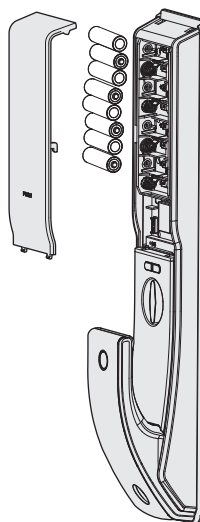
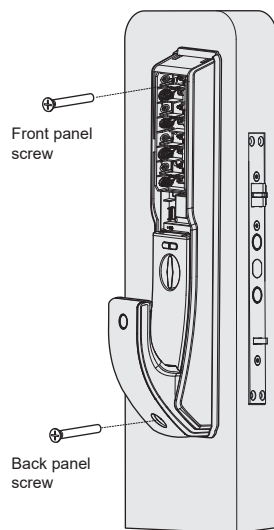

Install the back panel and alkaline battery, then install the battery cover.

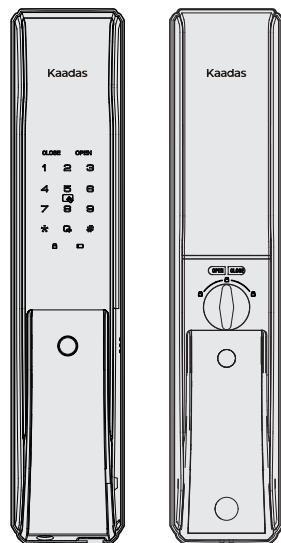

Check whether each part is installed well.

3. Overview

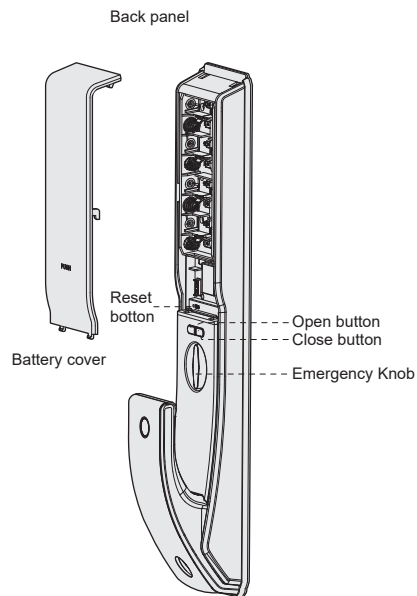
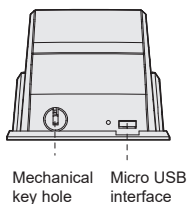
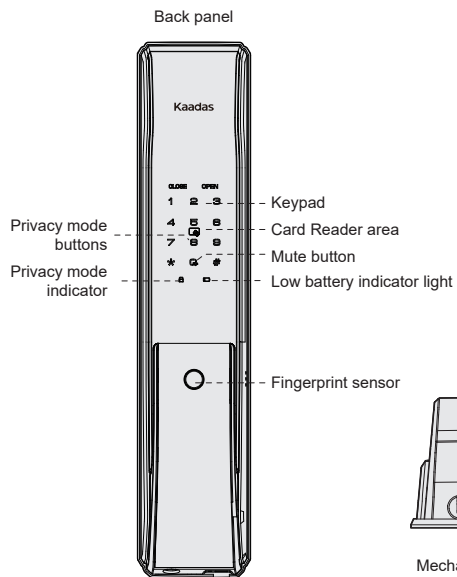

4. Set your smart lock

The system of this lock can be set to enable or disable dual-verification. When dual-verification is turned on, two kinds of keys (fingerprint + password, password + card, fingerprint + card) are required to pass the verification at the same time to unlock .close the dual-verification.

only need to verify one kind of secret key to unlock.

Security mode: need dual-verification (fingerprint + password, password + card, fingerprint + card).

Common mode: single verification (password, fingerprint, card can be verified).

	Security mode	Common mode
Master pin code	Yes The master code before entering master mode	Yes Initial Password 12345678
User pin code	One-time password prohibited	One-time password can be used
User fingerprint	Yes	Yes
User card	Yes	Yes
Method of entering master mode	Enter the master pin code to access	Enter the master pin code fingerprint to access

- Access into master mode

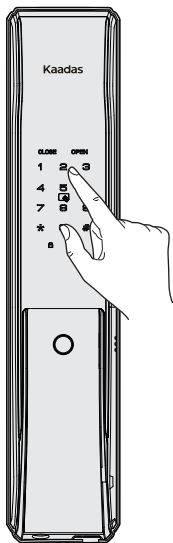

- 1.Touch the keypad area to wake up the keypad.
- 2.Press * twice and enter the master PIN code with # key to confirm.
- 3.Voice prompt: master mode.

Note:

If the Master Pin Code is the initial password, You need to modify the Master Pin Code before you can execute other operations.

- User setting

Enroll user

When enroll user, the lock automatically recognizes and adds a password, fingerprint, card, the user directly add the corresponding key.

In Master mode

1 1

Press 1 to go to user Settings, press 1 again to go to Add user fingerprint, and Enroll new fingerprint, Until a voice prompt: "Enrollment succeeded."

1 1

Press 1 to enter user Settings, press 1 again to enter add User card, and enter new User card, voice prompt: "Enrollment succeeded."

1 1

Press 1 to enter user Settings, press 1 to enter Add password, and enter password again and press # to confirm. Voice prompt: Enrollment succeeded.

- Add a temporary User(OTP)

In Master mode

1 2

Press 1 to enter user Settings, press 2 to enter Add temporary password, and enter temporary password again and press # to confirm. Voice prompt: Enrollment succeeded.

• Modify the Master Pin Code

In master mode

1 4

Press 1 to enter User Settings, then press 4 to enter modify Master Pin Code, enter the new Master Pin Code, press # to confirm, enter Master Pin Code, press # to confirm, Voice prompt: Set up succeeded.

• Delete user

In Master mode

1 5 1

Press 1 to enter User Settings, then press 5 to enter delete user, then press 1 to delete single user password, user fingerprint (optional), user card, and enter user password \ User fingerprint (optional) \ user card, voice prompt: deletion succeeded.

1 5 2

Press 1 to enter User Settings, then press 5 to delete a user, and then press 2 to delete all user passwords. The voice prompt: deletion succeeded, pin code database is empty. .

1 5 3

Press 1 to enter User Settings, press 5 to delete users, and press 3 to delete all user fingerprints. The voice prompt: deletion succeeded, fingerprint database is empty.

1 5 4

Press 1 to enter User Settings, then press 5 to enter user deletion, and then press 4 to delete all user cards. The voice prompt: Deletion succeeded and the card library is empty.

• Opening mode settings

In Master mode

1 6

Press (1) for user setting, Then press(6) for opening mode.

1. Press (1) for normal mode(single verification) which opening by PIN code or fingerprint or card.

2. press (2) for security mode(double verification) which means opening by PIN code+fingerprint or PIN code+card or fingerprint +card.

⚠ Notice: In security mode, to delete all users is prohibited.

• Enable/disable automatic mode

In Master mode

1 7

Press 1 to enter user Settings, then press 7 to turn on/off automatic mode; voice Prompt: set up succeeded,auto-mode/manual mode.

• Language Settings

In Master mode

2 1 or 2 or 3 or 4 or 5

Press 2 to enter the language Settings.

Press 1 to select Chinese;

Press 2 to select English;

Press 3 to select Russian;

Press 4 to select Spanish;

Press 5 to select Portuguese.

• Extended function

In Master mode

4 1 or 2

Press 4 to enter extended function Settings.

Press 1 to join the network.

Press 2 to log off the network.

- Unlock from outdoor(Common mode)

1. Use your smart door lock

Password to open the door

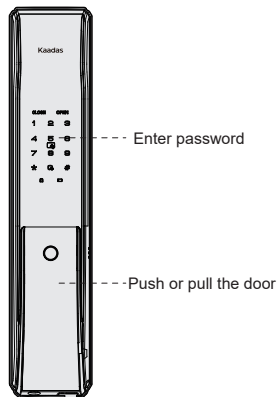

Outdoor | front panel

Touch the pad screen by palm to lighten keypad; then entering the enrolled PIN code with end of [#]. After voice prompt "verification succeeded", push or pull handle to open the door.

Card to open the door

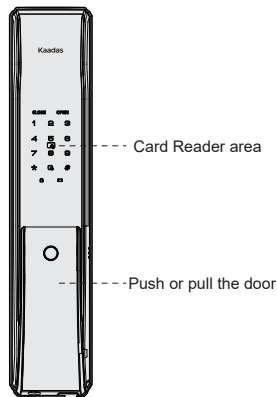

Outdoor | front panel

In common mode, Place the enrolled card properly on the card icon area. After voice prompt "verification succeeded", push or pull the handle to open the door.

Fingerprint to open the door

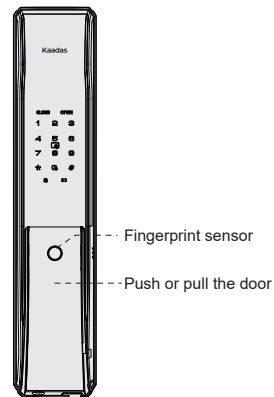

Outdoor | front panel

In the common mode, directly put the finger that has been enrolled on the fingerprint sensor. Voice prompt: verification succeeded, please push or pull the handle to open the door.

Under common mode, Enter incorrect Pin Code or card five times in a short period of time the lock will have a lockdown for 100S.

Under security mode, Enter incorrect passwords card or Pin code five times in a short period of time the lock will have a lockdown for 100S.

- Unlock by mechanical key

You can unlock by mechanical key if you forget pin code , the battery run out or system error occurs.
Insert the mechanical key and then rotate 180°to unlock. Push or pull to unlock.

If your door is right opening direction, please turn the key clockwise.



If your door is left opening direction, please turn the key counterclockwise.

Mechanical key hole

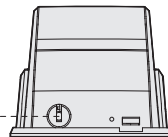

- Lock/unlock from in door

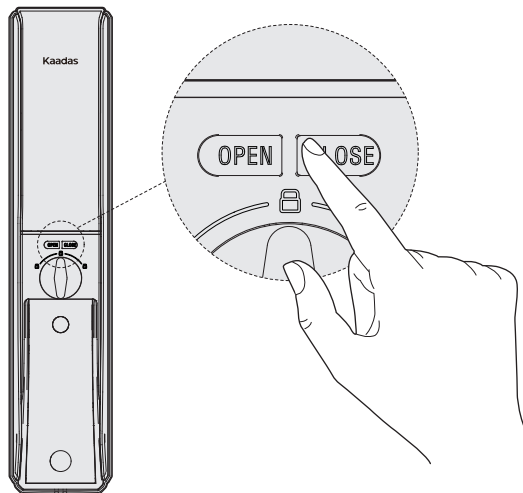

1. Locking button (close)

press the close button to lock, long press the close button 3 seconds to enable privacy mode.

In privacy mode , lock can be opened only by master pin code or unlock inside.

- 2.Unlocking button(open)double press the open button to unlock

- 3.Enable/ disable the sensor of inside handle, long press open and close button together 10s to enable/disable the sensor of inside handle.

• Emergency Knob

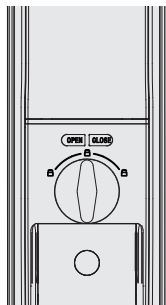

When system error occurs, you can rotate the knob to unlock Indoor

• Unlock by inside sensor handle

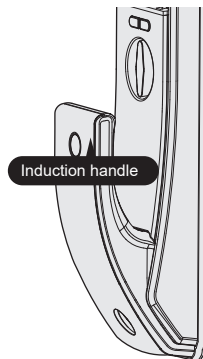

• Defense mode Enable/Disenable

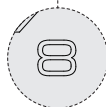

Defense mode button

1.Enable: After closing door, press the defense mode button to enable defense mode. voice prompt: defense mode enabled.

In defense mode, if someone unlocks from inside , the alarm will be triggered

2.Disable: Defense mode will be disabled once it is unlock from outside.

Inside sensor handle enabled , holding the inside handel and cover the sensor to unlock.
Inside sensor handle disabled, please press open button to unlock or enable sensor again.

- Volume adjustment

In the system setting, the volume is set to voice mode. When the door lock is wakened outdoors, long press the  key to enter the mute mode.

In the system setting, the volume is set to mute mode. When the door is wakened outdoor and no number is entered, press the  key to temporarily switch to voice mode. If the screen is turned off and wakened again, the normal volume will be restored.

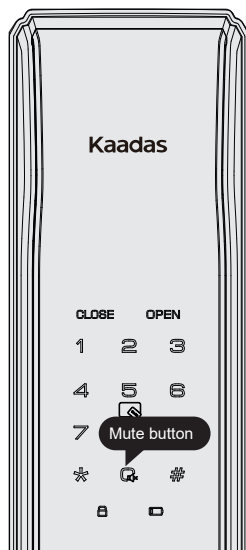

6. Other functions

- Restore to factory settings

If you forgot the master pin code, you can take out the battery cover then double press the Reset button till Voice prompts restored to factory setting , please modify the master pin code immediately. It means reset succeeded.

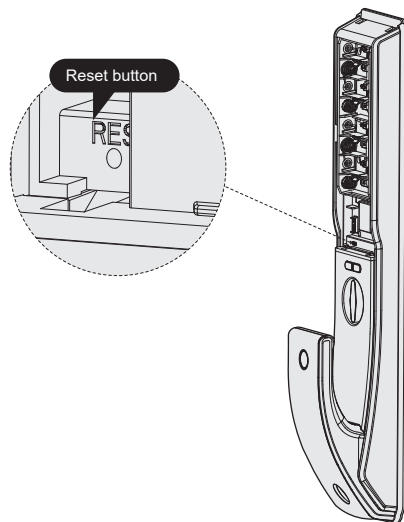

- System reboot

If you need to restart the system, you can use the charging bank as an emergency power supply and power on the door lock through the Micro USB interface to restart the system.

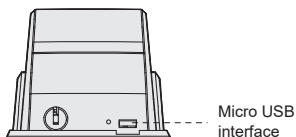

Outdoor | Front panel

- Emergency power supply

When the battery voltage is low and cannot be turned on externally, you can use the 5V charger as an emergency power supply to power on the door lock through the Micro USB interface. After opening the door lock, replace the battery immediately.



outdoor | front panel

Note: When the battery power is too low, every time, after the lock is successfully unlocked, the system will give a voice prompt: the power is low. please replace the battery; at this time, please replace the battery in time.

- Replace battery

When the system voice prompts: "The battery is low, please replace the battery", the battery needs to be replaced in time.

