





**NOTE:** DO NOT use any glassware except the provided Ninja glass carafe, which is safe to use due to its specialized glass material.

**NOTE:** Over Ice brew is designed to produce a concentrated brew into a vessel filled with ice. It is normal for some ice in the vessel to melt as the coffee is brewed, and this will produce a cold beverage with the ideal strength and flavor.

SPECIALTY BREW

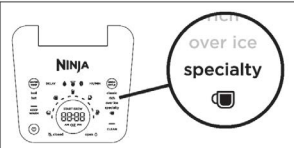

1 Press the BREW STYLE button to choose Specialty. Place the empty vessel you would like to brew into under the brew basket.

**NOTE:** If brewing an ice blended drink, fill the desired vessel with the amount of ice recommended in the recipe before brewing.

2 Press the START BREW button on the dial to start the brew. To cancel the brew at any time, press the START BREW button on the dial again or press the Power button.

3 The brewer will beep to signal the brew has started. The progress bar around the dial will illuminate to indicate the status of the brew. When the brew is finished, the machine will beep again and End will appear on the display.

**NOTE:** Specialty brew always yields approximately 4 oz. of coffee.

INTELLIGENT WARMING PLATE

The Intelligent Warming Plate will automatically turn on during Classic or Rich brews when a 1/4, 1/2, 3/4, or full carafe size is selected. The Intelligent Warming Plate is set to a specific temperature setpoint to avoid burning the coffee over time. To turn the warming plate on at any time, turn the dial to one of the carafe sizes, select Classic or Rich, and press the KEEP WARM button.



**IMPORTANT:** The light on the base of the brewer will illuminate only when the warming plate is hot and will remain illuminated until the plate has cooled down.

TIME ADJUSTMENT

You can adjust how long the Intelligent Warming Plate remains on (up to 4 hours).

By default, the Intelligent Warming Plate is set to remain on for 2 hours. To change the time setting of your warming plate, follow these instructions:

1 Press and hold KEEP WARM until the clock begins to flash the current warming time.

2 Turn the dial to increase the time in 15 minute increments up to 4 hours or decrease the time to 0 hours. Press START BREW on the dial to set the new time.

**NOTE:** If you set the warming time to 0 hours, Keep Warm will not automatically activate during or after a carafe brew cycle, but you can still turn it on manually by pressing the KEEP WARM button.

**NOTE:** The time adjustment setting will be saved and will not reset when the brewer is unplugged or loses power.

**NOTE:** Thermal carafe (CFP305) does not include a warming plate because of the thermal carafe's vacuum insulation.

SETTING THE DELAY BREW



1 Plug the brewer in and turn it on by pressing the Power button.

**NOTE:** The clock will remain on even if the brewer is turned off. Ensure the brewer is powered on to set Delay Brew.

2 After filling the water reservoir and adding ground coffee to the filter or inserting a pod in the Ninja Pod Adapter, close the sliding lid or adapter handle, and place the appropriate-size vessel under the brew basket.

3 Press DELAY. DELAY will illuminate and the clock will begin to flash "12:00" or the last time that was set.

4 While the clock is flashing, turn the Multi-Serve dial to adjust the hour. The AM or PM indicator will illuminate under the clock display as you are setting the desired time. Press START BREW on the dial and turn the Multi-Serve dial to adjust the minute. Press START BREW on the dial to lock in your time.

5 Once the desired time has been set, select the size of the vessel that you would like to brew using the Multi-Serve dial.

6 Press the BREW STLYE button to choose your brew style. If in hot water mode, press WATER TEMP to choose your water temperature.

7 Once the time, brew size, and brew style have been set, press the START BREW button to activate. When activated, the brewer will beep and DELAY and your selected options will remain illuminated. To cancel, press DELAY again.

**NOTE:** The brewer must remain on for the Delay Brew function to work. DO NOT power off or unplug after setting Delay Brew. If the brewer is turned off or unplugged, delay brew will need to be reset.

USING THE DRIP STOP

The drip stop is used to close off the brew basket to prevent any coffee from dispensing. You will need to manually open and close the drip stop by moving the lever to your desired position. It can be closed and reopened at any point before, during, or after a brew.

If you forget to open the Drip Stop, the brewer will pause the brew, and after 30 seconds it will give you a friendly audible reminder. After 5 minutes, the brew will be canceled.

**NOTE:** If the Drip Stop is closed before you begin a brew, the brewer will notify you with 3 beeps and the Drip Stop indicator will illuminate. Move the Drip Stop to the open position and press the START BREW button to begin your brew.

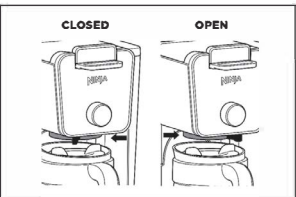

CLOSING THE DRIP STOP AFTER A BREW

When the brew cycle is complete, set the Drip Stop to the closed position to stop dripping from the brew basket and Ninja Pod Adapter. While the Drip Stop is closed, the Drip Stop indicator will illuminate.

**NOTE:** Remember to open the Drip Stop when you are ready to brew again. If you forget, your brewer will give you a friendly audible reminder.

DISPENSING HOT WATER

The Ninja DualBrew Pro System has a separate water line completely independent of the line used for brewing coffee. This ensures you get clean water every time with no coffee cross-contamination.

1 To switch to Hot Water Mode, turn the dial on the left side of the brewer to the water droplet icon. You should notice a change on the control panel.

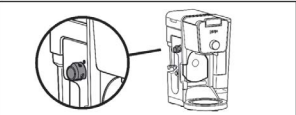

**NOTE:** If the display is flashing the water droplet icon, make sure the dial is turned completely to one side.

2 Use the Multi-Serve Dial to choose one of 17 sizes between 2 oz. and 60 oz.

3 Press Water Temp to adjust the temperature of the water from BOIL to HOT.

4 Press START BREW on the dial to start the brew.



**NOTE:** When dispensing hot water, use a vessel that is suitable for high temperatures.

WATER TEMP	EXAMPLES OF USES
Boil	Instant Oatmeal, Instant Mac & Cheese, Instant Soup, Tea
Hot	Hot Cocoa, Hot Water and Lemon

**NOTE:** The water will cool down once dispensed into vessel.

Volume		
2 oz.	14 oz.	28 oz.
4 oz.	16 oz.	32 oz.
6 oz.	18 oz.	40 oz.
8 oz.	20 oz.	50 oz.
10 oz.	22 oz.	60 oz.
12 oz.	24 oz.	

Not all functions are available on all models.

INTEGRATED FROTHER

The Integrated Frother does not heat milk.

1 Add milk to your cup until it is about 1/3 full.

- For cold froth, go to Step 2.
- For hot froth, microwave for 45-60 seconds.

**NOTE:** Frother does not heat liquid.



2 Swing the arm of the frother toward the front of the brewer. Install the frother whisk by twisting it to the right.

3 Hold the cup under the frother and submerge the whisk just below the surface of the milk. Press and hold the button on top of the frother and froth for 30-45 seconds.



4 Remove the frother whisk by twisting it to the left. Keep your cup below the whisk while you carry it to your sink or dishwasher for easy cleaning.

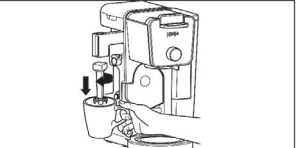

**WARNING:** To avoid contact with steam and hot surfaces. DO NOT reach across top of brewer to froth.

CLEANING & MAINTENANCE

CLEANING AFTER A BREW

1 After the brewer has cooled, remove the brew basket. If using pods, remove the Ninja Pod Adapter and brew basket. Wash the used parts thoroughly with soap and warm water.

2 Clean the frother whisk after each use. Hand-wash thoroughly or place on top rack of dishwasher.

3 Wash the carafe and brew-through lid with soap and warm water. Use a bottle brush or cloth to wash the inside of the carafe. DO NOT use a wire brush.

**NOTE:** For best results, we recommend rinsing the reservoir after brewing and refilling with fresh water for the next brew.

**NOTE:** The glass carafe, brew-through lid, permanent filter, brew basket, water reservoir, water reservoir lid, frother whisk, and Ninja Smart Scoop™ are all dishwasher safe.

CLEANING THE WATER RESERVOIR

Empty the reservoir and hand-wash or place in dishwasher. For a better clean, we recommend placing it in the bottom rack of the dishwasher standing upright with the opening facing downward. We recommend doing this weekly.

CLEANING THE CARAFE

We recommend cleaning your carafe after each use with warm, soapy water.

To clean the carafe more thoroughly, we recommend using a soft foam brush. DO NOT use a wire brush.

CLEANING THE SLIDING LID

Open the hinged hood on top of the brewer by pulling up on the left side. Once opened, slide the sliding lid out of the back of the brewer to remove it. Hand-wash the sliding lid with warm, soapy water. Slide the sliding lid back into its tracks and close the hinged hood.

**NOTE:** DO NOT place the sliding lid in the dishwasher.

CLEANING THE NINJA POD ADAPTER

Open the handle to reveal the needles and pod holder and hand-wash with warm, soapy water. Take care when cleaning around the needles. Then, close the handle and slide it back into the REMOVE position before reinstalling.

**NOTE:** DO NOT place the Ninja Pod Adapter in the dishwasher.

CLEANING & DESCALING YOUR BREWING SYSTEM



Your Ninja DualBrew coffee maker offers multiple modes to choose from, which include Grounds, Pods, and Hot Water (not available on all models). Each mode that you use will eventually need to be cleaned with a clean cycle.

The clean cycle is used for descaling the brewer when calcium scale buildup is affecting the performance of the brewer and/or the flavor of your coffee. The Intelligent Clean Cycle Indicator will automatically illuminate orange when a cleaning cycle is recommended for your brewer. If the indicator is ignored, your brewer may stop mid-brew and display "CLn," indicating it needs immediate cleaning on the current mode.

**NOTE:** The clean cycle takes approximately 75 minutes.

CHOOSING WHICH MODE TO CLEAN

When the Intelligent Clean Cycle Indicator turns on for the first time, run a clean cycle on the mode you use most. For example, if you primarily brew with grounds, run the clean cycle on the Grounds mode with the Sliding Lid closed. If you primarily use pods, ensure the Ninja® Pod Adapter is installed, and run the clean cycle through the Ninja Pod Adapter. If Hot Water mode is used at all, run an additional clean cycle in Hot Water mode.

The next time the Intelligent Clean Cycle Indicator illuminates orange, run a clean cycle on the remaining way to brew coffee. For example, if you ran a clean cycle on the Grounds mode first, run a clean cycle on the Pods mode next.

**NOTE:** If the display ever reads "CLn," it indicates heavy scale buildup on that mode. Run a clean cycle on the current mode.

To clean and descale your Ninja DualBrew Pro Coffee System:

1 Place the empty carafe beneath the brew basket.

2 Use a descaling solution specifically formulated for coffeemaker cleaning and follow the directions on the package. Fill the water reservoir up to, but not exceeding, the Full line.

OR

Fill the water reservoir to the Travel Mug line (16 oz.) with white vinegar, then fill the rest of the reservoir with water up to, but not exceeding, the Full line.

**IMPORTANT:** Only use white vinegar.

**NOTE:** Running a water-only clean cycle will not descale the brewer properly.

3 Once the water reservoir is filled with your cleaning solution and water mixture, press the CLEAN button then press the START BREW button to confirm and begin the cleaning cycle.

**NOTE:** To cancel the clean cycle, press the Power button or CLEAN button once. The brewer will beep and stop brewing through the cleaning mixture. Continue to follow the instructions starting at Step 6.

**IMPORTANT:** If you cancel the clean cycle, your brewer will not be properly descaled.

4 The clock will display and count down the remaining clean cycle time, which takes approximately 75 minutes to complete. Your brewer will deliver a small amount of cleaning solution to distribute it through the system. It will then pause, deliver additional cleaning solution, and repeat this process for 75 minutes. The extended pauses allow for maximum cleaning and descaling.

**IMPORTANT:** DO NOT remove the carafe at any time during the clean cycle.

5 Upon completion, the brewer will beep, the clock will display End, and the Intelligent Clean Cycle Indicator will turn off.

6 Empty the contents of the carafe and place it back under the brew basket. Clean the water reservoir with warm, soapy water to remove any cleaning solution that could affect the flavor of your coffee.

7 Fill the reservoir with fresh water up to, but not exceeding, the Full line.

8 Flush the system by running a water-only cycle. If cleaning the Grounds mode, run a Full Carafe Classic brew cycle. If cleaning the Pods mode, run a 12 oz. Classic brew. If cleaning the Hot Water mode, run a Full Carafe on BOIL. Rerun a water-only cycle if taste persists. After the cycle is complete, discard the water and thoroughly clean the carafe and brew basket.

**NOTE:** Hard water will cause scale buildup faster than soft water and the brewer will indicate it needs cleaning more often.

Brewer is not detecting the Ninja® Pod Adapter.

- Ensure the adapter is fully seated in place over the brew basket with the handle closed. Pull the handle toward you until it clicks into the LOCK position.
- Ensure the Hot Water Dial is turned completely to the coffee bean icon.

Coffee is splattering.

- Some splatter is normal. Use the cup tray when possible to reduce the distance between the cup and the coffee outlet.
- Ensure the Ninja Pod adapter is installed over the brew basket when brewing pods.

Brewer is not displaying sizes or styles to brew.

- Ensure the sliding lid is fully closed or the Ninja Pod Adapter handle is closed and in the LOCK position. Ensure the Hot Water Dial is turned completely to either the coffee bean or water droplet icon.

CLOCK DISPLAY MESSAGES:

End

- The brew cycle is complete.

Add Wtr

- The system does not have enough water in the reservoir to complete your brew. Add fresh water to the reservoir and then press the START BREW button to resume.
- If the reservoir is filled with water, remove and reseal the reservoir. If the issue persists, contact a service center.

CLn

- The system has detected that a clean cycle needs be run immediately to remove calcium scale buildup in the heater. See 'Cleaning & Descaling Your Brewing System' for instructions.

STOP

- A brew cycle was cancelled.

ERROR MESSAGES:

Er

- If the clock displays "Er" and then a number (ex. "Er 03"), contact a service center.



## HOT WATER

The water outlet is completely separate from the coffee outlet to ensure clean water is dispensed every time.

To enter hot water mode, turn the dial on the left side of the brewer to the water droplet icon, aligning it with the marker. You will see a change in the display.

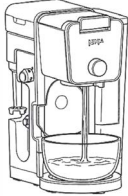

**IMPORTANT:** Close the drip stop before brewing hot water to ensure no excessive coffee drips into the vessel (refer to the drip stop section).

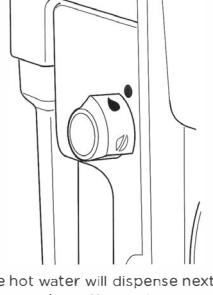

The hot water will dispense next to the coffee outlet.



BOIL

Two water temperatures for a variety of different foods and beverages.



HOT

17 size options ranging from 2 oz. to 60 oz.

**HOT WATER MODE ONLY**

**NOTE:** Make sure to use a vessel that is big enough for the brew size you select.

The hot water function may vary depending on the model.

Illustrations may differ from actual product. We are constantly striving to improve our products, therefore the specifications contained herein are subject to change without notice.