



160 FOOT RC RANGE



INDOOR/OUTDOOR



EXPERIENCE LEVEL

HYDROBOLT INSTRUCTION MANUAL



 **Odyssey**
toys

Beginner's Guide

Please read this manual carefully before operation and keep it for future reference.

- After connecting the battery socket, the boat will automatically power on when it touches the water, and it can be connected to the remote controller. When the connection is successful, the boat's light and the remote control's lights will turn on and stay on.
- The control distance of the boat should not exceed 50 meters, otherwise it may lose contact.
- When fully charged, the total battery life of the boat is about 20 minutes. When the voltage is low, the boat's light will change from steady to fast flashing, and it will automatically switch to the low speed gear. Please be sure to return to a close range 5 minutes in advance, to avoid being unable to retrieve the boat.
- When sailing, avoid debris as it may get caught in the propeller or cause damage to the boat.
- The navigation rudder needs to be manually adjusted.
- The boat is in the low speed gear by default when starting, and the high and low speeds mode can be switched by the speed button.
- If the remote control fails to connect to the boat within 2 minutes of being turned on, the remote control will automatically enter sleep mode, the indicator light will change from slow flashing to off, and can be restarted by pushing any button on the controller.
- When the boat is removed from the water, there is a risk of conduction if it remains wet. Dry the boat on exit.

CONTENTS

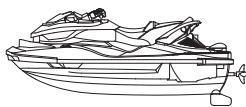

Boat x1
(Battery Included)



USB Charger x1



Remote Control x1



User Manual x1



Propeller x2



Boat Rack x1

Note: Please carefully count the parts and quantities. If you find that the parts are not complete, please provide proof of purchase and contact the sales merchant for replacement.

Product Introduction

The LM13 remote control boat uses a 2.4GHZ high-frequency remote control system, which is suitable for multi-player competition. Players can control the boat to run in the water, travel forward, backward, turn left and turn right.

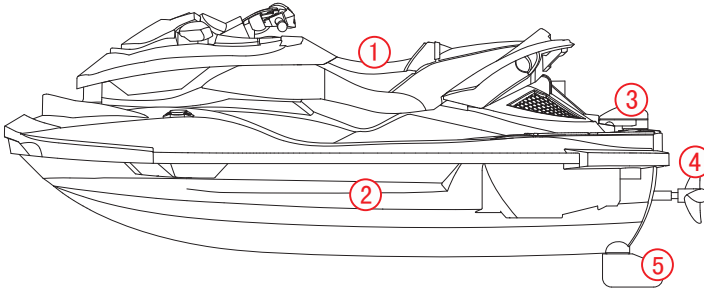

- ① Cabin Cover ② Hull ③ Cabin Cover Switch
- ④ Propeller ⑤ Navigation Rudder

REMOTE CONTROL

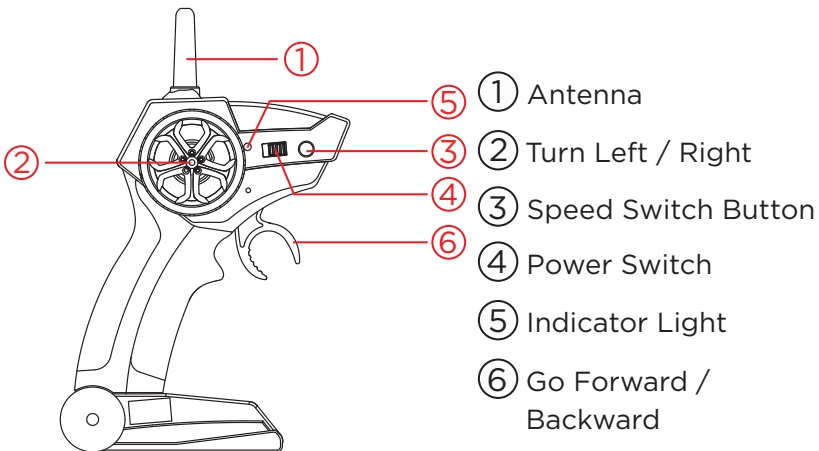

Battery Installation

1. Unscrew the cabin cover switch counter-clockwise.
2. Lift the tail of the cabin to 45 degrees and pull it out firmly.
3. Connect the battery socket and install the battery into the battery holder, taking care not to reverse the plug.
4. Insert the cabin at a 45-degree angle into the hull and push it forward.
5. Close on the cabin and lock the hatch switch clockwise.

①

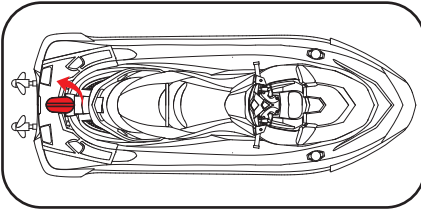

②

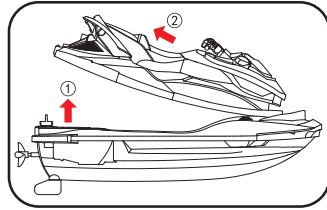

③

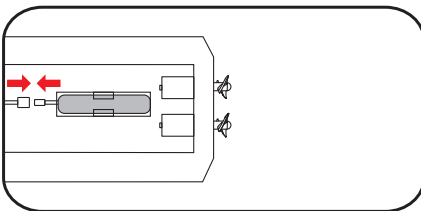

REMOTE CONTROL

Open the battery cover, and correctly insert two AA batteries according to the electrode instructions. (batteries need to be purchased separately)

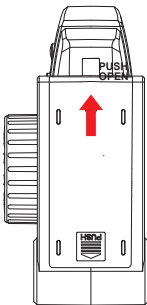

①

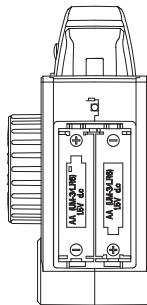

②

1. When inserting the battery, the positive and negative poles of the battery must be identified, and they cannot be reversed.
2. Do not mix old and new batteries or different types of batteries.

Operation with Remote Control

1. Go Forward / Backward

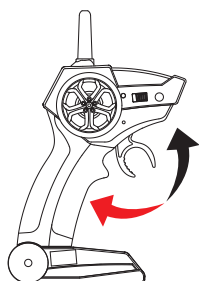

FORWARD

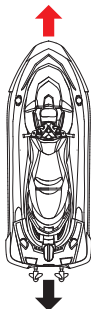

BACKWARD

2. Turn Left / Right

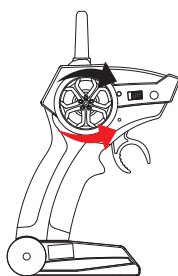

LEFT

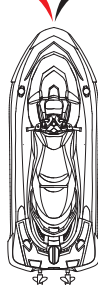

RIGHT

3. The navigation rudder can correct the navigation direction. When going forwards, you can manually adjust it to the left if it is turning right, or you can adjust it to the right if it is turning left.

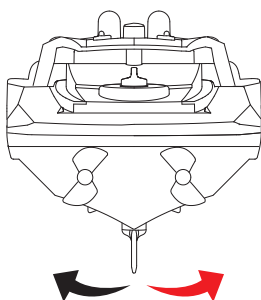

Battery Charging

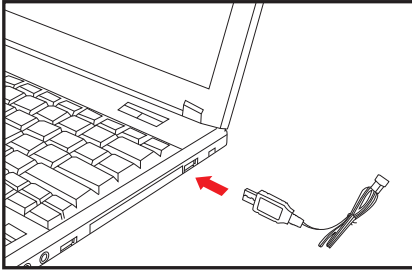

1. Insert the USB to the computer or the charging base of mobile phone.

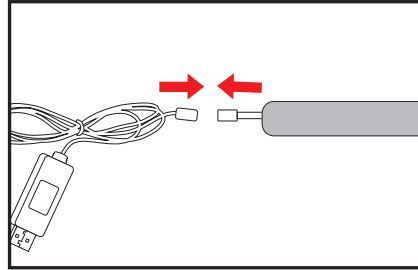

2. Connect the battery plug to the USB charger.

Note: The charging time is about 120 minutes and the total use time is about 20 minutes. The red light flashes when the battery is charging, and turns off when full.

CAUTIONS

Please use batteries with caution.

If the battery leaks, avoid liquid contact with skin and eyes. In case of skin contact, wash immediately with soap and water. In case of contact with eyes, rinse with plenty of cold water and seek medical advice immediately.

If the charger emits suspicious odor, noise, or smoke, unplug it immediately.

Please use the special charger delivered by the original factory for charging. It is strictly forbidden to use damaged or other brand chargers.

Do not charge swollen, leaked or damaged batteries.

Do not overcharge the battery. When the battery is fully charged, unplug the charger.

Do not charge close to flammable objects (carpets, wooden floors, solid wood furniture, etc.) or conductive objects. Keep the battery in sight when charging.

Never charge the battery immediately after using the product when the battery is still hot.

The battery charging temperature should be between 0°C and 40°C.

This device consists of electronic components and battery. For electronic and electrical waste, please follow the local waste disposal requirements for special treatment.

Safety Warnings

- This product must be used under adult supervision. This remote boat is not a toy, only for children over 14 years old.
- This product contains small parts. Do not swallow it to avoid suffocation.
- Keep a safe distance from the propeller rotating at high speed to avoid the risk of angulation.
- The motor can get hot, please do not touch it to avoid the risk of burns.
- In order to ensure the requirements of the electromagnetic environment of aeronautical radio stations, it is prohibited to use various model remote controls in the area centered on the runway of the airport and with a radius of 5000 meters.
- During the period and area where the relevant national authority issues radio control orders, the model remote control should be stopped as required.
- Regularly check the USB cable and other components. If they are damaged, stop using them until it is repaired.

MAINTENANCE AND REPAIR

1. When the remote boat stops working, the battery must be removed.
2. The surface of the remote boat should avoid prolonged exposure to the sun to prevent paint stripping. After each use, the surface of the remote boat should be cleaned with dry soft cloth.
3. When the remote boat is not used for a long time, the remote control battery must be taken out to prevent the battery leakage from damaging the remote control.

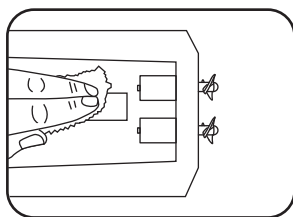

②

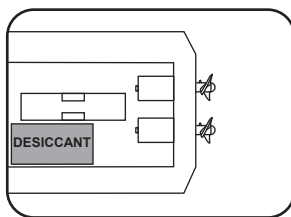

③

Note: After each use of the remote boat, a dry soft cloth should be used to absorb the water in the cabin and a desiccant should be used to ensure that the hull is dry and clean.

Please do not return this product to the store.

For Customer Service please email: Care@OdysseyToys.com

Please note the units model number and name in your email:

Model no. ODY-02LZ • HydroBolt

www.odysseytoys.com/support

1-(305)-933-4480

Hours of operation: 10:00am - 5:00pm EST

CAUTIONS AND WARNINGS

- Manufacturers and dealers disclaim all responsibility for damage caused by misuse.
- Keep hair and loose clothing away when powered on.
- Check the batteries regularly for potential leakage or corrosion that may occur.
- When installing the batteries carefully follow the polarity marking +/-.
- Do not mix different battery types.
- Remove exhausted or drained batteries.
- Do not submerge the unit in any liquids.
- Do not place the unit near powerful, un-shielded magnets.
- Do not expose the unit to extreme hot or cold temperatures.
- Do not hit, drop, or smash the unit with extreme force.
- Do not disassemble the unit for any reason.

NOT FOLLOWING THESE PRECAUTIONS WILL VOID YOUR WARRANTY.

60 DAY LIMITED WARRANTY

Odyssey Marketing / Odyssey Toys warrants to the original purchaser, when used in North America only, that this product shall be free of defects in material and workmanship. This warranty applies within 60 days of the original purchase date with normal home use.

This warranty does not apply for commercial use of this product. Use outside of North America is not covered by this warranty. During the warranty period, we will at our discretion, repair or replace this product without charge, as long as the product has not been abused or mishandled as by our determination. Our determination shall be final and be the consumer's sole remedy.

ALL RETURNS must be accompanied by a Return Authorization Number which is issued by Odyssey Marketing's Customer Service Department.

Please contact Customer Service BEFORE returning any products or parts thereof. Once you have obtained a Return Authorization Number, you will be provided a return address within the Customer Service email.

This warranty does not cover installation, adjustments in the home, nor damage due to accidents, misuse, abuse, fire, or any acts of God, incorrect line voltage, damage to other equipment caused by improper installation, unauthorized or improper modifications. This warranty gives you specific legal rights and you may also have other rights that vary from state to state.

**** THIS WARRANTY IS EXPRESSLY IN LIEU OF ALL OTHER WARRANTIES, EXPRESSED OR IMPLIED INCLUDING THE WARRANTIES OF MERCHANTABILITY AND FITNESS.****

©2024 Odyssey Toys LLC

