

How to Use the MightyJet Controller

PRESS: the ▲ or ▼ button to increase or decrease the flow rate of the MightyJet Pump.



PRESS AND HOLD: the fish icon button to toggle between STREAM Mode and SINE WAVE Mode.

When the controller's display that reads a "1" You are in STREAM Mode.

When the controller's display that reads a "2" You are in SINE WAVE Mode.

PARTS #'s FOR 8500 | 8501 | 8502

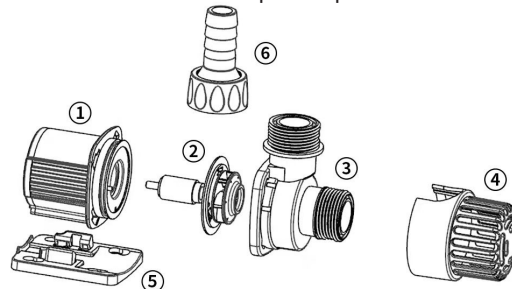

8500 Mini

①	MightyJet Motor	850003
②	MightyJet Impeller	850005
③	MightyJet Impeller Cover	850004
④	MightyJet Front Cover	850006
⑤	MightyJet Base	850007
⑥	MightyJet Fittings	850008

8501 DeskTop

①	MightyJet Motor	850103
②	MightyJet Impeller	850105
③	MightyJet Impeller Cover	850104
④	MightyJet Front Cover	850106
⑤	MightyJet Base	850107
⑥	MightyJet Fittings	850108

8502 MidSize

①	MightyJet Motor	850203
②	MightyJet Impeller	850205
③	MightyJet Impeller Cover	850204
④	MightyJet Front Cover	850206
⑤	MightyJet Base	850207
⑥	MightyJet Fittings	850208

WARNING

READ ALL SAFETY INSTRUCTIONS BEFORE USE.

To avoid electric shock, special care should be taken since water is employed in the use of aquarium equipment. For each of the following situations, do not attempt to repair yourself. Return the appliance to an authorized service facility for service or discard the appliance.

Carefully examine the appliance after installation. It should not be plugged in if there is water on parts not intended to be wet.

Do not operate any appliance if it has a damaged cord or plug, or if it is malfunctioning or if it is dropped or damaged in any manner.

To avoid the possibility of the appliance plug or receptacle getting wet, position aquarium to one side of a wall mounted receptacle to prevent water from dripping onto the receptacle plug. A "Drip Loop" should be arranged by the user for EACH cord connecting an aquarium appliance to a receptacle. The "Drip Loop" is that part of the cord below the level of the receptacle or the connector if an extension cord is used. This "Drip Loop" prevents water travelling along the cord and coming in contact with the receptacle. If the plug or the receptacle do get wet DO NOT unplug the cord. Disconnect the fuse to the circuit breaker that supplies power to the appliance. Then unplug and examine for the presence of water in the receptacle.

Close supervision is necessary when any appliance is used by or near children.

Always unplug an appliance from the outlet when not in use, before putting on or taking off parts, and before cleaning. Never yank the cord to pull plug from outlet. Grasp the plug and pull to disconnect.

Do not use an appliance for other than intended use. The use of attachments not recommended or sold by the appliance manufacturer may cause an unsafe condition.

Do not install or store the appliance where it will be exposed to the weather or to temperatures below freezing.

Make sure an appliance mounted on a tank is securely installed before operating it.

Read and observe all the important notices on the appliance.

This appliance has a polarized plug (one blade is wider than the other). As a safety feature, this plug will fit in a polarized outlet only one way. If the plug does not fit fully in the outlet, reverse the plug. If it still does not fit, contact a qualified electrician. Never use with an extension cord unless plug can be fully inserted. Do not attempt to defeat this safety feature.

If an extension cord is necessary, a cord with a proper rating should be used.



MODE 1: STREAM



The Stream Mode is a calm, uninterrupted constant movement of water at a single speed



Each Mode has 9 speed settings that can be controlled using the ▲ ▼ buttons.

1.1 Being the minimum and 1.9 being maximum speed.

After the speed has been set, a different number will show. This number is how much wattage is currently being used. Example: 30 = 30 Watts.

MODE 2: SINE WAVE



The Sine Wave Mode is a smooth repetitive oscillation that moves water in a continuous wave motion.



Each Mode has 9 speed settings that can be controlled using the ▲ ▼ buttons.

2.1 Being the minimum and 2.9 being maximum speed.

FEED MODE

PRESS: the 🐟 button to activate feed mode. The display will read 'FE' and the pump will shut off and will automatically resume after 10 minutes.

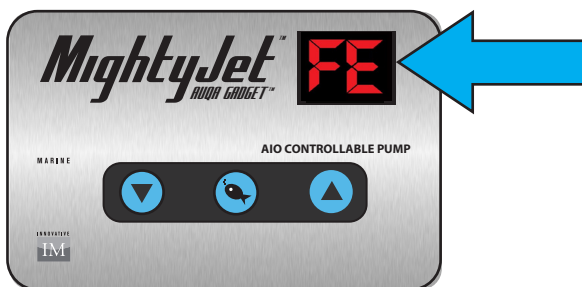

You can override the 10 minute timer by pressing the 'FEED' button again and your pump will resume.

LOCKING YOUR SETTINGS

PRESS AND HOLD: the ▼ button to activate the "LOCK" function. The display will read "LC" and all buttons will be disabled.

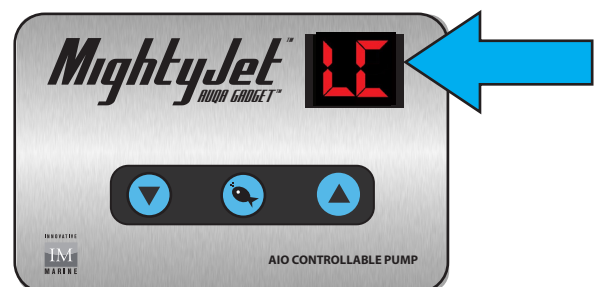

UNLOCKING YOUR SETTINGS

PRESS AND HOLD: the ▲ button to deactivate the "LOCK" function. The display will no longer read "LC" and all buttons will be enabled.