

This product is used for monitoring and displaying electrical parameters when charging mobile phones, as well as for testing various USB devices such as charger power and portable power bank capacity.

Two version specifications



Product specifications

Voltage range : 3.6V~32.0V Resolution Precision : 0.01V
 Current range : 0.00~8.00A Resolution Precision : 0.01A Maximum current 8.00A
 Capacity cumulative range : 0~99999mAh
 Resolution Precision : 0.01Ah
 Power cumulative range : 0~99999Wh
 Resolution Precision : 0.01Wh
 Power metering range : 000.00~150.00 W Resolution Precision : 0.01W
 Impedance Measuring range : 1~999.9Ω Resolution Precision : 0.1 Ω
 Temperature Measuring Range : 0~80℃ Resolution Precision : 1℃ Maximum
 Timing Measuring range : 999Hours 59Minutes59Seconds Resolution Precision:1s
 USB D+ Voltage Range : 0V~2.99V Resolution Precision : 0.01V
 USB D- Voltage Range : 0V~2.99V Resolution Precision : 0.01V
 Time to refresh : 500mS/ times
 Measurement rate : 0.5 times/s
 Alarm Mode : Display Hints
 Product size : 61mm x 68mm x 10.8mm
 Self-consumable flow : <0.02A
 Working temperature : -10~+60℃
 Working humidity : 10~80(no doubt)
 Pressure of work : 80~106kPa
 Certificate: RoHS, CE

Product Key operation instructions:

- 1: Short press the button to switch the screen
- 2: Quickly double-click the capacity to reset to zero (mAh)
- 3: Quick three-click power reset reset (Wh)
- 4: Quick four-click is the timer reset to clear the current group (00:00:00)
- 5: Quick five-click is to change the cumulative data storage group number、
(NO.X 10 groups of data)
- 6: Long press the button to reset the capacity, power, and time to reset the
current group (mAh, Wh, 00:00:00)
- 7: When the Screen rotation the interface, press and hold the key again to
rotation the screen settings
- 8: When interface is black, long press key button to enter background mode
- 9: When in the background mode, short press the button to the second item
and then long press it to clear the current when there is no load.
- 10: When in the over-voltage, low-voltage and over-current setting
interface, double-clicking is the add and three-clicking is reduce.
When adding or reduceing, long-pressing is continuous add and reduce.

APP Download address:

- 1.IOS APP: search E_test on iphone APP store to download
2Android APP: search E-test at Google play to down load or
<http://en.atorch.cn/upload/20220611142210.apk>



Please make sure to enable Bluetooth, location information, and storage permissions on your phone before going online

Note: This feature is only available on Bluetooth versions, and non Bluetooth versions do not support mobile app connectivity

Product accessories:



Product x'



OTG adapter x1

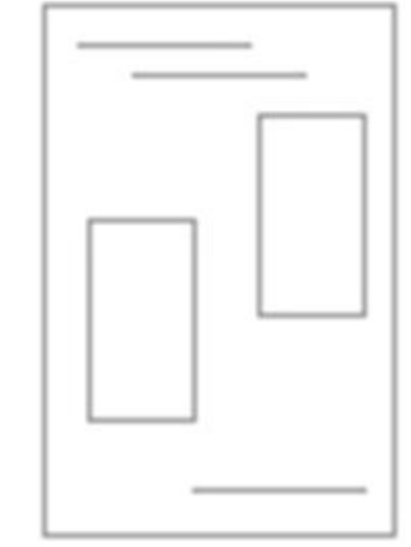

User Manual x1

Product size:

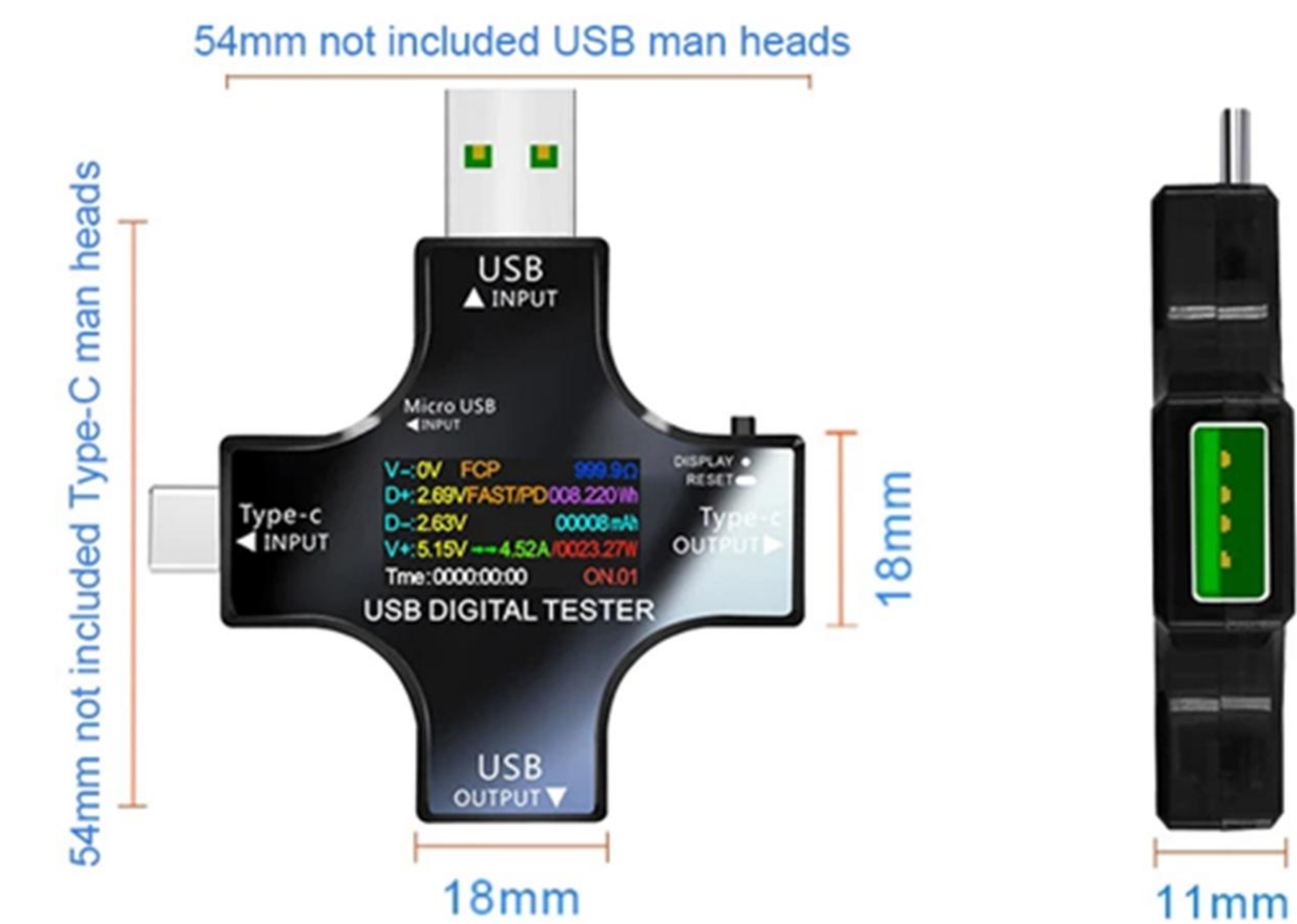

what is this?

This is a gift, it is an OTG adapter

- 1.It can be used as an OTG function,
- 2.It can also be used as a protocol trigger switch for PD chargers!

Functional interface:

14 in 1 Display Interface



Bluetooth version online instructions:

J7-c Bluetooth Connection Method

1. Plug **J7-c USB tester** into the USB charger and the Bluetooth indicator will light up.
2. Please download the mobile app software, only support Android 5.0 and above.
<https://www.mediafire.com/folder/31bc15uhq8odb/E-meter>
Then install the E-meter APP software on the phone.
3. Bluetooth on the phone needs to be turned on, Then open E-test APP on the phone

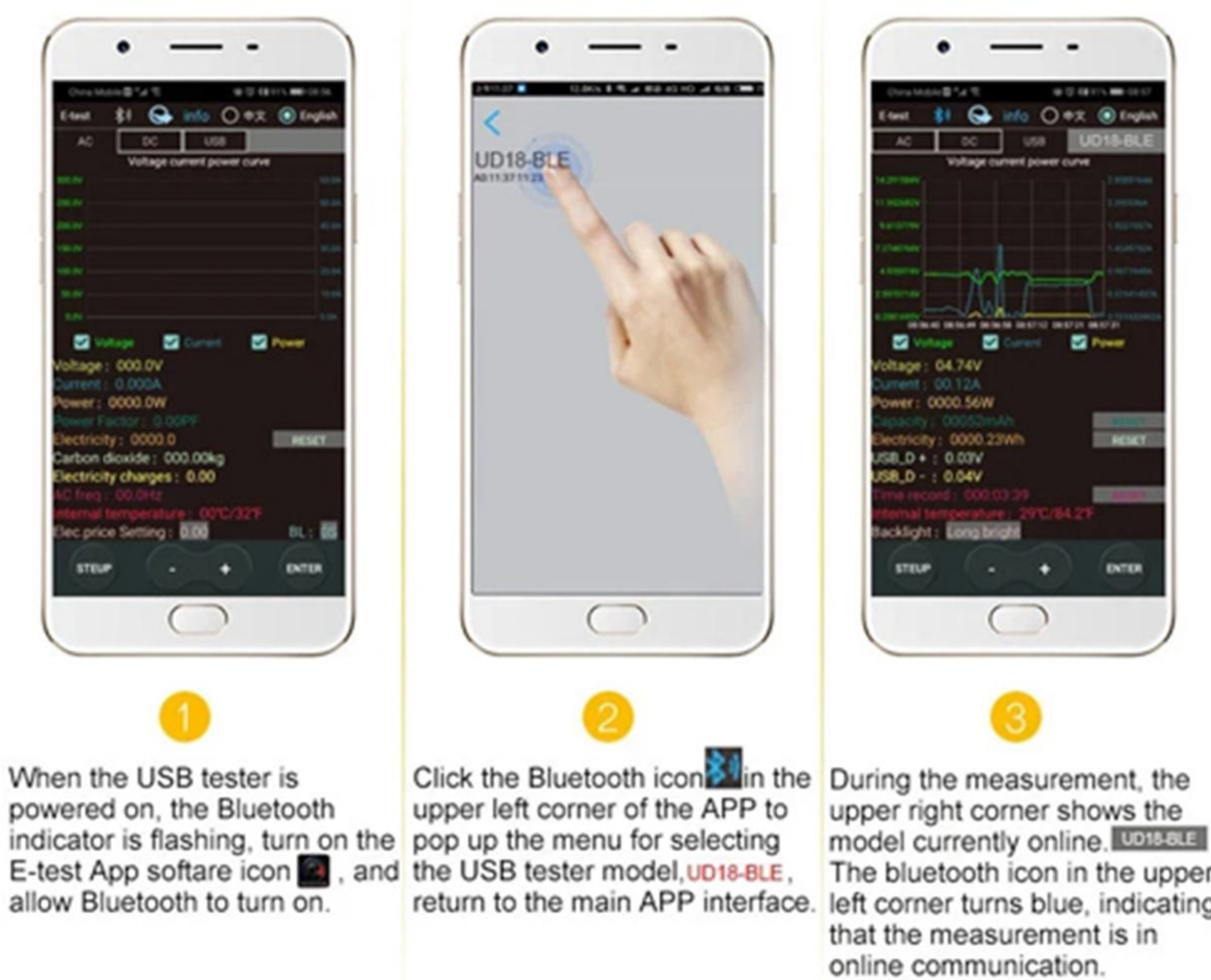

When the USB tester is powered on, the Bluetooth indicator is flashing, turn on the E-test App software icon , and allow Bluetooth to turn on.

Click the Bluetooth icon  in the upper left corner of the APP to pop up the menu for selecting the USB tester model, **UD18-BLE**, and return to the main APP interface

During the measurement, the upper right corner shows the model currently online. **UD18-BLE** The bluetooth icon in the upper left corner turns blue, indicating that the measurement is in online communication.

Mobile APP interface function introduction

Install mobile APP (IOS 7.0 and above Android 5.0 and above) software, Use the mobile phone Bluetooth function to wirelessly connect the product, read this device Achieve more measurement and control details data, leaving measurement technology without boundaries!

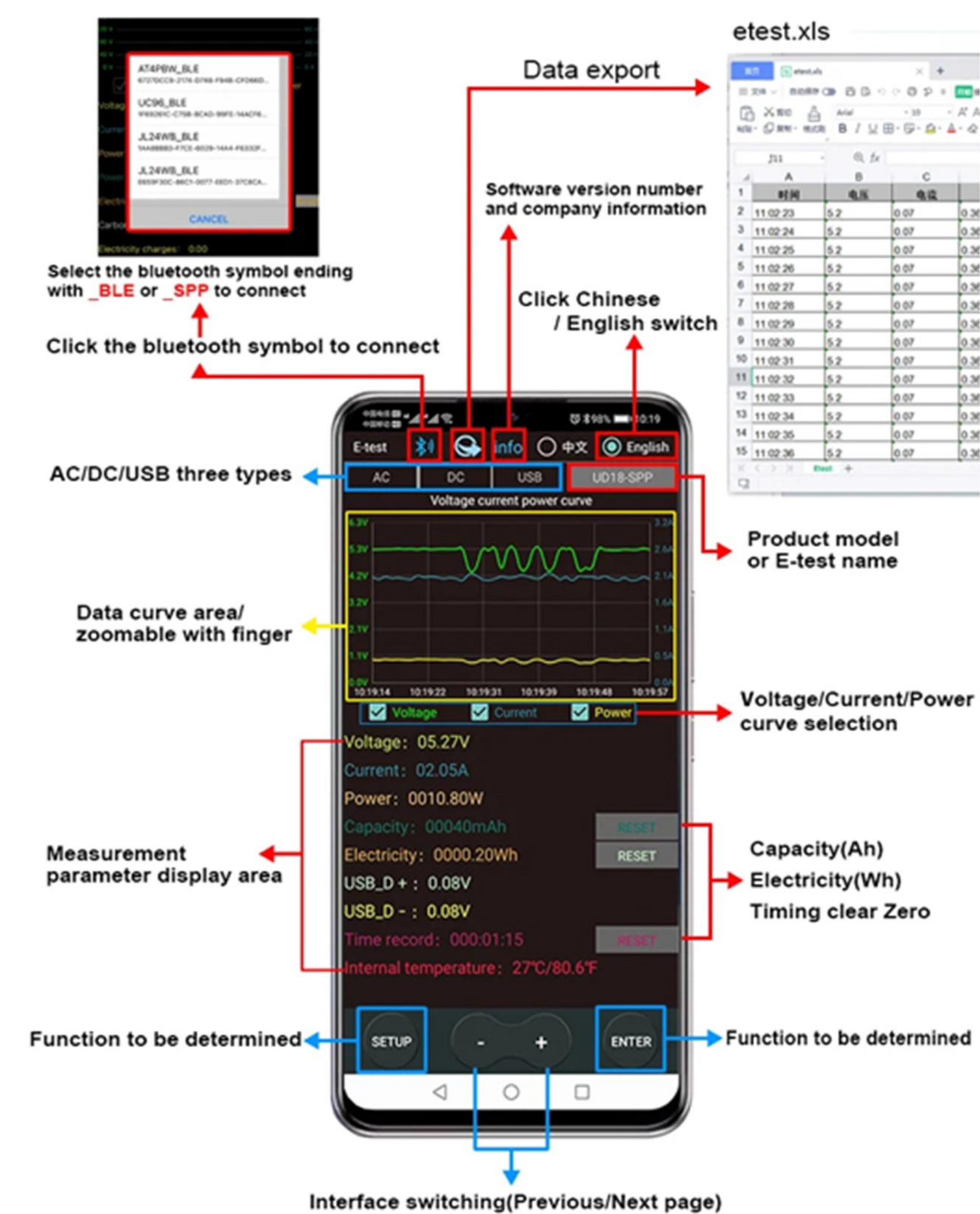

Why doesn't working when plugged into the USB-C port?

Since the PD charger (USB-C) has its own PD protocol, if you don't connect a mobile phone with the PD protocol, the PD protocol cannot be triggered, so you need to trigger its protocol to work normally!

-

Precautions before product use

Operation method 1.



Operation method 2.

