

MPS - PILOT SEAT

Instruction Manual
Bedienungsanleitung
Mode d'emploi

PARTS

[dimensions in mm / different scales]
No extra or spare parts listed!

1x



1x

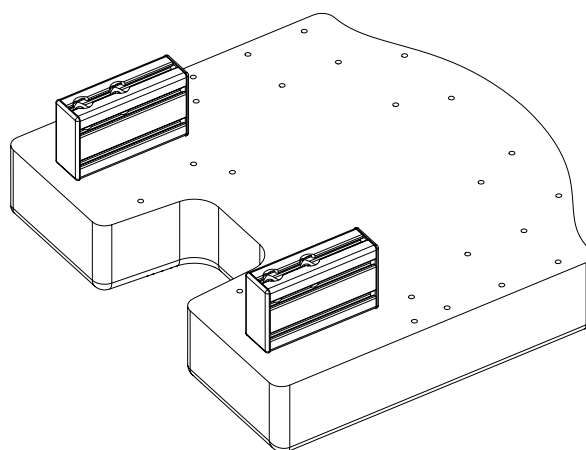

1x

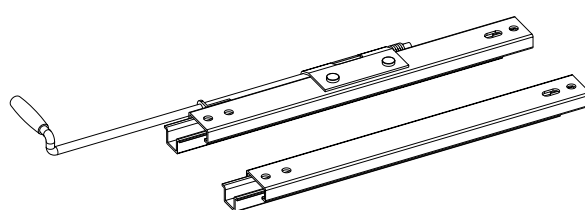

4x

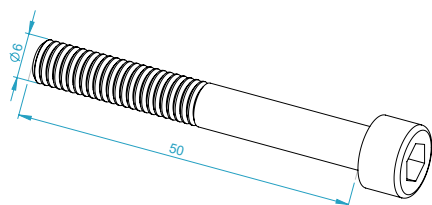

4x

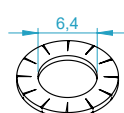

8x

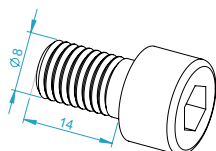

4x

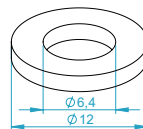

8x

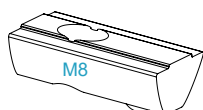

8x

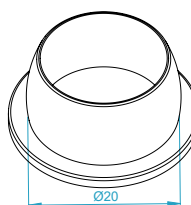

PARTS FOR OPTIONAL ARM-RESTS

1x

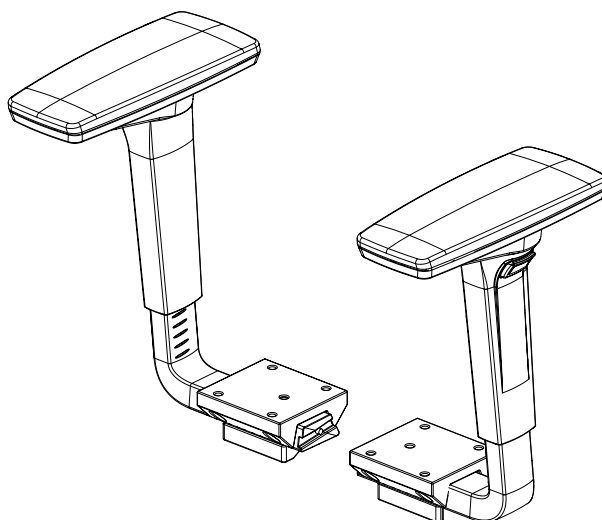

Already positioned in the appropriate
threads under the seat
(unscrew first)

8x

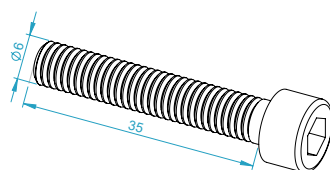

8x

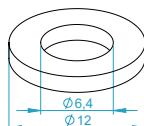

8x

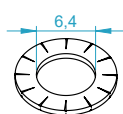

ASSEMBLY

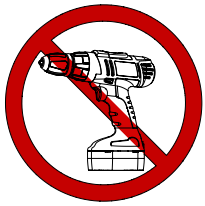

It is not recommended to use power tools.
Please make sure the screws are running smoothly in the threads. If not readjust the screw.
Do not use too much downward pressure.

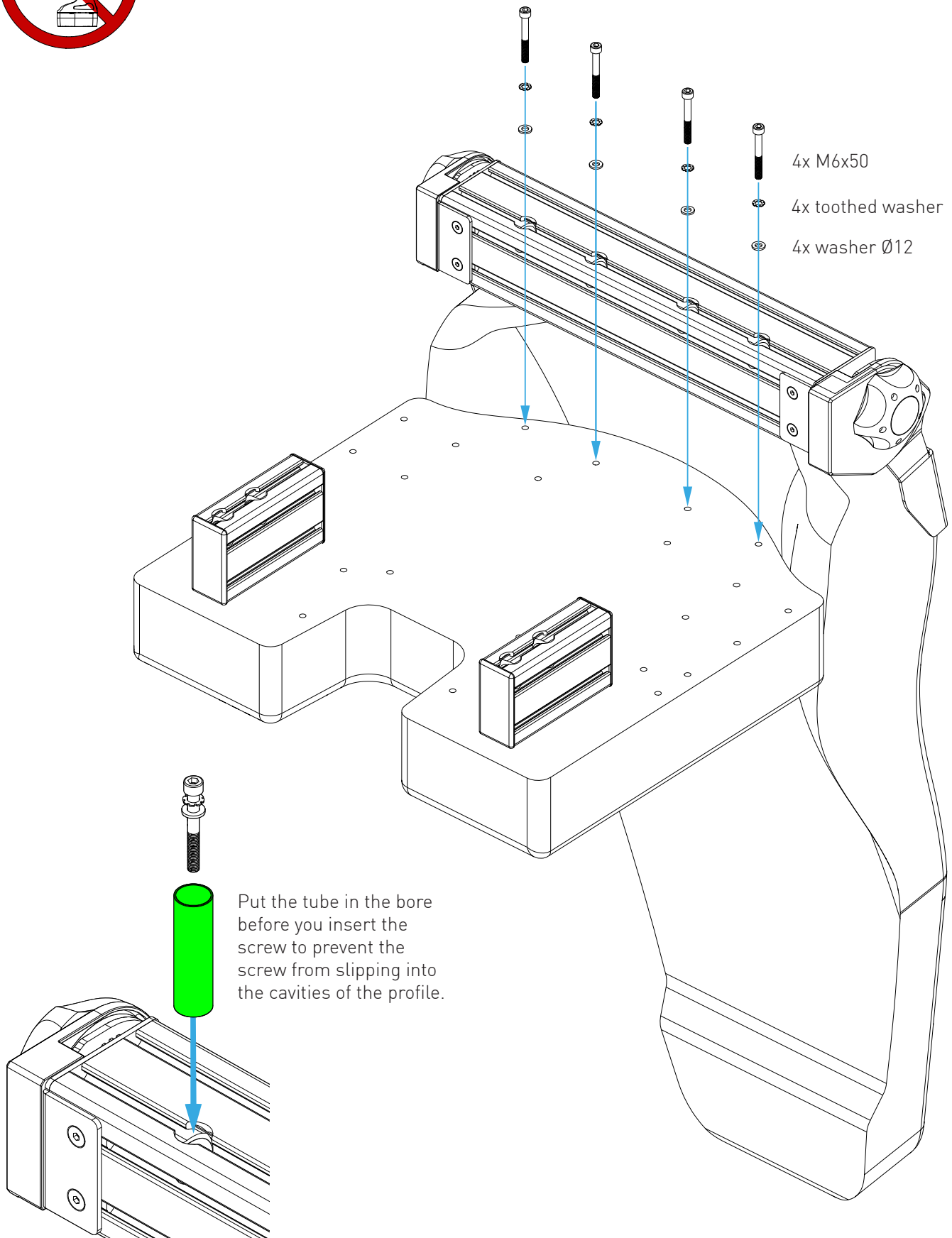

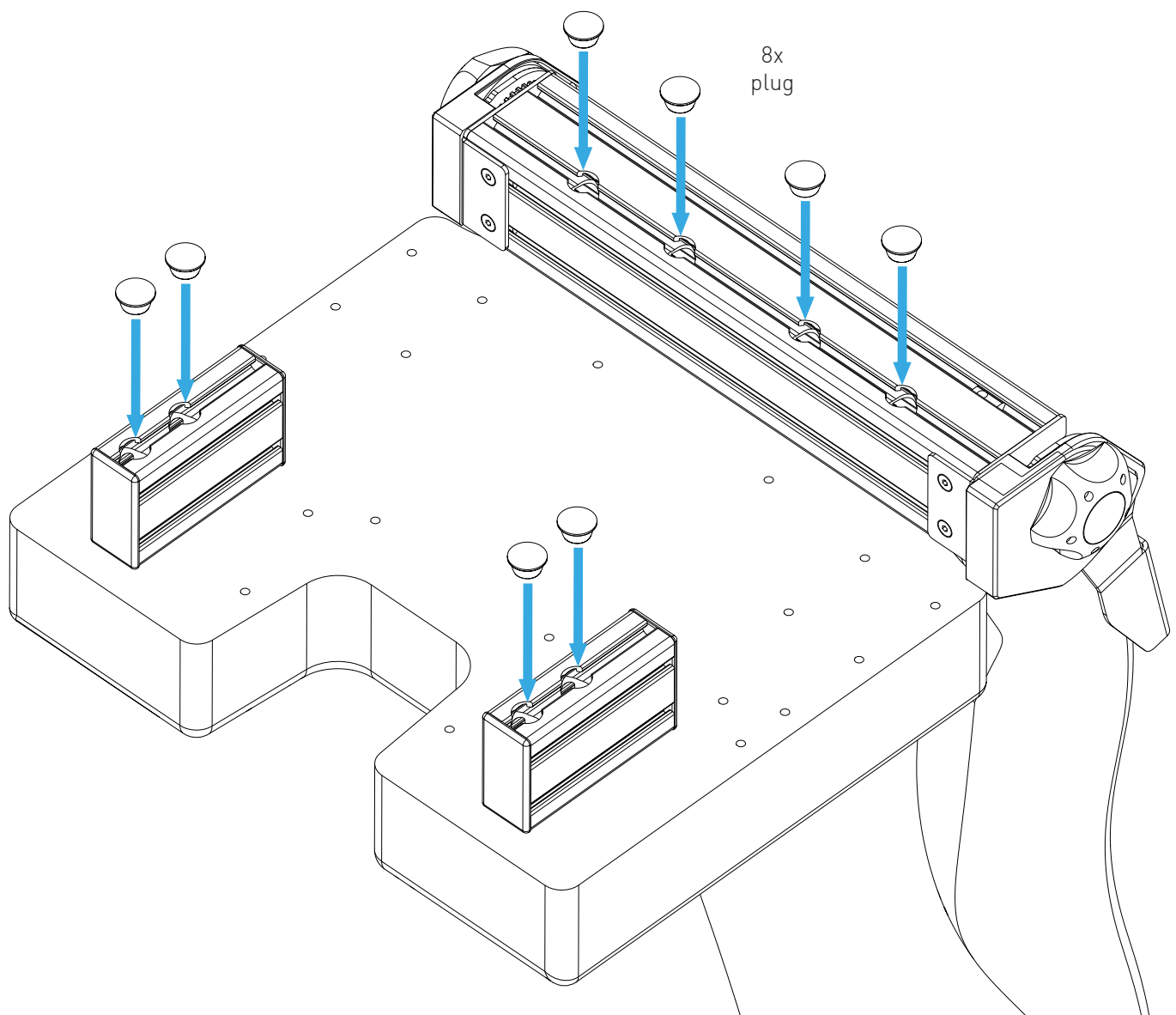

arm-rests
optional

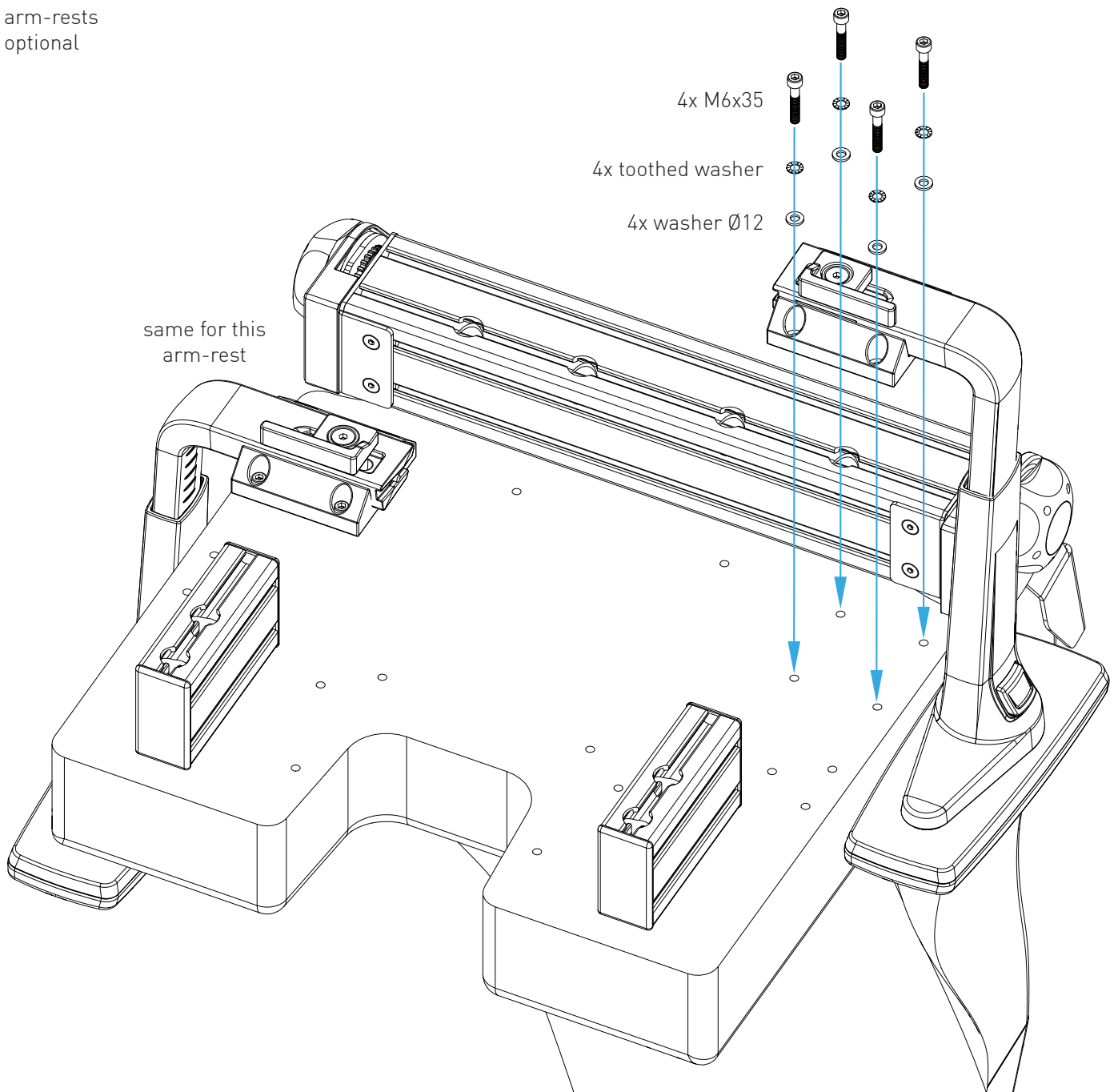

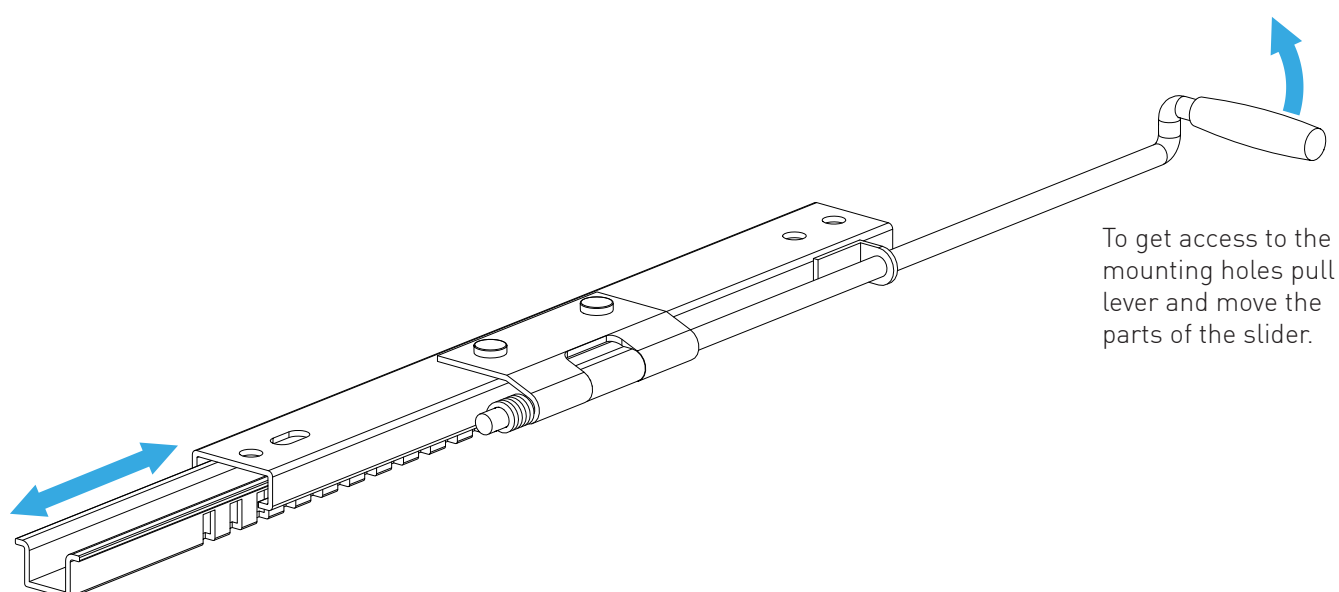
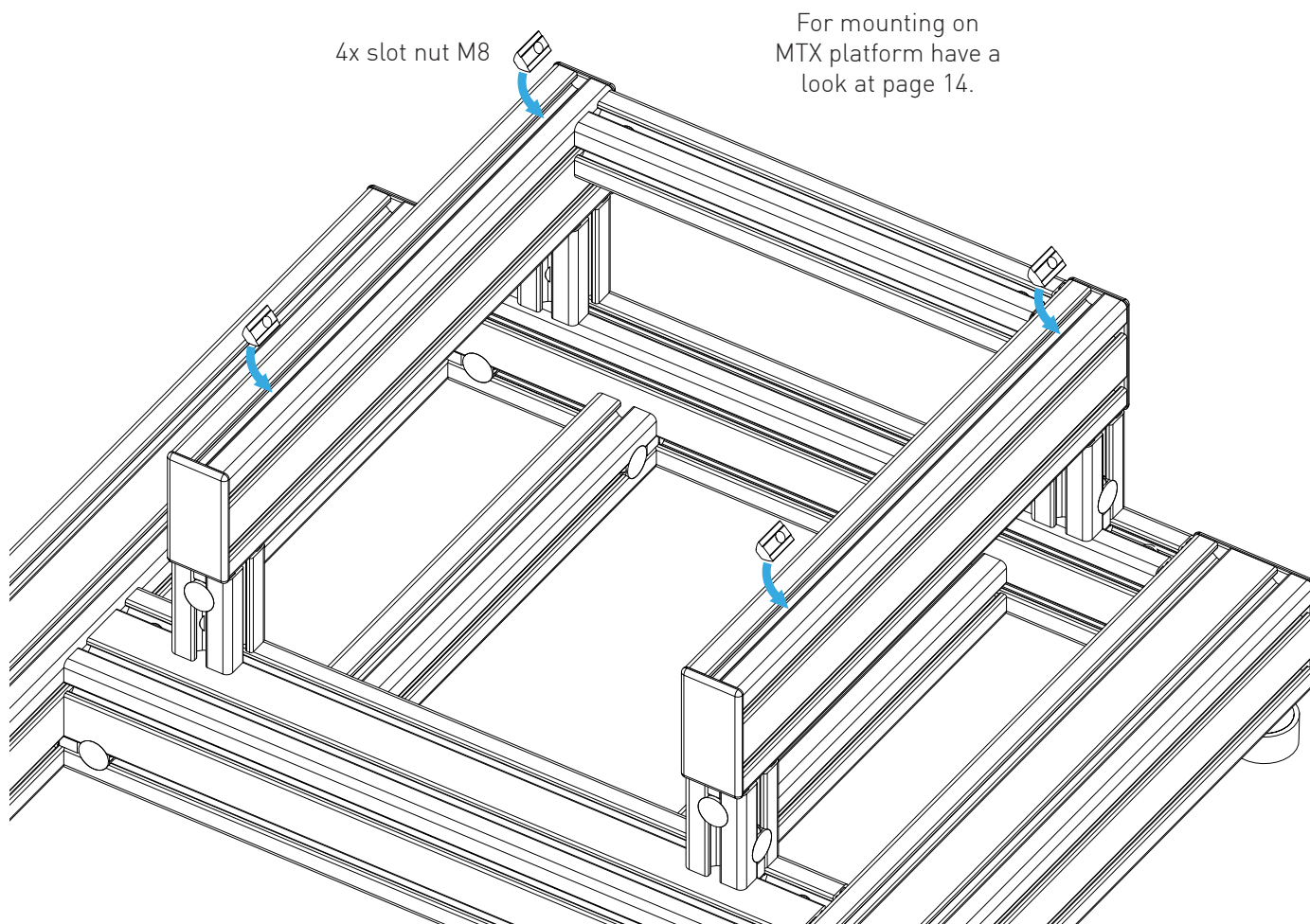

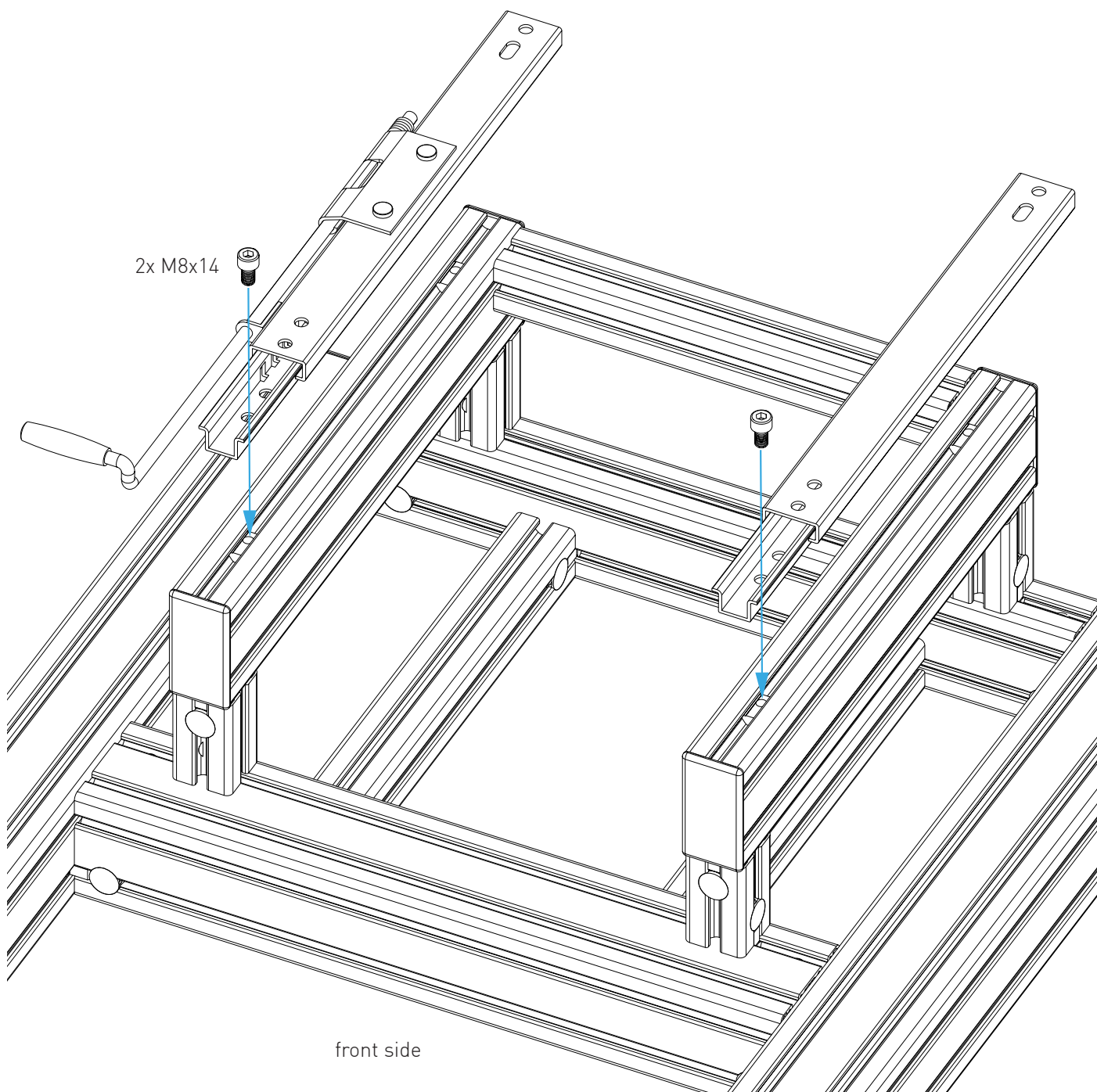

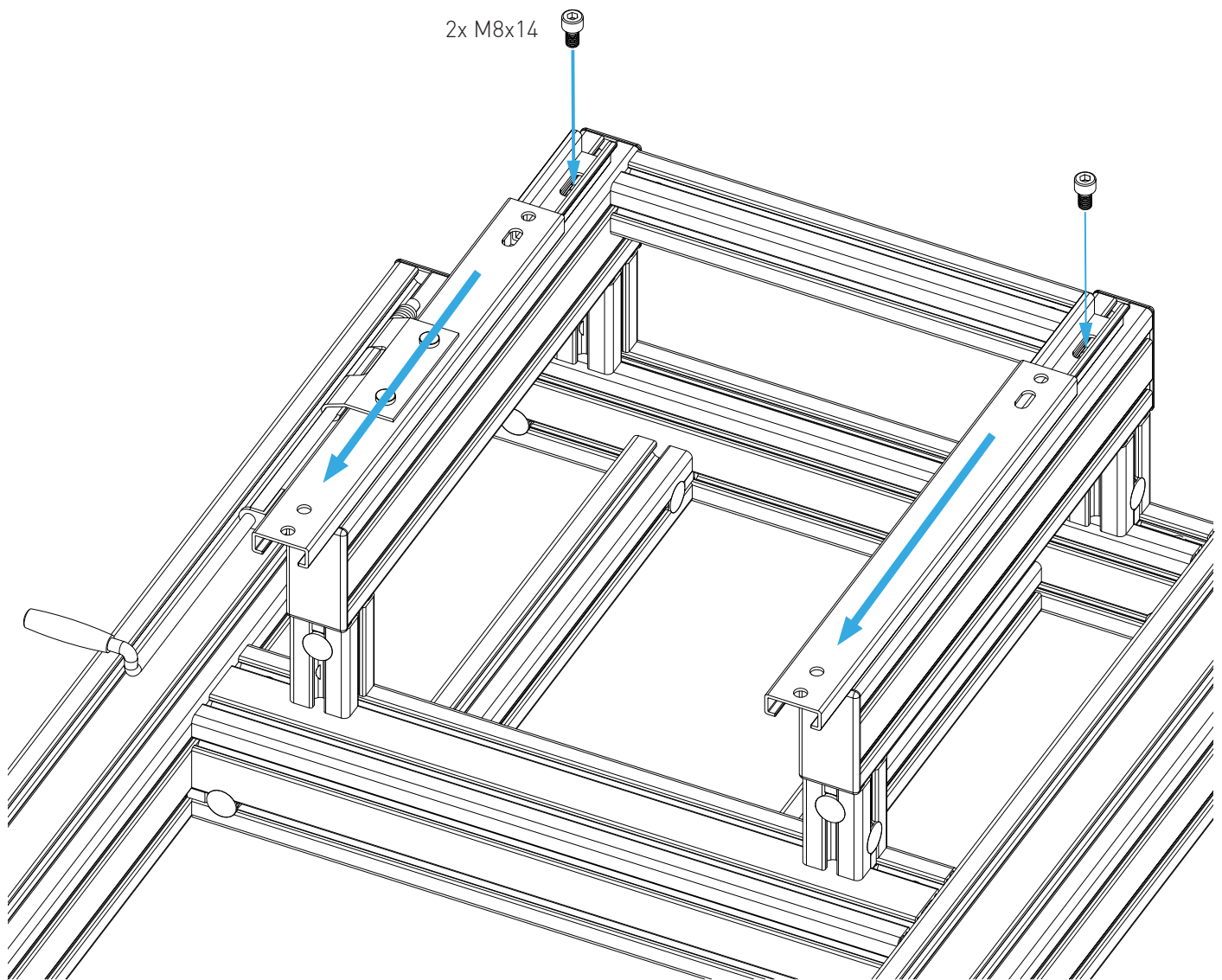

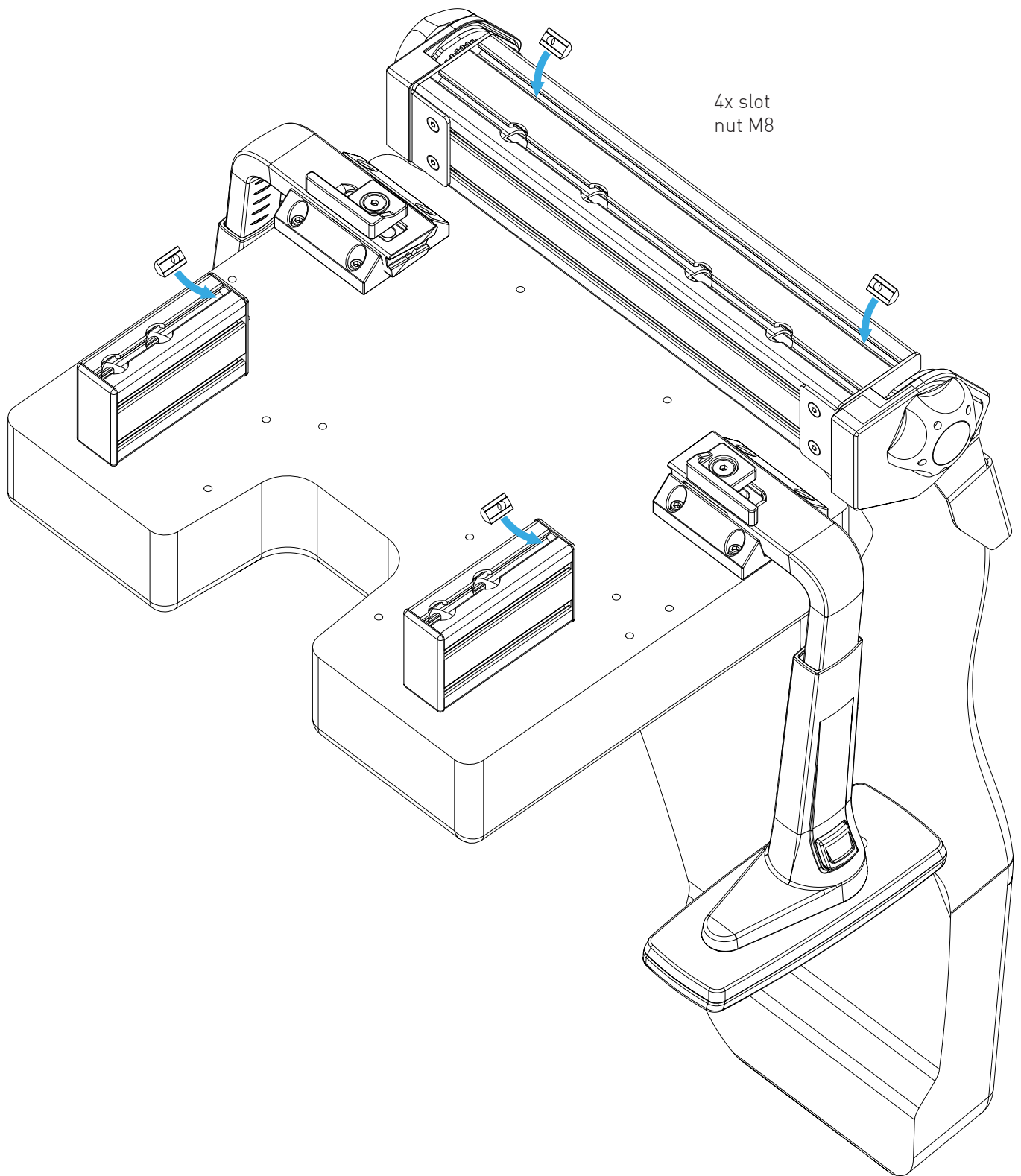

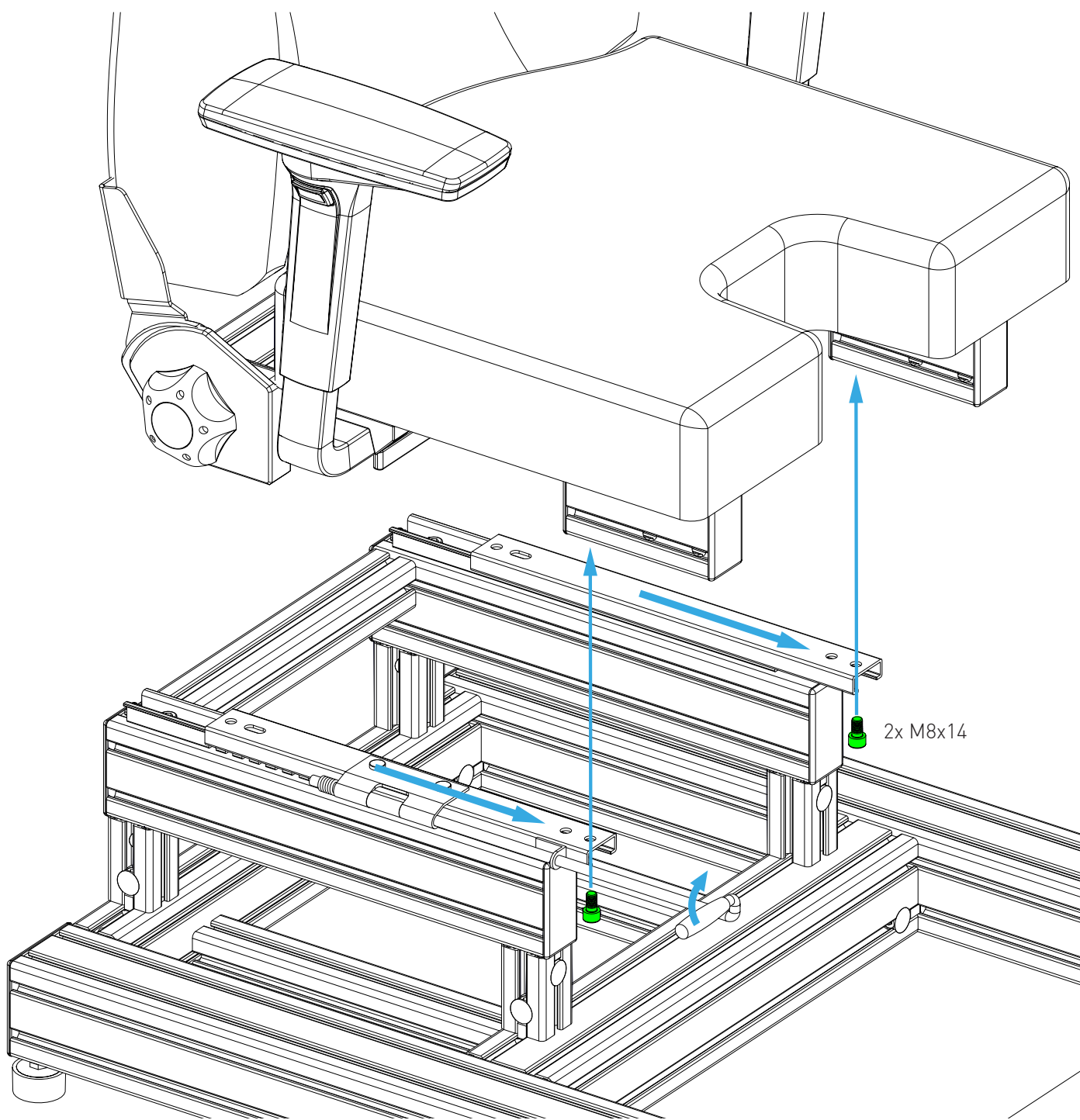

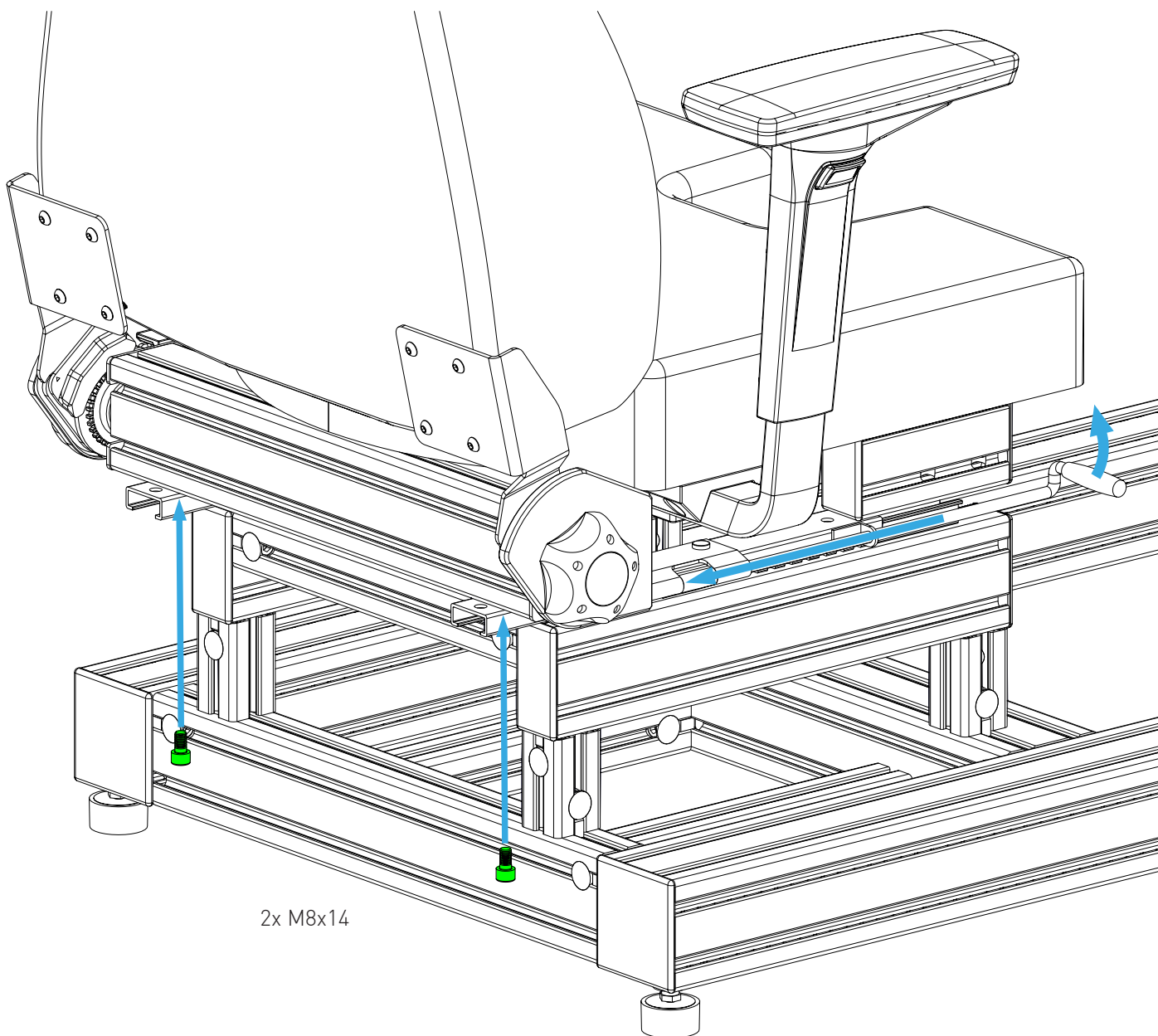

2x M8x14

bottom view

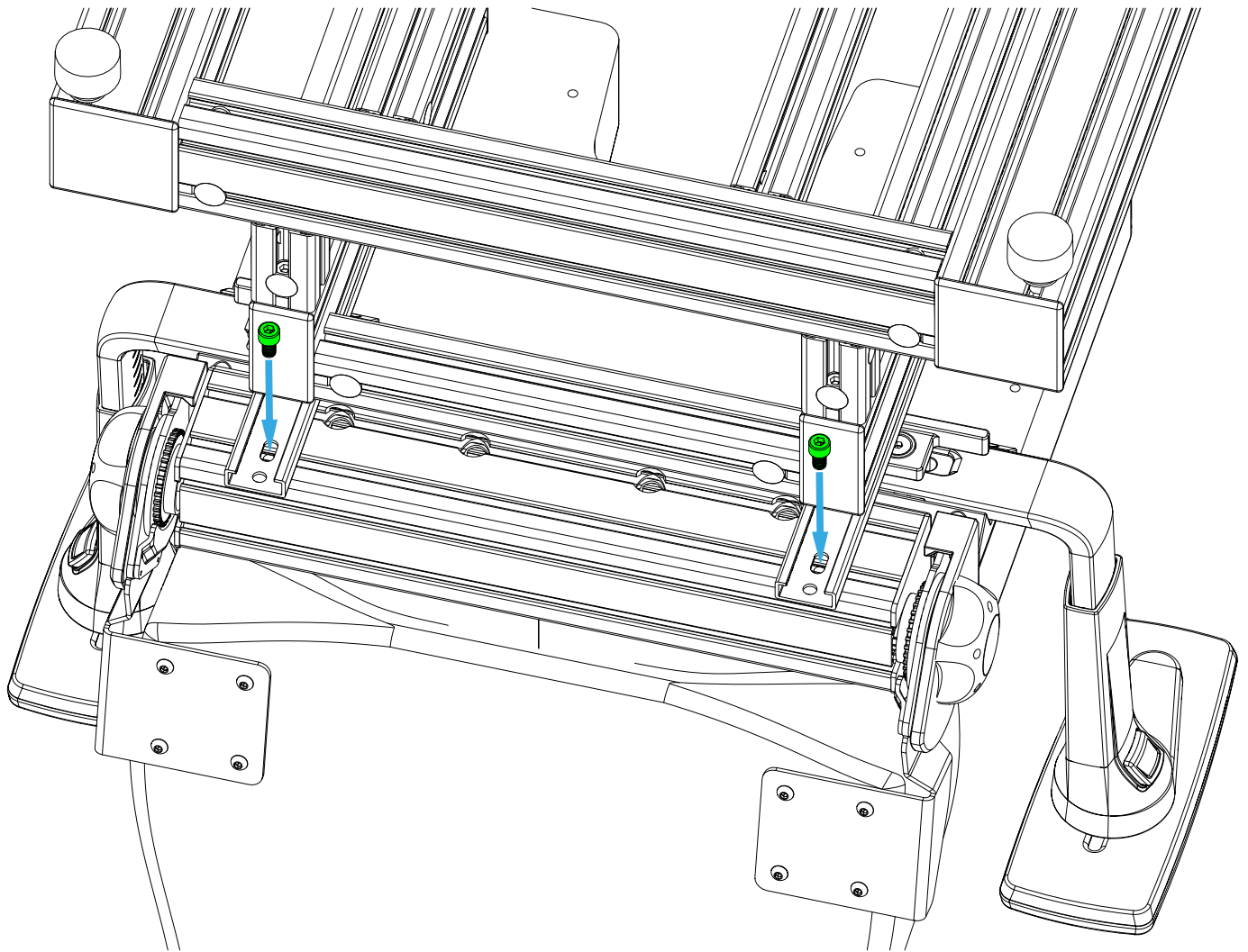

Mounting on MTX platform

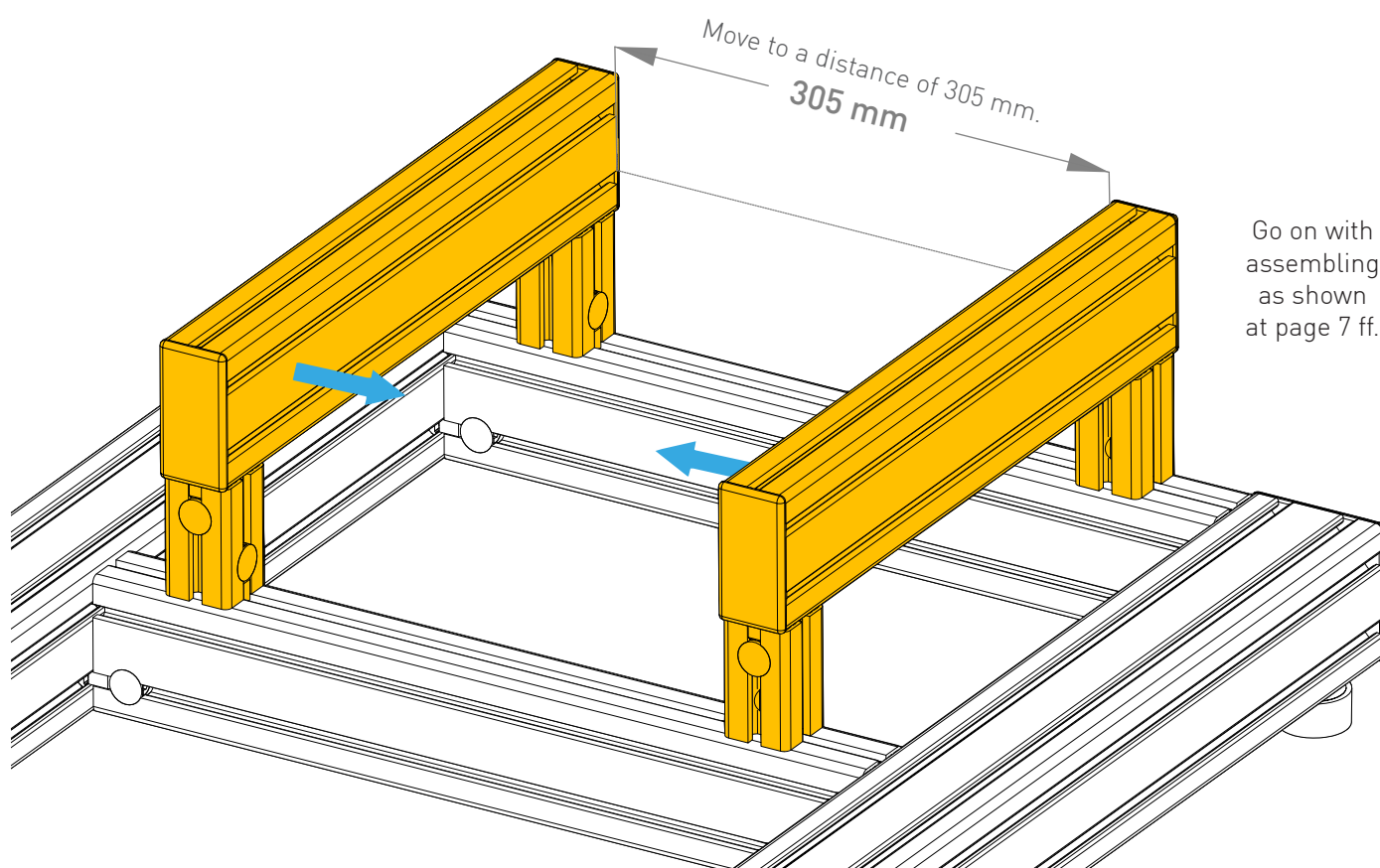
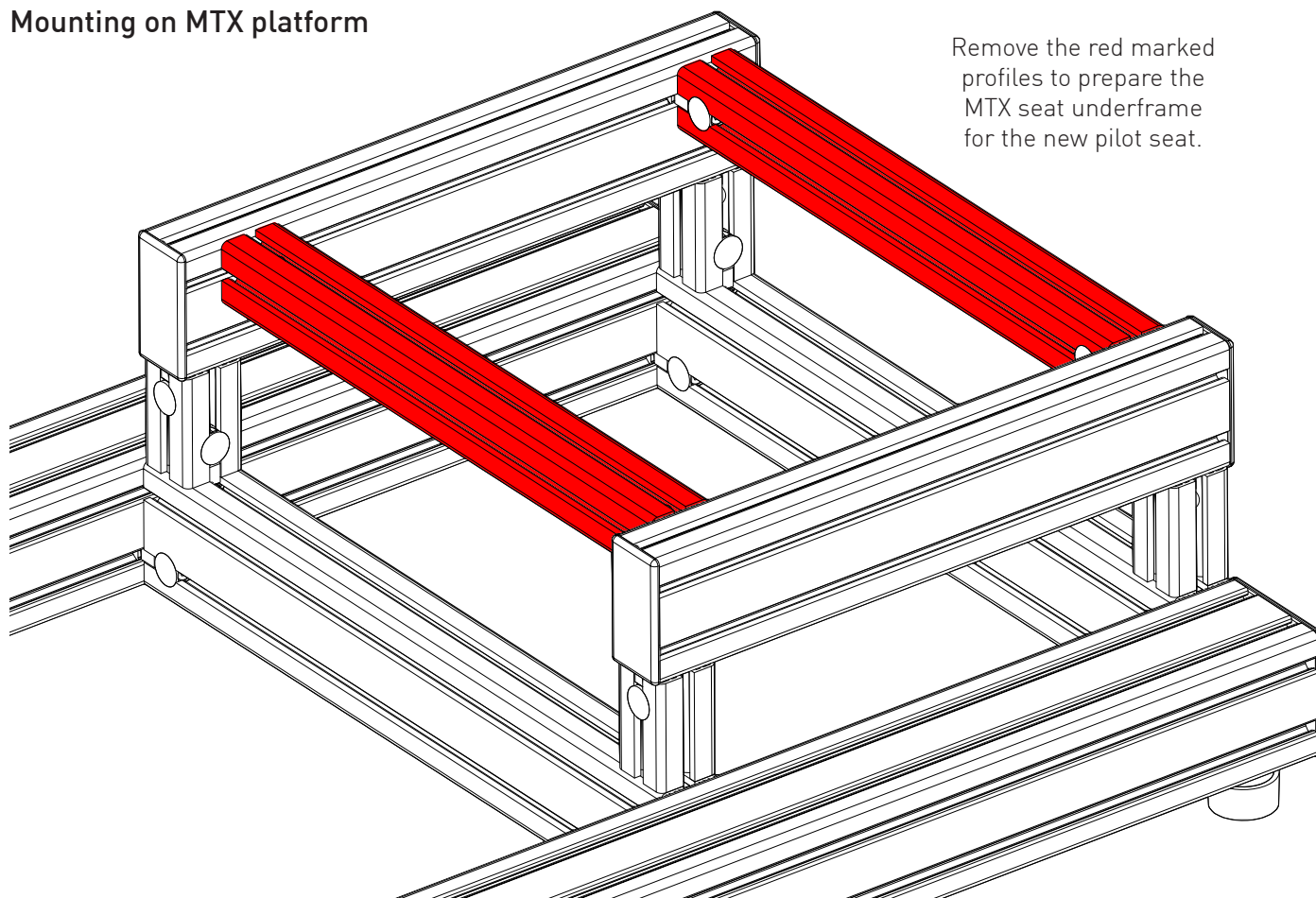



08-02-2023