

Original Floorstanding

Assembly Instructions

Tools Required:

- Socket Driver
- 10mm Spanner *or adjustable spanner

Sheet Code: BP-IM-047_REV5
Release Date: 14/05/2025

Copyright 2025 SpotSpot Ltd. (T/A Bouncepad) all rights reserved.
Confidential, no part of this publication may be reproduced or transmitted in any form without the written permission of the copyright holder.

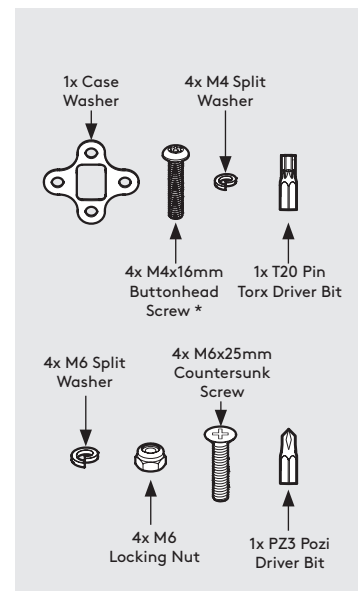
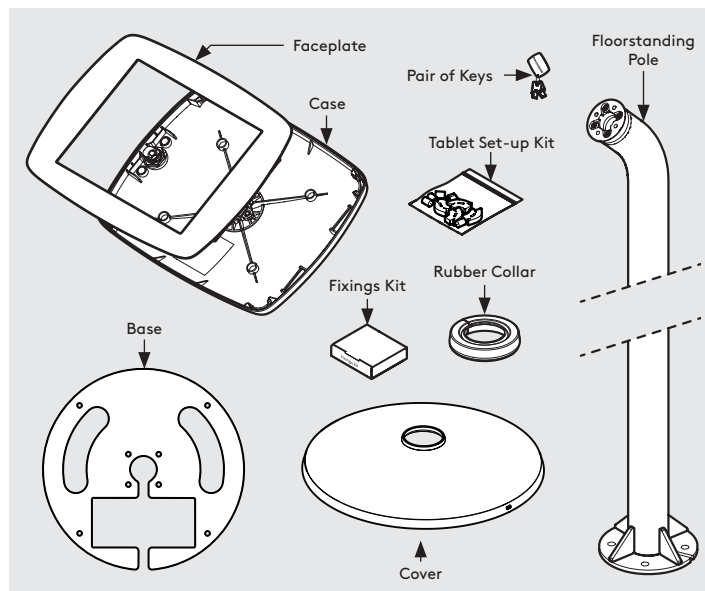

Fixings List
Due to the modular nature of our product range you may receive additional fixings in the fixings kit.
* Previous models may have been supplied with 20mm.

Tighten screw(s) using hand tools, using electric tools may damage your Bouncepad.

1 Orientate, locate & secure the Floorstanding Pole to the Base as shown. Ensure that all fixings are installed correctly.

2 Locate the Cover over the Floorstanding Pole.

3 Locate & secure the Case onto the Floorstanding Pole as shown. Tighten by hand.

4 Unlock & remove the Faceplate from the Case.

5 Feed the Power Cable through the Case & Floorstanding Pole.

6 Install the Tablet Setup Kit. Each kit is specific per Tablet & Case.

7 Install the Tablet into the Case & connect to Power Cable.

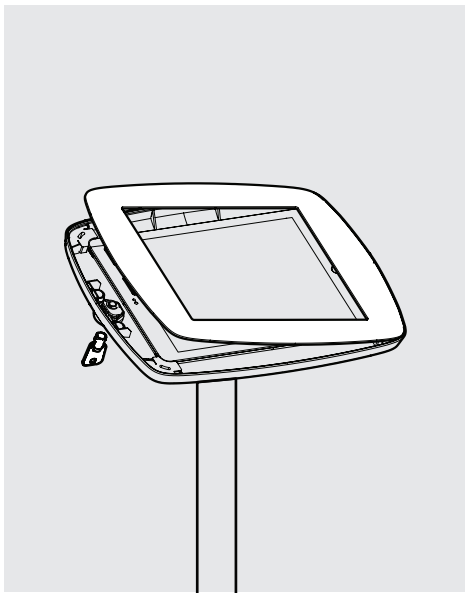

8

Locate & lock the Faceplate onto the Case.

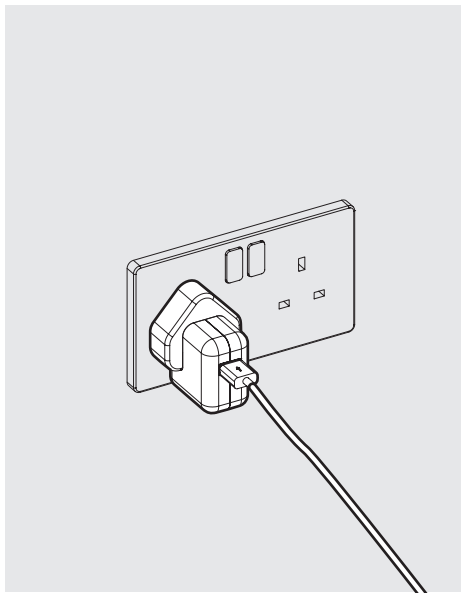

9.1

Connect the Power Cable to its mains power source.

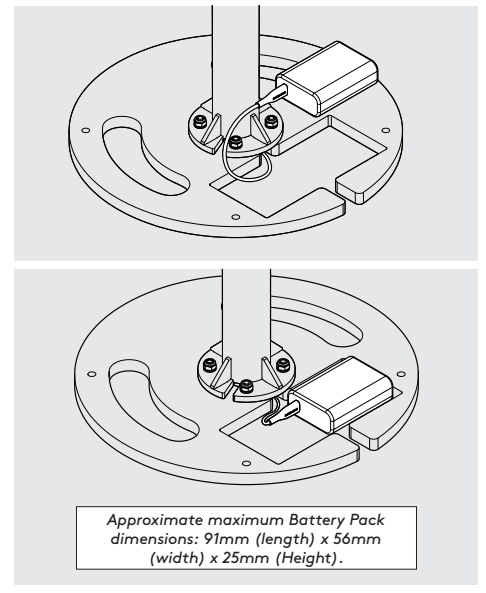

9.2

If installing a Battery Pack, connect the Power Cable & locate into the Base.

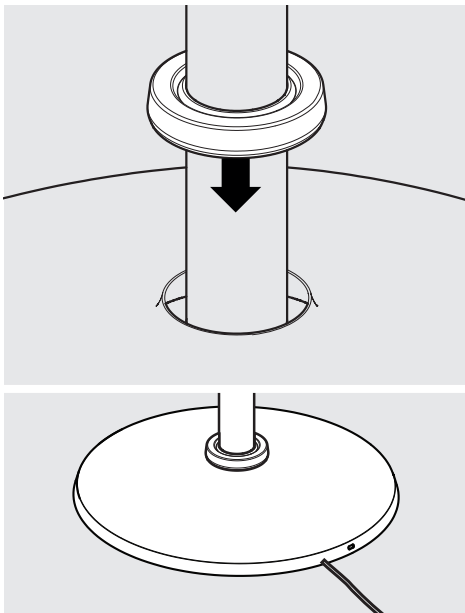

10

With the Cover on the ground, locate & fit the Rubber Collar.

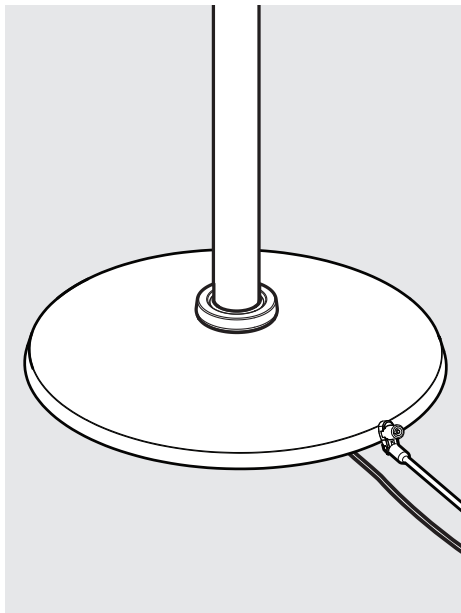

11

Use a Kensington® Microsaver product to tether to a secure object. (refer to your Kensington® instructions for full details)

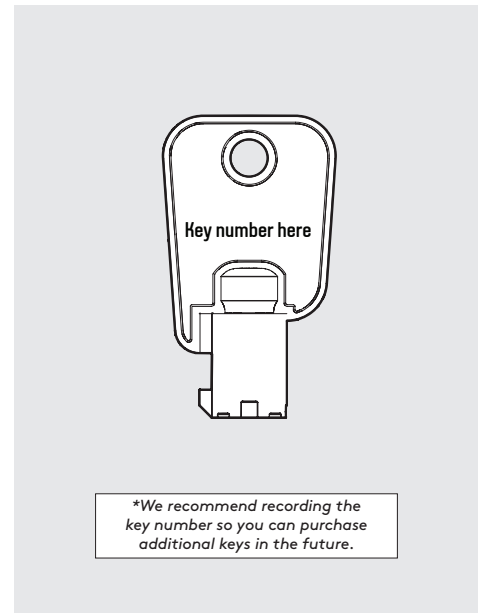

12

Installation is now complete.

Branding Mount

Assembly Instructions

Follow these instructions for the successful assembly of your Branding board to your Floorstanding.

Sheet Code: BP-OR-IM-011_REV2
Release Date: 01/04/2019

Copyright 2016 Spotsport Ltd. (T/A Bouncepad) all rights reserved. Confidential, no part of this publication may be reproduced or transmitted in any form without the written permission of the copyright holder.

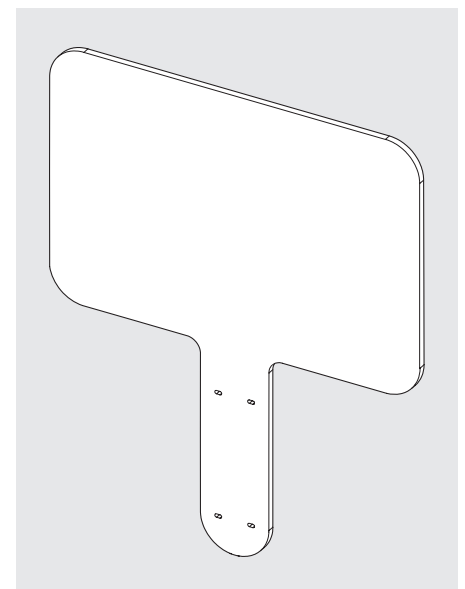
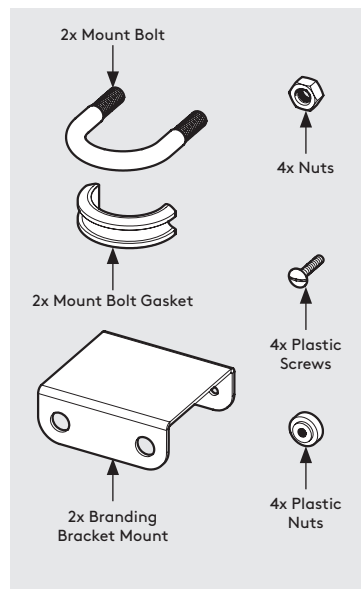
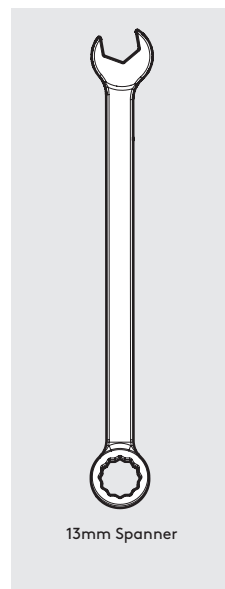

0

Tools required

0

Branding Mount - In the Box

A1

Follow 'A' steps if installing a Placard board

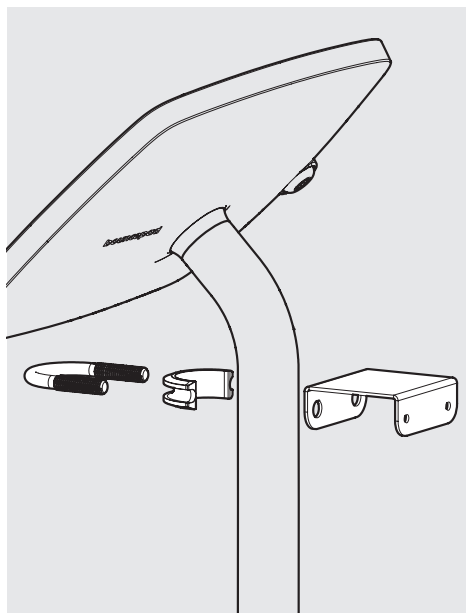

A2

Locate the top Bracket Mount & Mount Bolt to Floorstanding pole.

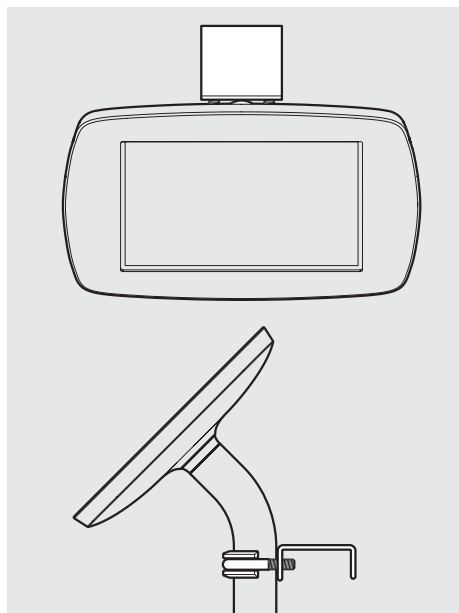

A3

Ensure that the Bracket Mount & Mount Bolt are positioned correctly as shown.

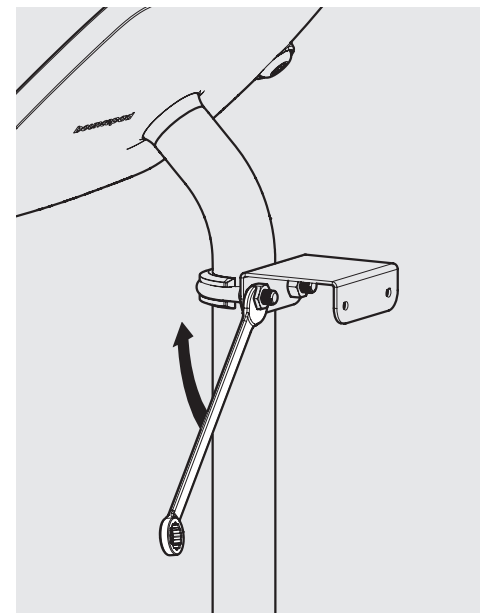

A4

Secure the Bracket Mount & Mount Bolt to the Floorstanding Pole with the supplied Nuts. Tighten evenly.

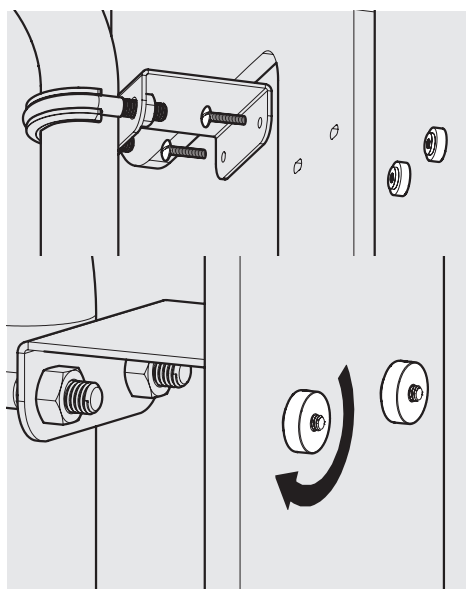

A5

Locate the Placard Board to the Bracket Mount. Secure with the supplied Plastic Screws & Nuts.

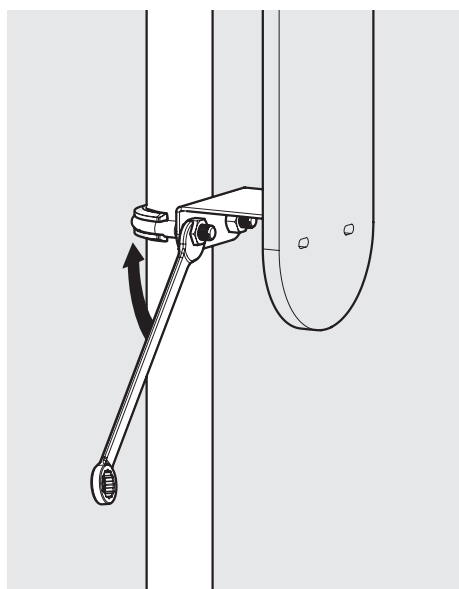

A6

Locate & secure the bottom Bracket Mount & Mount Bolt. Tighten the nuts evenly.

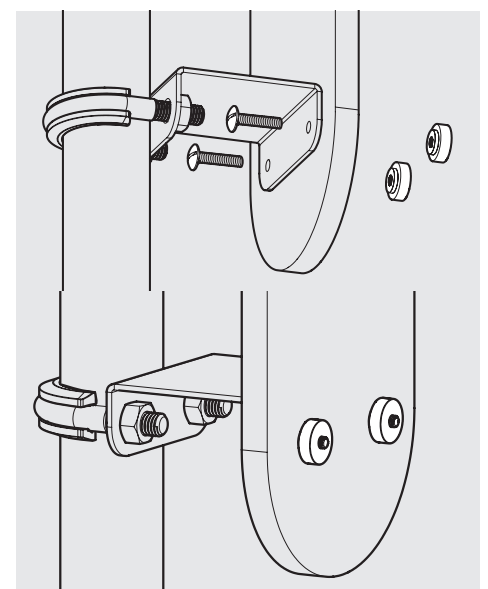

A7

Secure the bottom section of the Placard Board with the Plastic Screws & Nuts. Installation now complete.

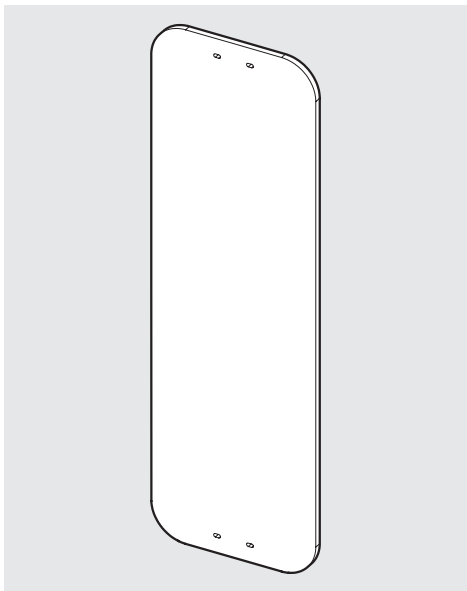

B1 Follow 'B' if installing a Front Board

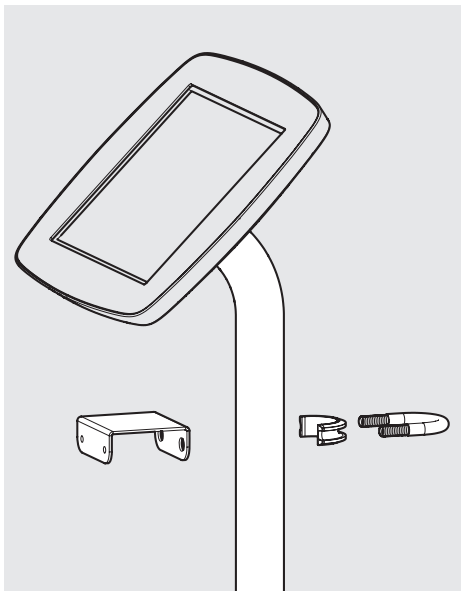

B2 Locate the top Bracket Mount & Mount Bolt to the Floorstanding pole.

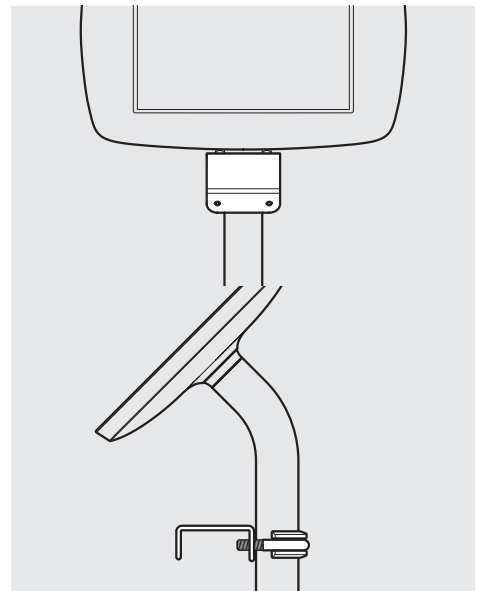

B3 Ensure the Bracket Mount & Mount Bolt are positioned correctly as shown.

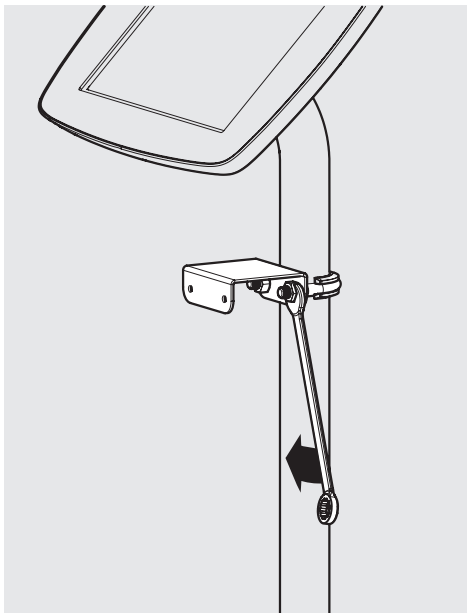

B4 Secure the Bracket Mount & Mount Bolt to the Floorstanding Pole with the supplied Nuts. Tighten evenly.

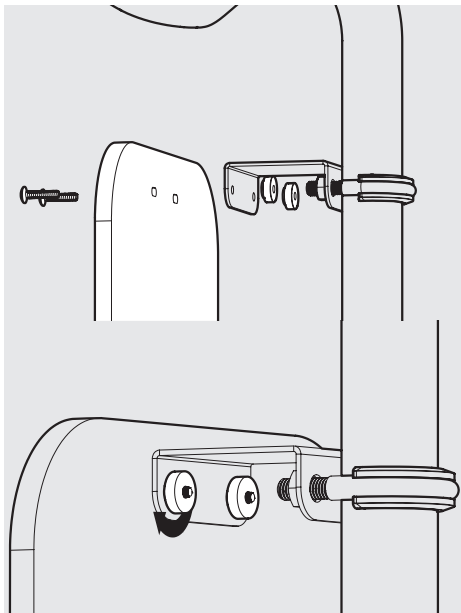

B5 Locate the Front Board to the Bracket Mount. Secure with the supplied Plastic Screws & Nuts.

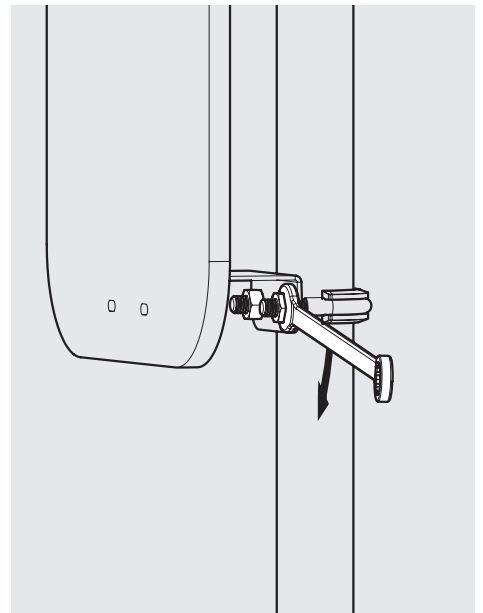

B6 Locate & secure the bottom Bracket Mount & Mount Bolt. Tighten the nuts evenly.

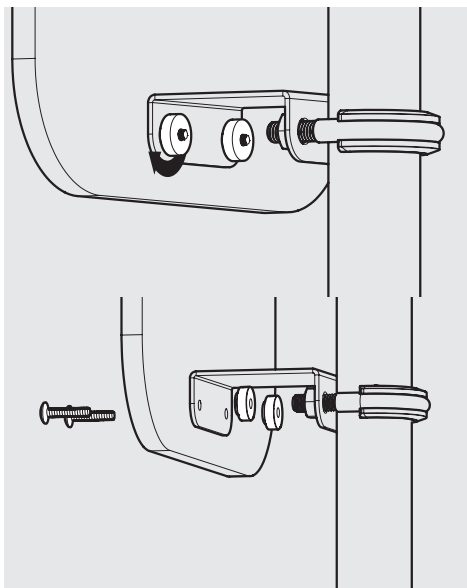

B7 Secure the bottom section of the Front Board with the Plastic Screws & Nuts. Installation now complete.