



## User Manual

Ver.2.5.4. Firmware

# Table of Contents

## **Safety Notes**

## **Introduction**

## **About the Product**

## **Part-names and functions**

## **Specification**

## **Hard-Disk Installation**

## **Connection**

1. Video & Audio output Connections
2. Connect to the Network
3. Connect to your PC

## **Remote Control Functions**

## **Settings**

HDD format on TV menu

HDD format on PC

Initial settings

Playback

A/V

Network

1. Wired LAN Setup
2. Wireless LAN Setup

System

Application

## **Major Function**

Favorites menu

Media Library menu

Recently Watched

Preview mode

Folder playback

Changing Main-menu background image

Sleep Timer

Viewing JukeBox information in Media Library

Folder Lock

Hide Locked Folders

# Table of Contents

## Using the Media Library

1. Movie Playback Function of Media Library
2. Photos Function of Media Library
3. Music Function of Media Library

How to use Music Jukebox in Photos slide-show?

Using Music Jukebox during slide-show

Using external subtitle files

Internet Radio

How to use the “Auto run” function

How to add Movie Subtitle TTF Fonts

DOCK-menu section

Compatibility list

Remote control function for DOCK

Docking the iPhone (iPad/iPod)

Checking the dock

Return to the Media Library

Return to the DOCK mode

Outdated iPod version (Not iOS)

iOS 4.x and the latest Apple devices.

How to watch a video recorded by iPhone

DOCK Audio Section

Audio-menu in DOCK

Accepting a call while playing an audio file on iXtreamer

DOCK Photos-menu

Using Audio and Photos simultaneously

Xtreaming

Internet

Using Xtreaming

Installation and Menu description

xJukeBox setup

Using xJukeBox

Using xVOD

File-manager menu

Using the File-manager

## Advanced Users Guide

Web Server

Web Server media-server

Usage of NAS (Network Attached Storage)

Web server Jukebox Application

Jukebox Web Server Application

How to use “iPhone remote” function

How to set-up Folder Sharing in Windows 7

# Table of Contents

English

How to set-up Folder Sharing in Windows Vista  
If folder accessing in window XP isn't available.  
How to configure Folder Sharing Permission in Windows XP  
How to register Network PC Shortcut  
You can't access a share on your network  
How to display "Guest" account "on" for Windows  
Firmware upgrade  
DOCK firmware upgrade  
Online firmware upgrade  
iXtreamer LED Status

## Troubleshooting

# Safety Notes

The following instructions are here to protect your safety and to prevent damage to your unit. Please read them before using out product.



## Warning

Violating these instructions may lead to serious injury or death.



## Caution

Violating these instructions may lead to injury or damage to the product.

English

## Instructions



Act prohibited



Contact by wet hand prohibited



Modification prohibited

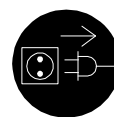

Power plug must be removed from power outlet

Do not connect a number of power plugs at the same time. (This may generate heat or cause fire.)

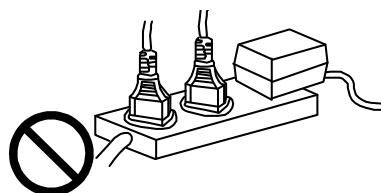

Do not forcefully pull out power cord. (Breakage of power cord may cause fire and electric shock.)

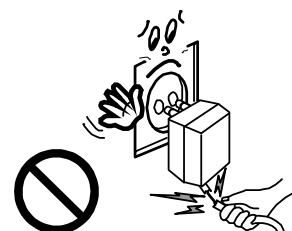

Do not insert or pull out power plug with wet hand. (This may cause electric shock.)

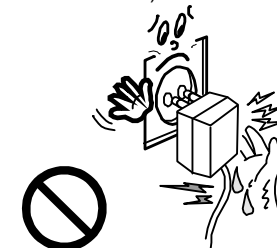

Do not insert power plug if it fits loose to power outlet. (This may cause fire or electric shock.)

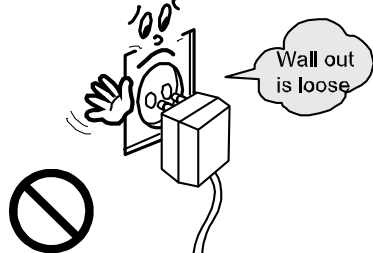

Make sure to turn off power switch and pull out power plug when moving product.

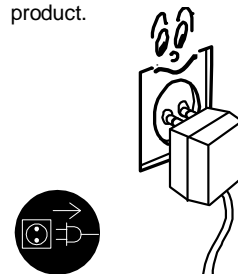

Do not place plant pots, cups or objects filled with chemical or water, etc. on top of product. (This may cause breakdown of product.)



Clean the outside of product by wiping it with lightly wet or dry towel. (Using detergent for grease removal, thinner or heavily wet towel, etc. may cause breakdown of product.)



Product must not be disassembled, repaired or modified. Take caution not to have foreign substances inserted into products. (This may cause breakdown of product or electric shock.)



Do not forcefully bend the connected power cord or have it pressed down by heavy objects. (This may cause fire or electric shock.)

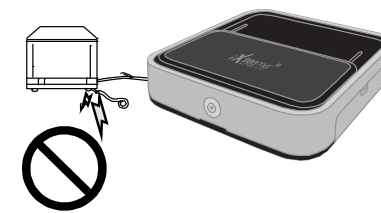

# Safety Notes

The following instructions are here to protect your safety and to prevent damage to your unit. Please read them before using out product.



## Warning

Violating these instructions may lead to serious injury or death.



## Caution

Violating these instructions may lead to injury or damage to product.

English

## Instructions



Act prohibited



Contact by wet hand prohibited



Modification prohibited



Soaking prohibited

Do not drop objects on top of product or exert impact to product. Keep product away from severe vibration or magnetic objects.)



Do not place plant pots, cups or containers filled with chemical or water, etc. on top of product. (This may cause fire/ electric shock. Falling of the objects may also cause injury.)



Do not place heavy objects on top of product. (Falling of objects may cause injury.)



Do not cover up product or install it in places with poor ventilation, such as a wall closet, etc

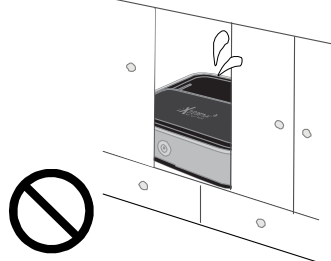

Install product in level and stable place. (Otherwise, product may not operate normally.)

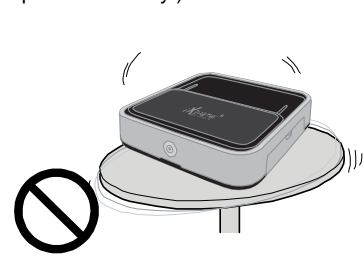

Product must not be disassembled, repaired or modified. Take caution not to have foreign substances inserted into products. (This may cause breakdown of product or electric shock.)



Do not install product in places where temperature is too high (35° or higher)/ too low (5° or less) or humidity is high

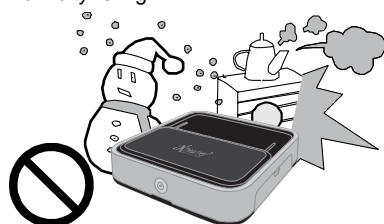

Do not install product under direct sunlight or near objects of heat, such as lit candle, cigarette or fire, etc.



Do not place product in water. (This may cause breakdown of product or electric shock.)



# Introduction

Congratulations on your purchase of the iXtremer Media Player, a state-of-the-art consumer electronic device that will enhance and enrich your home multimedia experience.

The iXtremer hybrid media player is based on the same successful platform as the models we introduced in 2010 which allow you to stream HD (MKV H.264) movies or user-generated videos, listen to high-quality digital music and show high-resolution slideshows of your family photos on your TV. The iXtremer is equipped with 1 normal size 3.5" HDD capacity of up to 3TB storage, double memory and iPhone/iPad dock that will allow you to enjoy your iTunes collection on TV.

With the iXtremer we are opening a new dimension to Media Players by connecting them to the wonderful world of Apple devices.

Due to the rapid development of our product we cannot possibly guarantee that this Guide will include all its features. So if you have questions please feel free to browse the Xtremer Knowledge base or contact our staff.

Please make sure to visit our site [www.xtremer.net](http://www.xtremer.net) for the Xtremer news, official announcements and firmware upgrade.

# About the Product

## Multimedia library

High Resolution HD-level File Play: iXtreameer supports the maximum of 1920X1080 progressive scan to provide clear and high resolution picture quality.

## Supporting Diverse Movie Format Types

iXtreameer supports a variety of HD files, such as TP, TS, TRP and M2T, M2TS, MTS files, but also MPEG1/2/4, Divx (3/4/5/6), Xvid, DAT, ISO, DVD (VOB, IFO) and MKV(X.264), AVC HD, WMV9, ASF, H.264, MOV, MP4, RMVB, FLV, etc. You can conveniently enjoy watching movies anywhere as long as you have access to a display device, such as TV, etc.

## Convenient Copy

iXtreameer allows you to copy a media file from and to a network-connected computer. Also, you can copy files by high-speed USB from a PC to iXtreameer HDD or to a USB storage device connected to iXtreameer.

## Supporting Diverse Music Files

iXtreameer supports a variety of music sources, such as AAC, MPEG audio MP1/2/3/A, WMV, WMA, FLAC, OGG, AC3 and DTS, etc. The player's fast forward and rewind functions allow you quickly navigate through your files.

## Digital Photo Album

iXtreameer supports the upgraded JPEG and BMP image files. The entire family can enjoy watching the files on your TV screen. Vertically photographed files can be rotated without requiring any modification.

## Network-shared File Play

Files shared on your home network can be played through wired or wireless connection without having to move them to the iXtreameer hard disk.

## NAS (Network Attached Storage)

iXtreameer can be used as a network drive in Windows with full SAMBA support.

## Supporting USB Host

iXtreameer supports 2 USB2.0 hosts. By connecting USB external storage devices, you can easily add additional storage to the iXtreameer and play the files on the external USB devices. A USB type memory card reader can also be used.

## Supporting UPnP client

iXtreameer supports UPnP server functions. iXtreameer supports free DDNS so that you can connect to the internal HDD of the Xtreameer not only from your local PC, but also from any PC with an Internet connection. This function can also be used from an external device that supports UPnP client.



# About the Product

## **Supporting High Resolution HDMI**

Built-in HDMI terminal for digital signal output enables you to enjoy video content with better picture quality.

## **5.1CH Audio Output and Down Mix Function**

iXtreamer provides 5.1CH Dolby Digital audio and DTS, etc. It can also downmix audio streams to 2 channels to play on a TV without requiring an additional decoding device, such as an amplifier (optical).

## **Supporting free DDNS**

iXtreamer provides 1 DDNS (Yourname.myxtreamer.net) to connect UPNP free Web Server that allows you to connect to your player from all over the world.

## **Supporting real-time YouTube access**

With iXtreamer you can search and play videos from YouTube without downloading them, find your favorite YouTube channels, playlists etc.

## **Internet**

Access Xtreamer section on the Main Menu to get access to hundreds of Internet streams and online channels as well as many Xtreamer community projects bringing you a variety of amazing online content and unique applications.

## **Internet Radio**

Enjoy a vast variety of styles and genres with our Internet-radio feature. Easily add any number of your favorite stations.

## **Easy access to your favorite files**

Add any file or folder to your Favorites for easy access via the Main-menu and create playlists that can be automatically run after startup.

## **iPhone\iPod\iPad dock**

iXtreamer has a truly unique ability to play all the media files stored on your iPod\iPhone\iPad on a TV or audio-system as well as charge your Apple device or upgrade its firmware.

## **iPhone\iPod\iPad control**

You can control your Xtreamer via iPod or any phone capable of connecting to your home network with a custom remote control application

# Part-names and functions

English



## Front Panel

- ① HDD cover
- ② Slide door
- ③ Power button and LED status
- ④ IR reception part

## Back Panel

- ① iPod connector
- ② Back Rest
- ③ USB host
- ④ USB slave port
- ⑤ 10/100Mbps LAN Port / USB host
- ⑥ HDMI terminal
- ⑦ Composite / Component terminal
- ⑧ Optical / Coaxial terminal
- ⑨ Power

# Specifications

English

Product Name	iXtreamer	
Processor	RTD1283DD(+) 400MHz Processor / 256MB DDR2 RAM, 256MB Flash RAM	
Operating System	Linux	
File System	FAT16/32 / NTFS / UDF / EXT2 / EXT3 / NFS / HFS / JFFS2	
Supported File & Formats	Video Formats	ASF / AVI / DIVX / FLV / IFO / ISO / M2P / M2TS / M2V / M4V / MKV / MOV / MP4 / MPEG / MPG / MTS / RMVB / TP / TRP / TS / VOB / WMV / BDMV
	Video Codec's	XVID SD/HD / MPEG1 / MPEG-2 (up to MP@HL1080i) MPEG-4 (ASP@L5, 720p 1-point GMC) H.264 ( <a href="#">High@L5.1</a> 16RefFrame) FLV (H.263) / FLV with VP6 (H.264) WMV9 (MP@HL) / VC-1 (MP@HL, AP@L3) / RTSP RealVideo 8/9/10, up to 720@30P / DVIX 3/ 4/ 5/ 6/ 7
	Audio Formats	AAC / AC3 / DTS / FLAC / FLC / M3U / M3U8 / M4A / MP1 / MP2 / MP3 / MPA / OGG / PCM / RA / RM / WAV / WMA / PLSX
	Audio Codec's	Dolby® Digital TrueHD / Dolby® Digital Plus / DTS HD MA / 7.1 down-mix / WMA Pro / MPEG I Layer 1, 2, 3 (Multi-Channel) LPCM, ADPCM, FLAC, AAC, WAV, and OGG Vorbis
	DownMix	DTS / DTS-HD MA / DTS-HD HR / Dolby D / Dolby TrueHD
	Pass through	DTS / DTS 96/24 / DTS ES / DTS-HD MA Dolby D / Dolby D EX / Dolby Pro Logic IIx / Dolby D+ / TrueHD
	Image	HD JPEG / BMP / GIF / PNG / TIFF / TIF / Progressive JPEG
Subtitle	SRT, SMI(SMIL), SUB, SSA, ASS, SUB+IDX, PGS(Blu-Ray) , MKV(Embedded)	
Video Output	HDMI 1.3a / Component / Composite	
Audio Output	Analog	Stereo RCA
	Digital	Optical (5.1ch) / Coaxial (5.1ch) / HDMI (7.1ch)
TV System	NTSC , PAL , HDMI Auto / FULL HD (1920x1080P) 50Hz, 60Hz, 24Hz	
Networking	Wired	Ethernet (10/100) LAN via RJ-45 Port
	Wireless	USB host port
Network Security	Wireless : WEP(Open mode, Share Mode) , WPAPSK, WPA2PSK, WPS	
Network Protocol	UPnP Server/ Client(AV), Web Server, NFS , FTP, SAMBA Server/ Client	
Hard-Disk Type	3.5" HDD Internal SATA I/II (up to 3TB)	
USB Interface	USB 2.0 Host x 2 USB Slave x 1 Dock Connector (iPhone / iPad / iPod : Apple 30Pin 5V, 2.1A)	
Power	DC 12V, 4A	
Dimension / FAN	242mm(W) X 251mm(H) X 66mm(D) / 50mm x 50mm x 10mm	

Specifications subject to change without prior notice

# Hard-Disk Installation

English



**01.** Open the hard disk cover

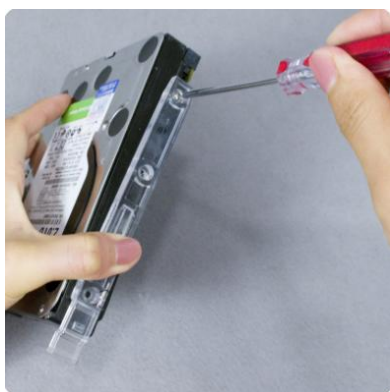

**02.** Connect the HDD guard to a SATA HDD as shown on the picture. Fasten the screws.



**03.** As shown here, slowly and carefully push the HDD guard together with the SATA HDD into the main body of iXtreamer



**04.** Close the hard disk cover.

# Connections

## Video & Audio Output Connections

### • HDMI cable connection

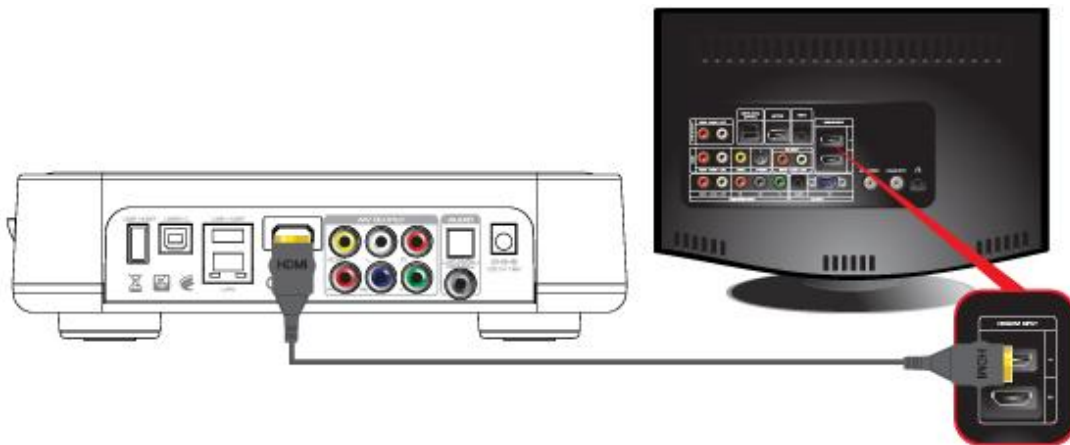

Connect HDMI cable to HDMI terminal at the back of product. Connect the remaining cable terminal to HDMI terminal at the back of a digital TV. Make sure to carefully distinguish between input and output terminals.

### • Composite cable connection

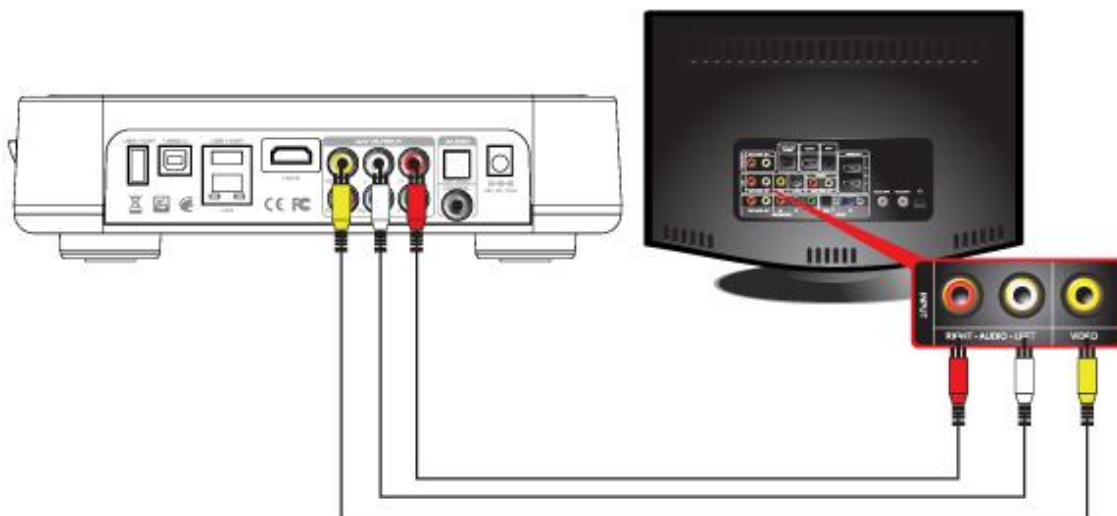

Connect yellow cable for video signal to the terminal located at the back of side of TV. Then, select external input of TV. Connect the remaining red and white terminal cables to the left/ right and audio output terminal at the back of the device. Then, connect red and white cables to the left/ right terminal of DTV input or component audio input located at the back of a digital TV.

# Connection

- **Component cable connection**

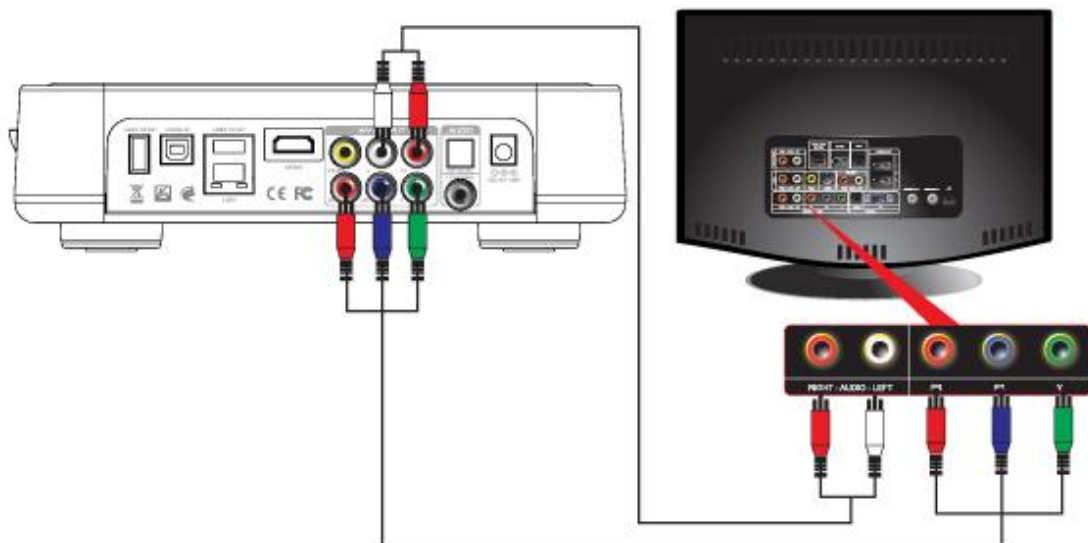

Connect the green, blue and red terminal cables to the iXtreamer and TV in accordance with the color scheme; connect white AV cable to L terminal, and red AV cable to R terminal. (Component cable is an optional item)

# Connection

## • Optical cable connection

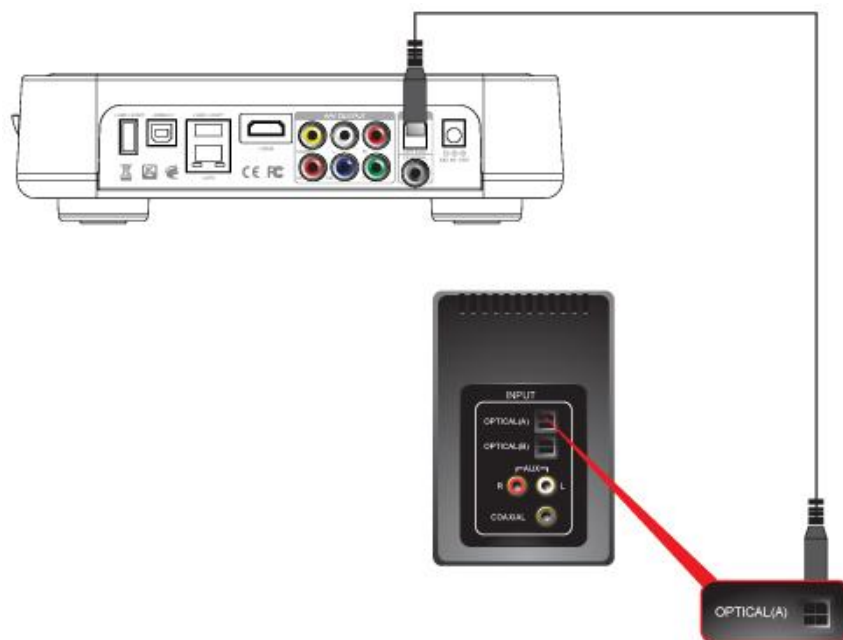

You can enjoy high-quality 5.1CH sound when connected to an amplifier or a receiver with optical cable. Connect optical cable to Optical port on iXtreamer as shown above. Then, connect to an amplifier or a receiver. ( Optical cable is optional )

## • Coaxial cable connection

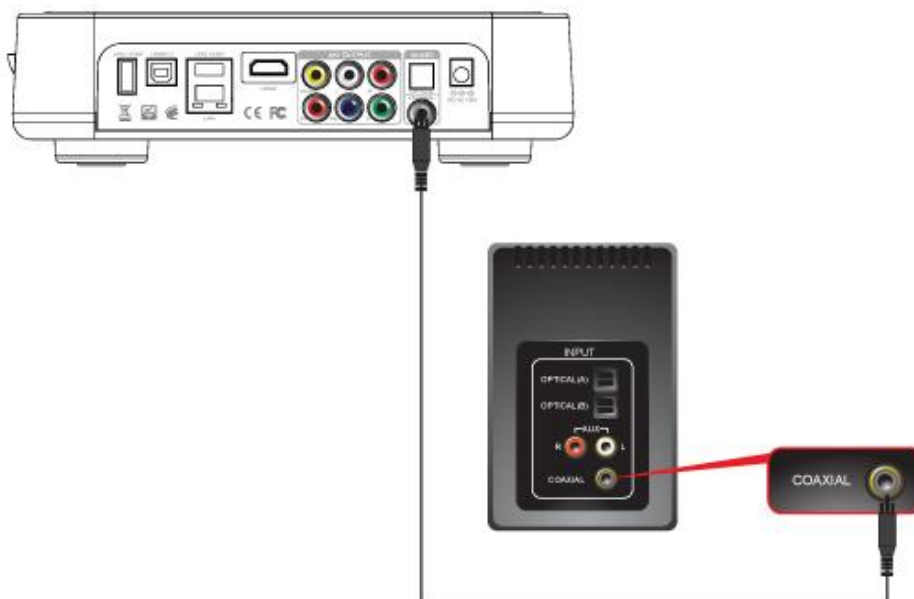

You can enjoy high-quality 5.1CH sound when connected to an amplifier or a receiver with coaxial output cable. Connect coaxial cable to coaxial port on iXtreamer as shown above. Then, connect to an amplifier or a receiver. ( Coaxial cable is optional )

# Connection

## Connect to the Network

### • Wired and Wireless Network

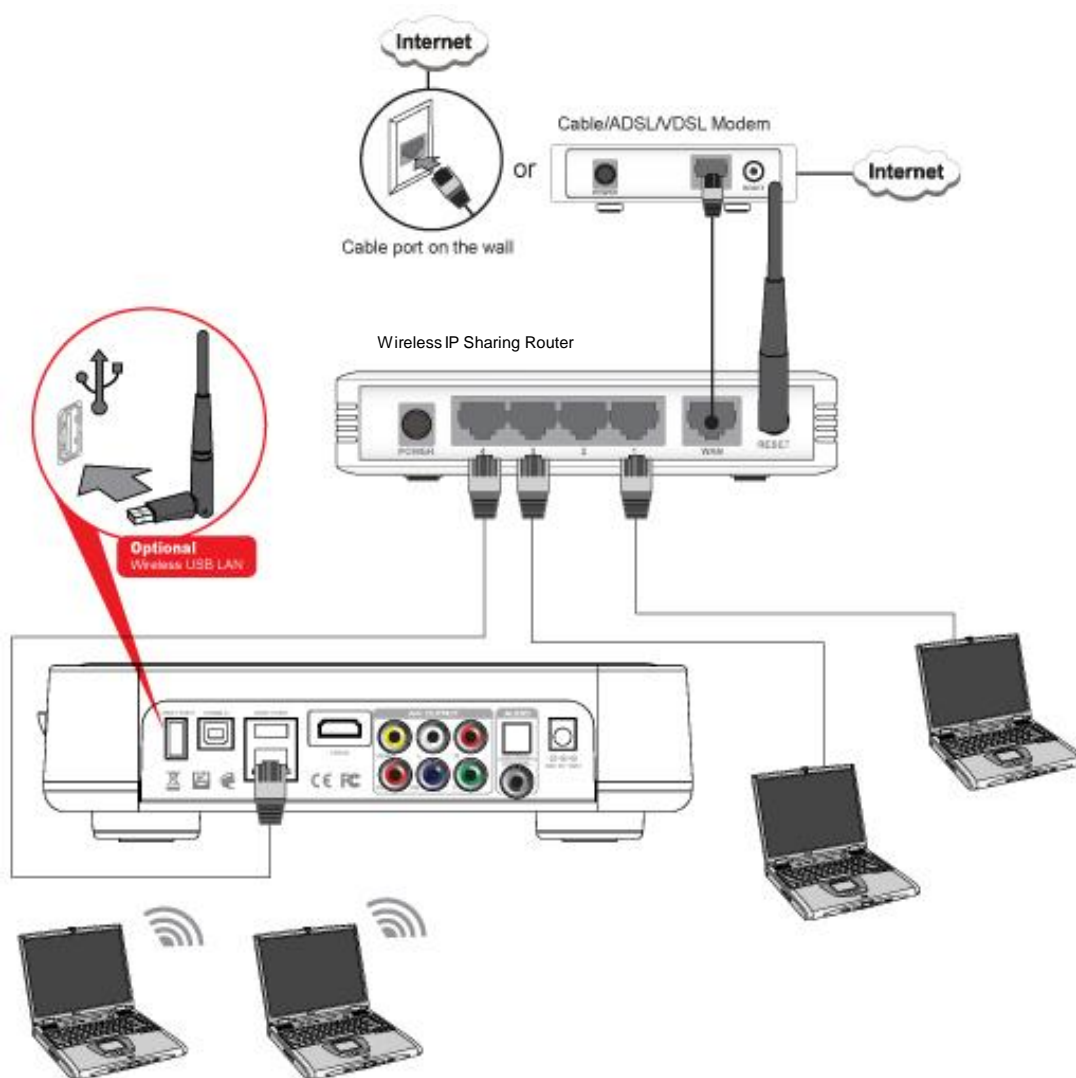



# Connection

## Connect to your PC

- **Connect the power adapter and USB cable (Slave connection)**

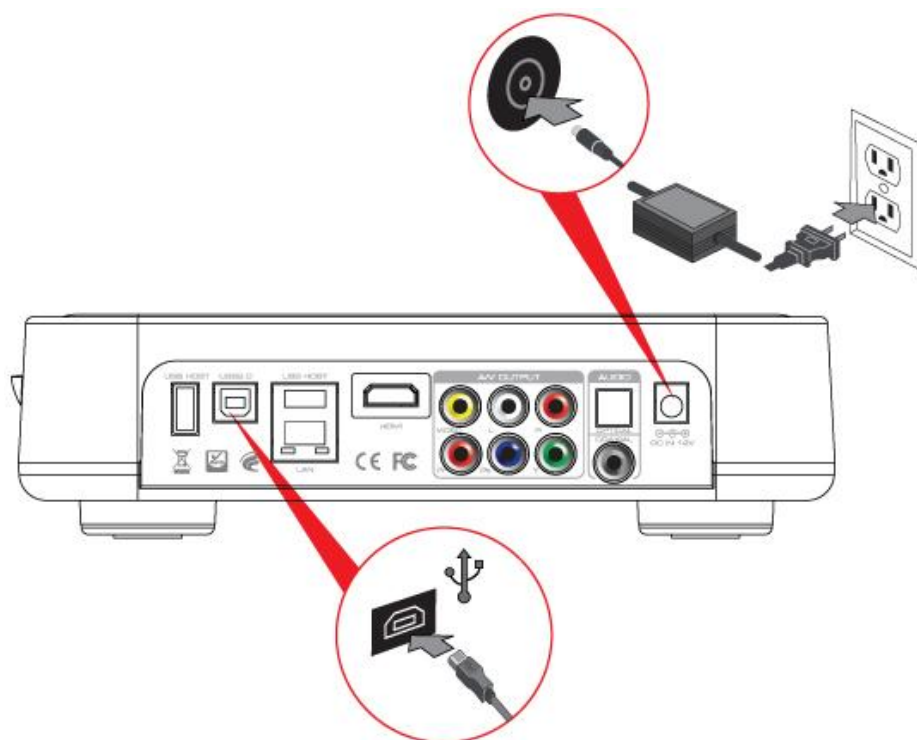

- **Disconnect the iXtreamer**

(1) Click on

(2) Disconnect



You must eject before disconnecting USB.  
If you don't eject before disconnecting you may loose data.

# Remote Control Functions

English





























# Remote Control Functions

English

1		POWER	Power on / off
2		DOCK	Changes to iPod (iPad) control mode, one more click switches to iXtreamer control mode.
3		iPod MODE	Shifts iPod mode (Currently, this function is supported for iPod touch and iPhone running iOS 4.0 or above)
4		iMusic	Shifts into iMusic mode (This function will be supported in the future)
5		EQ	Changes iPod sound output mode
6		Podcast	Shifts into Podcast mode (This function will be supported in the future)
7		F1	Adjust brightness of iPod movie
8		F2~F4	In the future updates these buttons will be used for additional iPod functions.
9		ADD	Add
10		EJECT	To add a selected media file to list / Eject for DVD
11		DELETE	Delete
12		ZOOM	To enlarge and reduce screen/ repeatedly pressing for adjusting zooming percentage/moving to position of enlarged output by using direction keys./ Setup the X,Y position on screen
13		GOTO	To select file in the same title or to execute shortcut to the already designated chapter position/shortcut to the desired time position
14		MENU	To change or set DVD file menus by moving to MENU screen during DVD(VOB) file play
15		SETUP	Function available when playing media file or using menu's in VIDEO IN screen to display various setup screens
16		FUNC	Opens a list of available functions
17		TVOUT	Toggle Video Output Modes and resolution (HDMI, AV) - double press
18		REFRESH	Refreshes the lists
19		PREVIEW	To turn on/ off preview screen automatically displayed in media play file search mode
20		BOOKMARK	Supports adding a file to bookmark and to show bookmark lists
21		INFO	To display the current status function available while playback / Open information of the movie playing

# Remote Control Functions

22		RETURN	Return to previous screen
23		NAVIGATION KEYS	To move the cursor and select files
24		ENTER	To confirm selection / play. When used to play a file toggles single-file playback.
25		PLAY/PAUSE	To play and pause a selected file. When used toggles consecutive (file-by-file) playback.
26		STOP	To stop playback
27		HOME	To return to the Main Menu.
28		PGUP	To move to previous chapter or file (list)
29		PGDN	To move to next chapter or file (list)
30		VOLUME	Volume adjustment
31		AUDIO	Option to change or select multiple audio tracks
32		SUBTITLE	Opens Subtitle browser
33		RWD/FWD	1.5x/2x/4x/8x/16x/32x speed, function available in movie files, mp3 as well sound output available in 2x speed
34		SHUFFLE	To change play sequence to shuffle
35		REPEAT	To repeat file in play or to repeat all media files in the corresponding folder
36		A-B	To set zone repetition
37		LED	Turns On/Off LED part of iXtreamer
38		SLEEP	Can be used to set the timer to turn off the player
39		16:9	Screen shifts into 16:9/16:10/4:3 ratio during playback
40		ANGLE	Used if Angle is supported in a DVD file.
41		MUTE	Mutes the sound
42		NTSC	Change output to NTSC
43		PAL	Change output to PAL
44		SYNC SUBTITLE	Adjust subtitle files to synch with a movie file(100ms/ 0.1sec)
45		EJECT	Eject disc
46		TITLE	Go to title menu (DVD-Video)
47		URL	This function will be supported in the future.
48		SEARCH	This function will be supported in the future.