

FFUUSS™



Installation instructions for the Ffuuss™ hand dryer

TROUBLESHOOTING.

IMPORTANT: TURN OFF THE ELECTRICAL SUPPLY TO THE ffuussTM BEFORE SERVICING IT.

Problem	Action	If the problems persist
The ffuussTM hand dryer does not start.	Make sure the ffuussTM hand dryer and the wiring are properly connected. Check that it is turned on.	Contact SPL Limited on office@splwashrooms.co.nz alternatively you can call 07 823 5790
The ffuussTM hand dryer starts and turns off erroneously.	Check that the infrared sensors are clean.	
Sometimes the ffuussTM hand dryer turns off when it is in use and then starts again after a while.	Check that the infrared sensors are clean and make sure the intake in the base is clean and is dust-free. If there is dust, remove it.	
The ffuussTM hand dryer continues to function after hands have been removed.	A 2 second delay after hands have been removed is acceptable.	
Air comes out of the front or the rear of the ffuussTM hand dryer.	Check there is nothing obstructing the air intake or outlet. If there is, remove it.	
The ffuussTM hand dryer is not drying hands properly.	Check that the infrared sensors are clean.	
The ffuussTM hand dryer works only for a couple of seconds and then it turns off.	Check there is nothing obstructing the air intake. If there is, remove it.	
Water accumulates in the base of the ffuussTM hand dryer.	Make sure the drain outlet is not blocked. If it is, clean and unblock it with the brush.	
The ffuussTM hand dryer reflects a red spot on the floor.	The water tank is full. Empty it and put it back. The red light will turn off.	
The ffuussTM hand dryer reflects a red spot on the floor and all the lights of the viewer are turned off.	Call or contact your distributor.	
The lights are on inside drying chamber but no air is blowing	Switch the hand dryer off at the wall, wait 30 seconds. Turn power supply back on and wait 6 minutes to allow for the recalibration of capacitive sensors.	

Table of contents

Warranty3
General Information5
Technical Specifications.....6
Installation Instructions.....7
Troubleshooting18

IMPORTANT INFORMATION—PLEASE READ BEFORE PROCEEDING:
TO ENSURE THE CORRECT FUNCTION OF THE FFUUSS HAND DRYER

After installing the unit or each time the unit is restarted after an electrical disconnection, an automatic calibration of the capacitive sensors is performed which lasts for 6 minutes. In order that this calibration is performed correctly, the unit should not be handled, activated or any object be brought close to its near vicinity, during this time.

SUPREME COMPREHENSIVE WARRANTY

Your Supreme Hand Dryer is fully guaranteed against defective materials and faulty workmanship commencing from the date of sale (according to SPL's records), subject to it being installed and maintained in accordance with the manufacturer's instructions.

SPL (2021) Limited warrants that should any part of the dryer fail within the given warranty period (2- 5 years product dependant), it will be remedied by SPL. The dryer should be returned to SPL (2021) Limited for all warranty claims. The cost of cartage will be payable by the customer.

This warranty excludes:

- Incorrect installation, or installation that does not specifically follow the installation guidelines supplied.
- Failure to follow manufacturer's maintenance instructions.
- Damage/Failure resulting from:
 - ◆ the use of non-authorised parts
 - ◆ authorised parts not installed in accordance with the manufacturer's instructions
 - ◆ accidental damage, negligent use, misuse, vandalism, neglect
 - ◆ damage caused either directly or indirectly by external sources - power outages, power surges, incorrect power supply, natural disaster, or insect infestation
 - ◆ water ingress caused by property maintenance or flooding
 - ◆ negligent cleaning practices (water ingress, harmful chemical etc)

The above includes consequential damage to any other goods, furnishings, or property.

- Normal wear and tear and consumable parts (HEPA filters, UV C Lamps, fuses, motor brushes etc).
- This warranty does not displace any statutory warranty in relation to the dryer but any liability of SPL (2021) Limited under any statutory warranty will be limited to a replacement or repair of the dryer or payment of the cost of such replacement or repair at the sole discretion of SPL (2021) Limited.

Note: Our Warranty only extends to products purchased and installed in New Zealand.



It is advisable to clean the filter every time the ffuuss™ hand dryer receives external maintenance. It is recommended the HEPA Filter is replaced 12 monthly or more frequently in high use situations.

It is also advisable to clean the water pipe hole with the brush every time the ffuuss™ hand dryer is cleaned. We recommend a monthly maintenance routine consisting of cleaning the surfaces, air intake (filter) and emptying and cleaning the water deposit.



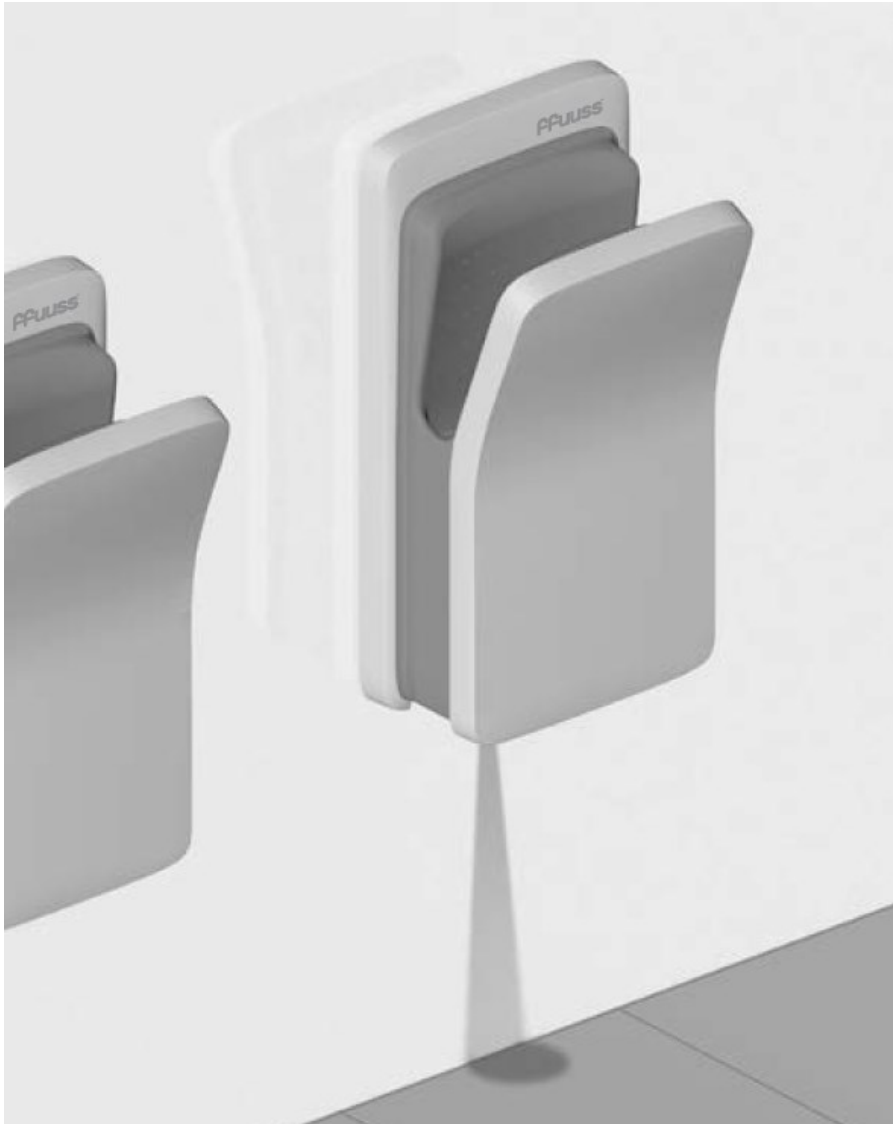

When a red spot is reflected on the floor, this means that the water tank is full. Empty the tank and clean it of any possible dirt. Put the tank back. Once the tank is empty, the red light will disappear.



GENERAL NOTES

The instructions included in the attached installation manual must be followed carefully when installing a ffuussTM hand dryer.

ffuussTM will not be liable for any damage to property or personal injury or death resulting from non-compliance with the instructions contained herein and in the installation manual.

Make sure your ffuussTM hand dryer works properly before allowing the public to use it.

Do not use the ffuussTM hand dryer for any purpose other than drying hands.

Using authentic ffuussTM spare parts can extend the correct and safe functioning of your unit.

WARNING

This product may contain substances known to the State of California to cause cancer, birth defects or other reproductive problems. Wash your hands after installing or repairing the ffuussTM hand dryer.

HOW TO USE

Place hands between the infrared sensors at the top of the ffuussTM hand dryer to activate the machine and the air outlet. Keep hands in the drying zone until the cycle ends.

CLEANING THE DEVICE.

Surfaces.

Only clean the surfaces of the ffuussTM hand dryer with a damp cloth. Do not use abrasive or caustic products.

MAINTENANCE ADVISE.

Air intake.

Check the air intake through the base of the ffuussTM hand dryer regularly and make sure that it is free from dust, dirt or any other particles. Also make sure that all the surfaces of the ffuussTM hand dryer and the infrared sensors are properly cleaned to ensure the correct functioning of the ffuussTM hand dryer.

TEST

Make sure the power supply is connected to the ffuussTM hand dryer. WAIT 6 MINUTES. Place hands between the infrared sensors at the top of the ffuussTM hand dryer to activate it and the air outlet. Keep hands in the drying zone until the cycle ends. Remove hands from the ffuussTM hand dryer and it will turn off automatically.

IMPORTANT INFORMATION

After installing the unit or each time the unit is restarted after an electrical disconnection, an automatic calibration of the capacitive sensors is performed which lasts for 6 minutes. In order that this calibration is performed correctly, the unit should not be handled, activated or any object be brought close to its near vicinity, during this time.

Technical Specifications

Electric system	
Input voltage:	220-240 V
Nominal power:	1100 W
Electric current:	5 A
Type of motor:	Universal with Preheat*
Motor speed:	23000 RPM
Working temperature:	40 °C/104 °F
*: Air Preheat feature patented by ffuusSTM	
Manufacturing	
Cover material: ABS	
Treated with Biomaster Silver Biocide antibacterial additive	
Finish: Various colours	
Mounting mooring: Galvanized steel	
Water inlet protection: IPX2	
HEPA H13 filter: Optional	
Operation	
Automatic activation by infrared	
Hand drying time: 15 seconds	
Blocking time: 25 seconds	
Airflow: Up to 73 l/s	
Logistics	
Net weight: 7.3 Kg	
Assembled weight: 8.8 Kg	
Box dimensions (mm): 690 / 360 / 285	
Regulations	
This unit complies with the following the European Directives/normatives:	
1999/5/CE 2004/108/CE 2006/95/CE 2002/96/EC 2011/65/EC UL-499 CSA-C22.2 N°113	
Others	
This unit has  technology	
Standard warranty	
Supreme	

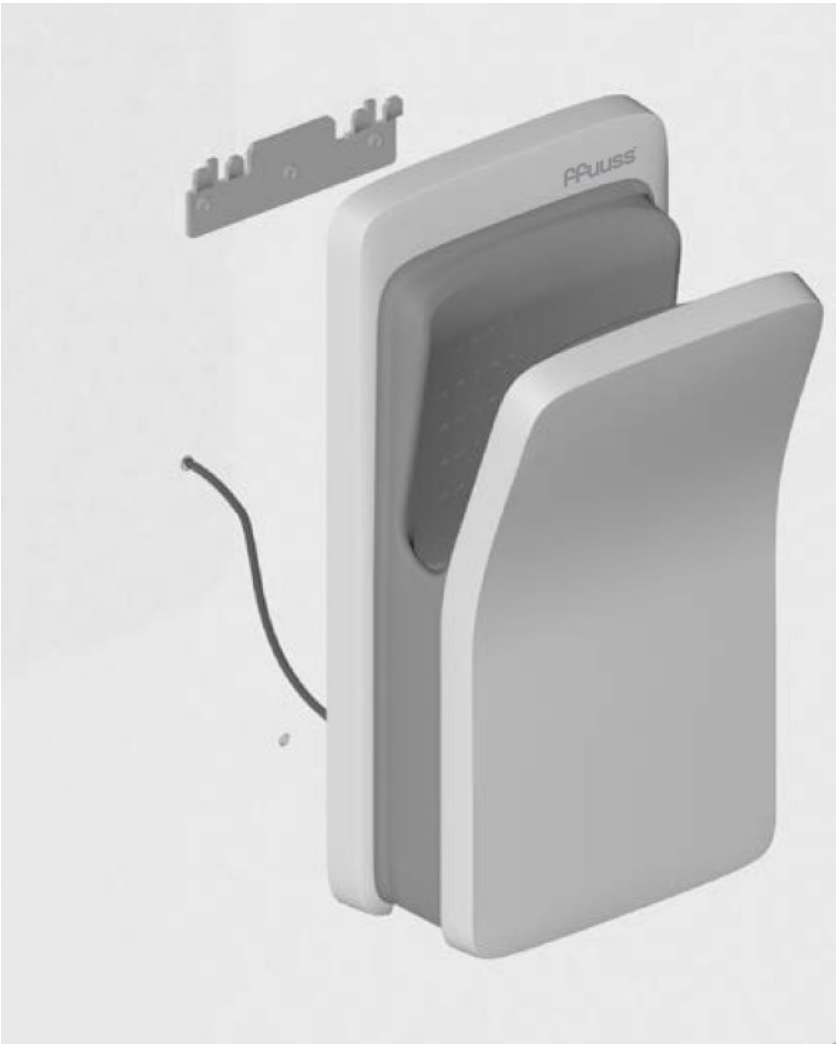

Place the ffuusTM hand dryer on the wall bracket, remove the air intake filter and fix the unit via the inner hole. Insert the filter and connect the unit.

To assist with attaching to the wall mount , firstly locate the two mounting tabs on the bracket in the hand dryer back plate recesses.

While pushing the top of the machine lightly down and back, just rock the complete machine right and left.

When the dryer locates correctly then the wall bracket tabs will pull the machine back to the wall, if you have a gap between the dryer and the wall then it is not located correctly.

Remember to lock the machine in position with the screw through the bottom moulding as per the picture below.





After installing the cable, screw the cover closed.



INSTRUCTIONS FOR INSTALLING THE ffuuss™ HAND DRYER ON THE WALL

Important safety information. Read before proceeding.

The installation and electrical wiring work must be undertaken by a qualified person or persons in accordance with all applicable codes and standards, including fire prevention.

WARNING:

Before starting any installation work, you must check the following:

The installation must be designed to be able to disconnect the device with a disconnection element separating all the contact points by at least 3mm.

Make sure the electricity supply has been disconnected or turned off before starting installation to avoid electrocution or electric shock.

Make sure there are no pipes (gas, water, air) electric cables, wires or ducts directly behind the drilling areas.

Before accessing the interior of the device, make sure you disconnect the power.

WARNING:

Risk of electric shock!

Do not remove the cover or attempt to repair unless qualified personnel are servicing the unit. If the cover is removed or handled incorrectly, the internal elements of the ffuuss™ hand dryer may cause damage or become permanently damaged.

WARNING:

In order to avoid the risk of fire or electric shock, do not expose the elements and the internal mechanisms of this unit to rain or humidity.

Check the power supply matches the specifications on the plate located in the back of the unit.

If this unit is connected to any power supply different to the one specified on the specifications plate of the unit, this may result in permanent damage to or the unsafe and incorrect functioning of the ffuuss™ hand dryer.

All wiring and electrical work must be performed by a qualified electrician in accordance with the rules and applicable federal, state and local laws, including fire prevention.

Fixed wiring should incorporate a switch or breaker with contact separation of at least 3mm in all poles.

These instructions must be read carefully before trying to install the ffuuss™ hand dryer.

Not following the installation instructions exactly may result in the malfunction of the ffuuss™, damage to property or even personal injury.

ffuuss™ shall not be liable for property damage or personal injury that may result from failure to comply with these instructions.

Not following these instructions will void this product's warranty. See the user section for warranty details.

WARNING:

The ffuuss™ hand dryer has a built-in pre-heat* system that delivers energy savings and, therefore, does not have a Stand-by function.

*Air pre-heat feature patented by ffuuss™.

WARNING

Safety and use:

Children over 8 years can use this hand dryer ffuuss™, as well as people having reduced capabilities (physical, sensorial, mental) but only in the case they had received proper surveillance and training on the use of the equipment, in order to make them understand what is the safe use of the hand dryer ffuuss™ and its potential dangers.

Children should always be under the supervision of an adult to avoid them playing with the device. An adult must carry out cleaning and maintenance of the equipment.

This equipment has been designed for efficient and quick hand drying. Do not attempt to dry any other part of the body.

WARNING:

To reduce the risk of fire, electric shock or personal injury, follow the steps detailed below:

1- Use this unit only as instructed by the manufacturer. If in doubt, contact the manufacturer or agent.

2- Before cleaning or servicing the unit, make sure the power supply is off by disconnecting the fixed wiring to the ffuuss™ hand dryer to ensure the machine is not switched on accidentally or to avoid an electric shock that may occur during its repair or maintenance.

3- Any installation or wiring work must be undertaken by qualified personnel in accordance with the codes and standards in force.

4- When cutting or drilling into the wall, do not damage the electrical wiring or other hidden services.

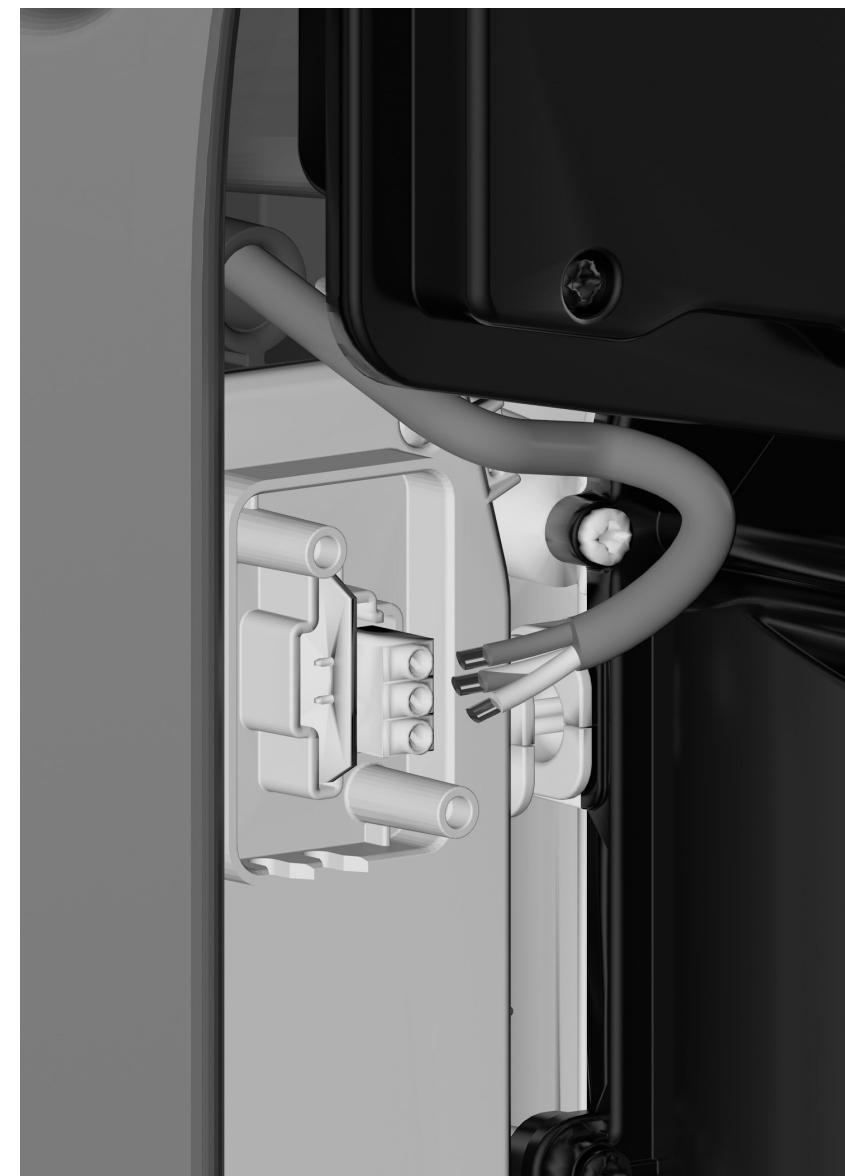

Once the cable has been passed through the hole, connect each end to its respective terminal, placing each one in the right path and then close the box.

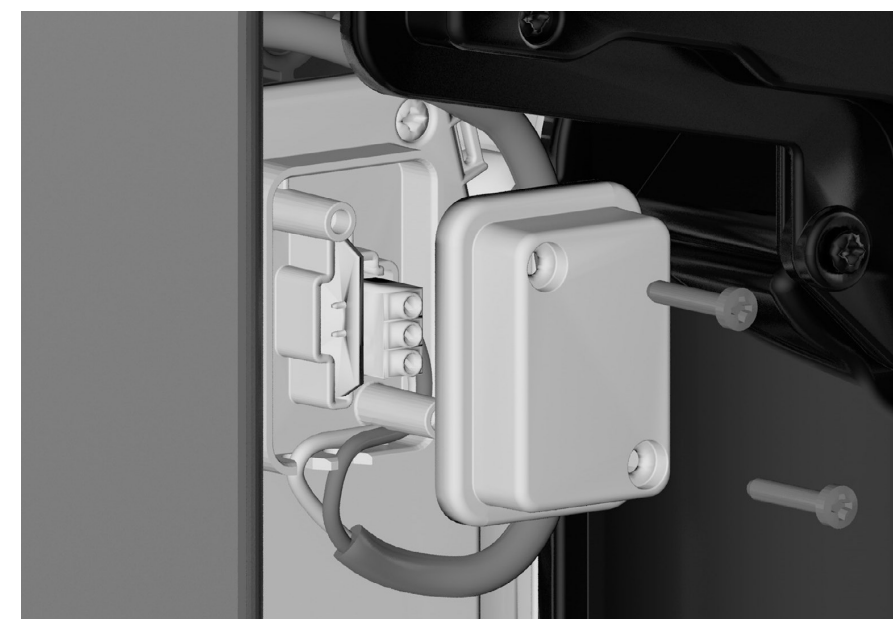

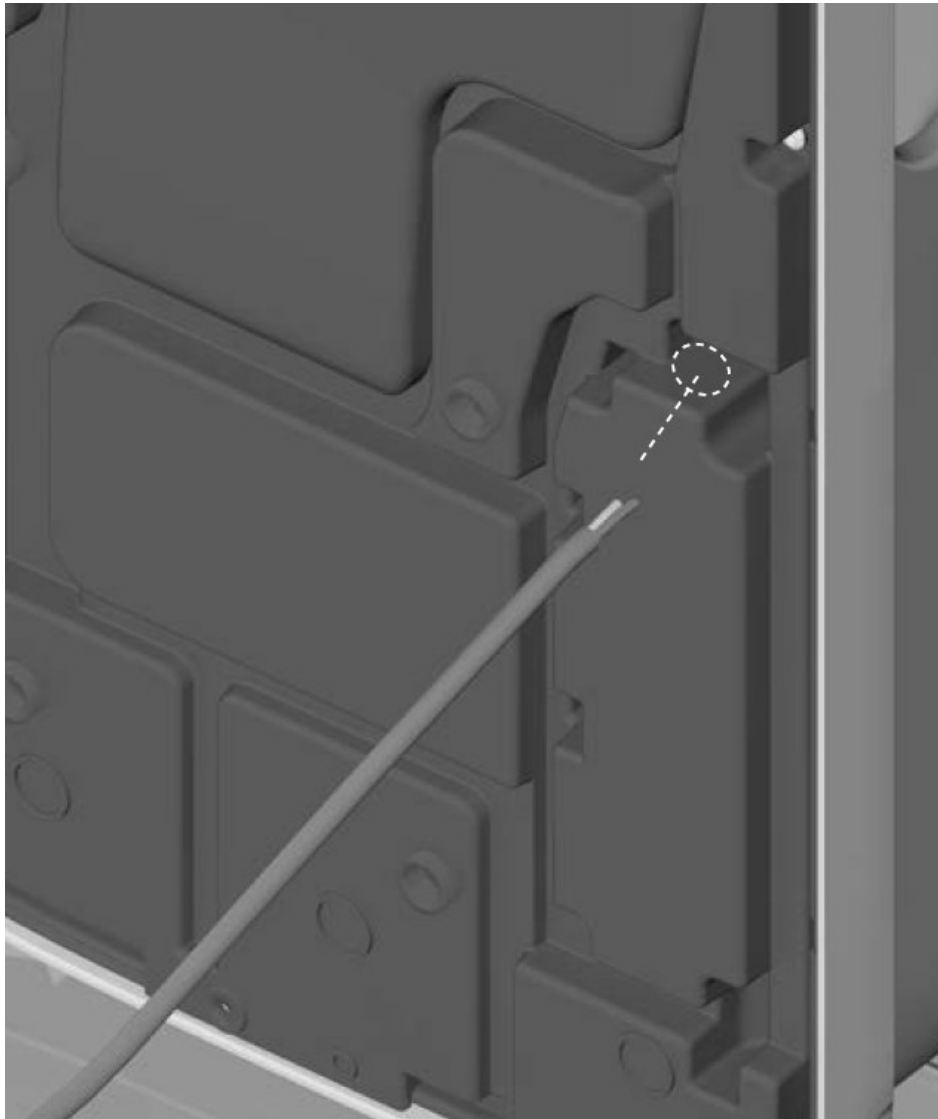

Introduce the electricity cable through the hole at the rear and pull it out from the front.



Place the hand dryer ffuuss™ template against the wall where it will be installed and make the holes according to the diagram. Check beforehand if there is a direct cable to the electricity network or if the hand dryer has to be connected using a plug.

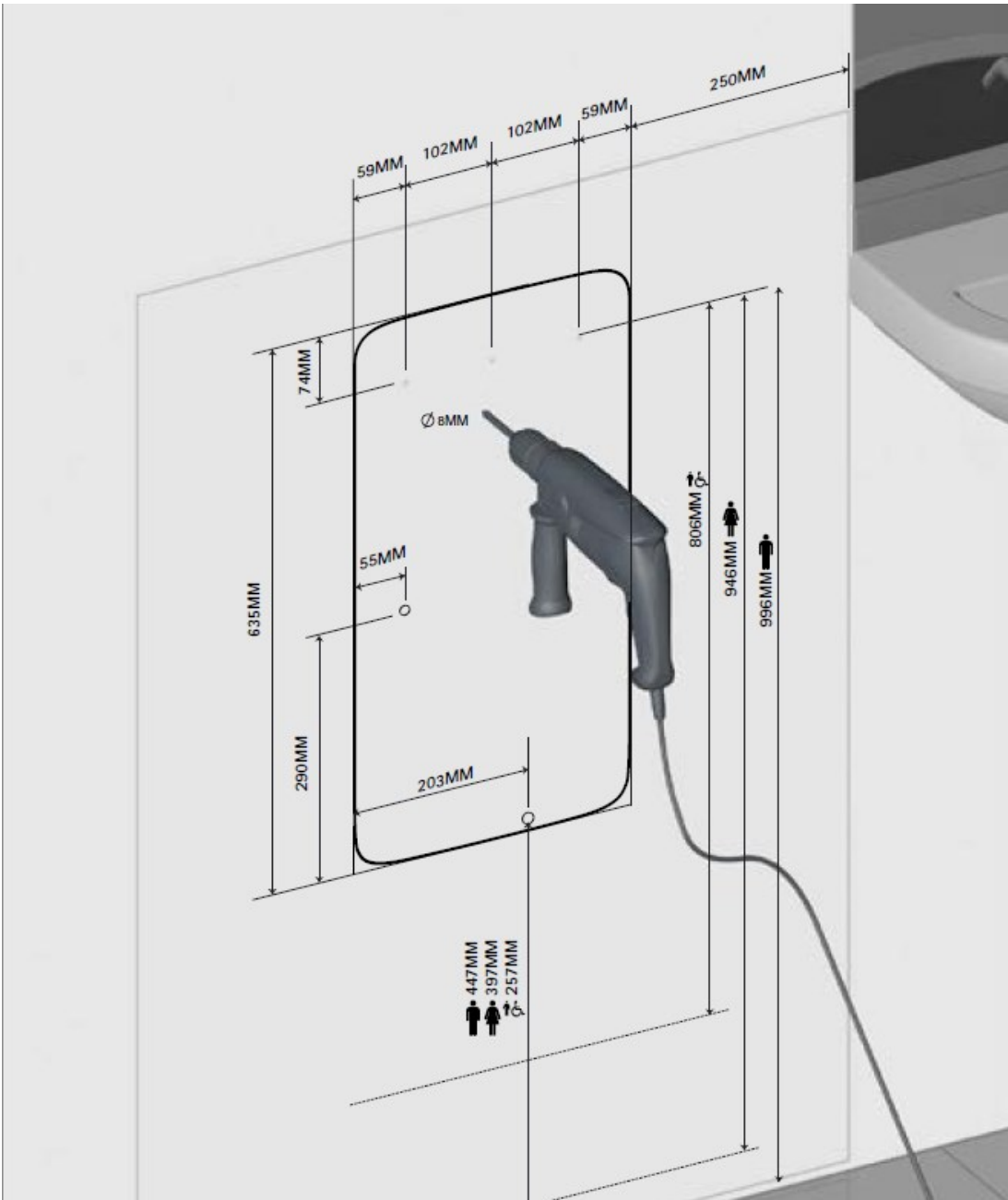

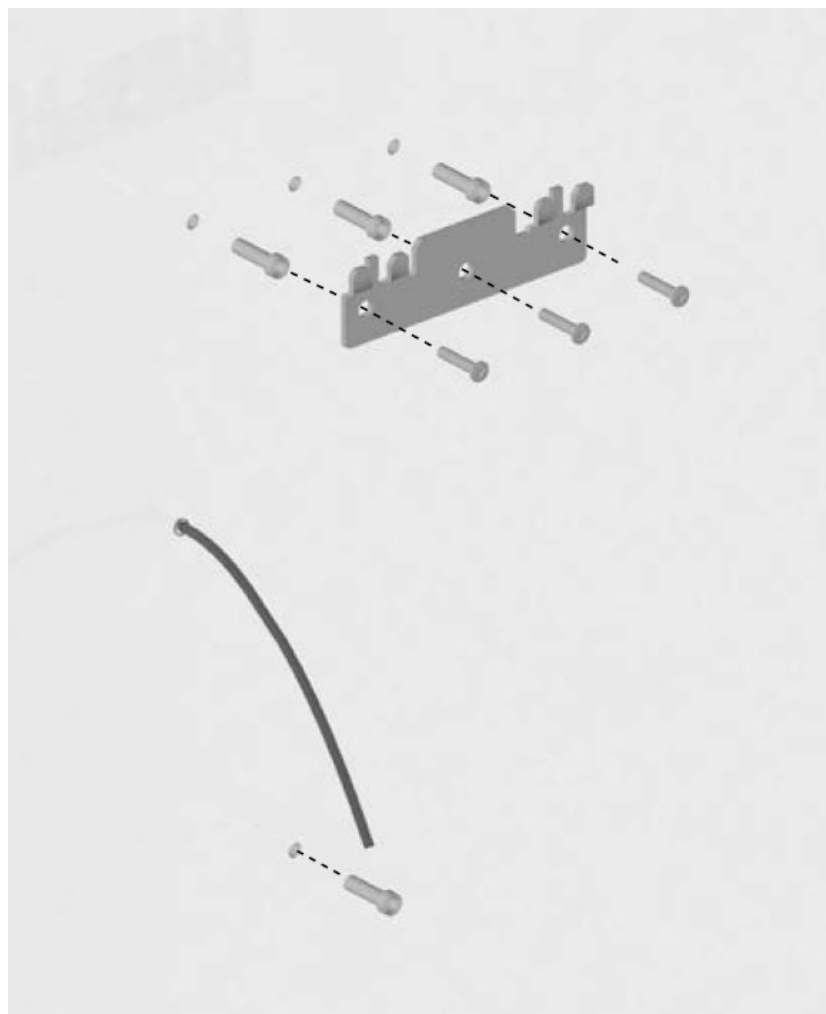

Once the marks have been made, attach the mounting bracket to the wall and prepare the cable to the electricity network.

ADDENDUM TO MOUNTING INSTRUCTIONS

To assist with attaching correctly to the wall mount, firstly locate the two mounting tabs on the bracket in the hand dryer back plate recesses.

While pushing the top of the machine lightly down and back, just rock the complete machine right and left.

When the dryer locates correctly then wall bracket tabs will pull the machine back to the wall, if you have a gap between the dryer and the wall then it is not located correctly.

Remember to lock the machine in position with the screw through the bottom moulding.

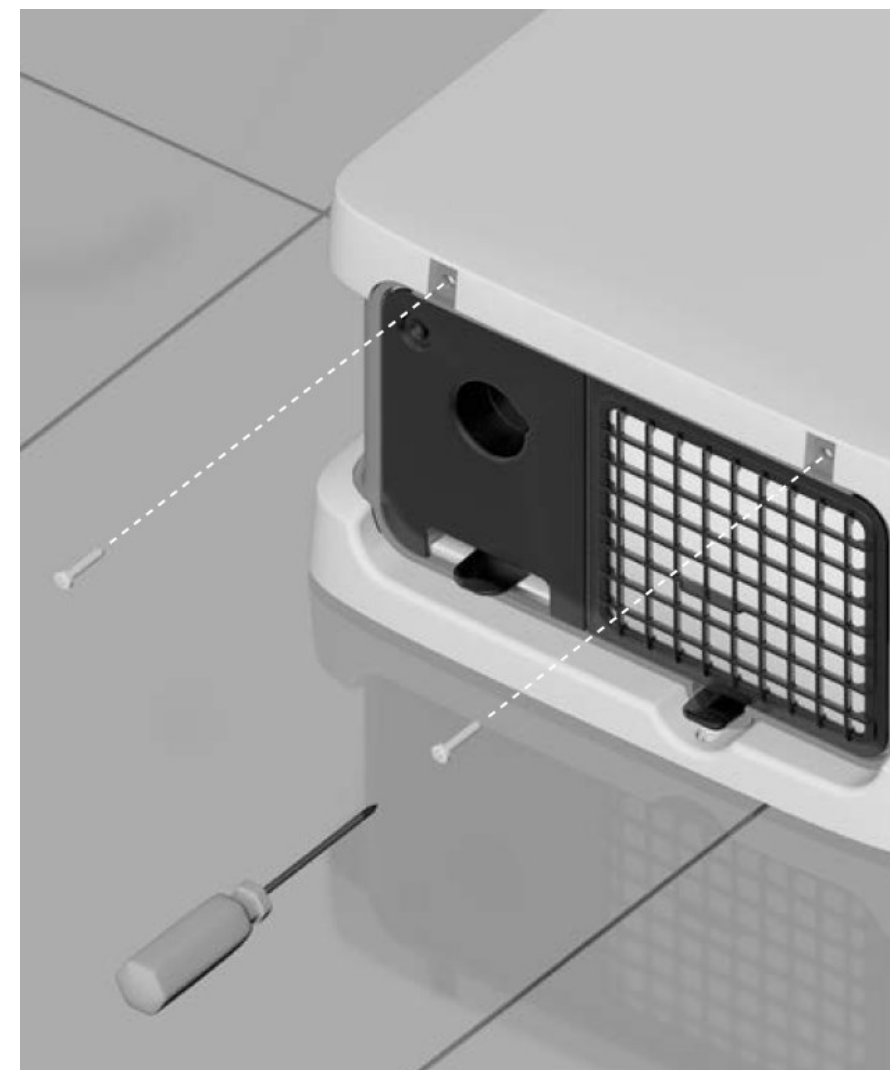

Take the ffuuss™ hand dryer from its packaging and open the front cover to install the electricity cable. Open the cover of the connector box which is where the cable to the network will be installed.

