

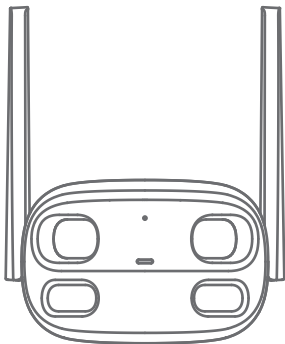

Be Secure, Be Botslab



Botslab Outdoor Dual-Lens Camera Quick Start Guide

Table of Contents

English.....	P01-P17
--------------	---------

Packing list

Please check whether the main unit and all accessories are complete upon unpacking.

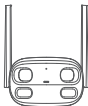

camera host x 1

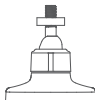

bracket x 1



screw pack x 1



warning
sticker x 1



Quick Start
Guide x 1



positioning
sticker x 1

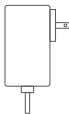

power
adapter x 1



screwdriver x 1

Due to ongoing updates and iteration of the product, there may be slight differences between the physical and schematic diagrams. Please refer to the actual products for the most accurate information.

Product appearance

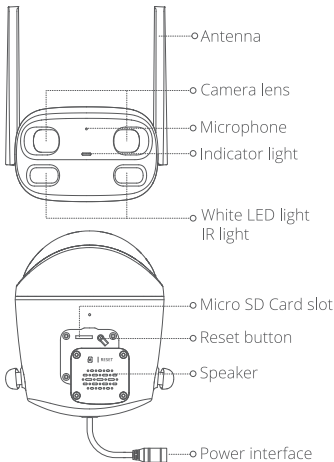

Memory card: Maximum 256GB

Guideline for Connecting to the Network

Download and install the APP

Method 1: Scan the QR code below with your mobile phone to download and install the **Botslab** APP.

Method 2: Search and download the **Botslab** APP from App Store or Google Play, and then install it.



Scan to download
Botslab APP



Connection Guide

- Before using the app to add a camera, please refer to the following diagram and connect the camera according to the prompts below.
- Connect the camera to the power supply.

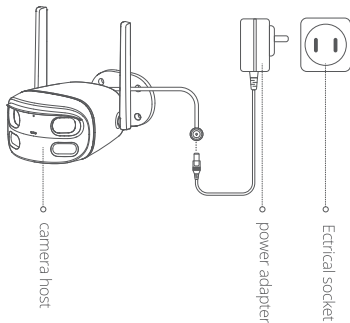

i If the indicator light slowly flashes green, this indicates that the device is ready for setup. If the indicator light does not flash green slowly, please press and hold the Reset button at the bottom of the camera for 3 seconds. Once you hear a "beep" sound, it indicates that the network configuration information has been cleared, and you can proceed with the next step.

Add the Device

Open the Botslab app, click the Register button to register a Botslab account. If you already have an account, click the "Login" button, and enter your account and password to log in.

Method 1

After logging in, Bluetooth will automatically search for the camera by default. Once the camera is found, add the device according to the prompts.



i When connecting to the network, please make sure that Bluetooth is enabled on the mobile phone and that the WiFi is properly connected.

Method 2

After logging in, click the "+" button on the upper right corner of the homepage, select "Scan" and use your mobile phone to scan the QR code on the camera. This will direct you to the network setup page. Follow the prompts to add the camera.

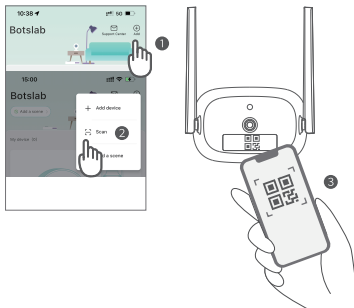

Method 3

After logging in, click the "+" button in the upper right corner of the APP homepage and add the "Botslab Outdoor Dual-Lens Camera W302" by model.

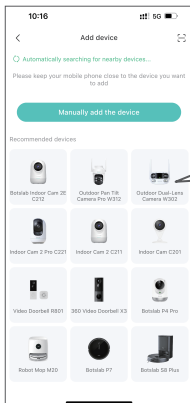

Outdoor Dual-Lens
Camera W302

Installation Guide

Installation method

1. Please use the original adapter to prevent overvoltage and overcurrent from damaging the product.
2. Pay attention to outdoor lightning protection measures.

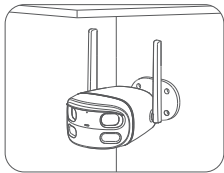

Wall-mounted
installation

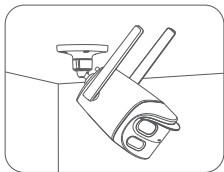

Ceiling
installation

Antenna Installation and Adjustment

When the antenna is parallel to the camera, it can affect signal reception.

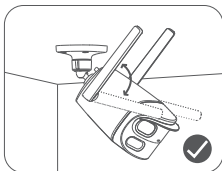

Example of correct antenna position

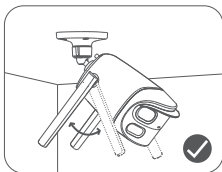

Example of correct antenna position

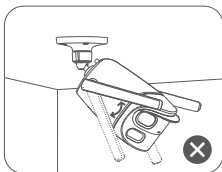

Example of incorrect antenna position

Installation Bracket

1. Attach the positioning sticker to the wall and drill a hole according to the position shown in the diagram.
2. Insert the expansion bolt into the wall at the positioning sticker's hole position.
3. Fix the bracket base with screws.

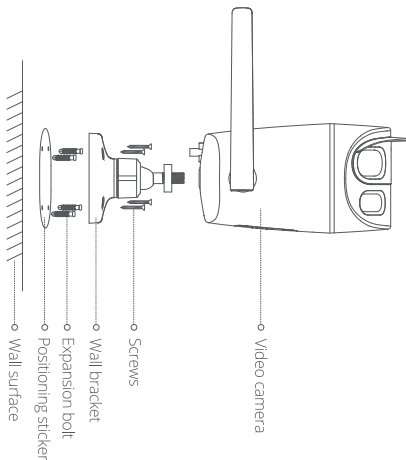

Installation of the Camera

1. Rotate the camera body and screw it into the bracket.
Adjust the camera position, and view the image's fixed position through the app.
2. Tighten the bracket by rotating the nuts and bracket base.
3. Adjust and unfold the antenna to the appropriate position.

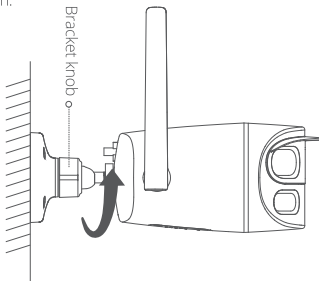

Precautions

1. To achieve better night vision imaging results, keep the lens front or side away from reflective objects such as glass and white walls. This will prevent nearby objects from appearing too bright while distant objects may appear dark or white.

2. Place the device in a location with good network signal reception and keep it away from metal objects (such as metal brackets, metal doors, and windows) or other sources of signal interference.
3. It is normal that the equipment generates heat during operation
4. This product is designed to operate within a temperature range of -20°C to +60°C. Do not use this product in environments that are too hot or too cold.
5. Please use the original power cord to ensure safety of power supply and good user experience.

Working Status Description

Indicator light status	Meaning of indicator light
Solid blue	Camera is online
Slowly flashing blue	The camera video is being viewed
Solid green	The device is bound but offline
Quickly flashing green	Device upgrade in progress
Slowly flashing green	Waiting for network configuration/ Camera is offline

The manufacturer reserves the right to adjust the product's functional status through firmware upgrades or software adjustments.

Important Statement

Personal information security

For the safety of you and your family, please make sure that the products you purchase are not bound to any unauthorized person. Botslab will take strict measures to protect the information security of you and your family.

Description of Hazardous Material Contents

Component	Hazardous substances and elements					
	Lead (Pb)	Mercury (Hg)	Cadmium (Cd)	Hexavalent Chromium (Cr (VI))	Polybrominated Biphenyls (PBB)	Polybrominated DiphenylEthers (PBDE)
Plastic enclosure	○	○	○	○	○	○
Circuit board components	×	○	○	○	○	○
Power cable	×	○	○	○	○	○
Adapter	×	○	○	○	○	○
Lens	○	○	○	○	○	○

This form is prepared in accordance with SJ/T11364.

○ :It indicates that for each item in this part, the hazardous substance is below the requirements set forth by the standard GB/T26572.

×

:It indicates that the hazardous substance in at least one homogeneous material of this part exceeds the limit specified in GB/T26572. However, it satisfies the limit requirements specified in the List of Exempt Applications of Hazardous Substances Identified in the Management Catalog.



Remarks: The lead content in a small number of special-purpose SMT electronic components (such as high-voltage resistors, ceramic resistors, diodes, etc.) in the part labeled "x" in the above table may be $\geq 0.1\%$. The lead content in screws or cores of data cables can be $\geq 0.1\%$ due to the adoption of high-performance alloy. These components are in compliance with exemption clauses of the EU RoHS Directive. At this stage, due to the limitations of the global technological development level, there is no alternative technologies and parts, and the lead content of the external contactable parts of the product meets the environmental protection requirements.

FCC Statement

This device complies with Part 15 of the FCC Rules. Operation is subject to the following two conditions:

- (1) This device may not cause harmful interference.
 - (2) This device must accept any interference received, including interference that may cause undesired operation.
2. Changes or modifications not expressly approved by the party responsible for compliance could void the user's authority to operate the equipment.

Note: This equipment has been tested and found to comply with the limits for a class B digital device, pursuant to Part 15 of the FCC Rules. These limits are designed to provide reasonable protection against harmful interference in a residential installation.

This equipment generates uses and can radiate radio frequency energy and, if not installed and used in accordance with the instructions, may cause harmful interference to radio communications. However, there is no guarantee that interference will not occur in a particular installation. If this equipment does cause

harmful interference to radio or television reception, which can be determined by turning the equipment off and on, the user is encouraged to try to correct the interference by one or more of the following measures:

- Reorient or relocate the receiving antenna.
- Increase the separation between the equipment and receiver.
- Connect the equipment into an outlet on a circuit different from that to which the receiver is connected.
- Consult the dealer or an experienced radio/TV technician for help.

The device has been evaluated to meet general RF exposure requirement. The device can be used in portable exposure condition without restriction.

ISED Statement

This device contains licence-exempt transmitter(s)/receiver(s) that comply with Innovation, Science and Economic Development Canada's licence-exempt RSS(s). Operation is subject to the following two conditions:

1. This device may not cause interference.
2. This device must accept any interference, including interference that may cause undesired operation of the device.

This equipment should be installed and operated with a minimum distance of 20 cm between the radiator and your body.

Le présent appareil est conforme aux CNR d'Industrie Canada applicables aux appareils radio exempts de licence.

L'exploitation est autorisée aux deux conditions suivantes :

- (1) l'appareil ne doit pas produire de brouillage, et (2)
- l'utilisateur de l'appareil doit accepter tout brouillage radioélectrique subi, même si le brouillage est susceptible d'en compromettre le fonctionnement.

Cet équipement doit être installé et utilisé avec une distance minimale de 20 cm entre le radiateur et votre corps.

After-Sales Service

Warranty policy for Botslab Video Doorbell

This product comes with a one-year Local Warranty Service. For detail of warranty service, please kindly contact local Authorized Distributors in your country.

Non-warranty policy for Botslab Video Doorbell

- No valid warranty certificate and purchase invoice.
- Damage caused by use, maintainance, or keeping of the product not in accordance with product description, damage caused by disassembly and repair unauthorized by Botslab, or artificial damage.
- Damages that result from force majeure.
- Normal decoloration and wastage during usage will not be included in warranty service.

Contact Us



<https://www.botslab.com>



service@botslab.com



[Facebook@botslabofficial](https://www.facebook.com/botslabofficial)



1-866-360-0505 (Only for US)

Working time: Mon-Fri, 9:00 - 17:00 EST

CE Declaration of conformity

This product complies with the radio interference requirements of the European community. Hereby, Botslab, Inc. declares that the product is in compliance with the essential requirements and other relevant provisions of RE Directive 2014/53/EU. You can find the Declaration of Conformity on

<http://www.botslab.com>. In accordance with Article 10(2) and Article 10(10), This product is allowed to be used in all EU member states.

The device is restricted to indoor use when operated in the European Community using frequency 5150MHz-5250MHz to reduce the potential for interference.

The device complies with RF specifications when the device used at least 20cm.

from your body.

RF power: XXXXX

RF frequency band: XXXXXX

The operating temperature of the product is: XXXXXX

	AT	BE	BG	CH	CY	CZ	DE
	DK	EE	EL	ES	FI	FR	HR
	HU	IE	IS	IT	LI	LT	LU
	LV	MT	NL	NO	PL	PT	RO
	SE	SI	SK	TR	UK(NI)		

Manufacturer Name: Botslab Inc.

Address: 919 North Market Street, Suite 950, Wilmington, New Castle, Delaware, USA

Product Name: Botslab Outdoor Dual-Lens Camera

Trademark: Botslab

Product Model: W302