

Hereby, [Thousandshores Deutschland GmbH] declares that the radio equipment type [True Wireless Earbuds BTH96] is in compliance with Directive 2014/53/EU. The full text of the EU declaration conformity is available at the following internet address:  
<http://files.tribit.com/bth96-eu-doc.pdf>

Hiermit erklärt [Thousandshores Deutschland GmbH], dass der Funkanlagentyp [True Wireless Earbuds BTH96] der Richtlinie 2014/53/EU entspricht. Der vollständige Text der EU-Konformitätserklärung ist unter der folgenden Internetadresse verfügbar:  
<http://files.tribit.com/bth96-de-doc.pdf>

Learn more about the UK Declaration of Conformity, Please click below link to download.  
<http://files.tribit.com/bth96-uk-doc.pdf>

# Tribit FlyBuds C2

———— True Wireless Earbuds ————

**Model: BTH96**

English User Manual | Benutzerhandbuch  
Guide Utilisateur | Manual de Usuario | Manuale Utente  
取扱説明書 | 用户指南 | 사용자 가이드



English User Manual	<b>1</b>
Benutzerhandbuch	<b>9</b>
Guide Utilisateur	<b>16</b>
Manual de Usuario	<b>23</b>
Manuale Utente	<b>30</b>
取扱説明書	<b>37</b>
用户指南	<b>44</b>
사용자 가이드	<b>51</b>

# Package Contents

- ① Earbuds(L/R)
- ② Charging Case
- ③ USB-C Charging Cable
- ④ User Manual

# Product Parts

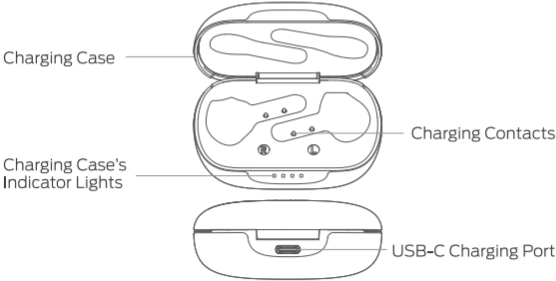
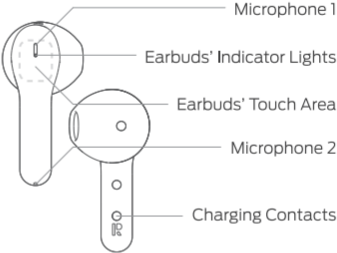

## How to Wear the Earbuds

### • To Wear



Place the earbud in your ear canal and rotate it until comfortable.

### • To Call



Aim the microphone at the mouth for a better call effect.

### • To Pick & Place

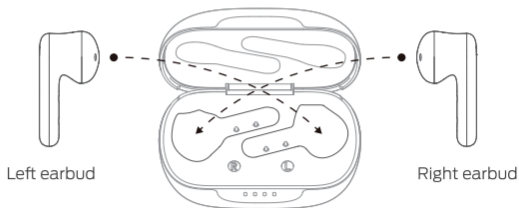

## Power ON / Power OFF

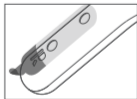

- For the first time use, please tear off the insulation sticker.



- **To power On:**  
Open the charging case



- **To power Off:**  
Close the charging case

## Bluetooth Connection Instructions



### Connect the earbuds to a Bluetooth device:

Open the charging case and the earbuds will automatically enter the Bluetooth pairing mode, then the earbuds' indicator lights will flash alternately red and white. Turn on the Bluetooth function in the Bluetooth device, refresh the Bluetooth device listing, then select the paired audio device named "Tribit FlyBuds C2" to connect. The indicator lights of the earbuds will go off after it connects successfully.

### Connect the earbuds with other devices:

**Method 1:** Please disconnect the earbuds with the currently connected Bluetooth device, and the earbuds will automatically enter Bluetooth pairing mode.

**Method 2:** Tap either earbud for 4 times. When the white indicator light goes on, touch and hold the earbud for 3 seconds. When the indicator lights of both earbuds flash in red at the same time, the earbuds will automatically enter Bluetooth pairing mode.

## Touch Control Instructions



Play / Pause	Tap either earbud twice
Next Track	Triple tap the right earbud
Volume +	Touch and hold the right earbud (during a call or music playing)
Volume -	Touch and hold the left earbud (during a call or music playing)
Voice Assistant	Triple tap the left earbud
Answer a Call	Tap either earbud once
End a Call	Tap either earbud twice
Rejecting an Incoming Call	Touch and hold either earbud
Power Off	Touch and hold either earbud for 10s (without a call or music playing) and the red light will flash for 1s with the power-off prompt tone: Power OFF
Power On	Touch and hold the left and right earphones for 6s and the white light will flash for 6s with the power-on prompt tone: Power ON



## Charging Instructions

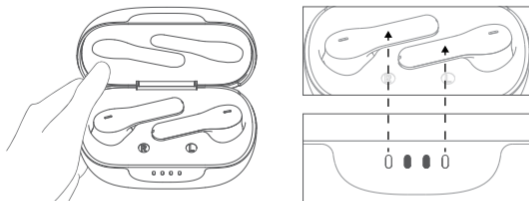

**When the earbuds' indicator lights flashes in red slowly, please charge the earbuds in time.**

• **To charge the earbuds:** Put the earbuds into the charging case and close the case to start charging. The indicator lights on the far left and right of the charging box show the charging status of the each earbud. During charging, the indicator lights will be always on and will go off after the earbuds are fully charged.

• **Charging time of the earbuds:** about 90 minutes

**Open the top cover of the charging case and it'll display its battery level. When the battery runs out, the indicator light of the charging case will be off. Please charge the case in time.**

• **To charge the charging case:** Plug one end of the USB cable into a 5V power supply, and the other end into the charging port of the charging case for charging. The indicator lights will flash during the charging process, and the 4 indicator lights will stay on when the earbuds are fully charged.

• **Charging time of the charging case:** about 90 minutes

\*The above data comes from Thousandshores Laboratory.  
Thousandshores reserves all rights for final explanation.

## How to Reset the Earbuds

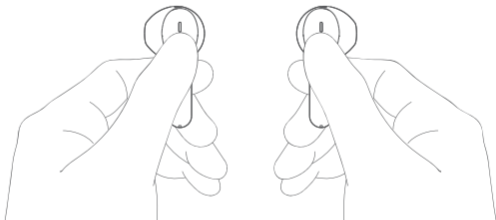

**Step 1:** Turn off the left and right earbuds. Touch and hold the touch area for 10 seconds (at the 6th second, the earbuds will turn on with the white indicator light flashing once and then go out).

**Step 2:** Double touch the left and right earbuds to enter the reset state within 5 seconds.

**Step 3:** After the earbuds are reset successfully, the white lights of the left and right earbuds will flash quickly.

**Note:** After resetting, if there is a Bluetooth device that has been connected to the earbuds, you need to delete the pairing record to allow the earbuds to be paired again.

## Frequency band & Maximum transmission power

Frequency band: 2402~2480MHz

Maximum transmission power: -6 ~ +4dBm

## Warning

1. Do not dismantle or modify the earbuds for any reason, otherwise any malfunction of the earbuds is not covered by the warranty.
2. Do not deliberately contact the earbuds to liquids, which may damage the earbuds may be damaged and the warranty turns invalid.
3. Do not place the earbuds in the environment where the temperature is too high or too low (above 45 °C or below -20 °C).
4. This product includes a built-in lithium battery. It is forbidden to disassemble, bump, squeeze or throw the product into fire.
5. Please keep the earbuds away from children to avoid accidental swallowing and other injuries.

## Important Notes

1. Under noisy environment, the voice from the earbuds will sound lower than the actual volume.
2. Listening to music with high volume for a long time may cause permanent damage to your hearing.
3. Please use the charging cable and power adapter or computer to charge the earbuds. When charging, only use the adapter that comply with the national/regional regulations and international and regional safety standards.

## FCC Statement

Changes or modifications not expressly approved by the party responsible for compliance could void the user's authority to operate the equipment. This equipment has been tested and found to comply with the limits for a Class B digital device, pursuant to Part 15 of the FCC Rules. These limits are designed to provide reasonable protection against harmful interference in a residential installation. This equipment

generates uses and can radiate radio frequency energy and, if not installed and used in accordance with the instructions, may cause harmful interference to radio communications. However, there is no guarantee that interference will not occur in a particular installation. If this equipment does cause harmful interference to radio or television reception, which can be determined by turning the equipment off and on, the user is encouraged to try to correct the interference by one or more of the following measures:

- Reorient or relocate the receiving antenna.
  - Increase the separation between the equipment and receiver.
  - Connect the equipment into an outlet on a circuit different from that to which the receiver is connected.
  - Consult the dealer or an experienced radio/TV technician for help
- This device complies with part 15 of the FCC rules. Operation is subject to the following two conditions
- (1) this device may not cause harmful interference, and
  - (2) this device must accept any interference received, including interference that may cause undesired operation.

## IC Caution

This device complies with Industry Canada licence-exempt RSS standard(s).

Operation is subject to the following two conditions:

- (1) This device may not cause interference, and
- (2) This device must accept any interference, including interference that may cause undesired operation of the device.

Qualcomm aptX is a product of Qualcomm Technologies, Inc. and/or its subsidiaries.

Qualcomm is a trademark of Qualcomm Incorporated, registered in the United States and other countries. aptX is a trademark of Qualcomm Technologies International, Ltd., registered in the United States and other countries.