

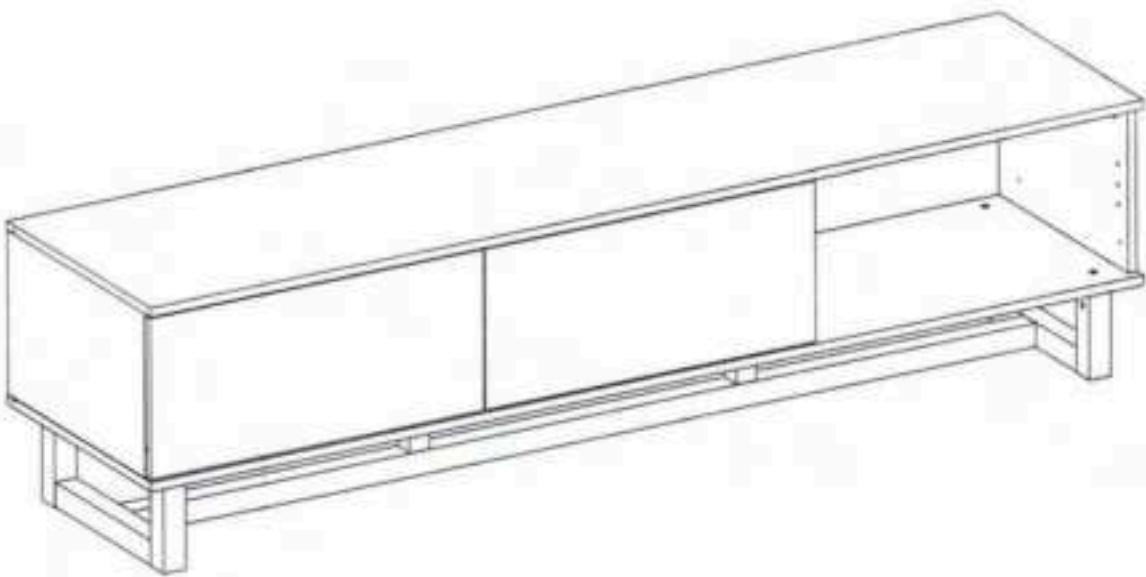

## ASSEMBLY INSTRUCTIONS

### RZ2100

## RAZE SERIES MODULAR AV CABINET



Thank you for choosing RZ2100 Furniture. Before beginning assembly, please check all parts are included and undamaged. For any assembly or parts enquiries, please contact Arisit Pty Ltd on 1300 762 219 or email to [arisit@arisit.com](mailto:arisit@arisit.com)

**WARNING**



**Children have died from furniture tipover.**

- NEVER allow children to stand, climb or hang on drawers, doors, or shelves.
- ALWAYS secure your television with an anchor device or mount the television on a wall.

Ask staff for more information or visit <https://www.productsafety.gov.au>

**" IMPORTANT: Please Choose your preferred configuration BEFORE installing draws & shelves "**  
**" IMPORTANT: REMOVE protective plastic film from panels BEFORE assembling the cabinet "**

# RZ2100BO



The cabinet top supports up to 55 kg (121 lbs.)  
The drawer supports up to 10 kg (22 lbs.)  
The shelf supports up to 5 kg (11 lbs.)

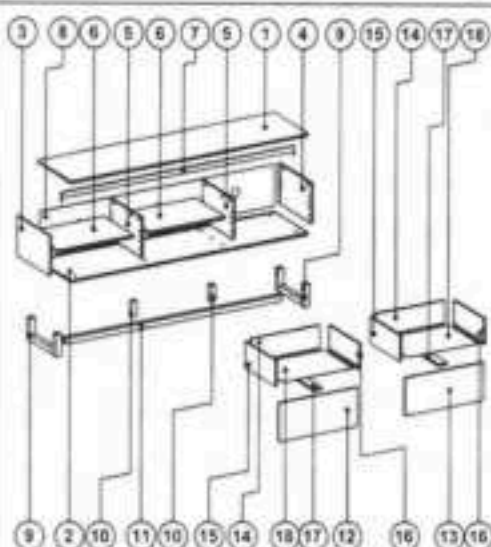
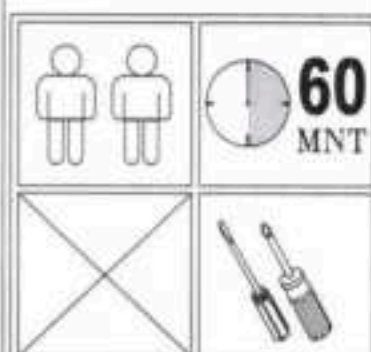

**PRODUCT CARE:** Care for your furniture by cleaning with glass cleaner and a disposable paper towel. do NOT use abrasive chemical products to clean your AVS furniture

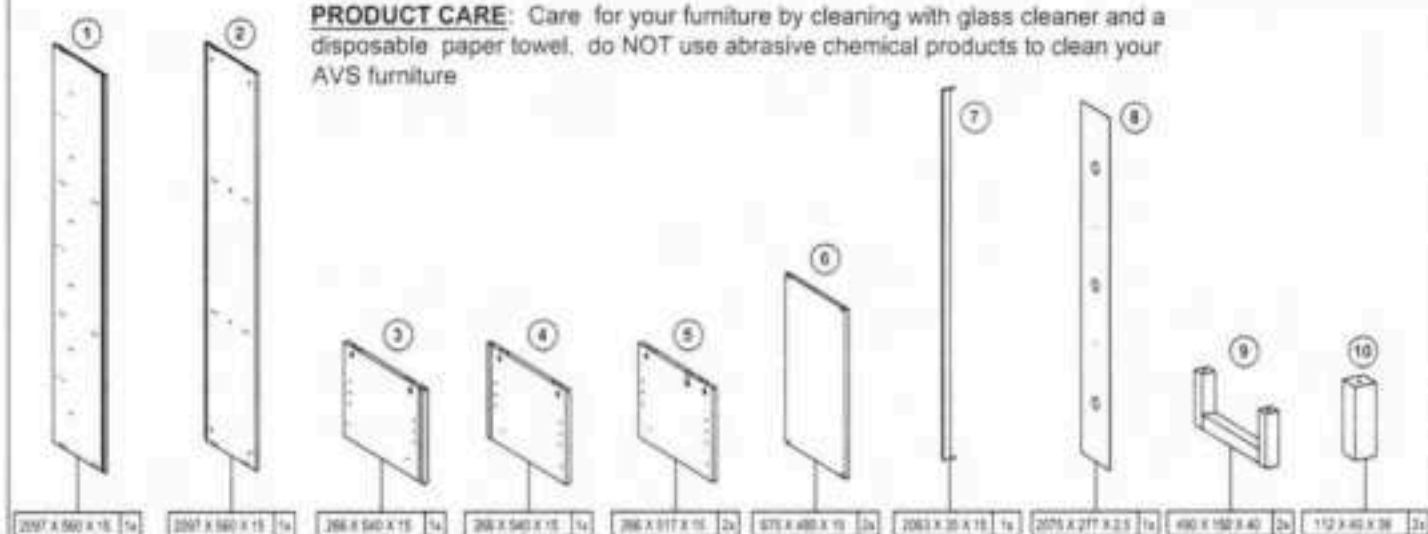

**CAUTION:** Do not use this product for any purpose not explicitly specified by AVS. Improper installation may cause property damage or personal injury. If you do not understand these directions, or have doubts about the safety of the installation, contact AVS Customer Service or call a qualified contractor. Arisit is not responsible for damage or injury caused by incorrect mounting, assembly, or use.

**WARNING!** This product contains small items that could be a choking hazard if swallowed. Keep these items away from young children!

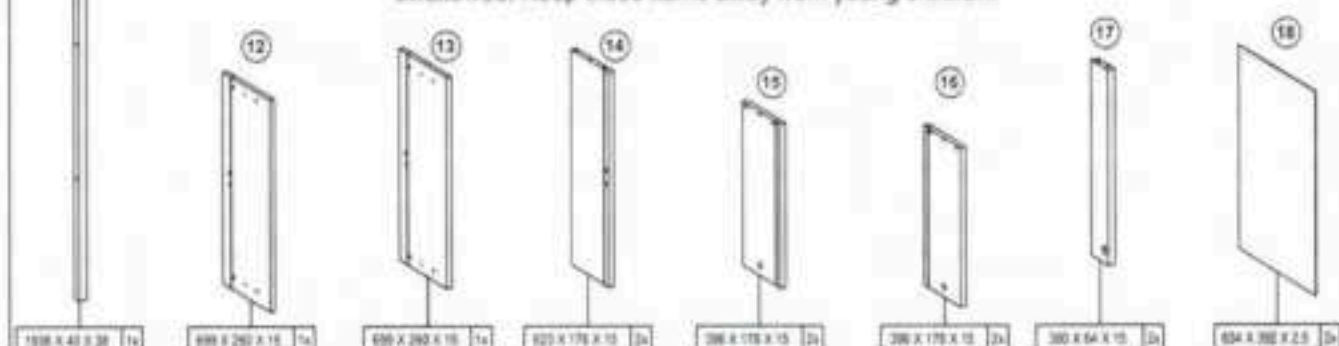

 A X 16	 B X 16	 C X 12	 D X 36	 E X 18	 F X 12
 G X 2SET	 H X 2	 I X 4	 J X 6	 K X 8	 L X 16
 M X 16	 N X 4	 O X 4	 P X 4	 Q X 6	 R X 6
 S X 1	 T X 2	 U X 2	 V X 2	 W X 2	 X X 2

AV Supply Group (AVS) intends to make this manual accurate and complete. However, AVS makes no claim that the information contained herein covers all details, conditions, or variations. Nor does it provide for every possible contingency in connection with the installation or use of this product. The information contained in this document is subject to change without notice or obligation of any kind. AVS makes no representation of warranty, expressed or implied, regarding the information contained herein. AVS assumes no responsibility for accuracy, completeness or sufficiency of the information contained in this document.

# RZ2100BO

1

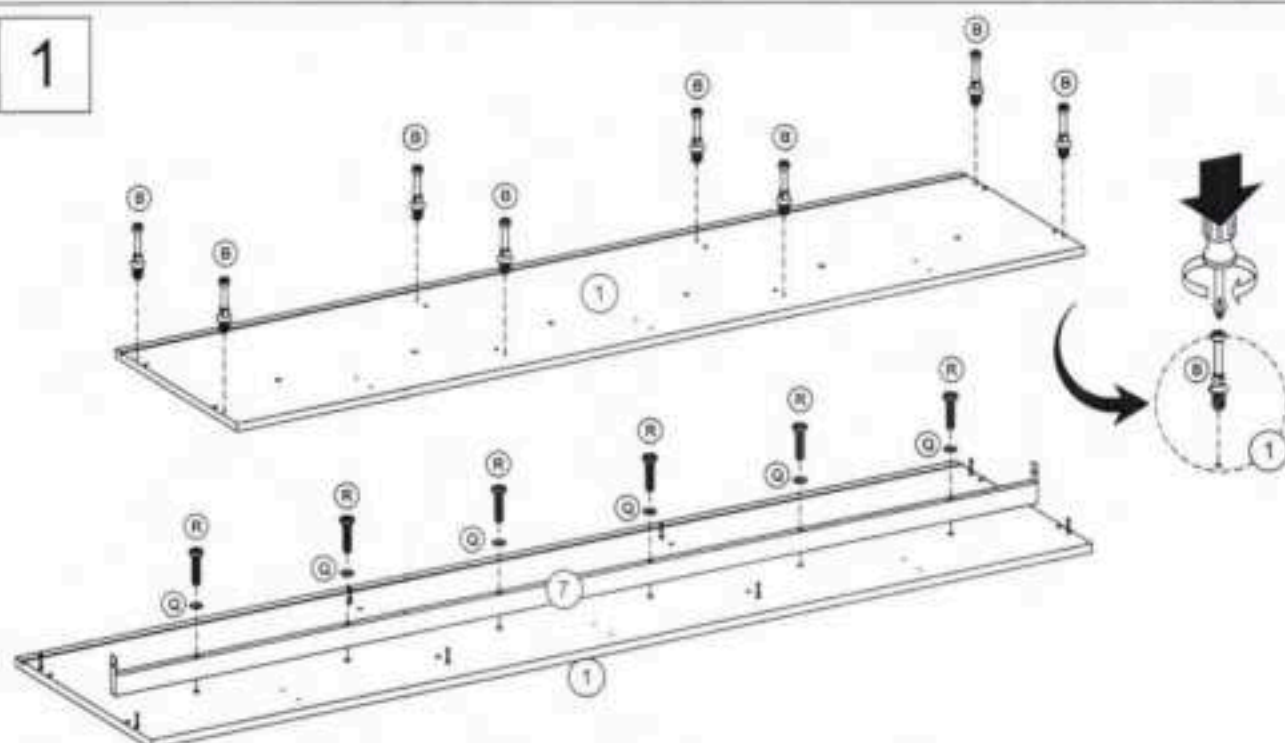

2

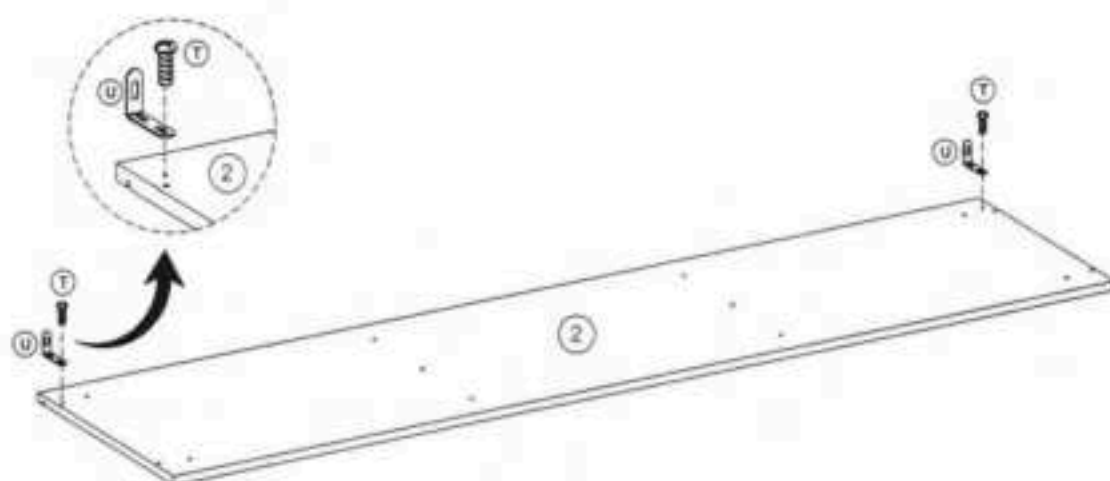

3

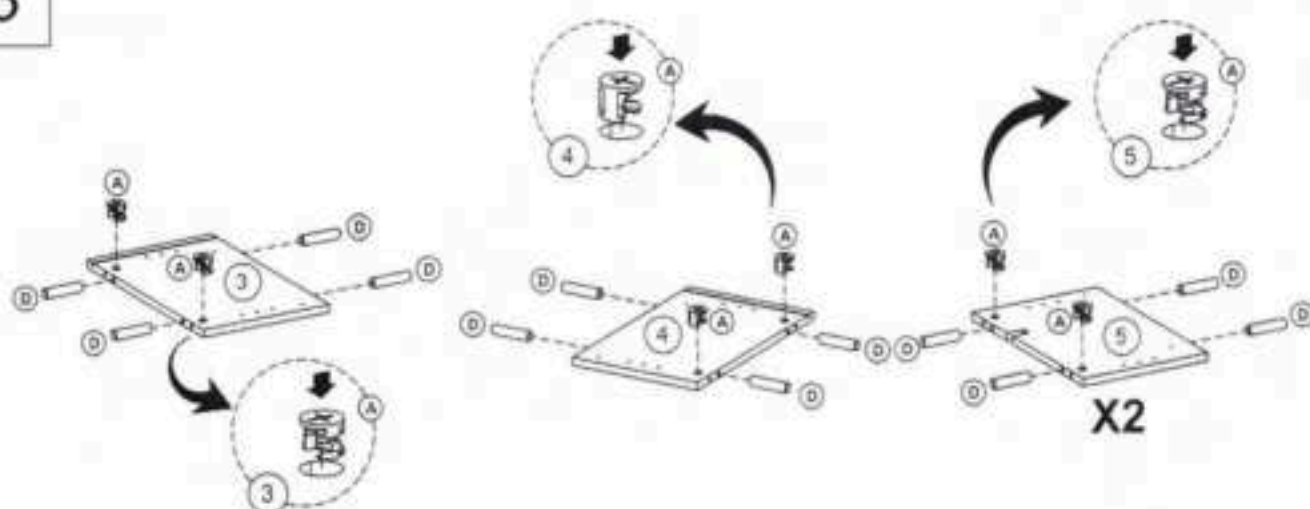

# RZ2100BO

4

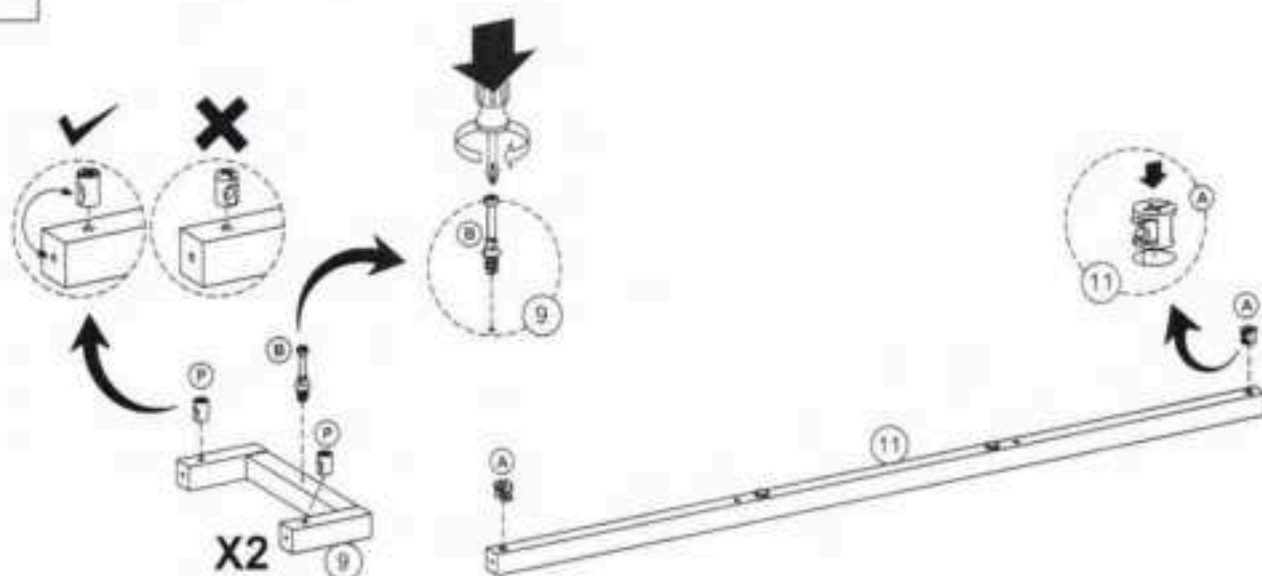

5

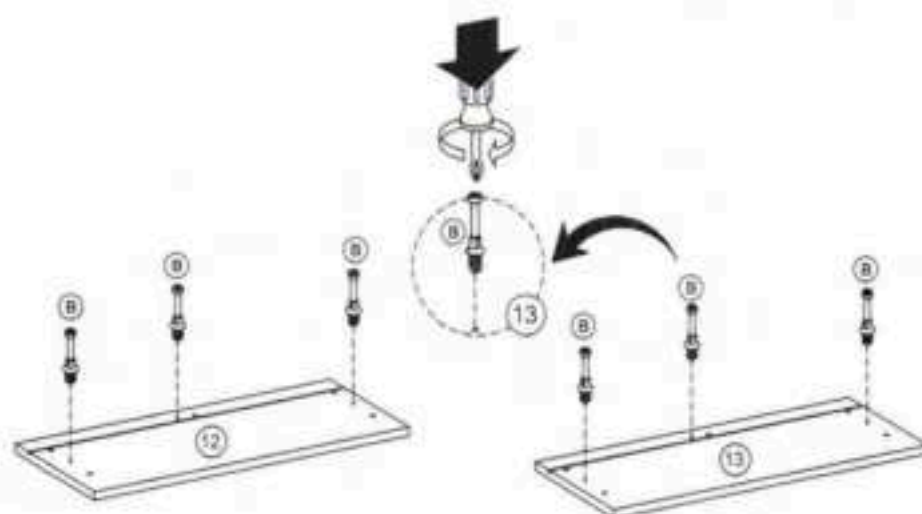

6

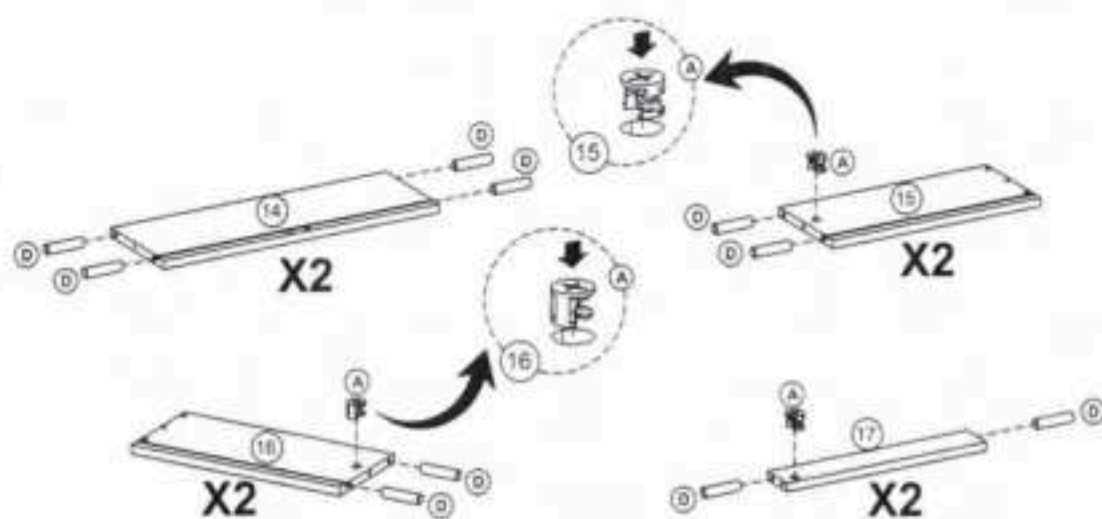



# RZ2100BO

7

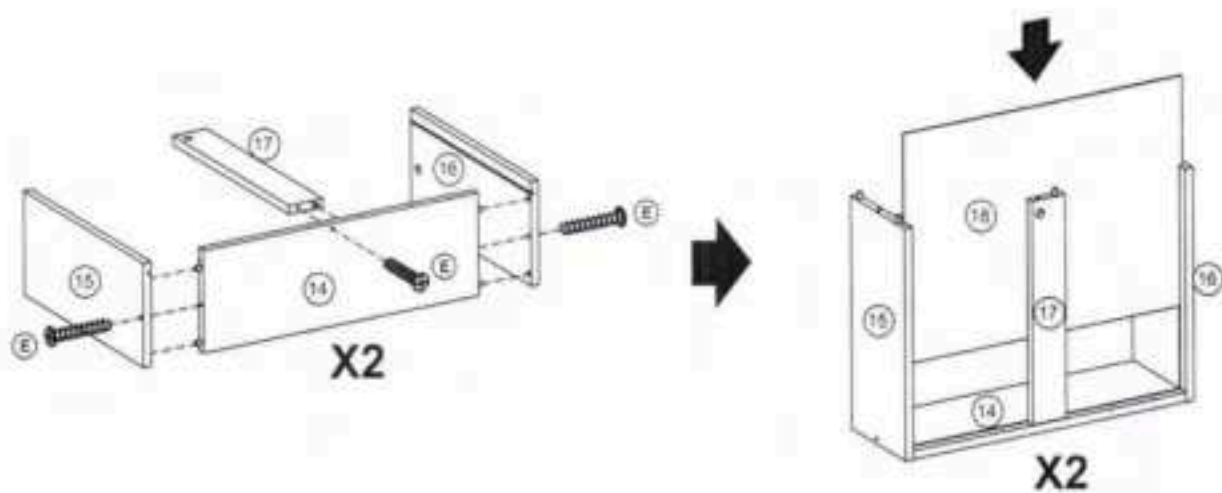

8

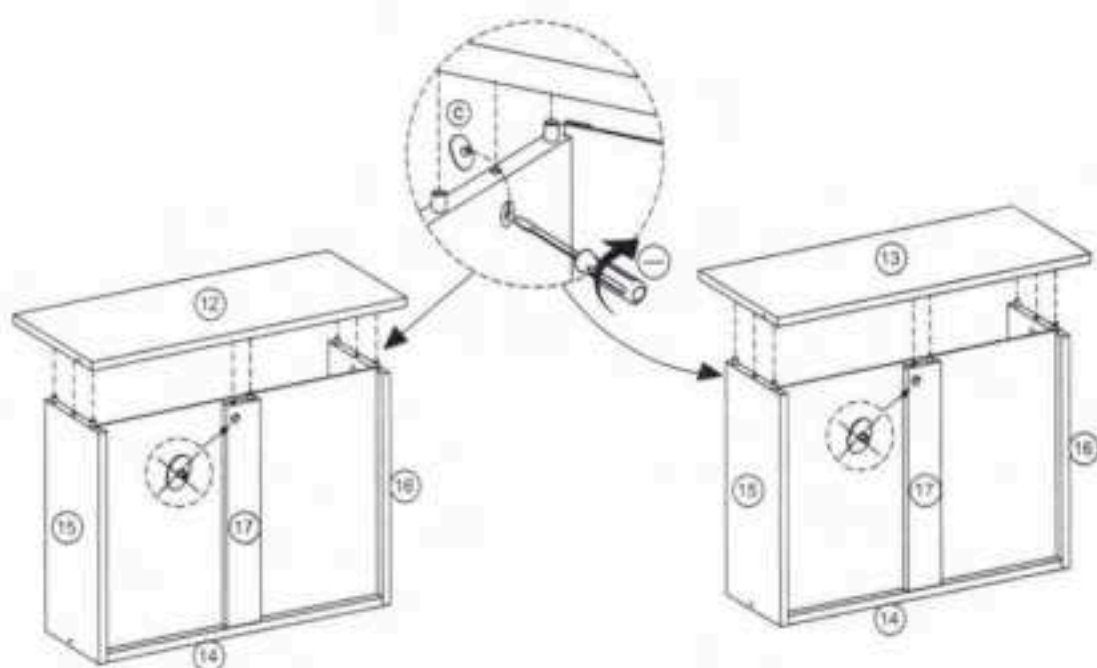

# RZ2100BO

9

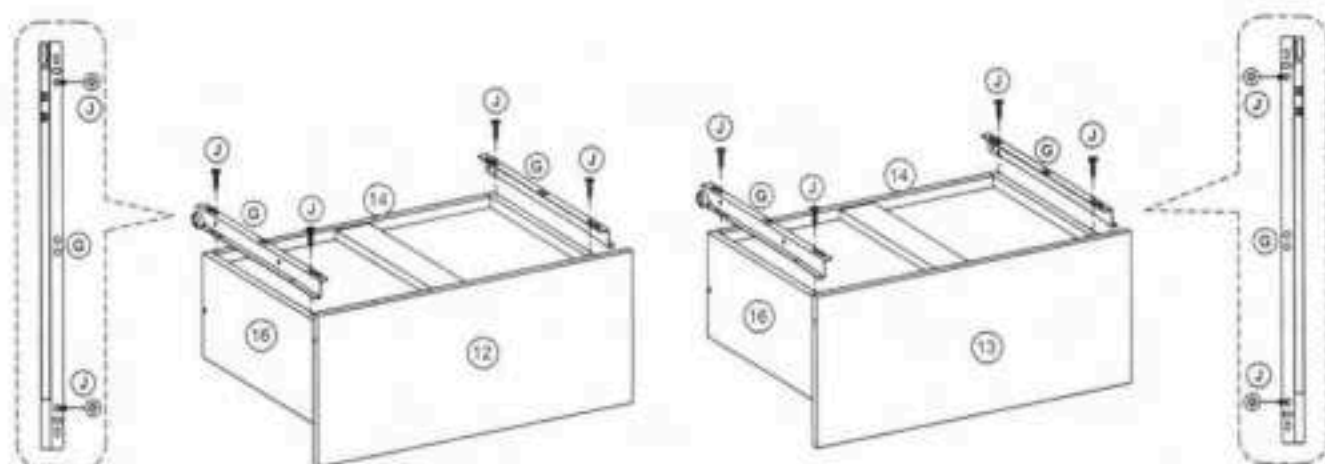

10

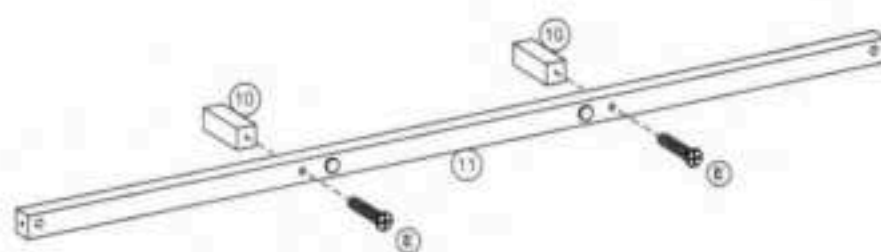

11

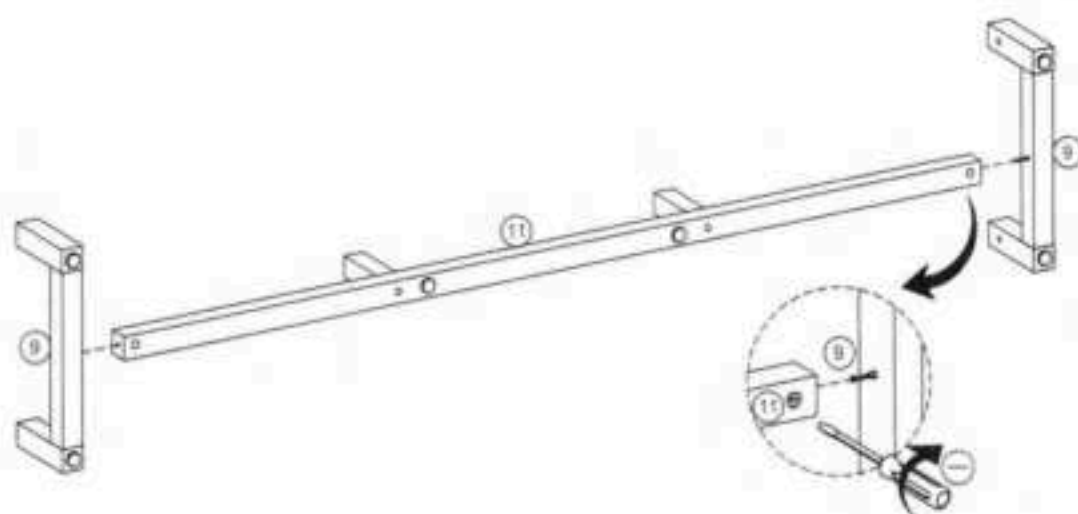

# RZ2100BO

12

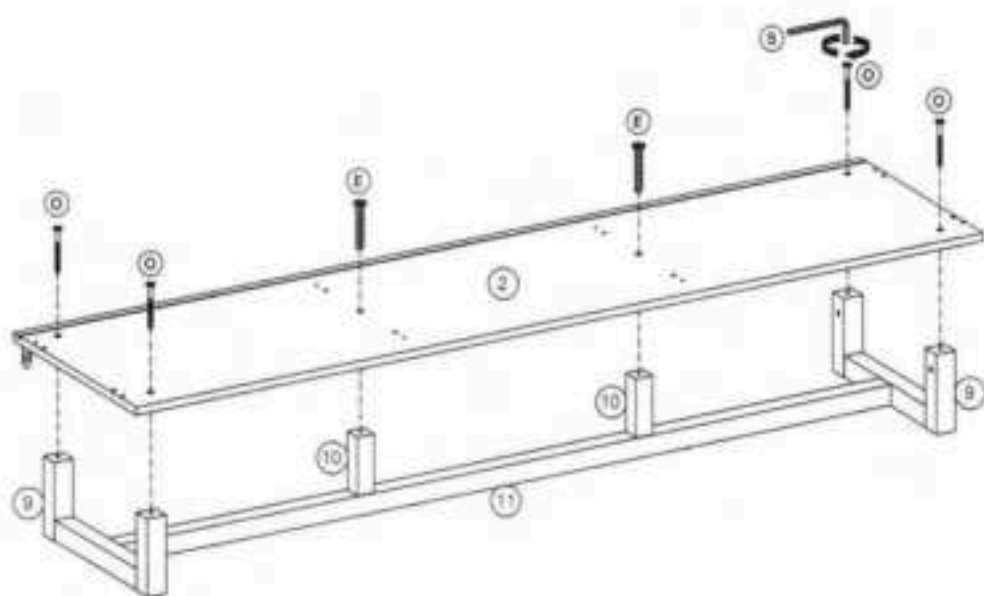

13

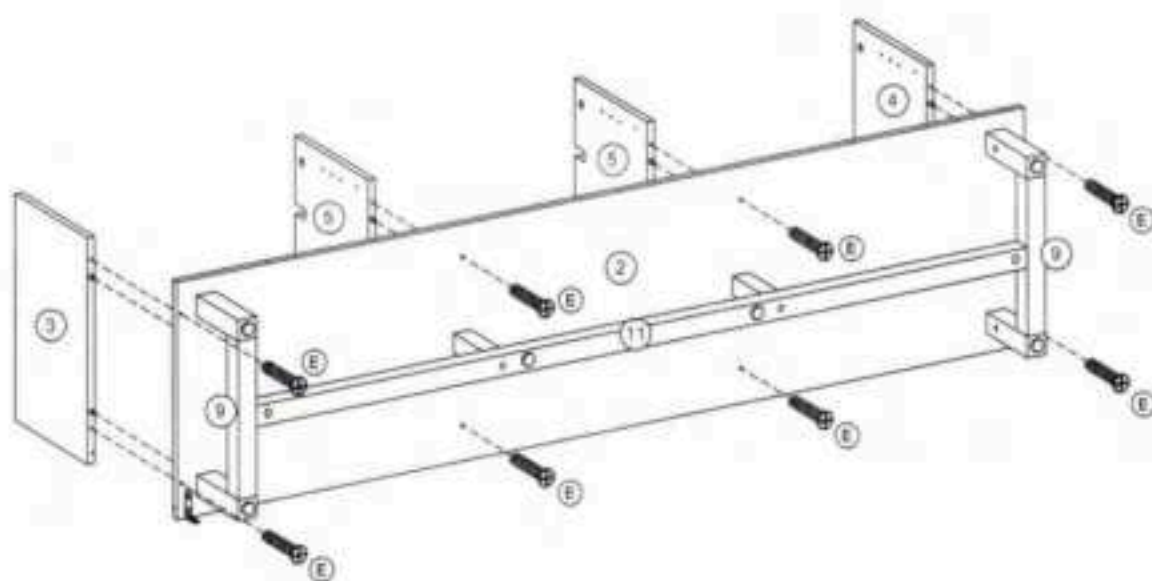

# RZ2100BO

14

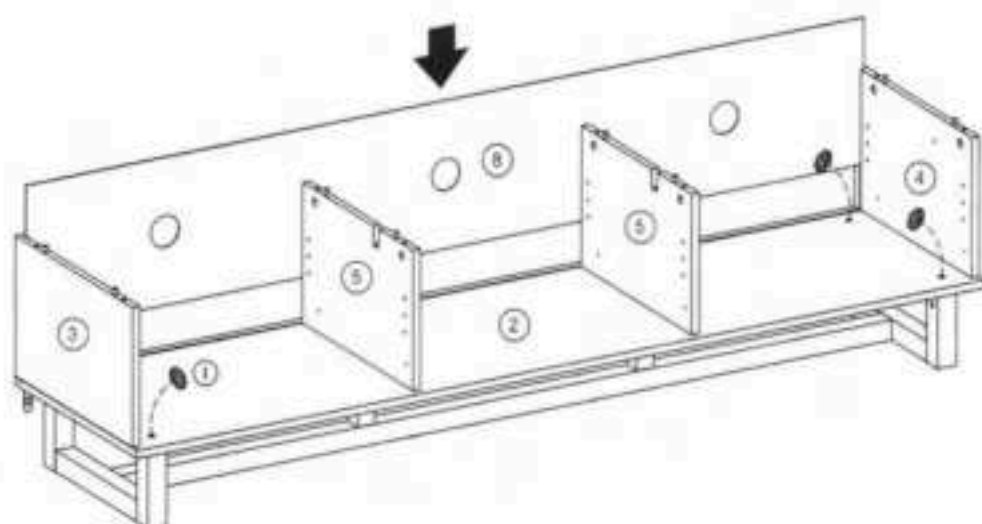

15

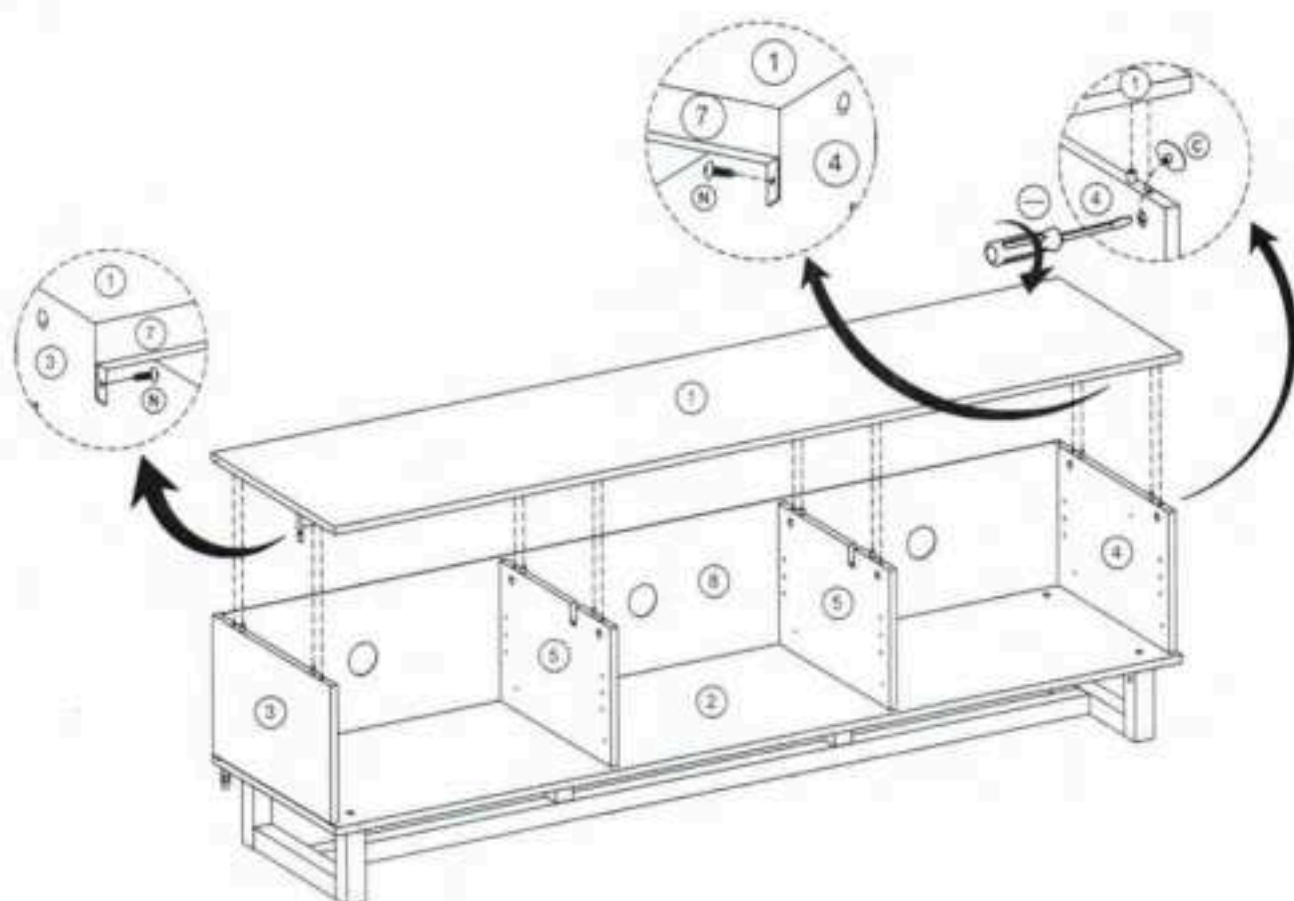



# RZ2100BO

16

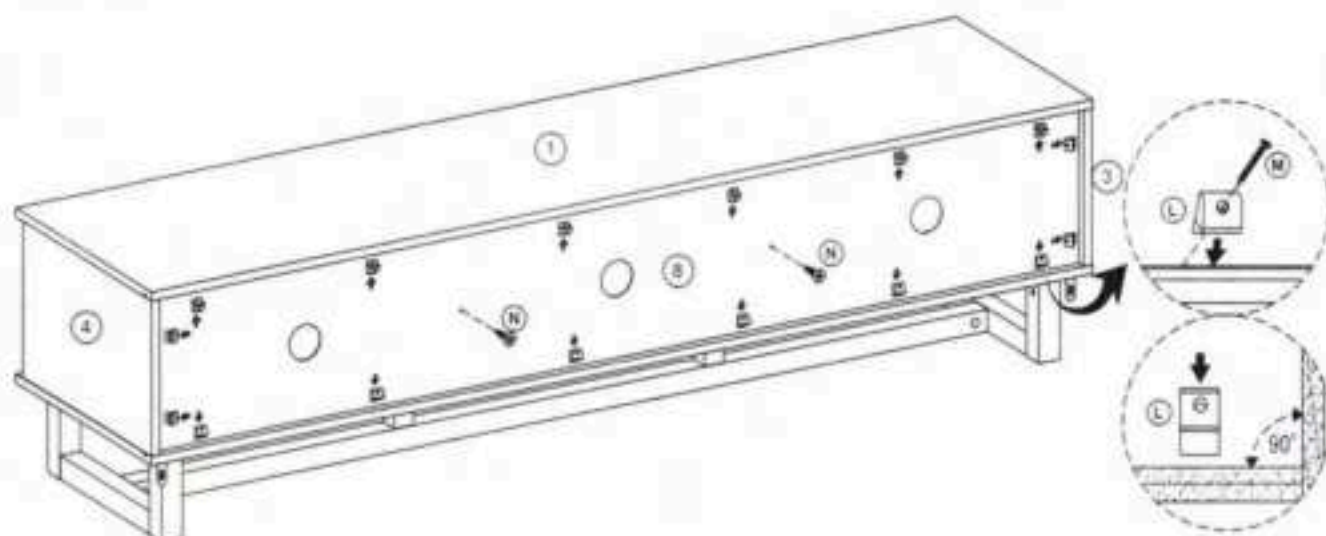

## OPTIONAL FOR ASSEMBLY DRAWER & SHELF

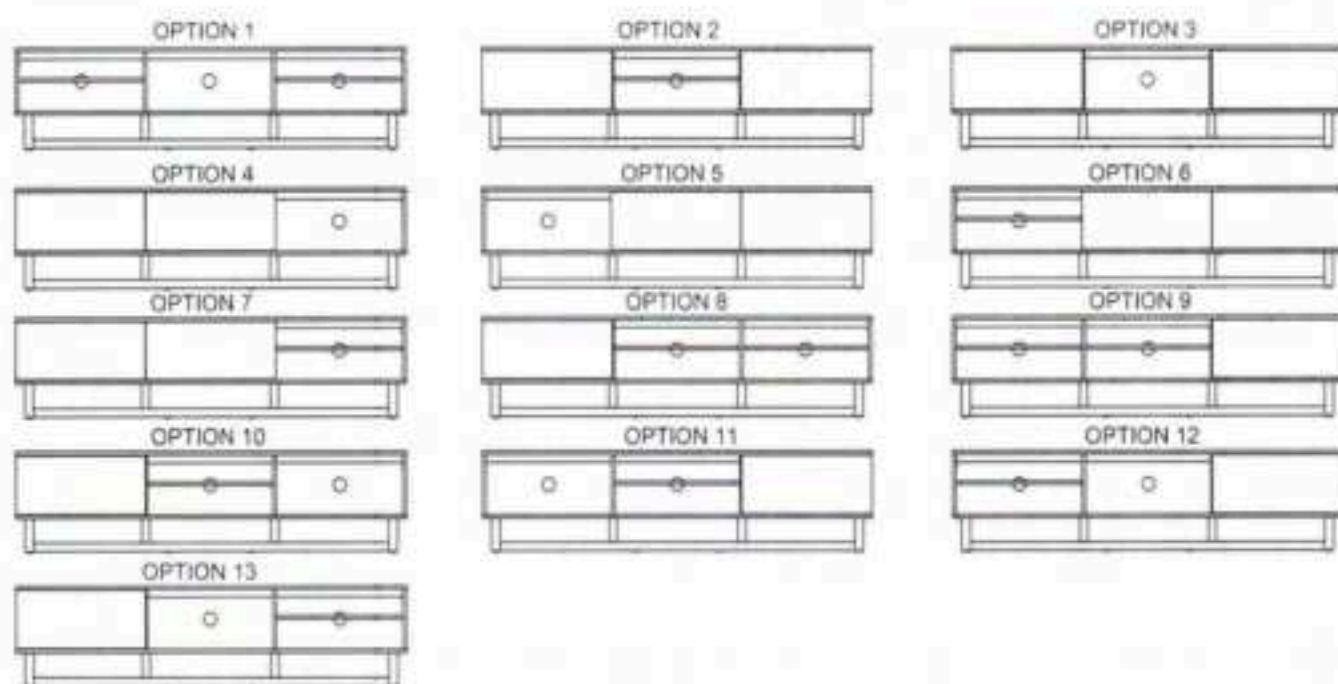

17

## OPTION 1

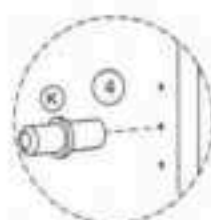
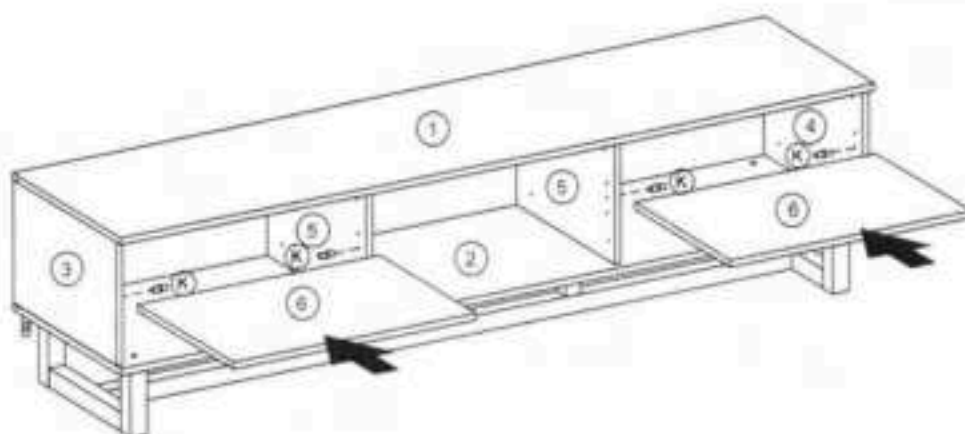

# RZ2100BO

17

OPTION 2

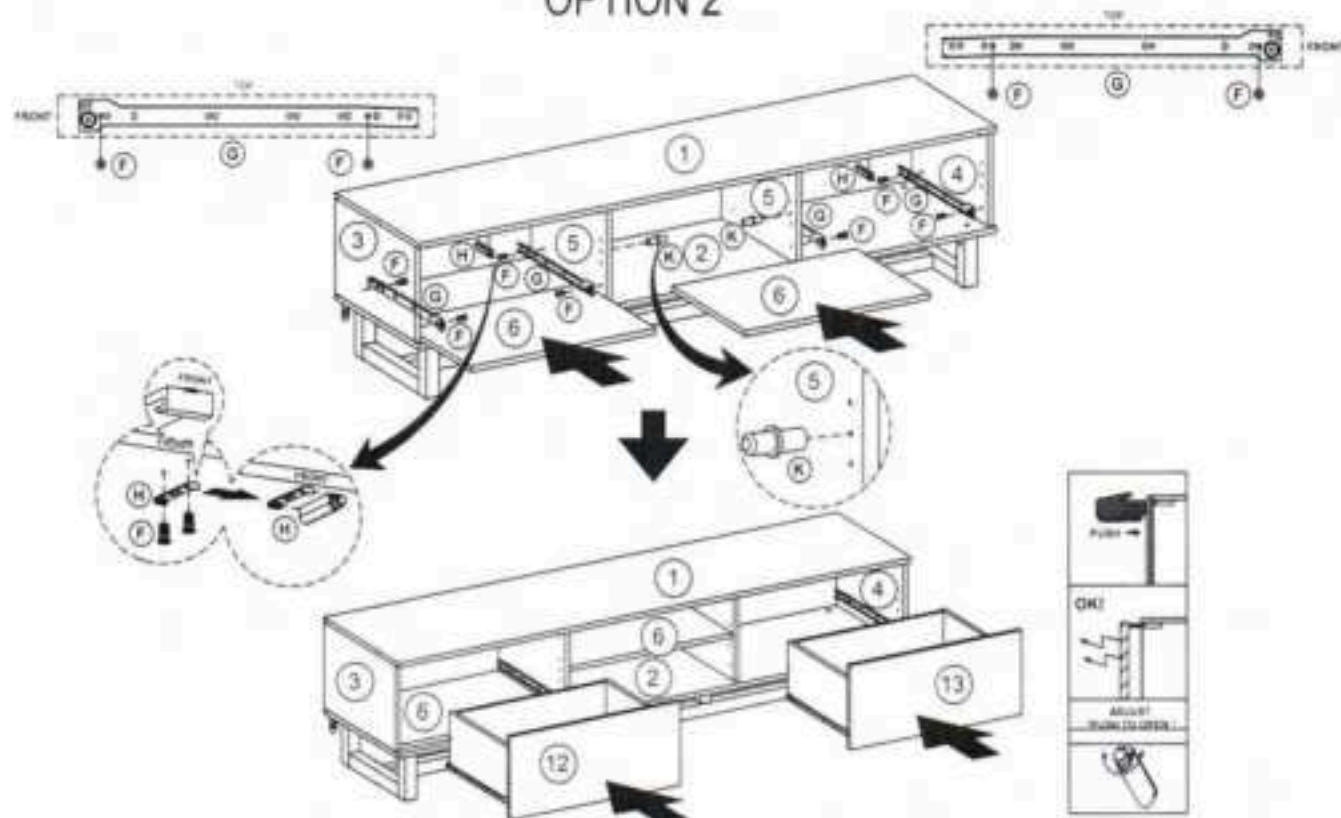

17

OPTION 3

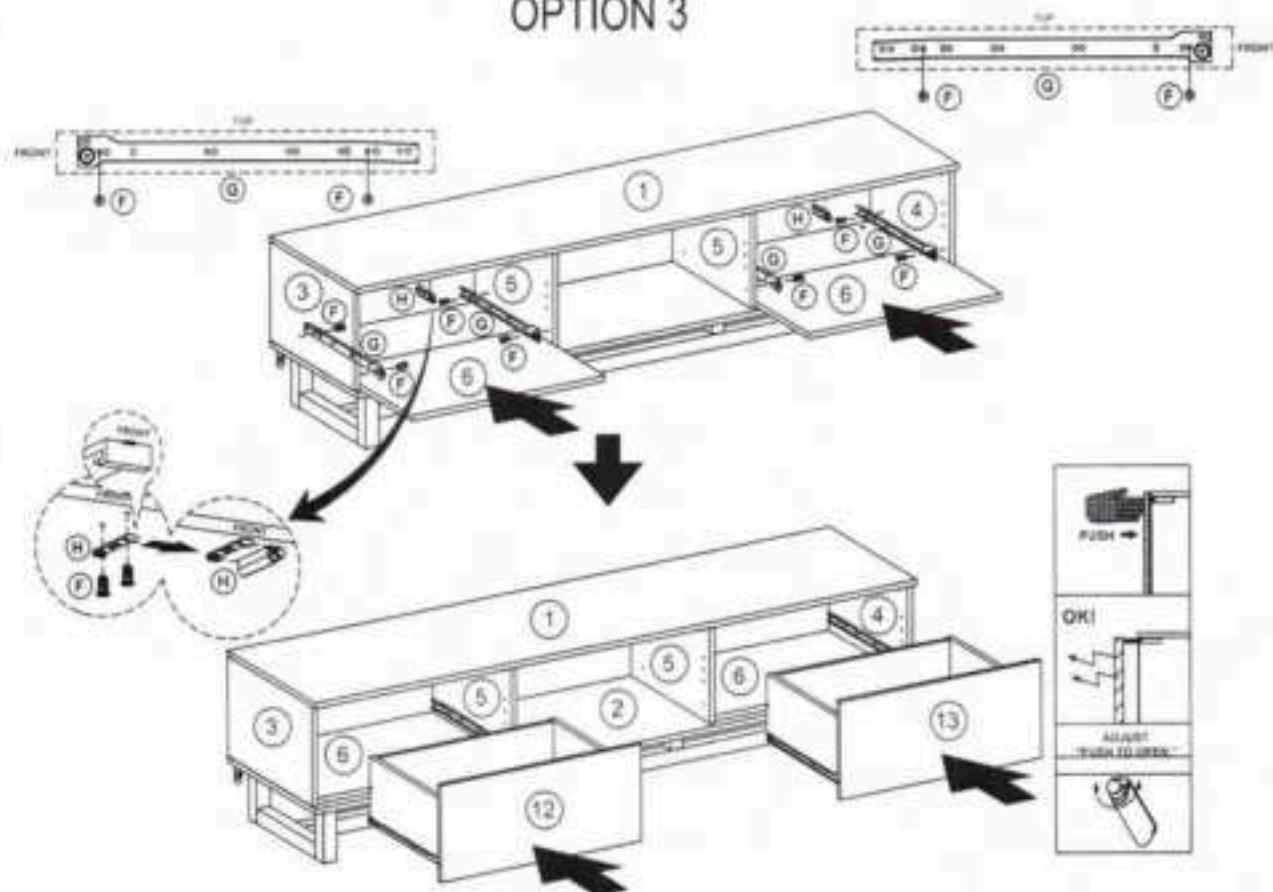

# RZ2100BO

17

OPTION 4

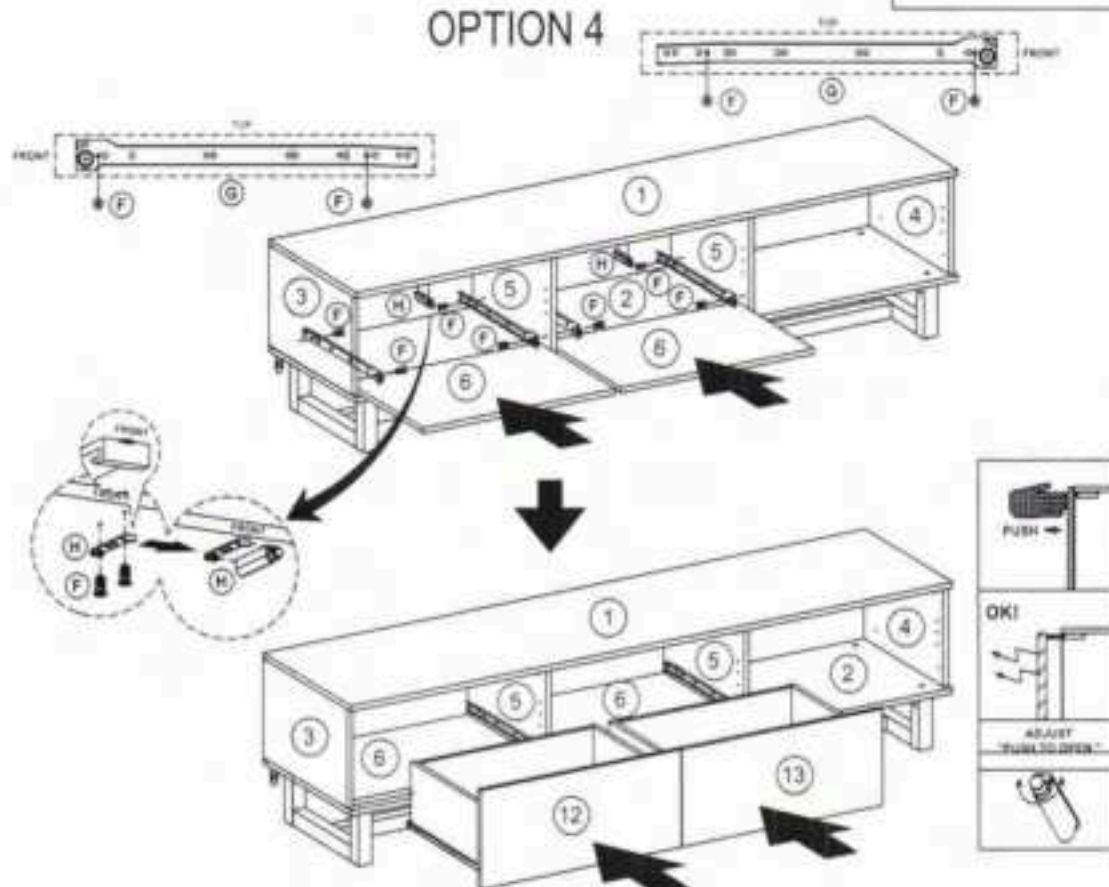

17

OPTION 5

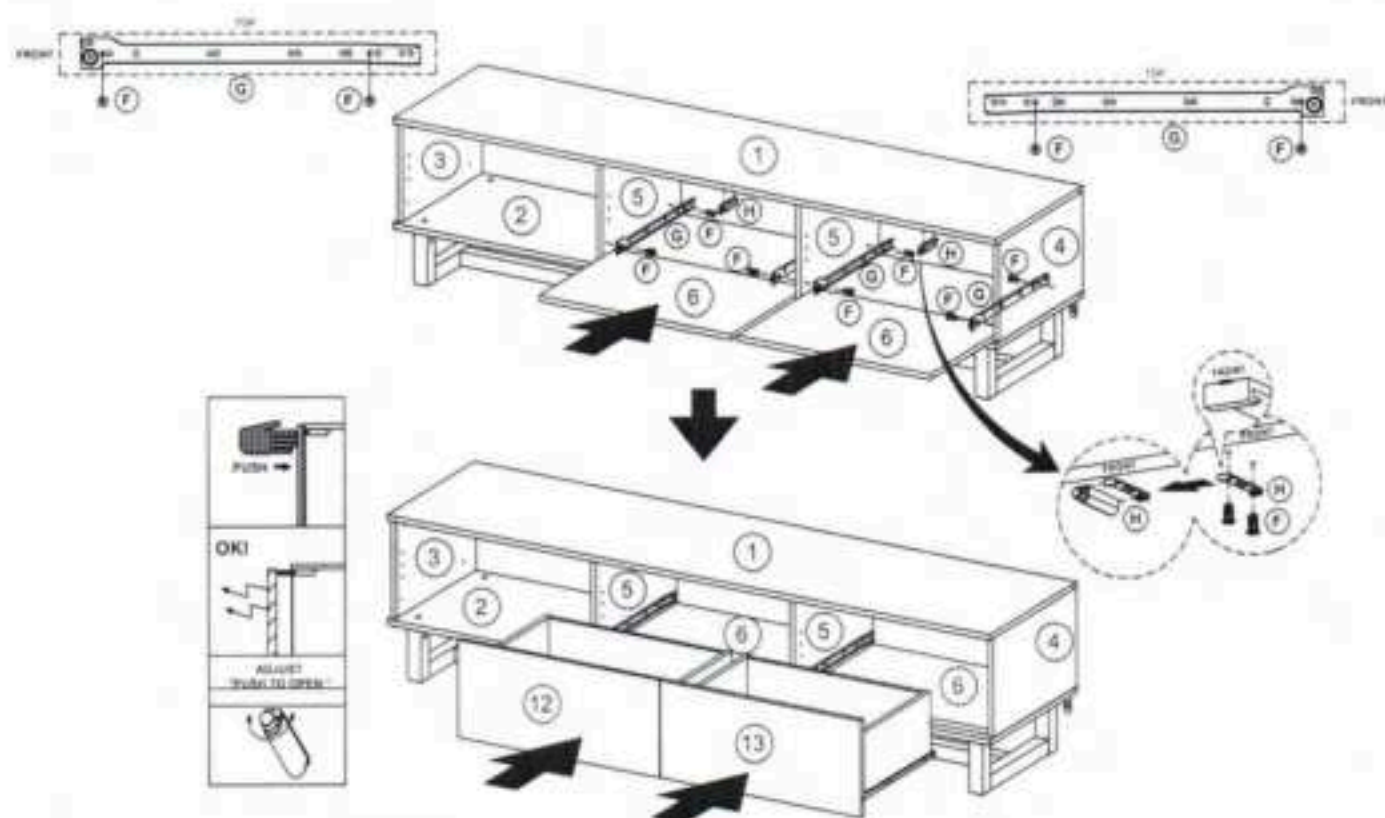



# RZ2100BO

17

## OPTION 6

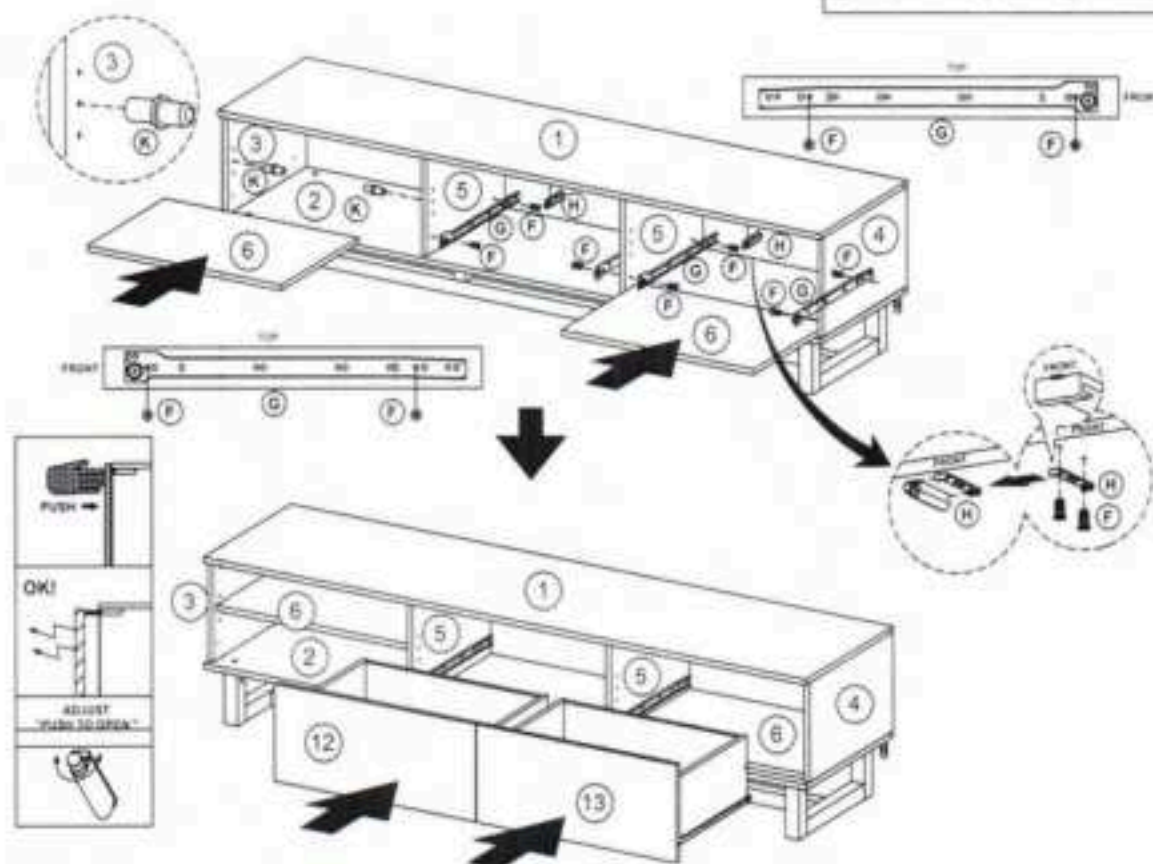

17

## OPTION 7

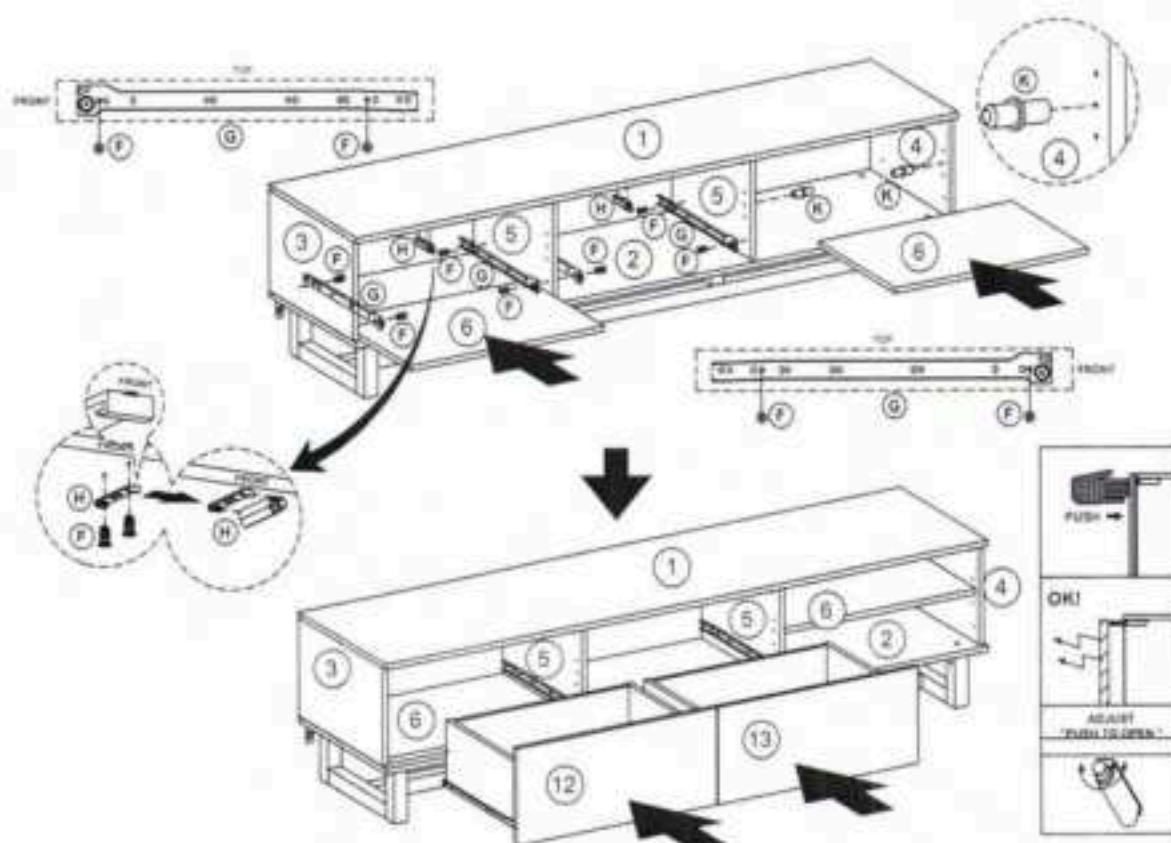

# RZ2100BO

17

OPTION 8

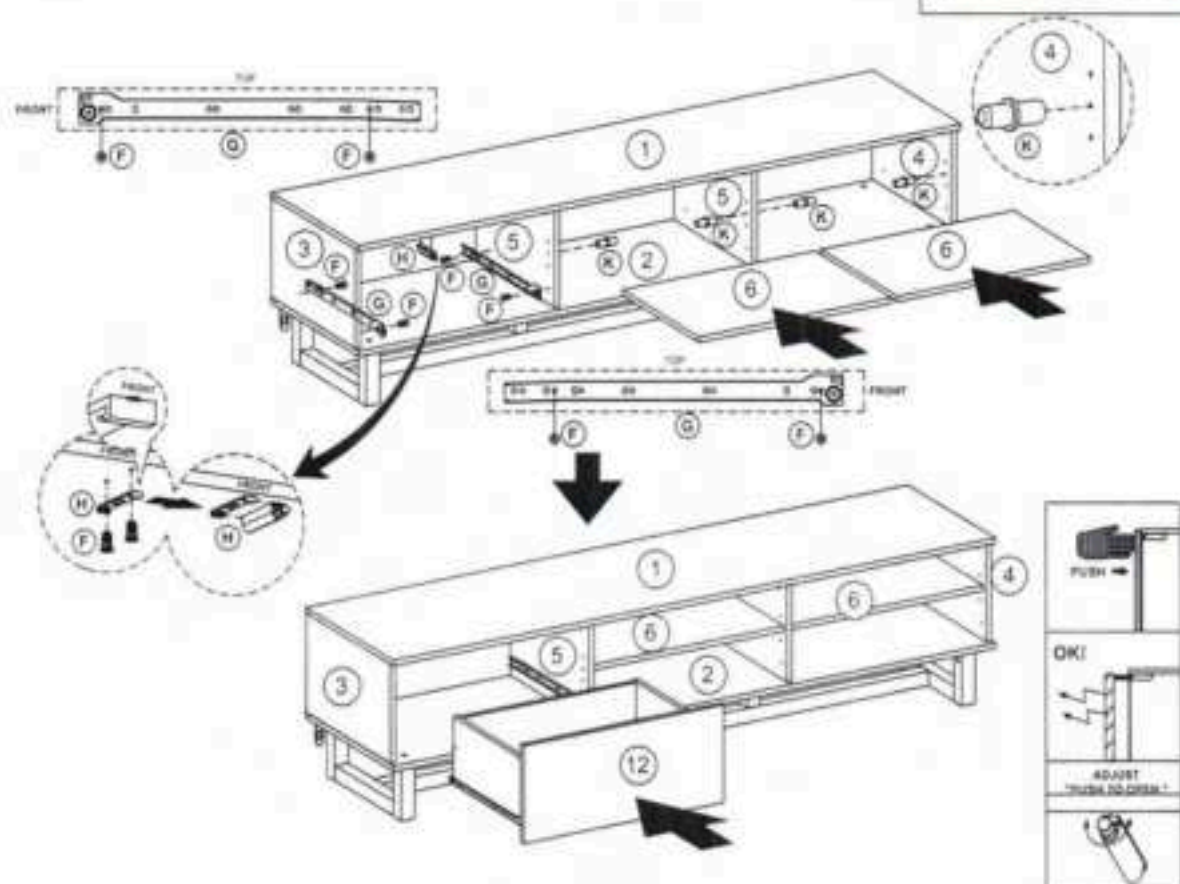

17

OPTION 9

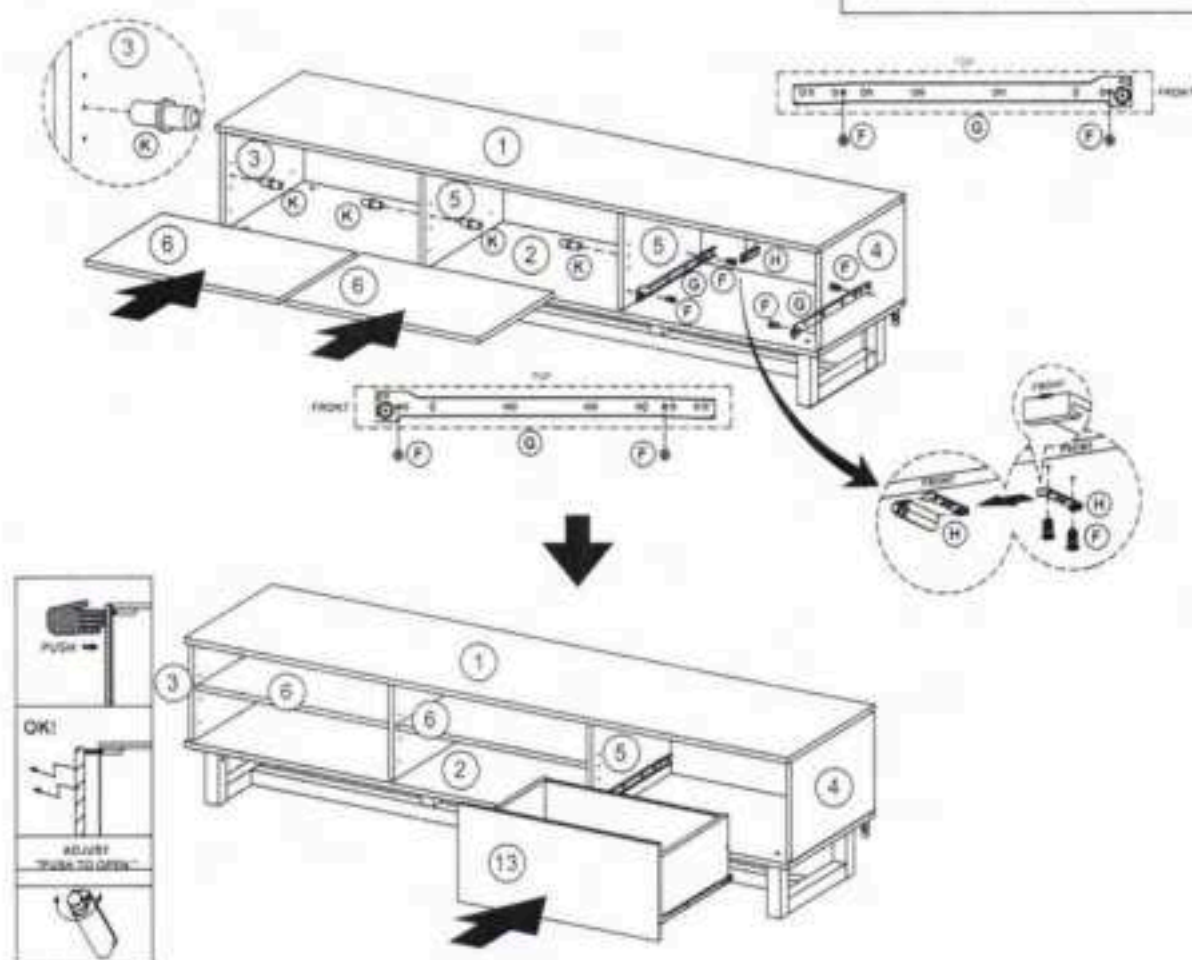



# RZ2100BO

17

OPTION 10

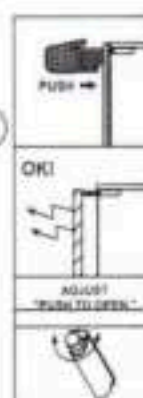
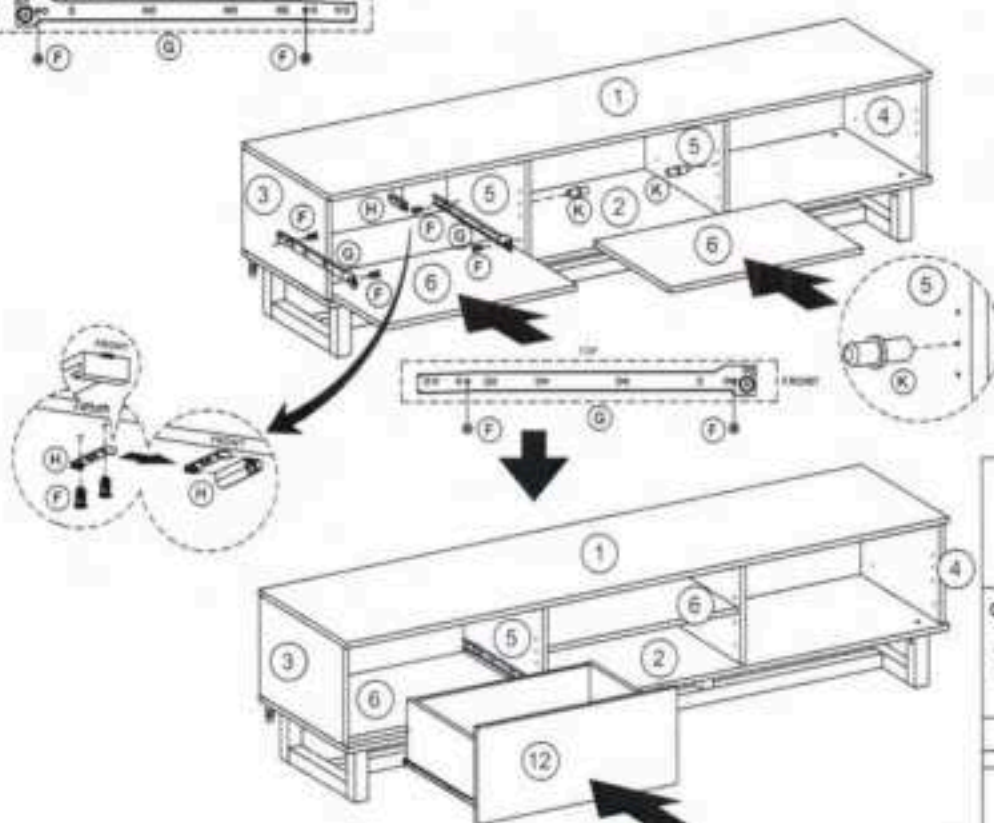
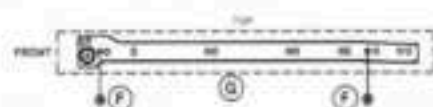
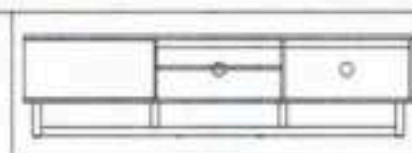

17

OPTION 11

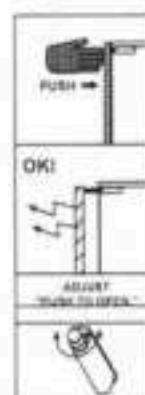
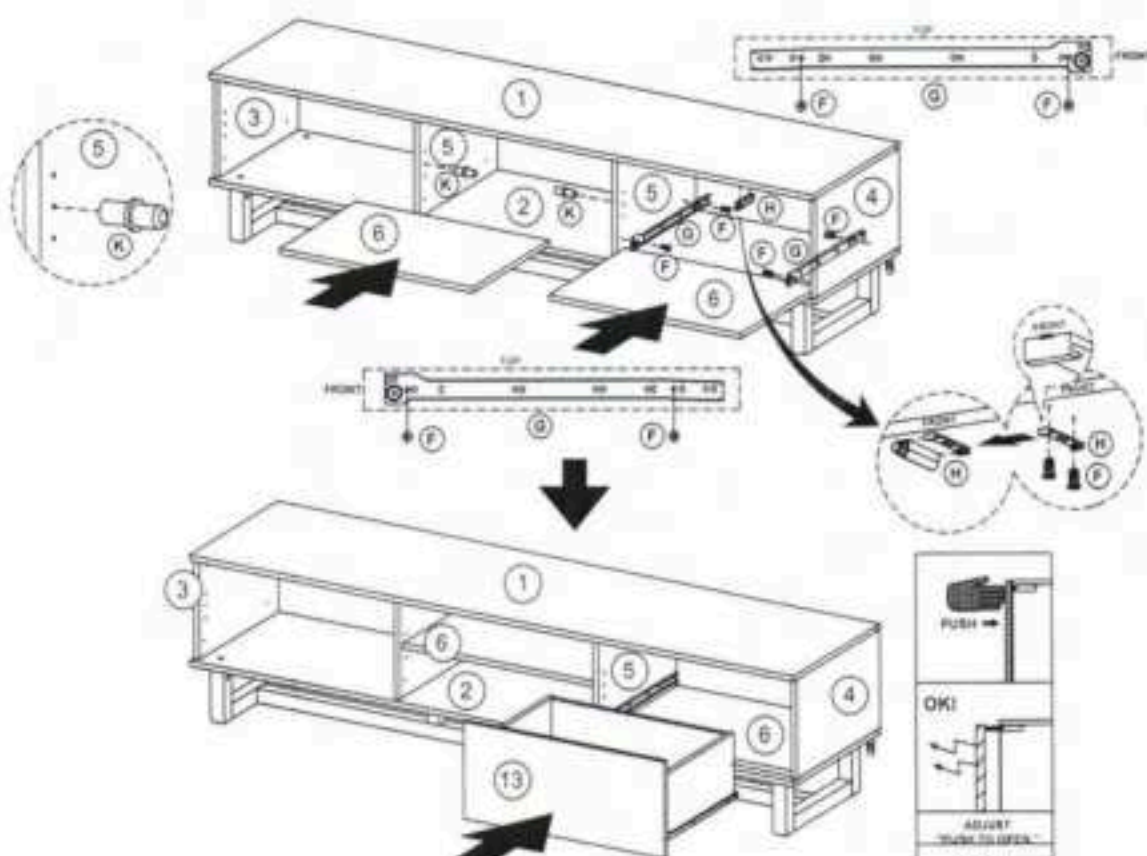
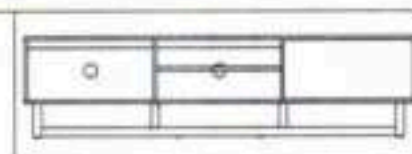

# RZ2100BO

17

OPTION 12

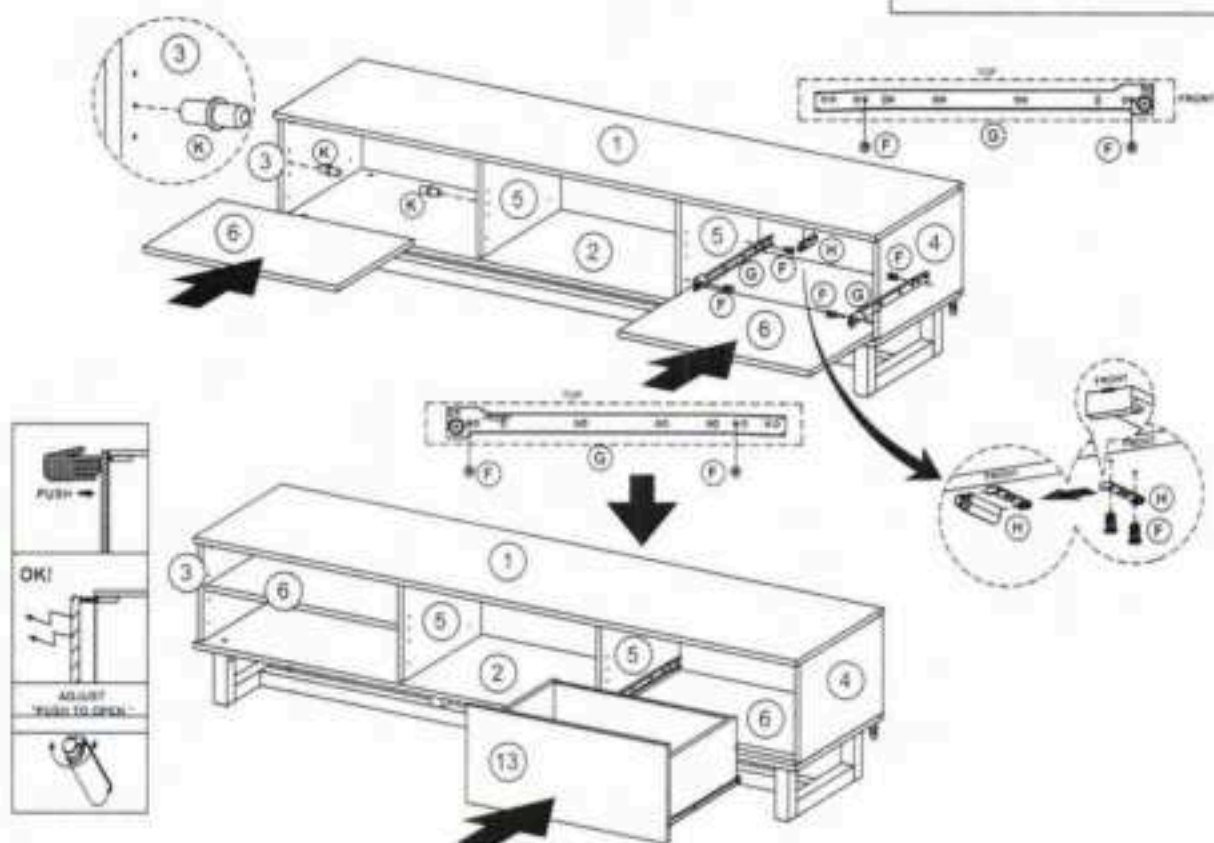

17

OPTION 13

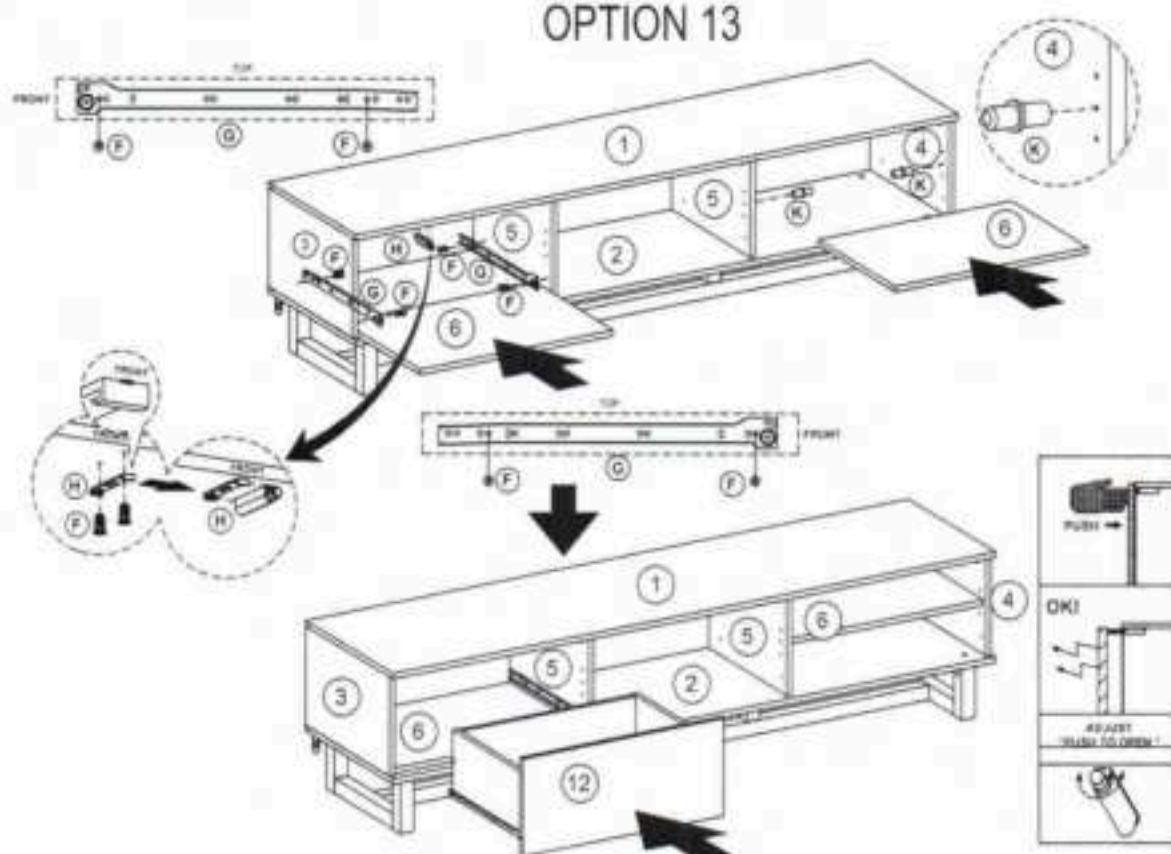

# RZ2100BO

18

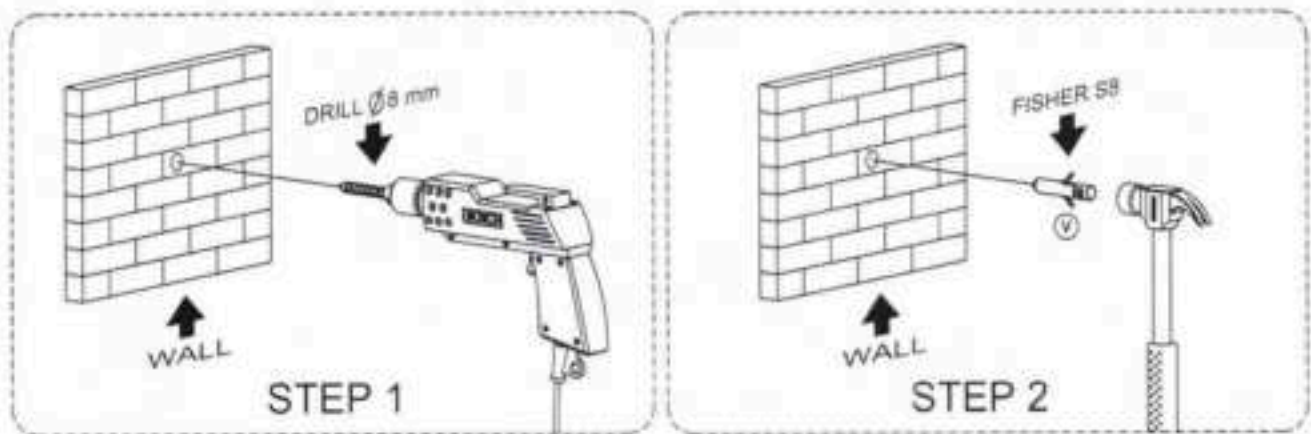

" We recommend using the safety bracket included or a Branded TV safety strap for your safety to prevent Cabinet & TV Tip over. "

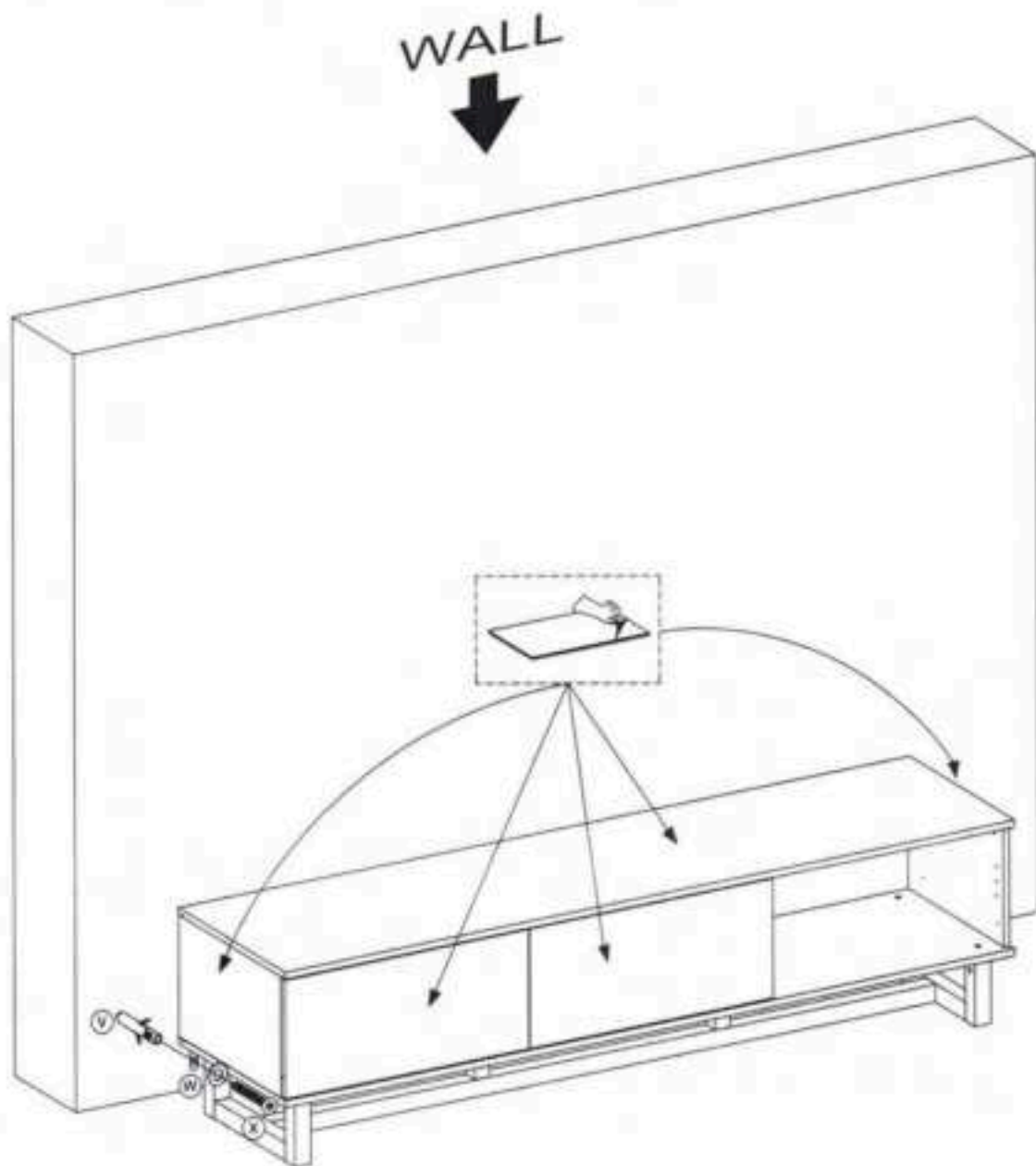

" Remove the protective plastic film from the panels before your start assembling the cabinets. "



NO	ID PART	DRAWING PART	DESCRIPTION	UNIQUE CODE OF HARDWARE
1	A		CAMLOCK (15 X 12 MM)	RZ2100BOA
2	B		CAMBOLT (7,5 X 32 MM)	RZ2100BOB
3	C		CAM CAP (17 MM)	RZ2100BOC
4	D		PEN DOWEL (8 X 32 MM)	RZ2100BOD
5	E		FLAT HEAD SCREW (10 X 33,5 MM)	RZ2100BOE
6	F		FLAT HEAD SCREW (6 X 8 MM)	RZ2100BOF
7	G		RAIL SELF CLOSING (350 MM)	RZ2100BOG
8	H		PUSH TO OPEN	RZ2100BOH
9	I		CAM STICKER (20 MM)	RZ2100BOI
10	J		FLAT HEAD SCREW (6 X 13 MM)	RZ2100BOJ
11	K		SHELF PIN	RZ2100BOK
12	L		BACKPLY STOPPER	RZ2100BOL
13	M		FLAT HEAD SCREW (4 X 19 MM)	RZ2100BOM
14	N		PAN HEAD SCREW (3 X 12 MM)	RZ2100BON
15	O		FLAT HEAD SCREW (6 X 50 MM)	RZ2100BOO
16	P		BARREL NUT	RZ2100BOP
17	Q		SPRING RING	RZ2100BOQ
18	R		PAN HEAD SCREW (6 X 45 MM)	RZ2100BOR
19	S		ALLEN KEY	RZ2100BOS
20	T		PAN HEAD SCREW (4 X 10 MM)	RZ2100BOT
21	U		L-PLATE	RZ2100BOU
22	V		FISHER 58	RZ2100BOV
23	W		WASHER PLATE	RZ2100BOW
24	X		FLAT HEAD SCREW (8 X 38 MM)	RZ2100BOX

NO	ID PART	DESCRIPTION	UNIQUE CODE OF HARDWARE
1	1	TOP PANEL	RZ2100BO1
2	2	BOTTOM PANEL	RZ2100BO2
3	3	SIDE PANEL (LEFT)	RZ2100BO3
4	4	SIDE PANEL (RIGHT)	RZ2100BO4
5	5	DIVIDER PANEL	RZ2100BO5
6	6	ADJUSTABLE SHELF	RZ2100BO6
7	7	TOP PANEL PIPE SUPPORT	RZ2100BO7
8	8	BACKPANEL	RZ2100BO8
9	9	SIDE LEG	RZ2100BO9
10	10	MIDDLE LEG	RZ2100BO10
11	11	BOTTOM SUPPORT PANEL	RZ2100BO11
12	12	FRONT DRAWER PANEL (LEFT)	RZ2100BO12
13	13	FRONT DRAWER PANEL (RIGHT)	RZ2100BO13
14	14	REAR DRAWER PANEL	RZ2100BO14
15	15	LEFT DRAWER PANEL	RZ2100BO15
16	16	RIGHT DRAWER PANEL	RZ2100BO16
17	17	BOTTOM DRAWER PANEL	RZ2100BO17