

# AI Bird Feeder Quick Guide

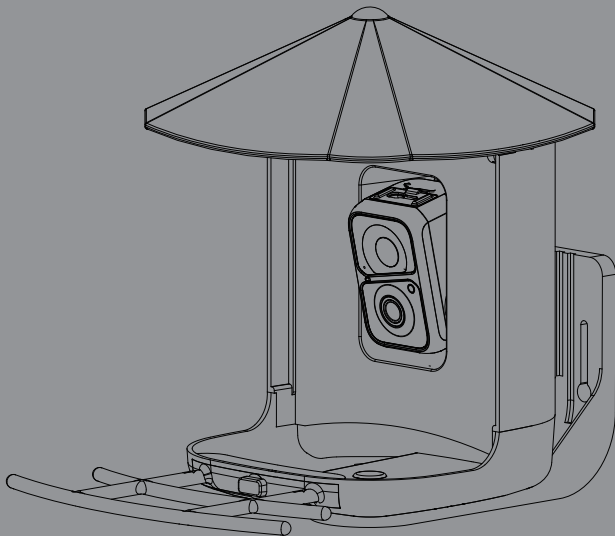

# Warning

NOTE: This equipment has been tested and found to comply with the limits for a Class B digital device, pursuant to part 15 of the FCC Rules. These limits are designed to provide reasonable protection against harmful interference in a residential installation. This equipment generates uses and can radiate radio frequency energy and, if not installed and used in accordance with the instructions, may cause harmful interference to radio communications. However, there is no guarantee that interference will not occur in a particular installation. If this equipment does cause harmful interference to radio or television reception, which can be determined by turning the equipment off and on, the user is encouraged to try to correct the interference by one or more of the following measures:

- Reorient or relocate the receiving antenna.
- Increase the separation between the equipment and receiver.
- Connect the equipment into an outlet on a circuit different from that to which the receiver is connected.
- Consult the dealer or an experienced radio/TV technician for help.

The antennas used for this transmitter must be installed to provide a separation distance of at least 20 cm from all persons and must not be co-located for operating in conjunction with any other antenna or transmitter.

FCC (USA) 15.9 prohibition against eavesdropping except for the operations of law enforcement officers conducted under lawful authority, no person shall use, either directly or indirectly, a device operated pursuant to the provision of this part for the purpose of overhearing or recording the private conversations of other unless such use is authorized by all of the parties engaging in the conversation. Changes or modifications not expressly approved by the party responsible for compliance could void the user's authority to operate the equipment.

FCCID: 2AY58-V1-VN-DB01

## **IC Caution:**

- English:

This device contains licence-exempt transmitter(s)/receiver(s) that comply with Innovation, Science and

Economic Development Canada's licence-exempt RSS(s). Operation is subject to the following two conditions:

This device may not cause interference.

This device must accept any interference, including interference that may cause undesired operation of the device.

**CE RED** This product can be used across EU member states.

# Catalog

1. What's In The Box	P. 1-3
2. Camera Structure	P. 4-5
3. Insert Micro SD Card	P. 6-7
4. Assemble Bird Feeder	P. 8-9
5. Battery Charging	P. 10
6. How To Turn On & Off The Camera	P. 11
7. Read Before Installation	P. 12
8. Set Up With Vicohome App	P. 13
9. Installation	P. 14-28
10. Cleaning Bird Feeder	P. 29-35
11. How to Add Bird Seed	P. 36-37
12. Status Light	P. 38
13. AI Bird Recognition	P. 38

# What's In The Box



Roof

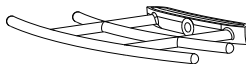

Perch

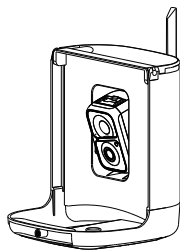

Bird Feeder



Tripod Adapter

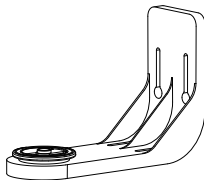

Mounting Bracket

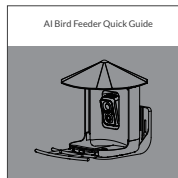

Quick Guide

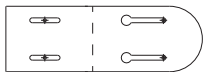

Drilling Template

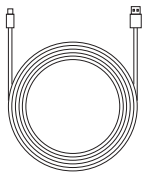

Type C Power Cable

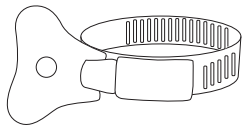

Hose Clip

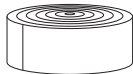

Black Strap



Perch Screw



Mounting Screws



Anchors



Ejector Pin

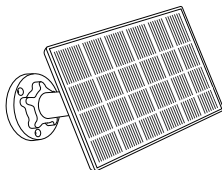

Solar Panel

# Camera Structure

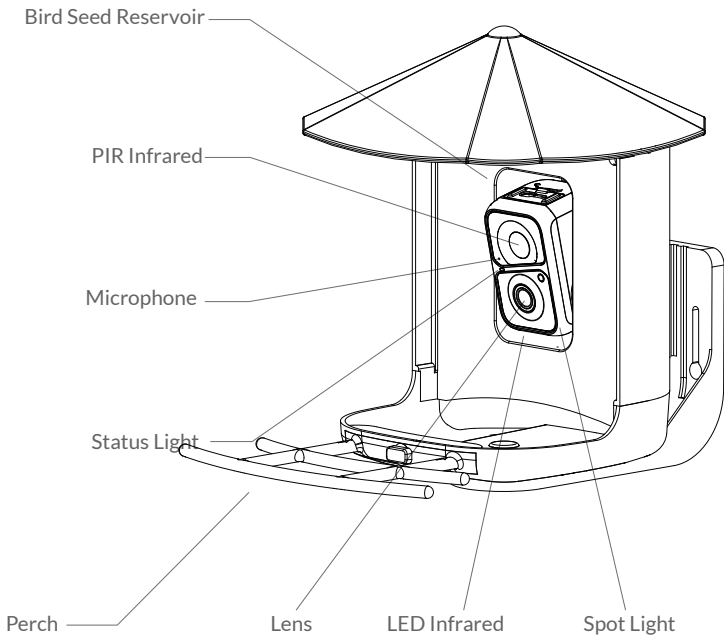



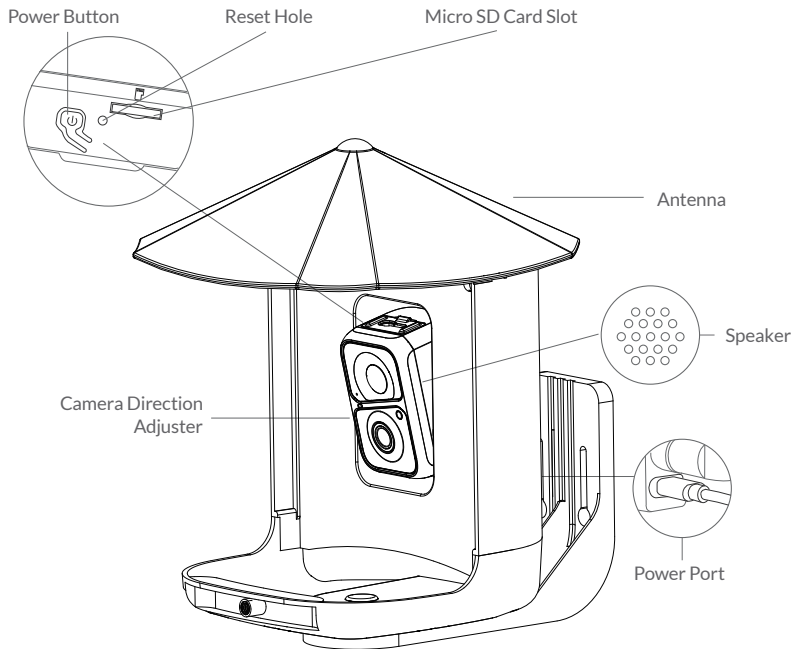

# Insert Micro SD Card

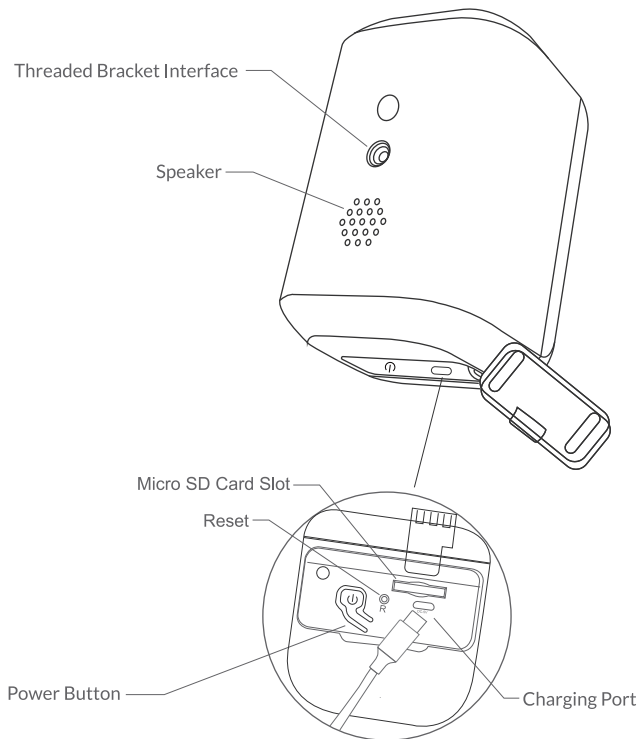

Bird Cam comes with a built-in card slot which supports up to 128GB Micro SD card.

**Step 1:** Rotate the camera down to the bottom.

**Step 2:** Open the top silicone plug. Insert the Micro SD card. Make sure to plug it in the right direction.

**Step 3:** Finally, Cover silicone plug.

# Assemble Bird Feeder

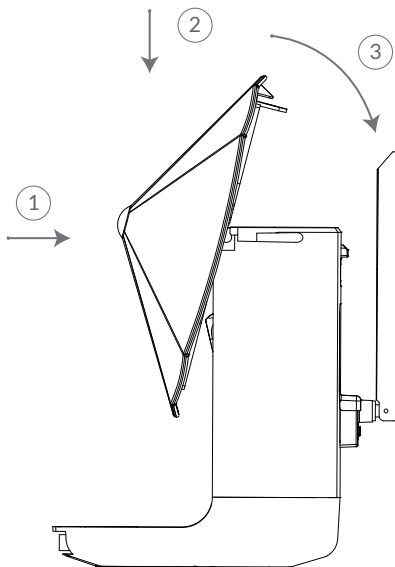

## Assemble the roof

**Step 1:** Face up the side of the roof with the buckles. Align the small pillar on both the left and the right side with the buckles of the white bird seed container.

**Step 2:** Push down to insert.

**Step 3:** Then rotate back to install the buckle behind the white bird seed container.

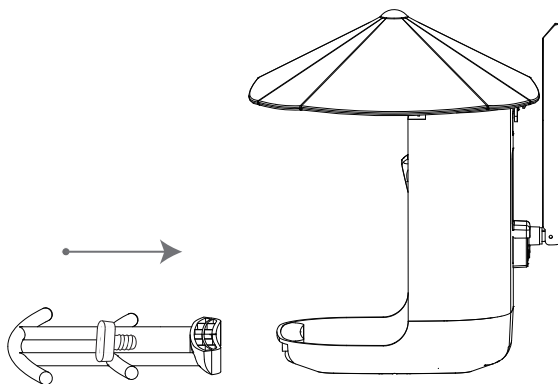

### Assemble Perch

Use the provided perch screw to install the perch.

# Battery Charging

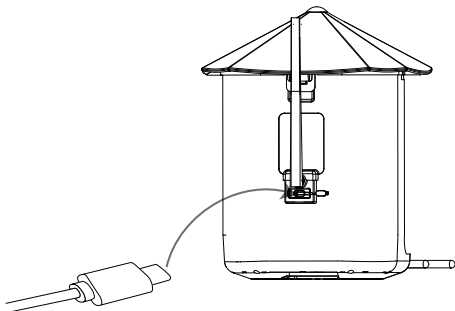

The batteries inside the camera are not fully charged according to the transportation safety regulations. Please fully charge the camera before using it. Please charge the batteries with provided Type C Port Cable (DC5V / 1.5A adapter not included).

The status light will be in solid yellow when charging, and will turn to solid green when it is fully charged. It takes about 14 hours to fully charge your camera.

# How To Turn On & Off The Camera

To turn on the camera:

Long press the power button for 3s to turn on the camera. Then the Status Light in the front of the camera will be solid blue. Double click the power button to enter WiFi mode after the prompt tone.

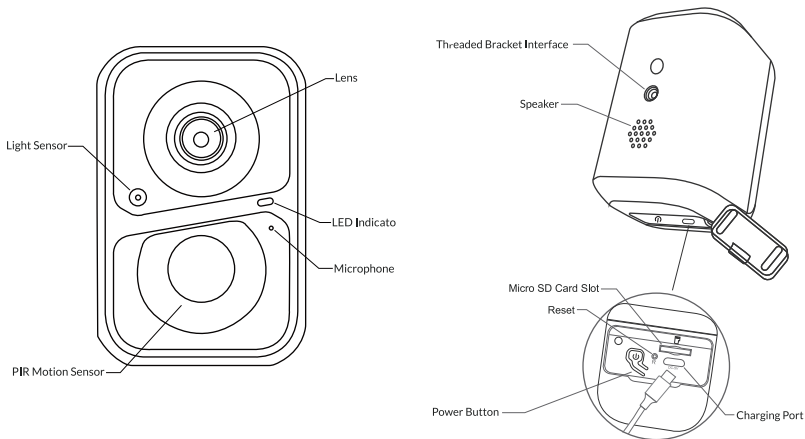

To turn off the camera:

Long press the power button for 3s to turn off the camera. Then the Status Light in the front of the camera will be off.

# Read Before Installation

1. Keep Bird Feeder and all accessories out of reach of children and pets.
2. Make sure the camera has been fully charged (DC5V / 1.5A).
3. Working temperature: -10°C to 50°C (14°F to 122°F)  
Working relative humidity: 0-95%
4. Please do not expose the camera lens to direct sunlight.
5. The camera has an IP65 waterproof rating, which supports working properly under rains or snows. But it can not be soaked in water.

## **Note:**

1. Bird Feeder Cam only works with 2.4GHz Wi-Fi.
2. Strong lights may interfere with the device's ability to scan QR code.
3. Avoid placing the device behind furniture or near microwaves products. Try to keep it within range of your Wi-Fi signal.



## Set Up With Vicohome App



Download Vicohome App from App Store or Google Play. You can also download the App by scanning the QR code above with the QR code scanner in your smartphone

# Installation

**Check the following things before you drill holes on your wall:**

Bird Feeder Cam has been successfully added to your Vicohome App and is able to stream video.

## Wall Installation:

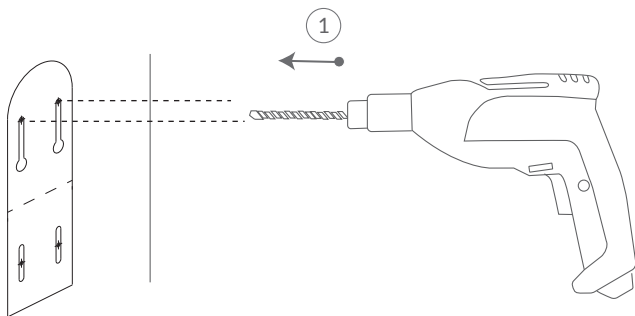

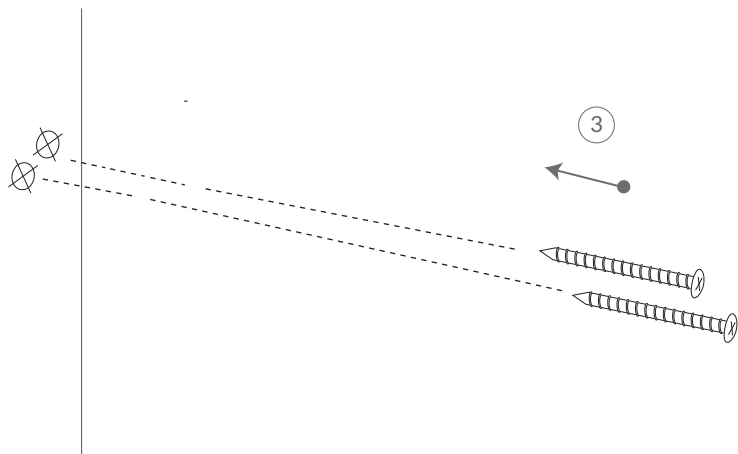
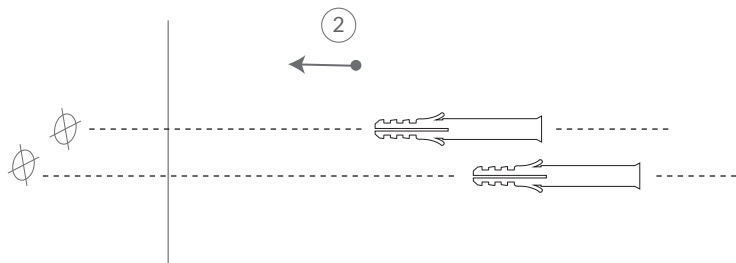

### Step 1:

1. Use the provided drilling template to mark the position of holes on your wall. Use drill bit (5/16", 8mm) to drill two holes.
2. Install the anchors to fix the screws. (Install on wood skip this step.)
3. Install the Mounting Bracket on your wall with the screws provided.

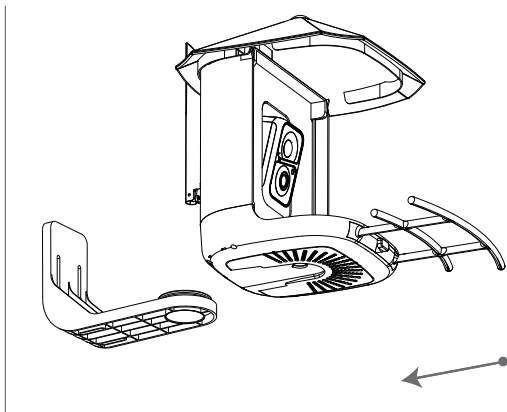

### Step 2:

Slide the Bird Feeder into the bracket through the slide rail.

## Tree Installation:

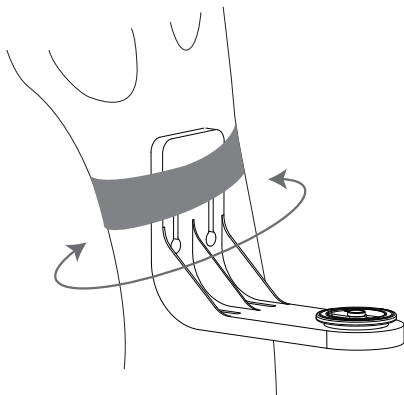

**Step 1:** Wrap the Mounting Bracket around the tree with the Black Strap.

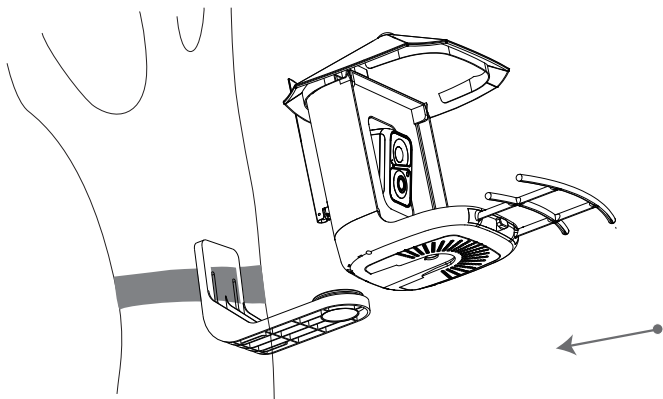

**Step 2:**Slide the Bird Feeder into the mounting bracket.

## Stand Installation:

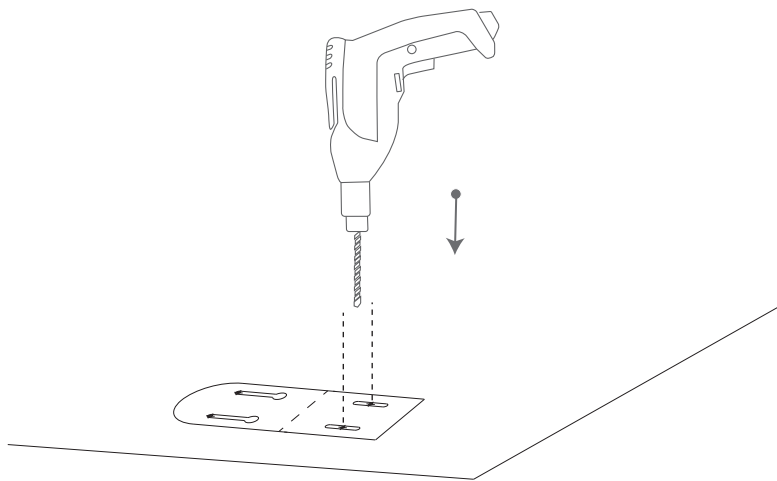

### Step 1:

The Bird Feeder can be placed steadily on a flat surface, but for stability, we recommend that the backplane is installed and fixed on a flat surface.

Use the provided drilling template to mark the position of holes on flat surface. Use drill bit (5/16", 8mm) to drill two holes.

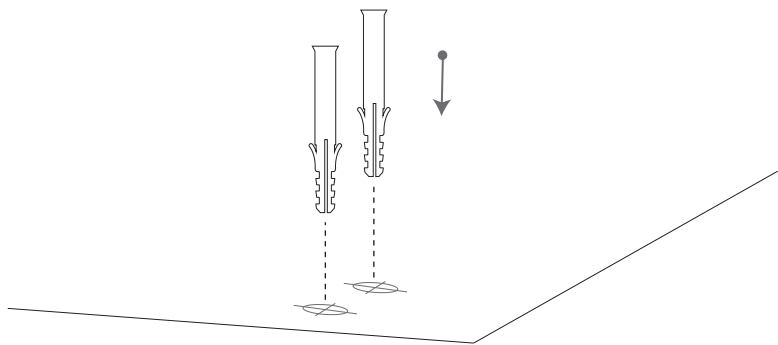

**Step 2:**

Install the anchors to fix the screws. (Install on wood skip this step.)



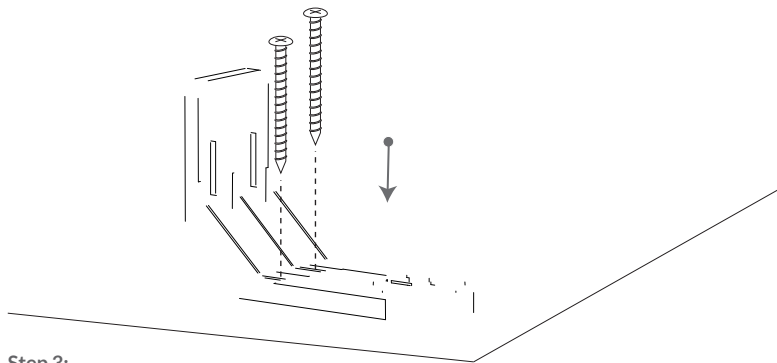

**Step 3:**

Install the Mounting Bracket on flat surface with the screws provided.

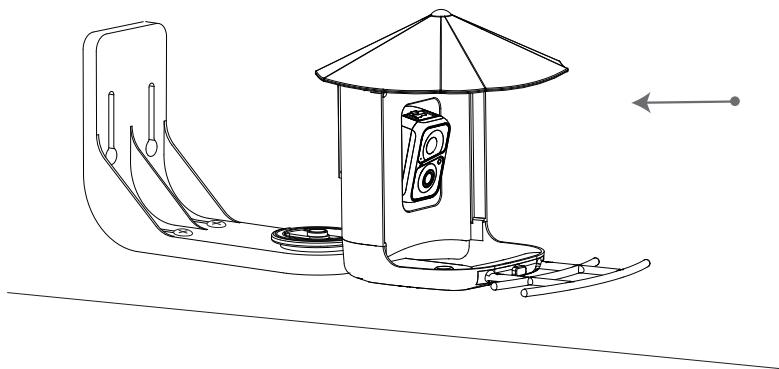

**Step 4:** Slide the Bird Feeder into the mounting bracket.

## Tripod Installation:

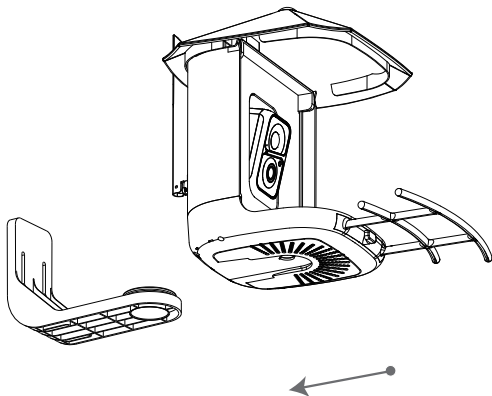

Make sure you don't have the bracket installed on the bottom of the Bird Feeder. If you need to remove it, please take a look at "Step 2 of Cleaning Bird Feeder" for instructions on how to remove the bracket.

### **Step 1:**

Slide the Bird Feeder into the Tripod Adapter.

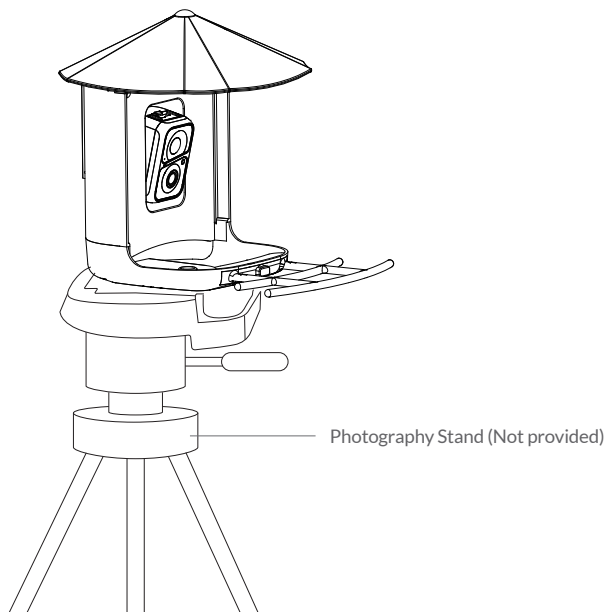

**Step 2:**

Install the Bird Feeder on the corresponding accessories, such as a photography stand (not provided).

**Pole Installation - Hose clip**

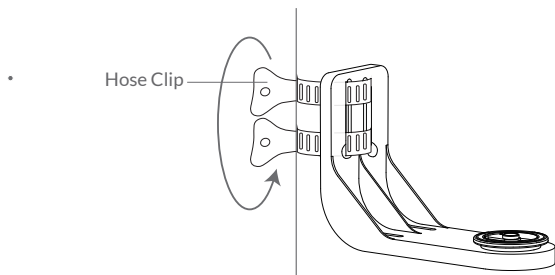

**Step 1:** Attach Bird Feeder to the pole with the Hose Clip turning the handle clockwise.

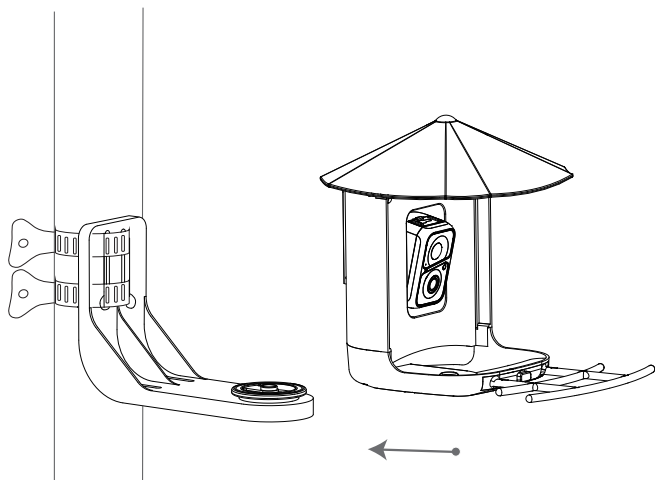

**Step 2:** Slide the Bird Feeder into the bracket through the slide rail.

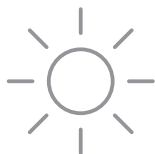
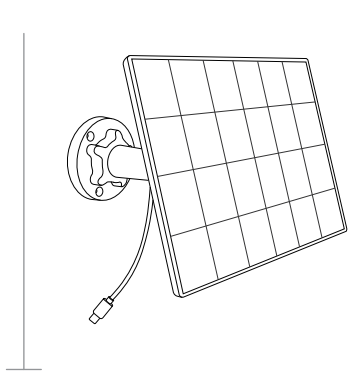

**Step 1:**

Find a good installation point and install the Solar Lite in a sunny location.

Solar Lite

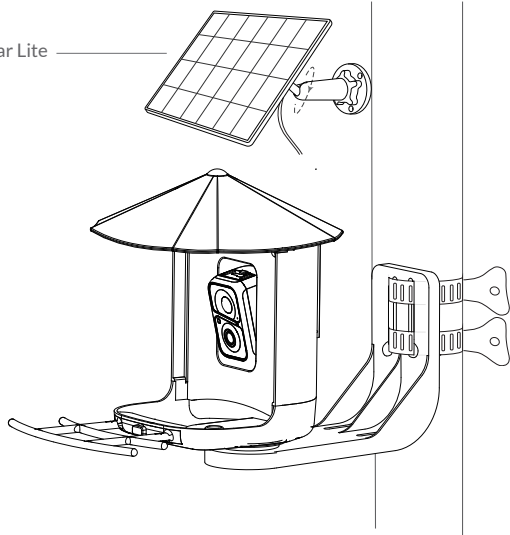

**Step 5:** Bird Feeder is installed and ready for bird watching.



# Cleaning Bird Feeder

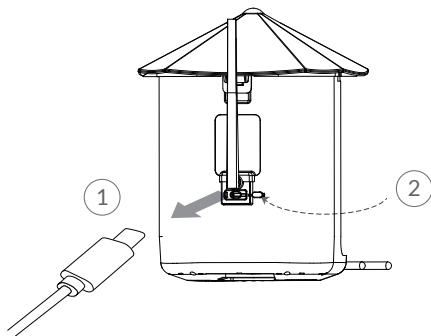

**Step 1:**Unplug the charging cable and put on the silicone cover.

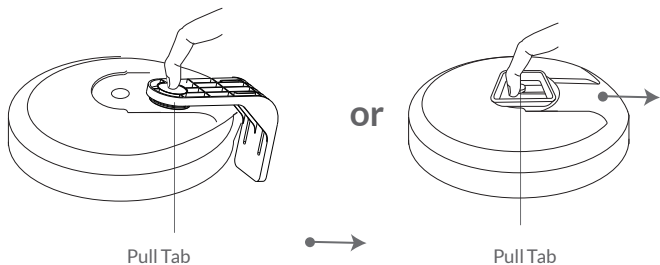

**Step 2:** Using the Pull Tab on the base of the feeder, remove the Bird Feeder from the bracket.

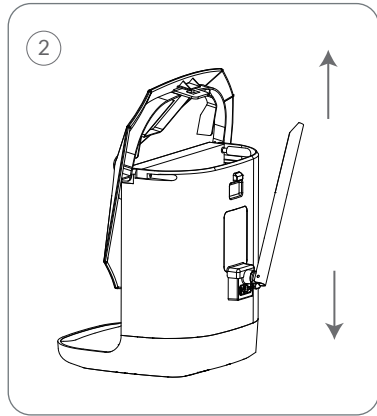
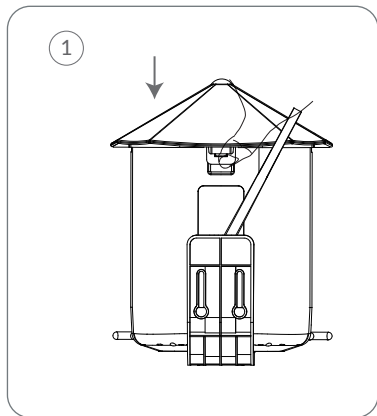

**Step 3:** Open up the buckle on the back of the Bird Feeder, and pull up on the roof to open.

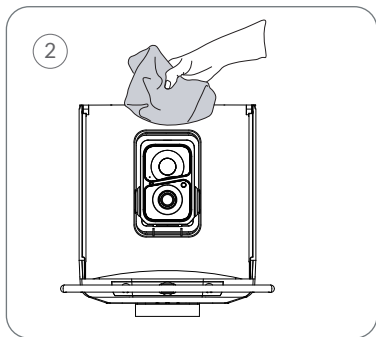

**Step 4:** Pour water into the top of the seed reservoir. Do not wash the camera or any of its components. They are water resistant, not water-proof.  
Dry the feeder, including the seed reservoir.

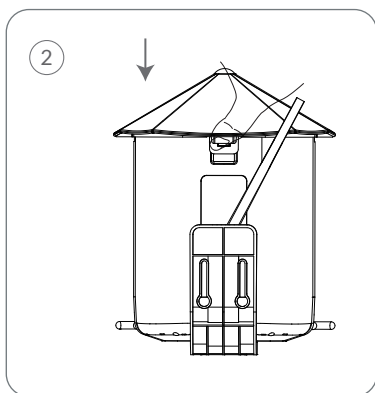
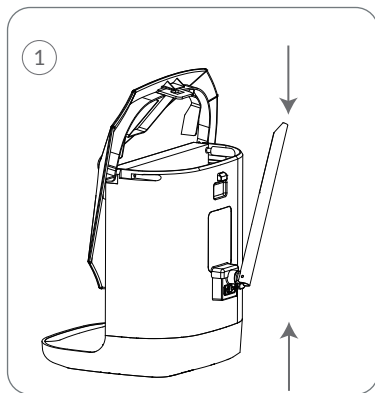

**Step 5:** Re-attach the Roof: Push the roof down and engage the snaps on the back of the Bird Feeder.

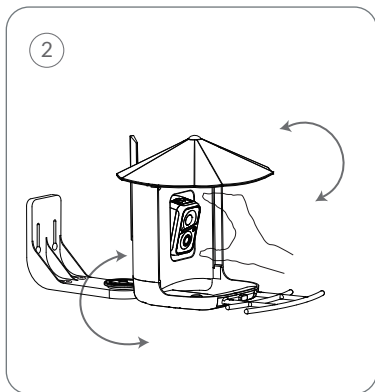
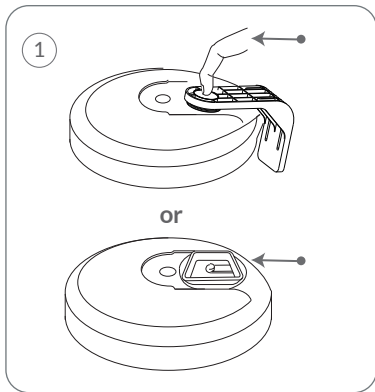

**Step 6:** Re-attach the bracket to the Bird Feeder base. Adjust the angle for both the Bird Feeder and camera.

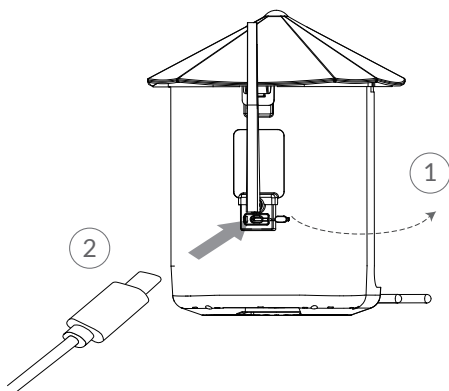

**Step 7:**Open the silicone plug, re-plug in the Solar Lite.

# How to Add Bird Seed

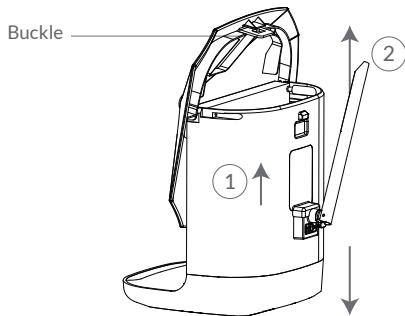

**Step 1:** Open up the buckle on the back of the Bird Feeder, and pull up on the roof to open.



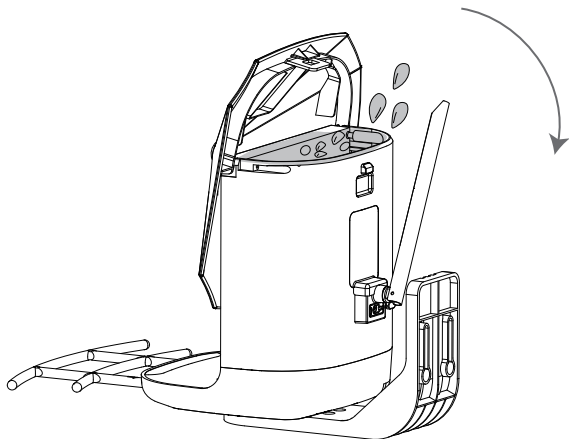

**Step 2:** You can add bird seed. Finally, close the roof back.

# Status Light

This camera uses status light to communicate.

LED Indicator	Description
Solid Blue	Working
None	Sleep/Power Off
Solid Yellow	Charging
Solid Green	Charging Finished

## AI Bird Recognition

\* This service requires a subscription.

AI Bird Recognition has undergone massive machine learning and uses AI intelligent recognition algorithms to inform you in real time "what species of bird are coming", automatically save the bird images/videos data for you, and also provide bird knowledge learning and so on.