

Tuya Smart Lock Instructions(2.4G Wi-Fi/ ZigBee)

1. Install Tuya app

1-1. Search "**Tuya Smart Life**" in the mobile software application market or scan the QR code to download.

<https://apps.apple.com/us/app/tuyasmart/id1034649547> (IOS, Apple Iphone App store link);

<https://play.google.com/store/apps/details?id=com.tuya.smart>(Googleplay, Android Smartphone App link);



2. Add gateway(EZ mode/ AP mode)

2-1. Use mobile phone number or email to register a Tuya account and log in Tuya app.

2-2. Click "Add Device" or "+" on the top right of the APP homepage to enter the "Add Device" page.

2-3. Select "Gateway Control", then select "Wireless Gateway (ZigBee)"

2-4. The system will connect to the WiFi that currently connected to the phone. (Note: The connected WiFi must be 2.4GHz)

2-5. EZ mode connection/ AP mode connection

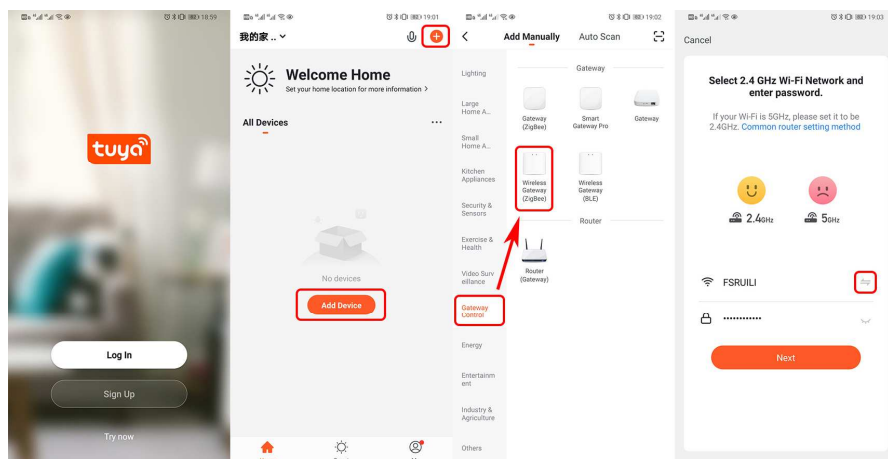

a. EZ mode

- ① Press and hold the reset button of the gateway for 5 seconds, wait for the red indicator light rapidly blink, and the blue light is on;
- ② Click Next and APP will add the gateway automatically.

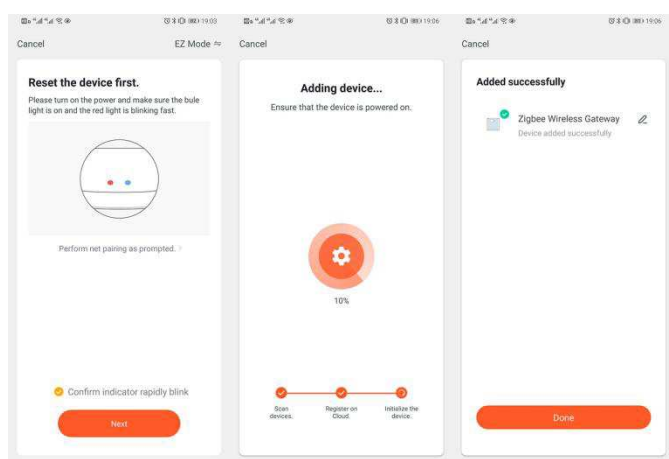

b. AP mode (Compatible mode)

- ① Click reset button of the gateway, select "AP mode (Compatible Mode)", and click Next.
- ② Click "Go to connect", it will jump page to the system WiFi connection page, select "SmartLife".
- ③ Return to the Tuya app, APP will add the gateway automatically.

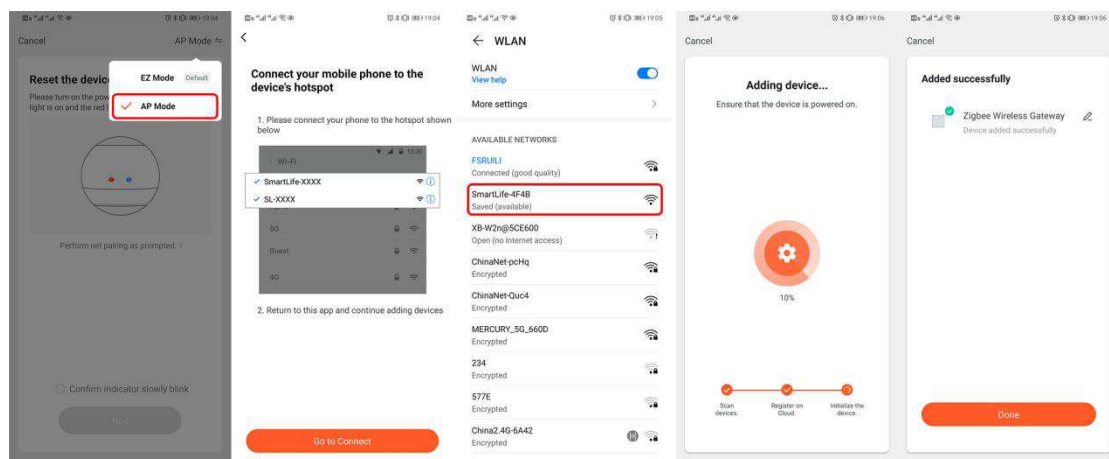

3. Add smart lock

- 3-1. Press the "reset button" of the smart lock for 5 seconds, and then verify the administrator and enters the system settings. Select "3. Mode", and then select "4. WiFi Set", the lock enters WiFi connection state.
- 3-2. Click "Zigbee Wireless Gateway" on the Tuya app, select "Add Sub device". Click "LED already blink", gateway detects and add the lock automatically.

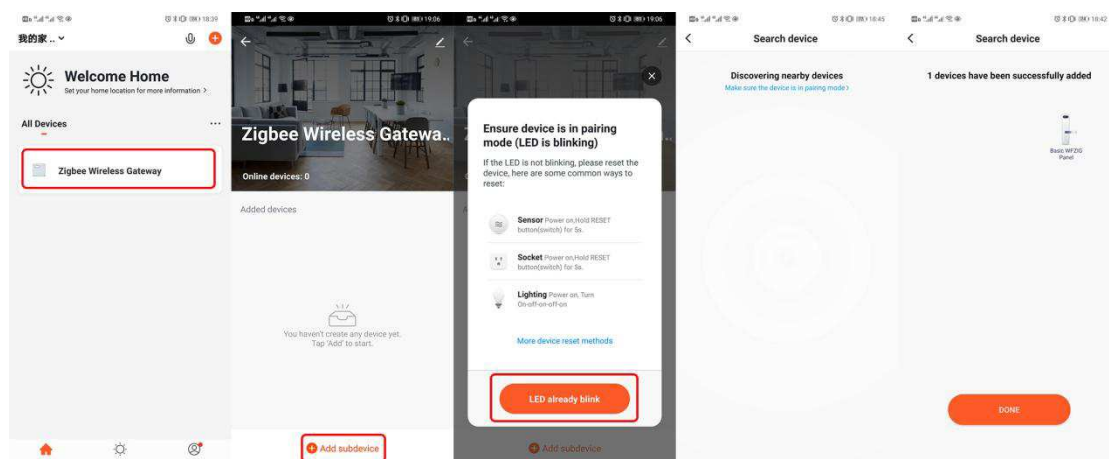

4. Remote unlock

- 4-1. Enter the settings of the lock, select "No password is required" in the Remote door opening management.
- 4-2. Click to unlock, and then confirm to unlock the lock by APP.

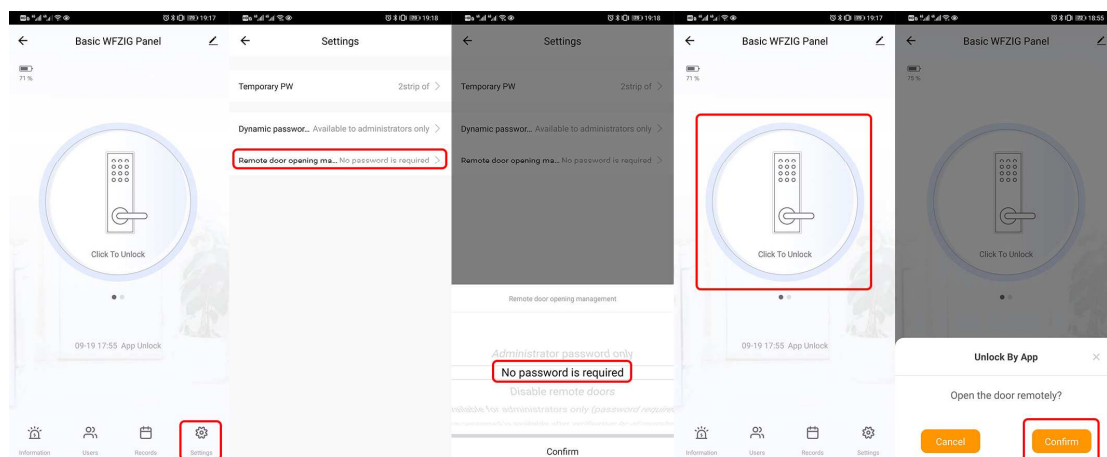

5. Temporary password

5-1. Enter settings of the lock, add temporary password with number 1-6, fill in "Password name", "Effective Time" and "Expiration Time", click "done" to confirm. (Note: Please use number 1-6 as the password, random generation is not allowed, otherwise it will not workable.)

