

Please note:the actual sizes for our greenhouses are different from the headline sizes we list on our website. Please bear this in mind when preparing your base. You can find exact base dimensions in mm's below.

# RHINO Premium

greenhousesdirect

## Premium 6ft base footprint 2024

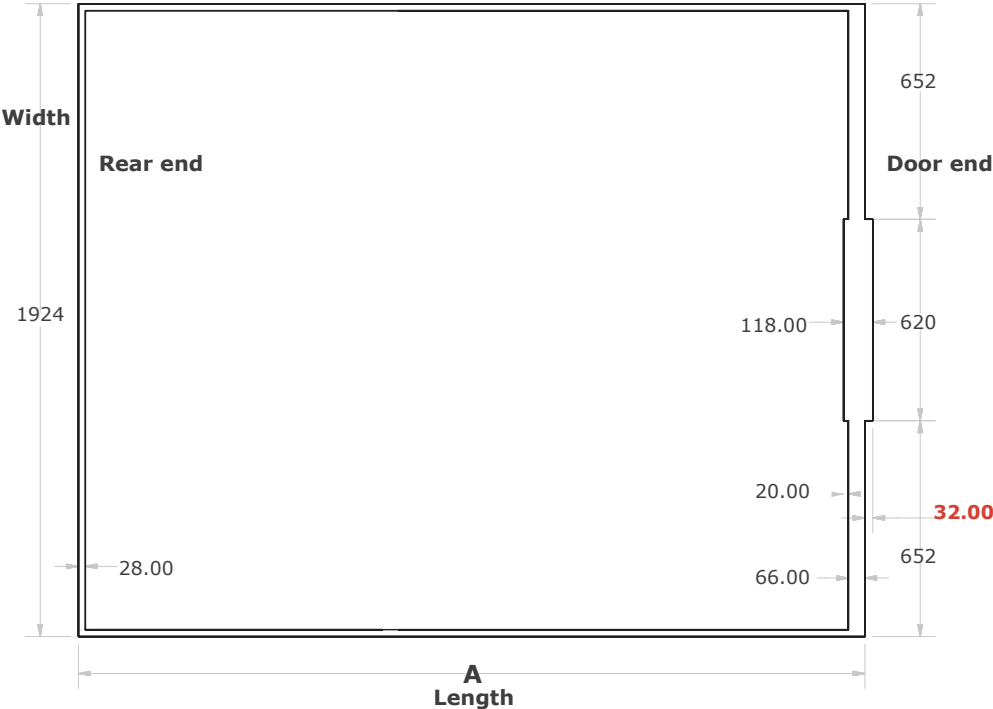

Nominal description		4'	6'	8'	10'	12'
Exact Length mm	A	1305	1923	2541	3159	3777

**Rhino Greenhouses Direct DO NOT RECOMMEND the use of hardcore [X], hogging [X] and shingle [X] as suitable base materials due to issues surrounding levelling and securing of greenhouse.**

### Base Footprint

The footprint shown here is the point of contact between the base section and the ground. The Rhino can be sited onto soil or a hard standing base. For a soil site, the Rhino requires flat level (spirit level) compact, firm soil and for the ground anchors (supplied) to be concreted into the soil after the greenhouse has been glazed. The location of the anchors varies according to the model. Membrane and shingle can be added inside after installation.

Please ensure that **32.00mm** is added to the overall base length to accommodate the door ramp.

### Soil bases

Please note that on completion of your Rhino, the internal and external ramps must be supported. The best way to achieve this is to excavate the soil and lay a path as shown taking care not to allow the ramp to lift and foul the door when sliding.

### Hardstand

The most common hardstand bases are either a perimeter base of slabs, concrete, with beds for growing into the ground and/or drainage, full slab base, or full concrete base with drainage.

However if for example you decide on installing a concrete strip foundation, you must be sure to make allowances for fixing down through each anchor as shown below. Failing to make the concrete strip wide enough could result in the foundation cracking as you drill the anchors points.

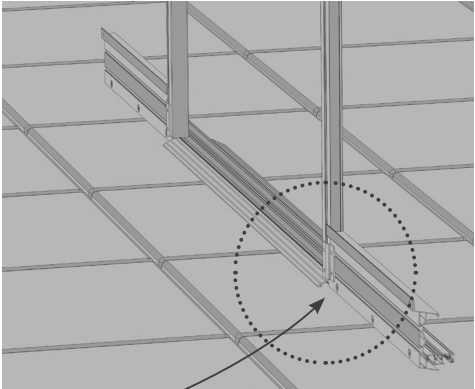
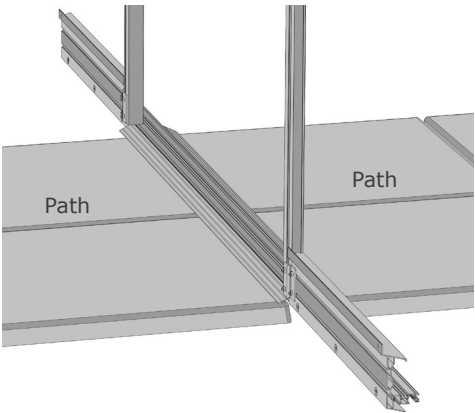
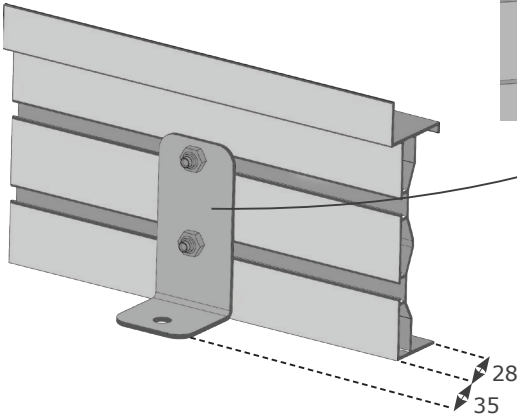

**Please note:the actual sizes for our greenhouses are different from the headline sizes we list on our website. Please bear this in mind when preparing your base. You can find exact base dimensions in mm's below.**

**Brick Plinth Base plan**

This Base plan must be adhered to allow the correct installation and subsequently allow for correct anchoring.

outside edge of the bricks. This will ensure that the Anchors can be fitted correctly. See below for full details.

Once the base is built, position the greenhouse so that the Inside of the front door base is aligned flush with the inside row of bricks. The sides and rear base will finish flush with the

Please note that on completion of your Rhino the internal ramp must be supported. The best way to achieve this is to install a path as shown.

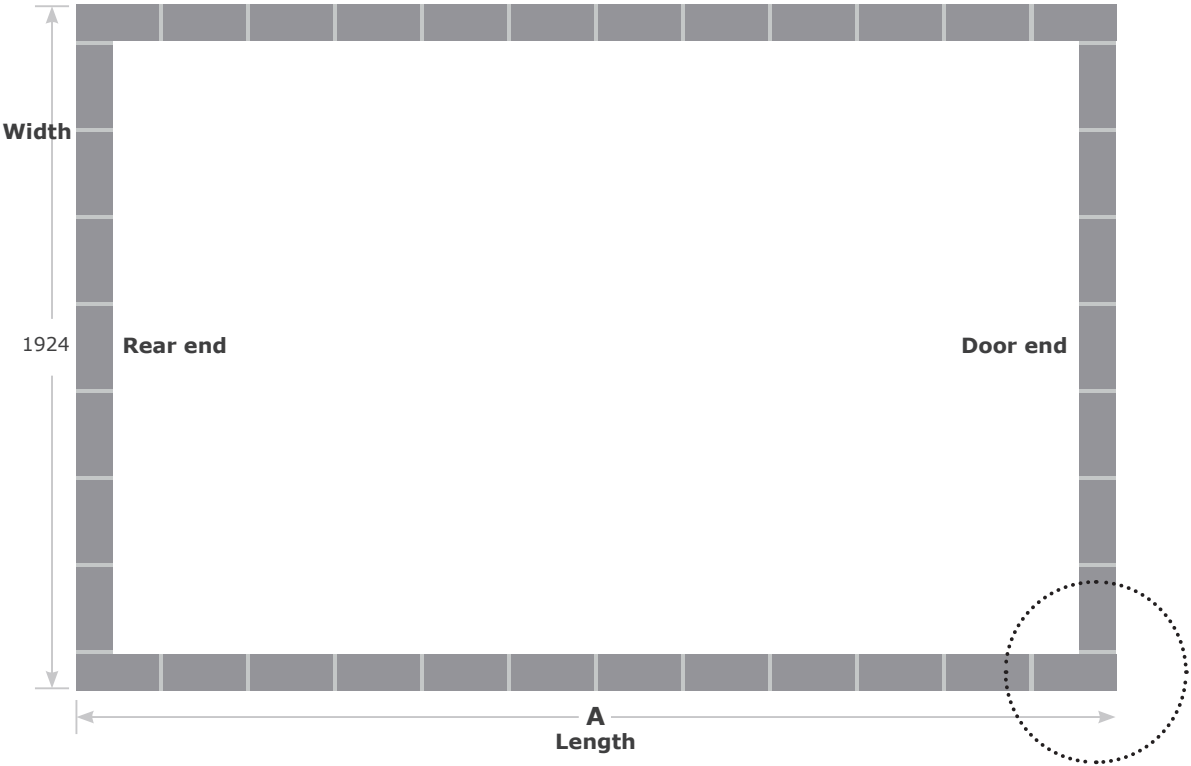

Nominal description		4'	6'	8'	10'	12'
Exact Length mm	A	1341	1959	2577	3195	3813

**Greenhouses Direct RECOMMEND solid and flat engineered bricks to ensure a good anchor point.**

