

HEAVY DUTY E TRACK L SHAPED SHELF BRACKET

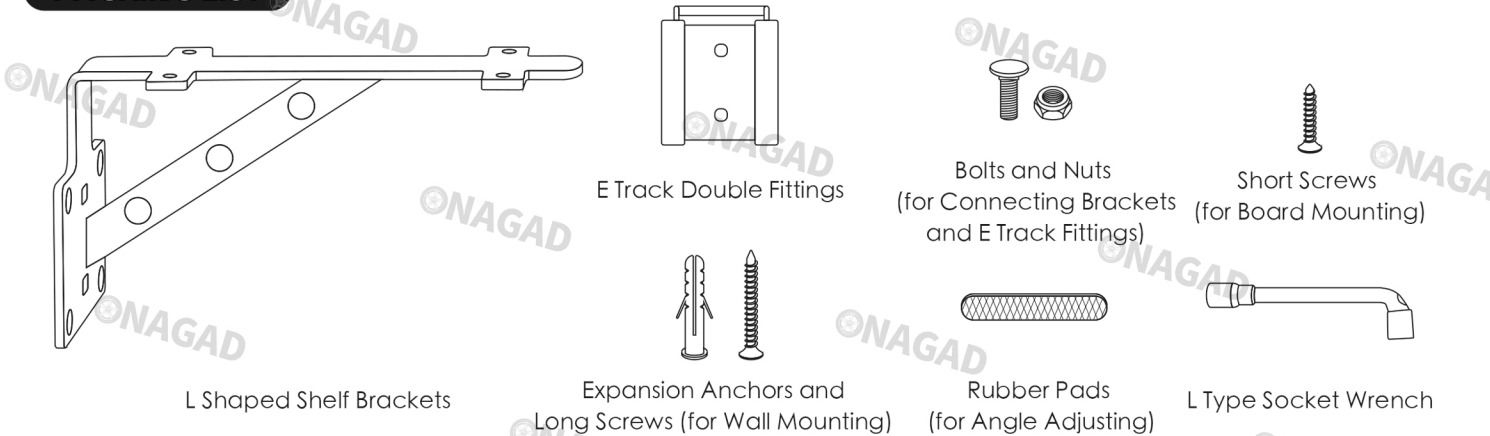

PACKING LIST



METHOD 1: E TRACK SYSTEM

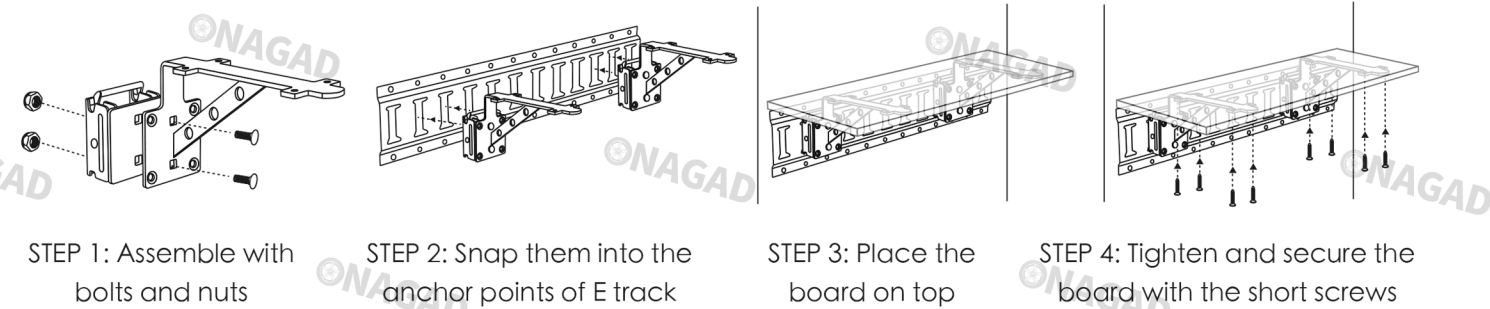

Q: Why do the brackets drop down and are not square to the wall when mated to the E-track?
A: By nature of how the e track works , the shelf will have a certain "looseness" to it. It's normal for the shelf to lean forward a bit. E track is made more for things to pull on it. On the shelf bracket, the physics of the shelf push down on the bottom of the bracket and the result is a bit of a tip forward.

How to Do?

Solution 1: Because each manufacture produce E-tracks that vary in specifications, you will need to go to the store and buy shims of a certain thickness to use the washers as spacers to lift the front edge, depending on the situation.

Solution 2: Attach the rubber pads in the package to the E-track connectors to lift the front edge.

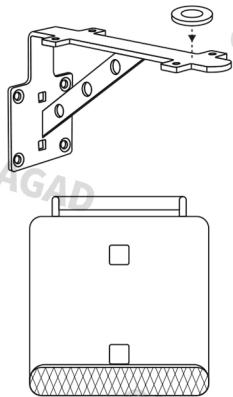

METHOD 2: WALL MOUNTING

