

VERA DREAM BED ASSEMBLY INSTRUCTION



Vendor Information	
Vendor Name:	LSMX1
Vendor Code:	V-005852

Living Space Information	
Vendor Collection:	VERA DREAM NON STORAGE

ITEM	DESCRIPTION	QUANTITY
1	VERA DREAM HEADBOARD	1
2	VERA DREAM RAILS/SLATS	1
3	VERA DREAM FOOTBOARD	1

		LIVING SPACES	
1	HEADBOARD		X1
2	RAILS/SLATS		X2
3	FOOTBOARD		X1

Hardware bag included in side rails and slat box with red ribbon to located.

A	5/16-18X1" SCREW BUTTON HEAD CAP		X8
B	WASHER 5/16 PLAIN		X8
C	3/16 SHORT ARM HEX KEY		X2
D	5/16-18X1 1/2" SCREW BUTTON HEAD CAP		X2

VERA DREAM BED NON STORAGE

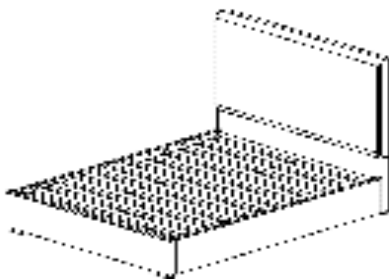

STEP 1: Attach side rails to headboard using Wrench(C), 4 Screws (A) and Washers (C).

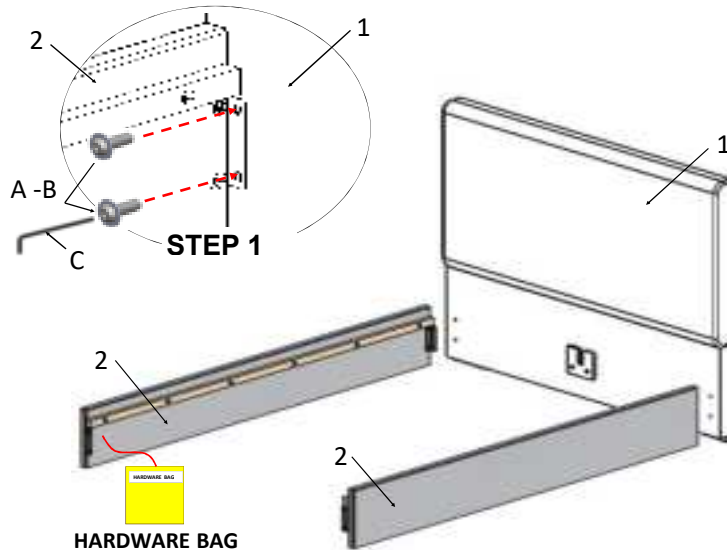

STEP 2: Attach Footboard to side rails using Wrench(C), 4 Screws (A) and Washer (C).

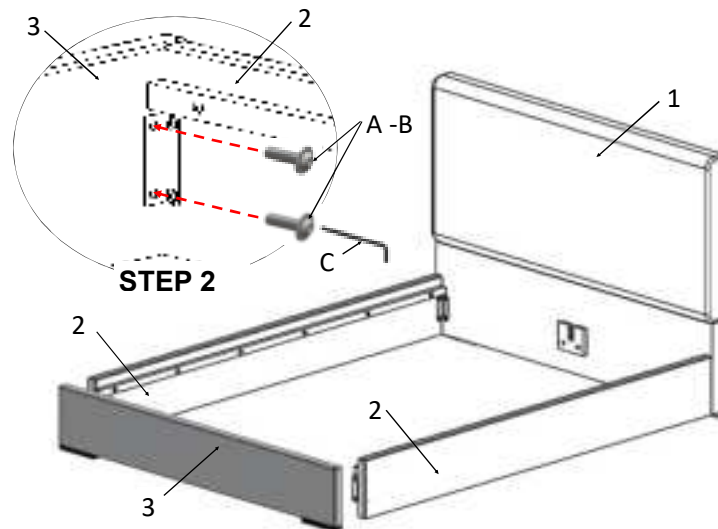

VERA DREAM BED ASSEMBLY INSTRUCTION



Vendor Information

Vendor Name: LSMX1
Vendor Code: V-005852

Living Space Information

Vendor Collection: VERA DREAM NON STORAGE

STEP 3: Attach the support legs with leveler to the center slat. Adjust the levers on bottom of support legs when necessary.

STEP 4: Place the piece from top to bottom into the U-shaped slot.

CENTER QUEEN BED - 1 QTY (5 Support legs)
CENTER CK BED - 1 QTY (5 Support legs)
CENTER EK BED - 2 QTY (10 Support legs)

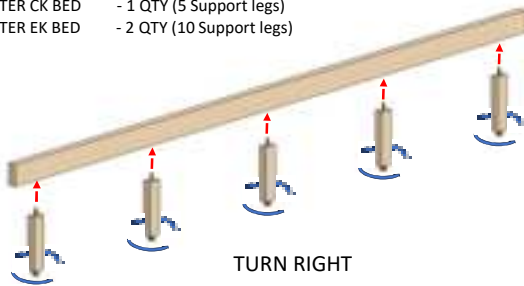

STEP3

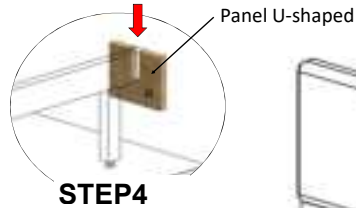

STEP4

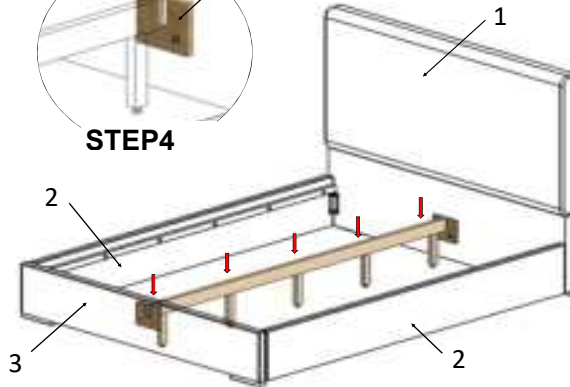

STEP 5: Unroll the slats onto the center slat starting at the footboard and ending at the headboard.

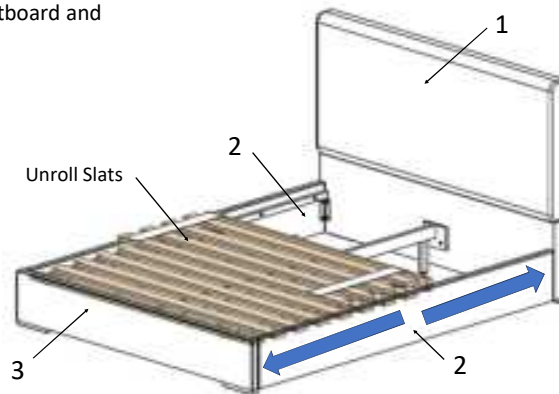

STEP 6: Verify the slats are installed properly the legs are perpendicular to the floor for full support.

