

Ealing outdoor spotlights

INSTRUCTIONS

Ground spotlight	1
Path spotlight	5
Surface spotlight	9
Flush spotlight	12
Straight connector	15
Split T connector	17

Ground spotlight

INCLUDED

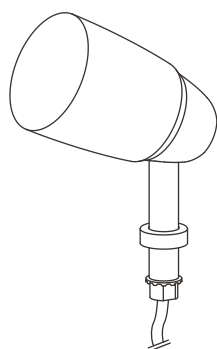

Light body x1

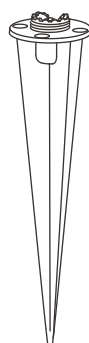

Spike x1



Rubber gasket x1



Spike cover x1

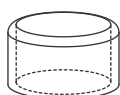

Glass bulb cover x1



Glass bulb cover tool x1

Ground spotlight instructions

TOOLS YOU'LL NEED



Lights must be installed by a qualified electrician.
All lights should be installed in dry conditions.
Turn off electrical supply to circuit before installation.

Location	Exterior
Class	Class I
IP rating	IP56
Driver required	No
Fire rating	No
Cable length	3000mm
Bulb type	GU10
Max wattage	8W
Bulb included	No
Switched	No
Dimmable	Bulb dependent
Rated voltage	220V-240V
Rated frequency	50-60Hz

Ground spotlight instructions

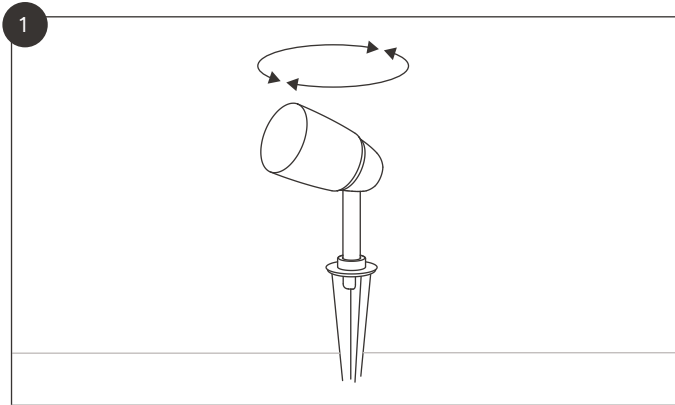

Align the spotlight direction with the spike.

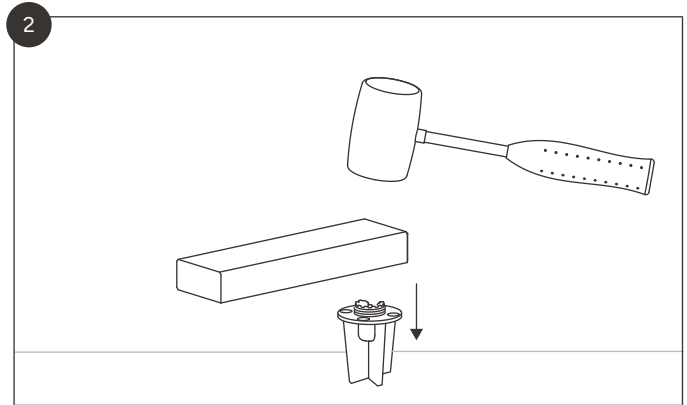

Remove the light body and hammer the spike into position.

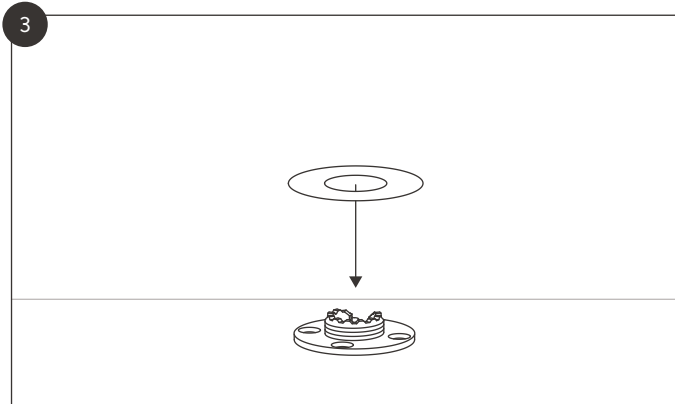

Cover the base with the brass spike cover.

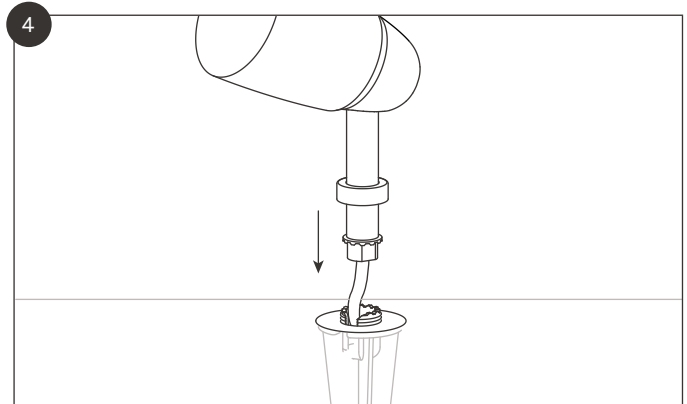

Feed the cable into position.

Ground spotlight instructions

5

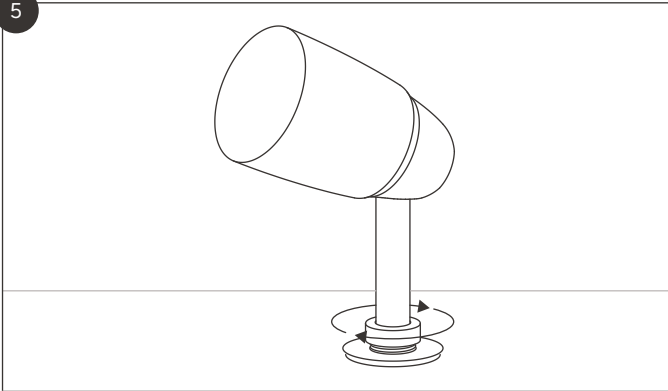

Place the light and tighten the collar.

6

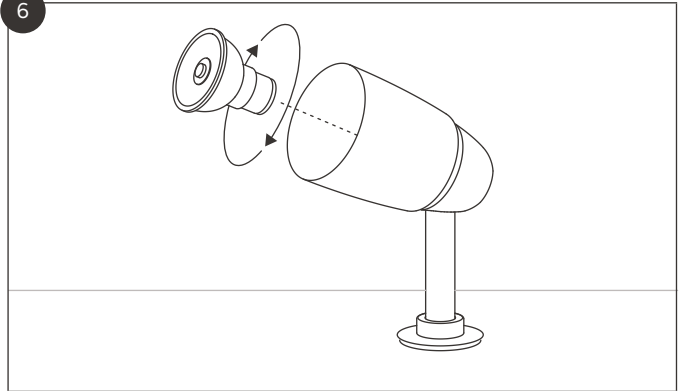

Add a GU10 bulb.

7

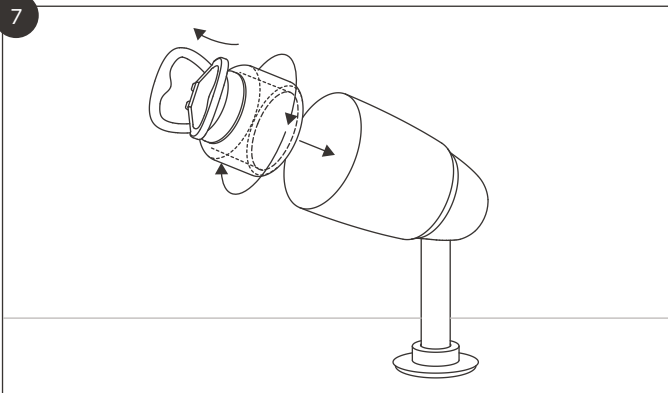

Fit the glass bulb cover using the tool provided.

Path spotlight

INCLUDED

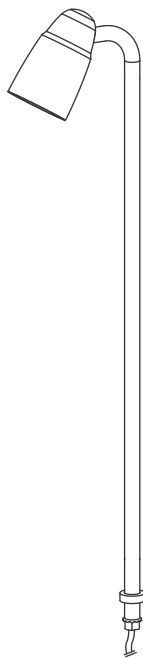

Light body x1



Spike cover x1

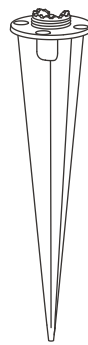

Spike x1

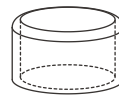

Glass bulb cover x1



Rubber gasket x1



Glass bulb cover tool x1

Path spotlight instructions

TOOLS YOU'LL NEED



Lights must be installed by a qualified electrician.
All lights should be installed in dry conditions.
Turn off electrical supply to circuit before installation.

Location	Exterior
Class	Class I
IP rating	IP56
Driver required	No
Fire rating	No
Cable length	3000mm
Bulb type	GU10
Max wattage	8W
Bulb included	No
Switched	No
Dimmable	Bulb dependent
Rated voltage	220V-240V
Rated frequency	50-60Hz

Path spotlight instructions

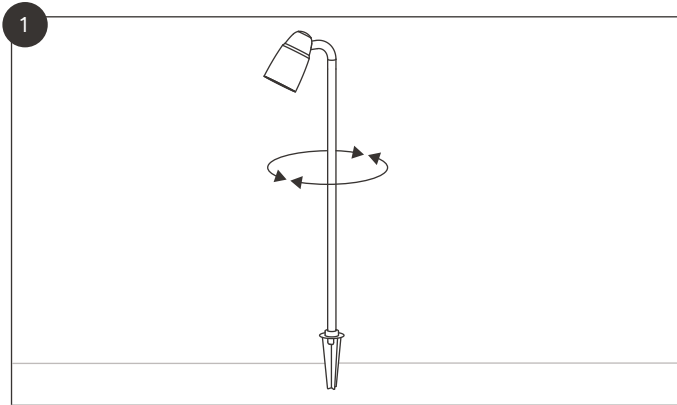

Align the spotlight direction with the spike.

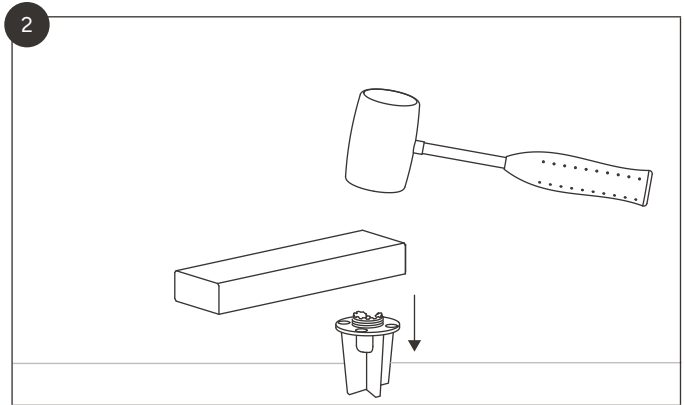

Remove the light body and hammer the spike into position.

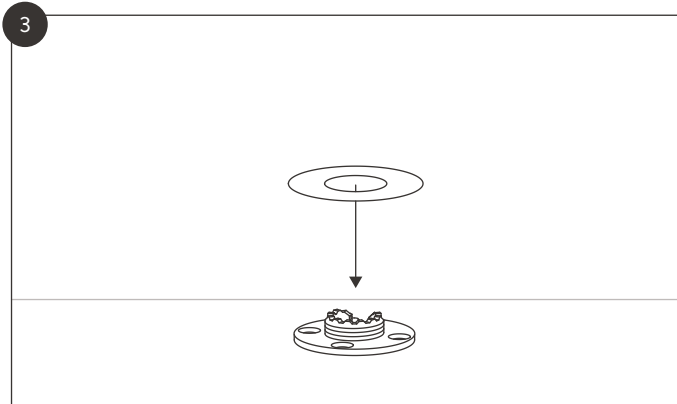

Cover the base with the brass spike cover.

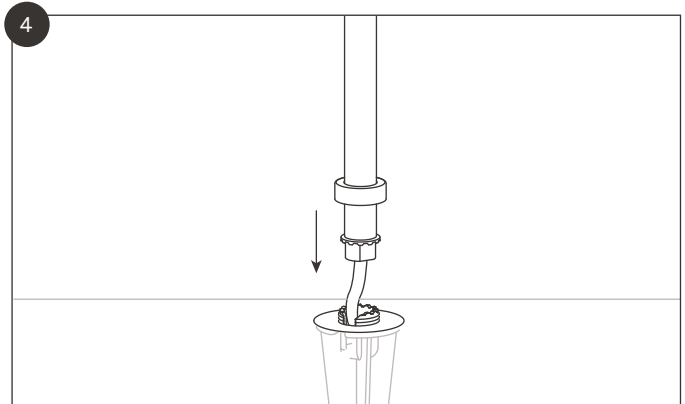

Feed the cable into position.

Path spotlight instructions

5

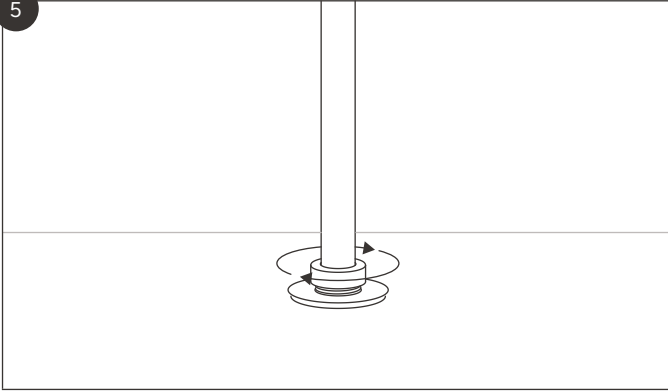

Place the light and tighten the collar.

6

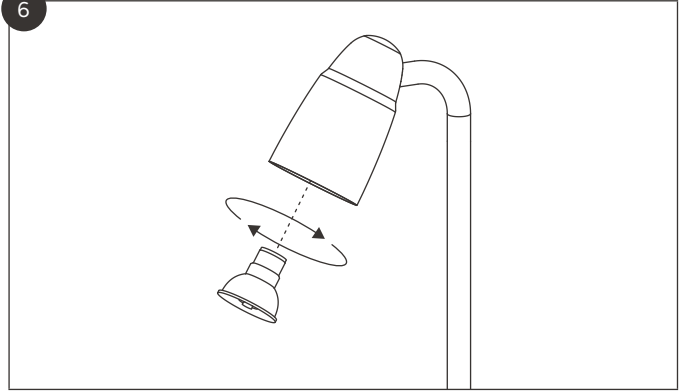

Add a GU10 bulb.

7

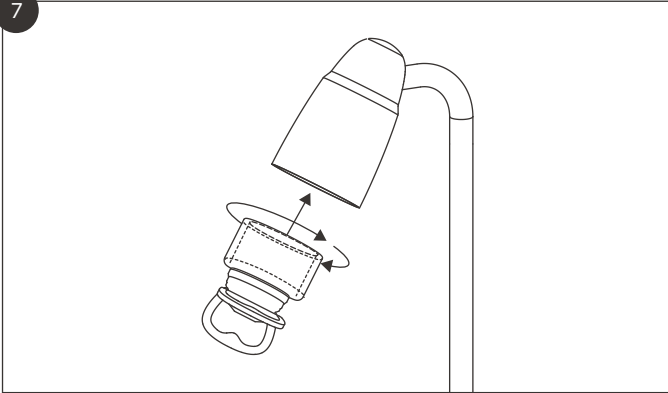

Fit the glass bulb cover using the tool provided.

Surface spotlight

INCLUDED

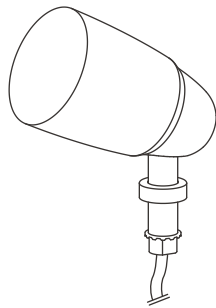

Light body x1



Anchor screw x3

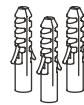

Anchor x3

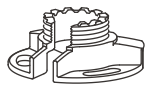

Wall mount x1

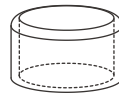

Glass bulb cover x1



Wall mount cover x1



Nylon washer x3



Glass bulb cover tool x1

Surface spotlight instructions

TOOLS YOU'LL NEED

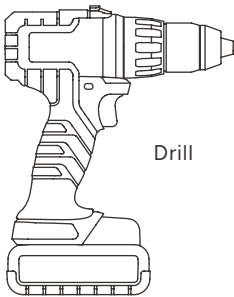

Drill



6mm drill bit



Crosshead screwdriver

Location	Exterior
Class	Class I
IP rating	IP56
Driver required	No
Fire rating	No
Cable length	3000mm
Bulb type	GU10
Max wattage	8W
Bulb included	No
Switched	No
Dimmable	Bulb dependent
Rated voltage	220V-240V
Rated frequency	50-60Hz

Lights must be installed by a qualified electrician.
All lights should be installed in dry conditions.
Turn off electrical supply to circuit before installation.

Surface spotlight instructions

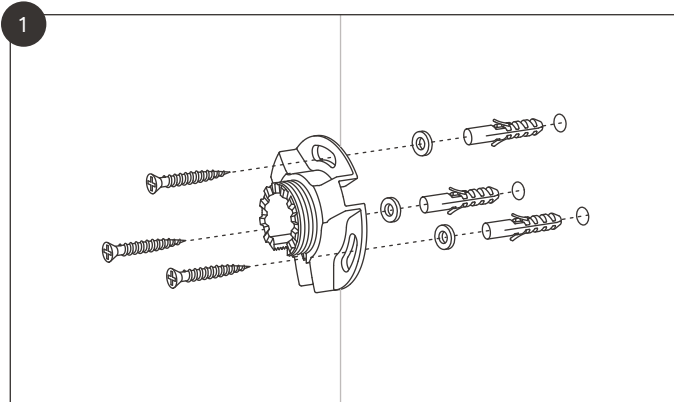

Drill holes, set anchors and screw the mount to the wall.

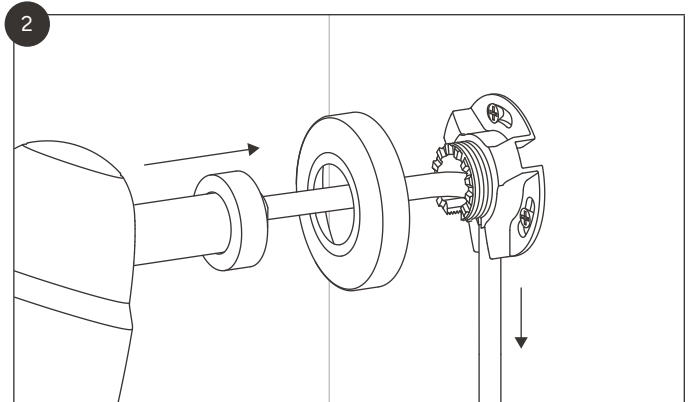

Feed the cable through the mount and down (or through) the wall. Install the wall mount cover.

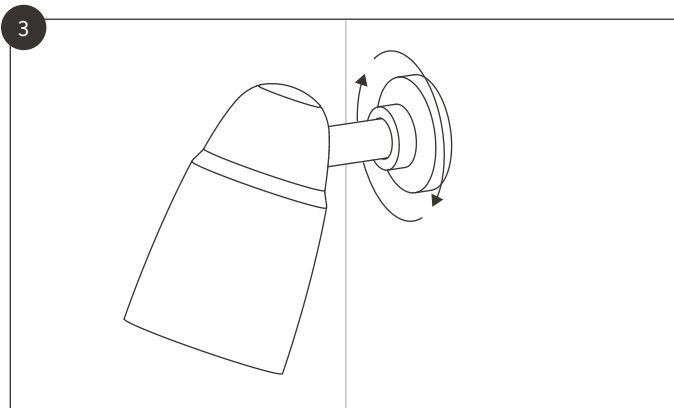

Fit the light body and tighten the wall mount cover to secure.

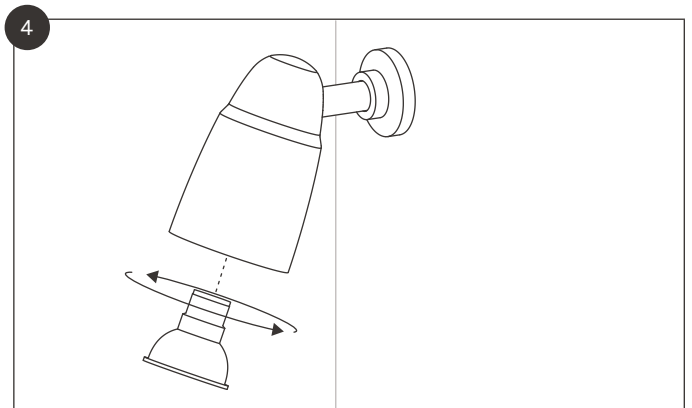

Add a GU10 bulb.

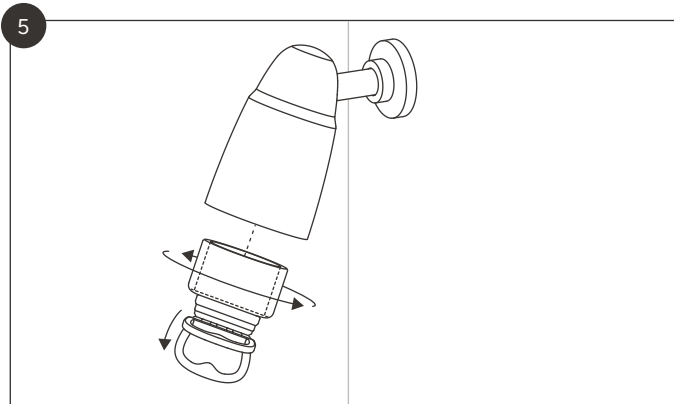

Fit the glass cover using the tool provided.

Flush spotlight

INCLUDED

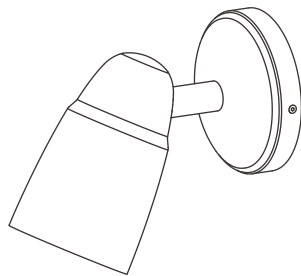

Light body x1



Rubber gasket x1



2-terminal WAGO x1

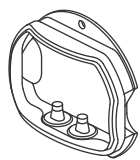

Wall mount x1



3-terminal WAGO x3

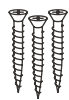

Wall screw x3

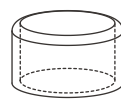

Glass bulb cover x1

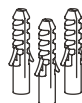

Anchor x3



Glass bulb cover tool x1

Flush spotlight instructions

TOOLS YOU'LL NEED

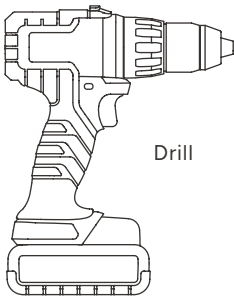

Drill



6mm drill bit



Crosshead screwdriver

Location	Exterior
Class	Class I
IP rating	IP56
Driver required	No
Fire rating	No
Cable length	3000mm
Bulb type	GU10
Max wattage	8W
Bulb included	No
Switched	No
Dimmable	Bulb dependent
Rated voltage	220V-240V
Rated frequency	50-60Hz

Lights must be installed by a qualified electrician.
All lights should be installed in dry conditions.
Turn off electrical supply to circuit before installation.

Flush spotlight instructions

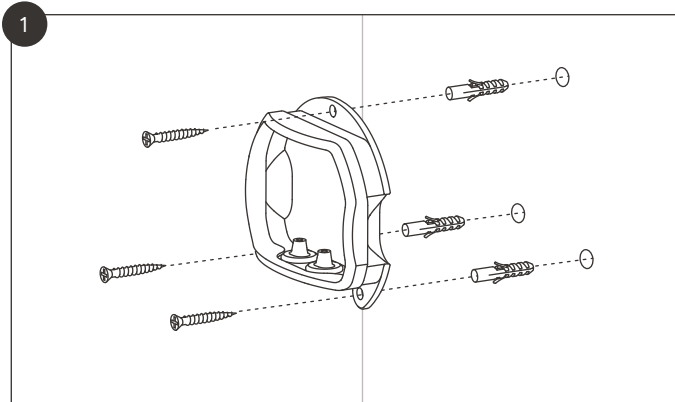

Drill holes, set anchors and screw the mount to the wall.

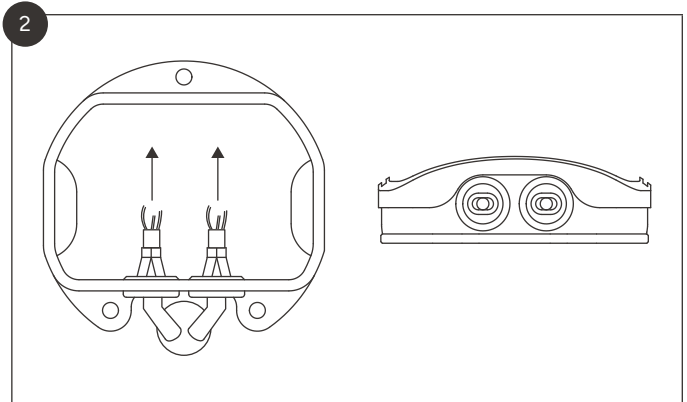

Feed the cable through the mount and down (or through) the wall. Install the wall mount cover.

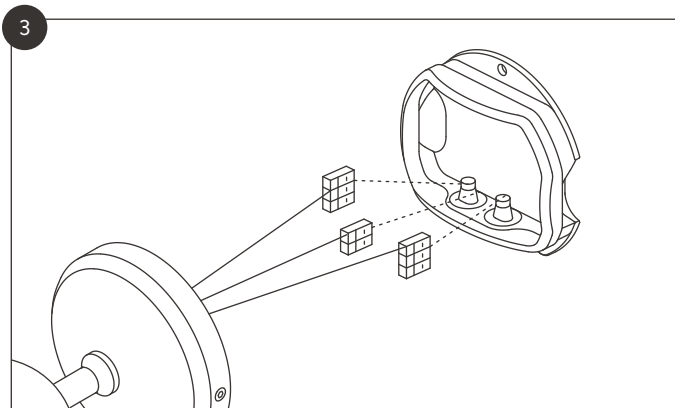

Make connections using the WAGOs.

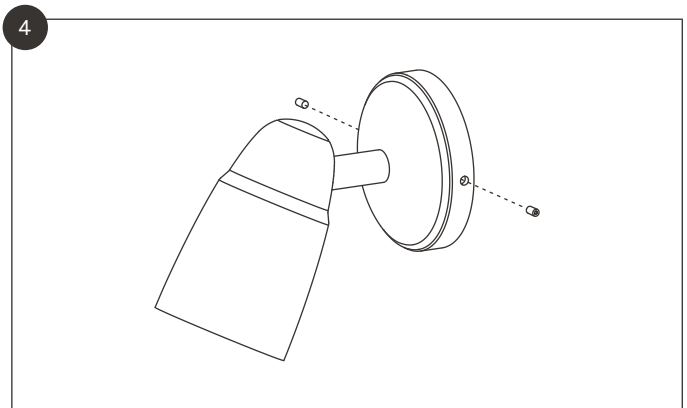

Fit the light body and tighten the wall mount cover to secure.

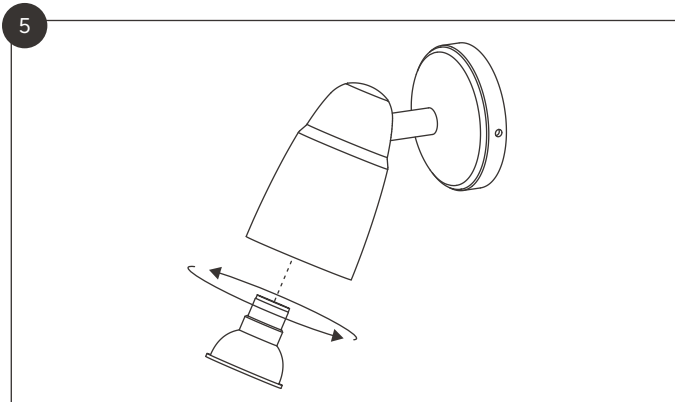

Add a GU10 bulb.

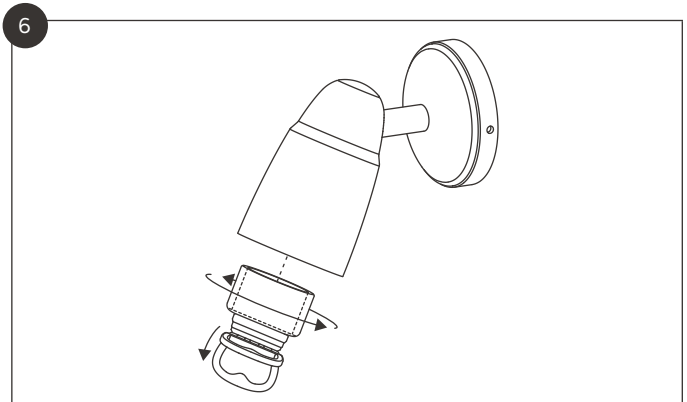

Fit the glass cover using the tool provided.

Straight connector

INCLUDED

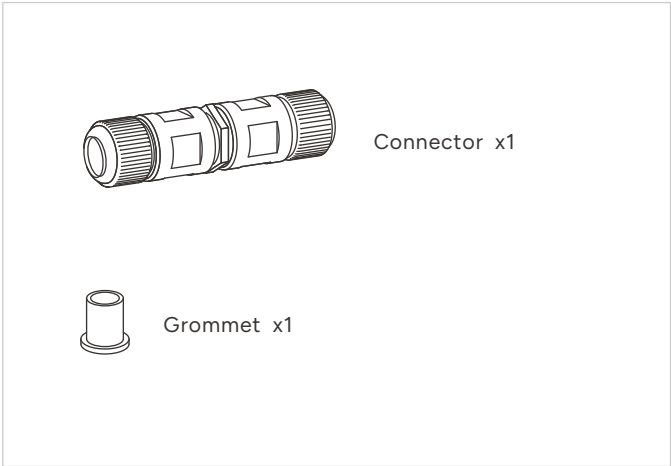

These products must be installed by a qualified electrician.
Turn off electrical supply to circuit before installation.

Location	Exterior
IP rating	IP68
Fire rating	No

Straight connector instructions

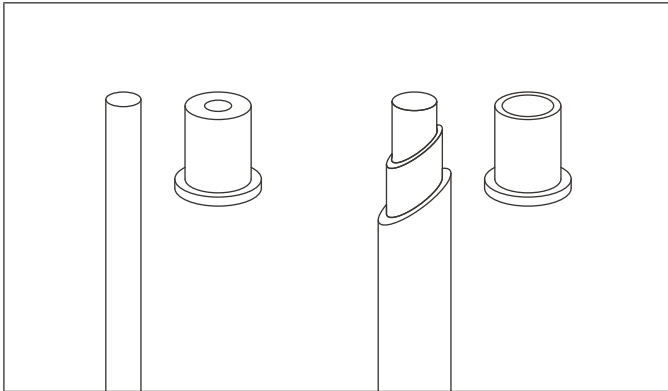

Note: swap grommets when using armoured cable.

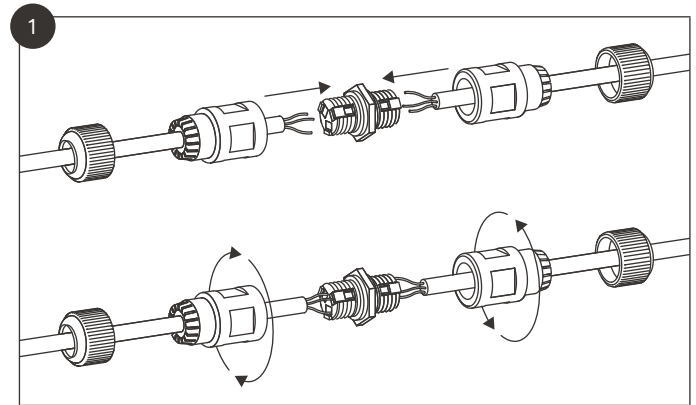

Connect the wires using the waterproof terminal.

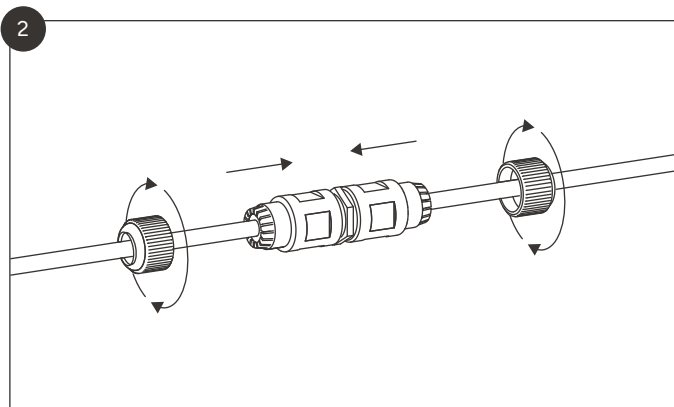

Screw the clamps on.

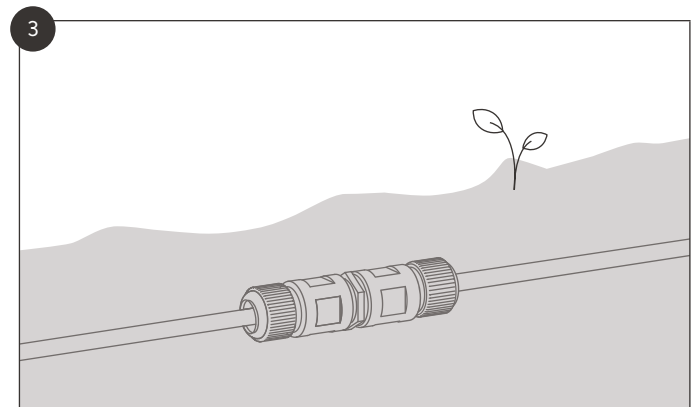

Hide the connector and cable as required, such as underground.

Split T connector

INCLUDED

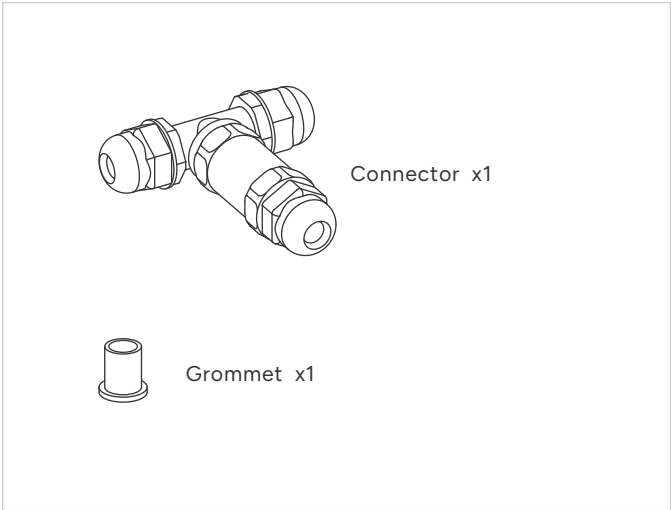

These products must be installed by a qualified electrician.
Turn off electrical supply to circuit before installation.

Location	Exterior
IP rating	IP68
Fire rating	No

Split T connector instructions

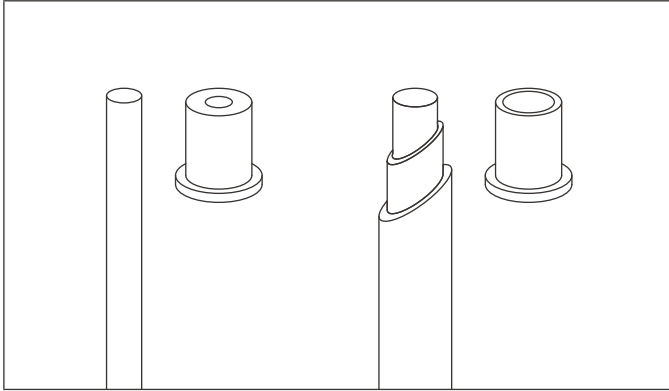

Note: swap grommets when using armoured cable.

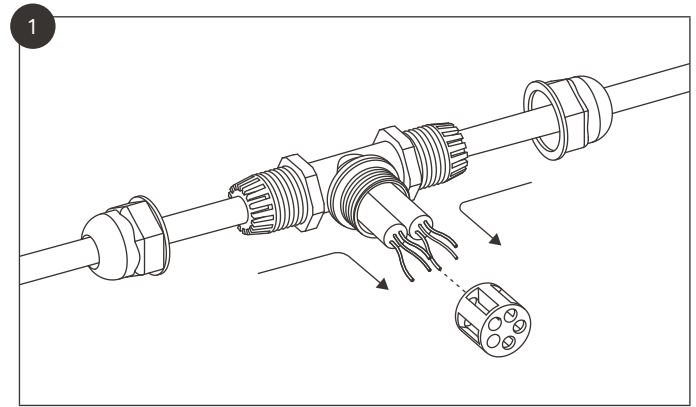

Connect the wires using the waterproof terminal.

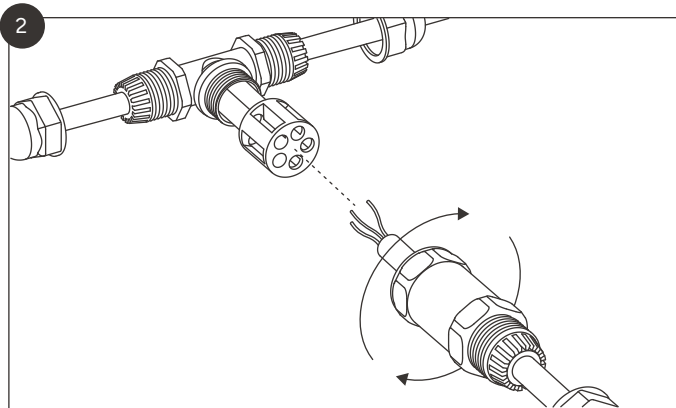

Screw the clamps on.

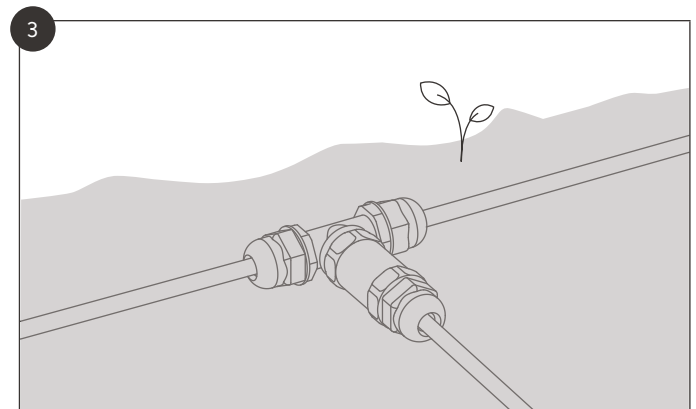

Hide the connector and cable as required, such as underground.