

QUICK-START GUIDE

This Quick Start Guide is not a substitute for the *User Instructions*. Before use, the wearer must read and understand the *User Instructions*.

1 POWER & VOLUME:

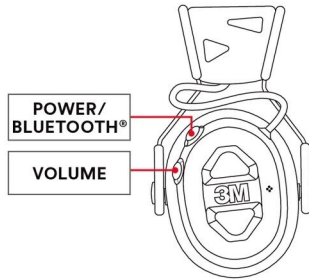

- Press and hold power button for 3 seconds to power ON/OFF headset.
- Voice Assist will announce "Power ON" or "Power OFF."
- Adjust ambient volume by selecting one of the four levels by pressing the volume button. To mute the ambient volume, press and hold the volume button. While muted, press the volume button once to return to your last volume setting.
- Performance is best when volume is set to lowest level needed for conversation.

2 PAIR DEVICE FUNCTION:

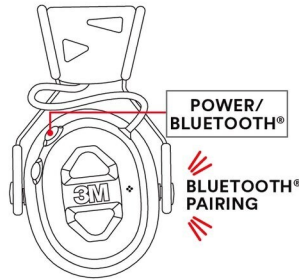

- Quickly double-tap the Bluetooth® button to enter pairing mode.
- You will hear "Bluetooth® pairing."
- Make sure your Bluetooth® enabled device is scanning/searching for devices.
- Check your device to make sure it has discovered "3M Pro-Protect."
- Select to connect to the hearing protector.

3 ONCE YOUR DEVICE IS PAIRED:

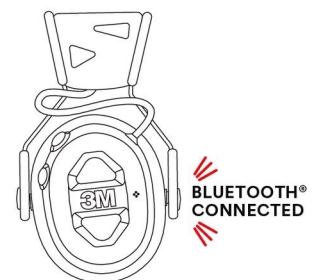

- Once connected successfully, you will hear "Bluetooth® connected."
- Once your device has been connected successfully to the "3M Pro-Protect," it will automatically link the next time you turn on the hearing protector.

4 INCOMING CALLS, MESSAGES, ALERTS & AUDIO PLAYBACK:

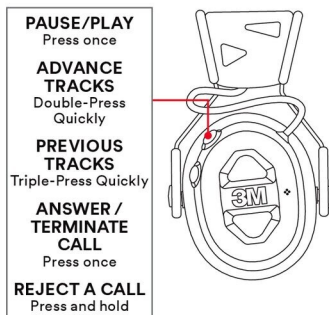

- To answer or disconnect a call, press the Bluetooth® button once.
- To reject a call and return to Bluetooth® from a "3M Pro-Protect" device, press and hold the Bluetooth® button.
- After disconnecting from the call, you will hear "Call terminated."

5 NAVIGATION:

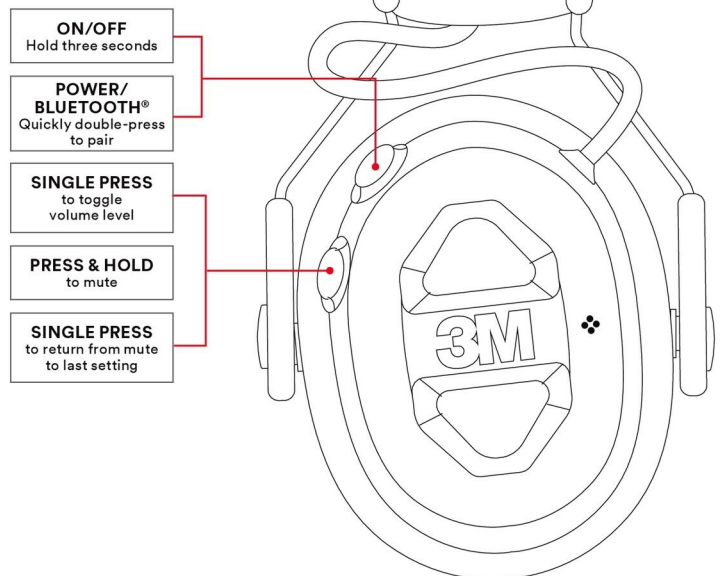

- **ON/OFF**
Hold three seconds
- **POWER/BLUETOOTH®**
Quickly double-press to pair
- **SINGLE PRESS**
to toggle volume level
- **PRESS & HOLD**
to mute
- **SINGLE PRESS**
to return from mute to last setting